

Emergency Evacuation Procedures

Sycamore Hall

Severe Weather

In the event of severe weather, all building occupants should immediately seek shelter in the designated shelter-in-place area in the building. If unable to safely move to the designated shelter-in-place area, seek shelter in a windowless interior room or hallway on the lowest floor of the building.

All building occupants should take shelter in the following areas of Sycamore Hall: basement, 1st floor of library, and interior hallways on the 2nd floor.

Bomb Threat/Fire

In the event of a bomb threat or fire in the building, all building occupants should immediately evacuate the building using the nearest exit. Once outside, proceed to the designated assembly area. If unable to safely move to the designated assembly area, contact on or more members of your department or unit to let them know you are safe and inform them of your whereabouts.

All building occupants should immediately evacuate the building and proceed to the area north of the University Union.

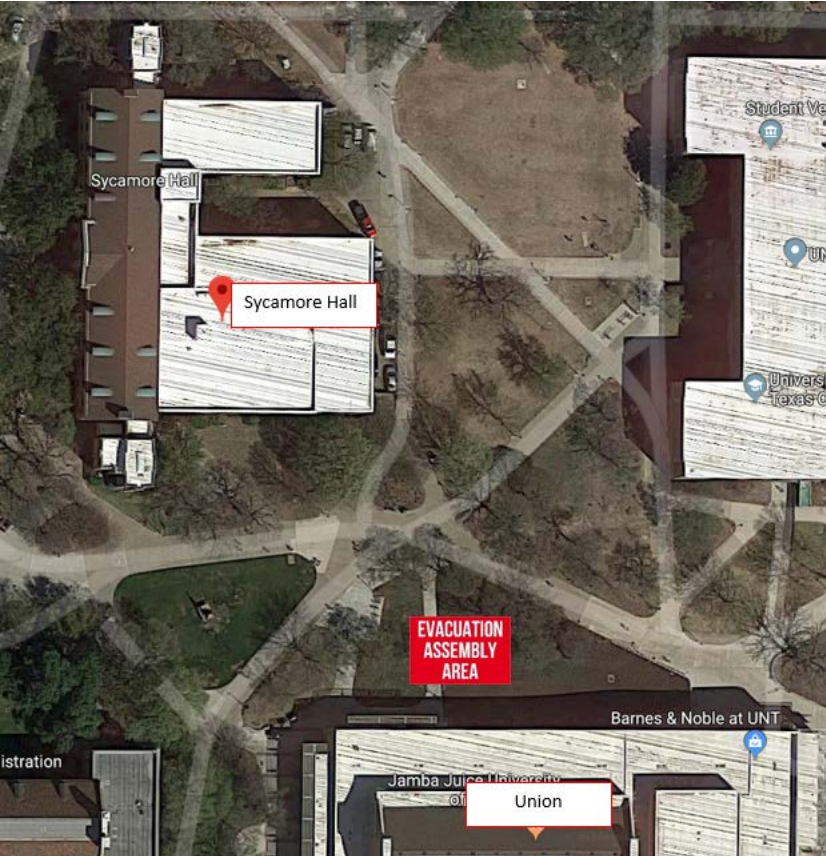

SYCAMORE HALL

BLDG #0111

11-2012



Exterior Gross Area
15753



BASEMENT FLOOR PLAN





Safety Legend

-  Areas of Refuge
-  Tornado Shelter Areas

 Exit/Evacuation Routes

In case of fire, do not use elevator

 Automatic External Defibrillator

 Evacuation Chair

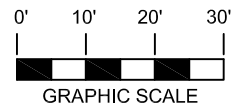

SYCAMORE HALL

BLDG #0111

02-2018

Exterior Gross Area
30990

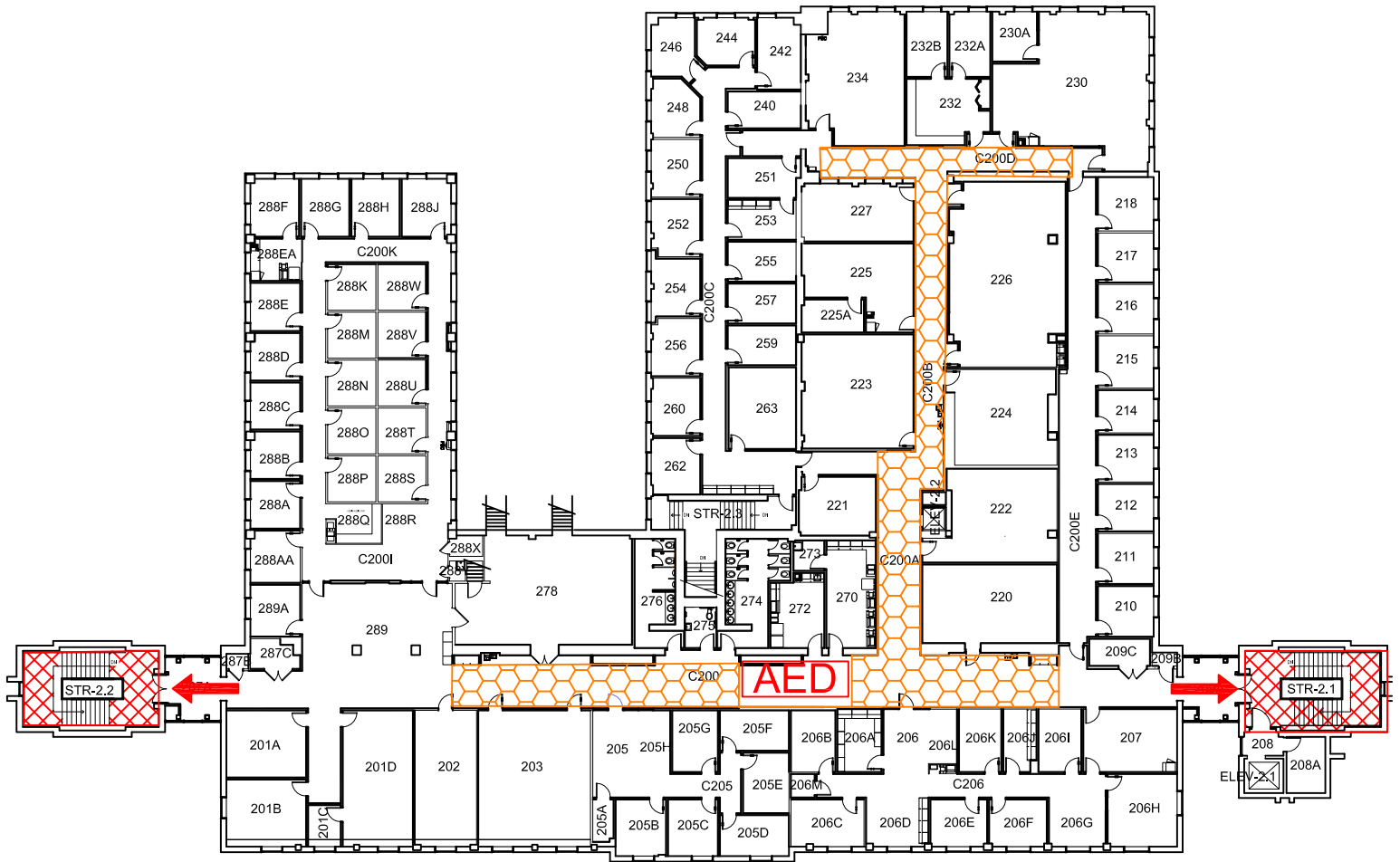



N ⊕ SECOND FLOOR PLAN



Safety Legend

 Areas of Refuge

 Tornado Shelter Areas

 Exit/Evacuation Routes

In case of fire, do not use elevator

 Automatic External Defibrillator

 Evacuation Chair