

# Emergency Evacuation Procedures

## Speech & Hearing Clinic

### Page Navigation

- [Severe Weather](#)
  - [Bomb Threat/Fire](#)
  - [Building Evacuation Maps](#)
- 

### Severe Weather

In the event of severe weather, all building occupants should immediately seek shelter in the designated shelter-in-place area in the building. If unable to safely move to the designated shelter-in-place area, seek shelter in a windowless interior room or hallway on the lowest floor of the building.

**All staff and others will proceed to the rooms 154, 156, and 158 sound booths.**

---

### Bomb Threat/Fire

In the event of a bomb threat or fire in the building, all building occupants should immediately evacuate the building using the nearest exit. Once outside, proceed to the designated assembly area. If unable to safely move to the designated assembly area, contact one or more members of your department or unit to let them know you are safe and inform them of your whereabouts.

Persons with mobility impairments who are unable to safely exit the building should move to a designated area of refuge and await assistance from emergency responders.

**All exits are clearly marked and all staff and others will immediately evacuate the building and proceed to the south end of parking lot 56 south of the building.**

---

### Building Evacuation Maps





[Print Full Size Map](#)

# SPEECH AND HEARING CLINIC

BUILDING # 0332  
07-2007

Exterior Gross Area  
8509

### Safety Legend

-  Areas of Refuge
-  Tornado Shelter Areas
-  Exit/Evacuation Routes
- In case of fire, do not use elevator*
-  AED Automatic External Defibrillator
-  Evacuation Chair

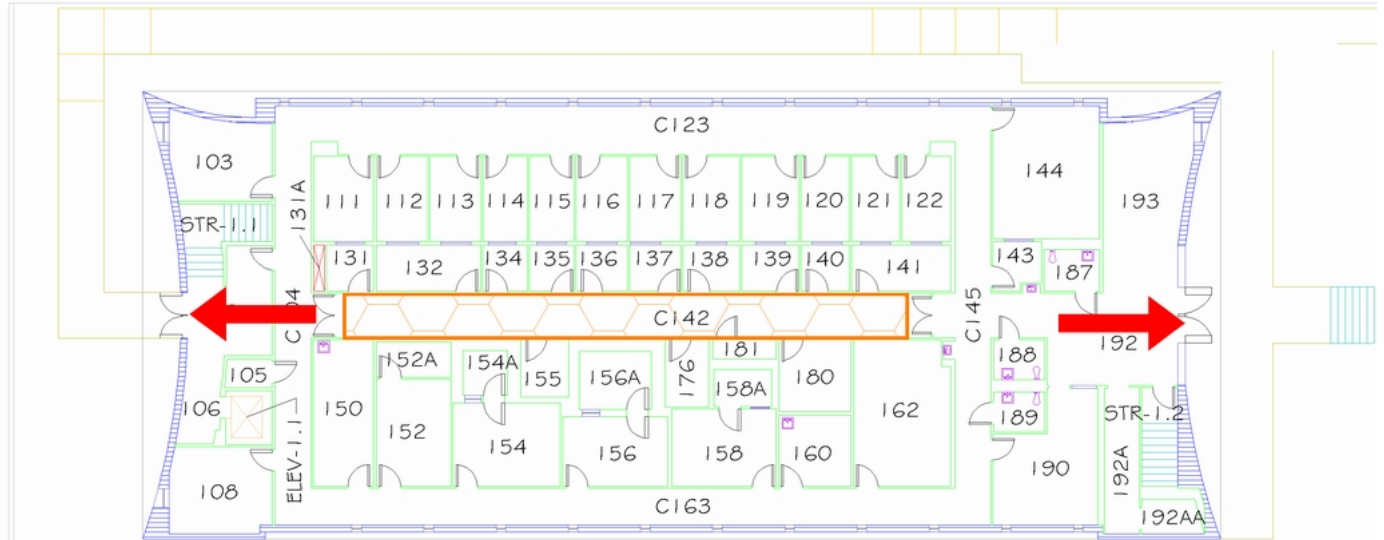

FIRST FLOOR PLAN

[Print Full Size Map](#)

# SPEECH AND HEARING CLINIC

## BUILDING # 0332

### 04-2009

Exterior Gross Area  
8300

#### Safety Legend

 Areas of Refuge

 Tornado Shelter Areas

 Exit/Evacuation Routes

*In case of fire, do not use elevator*

 AED Automatic External Defibrillator

 CHAIR Evacuation Chair

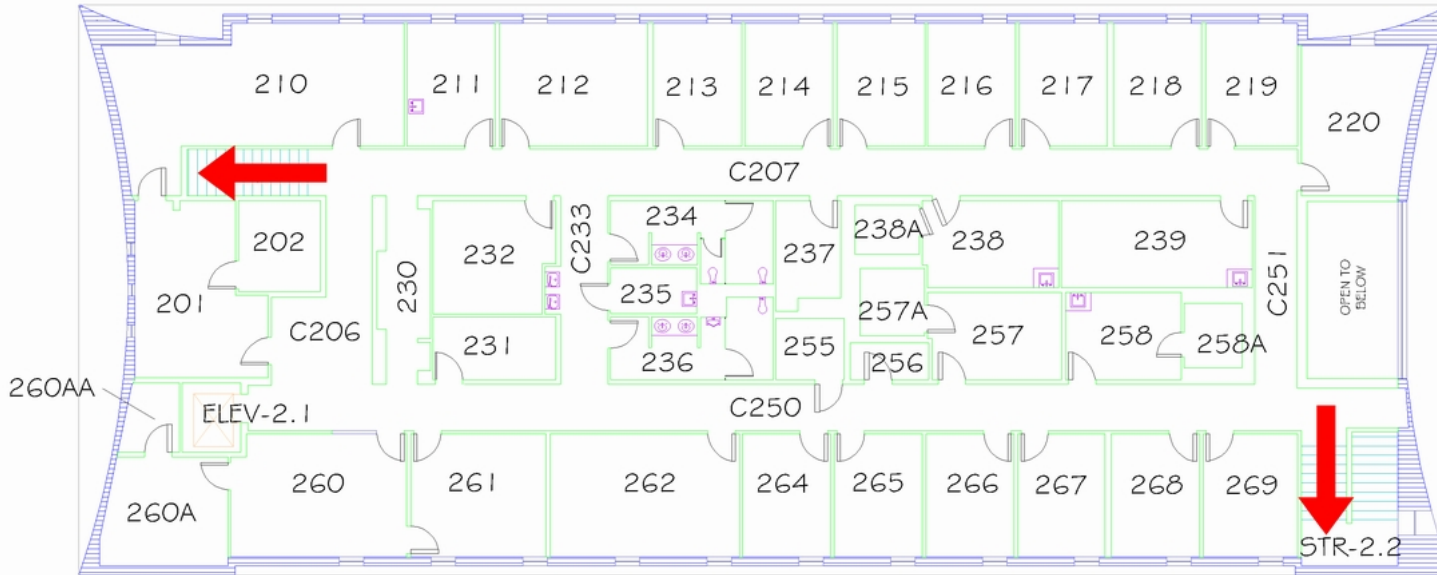

### SECOND FLOOR PLAN

