



Corridor-Based Work Zone Performance Measures: I-35, Central Texas

Work Zone Performance
Management Peer Exchange
Workshop

May 8, 2013 ♦ Atlanta, Georgia



I-35 Construction Corridor

- 15 sections
- 5 years
- 90+ miles
- Up to 11 projects active at one time
- 55k -110k ADT
- ~ 66% through traffic
- > 75% trucks at night

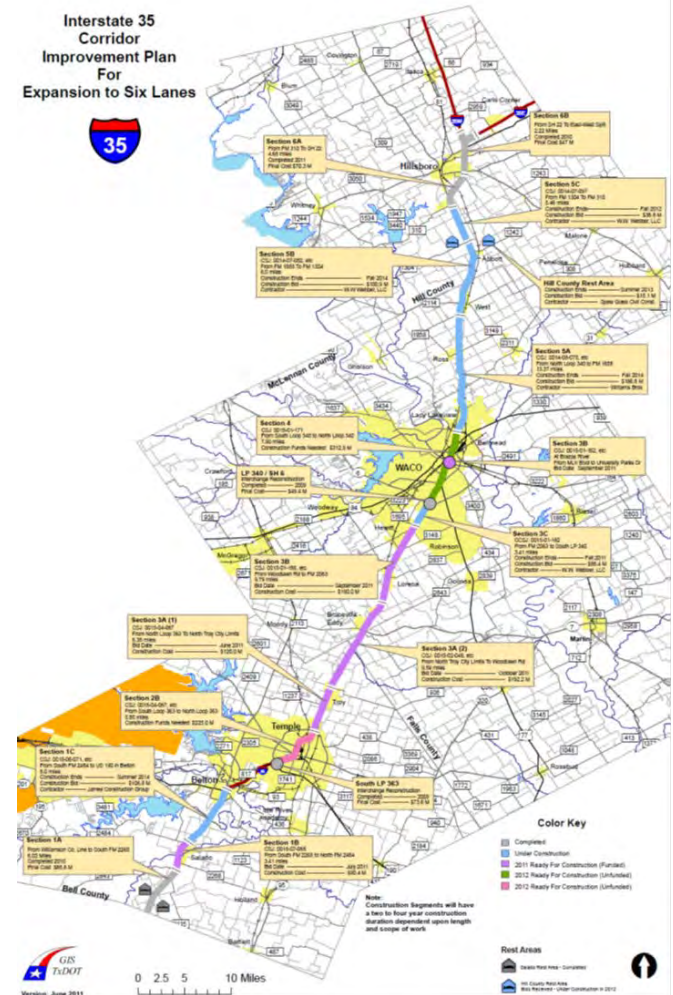



Vision for Traveler Information During Construction

- Provide information on current and anticipated travel conditions across multiple construction zones to assist:
 - Local residents
 - Regional travelers
 - Long-distance travelers
- Focus of system is on the construction-related impacts



Key Construction-Related Traffic Issues

- Multiple contractors working independently
- Nighttime lane closures
 - Some create queues, some do not
 - Potential for several in same direction of travel per night
- Alternative routes are limited (Waco, Temple, Belton)

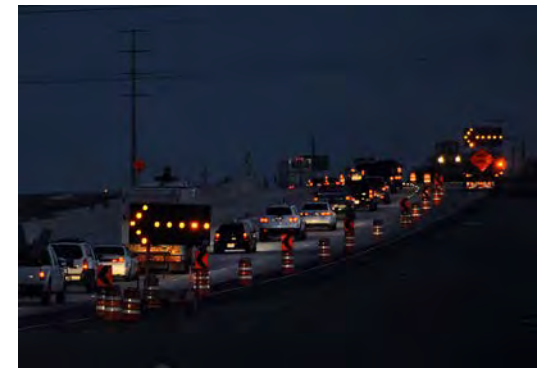
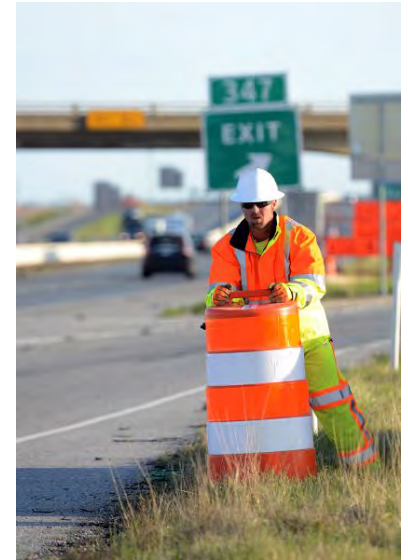

I-35 Data Sources

- Corridor lane closure database
- Traffic volumes
- Bluetooth travel time monitoring
- End-of-queue warning systems

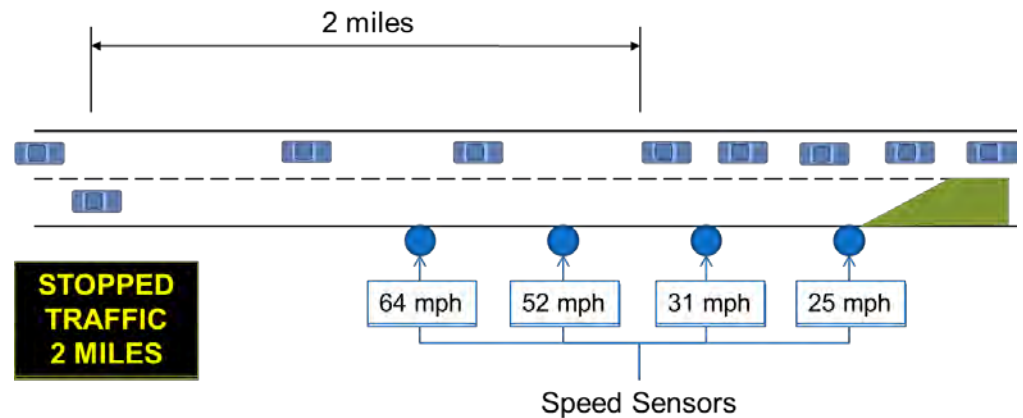



I-35 Corridor Measures

- Types of lane closures (full versus single lane)
- Advance notification times for lane closures
- Queues
 - % of lane closures causing queues
 - Maximum lengths
- Delays

Lane Closure Types and Notification

Closures by Impact

(March 2013)

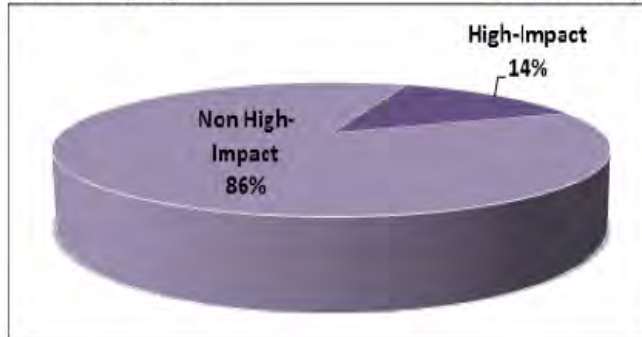

Completed vs. Cancelled Closures

(March 2013)

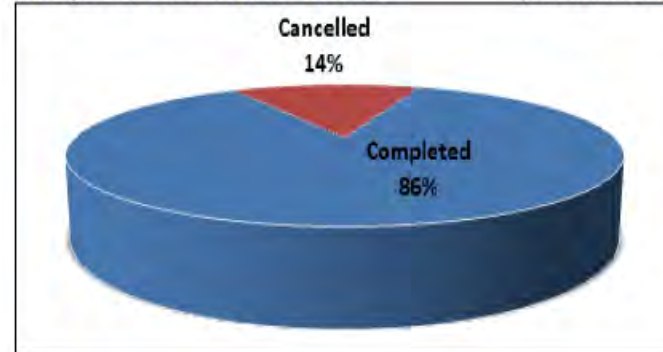

Distribution of Advance Closure Notification Times

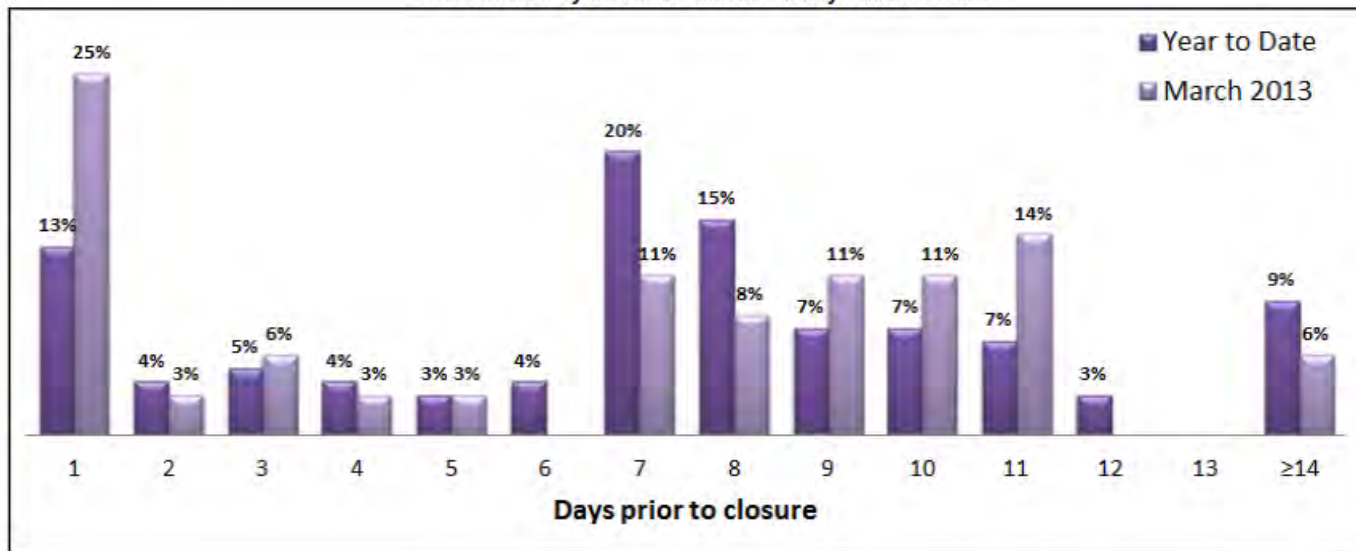

I-35 Closure Impacts - Queues

Percent of Lane Closures with Maximum Predicted Queue Length

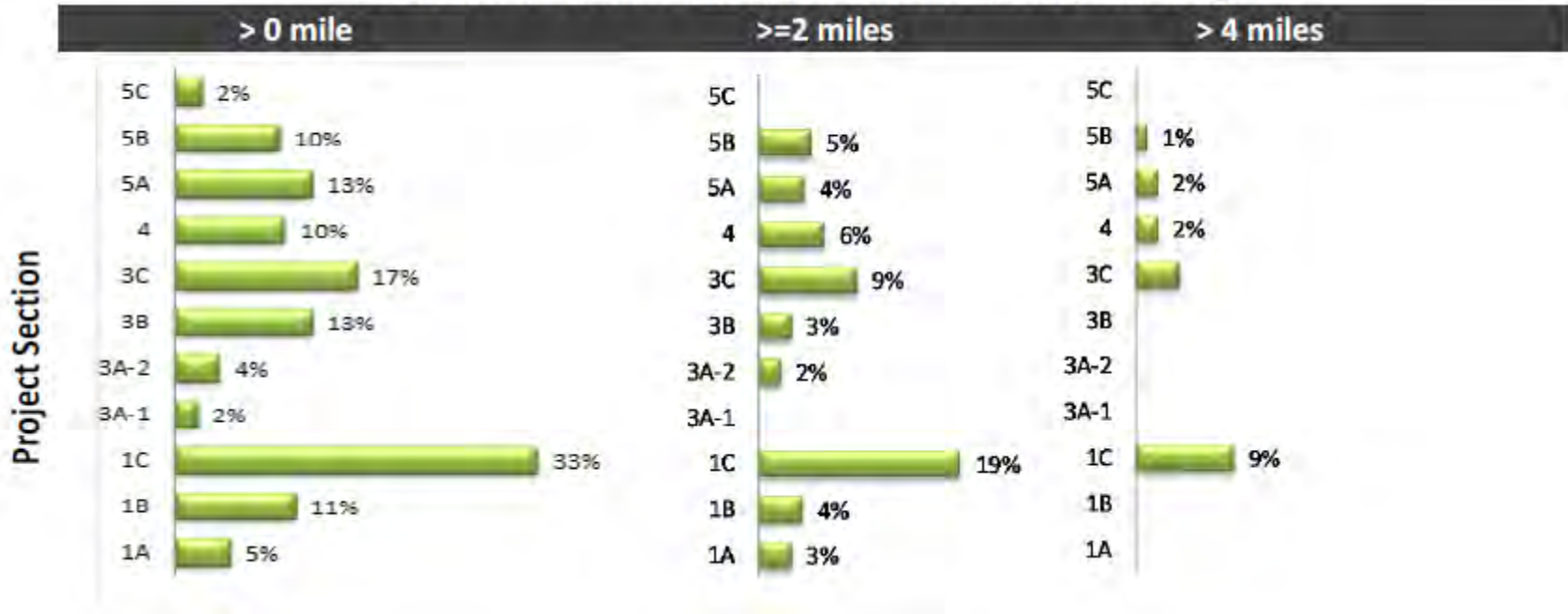

I-35 Closure Impacts-Delays

Percent of Lane Closures with Delay

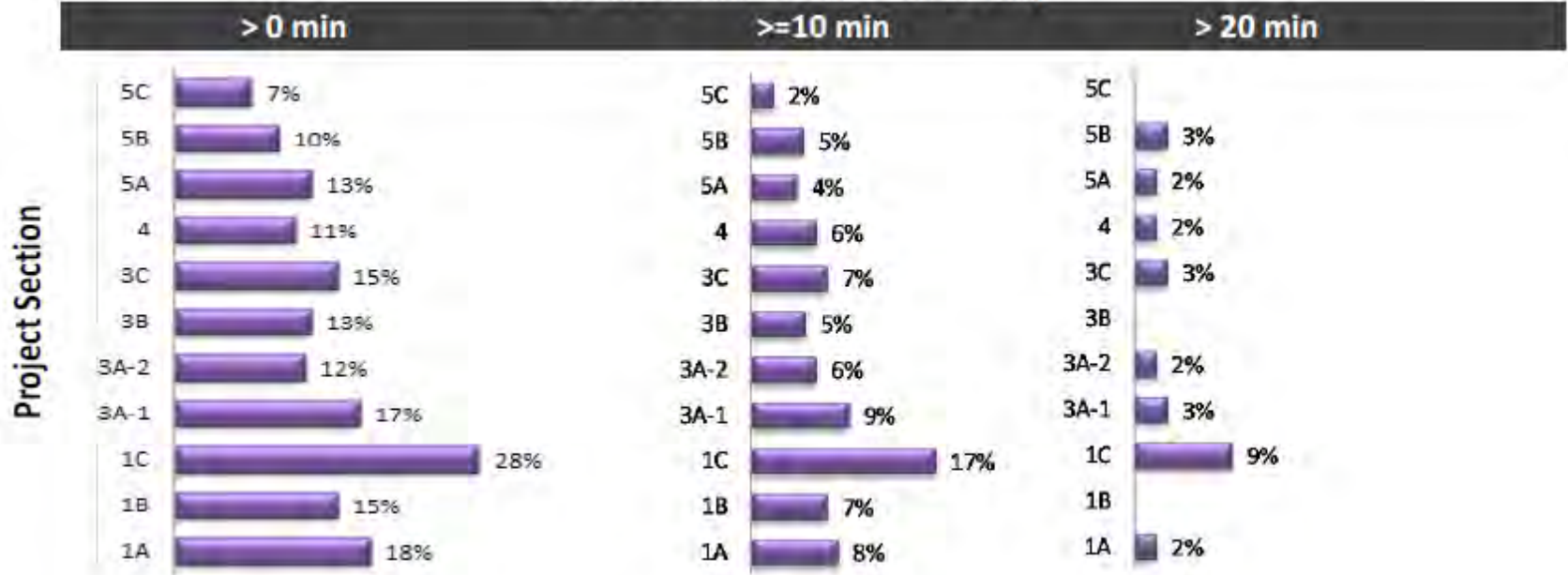

Drivers' Delay Experience

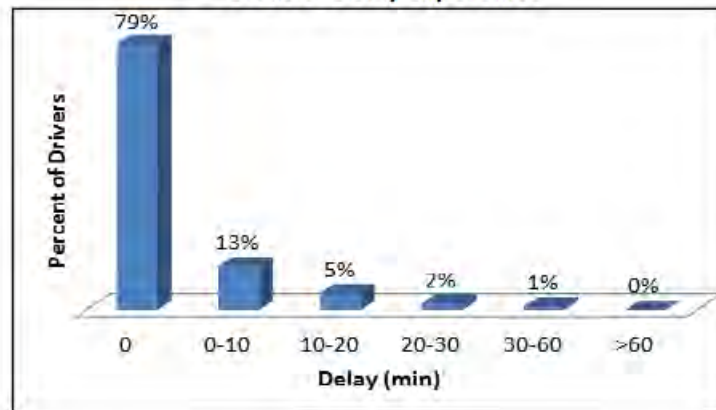

I-35 Corridor Impacts - Crashes

- Project and corridor-level changes
- Tracked in near real-time
- Associate back to key work activities (i.e., nighttime freeway lane closures)

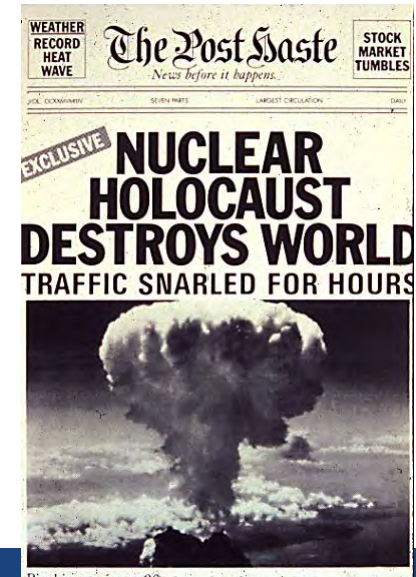



Discussion Questions

- What other corridor-level measures would your agency be interested in?
- What risks, if any, do you anticipate with possible misuse of these types of measures (from the media, political leaders, etc.)?