

CONSTRUCTION NOTICE

Chicago O'Hare Intl (ORD) Chicago, Illinois

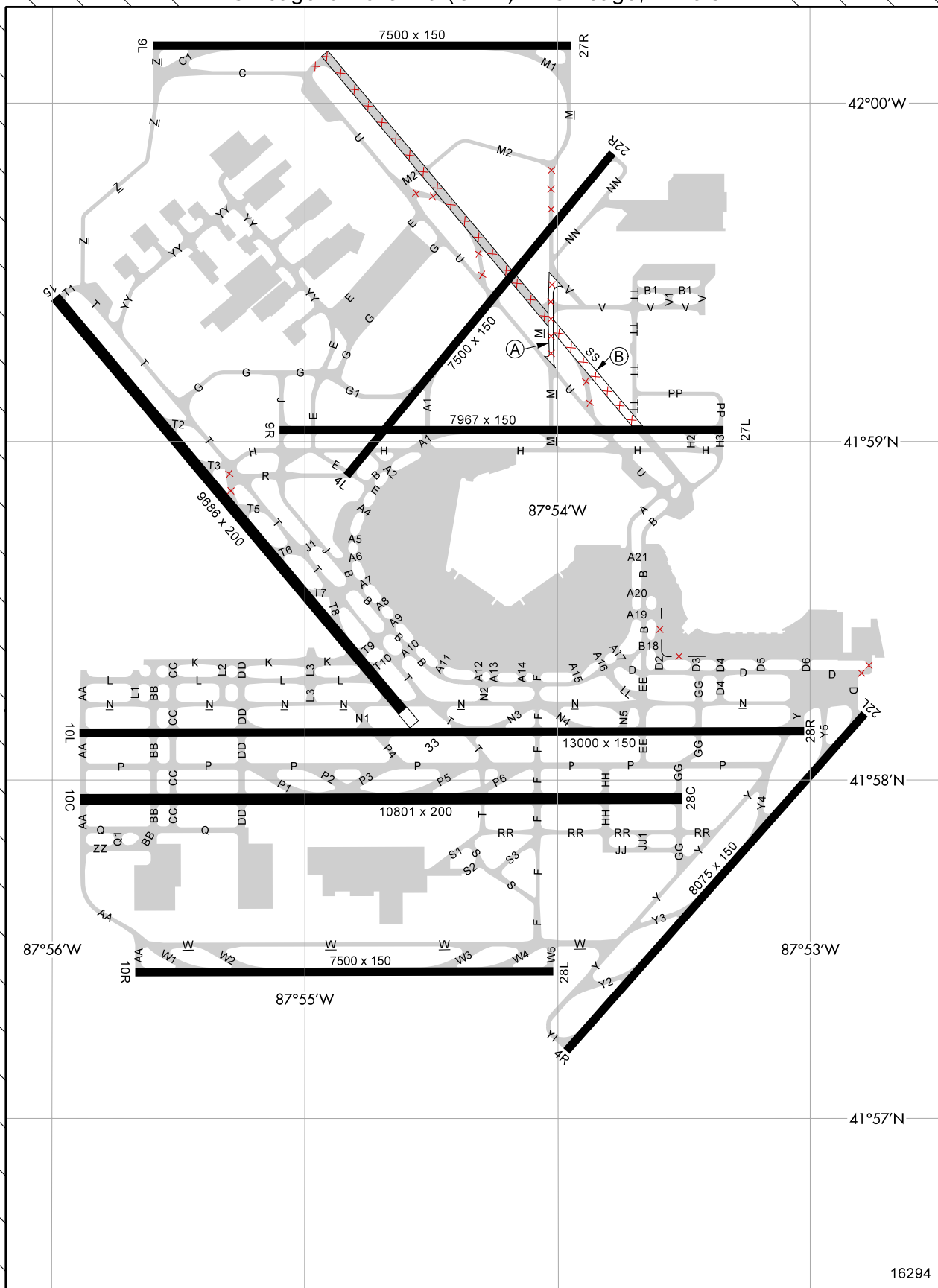

NOTAM

- (A) 09/615 TWY M BTN TWY U AND TWY V CLSD
- (B) 09/129 TWY SS BTN RWY 09R/27L AND TWY M CLSD

START DATE FINISH DATE

SEP 16, 2016 NOV 25, 2016
 SEP 30, 2016 NOV 25, 2016

NOTE: This diagram is intended to display published NOTAMS and is checked and updated daily (Mon. - Fri. only; no holidays); temporary closures and openings of less than 24 hours are not depicted; runway length shown is maximum length (shortened distances are not depicted); diagrams containing new runway surfaces will be deleted after (FAA) revised airport diagrams are published. Always CHECK CURRENT NOTAMS.

Consult NOTAMS for Latest Information