

Patient Services Center

The center is located inside the west entrance of the hospital and houses the Patient Advocate Office, Patient- and Family-Centered Care Resource Center, Ombudsman, and American Red Cross. The PAC is open Monday-Friday from 8:00 a.m.- 4:00 p.m. They help patients who have questions, problems or concerns about medical care and/or medical staff. Services provided at no cost include the use of a courtesy phone, computers, and television. They also make copies, send fax, provide community resources, and health information. To contact the PAS, call 526-7225.

Pharmacy

The main pharmacy is open Monday through Thursday 8 a.m. to 6 p.m., Friday 8 a.m. to 5 p.m. and Saturday 8 a.m. to 4 p.m. The WSFCC Pharmacy is open Monday through Friday 8 a.m. to 5 p.m.

Healer Chapel

Open 24 hours a day. Worship service schedule displayed at chapel. The chaplain can be reached at 526-7386/7412 or through the hospital operator (526-7000).

Dining

The dining facility is near the west entrance. Vending machines with soft drinks and snacks are available outside the dining facility and on the first floor of the WSFCC. A coffee shop is located on the first floor of the WSFCC.

Translator Service

Interpretive services for sign language and language translation are available at no cost and can be arranged through your healthcare team. Please ask at any clinic's front desk for this assistance if necessary.

PHONE NUMBERS

Army Wellness Center	526-3887
Acupuncture	526-5033
Allergy Clinic.....	526-7451
American Red Cross	526-7144
Behavioral Health	526-7155
Cardiology.....	526-7774
Child & Family Assistance Center	526-0771
Chiropractic Clinic.....	526-7834
Dermatology Clinic.....	526-7185
Dietitian	526-7290
Disease Management.....	526-7022
Ear, Nose & Throat Clinic	524-6399
EFMP.....	526-7805
Emergency Department	526-7111
Gastroenterology.....	526-7453
General Surgery Clinic.....	524-4166
Internal Medicine Clinic	526-7160
Laboratory.....	526-7791
Neurology.....	526-7632
OB/GYN Appointments	526-CARE (2273)
Occupational Therapy.....	526-7110
Optometry	526-7450
Orthopedic Clinic.....	526-7440
Pain Clinic	526-5033
Patient Advocate	526-7225
Pediatric Clinic.....	526-7653
Pharmacy	526-7410/9959
Pharmacy Refill.....	1-888-745-6427/524-4081
Physical Therapy.....	526-7120
Podiatry	526-7435
Preventive Medicine Clinic	526-2939
Radiology/X Ray	526-7300
Release of Information.....	526-7322
Social Work Services	526-4585
TRICARE.....	1-877-988-WEST (9378)
Urology Clinic	526-7115
Warrior Recovery.....	526-3286

Making an Appointment

Call the Pikes Peak Regional Access to Care line at 526-CARE (2273) or online at www.tricareonline.com

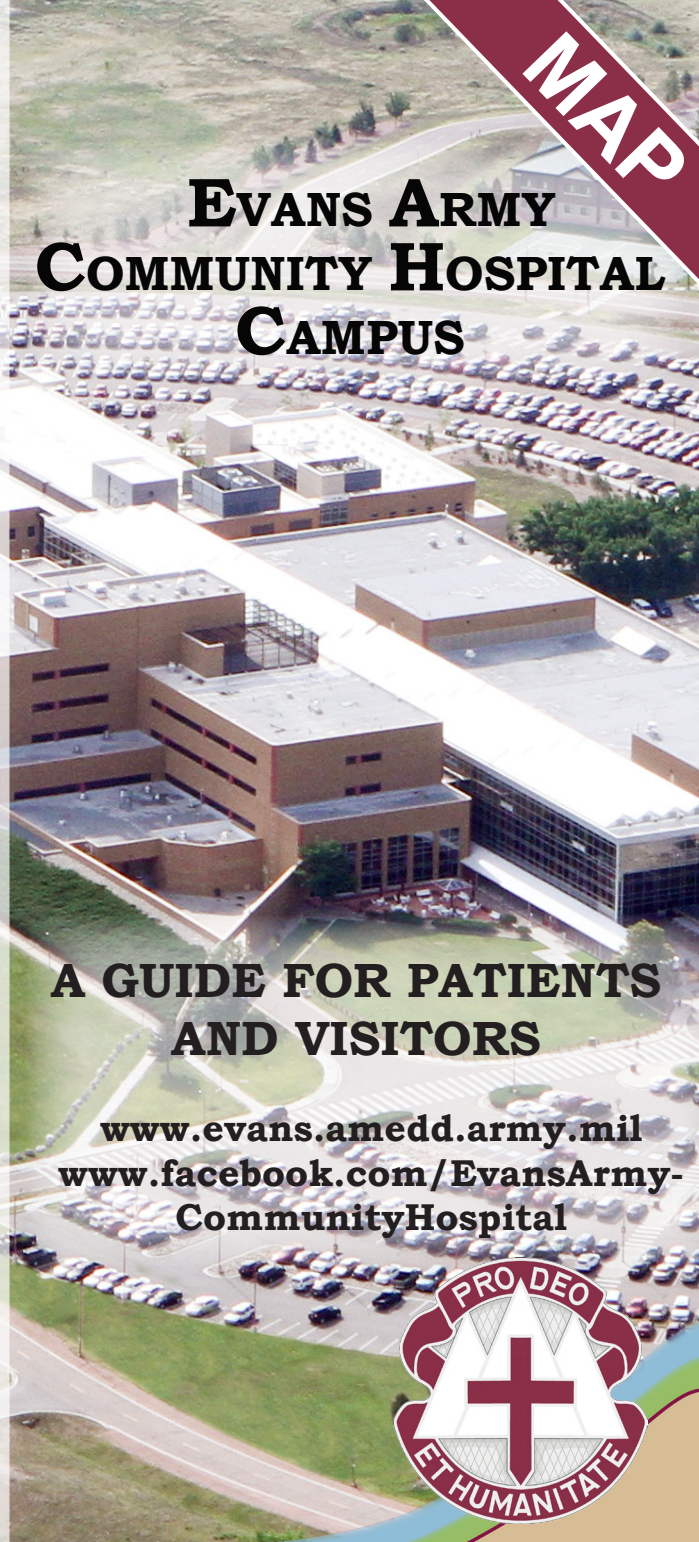

EVANS ARMY COMMUNITY HOSPITAL CAMPUS

A GUIDE FOR PATIENTS AND VISITORS

www.evans.amedd.army.mil
www.facebook.com/EvansArmyCommunityHospital



ABOUT US

Evans Army Community Hospital is part of the Fort Carson U.S. Army Medical Department Activity (MEDDAC), a premier system of health providing services to more than 72,000 Soldiers, Family members and retirees in the Front Range. Evans provides a full range of services for patients, from routine primary care to sophisticated, high-tech speciality care.

All of our enrollees are assigned a personal Primary Care Manager at one of our Family Medicine Clinics or Medical Homes. Each of them operate on the Patient-Centered Medical Home model. This concept puts the beneficiary at the center of a core health care team. Working in tandem with the beneficiary on a personalized health plan, the PCM and his/her core health team provides or arranges for necessary care in a timely manner.

Visiting Hours & Security

All exterior public building entrances are locked at the end of the duty day. To enter the hospital after hours or on the weekend, use the west entrance. Our Family Care Ward has open visiting hours.

Family Medicine Clinics

Iron Horse Clinic 524-4068
Robinson Clinic 524-4142
Warrior Clinic 526-9277

Community-Based Medical Homes

Mountain Post 524-7601
Premier 524-7601

Evans First/Ground Floor

Woods SFCC Second Floor

Woods SFCC First/Ground Floor

West Entrance
(Mountain side)

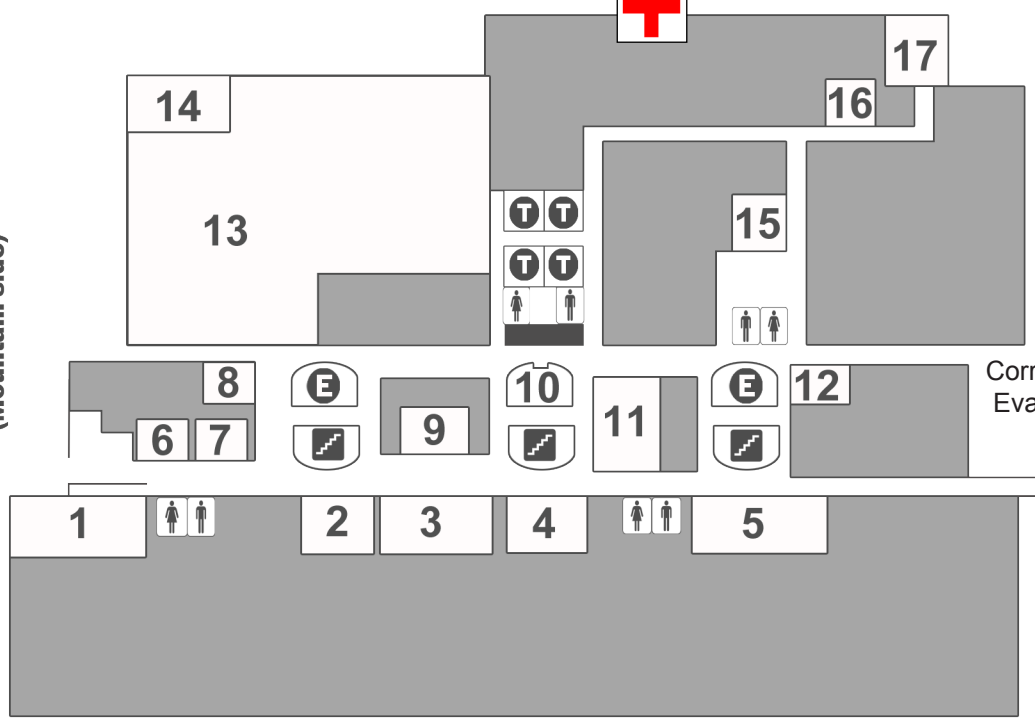

Corridor between
Evans and SFCC

To HQ Bldg

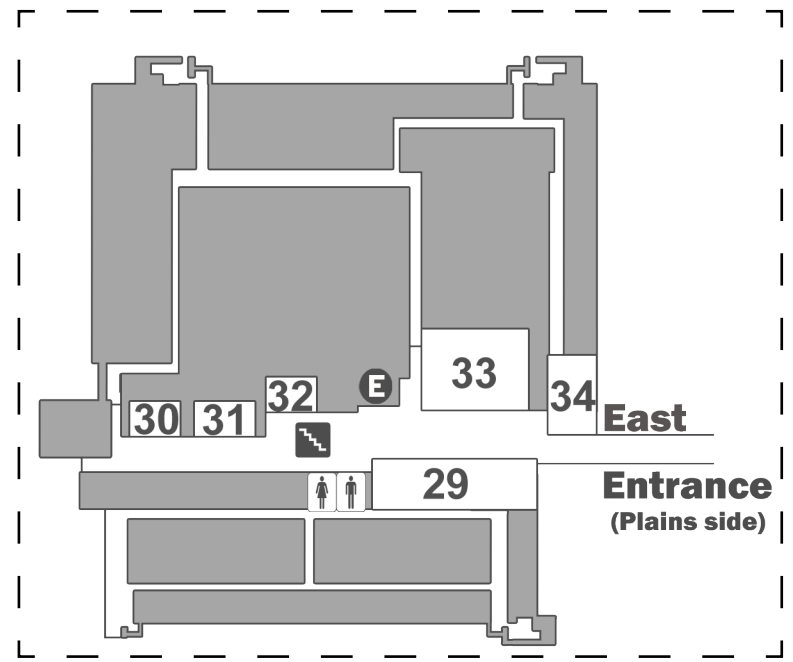

East

Entrance
(Plains side)

DIRECTORY

Acupuncture41	Dermatology2	Ombudsman36
Admissions/ Dispositions10	Dining Facility13	Optometry19
Allergy4	Ear, Nose & Throat ..20	Orthopedics40
Aspen Room14	EFMP35	Pain Clinic21
Audiology20	Family Care Ward *	Patient Advocate6
Birth Registrar12	General Surgery18	Pediatrics37
Breast Care Clinic...14	G.I. Clinic26	Patient Services Ctr...6
BK George Hall8	Gift Shop7	Pharmacy-Main9
Cardiology2	Immunizations/Adult ..4	Pharmacy-WFCC ..33
Chapel11	Intensive Care Unit ..28	Physical Therapy41
Child & Family Assistance Ctr...34	Internal Medicine3	Podiatry40
Chiropractic41	Iron Horse Clinic38	Radiology 15&39
Cochrane Hall22	Laboratory5	Records32
Coffee Shop30	Maternity *	Red Cross6
Conf. Rm 100431	Medical Library25	Same Day Surgery ..27
Conf. Rm 310442	MRI17	Sleep Lab24
DENTAC29	Neurology4	Urology21
	OB/GYN1	Warrior Clinic22
	Occup. Therapy41	

**EACH
Floor**

Clinic	
Maternity	3
Family Care Ward	4

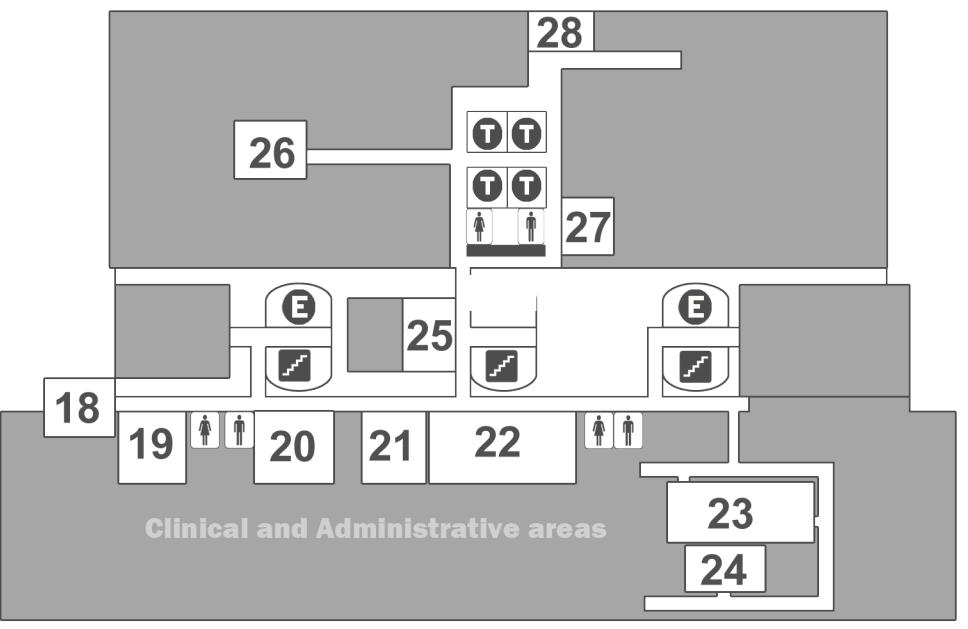

Evans Second Floor

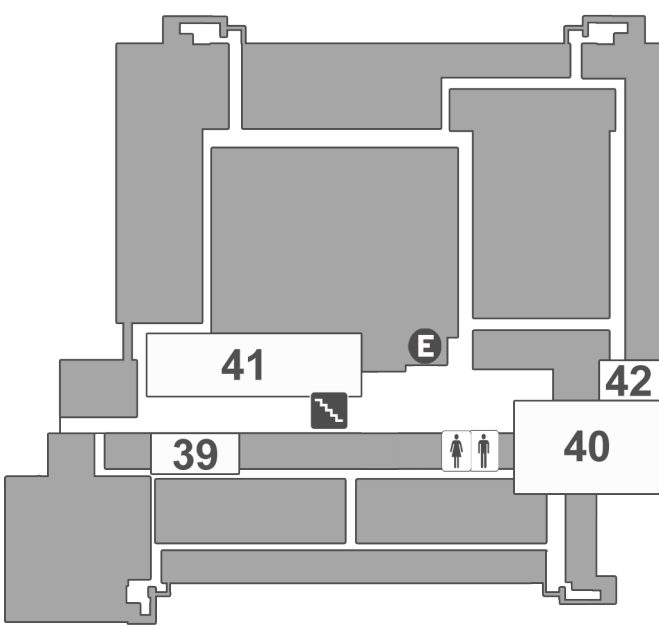

Woods SFCC Third Floor

Stairs
 Restrooms
 Elevators to floors 1,2,3
 Tower elevators to floors 3,4,5
 Emergency Room outside entrance