



**US Army Corps
of Engineers**®
New England District
696 Virginia Road
Concord, MA 01742-2751

PUBLIC NOTICE

Comment Period Begins: October 11, 2016
Comment Period Ends: November 10, 2016
File Number: NAE-2016-779
In Reply Refer To: Kevin R. Kotelly, P.E.
Phone: (978) 318-8703
E-mail: kevin.r.kotelly@usace.army.mil

The District Engineer has received a permit application to conduct work in waters of the United States from the Town of Scituate, Massachusetts. This work is proposed in the Atlantic Ocean at North Scituate Beach, Glades Road, Scituate, Massachusetts 02066. The site coordinates are: Latitude 42.235°, Longitude 70.759°.

The work involves work and the placement of fill material below the high tide line of waters of the United States in order to construct the North Scituate Beach Nourishment Project. The project requires approximately 240,000 cubic yards of material. The majority of the Project Area is protected by a concrete seawall fronted by an armor stone revetment. The beach nourishment would extend along the North Scituate Beach seawall and revetment for a distance of approximately 2,900 feet, including tapered sections at both ends with a footprint of approximately 21.1 acres. The seaward extent of the nourishment crest would be located roughly above the toe of the existing stone revetment. The seaward face of the nourishment would then slope downward on roughly a 10H:1V slope to meet the existing bottom. The design life of the project is projected to be nine years.

The nourishment would be composed of a mix of cobble, gravel, and sand to enhance the stability of the beach. Due to the orientation of the shoreline and incoming wave energy, the nourishment material would be transported both cross-shore and alongshore. The alongshore transport will move nourishment material fronting the seawall to the north behind the Well Rock and to south along the rest of the seawall. Periodic re-nourishment will also be required to account for sediment transported offshore and to adjacent shorelines. Maintenance would also be anticipated after significant storm events to replenish eroded sections of the beach to ensure stability and provide wave dissipation during future storm events.

The source of the beach nourishment material would be from upland sources and would be transported by truck to the site. Approximately 12,000 truck trips would be necessary to deliver the full 240,000 cubic yards of material. The estimated number of daily truck trips is 80 or approximately 14 trucks per hour to meet production requirements for the beach nourishment. The work will take place 6 hours per day (assuming 9 AM to 3 PM), 5 days per week, weather conditions permitting.

The Applicant's project purpose is storm damage protection. During storms, the seawall and revetment structure is overtopped and water ponds on Bailey's Causeway and Gannett Road. These two roads are used as evacuation routes for the residents of Glades Road, Scituate Neck, and Surfside Road. The Town of Scituate states that Glades Road can be closed during severe winter storms due to the overtopping waves, preventing emergency access for emergency vehicles and residents. They also state that beach nourishment provides the benefits of reduced flood damage to existing infrastructure and supply of sediment to downdrift beaches; beach nourishment addresses the sediment starvation concerns along the shoreline, provides added longevity to the existing shore protection infrastructure, protects the existing development from coastal flooding and storm damage, and restores a functional beach system that may enhance wildlife habitat.

CENAE-R
FILE NO. NAE-2016-779

The work is shown on the attached plans entitled, “North Scituate Beach, Scituate, Massachusetts,” on one sheet, and dated July 19, 2016.

The beach nourishment has been designed using the best available measures to avoid and minimize adverse impacts. The coastal habitats of the existing beach will be lost with the placement of the nourishment. Mitigation for unavoidable impacts is being considered during this permit review.

AUTHORITY

Permits are required pursuant to:

Section 10 of the Rivers and Harbors Act of 1899

Section 404 of the Clean Water Act

Section 103 of the Marine Protection, Research and Sanctuaries Act.

The decision whether to issue a permit will be based on an evaluation of the probable impact of the proposed activity on the public interest. That decision will reflect the national concern for both protection and utilization of important resources. The benefit which may reasonably accrue from the proposal must be balanced against its reasonably foreseeable detriments. All factors which may be relevant to the proposal will be considered, including the cumulative effects thereof; among those are: conservation, economics, aesthetics, general environmental concerns, wetlands, cultural value, fish and wildlife values, flood hazards, flood plain value, land use, navigation, shoreline erosion and accretion, recreation, water supply and conservation, water quality, energy needs, safety, food production and, in general, the needs and welfare of the people.

The Corps of Engineers is soliciting comments from the public; Federal, state, and local agencies and officials; Indian Tribes; and other interested parties in order to consider and evaluate the impacts of this proposed activity. Any comments received will be considered by the Corps of Engineers to determine whether to issue, modify, condition or deny a permit for this proposal. To make this decision, comments are used to assess impacts on endangered species, historic properties, water quality, general environmental effects, and the other public interest factors listed above. Comments are used in the preparation of an Environmental Assessment and/or an Environmental Impact Statement pursuant to the National Environmental Policy Act. Comments are also used to determine the need for a public hearing and to determine the overall public interest of the proposed activity.

Where the activity involves the discharge of dredged or fill material into waters of the United States or the transportation of dredged material for the purpose of disposing it in ocean waters, the evaluation of the impact of the activity in the public interest will also include application of the guidelines promulgated by the Administrator, U.S Environmental Protection Agency, under authority of Section 404(b) of the Clean Water Act, and/or Section 103 of the Marine Protection Research and Sanctuaries Act of 1972, as amended.

ESSENTIAL FISH HABITAT

The Magnuson-Stevens Fishery Conservation and Management Act, as amended by the Sustainable Fisheries Act of 1996 (Public Law 104-267), requires all federal agencies to consult with the National Marine Fisheries Service on all actions, or proposed actions, permitted, funded, or undertaken by the agency, that may adversely affect Essential Fish Habitat (EFH).

CENAE-R
FILE NO. NAE-2016-779

This project will impact 21.1 acres of Essential Fish Habitat (EFH) for Atlantic cod (*Gadus morhua*), haddock (*Melanogrammus aeglefinus*), pollock (*Pollachius virens*), whiting (*Merluccius bilinearis*), offshore hake (*Merluccius albidus*), red hake (*Urophycis chuss*), white hake (*Urophycis tenuis*), winter flounder (*Pseudopleuronectes americanus*), yellowtail flounder (*Limanda ferruginea*), windowpane flounder (*Scophthalmus aquosus*), American plaice (*Hippoglossoides platessoides*), ocean pout (*Macrozoarces americanus*), Atlantic halibut (*Hippoglossus hippoglossus*), Atlantic sea scallop (*Placopecten magellanicus*), Atlantic sea herring (*Clupea harengus*), monkfish (*Lophius americanus*), bluefish (*Pomatomus saltatrix*), long finned squid (*Loligo pealeii*), short finned squid (*Illex illecebrosus*), Atlantic butterfish (*Peprilus triacanthus*), Atlantic mackerel (*Scomber scombrus*), summer flounder (*Paralichthys dentatus*), scup (*Stenotomus chrysops*), black sea bass (*Centropristis striata*), surf clam (*Spisula solidissima*), ocean quahog (*Artica islandica*), and bluefin tuna (*Thunnus thynnus*). Loss of this habitat may adversely affect the species listed above. However, the District Engineer has made a preliminary determination that the site-specific adverse effect will not be substantial. Further consultation with the National Marine Fisheries Service regarding EFH conservation recommendations is being conducted and will be concluded prior to the final decision.

NATIONAL HISTORIC PRESERVATION ACT

Based on his initial review, the District Engineer has determined that little likelihood exists for the proposed work to impinge upon properties with cultural or Native American significance, or listed in, or eligible for listing in, the National Register of Historic Places. Therefore, no further consideration of the requirements of Section 106 of the National Historic Preservation Act of 1966, as amended, is necessary. This determination is based upon one or more of the following:

- a. The permit area has been extensively modified by previous work.
- b. The permit area has been recently created.
- c. The proposed activity is of limited nature and scope.
- d. Review of the latest published version of the National Register shows that no presence of registered properties listed as being eligible for inclusion therein are in the permit area or general vicinity.
- e. Coordination with the State Historic Preservation Officer and/or Tribal Historic Preservation Officer(s)

ENDANGERED SPECIES CONSULTATION

The New England District, Army Corps of Engineers has reviewed the list of species protected under the Endangered Species Act of 1973, as amended, which might occur at the project site. It is our preliminary determination that the proposed activity for which authorization is being sought is designed, situated or will be operated/used in such a manner that it is not likely to adversely affect any Federally listed endangered or threatened species or their designated critical habitat. By this Public Notice, we are requesting that the appropriate Federal Agency concur with our determination.

COASTAL ZONE MANAGEMENT

The States of Connecticut, Maine, Massachusetts, New Hampshire and Rhode Island have approved **Coastal Zone Management Programs**. Where applicable, the applicant states that any proposed activity will comply with and will be conducted in a manner that is consistent with the approved Coastal Zone Management Program. By this Public Notice, we are requesting the State concurrence or objection to the applicant's consistency statement.

CENAE-R
FILE NO. NAE-2016-779

The following authorizations have been applied for, or have been, or will be obtained:

- Permit, License or Assent from State.
- Permit from Local Wetland Agency or Conservation Commission.
- Water Quality Certification in accordance with Section 401 of the Clean Water Act.

In order to properly evaluate the proposal, we are seeking public comment. Anyone wishing to comment is encouraged to do so. Comments should be submitted in writing by the above date. If you have any questions, please contact Kevin R. Kotelly, P.E. at (978) 318-8703, (800) 343-4789 or (800) 362-4367, if calling from within Massachusetts.

Any person may request, in writing, within the comment period specified in this notice, that a public hearing be held to consider the application. Requests for a public hearing shall specifically state the reasons for holding a public hearing. The Corps holds public hearings for the purpose of obtaining public comments when that is the best means for understanding a wide variety of concerns from a diverse segment of the public.

The initial determinations made herein will be reviewed in light of facts submitted in response to this notice. All comments will be considered a matter of public record. Copies of letters of objection will be forwarded to the applicant who will normally be requested to contact objectors directly in an effort to reach an understanding.

THIS NOTICE IS NOT AN AUTHORIZATION TO DO ANY WORK.



Barbara Newman
Chief, Permits and Enforcement Branch
Regulatory Division

If you would prefer not to continue receiving Public Notices by email, please contact Ms. Tina Chaisson at (978) 318-8058 or e-mail her at bettina.m.chaisson@usace.army.mil. You may also check here () and return this portion of the Public Notice to: Bettina Chaisson, Regulatory Division, U.S. Army Corps of Engineers, 696 Virginia Road, Concord, MA 01742-2751.

NAME: _____

ADDRESS: _____

PHONE: _____

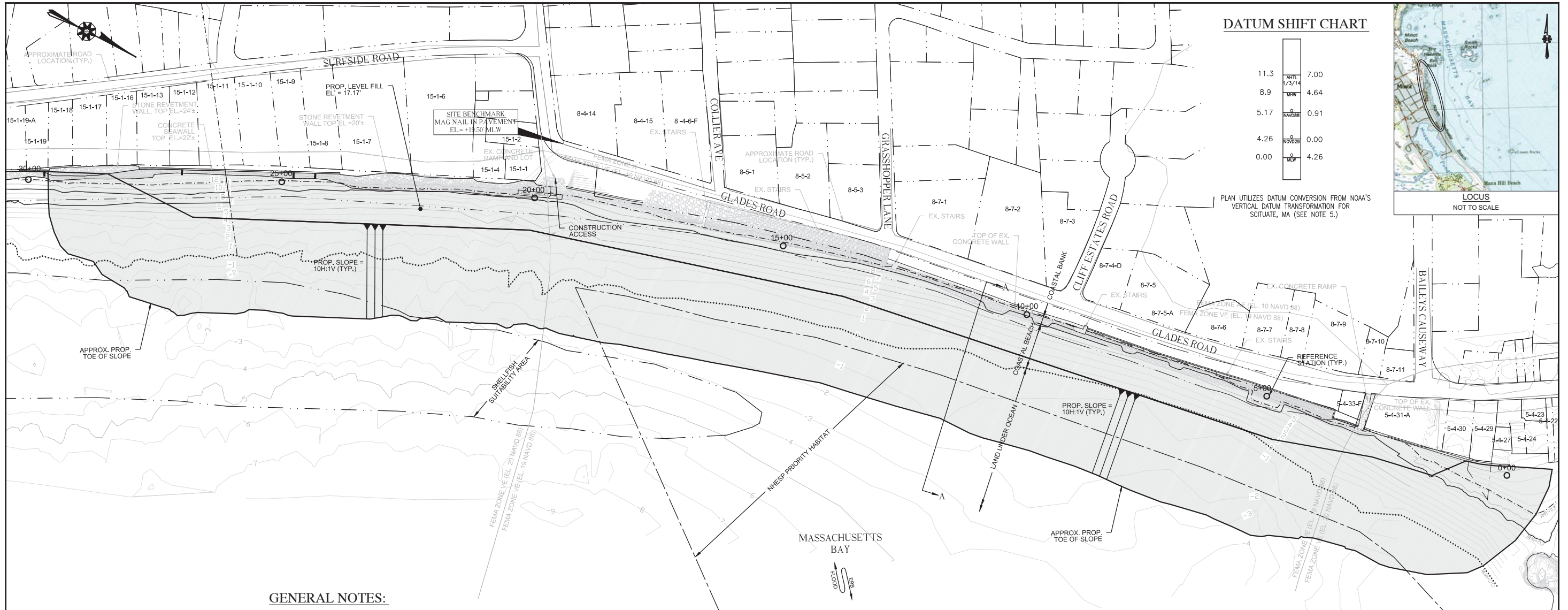

DATUM SHIFT CHART

11.3	AHTL 1/2/14	7.00
8.9	MHW	4.64
5.17	0 NAVD88	0.91
4.26	0 NAVD83	0.00
0.00	0 MLW	4.26

PLAN UTILIZES DATUM CONVERSION FROM NOAA'S VERTICAL DATUM TRANSFORMATION FOR SCITUATE, MA (SEE NOTE 5.)

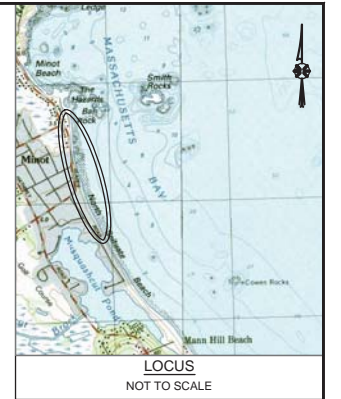

GENERAL NOTES:

- SITE BENCHMARK IS MAG NAIL SET IN PAVEMENT AT THE INTERSECTION OF GANNETT AND GLADES ROAD, EL. +19.50' MLW HELD, AS PROVIDED BY CLE ENGINEERING, INC.
- ELEVATIONS SHOWN ON THIS PLAN ARE RELATIVE TO MEAN LOW WATER (MLW) DATUM.
- INFORMATION SHOWN ON THIS PLAN IS BASED UPON THE TOPOGRAPHIC SURVEY ON MAY 22, 2015, HYDROGRAPHIC SURVEY ON JUNE 10, 2015, BOTH PERFORMED BY MERRILL CORPORATION, AND TOPOGRAPHIC SURVEY ON AUGUST 12, 2014, PERFORMED BY CLE.
- EXISTING GRADES REFLECT ON-SITE CONDITIONS PERFORMED ON THE ABOVE REFERENCED DATES.
- TIDAL DATUM SHIFT PROVIDED BY CLE ENGINEERING AS REFERENCED ON CLE PLAN ENTITLED "GLADES ROAD BEACH NOURISHMENT" DATED 8/15/14.
- NO PROPERTY LINES OR UTILITIES WERE INVESTIGATED FOR THE PURPOSE OF THIS PLAN. PROPERTY LINES SHOWN REFLECT MOST RECENT AVAILABLE MASS GIS DATA. PROPERTY OWNER INFORMATION PROVIDED BY TOWN OF SCITUATE ASSESSOR DATABASE.
- WALL STRUCTURE DESCRIPTIONS ARE SURVEYOR'S INTERPRETATION OF WALL CHARACTERISTICS AT TIME OF SURVEY.
- EXISTING ROAD LOCATIONS ARE APPROXIMATE AND SCALED FROM AERIAL IMAGERY AND ARE SHOWN FOR VISUAL ORIENTATION PURPOSES ONLY.
- SHELLFISH SUITABILITY AREA, NHESP PRIORITY HABITAT, AND BARRIER BEACH LOCATIONS SHOWN REFLECT THE MOST RECENT AVAILABLE MASSGIS DATA.
- FLOOD PLAN INFORMATION FROM FEMA FIRM 2502300107J EFFECTIVE DATE JULY 17, 2012.

LEGEND

EXISTING	DESCRIPTION
8-5-3	PARCEL ID
10	1' CONTOUR
[Symbol]	CONCRETE SEAWALL
[Symbol]	RIP RAP
[Symbol]	ANNUAL HIGH TIDE LINE (AHTL)
[Symbol]	MEAN HIGH WATER LINE (MHW)
[Symbol]	MEAN LOW WATER (MLW)
[Symbol]	PROPERTY LINES

	PROPOSED NOURISHMENT AREAS					
	COASTAL BEACH	NHESP PRIORITY HABITAT	SHELLFISH SUITABILITY AREA	LUO	COASTAL BANK	LAND SUBJECT TO COASTAL STORM FLOWAGE
ESTIMATED AREA (SF)	±417,600 (OF WHICH ±25,850 IS BARRIER BEACH)	±155,600	±33,050	±393,470	±54,960	±920,600

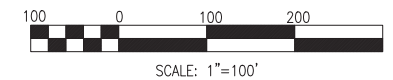

PERMIT PLAN
NOT FOR CONSTRUCTION

PROJECT: NORTH SCITUATE BEACH
SCITUATE, MASSACHUSETTS

CLIENT: APPLIED COASTAL RESEARCH AND ENGINEERING, INC.
766 FALMOUTH ROAD, SUITE A-1 MASHPEE, MA 02649

cleengineering
15 Creek Road | Marion, Massachusetts 02738
t: 508.748.0937 | www.cleengineering.com

BEACH NOURISHMENT PLAN SHEET 1 OF 1

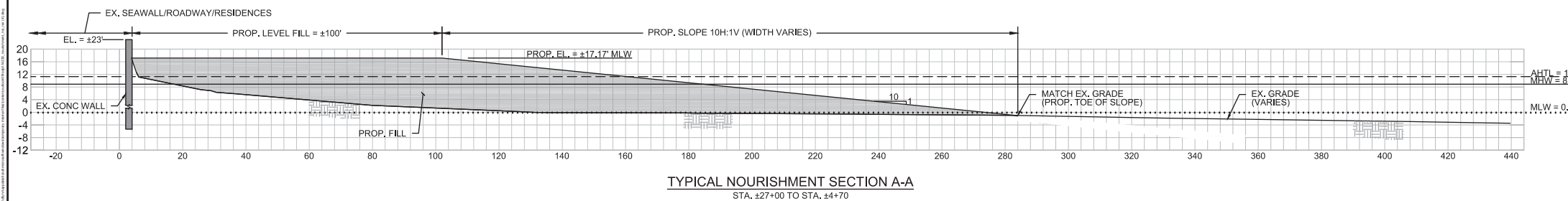

SCALE: AS NOTED	CHECKED:	DATE: July 19, 2016	JOB No. 14230
DRAWN BY: JMP/KGK	BY: JMP		
REVISION No.	DATE	COMMENT	