

BARS "B" & "C" - #4 BARS

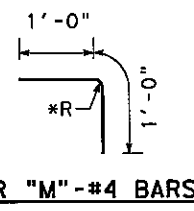

BAR "M" - #4 BARS

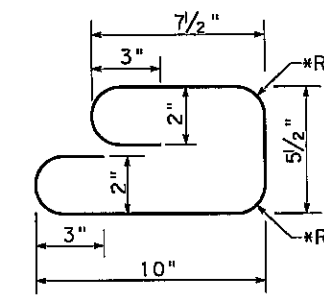

BAR "N" - #4 BARS

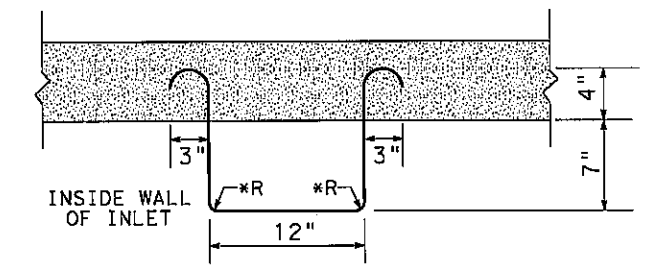

DETAIL OF INLET STEP
INLET STEP SHALL BE NO. 6 GALVANIZED REINFORCING BAR

* MINIMUM INSIDE DIAMETER OF BAR BENDS AS NOTED IN ITEM 440

INLET SIZE		INLET REINFORCING STEEL AND CONCRETE																																							
HEIGHT FT.	WIDTH FT.	BAR "A"				BAR "B"				BAR "C" *				BAR "D"				BAR "E"				BAR "F"				BAR "G"				BAR "H"											
		NO.	SZ.	SPACING	LENGTH	WT.	NO.	SZ.	SPACING	LENGTH	WT.	NO.	SZ.	SPACING	LENGTH	WT.	NO.	SZ.	SPACING	LENGTH	WT.	NO.	SZ.	SPACING	LENGTH	WT.	NO.	SZ.	SPACING	LENGTH	WT.	NO.	SZ.	SPACING	LENGTH	WT.					
2.5	3.0	7	6	AS SHN	5'-6"	58	11	4	6"C.C.	2'-4"	17	6	4	10"C.C.	2'-4"	9	4	4	12"C.C.	10'-6"	28	5	4	7"C.C.	8'-0"	27	6	4	10"C.C.	6'-0"	24	8	4	7"C.C.	3'-8"	20	4	4	AS SHN	4'-11"	13
3.0	3.0	7	6	AS SHN	5'-6"	58	11	4	6"C.C.	2'-10"	21	6	4	10"C.C.	2'-10"	11	6	4	12"C.C.	10'-6"	42	5	4	7"C.C.	8'-0"	27	6	4	10"C.C.	6'-0"	24	8	4	7"C.C.	4'-2"	22	4	4	AS SHN	4'-11"	13
3.5	3.0	7	6	AS SHN	5'-6"	58	11	4	6"C.C.	3'-4"	24	6	4	10"C.C.	3'-4"	13	6	4	12"C.C.	10'-6"	42	5	4	7"C.C.	8'-0"	27	6	4	10"C.C.	6'-0"	24	8	4	7"C.C.	4'-8"	25	4	4	AS SHN	4'-11"	13
4.0	3.0	7	6	AS SHN	5'-6"	58	11	4	6"C.C.	3'-10"	28	6	4	10"C.C.	3'-10"	15	8	4	12"C.C.	10'-6"	56	5	4	7"C.C.	8'-0"	27	6	4	10"C.C.	6'-0"	24	8	4	7"C.C.	5'-2"	28	4	4	AS SHN	4'-11"	13
4.5	3.0	7	6	AS SHN	5'-6"	58	11	4	6"C.C.	4'-4"	32	6	4	10"C.C.	4'-4"	17	8	4	12"C.C.	10'-6"	56	5	4	7"C.C.	8'-0"	27	6	4	10"C.C.	6'-0"	24	8	4	7"C.C.	5'-8"	30	4	4	AS SHN	4'-11"	13
5.0	3.0	7	6	AS SHN	5'-6"	58	11	4	6"C.C.	4'-10"	36	6	4	10"C.C.	4'-10"	19	10	4	12"C.C.	10'-6"	70	5	4	7"C.C.	8'-0"	27	6	4	10"C.C.	6'-0"	24	8	4	7"C.C.	6'-2"	33	4	4	AS SHN	4'-11"	13
5.5	3.0	7	6	AS SHN	5'-6"	58	11	4	6"C.C.	5'-4"	39	6	4	10"C.C.	5'-4"	21	10	4	12"C.C.	10'-6"	70	5	4	7"C.C.	8'-0"	27	6	4	10"C.C.	6'-0"	24	8	4	7"C.C.	6'-8"	36	4	4	AS SHN	4'-11"	13
6.0	3.0	7	6	AS SHN	5'-6"	58	11	4	6"C.C.	5'-10"	43	6	4	10"C.C.	5'-10"	23	12	4	12"C.C.	10'-6"	84	5	4	7"C.C.	8'-0"	27	6	4	10"C.C.	6'-0"	24	8	4	7"C.C.	7'-2"	38	4	4	AS SHN	4'-11"	13
7.0	3.0	7	6	AS SHN	5'-6"	58	11	4	6"C.C.	6'-10"	50	6	4	10"C.C.	6'-10"	27	14	4	12"C.C.	10'-6"	98	5	4	7"C.C.	8'-0"	27	6	4	10"C.C.	6'-0"	24	8	4	7"C.C.	8'-2"	44	4	4	AS SHN	4'-11"	13

* REDUCE BAR LENGTH AS NECESSARY TO PROVIDE CLEARANCE UNDER GRATE

INLET SIZE		INLET REINFORCING STEEL AND CONCRETE (CONT.)												TOTALS				
HEIGHT FT.	WIDTH FT.	BAR "I"				BAR "M"				BAR "N"				STEEL LBS.	CONC. C.Y.			
		NO.	SZ.	SPACING	LENGTH	WT.	NO.	SZ.	SPACING	LENGTH	WT.	NO.	SZ.			SPACING	LENGTH	WT.
2.5	3.0	2	4	AS SHN	2'-9"	4	7	4	24"C.C.	2'-0"	9	21	3	3"C.C.	2'-5"	19	227	1.63
3.0	3.0	2	4	AS SHN	2'-9"	4	7	4	24"C.C.	2'-0"	9	21	3	3"C.C.	2'-5"	19	250	1.80
3.5	3.0	2	4	AS SHN	2'-9"	4	7	4	24"C.C.	2'-0"	9	21	3	3"C.C.	2'-5"	19	258	1.96
4.0	3.0	2	4	AS SHN	2'-9"	4	7	4	24"C.C.	2'-0"	9	21	3	3"C.C.	2'-5"	19	281	2.13
4.5	3.0	2	4	AS SHN	2'-9"	4	7	4	24"C.C.	2'-0"	9	21	3	3"C.C.	2'-5"	19	289	2.29
5.0	3.0	2	4	AS SHN	2'-9"	4	7	4	24"C.C.	2'-0"	9	21	3	3"C.C.	2'-5"	19	311	2.46
5.5	3.0	2	4	AS SHN	2'-9"	4	7	4	24"C.C.	2'-0"	9	21	3	3"C.C.	2'-5"	19	320	2.62
6.0	3.0	2	4	AS SHN	2'-9"	4	7	4	24"C.C.	2'-0"	9	21	3	3"C.C.	2'-5"	19	342	2.79
7.0	3.0	2	4	AS SHN	2'-9"	4	7	4	24"C.C.	2'-0"	9	21	3	3"C.C.	2'-5"	19	373	3.12

CONCRETE TO BE DEDUCTED FOR ONE PIPE	
PIPE DIA.	CONC. C.Y.
15"	0.04
18"	0.05
21"	0.07
24"	0.09
27"	0.11
30"	0.14
36"	0.20

- GENERAL NOTES:**
1. ALL CONCRETE SHALL BE CLASS "A".
 2. ALL EXPOSED CORNERS SHALL BE CHAMFERED 3/4".
 3. INLET STEPS SPACED 14" C.C. AND LOCATED AND DIRECTED BY THE ENGINEER, SHALL BE PROVIDED AND INSTALLED IN ALL INLETS WHERE THE DEPTH EXCEEDS 5'-0".
 4. DIMENSIONS RELATING TO REINFORCING STEEL ARE TO THE CENTER OF THE BARS.
 5. TOTAL QUANTITIES SHOWN FOR CONCRETE AND REINFORCING STEEL ARE APPROXIMATE AND ARE PLACED HEREON FOR INFORMATIONAL PURPOSES ONLY.

REVISED ON 9/10/08
NOT TO SCALE



**RETAINING WALL INLET
TYPE I**

RWITY I)-08

FILE: RWITY I)-08	DN: TxDOT	CK: TxDOT	DW:	CK:
DISTRICT	FEDERAL AID PROJECT		SHEET	
DAL				
COUNTY	CONTROL	SECT	JOB	HIGHWAY

DISCLAIMER: The use of this standard is governed by the "Texas Engineering Practice Act". No warranty of any kind is made by TxDOT for any purpose whatsoever. TxDOT assumes no responsibility for the conversion of this standard to other formats or for incorrect results or damages resulting from its use.

LEVELS DISPLAYED