

20th Annual International Conference on Parent Education and Parenting

Featuring the Programs for Families Research and Evaluation Symposium



**April 25 – 26, 2013
University Union
Denton, TX, U.S.A.**



Welcome to the 20th *Annual International Conference on Parent Education and Parenting!*

We are excited you have decided to be part of the International Conference on Parent Education and Parenting at the University of North Texas. With the help of our presenters, we have put together two days of interesting and informative parent education workshops and research presentations, kicked off by our keynote address given by Dr. Velma McBride Murry from Vanderbilt University.

For the first time ever, this conference includes a Research and Evaluation Symposium. The goal of the Symposium is to provide resources and build collaborations for research and evaluation in parent education and parenting. The symposium is funded by The American Association of Family & Consumer Sciences (AAFCS) Ruth O'Brien Project Grant. Symposium sessions are interspersed through the program and noted as "RESEARCH & EVALUATION SYMPOSIUM SESSION". The symposium sessions include a special address by Dr. Denise Simmons from the University of North Texas, a panel, two breakout sessions, and a networking meeting geared toward building collaborations for research, evaluation, and grant writing.

After a productive two days, don't forget to enjoy the free admission Denton Arts and Jazz Festival Friday night after the conference!

You can read more about our keynote speakers, conference schedule, social events, and breakout sessions in the remainder of this program. We are happy to have you here at UNT!

Sincerely,
Arminta Lee Jacobson, Ph.D., CFCS, CFLE
Elaine Millikan Mathes Professor
Center for Parent Education, Director
Department of Educational Psychology
University of North Texas

2013 Conference Events and Highlights

Velma McBride Murry, Ph.D.- Dialogue with Keynote Speaker

Thursday, April 25, 2013 9:45 am -11:00 am
Diamond Eagle Suite – UNT University Union

Book and Resource Fair

Thursday, April 25 – 26, 2013 All Day
Atrium – UNT University Union

Meet and Greet Dinner

Sweetwater – Denton, TX

(Carpool will be provided. Participants should meet at the conference registration desk at 5:45 p.m. in the University Union, Level 3.)

Thursday, April 25, 2013 6:00pm – 8:00 pm
Sweetwater Grill & Tavern

Texas Association of Parent Educators (TAPE)

Presentation of Awards and Best Practices Presentation

Friday, April 26, 2013 12:00 pm – 1:10 pm
Golden Eagle Suite – UNT University Union

Programs for Families: Research and Evaluation Symposium Collaboration Session

Friday, April 26, 2013 2:50 pm – 4:00 pm
Room 413 – UNT University Union

33rd Annual Denton Arts & Jazz Festival

April 26, 2013, Friday, 5pm-11pm

April 27, 2013, Saturday, 10am-11pm

April 28, 2013, Sunday, 11am-9pm

Denton's Quakertown Park and Facilities

321 East McKinney (Corner of McKinney and Bell)

Denton, Texas 76201

KEYNOTE SPEAKER

“Parenting in a Global Society: Challenges and Opportunities”

Keynote Address: Thursday, 8:30 am – 9:30 am

Dialogue with Dr. Murry: Thursday, 9:45 am – 11:00 am

Velma McBride Murry, Ph.D., Betts Chair in Education and Human Development, Professor of Human and Organizational Development, Director, Center for Research on Rural Families and Communities, Peabody College, and Co-Director, Vanderbilt Medical Center, CTSA, Community Engagement Research Core, Vanderbilt University, Nashville, Tennessee



Dr. Murry has conducted research on rural African American parents and youth for 20 years and has identified proximal, malleable protective factors that deter youth risk engagement. Findings from these empirical studies informed the development of a curriculum, the Strong African American Families Program, which was designed to enhance parenting and family processes to encourage youth to delay the age of sexual onset and the initiation and escalation of alcohol and other drug use. Results from her longitudinal trials with African American families also informed the design, development, and implementation of the Pathways for African American Success Program, the first family-based, technology-interactive program targeting youth risk reduction by enhancing caregivers' regulated communicative parenting and youths' racial identity, self-esteem, decision-making processes, and risk-resistant efficacy. Dr. Murry brings a perspective on adversity that includes race, ethnicity, and poverty; a strong background in the role that parenting plays in addressing the needs of youth; and extensive experience in designing and implementing randomized control trials.

RESEARCH & EVALUATION SYMPOSIUM SPECIAL ADDRESS “A Blueprint for Preserving Our Legacy”

*Research & Evaluation Symposium Special Address: Thursday, 11:10 am – 12:20 pm,
Golden Eagle Suite at University Union*

*Denise Perry Simmons, Ph.D.
Assistant Vice President, UNT Research Development*



Dr. Denise Perry Simmons serves the Office of Research and Economic Development as the Assistant Vice President, UNT Research Development - specializing in Science, Technology, Engineering and Math. In this capacity she is charged with increasing UNT research growth through proposal development across all disciplines.

In her over thirty-five years as a scientist, she has held research and administrative appointments across medicine, industry, government and academia at top tier research institutions among which are Rockefeller University, University of Chicago, University of Maryland, Texas Medical Center-Baylor College of Medicine. During her tenure at UNT, among the initiatives that Dr. Simmons has led are those that resulted in (1) UNT's first cohort of NIH internship awards, 4 undergraduate and 4 graduate students in STEM and the social and behavioral sciences, (2) 4 UNT selected faculty who participate in development and implementation of the State of Texas Health Plan in Austin, (3) the State of Texas Department of Health Services (DSHS) first MOU with an academic institution – which has resulted in collaborations of UNT researchers with DSHS researchers and physicians, as well as the first cohort of 2012 student summer internships, (4) UNT 2012 Regional Conference National Endowment for the Humanities, (5) UNT 2012 NIH-NIGMS Division Director and ONC Principle Deputy Director Conference on Biomedical Informatics and Health IT Workforce (6) UNT 2011 Division Directors DOD – TATRC and CDMRP Conference, (7) UNT 2010 NIH Division Director Grant writing workshop for Faculty and Student, (8) UNT 2009 DOD-SBIR-STTR Conference. Dr. Simmons obtained her Ph.D. in the Biological Sciences from the University of Texas at Austin where she completed a combined degree with U.T.M.D. Anderson in Cancer Research. She has received fellow awards in medicinal chemistry at the University of Texas Drug Dynamics Institute and the National Institutes of Health-National Cancer Institute in the Laboratory of Carcinogenesis and Cellular Tumor Promotion, as well as NIH Outstanding Mentor and Technology Transfer Awards.

ChildBe

The Online Behavior Management System for Children

CALL (509) 340-2500 FOR DETAILS OR VISIT US AT WWW.CHILDBE.COM!

- ✓ For Families & In-Patient Organizations
- ✓ Monitor Behaviors & Generate Reports
- ✓ Manage Privileges & Assign Consequences
- ✓ Desktop, Tablet and Smartphone Compatible
- ✓ Assign Tasks & Reward With Points
- ✓ Share Access To Children With Family Members & In-Patient Organizations



ASPIRE Survey

**Assets—Skills— Professions—Interests—Relationships—
Environment**



A web based app that assesses the collective resources of all parents and adults associated with a school community to create mutually purposeful and meaningful engagement.

www.aspiresurvey.com

Nationally recognized by the
John Hopkins University National Network of
Partnership Schools in the 2012 publication of *Promising Partnership
Practices 2012.*

Reflective Listening/Respectful Speaking Tools for Powerful, Effective Communication

What would you like your spouse or friend or parent or child to understand? Have you been talking until you're "blue in the face" and still feel like you are not being heard?

Would you like to communicate better with your loved ones, employer or employees?

Then try a proven technique for communication — **Reflective Listening/Respectful Speaking**. With this system, healthy, effective communications skills can be learned and mastered. Parents learn to communicate with children. Children feel confident they are heard.

We offer this simple, yet very effective method of communication - a 4-card set of handy tools. Clear guidelines for use are included along with a bonus relationship poem/affirmation—"Get Better Together".

Order your set of Tools today:
Dasi-Ziyad Family Institute
P.O. Box 18998
Cleve. Hts., OH 44118
OR order at www.dzfi.org



Only \$5 per set of 4 attractive cards with instructions on back of each card. Include your name, address, how many sets ordered and add \$1.50 per set for shipping/handling. Save! Share with others! Order 5 sets and we pay shipping!

Parenting for the 21st Century©

This is a colorful, comprehensive & practical hands-on curriculum for trainers of parents and all childcare providers. This dynamic course is designed to empower and create Premium Parents™.

Healthy parenting is an art, a skill, and a mission. Our course covers the multifaceted job of being a parent in today's hectic, often confusing world. **Parenting for the 21st Century © is interactive, designed to empower all parents with skills, techniques, and principles to make them more effective with their children.**

Some topics: preparing for parenting, building character, effective discipline, healthy communication skills, financial management, accessing community resources, special challenges of single parents, children diagnosed as ADHD and more. (For list of all lessons, see www.dzfi.org)

Includes Instructor-Parent Agreement, client data form, instructor notes, 3 sets of Reflective Listening Tools, attendance sheets, parenting certificate, evaluation form.

**TOOB – Purchase the Complete "Teach out of the box" Parenting for the 21st Century© - everything necessary to present this curriculum.
Cost, only: \$169! + \$16 s/h = \$185 total.**

Order from the store at www.dzfi.org or
P.O. Box 18998
Cleve. Hts, OH 44118
216-321-0930



Thursday, April 25, 2013

<u>Time</u>	<u>Event</u>
7:30 am – 8:30 am	Registration – Silver Eagle Suite, University Union 3 rd Floor Continental Breakfast – Silver Eagle Suite
8:30 am – 9:30 am	General Session – Silver Eagle Suite, University Union 3 rd Floor Welcome and Greeting <i>Jerry Thomas, Ed.D., Dean, College of Education, University of North Texas, Denton, TX</i> Introduction of Keynote Speaker <i>Ashley Gillen, Undergraduate Researcher, University of North Texas, Denton, TX</i> <i>Yamuna Teter, Undergraduate Researcher, University of North Texas, Denton, TX</i> KEYNOTE ADDRESS Parenting in a Global Society: Challenges and Opportunities <i>Velma McBride Murry, Ph.D., Vanderbilt University, Nashville, TN</i>
9:30 am – 9:45 am	Break - Resource Fair

Concurrent Sessions

9:45 am – 10:55 am	DIAMOND EAGLE – UNIVERSITY UNION 3RD FLOOR Dialogue with Keynote Speaker Dr. Murry <i>Velma McBride Murry, Ph.D., Vanderbilt University, Nashville, TN</i>
	GOLDEN EAGLE – WORKSHOP Parent Involvement - Developing Partnerships between Families, Schools and Communities to Help Save our Children and Schools <i>Willie J. Kimmons, Ph.D., Author, Denton, TX</i> The bond between parents and their children will be strengthened by using strategies, suggestions and recommendations from this interactive, group participation workshop for those who teach and inspire our children.
	ROOM 409 – RESEARCH TO PRACTICE Fathers' Influence on the Spiritual Development of Daughters <i>Alan Wages, Ph.D. CFLE, Abilene Christian University, Abilene, TX</i> <i>Bridget Howe, Author, Abilene Christian University, Abilene, TX</i> This session highlights current research on the intentional and unintentional efforts of fathers that convey spiritual beliefs and practices to their children, as described through the experiences of young adults. Participants will learn current research on parent-child spiritual development, as well as descriptions of specific father-child interactions that are meaningful and lasting in the shaping of children's faith.
	The Potential of Spanish Language TV in Educating Families about How to Get to College <i>Amy Fann, Ph.D., University of North Texas, Denton, TX</i> <i>Patrick Vasquez, University of North Texas, Denton, TX</i> <i>Mayra Olivares-Urueta, University of North Texas, Denton, TX</i> The perceptions of Spanish-speaking Latino parents about the media as a vehicle to provide college knowledge were studied with a focus on college related material viewed on TV, the utility of this content, and parents' suggestions for utilizing TV as a medium for educating immigrant and first-generation families to help their children get to college.

ROOM 411 – WORKSHOP**Working with Fathers to Enhance Parenting Skills**

Nigel Vann, Author, ICF International, Silver City, NM

Children do better when their fathers are involved in their lives in positive and supportive ways, but often parent education programs are more successful at engaging mothers than fathers. This interactive workshop presented by the National Responsible Fatherhood Clearinghouse will provide resources and strategies designed to help remedy this situation for fathers, families and parent educators.

ROOM 412 – WORKSHOP**Building Family Strengths Through Eco-Friendly Parent Education - “Shifting our Focus to Simple Solutions”**

Elizabeth J. Dry, M.S., Dallas, TX

The activities presented in this workshop will provide access for our families to engage in powerful learning that will bring stability in an ever-changing world.

ROOM 413 – WORKSHOP**Co-Parenting for Successful Kids Online**

Cindy Straheim, M.S., University of Nebraska-Lincoln, Clay Center, NE

Co-Parenting for Successful Kids is an online parenting class approved by the Supreme Court of Nebraska for parents who are separating, divorcing, or seeking custody of minor children. The course is interactive, includes links to many resources, is skill based in its approach and focuses on the needs of children.

ROOM 415 – RESEARCH TO PRACTICE**Welcome to Holland: Faith and Resiliency**

Thomas Knestrict, Ph.D., Xavier University, Cincinnati, OH

This presentation will report data from the initial stage of a three stage study investigating Faith and Resiliency in Families Raising Children With Special Needs and discuss how these findings might be used to help service providers, and secular or faith based institutions in supporting these highly stressed families.

ROOM 417 – RESEARCH TO PRACTICE**The Intertwining Stages of Childhood and Parenthood**

Jennifer Lewis, Texas Woman's University, Denton, TX

Kelly Ramsey, M.S., Oklahoma City, OK

Comparative study on how a child's developmental stages impact parents as they move through the stages of parenting. The research uses Ellen Galinsky's model and Eric Erickson's stages of child development as a basis of identifying trends in parenting, across several spectrums. As the data continues to be correlated we are discovering that the affect is greater than what we imagined.

ROOM 418 – RESEARCH TO PRACTICE**Love Brain: Teaching our Teens the Dangers of Loving Only with Their Hearts**

Jesus Amaya, Ph.D., Universidad de Monterrey, San Pedro, Mexico

This session will identify the love and sex problems and consequences of adolescence: teen pregnancies, early sexualization, sexually transmitted disease, or marriages based on illusion with an ideal or unreal partner. The participants will design practical strategies to prevent these problems at home and their classrooms.

How Families Experience the Phenomenon of Adolescent Pregnancy and Parenting: Implications for Educators and Family Clinicians

Glenda J. Boyer, Ph.D., Frisco, TX

Linda Ladd, Ph.D., Texas Woman's University, Denton, TX

How does an entire family respond when an adolescent becomes pregnant? Researchers studied six families and learned that when a pregnant adolescent female participates in an educational support group in her school, the family can be helped through the pregnancy experience. Initial negative emotions and estrangement led to changes in the family dynamics due, partially, to the educational support group. Implications for parent educators will be discussed.

10:55 am –
11:10 am

Break – Resource Fair

11:10 am –
12:20 pm

GOLDEN EAGLE – RESEARCH & EVALUATION SYMPOSIUM SESSION**Special Address: “A Blueprint for Preserving Our Legacy”**

Denise Perry Simmons, Ph.D., Assistant Vice President, UNT Research Development

ROOM 409 – RESEARCH TO PRACTICE**Promoting Latino Parent Involvement in Students Going to College**

Nydia Sanchez, University of North Texas, Denton, TX

Enjoy the opportunity to learn about the transformative practices of a grassroots Latino parent organization that uses a cultural wealth model for parents to reclaim their children's educational aspirations for college. Issues, theoretical discussion and implications for practice and policy are relevant to a broad audience of researchers interested in the role of families in getting students into and/or through college.

Enhancing a Parent's Ability to Improve Their Childs' Attention and Cooperation within the Family: What do Educator's Need to Know?

Justine Faghihifar, M.S., OTR, CFLE, Author, Richardson, TX

Attendees of this workshop will learn techniques for increasing and extending children's attention and cognitive skills and increased everyday cooperation in families.

ROOM 411 – WORKSHOP**How Creative Arts Can Help You Talk to a Child**

Nechama Robinson, Author, Brookline Village, MA

Parents and educators are introduced to a creative model for using rhythm and visual arts to facilitate an expanded communication repertoire in dialogue with young children. The session includes warm-up experiment, theory and introduction to parent play model, and guided practice of model's main components.

ROOM 412 – WORKSHOP**Is That Normal? Creative Strategies for Incorporating Child Development Knowledge and Skills in Parent Education**

Kimberly Jayne, University of North Texas, Denton, TX

Learn innovative strategies to help parents' understand child development and incorporate developmental concepts into their parenting practices.

ROOM 413 – WORKSHOP**You Don't Know Unless You Ask! The A.S.P.I.R.E. Survey: Six Factors for Engaging Parents in Schools**

Michele Femc-Bagwell, Ph.D., University of Connecticut, Storrs, CT

Mallory Bagwell, Ph.D., Storrs, CT

This interactive session will provide an opportunity for participants to experience The A.S.P.I.R.E. Survey TM, an easily administered inventory that assesses the collective resource pool of parents and adults associated with a school community as well as the assets and traits of the community itself. This is done by inventorying six resource factors: Assets, Skills, Professions, Interests, and Relationships, Environment, recognizing them and connecting them to curricular, extra-curricular and fundraising activities.

ROOM 415 – WORKSHOP**Parents the First Teachers, Home the First Classroom: AVANCE's Dual Generation Parent-Child Education Program**

Glendelia M. Zavala, Ed.D., Author, AVANCE, Dallas, TX

This interactive workshop will demonstrate how AVANCE incorporates toy-making into its premier Parent-Child Education Program that reinforces the motto, "Parents are the first teachers and the home is the first classroom." Participants will also learn best practices of AVANCE's two-generation model that is adaptable in other ethnic communities.

ROOM 417 – WORKSHOP**Drugs + Kids = RISK**

Natalie Baerwaldt, M.S., CPS, Author, Dallas, TX

The question is not if a child will be offered drugs, but rather, when a child will be offered drugs. This presentation will provide conference attendees with the tools to help prevent children from choosing to use drugs and alcohol. Information on where and how to access additional free programs and tools will also be provided.

ROOM 418 – RESEARCH TO PRACTICE**Child Parent Relationship Training (CPRT): A Culturally-Responsive Parenting Program for Supporting Families in Crises**

Sue Bratton, Ph.D., LPC-S, RPT-S, University of North Texas, Denton, TX

Child Parent Relationship Therapy (CPRT) is a culturally-responsive parenting model with a strong research base to support its effectiveness with diverse populations of families in crises. This approach is particularly suited for families with young children and focuses on enhancing the parent-child relationship, and empowering parents to make a significant difference in their family's functioning.

Collaboration in Parent Education Program Evaluation: Lessons from the Field

Brenna Rivas, Ph.D., Southern Methodist University, Dallas, TX

Increasingly external funding is accompanied by the requirement of outside evaluators. This presentation shares the collaboration between a parent education program and its outside evaluators and what each of the collaborators has learned.

**12:20 pm –
1:10 pm**

Networking Luncheon – Silver Eagle Suite

**1:10 pm –
1:25 pm**

Break – Resource Fair

**1:25 pm –
2:35 pm**

GOLDEN EAGLE – RESEARCH & EVALUATION SYMPOSIUM SESSION**Panel: "Trends in Research and Evaluation Methods"**

Abbas Tashakkori, University of North Texas, Denton, TX

Mark DeHaven, Texas Prevention Institute, UNT Health Science Center, Fort Worth, TX

ROOM 411 – RESEARCH TO PRACTICE**Success: BioSocial Cognition Advocacy**

Thomas C. Rector, Author, McKinelyville, CA

This workshop explains a newly developed tool, concept, methodology, and application based upon current neuro-scientific research and practical application of BioSocial Cognition Model. The model connects a child's behavior and environmental influences that affect a child to create a positive paradigm shift.

ROOM 412 – WORKSHOP**Teach Resilience: How Parents and Educators Raise Kids Who Can Launch!**

Deborah Gilboa, M.D., Pittsburgh, PA

Resilience is the ability to approach challenges and recover from set-backs. Teaching children to be resilient is the hardest, and possibly most important, work of the adults in their lives. An explanation of how children's health and futures depend on their resilience, and practical tools for instilling the confidence and problem-solving children need.

ROOM 413 – WORKSHOP**Creative Approaches to Parent Education**

Kristin King, LCSW, St. David's Health Care System, Austin, TX

Participants will explore creative alternatives to the traditional lecture method of Parent Education.

ROOM 415 – VIDEO CONFERENCE**Parent Education: A UK perspective**

Alison Prowle, Institute of Education, University of Worcester, United Kingdom

This consists of three interrelated presentations (a) overview and professional context about current developments and trends related to support and collaboration with parents in the early childhood sector in England. (b) Report of a research project carried which conducted evidence based evaluation of a parental support program in England. (c) Pictures of integrated services in one Children's Centre in England.

ROOM 417 – WORKSHOP**Puzzlemania: The Interlocking Pieces of Parenting Stages and Child Development**

Kelly Ramsey, M.S., Oklahoma City, OK

Jennifer Lewis, Texas Woman's University, Denton, TX

This interactive workshop session will engage parents and early childhood professionals to examine the correlation of parental stages to children's developmental stages. Parenting education models presented respect cultural aspects provide practical application of child development, and adult learning theories and parenting education techniques that engage parents of children from conception to young adulthood.

ROOM 418 – WORKSHOP**How to become a Breakthrough Parent**

Rashada Torrence, C.P., H.O.P.E. for Sunny Skies, Richmond, TX

Informative session on child development, co-parenting, and the stressors of parenting to prevent child abuse and neglect.

**2:35 pm –
2:50 pm**

Break – Resource Fair

**2:50 pm –
4:00 pm**

GOLDEN EAGLE – WORKSHOP**The Missing Link: Preventing Child Abuse by Teaching Teens Relationship Skills**

Janet Pozmantier, M.S., L.P.C., L.M.F.T., R.P.T., The Dibble Institute, Berkeley, CA

Since one of the most powerful impacts on a child's well-being is the quality of the relationship between his/her parents, preventing child abuse can begin with teaching teens healthy relationship skills – long before they become parents. Participants attending this highly interactive session will learn about innovative, award-winning,

evidence-based models of relationship education for youth, including those at high risk or pregnant and parenting, and leave energized with sample activities ready to use.

ROOM 409 – WORKSHOP

Now That They Are Back

Kay Higgs-Adams MSW LISW-S CFLE., Author, Gahanna, OH.

This interactive workshop will explore gaps in the little known about the effects of military deployment on the emotional well-being of children today. Participants will view the animated multi-media video "Mr. Poe and Friends" and discuss family reunion after deployment.

ROOM 411 – WORKSHOP

Striking a Balance and Need for Support: Work-Life Balance Issues of Graduate Student Parents

Victoria Calvin, M.S., Family Ministry, Keller, TX

This workshop will explore work-life balance issues of graduate student-parents. Graduate student-parents frequently struggle to balance the demands of school, work, and family, often in environments that provide them little or no support. Through interactive activities, participants will use this information to examine the work-life balance challenges of graduate student-parents and provide recommendations regarding how to best support this group of students.

ROOM 412 – WORKSHOP

Teaching Kids to Be Good People

Annie Fox, M.Ed., Author, CA

This workshop will inspire 21st Century parents to embrace their role as character educators and provide pragmatic lessons for moral compass skill-building in children.

ROOM 413 – WORKSHOP

Providing Support for Changing Families: Child-parent Relationship Training (CPRT) with Divorced Parents

Dalena Dillman Taylor, University of North Texas, Denton, TX

This presentation reviews research on specific intervention designed to improve parent-child relationship with divorced parents. In addition to gaining a greater awareness of the importance of the parent-child relationship between divorced parents and their children. Participants will gain deeper knowledge of the many challenges of families of divorce.

ROOM 415 – WORKSHOP

Suicide Prevention: A Lifesaving Lesson

Sandra McClintic, Ph.D, CFLE, Texas Woman's University, Denton, TX

This interactive presentation will identify the characteristics of depression and its relationship with suicidal thoughts. Strategies to help those who find themselves in a depressed or suicidal situation will also be discussed.

ROOM 417 – WORKSHOP

Parenting for the 21st Century

Krsnanandini Devi Dasi, CFLE, CFWI, Author, Cleveland Heights, OH

Parenting for the 21st Century is a colorful, comprehensive, practical, hands-on education course for parents and other childcare providers. Developed over a decade ago and implemented with many parent audiences, this dynamic course is designed to empower! In this workshop, we give an overview of the Parenting for the 21st Century curriculum, including the skills, tools, techniques, principles, illustrations utilized in this powerful curriculum.

ROOM 418 – WORKSHOP

Children with Sensory Processing Disorders: Helping Parents/Caregivers, Teachers and Child Care Providers

Jane Humphries, Ed.D., Oklahoma State Department of Health, Oklahoma City, OK
Kari Rains, Oklahoma State Department of Health, Stillwater, OK

The intent of this workshop is equip parent educators serving families, child care providers, and other caregivers with quick, easy, and inexpensive activities to address the sensory needs of all young children. Participants will be provided with specific sensory activities that can be used immediately.

6:00 pm – 8:00 pm **Meet and Greet Dinner – Sweetwater, Denton, TX**
(Carpool will be provided. Participants should meet at the conference registration desk at 5:45 pm in the University Union, 3rd floor.)

Friday, April 26, 2013

Time **Event**

7:30 am – 8:15 am **Registration** – Silver Eagle Suite, University Union 3rd Floor
Continental Breakfast – Silver Eagle Suite

8:15 am – 9:00 am **General Session** – Silver Eagle Suite, University Union 3rd Floor
Showcase of Professional Organizations

9:00 am – 9:15 am **Break - Resource Fair**

9:15 am – 10:25 am **GOLDEN EAGLE – WORKSHOP**
Peacefulness at School and Home - Behavioral Management Strategies That Work!!!

Ingrid Campbell, MAT, Author, Camden, NJ

This is a highly energetic and interactive session where participants learn research-based behavioral management strategies designed to impact both the classroom and home setting. Participants will be able to implement learned strategies the very next day!!!

SILVER EAGLE – POSTER SESSIONS

The Effects of Parental Infidelity and Interparental Conflict on Adult Children: A Contextual Perspective

Alexandra Schmidt, Texas Woman's University (TWU), Denton, TX

This poster will present the results of a study examining how adult children's perceptions of trust and fairness are related to the occurrence of infidelity and levels of interparental conflict within the family of origin. Implications for parent education, future research, and clinical practice will be presented.

Is your Child Care Provider a Mother to Your Child? She Might Think so: Providers' Role Perception and Implications for Parents.

Holly E Follmer, M.S., Texas Tech University, Abilene, TX

The original research featured explores the various identities child care providers assume when enacting their role of lead teacher in a young children's classroom. Suggestions and considerations for addressing the implications these identities may have for parents as child care consumers will be presented.

Infant Attachment to a Caregiver

Kaylee Mackey, University of North Texas, Denton, TX

Infant-Caregiver Attachment is one of the most critical predictors of success for infants. This poster explains ways to both develop and maintain secure attachments, as well as the tactics to do so.

African American Parents: We Are Involved In Our Children's Education

Nedra Washington, Ph.D., Texas Woman's University, Denton, TX

Recent findings indicate that African American parents are involved in the education of their children, prekindergarten through sixth grade. Using Epstein's Model of Parental Involvement, diverse means of involving parents will be provided best practices for the home, school, and community will be explored.

Mothers' and Fathers' Parenting Characteristics in Relation to Family Earner Status and Self-Perceived Interpersonal Competence

Wen-Chuan Rita Chang, University of North Texas, Denton, TX

Lin Moore, Ph.D., Texas Woman's University, Denton, TX

Mothers' and fathers' parenting characteristics in relation to family earner status and self-perceived interpersonal competence are the result of a study of parenting characteristic and self-perceived interpersonal competence.

Teen Parenting through Youth Promotion

Yolanda T. Mitchell, M.S., Kansas State University, Manhattan, KS

Roudi R. Nazarinia, Kansas State University, Manhattan, KS

This poster session focuses on successful teen parenting through youth promotion. Teen parenting research is used to inform the practice of educational workshops centered on offering support to family members, as well as tools related to teen parenting and relationships and to aid in helping teens become successful parents.

Prenatal Care for Homeless Women.

Marla Ross, University of North Texas, Denton, TX

While there are many antenatal resources available, one study revealed that only slightly over half of the homeless women studied received prenatal care (Bloom et al., 2004). Identifying the barriers to accessing prenatal care and analyzing ways to increase prenatal care usage will provide information about how to promote positive health outcomes for homeless women and their infants.

When One Person Joins, the Whole Family Serves: The Struggles of the American Military Family.

Katie Clayton, University of North Texas, Denton, TX

Using Family Systems Theory, this literature review points out the many stressors that military families must endure in addition to typical family dynamics, and the effects those stressors have on the family system.

"Mommy Wars" Deconstructed.

Yamuna Teter, University of North Texas, Denton, TX

Using Bronfenbrenner's Bioecological Systems Theory, this literature review discusses the impact of the rhetoric on mothers, both stay-at-home and working. Recommendations are made for Certified Family Life Educators to help change the discourse of the "Mommy Wars".

ROOM 409 – RESEARCH TO PRACTICE**International Perspectives on Parental Involvement**

Dena Brown Ed.S., The University of Mississippi, Mississippi.

Parental involvement has long been considered the cornerstone of a child's success. The purpose of this presentation is to give insight into the impact parental involvement has in classrooms and communities around the world

ROOM 411 – WORKSHOP**Empowering Generation Next**

Ashley Parks, CFP, Author, Dallas, TX

Useful insights and practical tips for how to help children of all ages to be financially responsible and savvy with money. Author of *The Saving Seed* and a Certified Financial Planner, she will give examples of positive and negative modeling of parents.

ROOM 412 – WORKSHOP**Babies in Bloom**

Natalie Baerwaldt, M.S., CPS, Dallas, TX

The four domains of development and how babies' development blooms through their interactions and experiences with their environments will be presented. Attendees will use reflection to understand and conceptualize their roles as caregivers' and with an understanding of their own social/emotional needs, will be better able to meet the needs of the developing children they work with.

ROOM 413 – RESEARCH TO PRACTICE**Men as Fathers, Fathering Behavior, and Fatherhood Roles: A Global View.**

Rudy Ray Seward, Ph.D., University of North Texas, Denton, TX

Progress has been made internationally to better understand fathers, fathering, and fatherhood. Extant literature and research results, including findings from studies conducted by the authors, provide a wealth of details on fathers (the men), fathering (the behavior), and fatherhood (conceptualizations of the status or position).

My House is my Grandchildren's Home: Understanding Challenges and Providing Support for Rural Custodial Grandparents

Sandra Bailey, Ph.D., CFLE, Montana State University, Bozeman, MT

Grandparents rearing grandchildren is a growing family constellation. This presentation will focus on 10 years of research on White and Native American custodial grandparenting in a rural/frontier state. A discussion of how the research findings can be translated into parent education programming for this population will be included.

ROOM 415 – RESEARCH TO PRACTICE**Experiencing Motherhood: An Evaluation of the Effects of a Mother's Race/Ethnicity**

Yolanda T. Mitchell, M.S., Kansas State University, Manhattan, KS

Roudi R. Nazarinia, Kansas State University, Manhattan, KS

This workshop introduces three modules aimed at increasing cultural competency in new and existing parenting programs.

ROOM 417 – RESEARCH TO PRACTICE**Children Sapiens but Dumber: Executive Intelligence Deficit**

Jesus Amaya, Ph.D., Universidad de Monterrey, San Pedro, Mexico

How many times have we heard of highly intelligent people who act foolishly in their jobs, with their families, or in society? The lack of frontal intelligence (execute) and self-discipline is the biggest problem of our time. Participants will learn about how to form a generation of children and teenagers with greater personal strength to successfully face a world full of distractions and destructive behaviors.

Behavioral Parent Training for Low-Income Parents of Children in Need: Evaluating Treatments by Bringing the Laboratory to You

Michael Sofis, Author, Lawrence, KS

Presentation focuses on making your parent education model fit to up to date research findings and treatments. It focuses on creating a parent education model that is data-driven, that uses empirically supported techniques for evaluating behavior change, and

implements new treatments or research in ways that recognize organizational constraints.

ROOM 418 – RESEARCH TO PRACTICE

Parenting with the Criminal Justice System, the Foster Care System, and the Medical Community Looking Over Your Shoulder

Linda D. Ladd, Ph.D., Psy.D., Texas Woman's University, Denton, TX

Shiela Lumar, Ph.D., Stephen F. Austin University, Nacogdoches, TX

Amy Sue Patric Ott, Ph.D., Gainesville, TX

Jennifer Newquist, Ph.D., Denton, TX

How do parents parent when they have the criminal justice system or the foster care system or the medical community involved in the family microsystem? This symposium will examine how parent educators can work with parents who have these agencies or institutions and others from the mesosystem and the ecosystem involved in their family unit. Findings from three dissertations will illustrate how parents adjusted and adapted to both intrusion and support from these groups.

How to Raise a Child to be a Troubled, Difficult or Otherwise Rebellious Teen

Steve Wages, Ph.D., CFLE, CPA, Abilene Christian University, Abilene, TX

The formula for raising a child to become a troubled, difficult, or otherwise rebellious teen is actually quite simple: take an under involved parent, mix in a dose of negative peer pressure, and sprinkle with boredom and you have a difficult teen on your hands. This session provides a five-step preventive model of parenting strategies designed to significantly increase the probability of raising a child to become a well-adjusted adolescent of character and competence.

10:25 am –
10:40 am **Break – Resource Fair**

10:40 am –
11:50 am **GOLDEN EAGLE – RESEARCH & EVALUATION SYMPOSIUM SESSION**
Evaluating your Program: Pitfalls, Solutions, Selling the Evaluation, and Thinking Outside the Box

Dani Yomtov, California State University, West Hills, CA

Genesis Xandra Garcia, California State University, Northridge, CA

Scott Plunkett, California State University, Northridge, CA

This will be an interactive workshop to help social services providers not only conduct quality program evaluation but also be able to communicate the importance of program evaluation to stakeholders and outside observers. Misconceptions and common obstacles to program evaluation, as well as ways to overcome them, will also be discussed.

ROOM 411 – WORKSHOP

Ex-Offenders and Reestablishing Parental Roles after Release from Incarceration

Shelia Lumar, Ph.D., Stephen F. Austin State University, Nacogdoches, TX

Marie Saracino, Ph.D., Stephen F. Austin State University, Nacogdoches, TX

This workshop aims to increase awareness for parent educators and practitioners serving children, parents and families contending with the reintegration of the formerly incarcerated parent back into their parental roles after release from prison. Topics include parent-child interactions prior to and during incarceration, formerly incarcerated parent reintegration patterns into family life, family conflict, renegotiation of parent roles, reattachments of parent-child relationships, family reconstruction as well as educational and therapeutic interventions.

ROOM 412 – WORKSHOP

Special Education Child Find to Dismissal: Know the Process

Lauren A. McKinney, M.Ed., Author, Garland, TX

Between the No Child Left Behind Act, the Texas Education Agency, your school district,

and campus mandates, special education appears to be a convoluted, difficult, overwhelming, and scary experience. This workshop will provide you with the tools and information you need to be knowledgeable about special education law (Individuals with Disabilities Education Act).

ROOM 413 – WORKSHOP

Parenting Here and Now

Rodney Hamright, Author, Dallas, TX

Parents who developed the skills to encourage their child or teen to delay becoming sexually active along with delaying the use of drugs and alcohol, help develop positive attitudes towards life and contribute to the personal growth and academic success of their children. This interactive parenting session will explore the importance of parents as prevention agents.

**ROOM 418 – PANEL DISCUSSION - Texas Association of Parent Educators
Career Paths for Family and Parent Education Professionals**

Sandy McClintic, Texas Womans University, Denton

Maggie Jover – Texas AgriLife Extension

Elaine Shriver – Texas Parents as Teachers

Helen Hygaard - Plano Family Literacy Program

Victoria Calvin - Keller United Methodist Church - Family Ministry

This panel of family life educators will discuss career opportunities and interact with participants.

**11:50 am –
12:00 pm**

Break – Resource Fair

**12:00 pm –
1:10 pm**

**Lunch – Presentation of Awards and Best Practices Presentation
Texas Association of Parent Educators
Business Meeting
Introduction of awardees**
Sandra McClintic, TAPE President

**1:10 pm –
1:25 pm**

Break – Resource Fair

**1:25 pm –
2:35 pm**

**GOLDEN EAGLE – RESEARCH & EVALUATION SYMPOSIUM SESSION
Development and Evaluation of The Eau Claire Hmong Family Strengthening
Project**

Geetika Tiwari, Researcher, Coppell, TX

The project was a joint community collaboration between the University of Wisconsin (UW) - Madison, UW Extension and local community liaisons from the city of Eau Claire, WI. The project was a family-strengthening program targeting Hmong families with middle school aged children. The presentation will provide information, insight, and lessons learned regarding the whole life-cycle of a program, including grant writing, needs assessment, program selection, program adaptation, program implementation, and program evaluation.

**Home Instruction for Parents of Preschool Youngsters (HIPPY): Home Visiting
Evaluation Lessons and Future Directions**

Amber McEnturff, Evaluator, Texas HIPPY Center, Denton, TX

Arminta Jacobson, Ph.D., Center for Parent Education, Denton, TX

HIPPY is an early childhood home visiting program aimed at increasing parent involvement in education and school readiness for children. Attendees will learn about how HIPPY uses collaboration, both among HIPPY programs and other organizations, to achieve improve research and evaluation efforts. Future directions for home visiting

evaluation will also be discussed.

ROOM 409 – WORKSHOP

Meeting High Risk Family's Needs with a Parent Support Group Model

Jane Humphries, Ph.D., Oklahoma State Department of Health, Oklahoma City, OK

The intent of this workshop is to share Oklahoma's implementation of the Circle of Parents® support group model. Areas to be covered will include practical implementation tips and strategies, guidance on lessons learned, as well as an overview of early data findings of participants who are engaged in this parent education model.

ROOM 411 – RESEARCH TO PRACTICE

A Cross Country Exploration Pilot Study of the Multiple Predictors of Father's Involvement with Their Infants

Chia Jung Yeh, M.S., Texas Woman's University, Denton, TX

Chih-Hung Chung, University of North Texas, Denton, TX

Potchanat Samermit, Ph.D., University of Interdisciplinary Studies

Lin Moore, Ph.D., Texas Woman's University, Denton, TX

Research results on the phenomenon of father's involvement across countries, understand the association between father's involvement and some potential predictors, and determine the multiple predictors of father involvement will be presented.

Researchers will provide implications and recommendations based on research finding.

Informing Parents: Birth Defects in Texas

Susie Mikler, Ph.D., Author, Denton, TX

Research was conducted on birth defects in Texas. Data for this study was collected from the health registry of Texas.

ROOM 412 – RESEARCH TO PRACTICE

Impact of a Robust, Comprehensive Marriage Program on Families

Jennifer Acker, M.S., The Parenting Center, Fort Worth, TX

This workshop will provide outcome and impact information about a comprehensive marriage program with a very robust approach to providing services. The presenter will discuss program successes as well as challenges and barriers to providing marriage education and parenting classes to challenging populations.

ROOM 413 – WORKSHOP

How Parents Can Teach Social-Sexual Boundaries to Their Kids with Developmental Disabilities

Stacy F. Everson, RN, Author, San Diego, CA

Parents will learn about common social-sexual boundary problems in young people with developmental disabilities. They will be provided with tools and strategies to address these common problems and minimize the impact of such problems.

ROOM 417 – WORKSHOP

Routines and How They Can Improve Children's Sleep

Rebecca Michi, Author, Dallas, TX

Daily nap and night routines can help a child of any age sleep better. You'll learn age appropriate daily routines as well as optimal nap and night routines for a better nap and night sleep.

ROOM 418 – RESEARCH TO PRACTICE

The Benefits of a Holistic and Strength-based Approach to Parenting and Family Life Education

Janet C. Benavente, MHR, Colorado State University, Brighton, CO

Examine how a multi-faceted family strengthening program was implemented with both Spanish and English audiences

Money and Your Child's Academic Future

Nicoline Ambe, Ph.D., Author, Compton, CA

Three prevailing problems underlie a parent's inability to pay for their children's education: (a) Not enough money is set aside for children's education, (b) Bad money habits that render many parents debt-laden and unable to free up extra money for their children's education, (c) Children are not taught basic money management skills which can help them independently take control of their financial future in cases where a parent may be unable.

**2:35 pm –
2:50 pm**

Break – Resource Fair

**2:50 pm –
4:00 pm**

GOLDEN EAGLE – ROUND TABLE DISCUSSIONS**The Significance of Parenting: United States and Internationally**

Hannah Mills, M.S., Texas Woman's University, Denton, TX

The presentation will describe the importance of parenting and implications for children's development due to parenting styles. Various parenting styles will be described in addition to how they may differ between the United States and internationally.

Effective Parental Monitoring of the Media

LaKendra L. Parker, M.S., Texas Woman's University, Denton, TX

Through both work and education I have been able to develop the knowledge and skills needed to successfully run my own life coaching and consulting business. With all of the adult content and violence being shown on today's American television stations, parental media monitoring may be of an essence.

Children Adopted at Older Ages from the Public Foster Care System: A Review of the Literature

Nerissa LeBlanc Gillum, Ph.D., Texas Woman's University, Denton, TX

Research published from 2001 through 2010 on children adopted at older ages from the public foster care system was analyzed and synthesized into a decade review. This literature review will help determine directions of future research.

ROOM 412 – WORKSHOP**Family Wellness: Survival Skills for Healthy Families throughout the World**

Erin O. Smile, M.S., LMFT, CFLE., Author, Santa Clara, CA

Families throughout the world share the universal desire to raise the best children possible! Come join us to learn how Family Wellness: Survival Skills for Healthy Families has been effectively implemented in diverse cultures and nationalities around the global.

ROOM 413 – RESEARCH AND EVALUATION SYMPOSIUM SESSION**Programs for Families Research and Evaluation Symposium Networking Session**

Join us for a networking and research collaboration planning session! If another concurrent session interests you, feel free to stop by late if that session finishes early.

ROOM 415 - WORKSHOP**Infant Development**

Joy Chen, M.S., Texas Woman's University, Denton, TX

This workshop addresses four important areas of development and provides hands-on activities that attendees can use with the infants and toddlers they serve.

ROOM 417 – RESEARCH TO PRACTICE**The Impact of the Father-Child Time Together on the Father's Perception of His Role**

Amy Ramanus, M.S., Texas Woman's University, Denton, TX

Using panel data from the National Survey of Families and Households (n=1064), the researcher examines the amount of time a divorced father spends with his biological child, what they do during such visitation time, and the impact on the father's perception of happiness involving the relationship he has with his child. Results indicate the amount of time a father spends with his child can have a statistically significant effect on the father's perception of his relationship with his child.

Impact of Modeling on Learning Outcomes of at Risk Children

Victoria I. Iroegbu, Ph.D., Obafemi Awolowo University, Ile-Ife, Nigeria

This study examined confidence of at risk children of their basic level of education, and the effects of improved learning outcomes reduce number of dropouts in school.

ROOM 418 – WORKSHOP

The Importance of Parent Education and Support for Military Families with Young Children

Janet Crow, Ph.D., CFLE, Baylor University, Waco, TX

Military parents cope with unique challenges as they endeavor to raise children in the face of military-lifestyle related stressors. Single-parent military and dual-military families, in which both parents serve, face additionally difficult circumstances that challenge optimal parenting and child development. This session will include an examination of research and anecdotal reports of the realities of these families' lives and will explore the elements of effective parenting support and education for this population.

With gratitude towards all who have made this conference possible:

Co-Sponsors

**UNT College of Education
Department of Educational Psychology
College of Public Affairs and Community Service
UNT Department of Sociology
Texas Association of Parent Educators**

LEVEL 4

- MEETING ROOM 409
- MEETING ROOM 411
- MEETING ROOM 412
- MEETING ROOM 413
- MEETING ROOM 415
- MEETING ROOM 416
- MEETING ROOM 417
- MEETING ROOM 418
- L3 ACCESS TO LEVEL 3
- 1 CENTER FOR LEADERSHIP & SERVICES
- 2 GREEK LIFE
- 3 STUDENT AFFAIRS OFFICES
- 4 UNION ADMINISTRATION
- 5 UNION FACILITIES & TECH OFFICE
- 6 MULTIMEDIA PRODUCTIONS

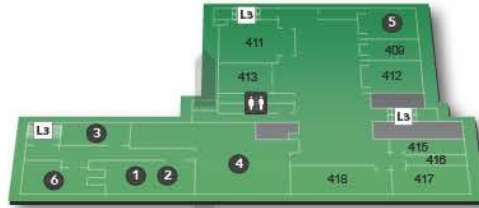

LEVEL 3

- 5 ABNEY
- L2 ACCESS TO LEVEL 2
- L2/L4 ACCESS TO LEVEL 2/4
- 8 ATM
- 9 CAMPUS LIFE
- 10 CENTER FOR STUDENT RIGHTS AND RESPONSIBILITIES
- 11 DEAN OF STUDENTS
- 12 DIAMOND
- 15 GOLDEN
- 16 HANN
- 17 INFORMATION CENTER
- 18 LEARNING CENTER
- 19 LOUNGE
- 20 LYCEUM
- 21 NIGHT MANAGER
- 22 OFFICE OF DISABILITY ACCOMMODATIONS
- 23 ORIENTATION & TRANSITION PROGRAMS
- 24 PONDER
- 25 SILVER EAGLE SUITE
- 26 STUDENT GOVERNMENT ASSOCIATION
- 27 STUDENT LEGAL SERVICES
- 28 TECH.
- 29 TICKET SALES
- 30 TRANSFER CENTER & STUDENT ACTIVITIES & ORGANIZATIONS
- 31 UNION GALLERY
- 32 VETERANS CENTER
- 33 WELLS FARGO BANK

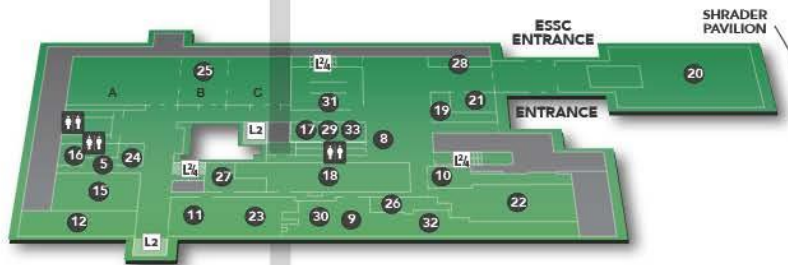

LEVEL 2

- L1 ACCESS TO LEVEL 1
- L3 ACCESS TO LEVEL 3
- L1/3 ACCESS TO LEVELS 1/3
- LL ACCESS TO LOWER LEVEL TEXTBOOK SALES
- 38 AVESTA
- 39 UNT BOOKSTORE
- 40 COMPUTER/TRADE BOOK
- 41 CONFERENCE
- 42 THE CORNER
- 43 DESIGN WORKS
- 44 EAGLE EXPRESS POSTAL SERVICE
- 45 EAGLE IMAGES
- 48 GREEN MOUNTAIN COFFEE
- 49 MULTICULTURAL CENTER
- 50 UNT MAIL SERVICE
- 51 SCHEDULING SERVICES
- 52 UNIVERSITY PROGRAM COUNCIL

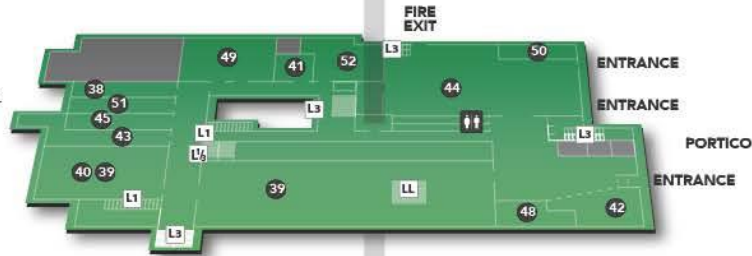

LEVEL 1

- UL ACCESS TO BOOKSTORE UPPER LEVEL
- L2 ACCESS TO LEVEL 2
- 55 ATMs
- 56 UNT BOOKSTORE LOWER LEVEL
- 57 BOOK BUY BACK
- 58 CAMPUS CHAT
- 59 CHICK-FIL-A
- 60 COURTYARD
- 62 EINSTEIN'S BAGELS
- 63 FAMILY RR
- 64 FOOD COURT
- 65 ONE O'CLOCK LOUNGE
- 67 RETAIL DINING ADMIN.
- 68 THE SYNDICATE
- 69 TACO BELL
- 70 VENDING

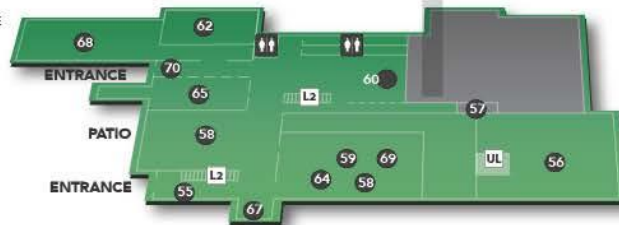

- WALKING PATH
- ELEVATOR
- STAIRS
- RESTROOM