

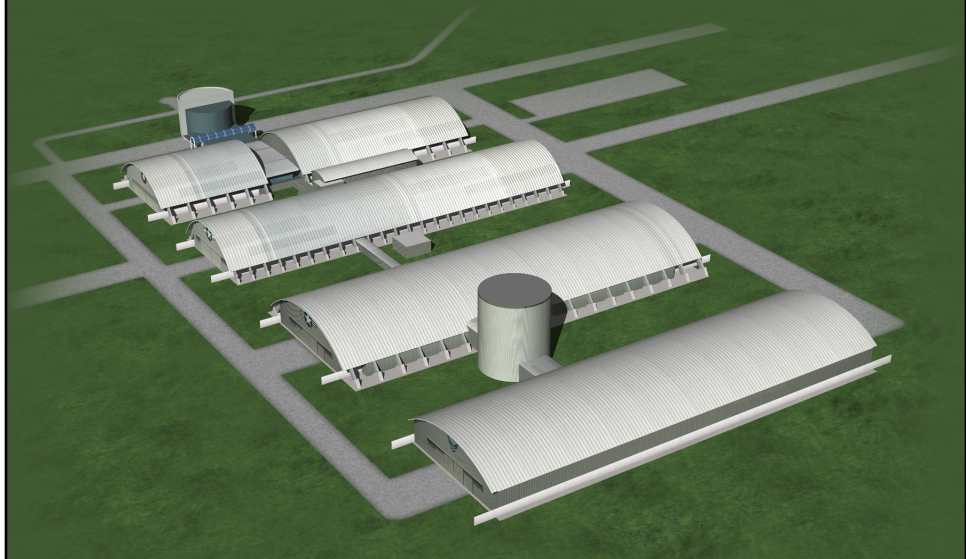

EXPANSION

Space Gallery | Presidential Aircraft Gallery | Global Reach Gallery



The Air Force's national museum is growing

The National Museum of the U.S. Air Force is in the midst of a multi-phase, long-term expansion plan to expand its current one million square feet of exhibit space with a fourth building that will house the Space Gallery, Presidential Aircraft Gallery and Global Reach Gallery.

www.nationalmuseum.af.mil/expansion.asp

Space Gallery

This gallery will tell the remarkable story of Air Force activities in space. A major exhibit component of the gallery will be the NASA Crew Compartment Trainer (CCT), a high-fidelity

representation of a space shuttle orbiter crew station that was used primarily for on-orbit crew training and engineering evaluations. The gallery also will include a Titan IV space launch vehicle, Mercury, Gemini and Apollo spacecraft, and many recently retired NASA artifacts such as a nose cap assembly, landing gear strut and a variety of astronaut equipment. In addition, a range of satellites and related items will showcase the Air Force's vast reconnaissance, early warning, communications and other space-based capabilities. Other new exhibits will be developed to showcase Air Force technologies with many unique characteristics in design, propulsion, payload capacity, human factors, communication, range, speed and operating environment.

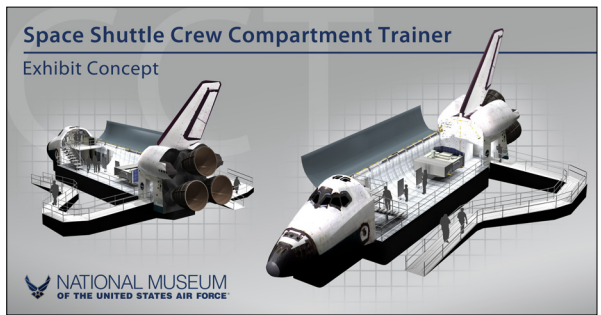

Presidential Aircraft Gallery

The museum is the repository for Air Force aircraft that have been retired from the presidential aircraft fleet. Currently, the museum's presidential aircraft are on display in an auxiliary hangar a mile from the main museum complex on a controlled-access portion of Wright-Patterson Air Force Base. Visitors must be transported by bus to this facility. The new gallery will permit the museum to bring the presidential aircraft to the main facility, allowing all visitors the opportunity to view this historic collection of nine presidential aircraft, among them the Douglas VC-54 used by Presidents Roosevelt and Truman, the Douglas VC-118 used by President Truman, the Lockheed VC-121E used by President Eisenhower and the Boeing VC-137C used by President Kennedy.



Global Reach Gallery

An important element of Air Force history will be told in the Global Reach Gallery. Providing airlift remains a major mission of the U.S. Air Force and it forms a critical part of the Air Force's ability to maintain global reach. The Global Reach Gallery will give the opportunity to house large aircraft currently

in the museum’s collection, such as the C-141 *Hanoi Taxi*, and those anticipated to become part of the collection, such as a C-5 Galaxy and KC-135. The Air Force’s airlift and air refueling missions will also be explained in this gallery.



Educational Programming

The museum is planning to develop new exhibits with an emphasis on science, technology, engineering and math (STEM) programs. These include exhibits that will showcase Air Force technologies with many unique characteristics in design, propulsion, payload capacity, human factors, communication, range, speed and operating environment.

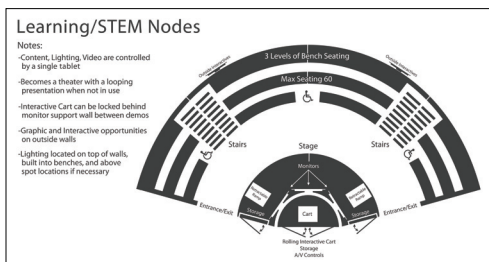

One of the unique features of the fourth building will be the creation of dedicated, interactive spaces for learning in the galleries. Three Learning Nodes will provide a unique environment for lectures and demonstrations, as well as extensions of the exhibit experience. These

60-seat “gallery classrooms” will allow museum staff to facilitate new STEM experiences, while guest scientists and engineers from Air Force organizations, the aerospace industry, and area colleges and universities will be invited to share their expertise. Multimedia presentations will introduce students to air and space missions and the men and women responsible for their execution. When the nodes are not in use for scheduled programs, multimedia presentations will captivate public audiences.

Global Reach Gallery

Space Gallery

Presidential Gallery

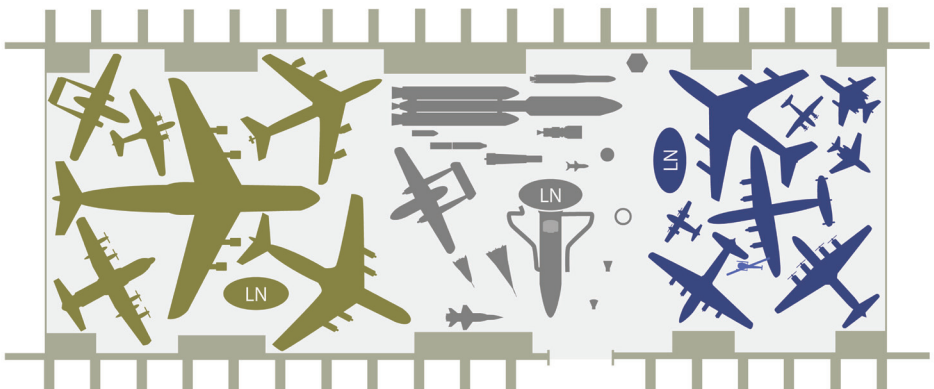



NATIONAL MUSEUM
OF THE UNITED STATES AIR FORCE®
"We are the keepers of their stories"®

www.nationalmuseum.af.mil/expansion.asp