



U.S. Department
of Transportation

Alaskan Region

222 W. 7th Avenue #14
Anchorage, Alaska
99513-7587

**Federal Aviation
Administration**

October 8, 2010

Mr. Harvey M. Douthit, PE, Design Section Chief
Alaska Department of Transportation
Aviation Design Section
4111 Aviation Drive
Anchorage, AK 99502

Dear Mr. Douthit:

**Whittier Airport, Whittier, Alaska
Revised Airport Layout Plan Conditional Approval
Airspace Case 2008AAL-180NRA**

We have completed our review of the Revised Airport Layout Plan (ALP) for the Whittier Airport, and find it acceptable from a planning standpoint. No Modifications to Standards are approved with this ALP approval.

We note the following outstanding challenges with this ALP that may require further action from the airport sponsor:

- Currently the Alaska DOT&PF is operating this airport in trespass of Railroad property (Tract I). In addition, the 5-year lease with the US Army Corps of Engineers will expire in 3 years (Tract II). We are uncertain of the scope and expiration date of the City of Whittier Agreement with DOT&PF (Tract III). Since the airport sponsor does not have sufficient property interest on this airport the FAA is unable to issue any developmental or maintenance Airport Improvement Program (AIP) grants for this site.
- Please correct the narrative to indicate that this is a VFR airport and obstructions prevent this site from developing a straight-in approach procedure.
- Please submit the proposed runway numbers change to NFDC.

The conditional approval indicated by my signature is given subject to the condition that the proposed airport development that requires environmental processing shall not be undertaken without prior written environmental approval by the FAA. This approval considers only the safety, utility, and efficiency of the airport. We encourage you to work with appropriate agencies to encourage adoption of height and zoning restrictions.

This approval does not represent a commitment to provide financial assistance to implement the proposed plan. FAA assistance in any development or its approval for any development will be determined at the time of request, based on the existing regulations, project justification, and eligibility at the time of the request.

When airport construction, alteration, or deactivation is undertaken, such action requires FAA notification and review in accordance with the provisions of Part 77 and Part 157 of the Federal Aviation Regulations. In addition, all airport construction must be completed in accordance with FAA Advisory circulars current at the time of construction. Please attach this letter to the enclosed ALP and retain it in your files for future use.

If you have any questions, please contact Gabriel Mahns at 271-3665.

Sincerely,

John Lovett
Lead Civil Engineer, Airports Division

DOWL File No.: 232-103-1

Designed By: rlewellyn
 Drawn By: Bobalinn
 Checked By: Doraean
 Date Plotted: 9/15/2010, 1:46 PM
 Layout Name: D:\Projects\AUTOCAD\TEMP\Pub\shin_3432\ALP-Whittier.dwg
 File Name:

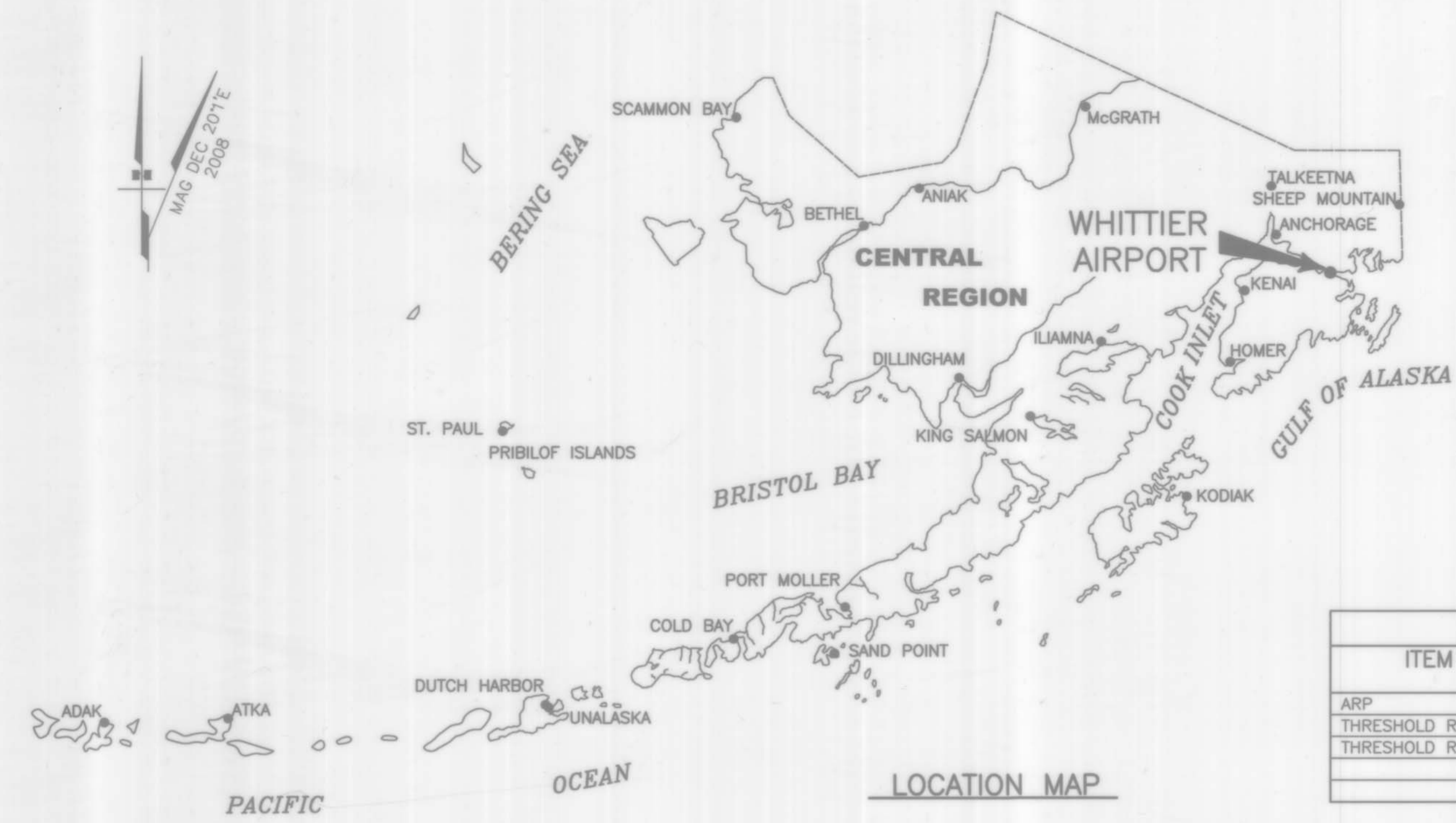

LOCATION MAP

LEGEND		
ITEM	EXISTING	ULTIMATE
AIRPORT REFERENCE POINT (A.R.P.)		
ANTENNA		
BLUFF		
BUILDINGS		
BUILDING RESTRICTION LINE		
FENCE		
PAPI		
PROPERTY LINE		
RAIL		
ROADWAYS		
ROTATING BEACON		
SHORELINE		
SURVEY MONUMENT		
THRESHOLD MARKERS/LIGHTS		
TOPOGRAPHIC CONTOURS		
TREE (LARGE SINGLE)		
TREELINE		
VASI		
WIND CONE		
WIND CONE AND SEGMENTED CIRCLE		

GEOGRAPHIC COORDINATES TABLE				
ITEM	EXISTING LATITUDE	EXISTING LONGITUDE	ULTIMATE LATITUDE	ULTIMATE LONGITUDE
ARP	60°46'37.81" N	148°43'10.75" W		
THRESHOLD RW 4	60°46'33.72" N	148°43'23.08" W		
THRESHOLD RW 22	60°46'41.90" N	148°42'58.42" W		



VICINITY MAP

PROTRACTED T 8 N, R 4 E, SEC. 15
 SEWARD MERIDIAN
 U.S.G.S. SEWARD (D-5), ALASKA

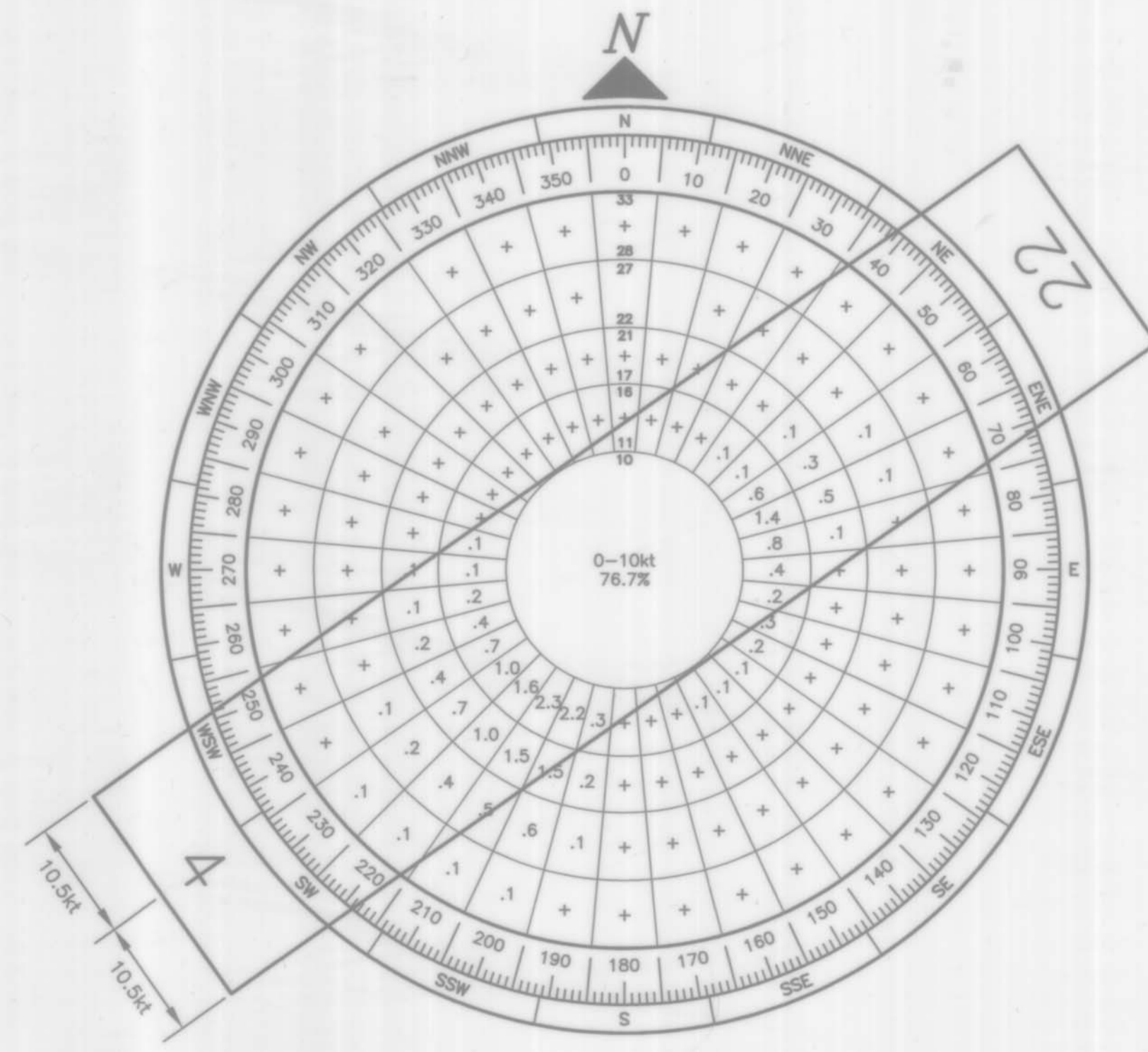
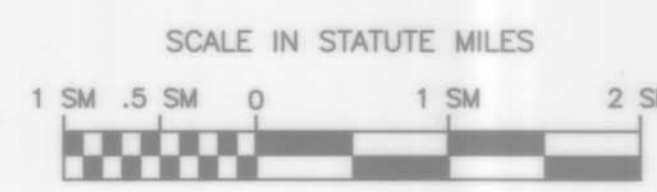

RUNWAY	WIND DATA TABLE			
	10.5 kt	13 kt	16 kt	20 kt
4/22	96.0	98.2	99.4	99.8

SOURCE: NATIONAL CLIMATIC DATA CENTER.
 PERIOD: 1975 - 2007.

AIRPORT DATA TABLE		
ITEM	EXISTING	ULTIMATE
ICAO IDENTIFIER	NONE	
NATIONAL AIRPORT IDENTIFIER	ITEM	
FAA SITE NUMBER	50875.*A	
AIRPORT ELEVATION NAVD88	39'	
AIRPORT REFERENCE CODE	A-1	
MEAN MAX. TEMPERATURE, HOTTEST MONTH	63°F, AUGUST	
AIRPORT AND TERMINAL NAVIGATION AIDS	NONE	
TAXIWAY LIGHTING/MARKING	NONE	
OBSTRUCTION SURVEY SOURCE & TYPE	NONE	
MAGNETIC DECLINATION, YEAR, RATE OF CHANGE	20°53'E, 2005, -0°16'(W) / YEAR 19°28'E, 2010, -0°16'(W) / YEAR	

RUNWAY 4/22 DATA TABLE				
ITEM	EXISTING	NEAR TERM	ULTIMATE	
RUNWAY TYPE UTILITY OR OTHER THAN UTILITY	UTILITY			
FAR PART 77 APPROACH CATEGORY (V, NPI, P)	V			
APPROACH SURFACES	20:1			
VISIBILITY MINIMUM	≥1 SM			
RUNWAY SURFACE	GRAVEL			
PAVEMENT STRENGTH SW,DW,DTW,DDTW x1000lbs	N/A			
AIRCRAFT APPROACH CATEGORY	A			
AIRPLANE DESIGN GROUP	I			
TRUE BEARING	N55°50'55"E			
EFFECTIVE GRADE	1.35%			
TOUCHDOWN ELEVATION NAVD88 (ESTIMATED)	39' / 39'			
RUNWAY DIMENSIONS	60' x 1480'			
RUNWAY SAFETY AREA (RSA) DIMENSIONS	100' x 1705'			
LENGTH BEYOND R/W END	25' / 200'			
RUNWAY PROTECTION ZONE (RPZ) DIMENSIONS	250' x 450' x 1000'			
RUNWAY OBJECT FREE AREA (ROFA) DIMENSIONS	250' x 1745'			
LENGTH BEYOND R/W END OR STOPWAY	25' / 240'			
RUNWAY OBSTACLE FREE ZONE (ROFZ) DIMENSIONS	250' x 1880'			
RUNWAY LIGHTING	NONE			
RUNWAY MARKING TYPE	NONE			
RUNWAY VISUAL APPROACH AIDS	NONE			

NOTES

1. THE INFORMATION SHOWN HEREON IS BASED ON A FIELD SURVEY PERFORMED BY DOWL HKM ON NOVEMBER 14, 2007.
2. THE HORIZONTAL DATUM IS NAD83(CORS96) (EPOCH:2003.0000) AS DETERMINED BY STATIC GPS OBSERVATIONS USING LEICA DUAL FREQUENCY GPS RECEIVERS AND PROCESSED USING THE NGS OPUS UTILITY. CONTROL CORS STATIONS USED FOR THE POSITION SOLUTION WERE TSEA, POTS AND CHIS.
3. THRESHOLD COORDINATES WERE DETERMINED USING A STATIC GPS NETWORK. THE TOPOGRAPHIC MAPPING IN THE AIRPORT VICINITY WAS DIGITIZED FROM USGS QUAD SEWARD (D-5).
4. RUNWAY NUMBERS CHANGED FROM 3/21 TO 4/22 DUE TO CHANGES IN MAGNETIC DECLINATION.

DRAWING INDEX		SHT #	TITLE
		2	EXISTING LAYOUT
		3	AIRPORT AIRSPACE, 14 CFR, PART 77

BY DATE	REVISION
APPROVED: <i>K. Kim Rice</i>	DATE: 10-1-2010
K. KIM RICE, P.E.	PRECONSTRUCTION ENGINEER
RECOMMENDED: <i>Harvey M. Douthitt</i>	DATE: 10/1/2010
HARVEY M. DOUTHITT, P.E.	DESIGN SECTION CHIEF

STATE OF ALASKA DEPARTMENT OF TRANSPORTATION AND PUBLIC FACILITIES CENTRAL REGION	
WHITTIER AIRPORT WHITTIER, ALASKA AIRPORT LAYOUT PLAN	
DATE: 09/15/2010	SHEET: 1 OF 3

AIRPORT LAYOUT PLAN CONDITIONAL APPROVAL SUBJECT TO ALP APPROVAL LETTER DATED 10/8/2010 FAA AIRSPACE REVIEW NUMBER: 2008-AAL-180-NRA	DATE: 10/8/2010 FAA, AIRPORTS DIVISION ALASKAN REGION, AAL-612
---	---

FILE No.: 232-103-2

9/16/2010, 1:46 PM
 Date Plotted:
 Layout Name: C:\PROJECTS\AUTOCAD\TEMP\publish_3432_VLP-WHITTIER.dwg
 File Name:
 Drawn By: miewellm
 Checked By: bbojolin
 I. Bhanoon

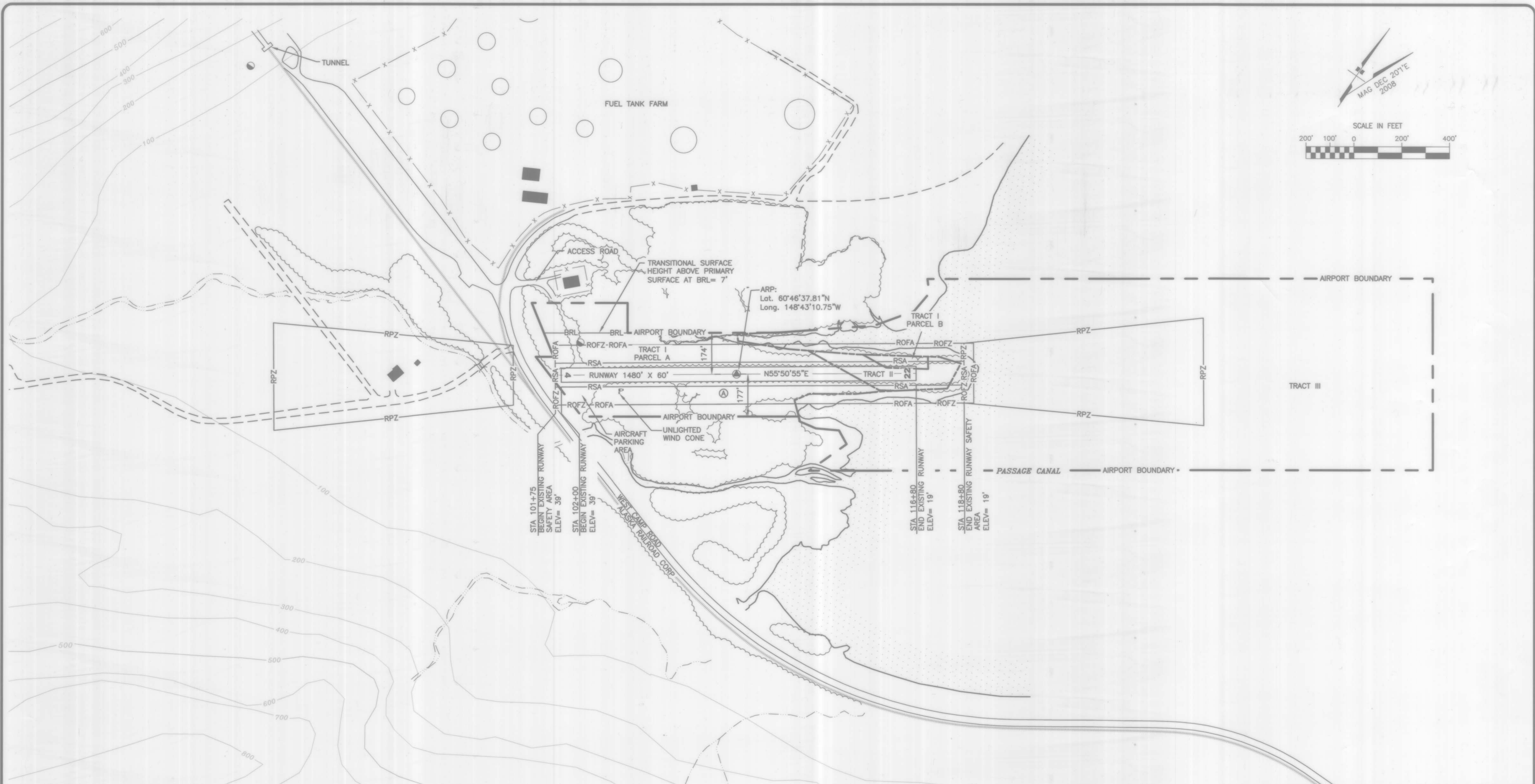

ROFZ PENETRATIONS		
ID #	DESCRIPTION	DISPOSITION
(A)	BRUSH*	REMOVE

* ENTIRE LENGTH BOTH SIDES OF RUNWAY

BUILDING DATA TABLE				
ID #	DESCRIPTION	STATION/OFFSET	TOP ELEV (NAVD88)	OBSTRUCT MARKING

PROPERTY STATUS							
ID #	INTEREST	GRANTOR	GRANTEE	PARCEL SIZE	DATE ACQUIRED	RECORDED DOC NO.	ACQUIRED AIP NO.
TR I* PARCEL A	20-YEAR LEASE SUPP'L No.1 ISSUED 11/15/83	ALASKA RAILROAD CORPORATION	STATE OF ALASKA, DOT/PF	11.23± ac	11/15/78	ADA 11304 BK1132,PG530,ANC.	N/A
TR-I* PARCEL B	20-YEAR LEASE SUPP'L No.1 ISSUED 11/15/83	ALASKA RAILROAD CORPORATION	STATE OF ALASKA, DOT/PF	1.03± ac	11/15/78	ADA 11304 BK1132,PG530,ANC.	N/A
TR II	5-YEAR LEASE (ENDS 11/14/08)	US ARMY CORPS OF ENGINEERS	STATE OF ALASKA, DOT/PF	4.83 ac		ADA 11304	N/A
TR III**	LAND MANAGER AGREEMENT	CITY OF WHITTIER	STATE OF ALASKA, DOT/PF	43.84± ac	9-19-00	UNRECORDED	N/A

* SUPPLEMENT No. 1 REDUCED ACREAGE OF ORIGINAL TRACT I WHICH CONTAINED 38.40 ACRES & CREATED PARCELS A & B.
 ** TRACT III OVERLAPS TRACT I AND TRACT II. THE OVERLAPPING BOUNDARIES HAVE BEEN REMOVED FOR CLARITY.

BY	DATE	REVISION

WHITTIER AIRPORT
 WHITTIER, ALASKA
 AIRPORT LAYOUT PLAN
 EXISTING LAYOUT

DATE:
09/15/2010
 SHEET:
2
 OF
3

FILE No.: 232-50-5

Designed By: mlsellin
 Drawn By: hognin
 Checked By: banson

Date Plotted: 9/16/2010, 1:46 PM
 Layout Name: P77 (3)
 File Name: C:\PROJECTS\AUTOCAD\TEMP_AcPublish_3432\ALP-WHITTIER.dwg

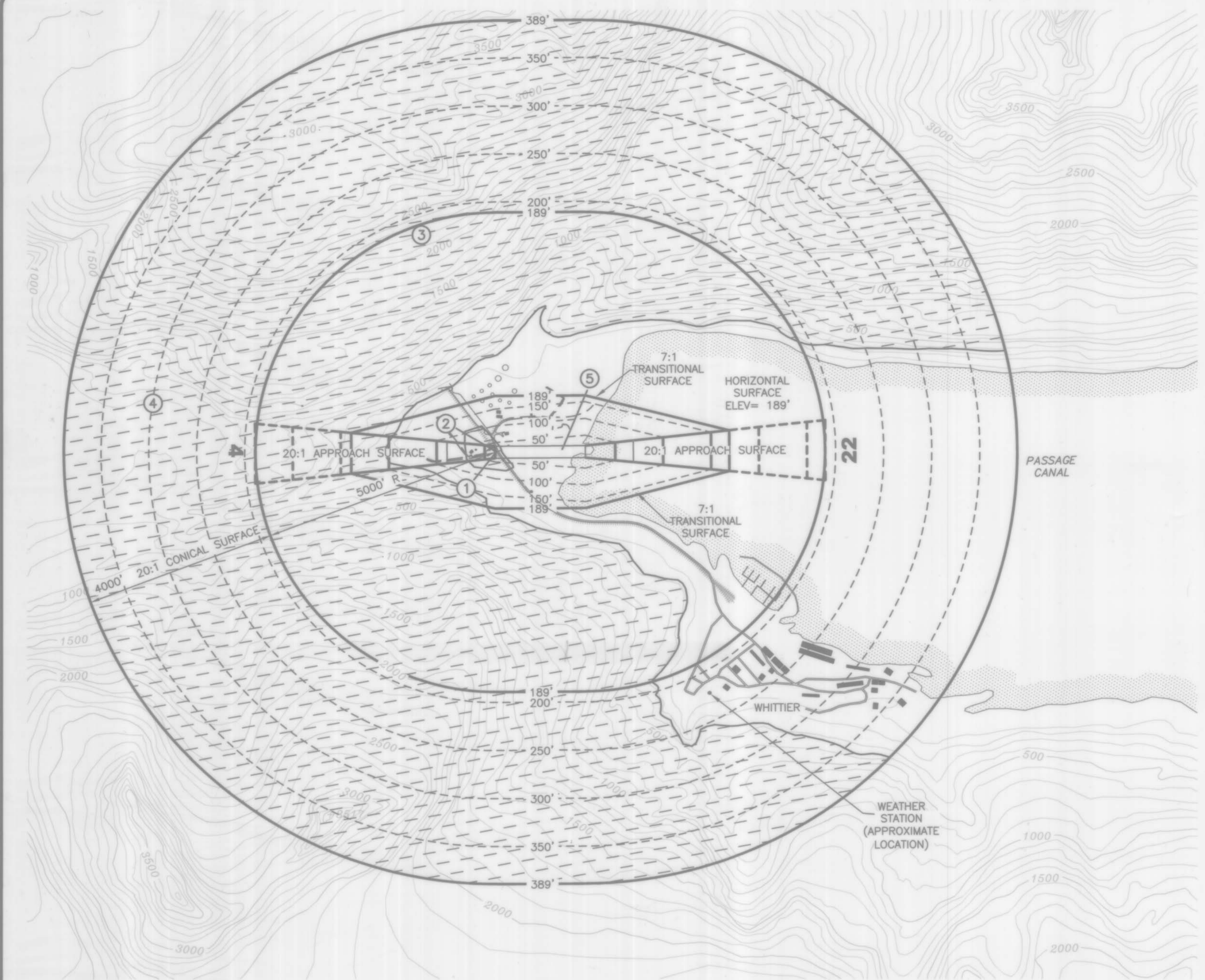

PART 77 SURFACE OBSTRUCTIONS TABLE (OUTER PORTION RW 4/22)								
ID #	DESCRIPTION	STATION/OFFSET	ELEVATION	SURFACE PENETRATED	SURFACE ELEVATION	AMOUNT PENETRATION	DISPOSITION	STAGE TO CORRECT
1	ROAD	100+84/0	67'	PRIMARY/APPROACH	39'***	28'	TO REMAIN	
2	RAILROAD TRACKS	100+27/0	78'	APPROACH	48'***	30'	TO REMAIN	
3	TERRAIN	*	189' - ~2200'	HORIZONTAL	189'	1' - 2011'	TO REMAIN	
4	TERRAIN	*	189' - ~3500'	CONICAL	189' - 389'	1' - 1489'	TO REMAIN	
5	BRUSH	**/55'	29' - 49'	PRIMARY	19' - 39'	10'	REMOVE	

* SEE PLAN VIEW.
 ** ALMOST ENTIRE LENGTH BOTH SIDES OF RUNWAY.
 *** INCLUDES ROAD CLEARANCE 15' OR RAILROAD CLEARANCE 23' AS APPROPRIATE.



NOTES

1. AIRPORT ELEVATION IS 39'.
2. PRIMARY SURFACE WIDTH IS 250'.
3. TOPO CONTOURS ARE SHOWN IN FEET. BASEMAP DATA FROM USGS SEWARD (D-5).
4. A RANGEFINDER WITH BUILT-IN INCLINOMETER WAS USED TO IDENTIFY OBSTRUCTIONS CLOSE TO THE RUNWAY IN THE PRIMARY AND TRANSITIONAL SURFACES.
5. APPROACH SURFACES ARE 20:1, BEGINNING 200' BEYOND THE THRESHOLDS.
6. THERE ARE NO OBSTRUCTIONS IN THE APPROACH TO RUNWAY 22, THEREFORE THE OBSTRUCTION CLEARANCE SLOPE IS ESTABLISHED AS 50:1 PER FAA AC 150/5200-35, CHAPTER 4.
7. THE RUNWAY 4 CONTROLLING OBSTRUCTION IS A ROAD AT STATION 100+84, ON RUNWAY CENTERLINE, ELEVATION IS 67' ABOVE RUNWAY. THE OBSTRUCTION CLEARANCE SLOPE IS 1:1, PER FAA AC 150/5200-35, CHAPTER 4.
8. THERE ARE NO OBJECT PENETRATIONS IN THE RUNWAY APPROACH END SITING SURFACE OF RUNWAY 22, AS DEFINED IN FAA AC 150/5300-13, TABLE AS-1, ROW 5.
9. THE RUNWAY 4 APPROACH END SITING SURFACES DO NOT MEET ANY THRESHOLD SITING CRITERIA BECAUSE OF TERRAIN.
10. THERE ARE NO KNOWN HEIGHT RESTRICTIONS. WHITTIER IS CLASSIFIED AS A SECOND CLASS CITY.
11. THERE IS A WEATHER STATION LOCATED APPROXIMATELY 1.2 NM FROM THE ARP AT A BEARING OF 120'.

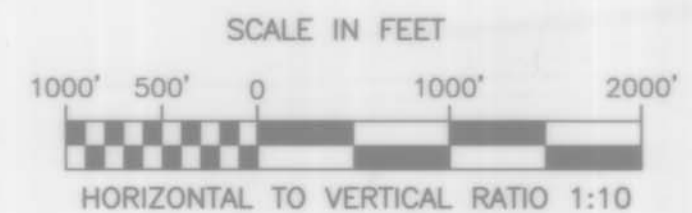
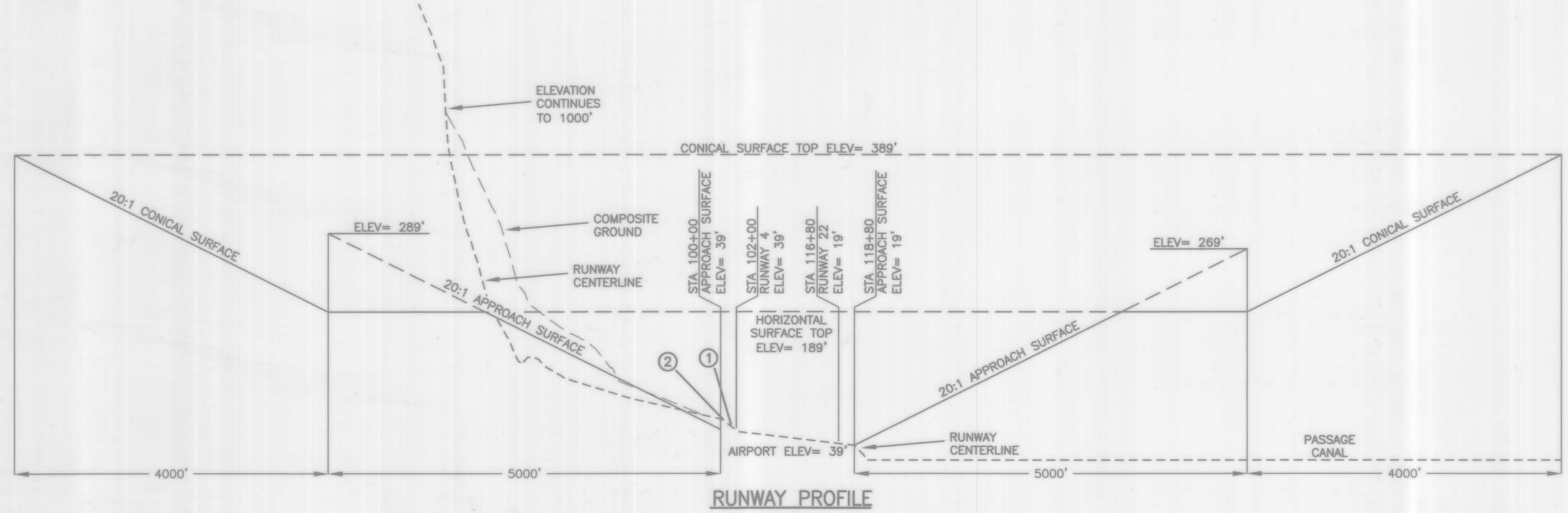

BY	DATE	REVISION

WHITTIER AIRPORT
 WHITTIER, ALASKA
 AIRPORT LAYOUT PLAN

DATE: 09/15/2010
 SHEET: 3 OF 3

AIRPORT AIRSPACE
 14 CFR, PART 77