

# AIRPORT LAYOUT PLAN FOR MANOKOTAK AIRPORT

2006

DRAWING INDEX

- 1 - COVER SHEET AND INDEX
- 2 - VICINITY MAP AND DATA TABLES
- 3 - PROPOSED RUNWAY 03/21 PLAN
- 4 - FUTURE RUNWAY 03/21 PLAN
- 5 - RUNWAY 03/21 INNER APPROACH SURFACE PLAN AND PROFILE
- 6 - TERMINAL AREA PLAN
- 7 - RUNWAY 03/21 APPROACH PROFILES
- 8 - F.A.R. PART 77 SURFACES
- 9 - NARRATIVE REPORT
- 10 - AIRPORT PROPERTY MAP



DATE	BY	REVISIONS
8/3/06	JTC/DM	F.A.A. AIRSPACE
4-26-11		AS-BUILT: UPDATED SHEETS 2-8 &

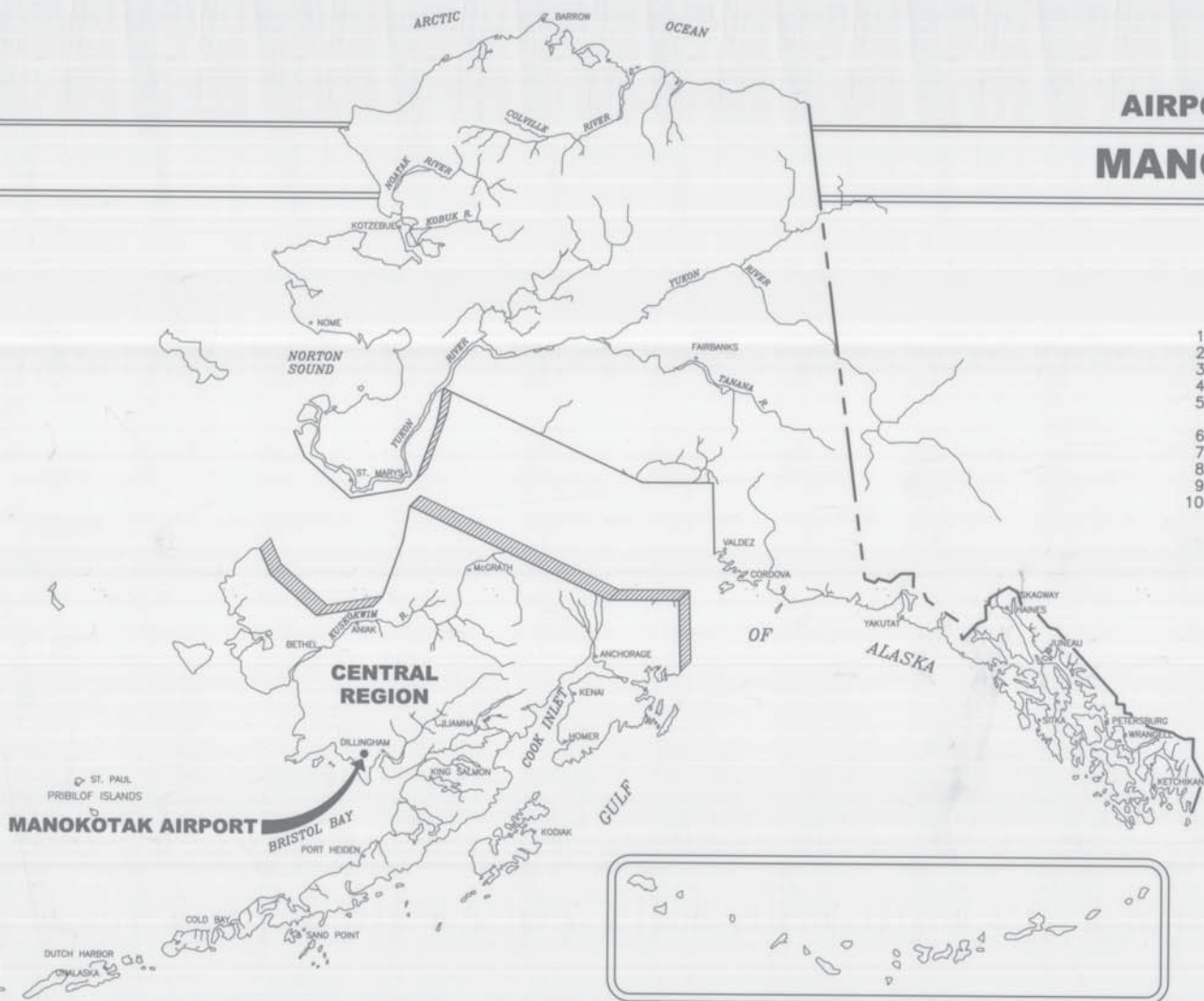

**SPONSORED BY  
STATE OF ALASKA  
DEPARTMENT OF TRANSPORTATION  
AND PUBLIC FACILITIES  
CENTRAL REGION**

**APPROVED** *[Signature]*  
**ROBERT A. CAMPBELL, P.E.**  
**PRECONSTRUCTION ENGINEER**

**RECOMMENDED** *[Signature]*  
**HARVEY M. DOUTHIT, P.E.**  
**DESIGN SECTION CHIEF**

AIRPORT LAYOUT PLAN CONDITIONAL APPROVAL  
SUBJECT: ALP APPROVAL LETTER DATED 8/31/06

F.A.A. AIRSPACE REVIEW NUMBER:  
05-AAL-139NRA

DATE: 8/30/06

**MANOKOTAK AIRPORT  
AIRPORT LAYOUT PLAN**

**SHEET 1 OF 10**

M.B.A. 10/2/06  
 Manokotak ALP in Final 10/2/06  
 Cover Sheet 3 index 1/10

DATE: 8/31/06  
 BY: JTC/DM  
 PROJECT: MANOKOTAK AIRPORT LAYOUT PLAN  
 SHEET: COVER SHEET 3 INDEX



DATE: 07/20/06 11:38 AM  
 DRAWN BY: J. J. JENSEN  
 CHECKED BY: J. J. JENSEN  
 PROJECT: MANOKOTAK AIRPORT LAYOUT PLAN

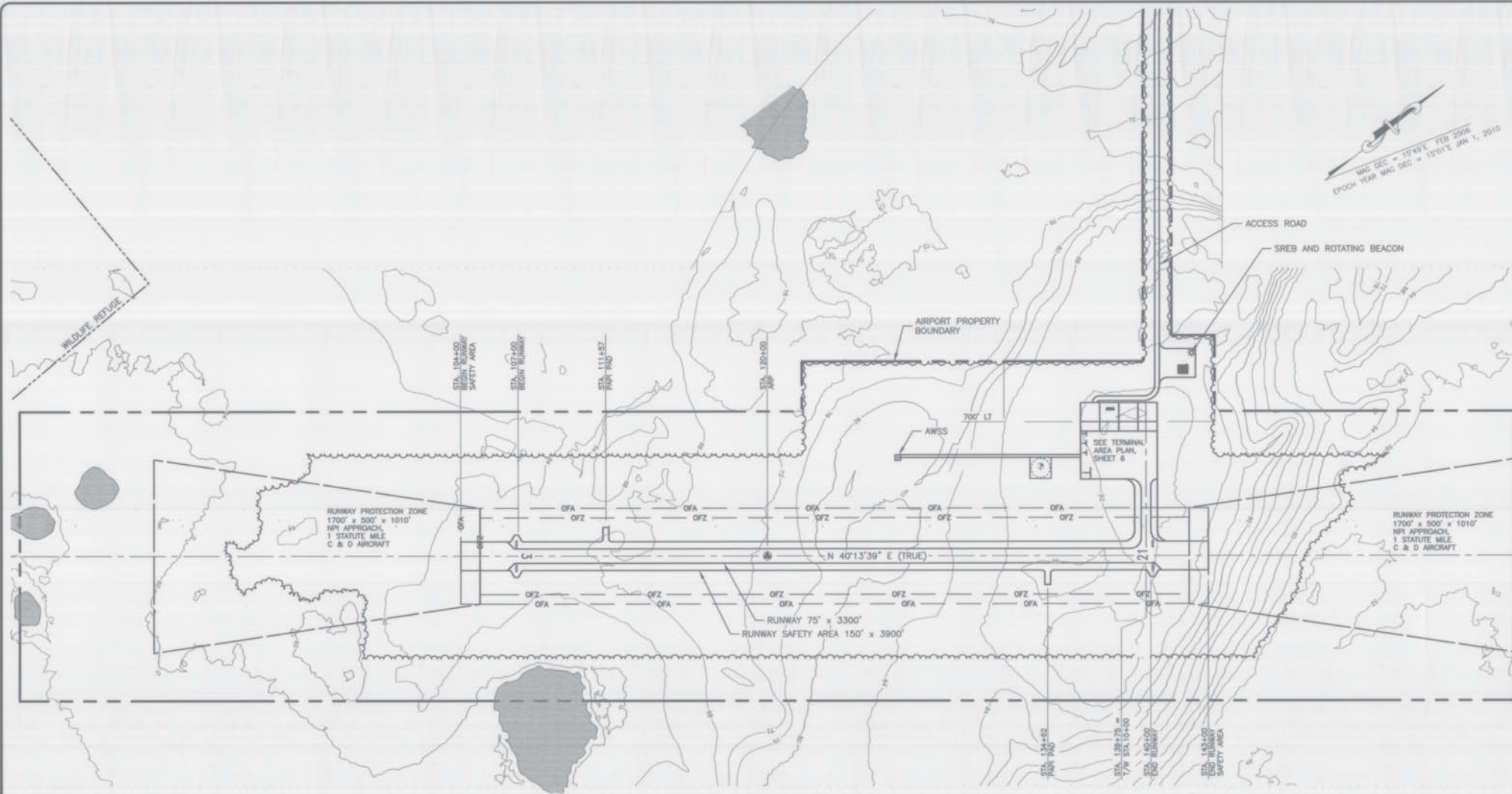

MAG DEC = 15°49' E, FEB 2006  
 EPOCH YEAR MAG DEC = 15°01' E, JAN 1, 2010

**NOTES:**

- SEE SHEET 6 FOR BUILDING DATA TABLE AND SHEET 8 FOR OBSTRUCTIONS DATA TABLE.

**RUNWAY 03/21 PLAN**



NO.	DATE	REVISIONS
1	4-26-11	AS-BUILT: UPDATED TO EXISTING CONDITIONS

STATE OF ALASKA  
 DEPARTMENT OF TRANSPORTATION  
 AND PUBLIC FACILITIES  
 CENTRAL REGION

**MANOKOTAK AIRPORT**  
 MANOKOTAK, ALASKA  
 AIRPORT LAYOUT PLAN  
 EXISTING RUNWAY 03/21 PLAN

DATE: JULY 2006  
 SHEET: 3 OF 10

MAG DEC = 1549T, FEB 2006  
 EPOCH YEAR MAG DEC = 1551T, JAN 1, 2010

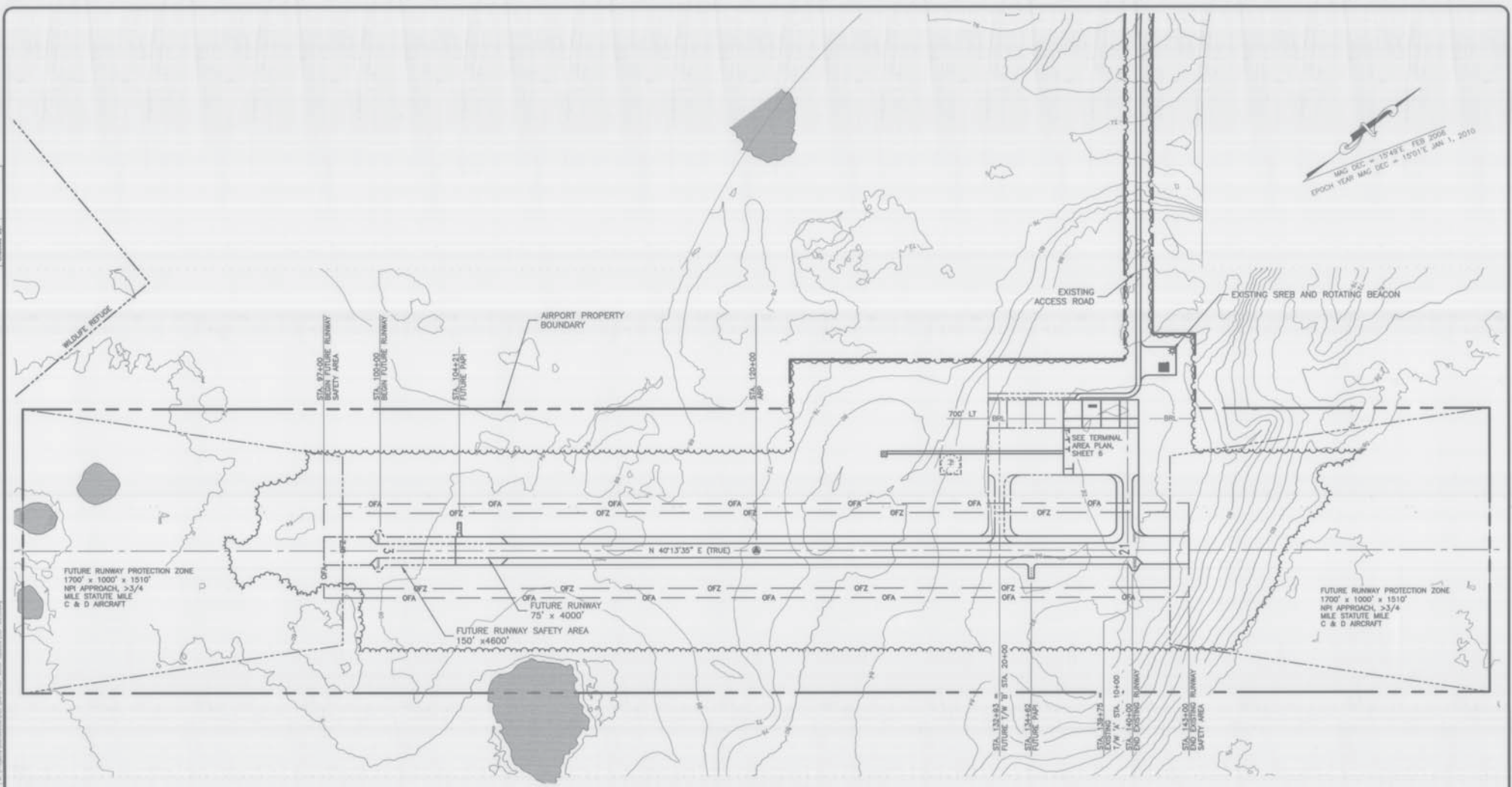

**FUTURE RUNWAY 03/21 PLAN**

**NOTES:**

- 1. SEE SHEET 6 FOR BUILDING DATA TABLE AND SHEET 8 FOR OBSTRUCTIONS DATA TABLE.



DATE PLOTTED: 1/27/06 11:30 AM  
 DRAWN BY: J. B. BROWN  
 CHECKED BY: J. B. BROWN  
 FILE NAME: \\manokotak\manokotak\0321\0321.dwg

NO.	DATE	REVISIONS
723	4-26-11	AS-BUILT: UPDATED TO EXISTING CONDITIONS

STATE OF ALASKA  
 DEPARTMENT OF TRANSPORTATION  
 AND PUBLIC FACILITIES  
 CENTRAL REGION

**MANOKOTAK AIRPORT**  
 MANOKOTAK, ALASKA  
 AIRPORT LAYOUT PLAN  
 FUTURE RUNWAY 03/21 PLAN

DATE: JULY 2006  
 SHEET: 4 OF 10

Date Plotted: 1/17/2018, 8:35 AM  
 User: j...  
 Plot Path: ...

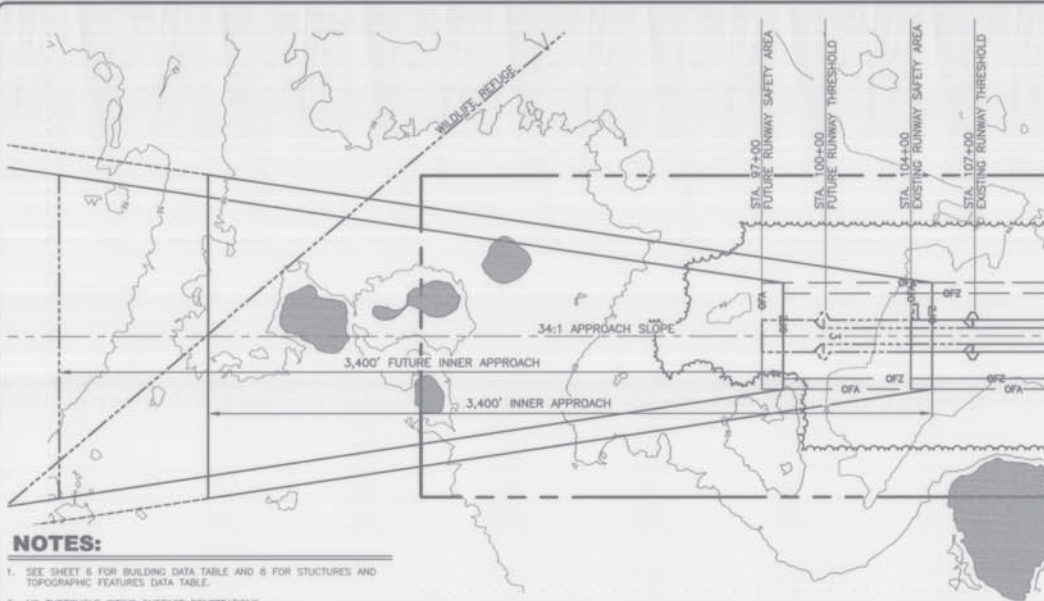

**NOTES:**

1. SEE SHEET 8 FOR BUILDING DATA TABLE AND 8 FOR STRUCTURES AND TOPOGRAPHIC FEATURES DATA TABLE.
2. NO THRESHOLD SITING SURFACE PENETRATIONS.
3. TERPS PARAGRAPH 251, 20:1 APPROACH SURFACE CLEAR.
4. OBSTRUCTION CLEARANCE SLOPE GREATER THAN 50:1.

**RUNWAY 03 PLAN**

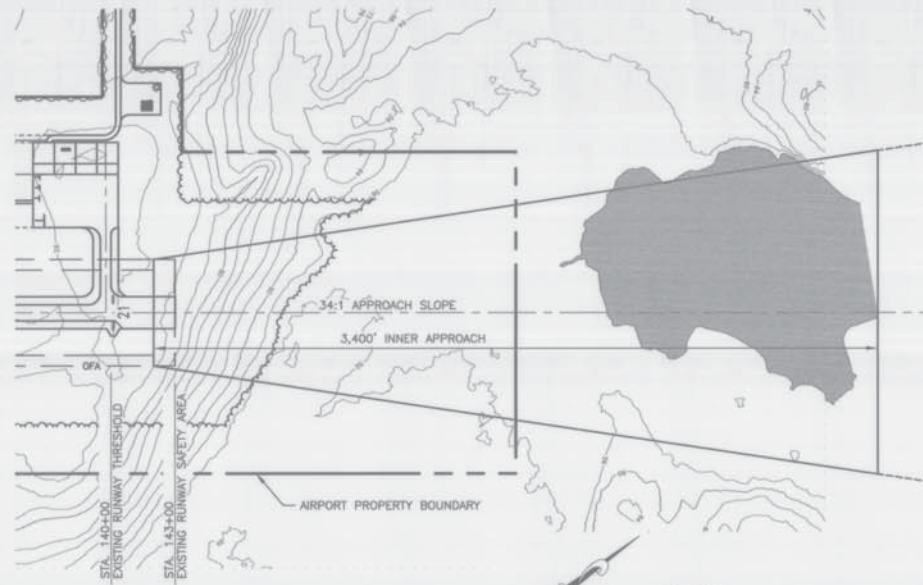

**RUNWAY 21 PLAN**

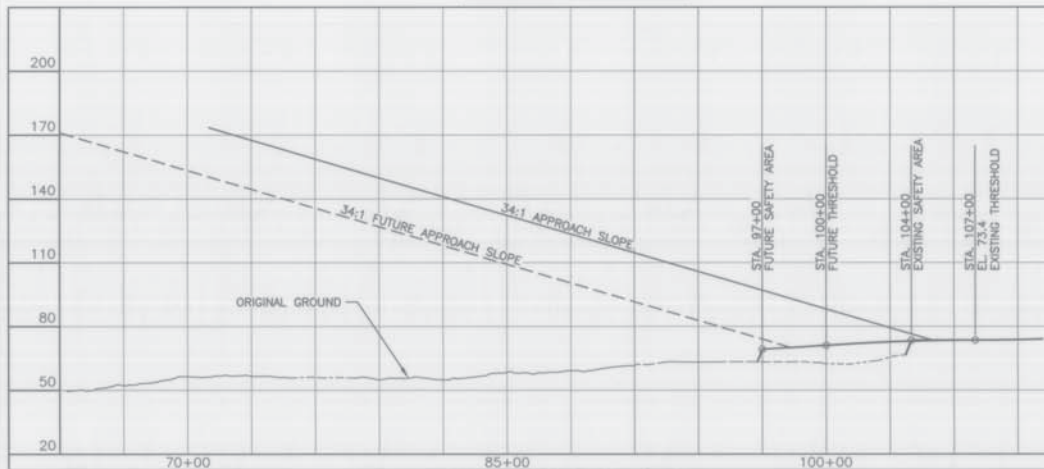
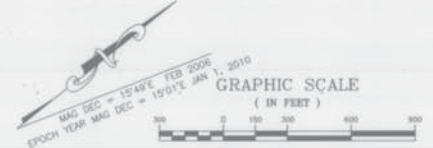

**RUNWAY 03 PROFILE**

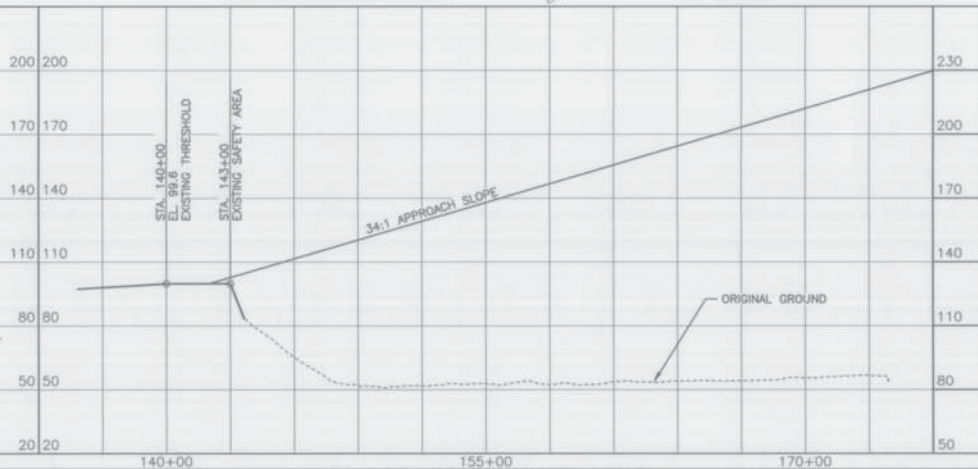

**RUNWAY 21 PROFILE**

NO.	DATE	REVISIONS
223	4-26-11	AS-BUILT: UPDATED TO EXISTING CONDITIONS

STATE OF ALASKA  
 DEPARTMENT OF TRANSPORTATION  
 AND PUBLIC FACILITIES  
 CENTRAL REGION

**MANOKOTAK AIRPORT**  
 MANOKOTAK, ALASKA  
 AIRPORT LAYOUT PLAN  
 RUNWAY 03/21 INNER APPROACH SURFACE  
 PLAN AND PROFILE

DATE: JULY 2008  
 SHEET: 5 OF 10

MAG DEC = 1249E FEB 2009  
 EPOCH 1928 MAG DEC = 1207E JAN 1, 2010

GRAPHIC SCALE  
 ( IN FEET )



PROPOSED AND FUTURE TAXIWAY DATA TABLE		
DESCRIPTION	T/W 'A' & T/W 'B'	
AIRPORT DESIGN GROUP	B	
TAXIWAY WIDTH	90'	
TAXIWAY SAFETY AREA WIDTH	118'	
TAXIWAY OBJECT FREE AREA WIDTH	188'	

BUILDING DATA TABLE							
BUILDING ID #	DESCRIPTION	BUILDING STA/OFFSET	TOP ELEV (MSL)	HEIGHT ABOVE GRADE SURF (B BLD)	AMOUNT OF PENETRATION	DISPOSITION TO REMAIN	DESTRUCTION MARKING
A	AWSS	126+80 / 512' LT	122.81	32.25	125.42	NONE	NONE
B	SREB	141+04 / 840' LT	122.75	22.95	199.20	NONE	NONE

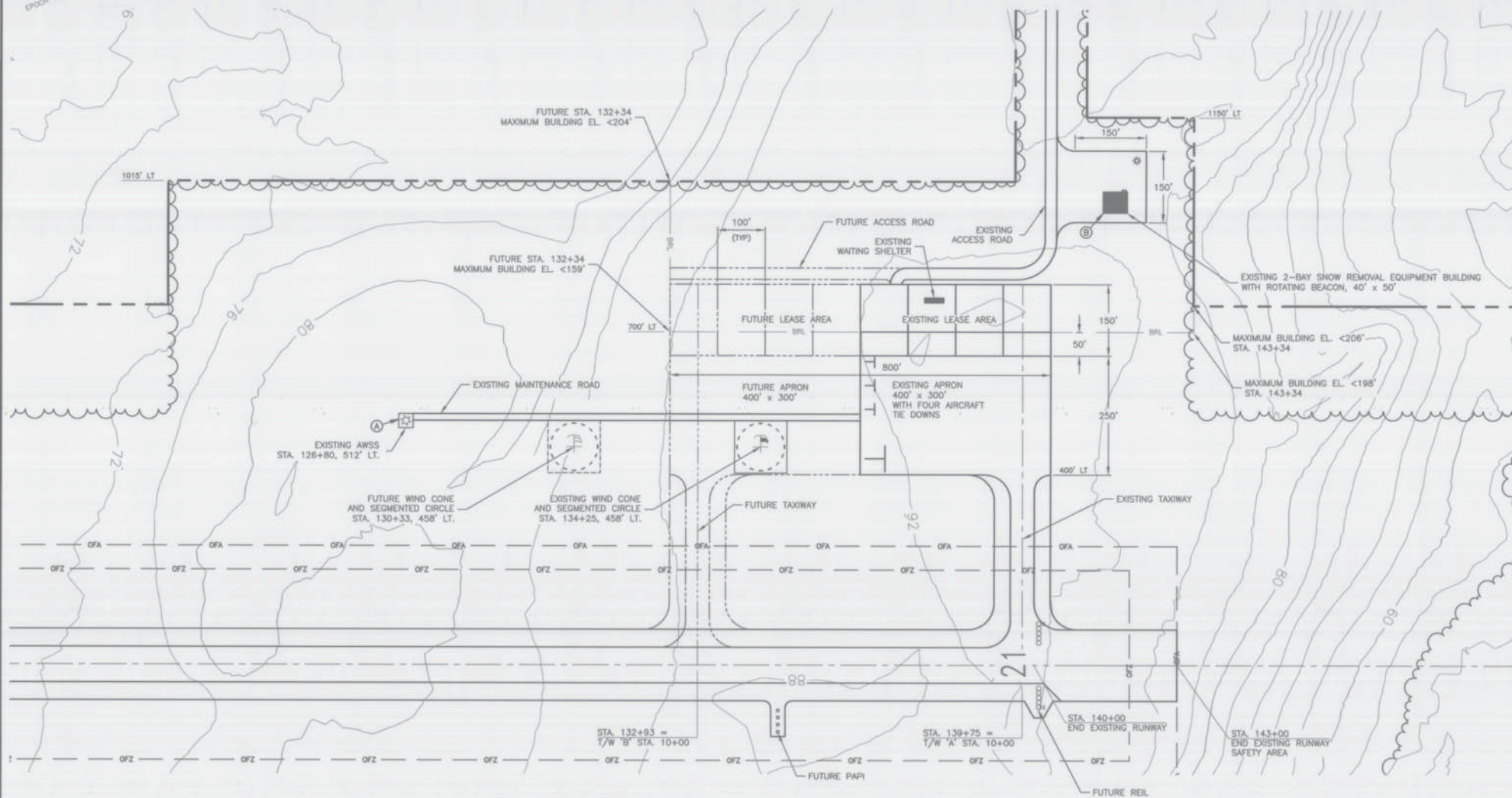

**TERMINAL AREA PLAN**

NO.	DATE	REVISIONS
1	4-2-11	AS-BUILT: UPDATED TO EXISTING CONDITIONS

STATE OF ALASKA  
 DEPARTMENT OF TRANSPORTATION  
 AND PUBLIC FACILITIES  
 CENTRAL REGION

MANOKOTAK AIRPORT  
 MANOKOTAK, ALASKA  
 AIRPORT LAYOUT PLAN  
 TERMINAL AREA PLAN

DATE: JULY 2008  
 SHEET: 6 OF 10

DRAWN BY: J. J. JENSEN, CIVIL ENGINEER  
 CHECKED BY: J. J. JENSEN, CIVIL ENGINEER  
 DATE: 07/20/06

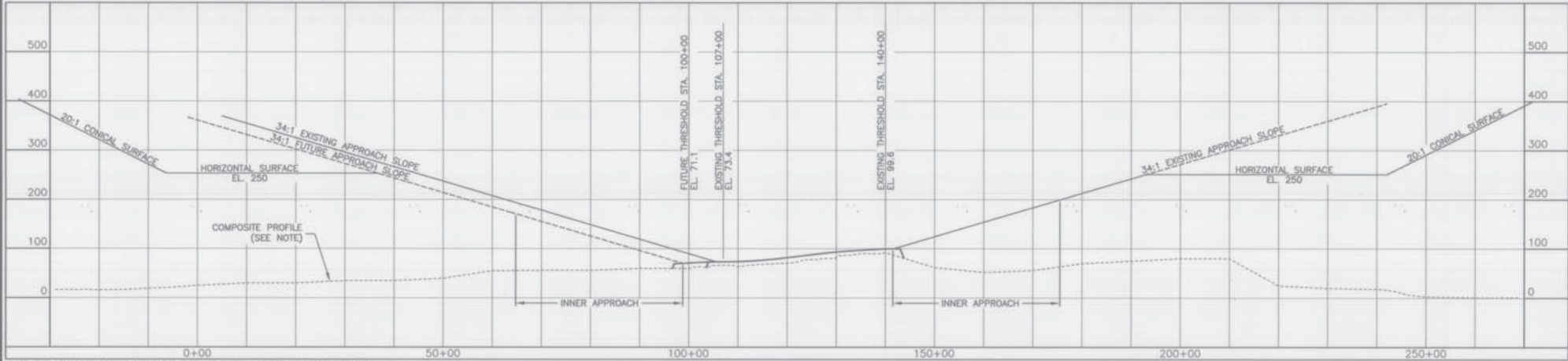

**RUNWAY 03/21 APPROACH PROFILE**

NOTE: THE COMPOSITE PROFILE ALONG THE EXTENDED RUNWAY CENTERLINE REPRESENTS THE HIGHEST TERRAIN ACROSS THE WIDTH AND ALONG THE LENGTH OF THE APPROACH SURFACE.

BY	DATE	REVISIONS
JJS	4-24-11	AS-BUILT: UPDATED TO EXISTING CONDITIONS

STATE OF ALASKA  
 DEPARTMENT OF TRANSPORTATION  
 AND PUBLIC FACILITIES  
 CENTRAL REGION

MANOKOTAK AIRPORT  
 MANOKOTAK, ALASKA  
 AIRPORT LAYOUT PLAN  
 RUNWAY 03/21 APPROACH PROFILES

DATE: JULY 2006  
 SHEET: 7 OF 10

Date Printed: 1/17/2008 1:02 PM  
 Drawn By: J. J. ...  
 Checked By: ...  
 Project Name: ...  
 File Name: ...

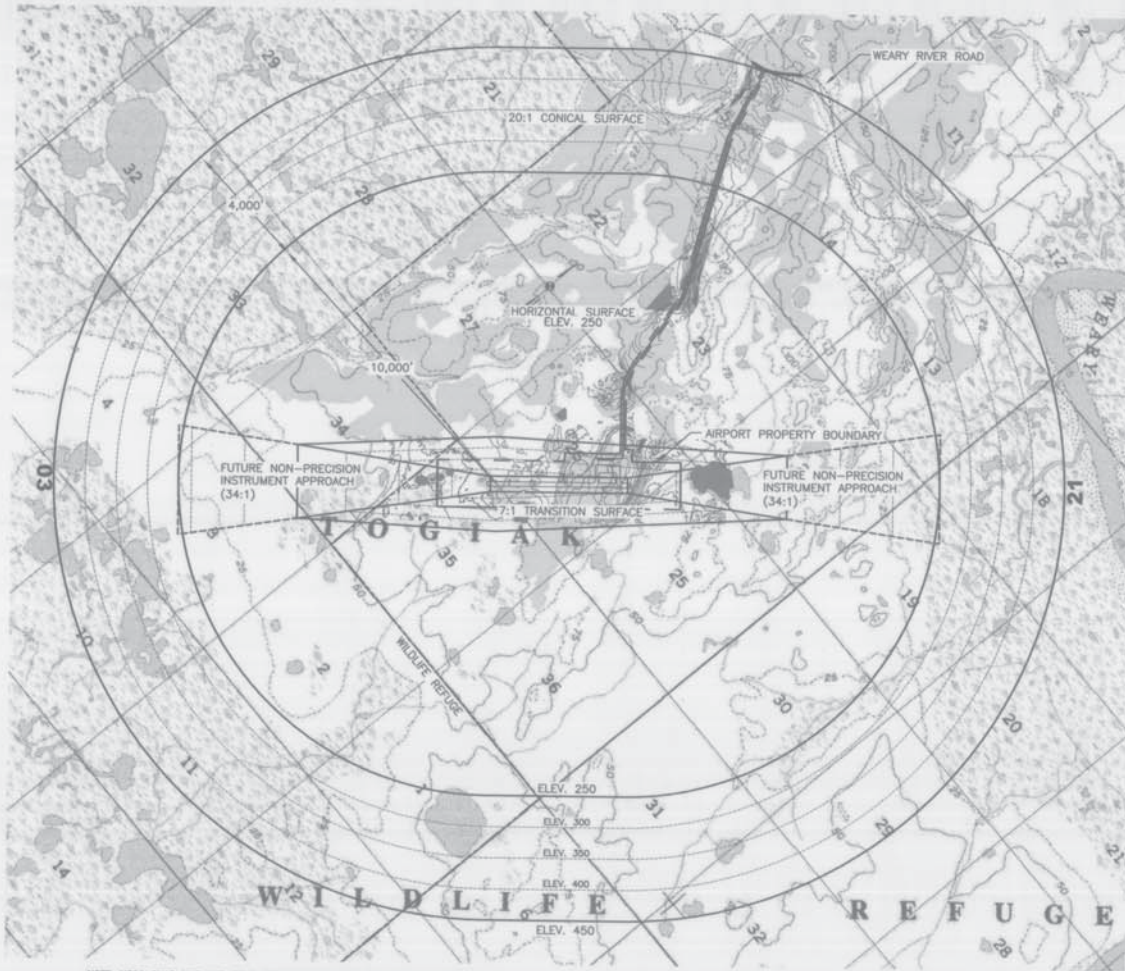

NOTE: USGS QUAD MAP AND FIELD OBSERVATIONS USED FOR AIRSPACE DRAWINGS.



F.A.R. PART 77 OBSTRUCTION TABLE								
OBSTRUCTION ID	DESCRIPTION	OBSTRUCTION STA/OFFSET	OBSTRUCTION ELEVATION	SURFACE PENETRATED	SURFACE ELEVATION	AMOUNT OF PENETRATION	DISPOSITION	STAGE TO BE CORRECTED
	NO KNOWN OBSTRUCTIONS							

THE PRIMARY SURFACE WIDTH IS 500 FEET.

NO.	DATE	REVISIONS
775	4-28-11	AS-BUILT: UPDATED TO EXISTING CONDITIONS

STATE OF ALASKA  
 DEPARTMENT OF TRANSPORTATION  
 AND PUBLIC FACILITIES  
 CENTRAL REGION

MANOKOTAK AIRPORT  
 MANOKOTAK, ALASKA  
 AIRPORT LAYOUT PLAN  
 F.A.R. PART 77 SURFACES

DATE: JULY 2008  
 SHEET: 8 OF 10



PROPERTY STATUS							
ID #	INTEREST	GRANTOR	GRANTEE	PARCEL SIZE	DATE ACQUIRED	RECORDED DOC NO.	ACQUIRED AIP NO.
PARCEL 1	FEE SURFACE	MANOKOTAK NATIVES	STATE OF ALASKA, DOT&PF	329.788 AC	7/25/06	2006-000371-0	3-02-0171-0206
PARCEL 1	FEE SUBSURFACE	BRISTOL BAY NATIVE CORP	STATE OF ALASKA, DOT&PF	329.788 AC	7/25/06	2006-000372-0	3-02-0171-0206

MAG DEC = 1974E FEB 2006  
EPOCH YEAR MAG DEC = 1974E JAN 1, 2010

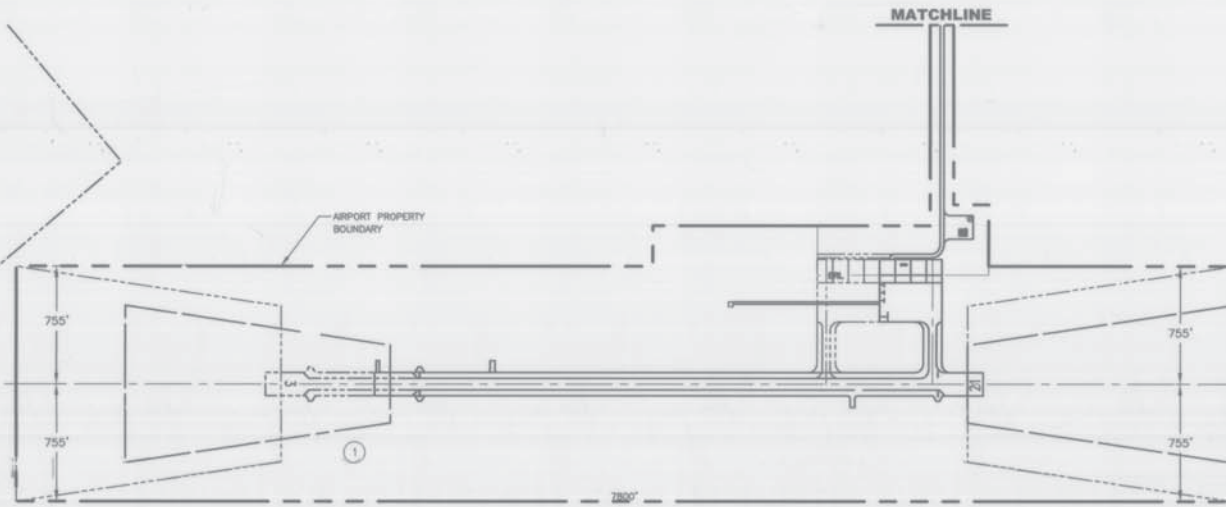

MAG DEC = 1974E FEB 2006  
EPOCH YEAR MAG DEC = 1974E JAN 1, 2010

**PROPERTY MAP**



**NOTES:**

1. THE EXISTING PROPERTY IS SHOWN ON THE EXISTING PROPERTY PLAN (NOT ATTACHED).

12.5	4-26-11	AS-BUILT; UPDATED TO EXISTING CONDITIONS
BY	DATE	REVISIONS

STATE OF ALASKA  
DEPARTMENT OF TRANSPORTATION  
AND PUBLIC FACILITIES  
CENTRAL REGION

MANOKOTAK AIRPORT  
MANOKOTAK, ALASKA  
AIRPORT LAYOUT PLAN  
AIRPORT PROPERTY MAP

DATE: JULY 2006  
SHEET: 10 OF 10

Alaska Planning 12/22/2010 10:38 AM  
 C:\Users\james\Documents\Projects\2010\20100720\20100720.dwg  
 12/22/2010 10:38 AM  
 James  
 12/22/2010 10:38 AM