



U.S. Department
of Transportation

Alaskan Region

222 W. 7th Avenue #14
Anchorage, Alaska
99513-7587

**Federal Aviation
Administration**

March 22, 2011

Butch Douthit, P.E.
Aviation Design Section Chief
Central Region Department of Transportation
and Public Facilities, State of Alaska
P.O. Box 196900
Anchorage, AK 99519-6900

Dear Mr. Douthit:

**Kasigluk Airport
Kasigluk, Alaska
As-Built Airport Layout Plan
2010-AAL-230-NRA**

We have completed our review of the Kasigluk Airport As-Built Airport Layout Plan (ALP), and find it acceptable for documenting the existing conditions of the airport. We look forward to working with you on identifying and addressing future needs at the airport.

Please attach this letter to the enclosed ALP and retain it in your files for future use

Sincerely,

A handwritten signature in blue ink, appearing to read "Pat Oien".

Pat Oien, P.E., Airport Planner
Airports Division

Enclosure: Kasigluk Airport ALP

FILE NO. 222-10-1

DESIGNED BY: [Signature]
 CHECKED BY: [Signature]
 DATE: 3/21/11



LEGEND		
ITEM	EXISTING	ULTIMATE
AIRPORT REFERENCE POINT (ARP)	○	●
AREAS	□	■
BLUFF	—	—
BUILDINGS	—	—
BUILDING RESTRICTION LINE (BRL)	—	—
FENCE	—	—
PAPI	—	—
PROPERTY LINE	—	—
SEE	—	—
ROADWAYS	—	—
ROTATING BEACON	—	—
SHORELINE	—	—
SURVEY MONUMENT	—	—
THRESHOLD MARKERS/LIGHTS	—	—
TOPOGRAPHIC CONTOURS	—	—
TREE (LARGE SINGLE)	—	—
TREELINE	—	—
VAS	—	—
WIND CONE	—	—
WIND CONE AND SEGMENTED CIRCLE	—	—

GEOGRAPHIC COORDINATES TABLE				
ITEM	EXISTING LATITUDE	EXISTING LONGITUDE	ULTIMATE LATITUDE	ULTIMATE LONGITUDE
ARP	62°52'24.05" N	162°31'47.50" W		
THRESHOLD RW 17	62°52'38.71" N	162°31'24.15" W		
THRESHOLD RW 35	62°52'08.35" N	162°31'30.81" W		

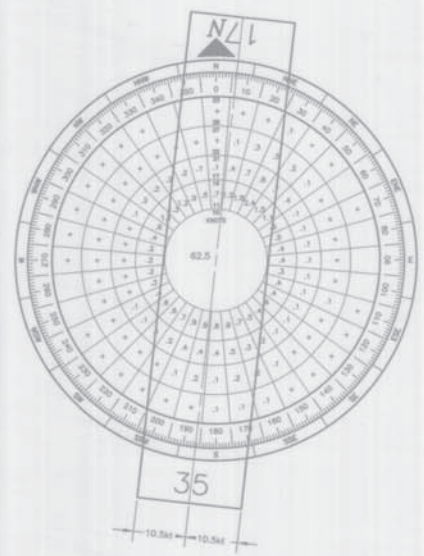

WIND DATA TABLE				
RUNWAY	10.5 kt	13 kt	16 kt	20 kt
17/35	63.09			

SOURCE: NATIONAL CLIMATIC DATA CENTER IS FOR BETHEL, ALASKA WHICH IS LOCATED 24 MILES SOUTHEAST OF KASIGLUK. PERIOD 2000-2009

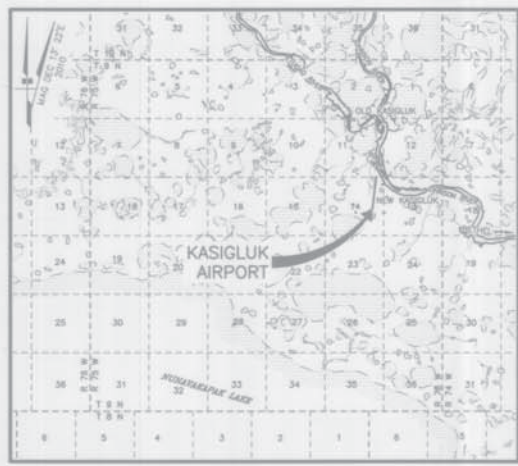

VICINITY MAP
 SEC. 02, T 9 N, R 75 W,
 SEWARD MERIDIAN
 U.S.G.S. 6480 INLET (D-2), ALASKA



AIRPORT DATA		
ITEM	EXISTING	ULTIMATE
ICAO IDENTIFIER	PAAC	
NATIONAL AIRPORT IDENTIFIER	209	
FMA SITE NUMBER	50455.5*	
AIRPORT ELEVATION MAF/BS	47.9'	
AIRPORT REFERENCE CODE	A-1	
MEAN MAX. TEMPERATURE, HOTTEST MONTH	63.1° JULY	
AIRPORT AND TERMINAL NAVIGATION AIDS	ROTATING BEACON	
TAXIWAY LIGHTING/MARKING	M/NONE	
OBSTRUCTION SURVEY SOURCE & TYPE	NONE	
MAGNETIC DECLINATION, YEAR, RATE OF CHANGE	1722' E 2010	0'11" W / YEAR

RUNWAY 17/35 DATA			
ITEM	EXISTING	NEAR TERM	ULTIMATE
RUNWAY TYPE	UTILITY OR OTHER THAN UTILITY		UTILITY
FAR PART 77 APPROACH CATEGORY (X, Y, Z, P)			V-X
APPROACH SURFACES	3017 / 3011		
VISIBILITY MINIMUM	1SM		
RUNWAY SURFACE	GRAVEL		
PAVEMENT STRENGTH (K1/1000) (K15/1000)	N/A		
AIRCRAFT APPROACH CATEGORY	A		
AIRPLANE CLOSURE GROUP	1		
MEAN GEODETIC BEARING	HP16°37.6'E		
EFFECTIVE GRADE	0.66%		
TOUCHDOWN ELEVATION MAF/BS (ESTIMATED)	47.9' / 47.9'		
RUNWAY DIMENSIONS	897 x 3400'		
RUNWAY SAFETY AREA (RSA) DIMENSIONS	120' x 3400'		
LENGTH BEYOND R/W END	240' / 240'		
RUNWAY PROTECTION ZONE (RPZ) DIMENSIONS	500' x 700' x 1000'		
RUNWAY OBSTACLE FREE AREA (OFA) DIMENSIONS	250' x 3400'		
LENGTH BEYOND R/W END OR STOPWAY	240' / 240'		
RUNWAY OBSTACLE FREE ZONE (OFZ) DIMENSIONS	250' x 3400'		
RUNWAY LIGHTING	M		
RUNWAY MARKING TYPE	NONE		
RUNWAY VISUAL APPROACH AIDS	NONE		

DRAWING INDEX		STATE OF ALASKA DEPARTMENT OF TRANSPORTATION AND PUBLIC FACILITIES CENTRAL REGION	
SHT #	TITLE	KASIGLUK AIRPORT KASIGLUK, ALASKA AIRPORT LAYOUT PLAN DATE: 02/18/2011 SHEET: 1 of 5	
1	DATA		
2	EXISTING LAYOUT		
3	EXISTING INNER PORTION OF THE APPROACH SURFACE		
4	AIRPORT AIRSPACE, 14 CFR, PART 77		
5	AIRPORT PROPERTY MAP		
BY / DATE	REVISION	APPROVED: [Signature] RECOMMENDED: [Signature] HARVEY B. SOUTH, P.E. DESIGN SECTION CHIEF	
AIRPORT LAYOUT PLAN CONDITIONAL APPROVAL SUBJECT TO ALP APPROVAL LETTER DATED 3/26/11 FMA AIRSPACE REVIEW NUMBER 2010-ML-230-N/A DATE: 3/26/11 FAA, AIRPORTS DIVISION ALASKAN REGION, AAL-621			

STATE OF ALASKA, DEPT. OF TRANSPORTATION AND PUBLIC FACILITIES
 PROJECT NO. 2010-101-02
 SHEET NO. 2 OF 5
 DATE: 02/16/2011

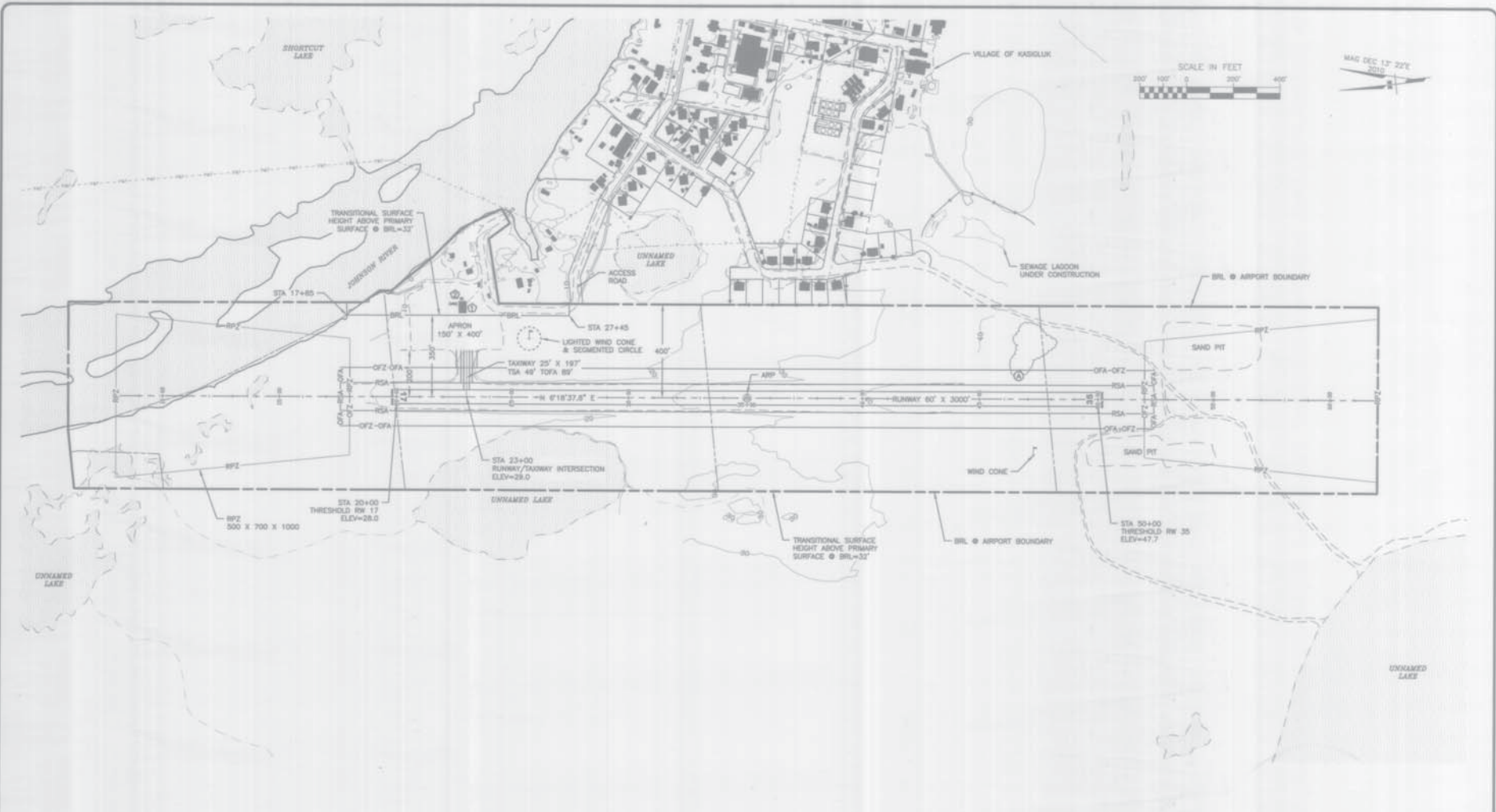

BUILDING DATA TABLE				
ID #	DESCRIPTION	STATION/OFFSET	TOP ELEV (NAVD85)	OBSTRUCT MARKING
01	SHE BUILDING	25+82/362 LT	41	NONE
02	ELECTRICAL ENCLOSURE	25+78/417 LT	32	NONE

OFZ PENETRATIONS		
ID #	DESCRIPTION	DISPOSITION
01	BRUSH	REMOVE

NOTES:
 1. 10' TOPOGRAPHIC CONTOURS PROVIDED BY THE ALASKA DEPT. OF COMMUNITY, COMMERCE AND ECONOMIC DEVELOPMENT ARE AVAILABLE FOR ONLY PART OF THE AIRPORT.

BY	DATE	REVISION

STATE OF ALASKA
DEPARTMENT OF TRANSPORTATION
AND PUBLIC FACILITIES
CENTRAL REGION

KASIGLUK AIRPORT
 KASIGLUK, ALASKA
 AIRPORT LAYOUT PLAN
 EXISTING LAYOUT

DATE	02/16/2011
SHEET	2 of 5

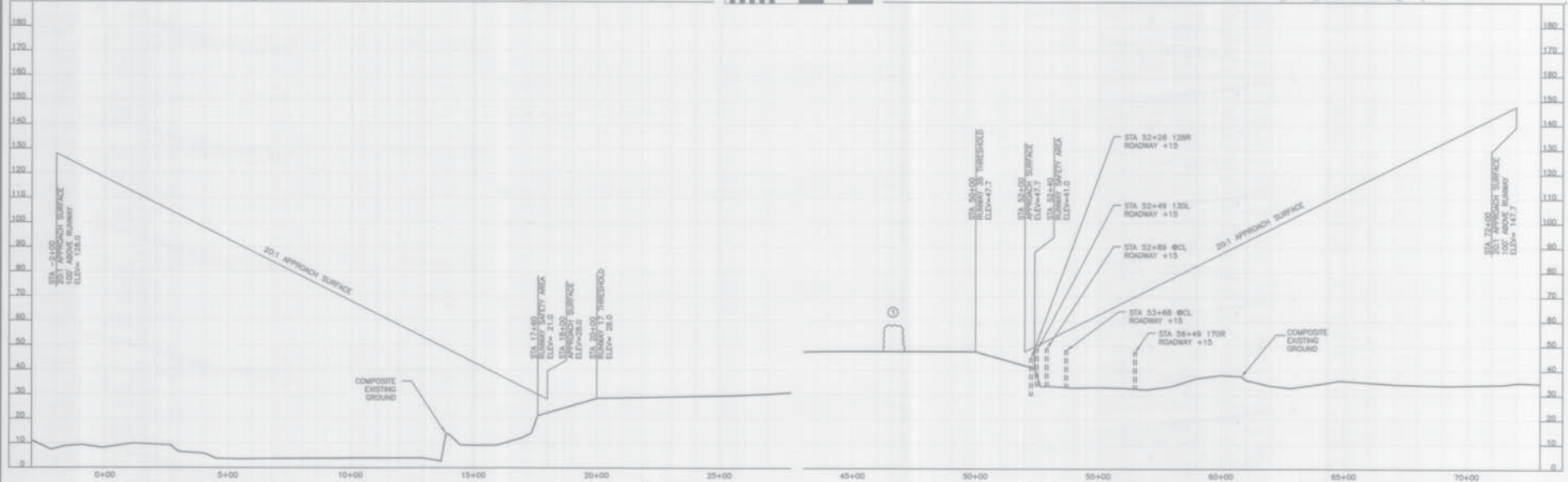
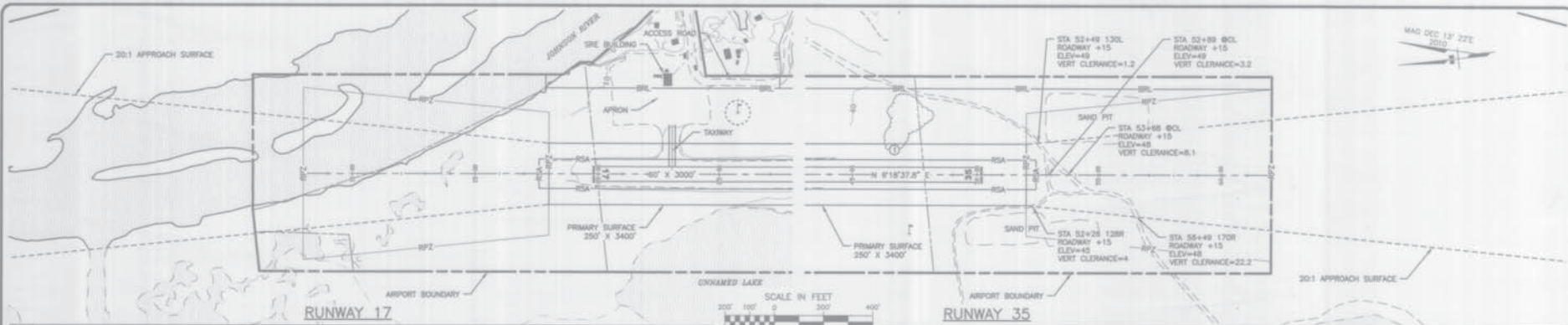

RUNWAY 17

ID #	DESCRIPTION	STATION/OFFSET	ELEVATION	SURFACE PENETRATED	SURFACE ELEVATION	AMOUNT OF PENETRATION	DISPOSITION	STAGE TO CORRECT
	NONE							

NOTE: REFER TO THE AIRPORT AIRSPACE DRAWING FOR PENETRATIONS OF THE OUTER APPROACH SURFACES.

NOTES:

- THERE ARE NO OBSTRUCTIONS IN THE APPROACH TO RUNWAY 17, THEREFORE THE OBSTRUCTION CLEARANCE SLOPE IS ESTABLISHED AS 50:1 PER FAA AC 150/5200-35, SECTION 4, DATA ELEMENT NUMBER 57.
- THERE ARE NO OBJECT PENETRATIONS IN THE RUNWAY APPROACH END SLOPE SURFACE OF RUNWAY 17, AS DEFINED IN FAA AC 150/5300-13, CHG 13, APPENDIX 2, TABLE A2-1, LINE 5.

RUNWAY 35

ID #	DESCRIPTION	STATION/OFFSET	ELEVATION	SURFACE PENETRATED	SURFACE ELEVATION	AMOUNT OF PENETRATION	DISPOSITION	STAGE TO CORRECT
(1)	BRUSH	48+55/10.3L	58.0	PRIMARY	47.7	11	REMOVE	ULTIMATE

NOTE: REFER TO THE AIRPORT AIRSPACE DRAWING FOR PENETRATIONS OF THE OUTER APPROACH SURFACES.

NOTES:

- THERE ARE NO OBSTRUCTIONS IN THE APPROACH TO RUNWAY 35, THEREFORE THE OBSTRUCTION CLEARANCE SLOPE IS ESTABLISHED AS 50:1 PER FAA AC 150/5200-35, SECTION 4, DATA ELEMENT NUMBER 57.
- THERE ARE NO OBJECT PENETRATIONS IN THE RUNWAY APPROACH END SLOPE SURFACE OF RUNWAY 35, AS DEFINED IN FAA AC 150/5300-13, CHG 13, APPENDIX 2, TABLE A2-1, LINE 5.

BY	DATE	REVISION

**STATE OF ALASKA
DEPARTMENT OF TRANSPORTATION
AND PUBLIC FACILITIES
CENTRAL REGION**

KASIGLUK AIRPORT
KASIGLUK, ALASKA
AIRPORT LAYOUT PLAN

EXISTING INNER PORTION OF THE APPROACH SURFACE

DATE: 02/15/2011
SHEET: 3 OF 5

Project No. 12742(01) - 032.00
 Contract No. 12742(01) - 032.00
 Contract No. 12742(01) - 032.00
 Contract No. 12742(01) - 032.00

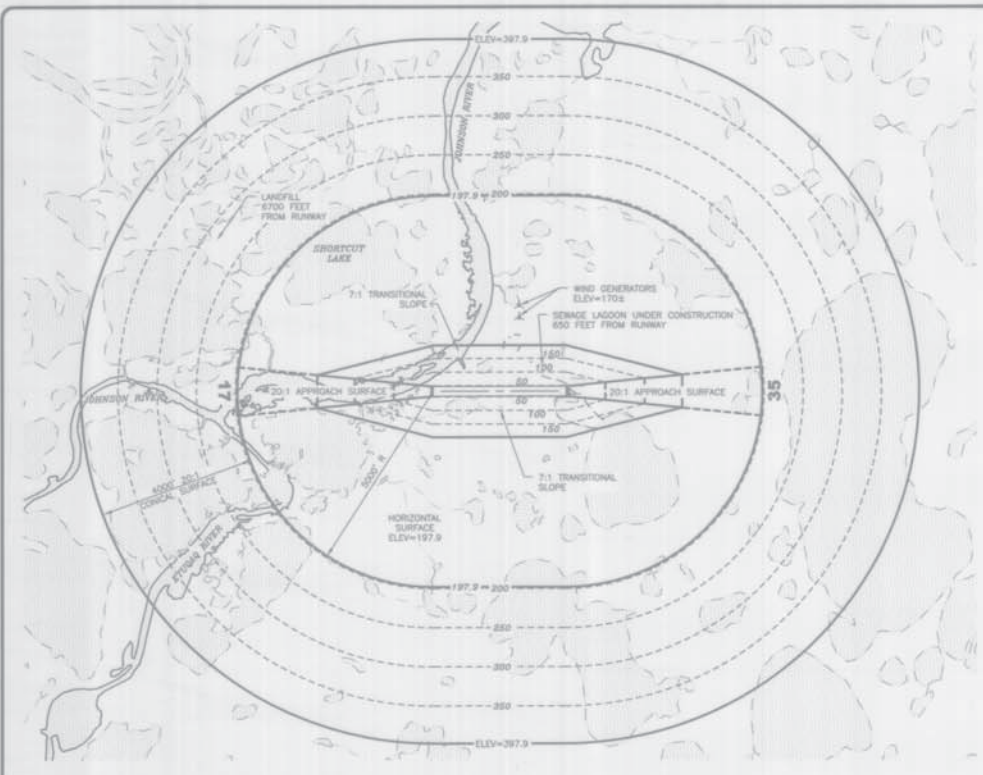

RUNWAY 17/35

PART 77 SURFACE OBSTRUCTIONS (OUTER PORTION)								
ID #	DESCRIPTION	STATION/OFFSET	ELEVATION	SURFACE PENETRATED	SURFACE ELEVATION	AMOUNT PENETRATION	DISPOSITION	STAGE TO CORRECT
	NONE							



NOTES

1. AIRPORT ELEVATION IS 47.9'.
2. ALL CONTOURS ARE IN FEET. BASEMAP DATA IS FROM USGS QUAD 64RD 94ET (0-2). USGS DATUM IS WGS84.
3. PRIMARY SURFACE WIDTH IS 250'.
4. A RANGE FINDER WITH A BUILT-IN INCHMETER WAS USED TO IDENTIFY OBSTRUCTIONS CLOSE TO THE RUNWAY IN THE PRIMARY AND TRANSITIONAL SURFACES.
5. REFER TO INNER PORTION OF THE APPROACH SURFACE DRAWING FOR CLOSE-IN OBSTRUCTIONS.
6. LANDFILL LOCATED 6700' FROM NEAREST POINT ON THE RUNWAY. THE SEWAGE LAGOON UNDER CONSTRUCTION IS LOCATED 650' FROM THE NEAREST POINT ON THE RUNWAY.
7. THERE ARE NO KNOWN ORDINANCES OR STATUTES IN EFFECT THAT SPECIFY HEIGHT RESTRICTIONS.
8. APPROACH SURFACES ARE 20:1 BEGINNING AT 200 FEET BEYOND THE THRESHOLDS.

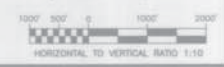
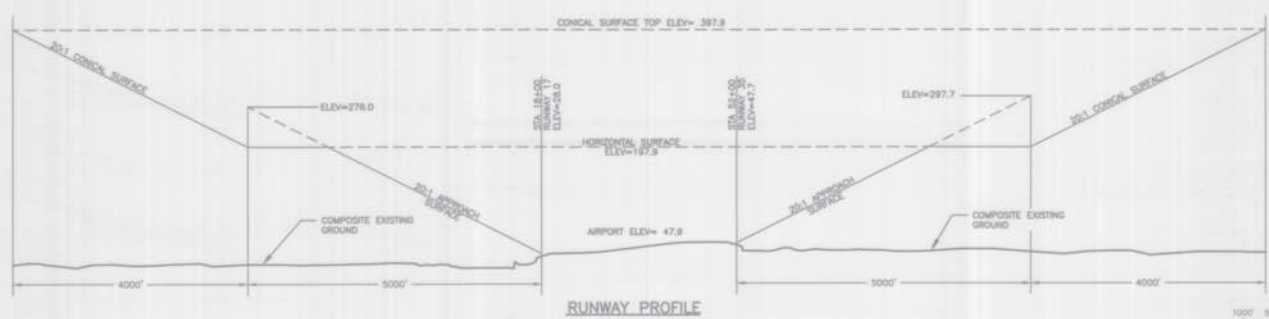

STATE OF ALASKA
DEPARTMENT OF TRANSPORTATION
AND PUBLIC FACILITIES
CENTRAL REGION

KASIGLUK AIRPORT
 KASIGLUK, ALASKA
 AIRPORT LAYOUT PLAN
 AIRPORT AIRSPACE
 14 CFR, PART 77

DATE: 02/18/2011
 SHEET: 4 OF 5

DRAWN BY: J. J. JONES
 CHECKED BY: J. J. JONES
 DATE: 12/20/2011
 FILE NO.: 233-101-4
 PROJECT: KASIGLUK AIRPORT LAYOUT PLAN

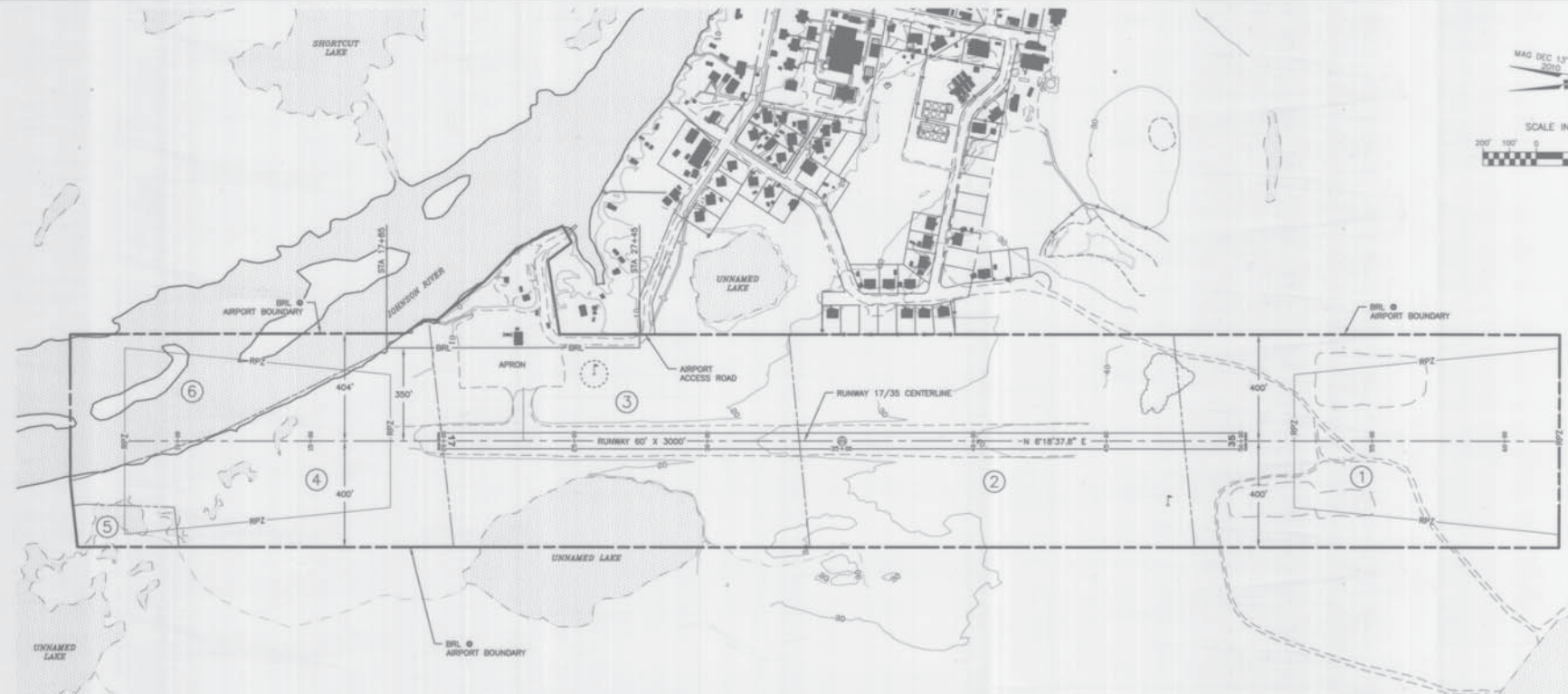

LEGEND	
	AIRPORT PROPERTY BOUNDARY
	PARCEL BOUNDARY

NOTES:
 1. THIS DRAWING WAS PREPARED FROM THE 1997 AIRPORT LAYOUT PLAN.

PROPERTY STATUS							
ID #	INTEREST	GRANTOR	GRANTEE	PARCEL SIZE	DATE ACQUIRED	RECORDED DOC NO.	ACQUIRED AIP NO.
1	FEE SIMPLE	NELLIE SLIM	STATE OF ALASKA, DOT/PF	160.0 ac ±	1/24/97	BK 74 PG 475	3-02-0341-01
2	FEE SIMPLE	RENE NICHOLAS	STATE OF ALASKA, DOT/PF	79.02 ac ±	1/24/97	BK 74 PG 483	3-02-0341-01
3	FEE SIMPLE	ANNA NECK	STATE OF ALASKA, DOT/PF	80.0 ac ±	1/24/97	BK 74 PG 487	3-02-0341-01
4	FEE SIMPLE	JOAN NECK	STATE OF ALASKA, DOT/PF	80.0 ac ±	1/24/97	BK 74 PG 479	3-02-0341-01
5	LL.M.A.	STATE OF ALASKA, DNR	STATE OF ALASKA, DOT/PF	LARGE	2/5/97		
6	LL.M.A.	STATE OF ALASKA, DNR	STATE OF ALASKA, DOT/PF	LARGE	2/5/97		

BY	DATE	REVISION

STATE OF ALASKA
DEPARTMENT OF TRANSPORTATION
AND PUBLIC FACILITIES
 CENTRAL REGION

KASIGLUK AIRPORT KASIGLUK, ALASKA AIRPORT LAYOUT PLAN AIRPORT PROPERTY MAP	DATE: 02/16/2011
	SHEET: 5 of 5