

FILE No.: 232-101-1
 Date Plotted: 1/27/2011, 1:08 PM
 Layout Name: DATA (1)
 File Name: P:\Projects\059422\0594225\Hooper Bay\HOOPER-BAY-ALP.dwg
 Designed By: mlawlyn
 Drawn By: mbauer
 Checked By: blanson

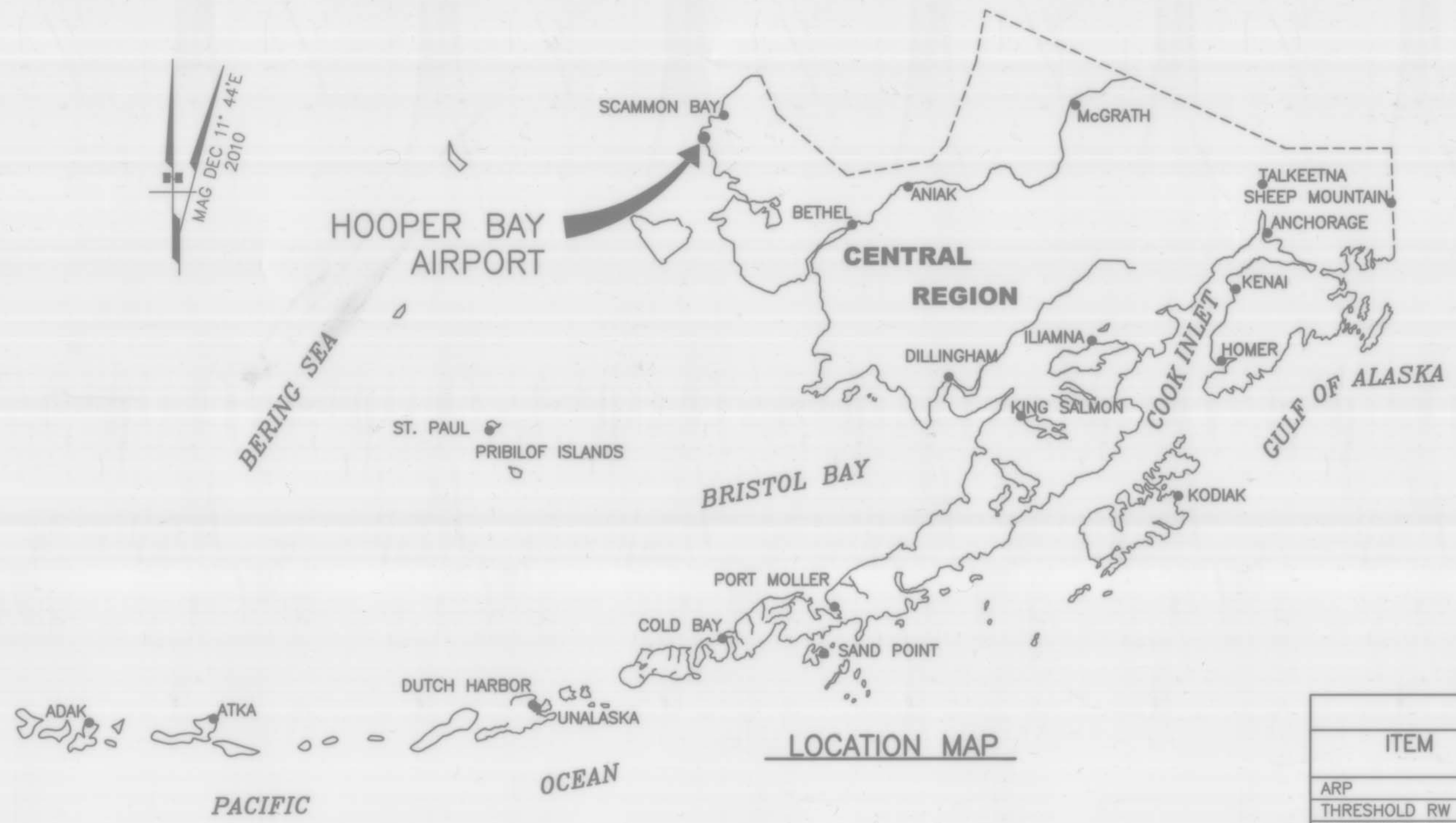

LEGEND		
ITEM	EXISTING	ULTIMATE
AIRPORT REFERENCE POINT (ARP)		
ANTENNA		
BLUFF		
BUILDINGS		
BUILDING RESTRICTION LINE (BRL)		
FENCE		
PAPI		
PROPERTY LINE		
REIL		
ROADWAYS		
ROTATING BEACON		
SHORELINE		
SURVEY MONUMENT		
THRESHOLD MARKERS/LIGHTS		
TOPOGRAPHIC CONTOURS		
TREE (LARGE SINGLE)		
TREELINE		
VASI		
WIND CONE		
WIND CONE AND SEGMENTED CIRCLE		

AIRPORT DATA		
ITEM	EXISTING	ULTIMATE
ICAO IDENTIFIER	PAHP	
NATIONAL AIRPORT IDENTIFIER	HPB	
FAA SITE NUMBER	50322.*A	
AIRPORT ELEVATION NAVD88	12.8'	
AIRPORT REFERENCE CODE	B-II	
MEAN MAX. TEMPERATURE, HOTTEST MONTH	53°F, JULY	
AIRPORT AND TERMINAL NAVIGATION AIDS	ROTATING BEACON	
	VOR/DME	
	GPS	
TAXIWAY LIGHTING/MARKING	MITL	
OBSTRUCTION SURVEY SOURCE & TYPE	NONE	
MAGNETIC DECLINATION, YEAR, RATE OF CHANGE	11°44'E / 2010	-0°12'(W) / YEAR

GEOGRAPHIC COORDINATES TABLE				
ITEM	EXISTING LATITUDE	EXISTING LONGITUDE	ULTIMATE LATITUDE	ULTIMATE LONGITUDE
ARP	61°31'25.94"N	166°08'47.85"W		
THRESHOLD RW 13	61°31'39.81"N	166°09'05.55"W		
THRESHOLD RW 31	61°31'12.06"N	166°08'30.15"W		

RUNWAY 13/31 DATA			
ITEM	EXISTING	NEAR TERM	ULTIMATE
RUNWAY TYPE UTILITY OR OTHER THAN UTILITY	UTILITY		
FAR PART 77 APPROACH CATEGORY (V, NPI, P)	NPI / NPI		
APPROACH SURFACES	20:1 / 20:1		
VISIBILITY MINIMUM	1 SM		
RUNWAY SURFACE	ASPHALT-GRAVEL		
PAVEMENT STRENGTH SW,DW,DTW,DDTW x1000lbs	25 S; 42 D		
AIRCRAFT APPROACH CATEGORY	B		
AIRPLANE DESIGN GROUP	II		
MEAN GEODETIC BEARING	N 31°20'54.61" W		
EFFECTIVE GRADE	0.018%		
TOUCHDOWN ELEVATION NAVD88 (ESTIMATED)	12.8' / 12.8'		
RUNWAY DIMENSIONS	75' x 3300'		
RUNWAY SAFETY AREA (RSA) DIMENSIONS	150' x 3900'		
LENGTH BEYOND R/W END	300' / 300'		
RUNWAY PROTECTION ZONE (RPZ) DIMENSIONS	500' x 700' x 1000'		
RUNWAY OBJECT FREE AREA (OFA) DIMENSIONS	500' x 3900'		
LENGTH BEYOND R/W END OR STOPWAY	300' / 300'		
RUNWAY OBSTACLE FREE ZONE (OFZ) DIMENSIONS	250' x 3700'		
RUNWAY LIGHTING	MIRL		
RUNWAY MARKING TYPE	NON-PRECISION		
RUNWAY VISUAL APPROACH AIDS	VASI, ODALS		

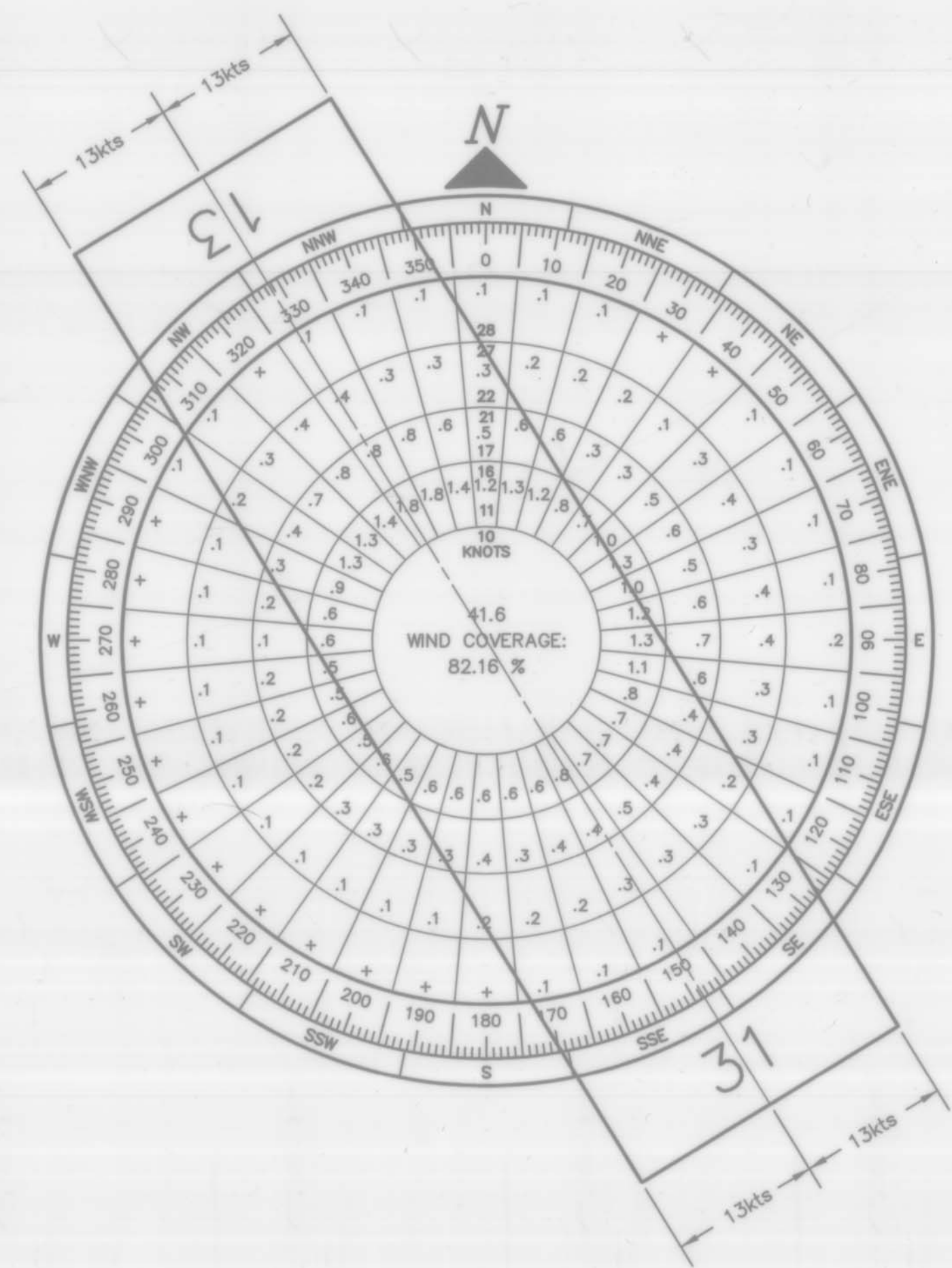

WIND DATA TABLE				
RUNWAY	10.5 kt	13 kt	16 kt	20 kt
13/31	73.17	82.16		

SOURCE: NATIONAL CLIMATIC DATA CENTER
 PERIOD: 2000-2009

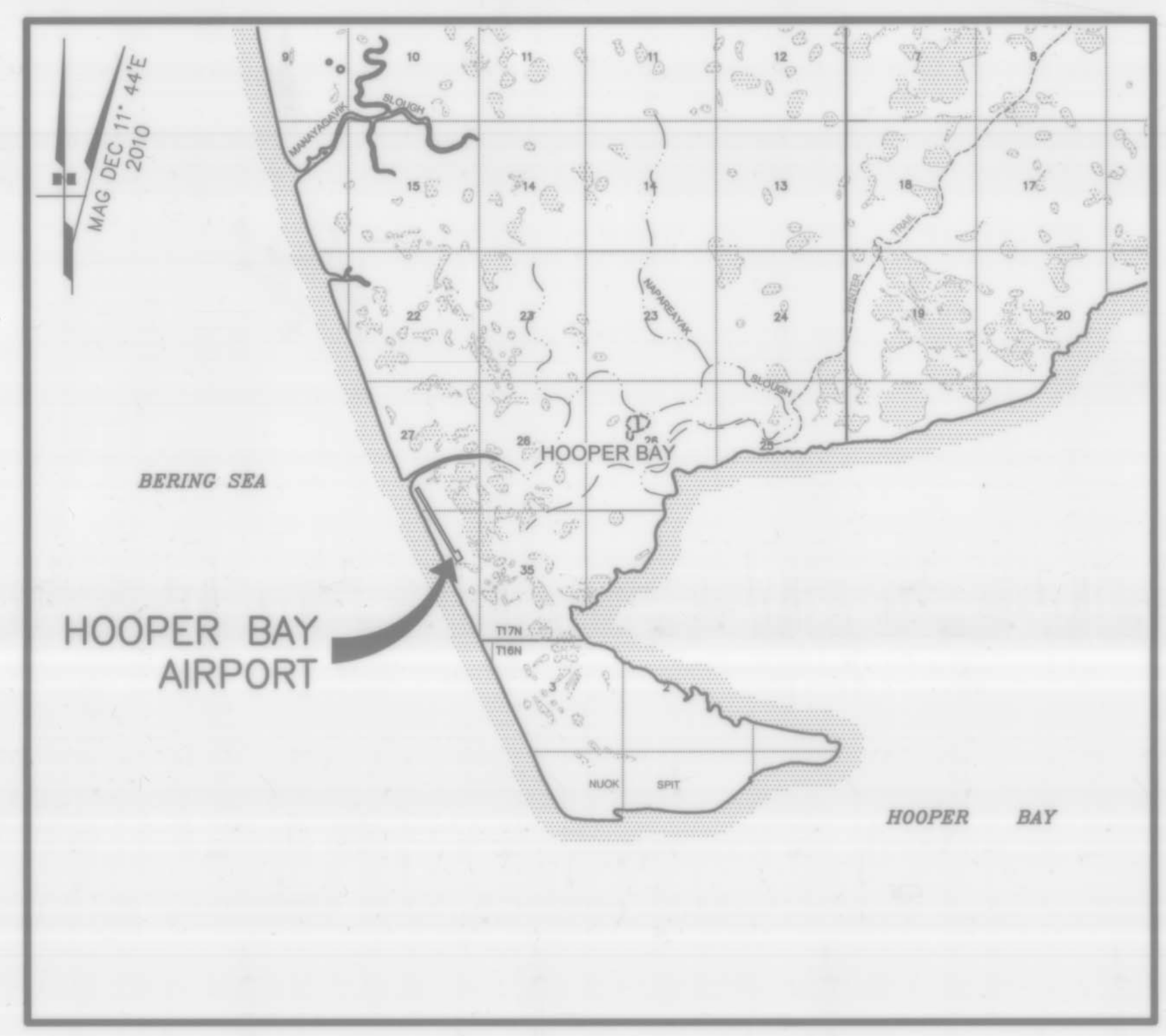

VICINITY MAP
 SECTIONS 26,27,34,35
 T16N, R93W, AND T17N, R93W, SEWARD MERIDIAN, ALASKA.
 U.S.G.S. HOOPER BAY (C-3) AND (C-4)

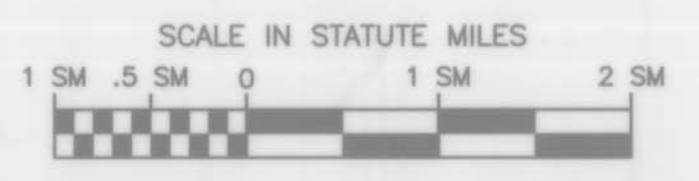

DRAWING INDEX	
SHT #	TITLE
1	DATA
2	EXISTING LAYOUT
3	EXISTING INNER PORTION OF THE APPROACH SURFACE
4	AIRPORT AIRSPACE, 14 CFR, PART 77
5	AIRPORT PROPERTY MAP

BY DATE	REVISION
APPROVED: <i>[Signature]</i>	DATE: 2/23/2011
RECOMMENDED: <i>[Signature]</i>	DATE: 2/23/2011
HARVEY M. DOUTHIT, P.E.	DESIGN SECTION CHIEF

STATE OF ALASKA DEPARTMENT OF TRANSPORTATION AND PUBLIC FACILITIES CENTRAL REGION	
HOOPER BAY AIRPORT HOOPER BAY, ALASKA AIRPORT LAYOUT PLAN	
DATE: 1/27/2011	SHEET: 1 OF 5

AIRPORT LAYOUT PLAN CONDITIONAL APPROVAL SUBJECT TO ALP APPROVAL LETTER DATED 2/21/11 FAA AIRSPACE REVIEW NUMBER: 2010-AAL-214PKA	
DATE: 3-21-11	621

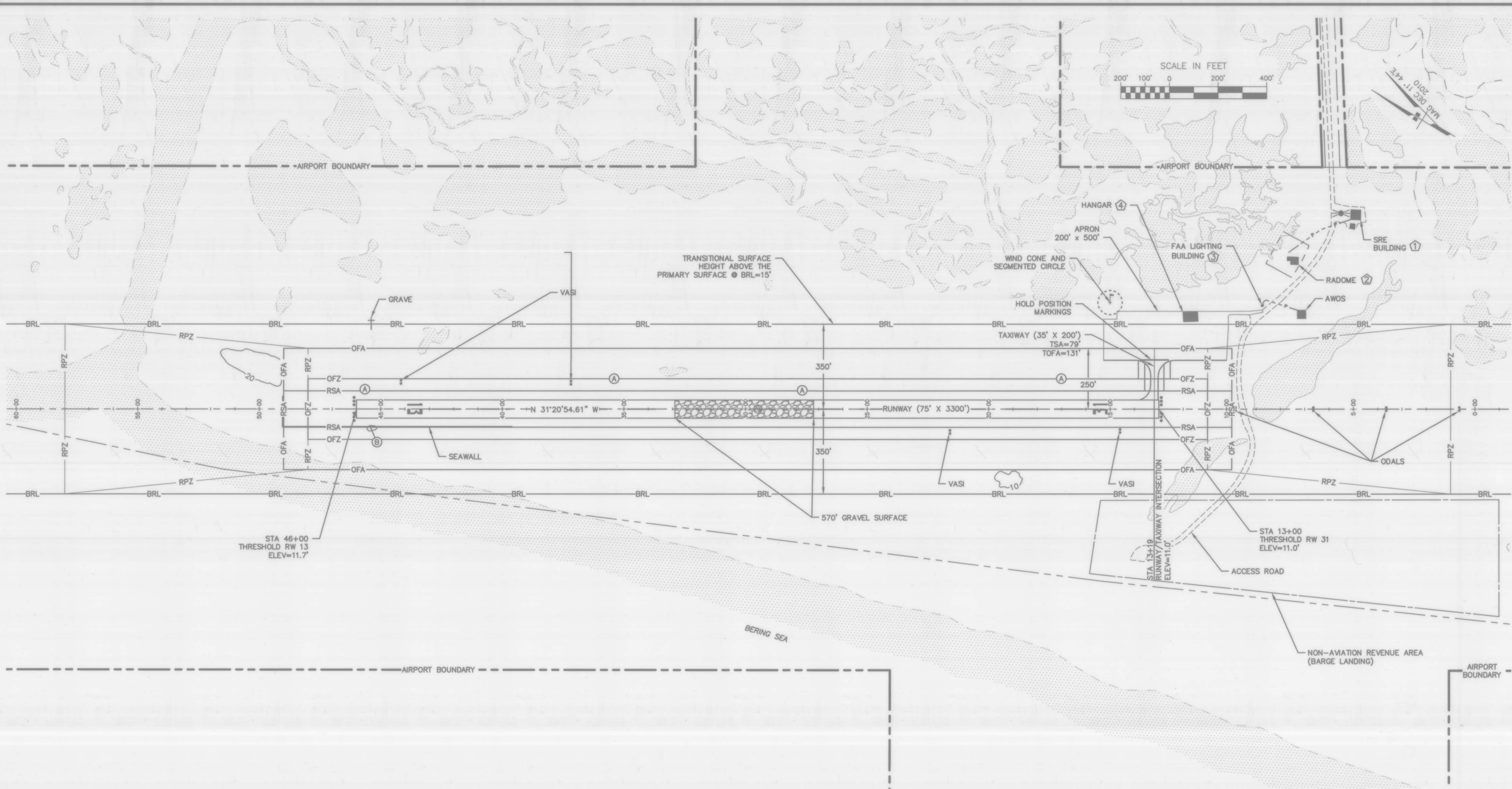

OFZ PENETRATIONS		
ID #	DESCRIPTION	DISPOSITION
(A)	GROUND 1'-3' ABOVE RUNWAY ELEVATION ENTIRE RUNWAY LENGTH	REMOVE
(B)	GROUND 5' ABOVE RUNWAY ELEVATION	REMOVE

BUILDING DATA TABLE				
ID #	DESCRIPTION	STATION/OFFSET	TOP ELEV (NAVD88)	OBSTRUCT MARKING
1	SRE BUILDING	4+90/782' RT	21' (EST)	NONE
2	RADOME	7+42/598' RT	24' (EST)	NONE
3	FAA LIGHTING BUILDING	8+74/423' RT	15' (EST)	NONE
4	HANGAR	11+70/360' RT	27'	NONE

NOTES:
 1. TOPOGRAPHIC CONTOUR DATA NOT AVAILABLE.
 2. RUNWAY MARKINGS WILL NEED TO BE UPDATED FROM 13/31 TO 14/32 DUE TO CHANGES IN MAGNETIC DECLINATION.

BY	DATE	REVISION

**STATE OF ALASKA
 DEPARTMENT OF TRANSPORTATION
 AND PUBLIC FACILITIES
 CENTRAL REGION**

HOOPER BAY AIRPORT
 HOOPER BAY, ALASKA
 AIRPORT LAYOUT PLAN
 EXISTING LAYOUT

DATE: 1/27/2011
 SHEET: 2 OF 5

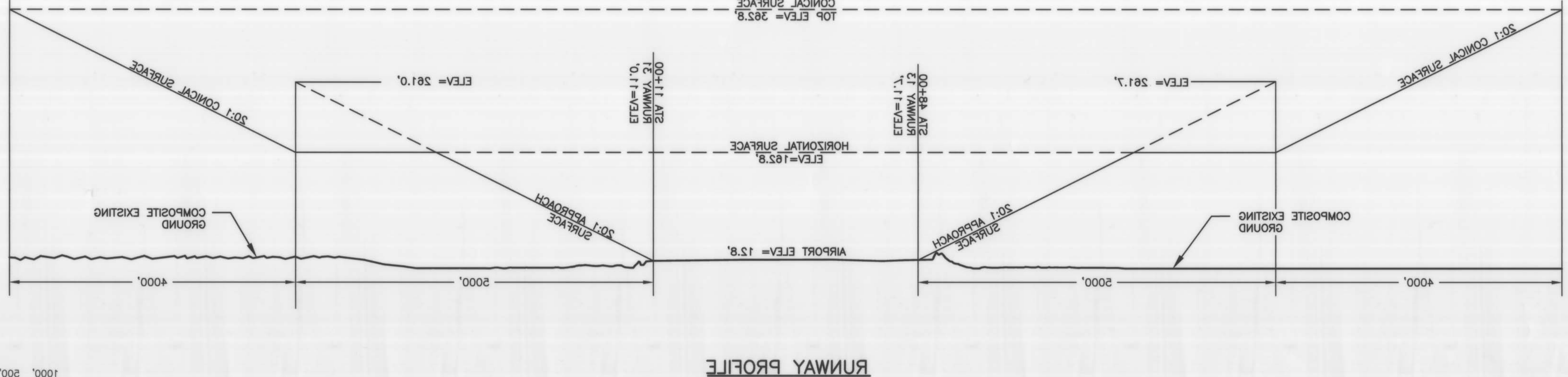
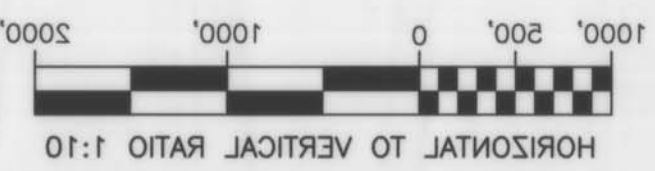

RUNWAY PROFILE

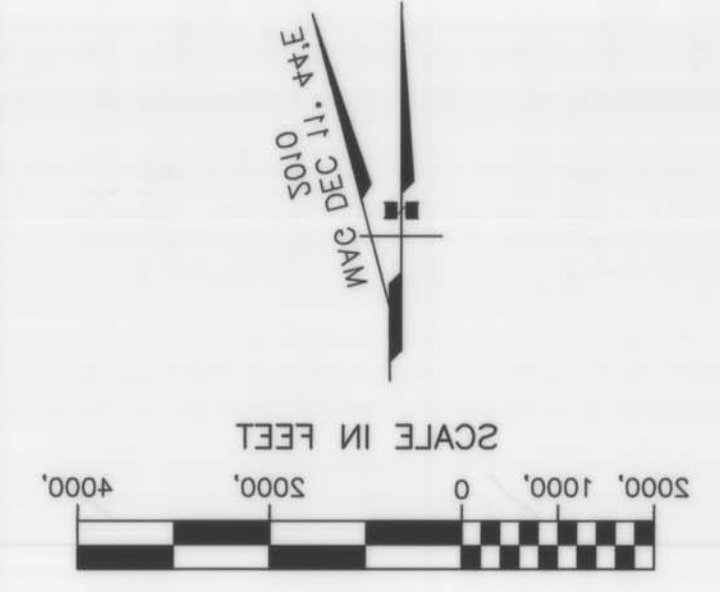
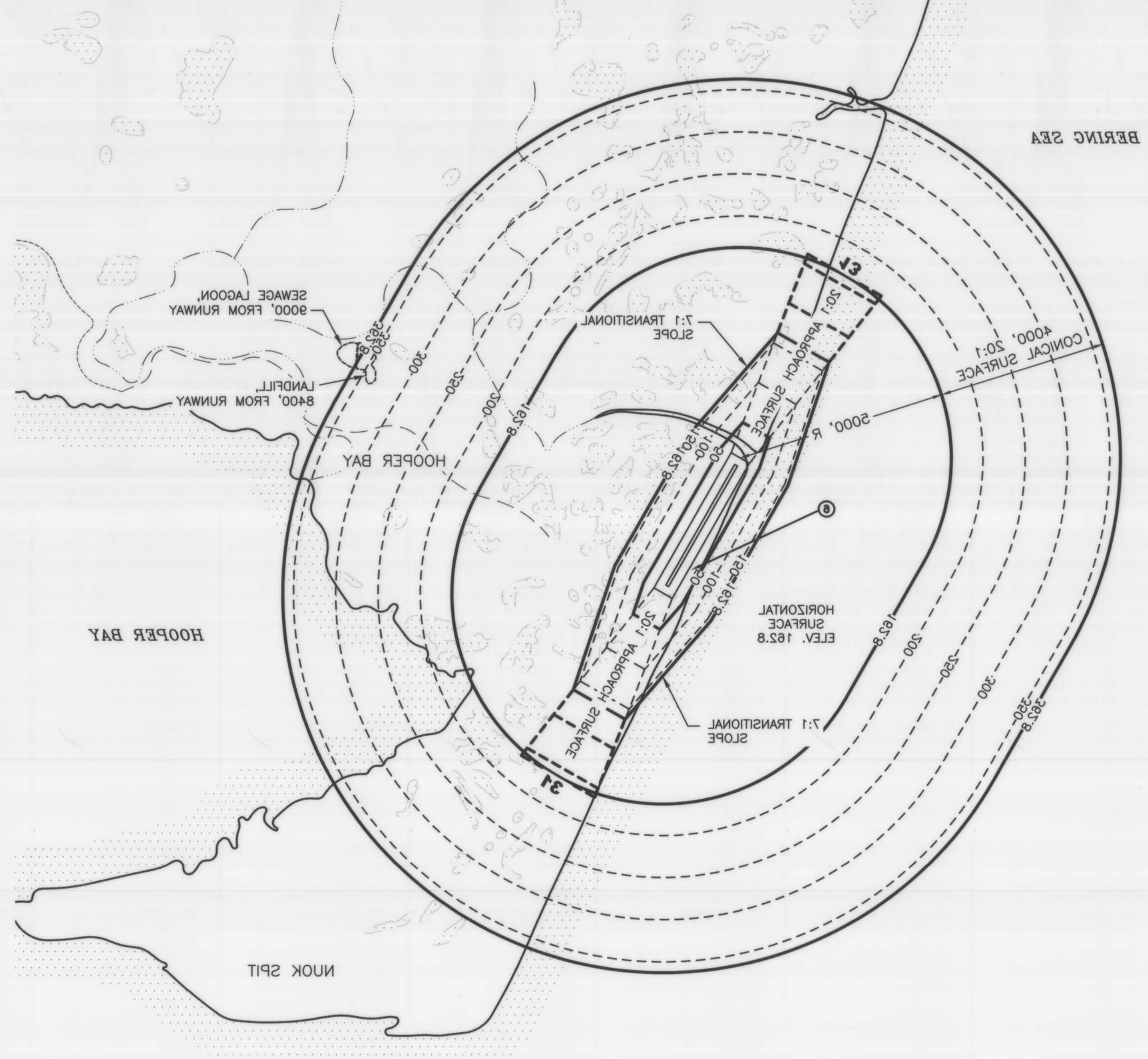

NOTES

1. AIRPORT ELEVATION IS 12.8'.
2. ALL CONTOURS ARE IN FEET. BASEMAP DATA IS FROM USGS QUADS HOOPER BAY (C-3, C-4). USGS DATUM IS WGS84.
3. PRIMARY SURFACE WIDTH IS 500'.
4. A RANGE FINDER WITH A BUILT-IN INCLINOMETER WAS USED TO IDENTIFY OBSTRUCTIONS CLOSE TO THE RUNWAY IN THE PRIMARY AND TRANSITIONAL SURFACES.
5. REFER TO INNER PORTION OF THE APPROACH SURFACE DRAWING FOR CLOSE-IN OBSTRUCTIONS.
6. THE LANDFILL IS LOCATED 8400' FROM THE NEAREST POINT ON THE RUNWAY. THE SEWAGE LAGOON IS LOCATED 9000' FROM THE NEAREST POINT ON THE RUNWAY.
7. THERE ARE NO KNOWN ORDINANCES OR STATUTES IN EFFECT THAT SPECIFY HEIGHT RESTRICTIONS.
8. APPROACH SURFACES ARE 20:1 BEGINNING AT 200 FEET BEYOND THE THRESHOLDS.

PART 77 SURFACE OBSTRUCTION TABLE (OUTER PORTION RW)

ID #	DESCRIPTION	STATION / OFFSET	ELEVATION	PENETRATED SURFACE	SURFACE AMOUNT	DISPOSITION
(a)	GROUND	19+30\283' TL	2+8'	TRANSITIONAL	13.9'	REMOVE

RUNWAY 13\31

FILE No.: 232-101-5
 Designed By: mllwllhyn
 Drawn By: Bodulim
 Checked By: Dharson
 Date Plotted: 1/27/2011, 1:08 PM
 Layout Name: P:\V\projects\059422\Hooper Bay\Hooper Bay\HOOPER-BAY-ALP.dwg
 File Name:

MATCHLINE THIS SHEET

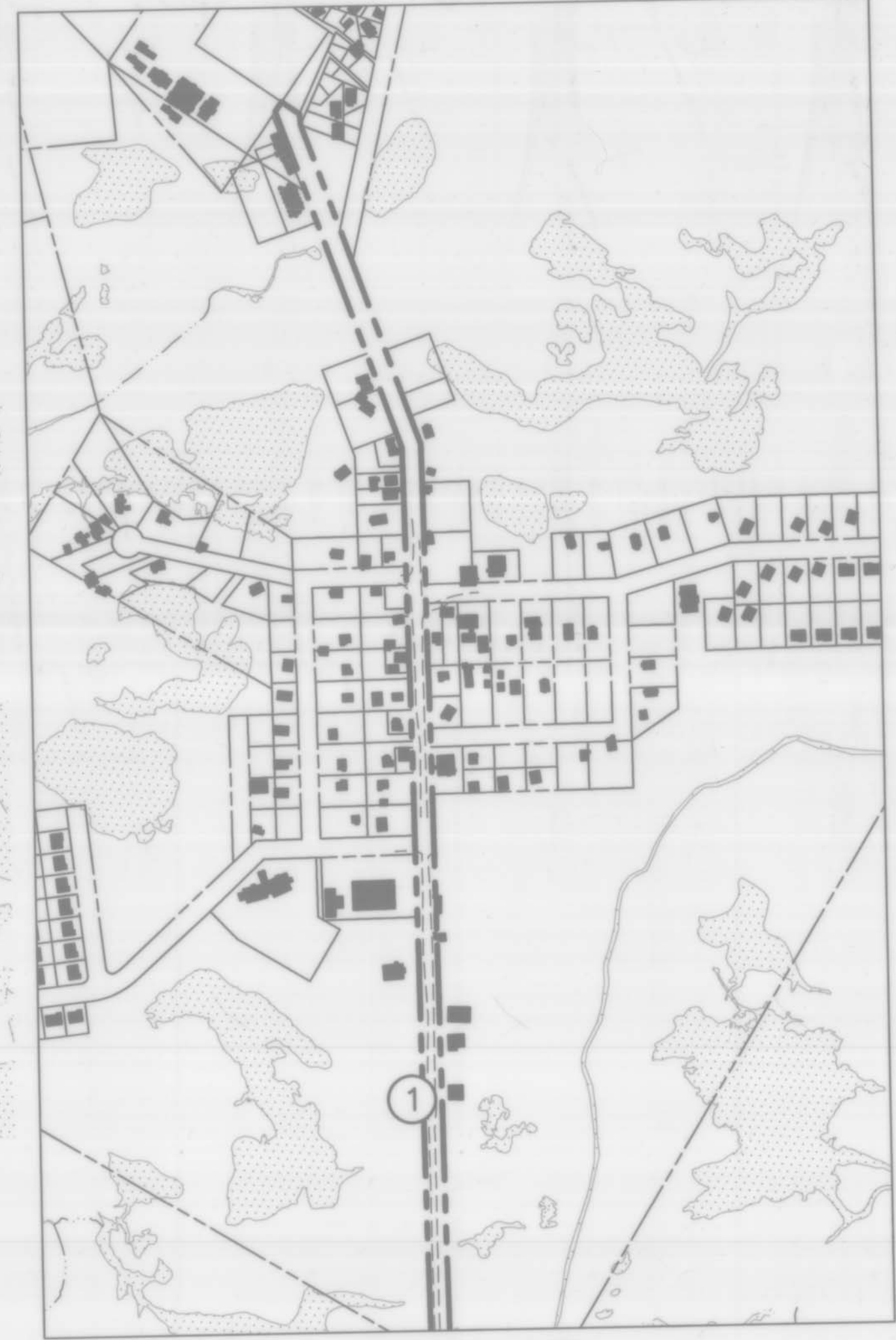
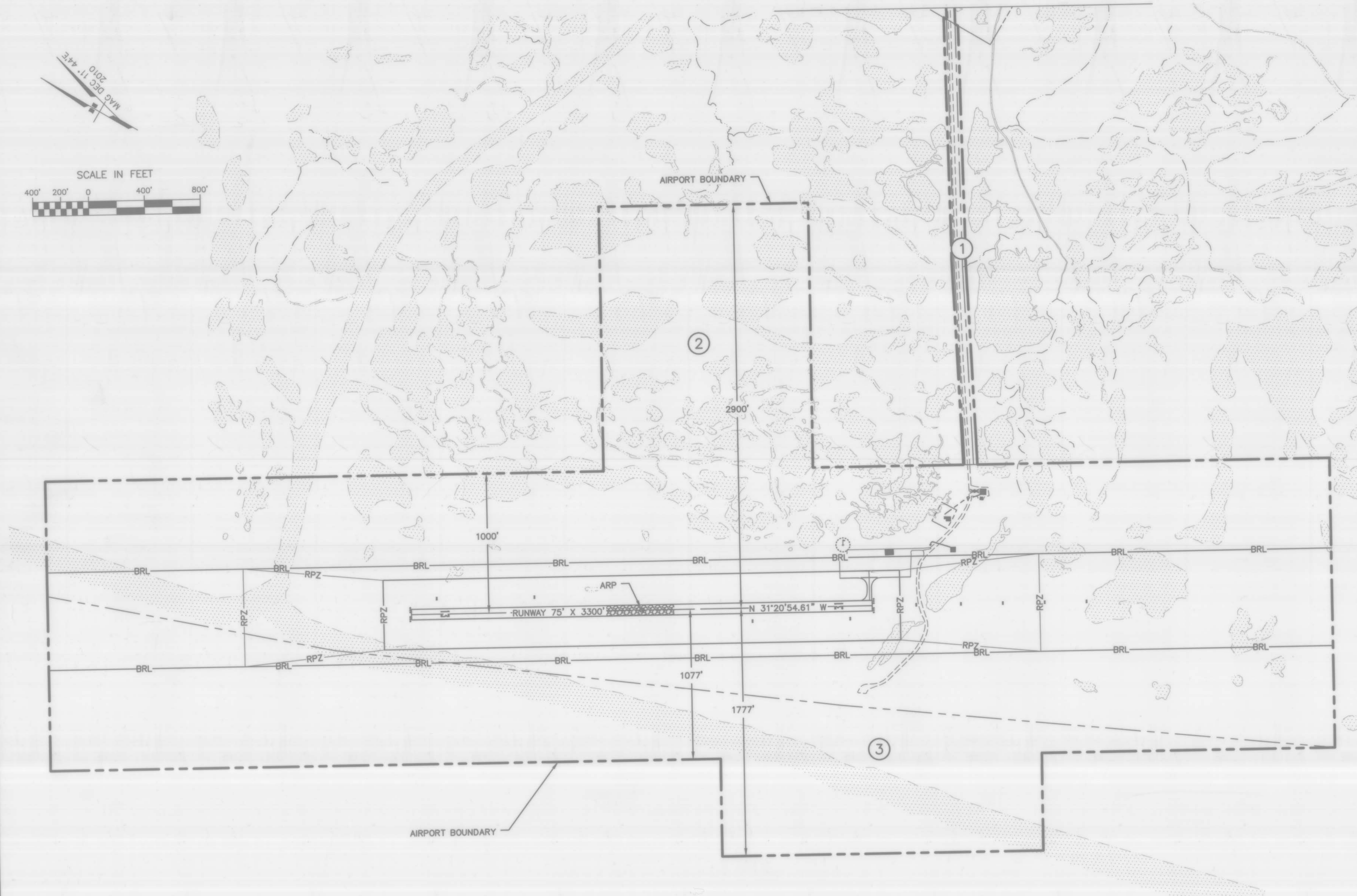
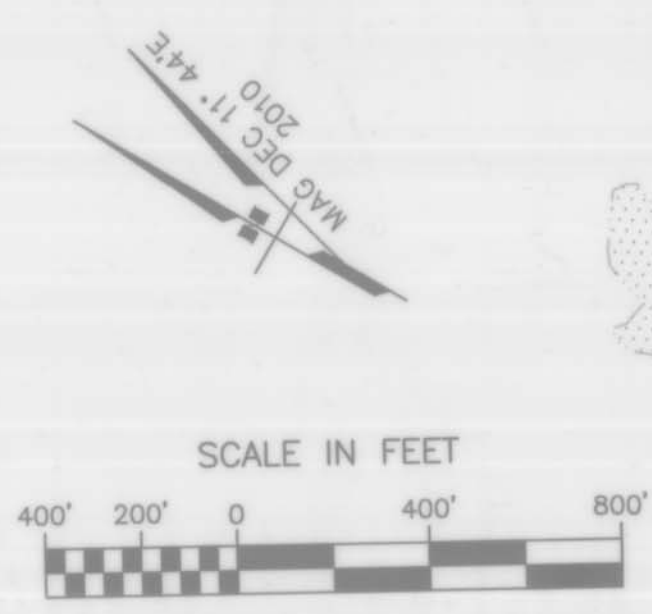

LEGEND	
	AIRPORT PROPERTY BOUNDARY
	PARCEL BOUNDARY

- NOTES:**
- THIS DRAWING WAS PREPARED FROM THE SURVEY CONTROL DIAGRAM DATED 7/6/2005, THE PROPERTY PLAN DATED 3/15/1972, REVISED ON 4/11/1975, AND DCCED MAPPING PREPARED MAY 2007.
 - ID#1 INCLUDES BOTH THE 60' AND 100' WIDTH PARCELS. THE 60' PARCEL EXTENDS INTO HOOPER BAY PER PREVIOUS PROPERTY PLAN AND DCCED MAPPING. THE 100' PARCEL ENDS AS SHOWN HERE PER THE 2005 SCD.

PROPERTY STATUS							
ID #	INTEREST	GRANTOR	GRANTEE	PARCEL SIZE	DATE ACQUIRED	RECORDED DOC NO.	ACQUIRED AIP NO.
1	60' ROW-EIN 9 C5	STATE OF ALASKA	STATE OF ALASKA, DOT/PF	16.96 ac ±	11/18/58		
1	100' ROW-RST 93 (RS2477)	STATE OF ALASKA	STATE OF ALASKA, DOT/PF	390.62 ac ±	4/14/64		2005-001109-0
2	Fed. Patent-#1235732	US of A, DOI	STATE OF ALASKA, DOT/PF	150.47 ac ±	2/2/73	BK 27 PG 410	
3	ILMT	STATE OF ALASKA, DNR	STATE OF ALASKA, DOT/PF				

BY	DATE	REVISION

**STATE OF ALASKA
 DEPARTMENT OF TRANSPORTATION
 AND PUBLIC FACILITIES
 CENTRAL REGION**

HOOPER BAY AIRPORT
 HOOPER BAY, ALASKA
 AIRPORT LAYOUT PLAN
 AIRPORT PROPERTY MAP

DATE: 1/27/2011
 SHEET: 5 OF 5