



U.S. Department
of Transportation

Alaskan Region

222 W. 7th Avenue #14
Anchorage, Alaska
99513-7587

**Federal Aviation
Administration**

May 16, 2012

Butch Douthit, P.E.
Aviation Design Chief
Central Region Department of Transportation
and Public Facilities, State of Alaska
P.O. Box 196900
Anchorage AK 99519

Dear Mr. Douthit:

**Akutan Airport
Akutan Alaska
Airport Layout Plan Conditional Approval
2011-AAL-14-NRA**

We have completed our review of the Akutan Airport Layout Plan (ALP), and find it acceptable from a planning standpoint.

The conditional approval indicated by my signature is given subject to the condition that the proposed airport development that requires environmental processing shall not be undertaken without prior written environmental approval by the FAA.

This approval considers only the safety, utility, and efficiency of the airport.

This approval does not represent a commitment to provide financial assistance to implement the proposed plan. FAA assistance in any development or its approval for any development will be determined at the time of request, based on the existing regulations, project justification, and eligibility at the time of the request.

Please attach this letter to the enclosed ALP and retain it in your files for future use.

If you have any questions, please contact me at 271-5445.

Sincerely,

Pat Oien, P.E., Airport Planner
Airports Division

Enclosure: Akutan ALP

Date: 04/27/12
 Drawn by: [Signature]
 Checked by: [Signature]
 Date: 04/27/12
 Drawn by: [Signature]
 Checked by: [Signature]

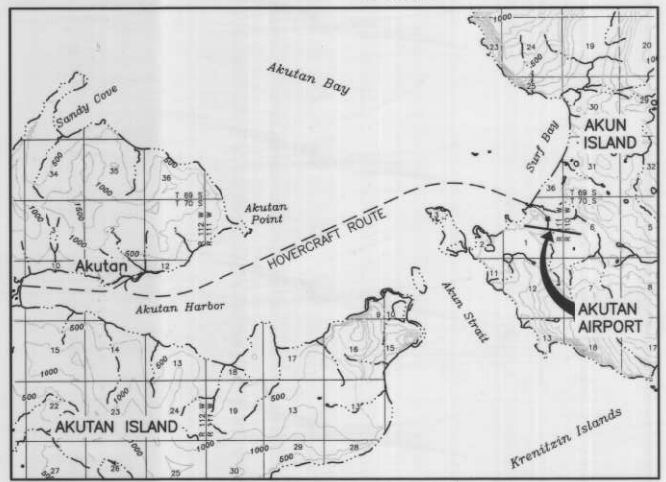

ITEM	LEGEND		
	EXISTING	NEAR TERM	ULTIMATE
AIRPORT REFERENCE POINT (A.R.P.)	(Symbol)	(Symbol)	(Symbol)
ANTENNA	(Symbol)	(Symbol)	(Symbol)
BLUFF	(Symbol)	(Symbol)	(Symbol)
BUILDINGS	(Symbol)	(Symbol)	(Symbol)
BUILDING RESTRICTION LINE	(Symbol)	(Symbol)	(Symbol)
FENCE	(Symbol)	(Symbol)	(Symbol)
PAPI	(Symbol)	(Symbol)	(Symbol)
PROPERTY LINE	(Symbol)	(Symbol)	(Symbol)
REL.	(Symbol)	(Symbol)	(Symbol)
ROADWAYS	(Symbol)	(Symbol)	(Symbol)
ROTATING BEACON	(Symbol)	(Symbol)	(Symbol)
SHORELINE, WATERWAY	(Symbol)	(Symbol)	(Symbol)
SURVEY MONUMENT	(Symbol)	(Symbol)	(Symbol)
THRESHOLD MARKERS/LIGHTS	(Symbol)	(Symbol)	(Symbol)
TOPOGRAPHIC CONTOURS	(Symbol)	(Symbol)	(Symbol)
TREELINE	(Symbol)	(Symbol)	(Symbol)
VASI	(Symbol)	(Symbol)	(Symbol)
WIND CONE	(Symbol)	(Symbol)	(Symbol)
WIND CONE AND SEGMENTED CIRCLE	(Symbol)	(Symbol)	(Symbol)
HATCH REPRESENTING LAKE	(Symbol)	(Symbol)	(Symbol)

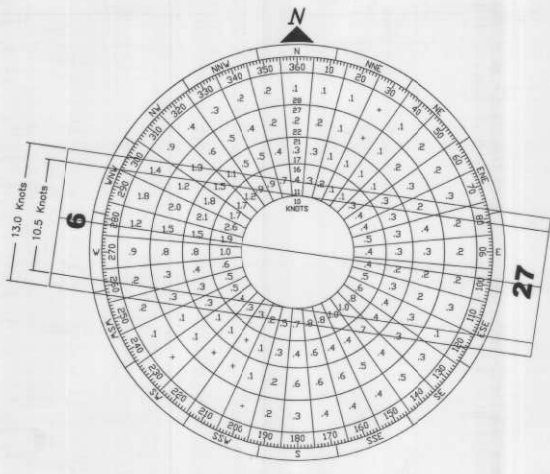

WIND DATA TABLE	10.5 kt	13 kt
9/27	69.2%	78.1%

SOURCE: WISALA MARKS001 AUTOMATIC WEATHER STATION
 INSTALLED AND MAINTAINED BY HDR ALASKA, INC.
 PERIOD: 6/3/2005 THRU 8/10/2007
 EXCEPT FOR THE PERIOD 8/10/2005 THRU
 9/28/2005 WHEN COWS KNOCKED THE TOWER DOWN

AIRPORT DATA TABLE			
ITEM	NEAR TERM	ULTIMATE	
ICAO IDENTIFIER			
NATIONAL AIRPORT IDENTIFIER			
FAA SITE NUMBER	50022.1A	50022.1A	
AIRPORT ELEVATION NAVOB8	133.0'	133.0'	
AIRPORT REFERENCE CODE	8-II	8-II	
MEAN MAX. TEMPERATURE, HOTTEST MONTH	60°F JULY	60°F JULY	
AIRPORT AND TERRAIN NAVIGATION AIDS	ROTATING BEACON	ROTATING BEACON	
TAXIWAY LIGHTING/MARKING	LOC & DME	LOC & DME	
OBSTRUCTION SURVEY SOURCE & TYPE	MIL	MIL	
MAGNETIC DECLINATION, YEAR, RATE OF CHANGE	11°06'E, OCT 1, 2010; 0'10"W/YR		

- NOTES:
 1. ALL ELEVATIONS PROVIDED IN THIS AIRPORT LAYOUT PLAN ARE BASED ON A NAVD83 DATUM.
 2. HORIZONTAL GEOGRAPHIC COORDINATES ARE BASED ON NAD 83.
 3. CAUTION SHOULD BE USED WHEN COMPARING THE AIRPORT LAYOUT PLAN AND THE CONSTRUCTION DOCUMENTS PREPARED BY THE ADOT FOR THE AKUTAN AIRPORT. THE AIRPORT LAYOUT PLAN ELEVATIONS ARE BASED ON A NAVD83 DATUM WHILE THE CONSTRUCTION DOCUMENT ELEVATIONS ARE BASED ON THE MLLW DATUM.

GEOGRAPHIC COORDINATES TABLE						
ITEM	EXISTING LATITUDE	EXISTING LONGITUDE	NEAR TERM LATITUDE	NEAR TERM LONGITUDE	ULTIMATE LATITUDE	ULTIMATE LONGITUDE
ARP	NONE	NONE	N54°08'40.60"	W 65°36'14.78"	N54°08'40.60"	W165°36'14.78"
THRESHOLD RW 9			N54°08'43.96"	W 65°36'52.13"	N54°08'43.96"	W165°36'52.13"
THRESHOLD RW 27			N54°08'37.24"	W 65°35'37.44"	N54°08'37.24"	W165°35'37.44"

RUNWAY 9/27 DATA TABLE			
ITEM	NEAR TERM	ULTIMATE	
RUNWAY TYPE	UTILITY OR OTHER THAN UTILITY	OTHER THAN UTILITY	OTHER THAN UTILITY
FAA PART 77 APPROACH CATEGORY (V, NPI, P)	NPI / V	NPI / NPI	
APPROACH SURFACES	34:1 / 20:1	34:1 / 34:1	
VISIBILITY MINIMUM	<1 MILE / >1 MILE	<3/4 MILE / <3/4 MILE	
RUNWAY SURFACE	ASPHALT	ASPHALT	
PAVEMENT STRENGTH S _N , D _N , D _{TW} , D _{TW} x1000lbs	S 30 DW 75	S 30 DW 75	
AIRCRAFT APPROACH CATEGORY	B	B	
AIRPLANE DESIGN GROUP	II	II	
TRUE BEARING	S81°17'28.13"E	S81°17'28.13"E	
EFFECTIVE GRADE	0.71%	0.71%	
TOUCH-DOWN ZONE ELEVATION NAVOB8	117.0' / 133.0'	117.0' / 133.0'	
RUNWAY DIMENSIONS	4500' X 75'	4500' X 100'	
RUNWAY SAFETY AREA (RSA) DIMENSIONS	5100' X 150'	5700' X 300'	
LENGTH BEYOND R/W END	300'	600'	
RUNWAY PROTECTION ZONE (RPZ) DIMENSIONS RWY 9	1700'x1000'x1510'	2500'x1000'x1750'	
RWY 27	1000'x500'x700'	2500'x1000'x1750'	
RUNWAY OBJECT FREE AREA (OFA) DIMENSIONS	5100' X 500'	5700' X 800'	
LENGTH BEYOND R/W END OR STOPWAY	300'	600'	
RUNWAY OBSTACLE FREE ZONE (OFZ) DIMENSIONS	4900' X 400'	4900' X 400'	
RUNWAY LIGHTING	MIRL	MIRL	
RUNWAY MARKING TYPE	NPI	PI	
RUNWAY VISUAL APPROACH AIDS	PAPI/PAPI	MALSF,PAPI,REILS/PAPI,REILS	

THERE ARE NO OBJECT FREE AREA PENETRATIONS
 THERE ARE NO OFZ OBJECT PENETRATIONS

DRAWING INDEX	
SHT No.	TITLE
1	COVER AND DATA
2	NEAR TERM LAYOUT
3	ULTIMATE LAYOUT
4	NEAR TERM INNER PORTION OF THE RUNWAY 9 APPROACH SURFACE
5	NEAR TERM INNER PORTION OF THE RUNWAY 27 APPROACH SURFACE
6	ULTIMATE INNER PORTION OF THE RUNWAY 9 APPROACH SURFACE
7	ULTIMATE INNER PORTION OF THE RUNWAY 27 APPROACH SURFACE
8	AIRPORT AIRSPACE 14 CFR, PART 77
9	AIRPORT PROPERTY MAP

MODIFICATION TO STANDARDS/ NON STANDARD CONDITIONS			
DESCRIPTION	STANDARD	EXISTING	ULTIMATE
NONE			

BY	DATE	REVISION

APPROVED: [Signature]	DATE: 5/12/12
RECOMMENDED: [Signature]	DATE: 5/12/12
DESIGN SECTION CHIEF: [Signature]	
FAA AIRPORTS DIVISION ALASKAN REGION, AAL-621	DATE: 5/11/12

STATE OF ALASKA
 DEPARTMENT OF TRANSPORTATION
 AND PUBLIC FACILITIES
 CENTRAL REGION

AKUTAN AIRPORT
 AKUTAN, ALASKA
 AIRPORT LAYOUT PLAN

COVER AND DATA

DATE: 04/27/12
 SHEET: 1 OF 9

Date Plotted: 04/27/12
 Layout Name: SHEET 5
 File Name: \\sawtooth\work\6753\110330_Akutan_Airport_080\Drawings\Airport_Layout_Plan_(RW_27)_AC_150_5300-13.dwg
 Drawn By: [blank]
 Checked By: [blank]

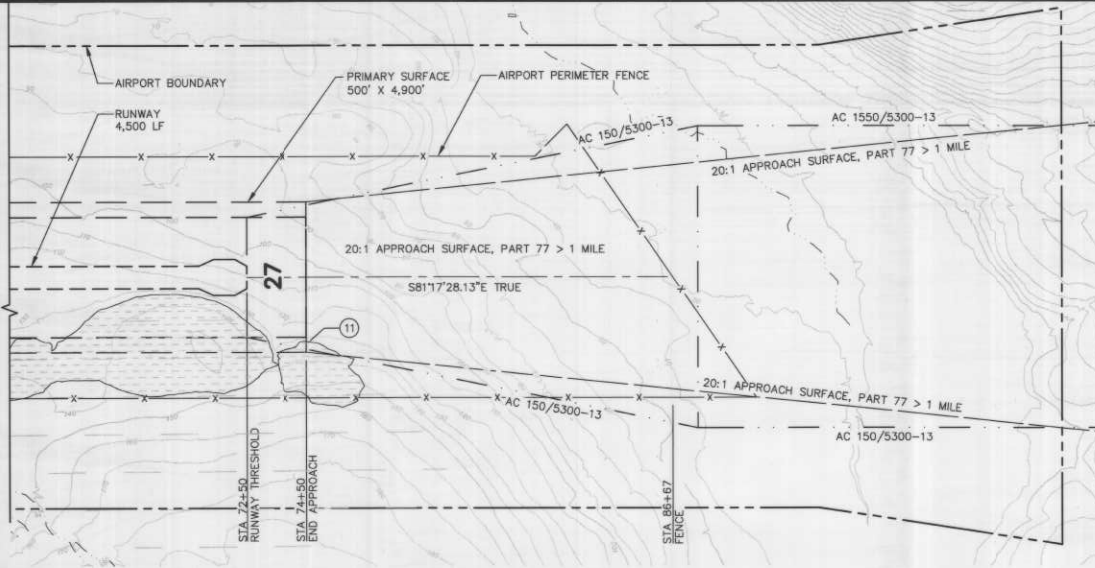
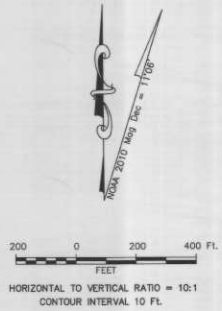

RUNWAY 27 APPROACH PLAN

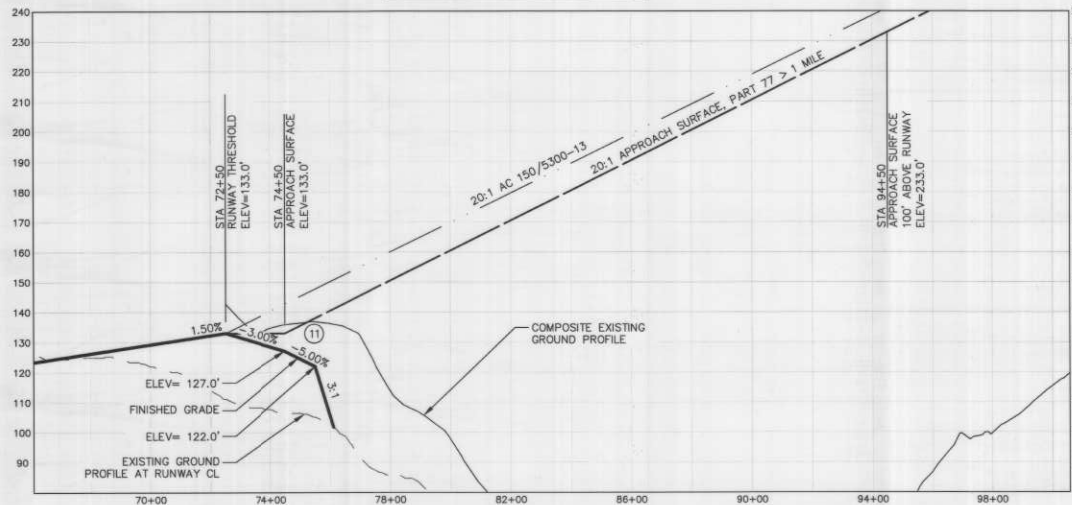

RUNWAY 27 APPROACH PROFILE

PART 77 SURFACE OBSTRUCTION TABLE (INNER PORTION RW 27)							
ID#	DESCRIPTION	STATION/OFFSET	ELEVATION NAVD88	SURFACE PENETRATED	SURFACE ELEVATION	AMOUNT PENETRATION	DISPOSITION
11	GROUND	74+50/250'R	135	APPROACH	133	2	REMOVE
							NEAR TERM

NOTE: REFER TO THE AIRPORT AIRSPACE DRAWING FOR PENETRATIONS OF THE OUTER APPROACH SURFACES

BY	DATE	REVISION

- NOTES:
- AFTER NEAR TERM DEVELOPMENT, THE CONTROLLING OBSTRUCTION CLEARANCE SLOPE FOR RUNWAY 27 IS ESTABLISHED AT 20:1 PER FAA AC 150/5200-35, SECTION 4, D.E.N. 57
 - AFTER NEAR TERM DEVELOPMENT, THERE WILL BE NO OBJECT PENETRATIONS IN THE RUNWAY APPROACH END SITING SURFACES OF RUNWAY 27 AS DEFINED IN FAA AC 150/5300-13 CHG 15 APPENDIX 2 TABLE A2-1, LINE 3.

STATE OF ALASKA
DEPARTMENT OF TRANSPORTATION
AND PUBLIC FACILITIES
CENTRAL REGION

AKUTAN AIRPORT
 AKUTAN, ALASKA
 AIRPORT LAYOUT PLAN

NEAR TERM INNER PORTION OF THE RUNWAY 27 APPROACH SURFACE

DATE: 04/27/12
 SHEET: 5 OF 9

Date Printed: 4/24/2012
 File Name: \\fs0001\PROJECTS\2012\15101032_Akutan_Airport_IBN\Drawings\Airport_Layout_Sheet_AKAP\Akutan_Airport_Airport_Layout_Sheet_08.dwg
 Drawing By: DTK
 Checked By: DTK

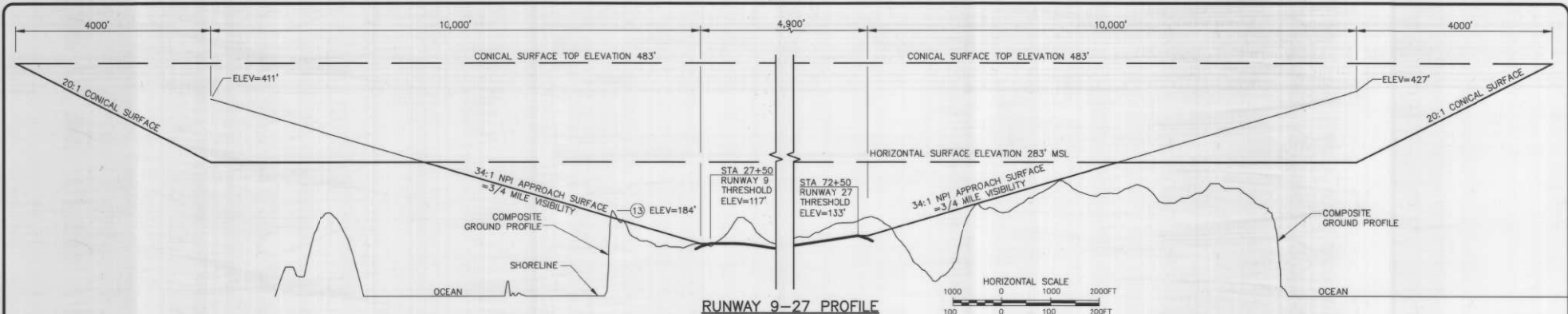

RUNWAY 9-27 PROFILE

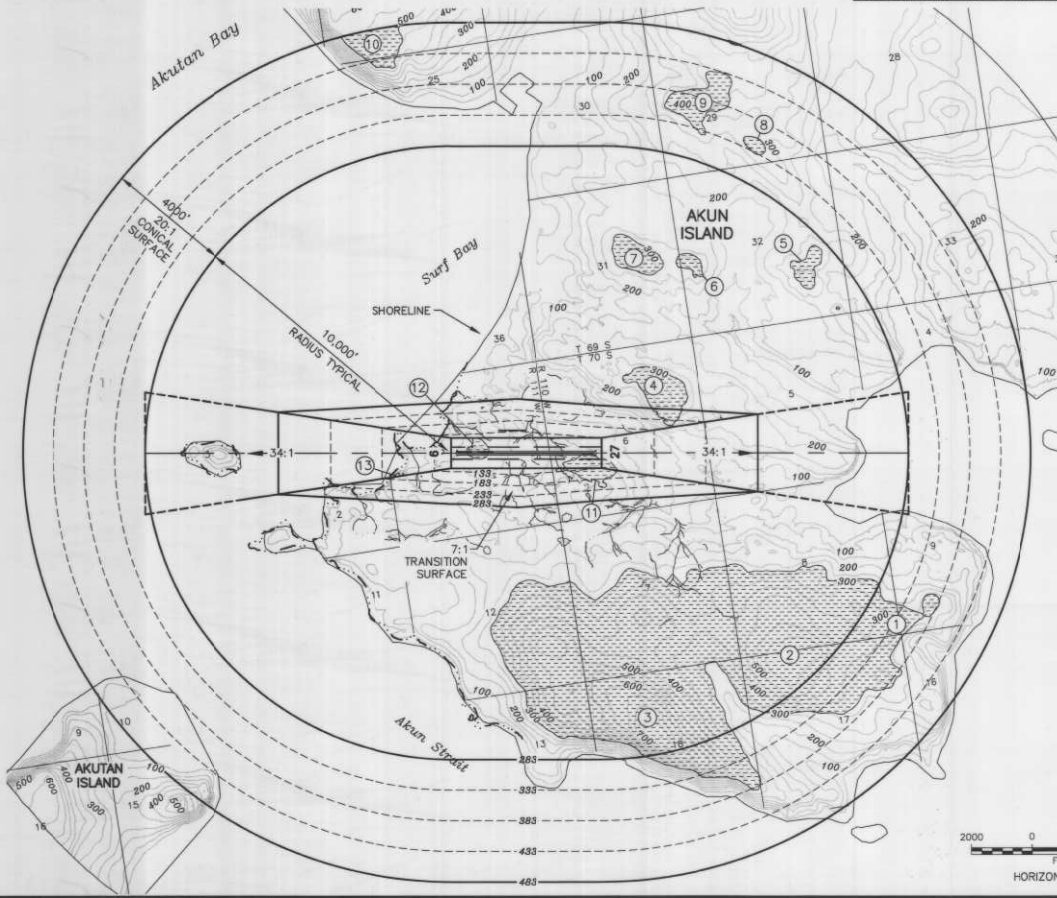
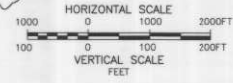

PART 77 SURFACE OBSTRUCTION TABLE (OUTER PORTION RW 9-27)

ID #		STATION OFFSET	ELEVATION NAVD 88	SURFACE PENETRATION	SURFACE ELEVATION	AMOUNT (ft) PENETRATION	DISPOSITION	STAGE TO CORRECT
1	HIGHEST TERRAIN POINT	132+40, 5,087R	450	HORIZONTAL	335	167	REMAIN *	ULTIMATE
2	HIGHEST TERRAIN POINT	135+30, 6,654R	590	HORIZONTAL	283	307	REMAIN	---
3	HIGHEST TERRAIN POINT	91+60, 9,267R	800	HORIZONTAL	283	517	REMAIN	---
4	HIGHEST TERRAIN POINT	93+60, 2,096R	390	HORIZ/TRANS	283	107	REMOVE	---
5	HIGHEST TERRAIN POINT	142+50, 5,618R	310	HORIZONTAL	283	27	REMAIN	---
6	HIGHEST TERRAIN POINT	102+60, 6,260R	310	HORIZONTAL	283	27	REMAIN	---
7	HIGHEST TERRAIN POINT	86+30, 6,314R	340	HORIZONTAL	283	57	REMAIN	---
8	HIGHEST TERRAIN POINT	126+00, 9,935R	360	CONICAL	344	16	REMAIN	---
9	HIGHEST TERRAIN POINT	109+60, 11,500L	450	CONICAL	385	65	REMAIN	---
10	HIGHEST TERRAIN POINT	-8+50, 13,750L	560	CONICAL	481	79	REMAIN	---
11	HIGHEST TERRAIN POINT	74+50, 500R	165	APPROACH/TRANS	133	32	REMOVE	NEAR/ULTIMATE
12	HIGHEST TERRAIN POINT	36+50, 100L	170	PRIMARY/TRANS	116	54	REMOVE	NEAR/ULTIMATE
13	HIGHEST TERRAIN POINT	7+80, 750L	184	APPROACH	171	13	REMOVE	ULTIMATE

*TERRAIN PENETRATION TO THE APPROACH AND TRANSITION SURFACES TO BE REMOVED.
 TERRAIN PENETRATION TO THE HORIZONTAL AND CONICAL SURFACES TO REMAIN.

NOTES:

- ELEVATIONS ARE IN FEET
- AIRPORT ELEVATION IS 133.0' NAVD 88
- DRAWING BASED ON U.S.G.S. UNIMAK A-5
- REFER TO THE INNER PORTION OF THE APPROACH SURFACE PLAN VIEW FOR CLOSE IN DETAILS, SHEETS 4-7
- ULTIMATE PRIMARY SURFACE IS 1,000' WIDE
- NO SEWAGE LAGOONS OR LANDFILLS HAVE BEEN IDENTIFIED WITHIN 10,000' OF THE AIRPORT
- THERE ARE NO KNOWN HEIGHT RESTRICTIONS
- APPROACH SURFACES ARE 34:1 BEGINNING 200 FEET BEFORE EACH THRESHOLD

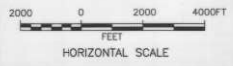

STATE OF ALASKA
DEPARTMENT OF TRANSPORTATION
AND PUBLIC FACILITIES
CENTRAL REGION

AKUTAN AIRPORT
 AKUTAN, ALASKA
 AIRPORT LAYOUT PLAN
 AIRPORT AIRSPACE
 14 CFR, PART 77

DATE: 04/27/12
 SHEET: 8 OF 9

BY	DATE	REVISION

Date Plotted: 4/26/2012
 Project Name: AKUTAN II
 File Name: \\p0000001\PROJECTS\2010\111033_Akutan Airport (R) (Construction) Layout Plan (RFP) Akutan II R-Shop.dwg

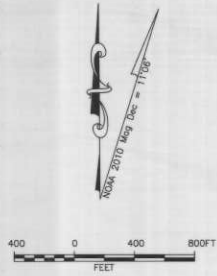

Akutun Bay

TO AKUTAN VILLAGE
7 MILES

Surf Bay

SHORELINE

TRACT II

ROTATING BEACON

PROPOSED AIRPORT
BOUNDARY

Surf Bay

TRACT I

RPZ

RPZ

4,500' X 100'
S81°17'28.13"E TRUE

27

2,710'

887'

887'

811'

8,298'

811'

NOTES:

1. THE STATE OF ALASKA DOES NOT HAVE ANY CURRENT PROPERTY INTEREST AT AKUTAN ISLAND. ALL PROPERTY FOR THE AIRPORT WILL HAVE TO BE ACQUIRED.

PROPERTY STATUS							
ID #	INTEREST	GRANTOR	GRANTEE	PARCEL SIZE	DATE ACQUIRED	RECORDED DOC NO.	ACQUIRED AIP NO.
I	FEE SIMPLE	AKUTAN CORP.		359.75 ac	TO BE ACQUIRED		
II	FEE SIMPLE	AKUTAN CORP.		9.40 ac	TO BE ACQUIRED		

BY	DATE	REVISION

STATE OF ALASKA
DEPARTMENT OF TRANSPORTATION
AND PUBLIC FACILITIES
CENTRAL REGION

AKUTAN AIRPORT
 AKUTAN, ALASKA
 AIRPORT LAYOUT PLAN
 AIRPORT PROPERTY MAP

DATE: 04/27/12
 SHEET: 9 OF 9