

A
B
C
D
E
F
G
H

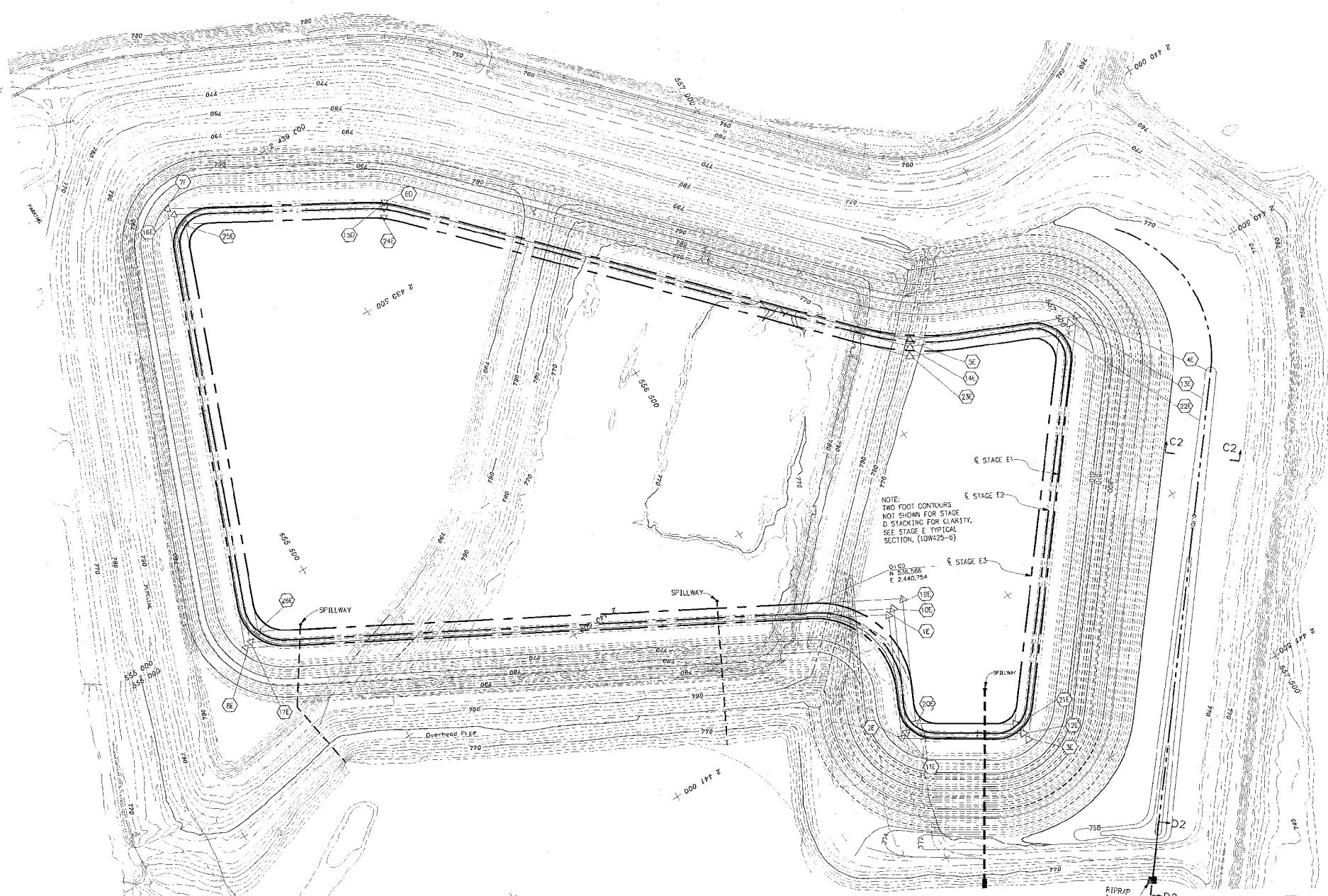

P1	Lambert North	Coordinate East	R (ft)	Δ (deg)	T (ft)	D	L (ft)	PC (sta)	PT (sta)
1E	556,714	2,440,882	210	90	200.49	27.29	320.14	0.00	320.14
2E	555,570	2,441,174	96	84.475	86.25	60.31	139.30	369.19	508.49
3E	555,846	2,441,340	95	83.745	85.16	60.31	138.70	663.97	802.67
4E	557,541	2,440,474	95	104.896	123.57	63.31	173.78	1710.92	1884.7
5E	557,142	2,440,299	630	23.399	130.46	9.09	256.12	2067.16	2323.28
6E	555,190	2,439,279	370	16.902	54.97	15.49	103.49	3534.04	3642.53
7E	555,705	2,438,997	95	97.980	109.25	60.31	162.58	4039.53	4292.11
8E	555,264	2,440,082	120	83.235	105.61	47.75	174.36	5157.27	5331.63
10E	555,734	2,440,875	215	90	265.26	26.65	327.76	0	327.76
11E	556,589	2,441,169	96	84.475	72.64	71.62	117.95	377.6	495.55
12E	555,842	2,441,329	80	83.745	71.71	71.62	117.32	650.38	767.7
13E	557,517	2,440,480	80	104.896	104.06	71.62	146.60	1676.0	1822.6
14E	557,135	2,440,314	645	23.399	133.57	8.88	264.72	2000.6	2265.32
15E	555,183	2,439,293	355	16.902	52.74	16.14	104.18	3474.58	3578.76
16E	555,712	2,439,319	80	97.98	92	71.62	135.94	3979.04	4115.98
17E	555,283	2,440,075	105	83.235	93.28	54.57	152.50	5070.38	5222.88
19E	555,767	2,440,865	240	90	229.13	23.88	335.87	0	365.87
20E	556,622	2,441,159	96	84.475	49.94	104.17	80.65	414.92	495.57
21E	555,837	2,441,295	55	83.745	49.3	104.17	80.42	651.24	731.66
22E	557,477	2,440,490	55	104.896	71.54	104.17	100.68	1639.22	1739.9
23E	557,170	2,440,334	670	23.399	138.74	8.55	273.60	1918.24	2197.84
24E	556,167	2,439,312	330	16.902	49.03	17.36	97.46	3462.41	3499.87
25E	555,725	2,439,056	55	97.98	63.25	104.17	94.00	3898.38	3992.38
26E	555,315	2,440,063	80	83.235	71.07	71.62	116.21	4945.4	5061.61

NOTES:
1. FOR GENERAL NOTES SEE 10W425-1.

REV	DATE	BY	CHKD	APPD	DESC
SCALE: 1"=100'					
EXCEPT AS NOTED					
YARD					
DREDGE CELLS					
EXISTING / FUTURE CONTOURS					
AND STAGE E PLAN					
DESIGNED BY	DRAWN BY	CHECKED BY	APPROVED BY	REVISED BY	DATE
B.K. ELDER	G.C. LAWSON	B.K. ELDER	H.L. PEITY	K.W. BURNETT	G. JOHNSON
KINGSTON FOSSIL PLANT					
TENNESSEE VALLEY AUTHORITY					
FOSSIL AND HYDRO ENGINEERING					
AUTOCAD R14	DATE	36 C	10W425-10	REV	0



4/6/98