

361 C SK PR0637 C08

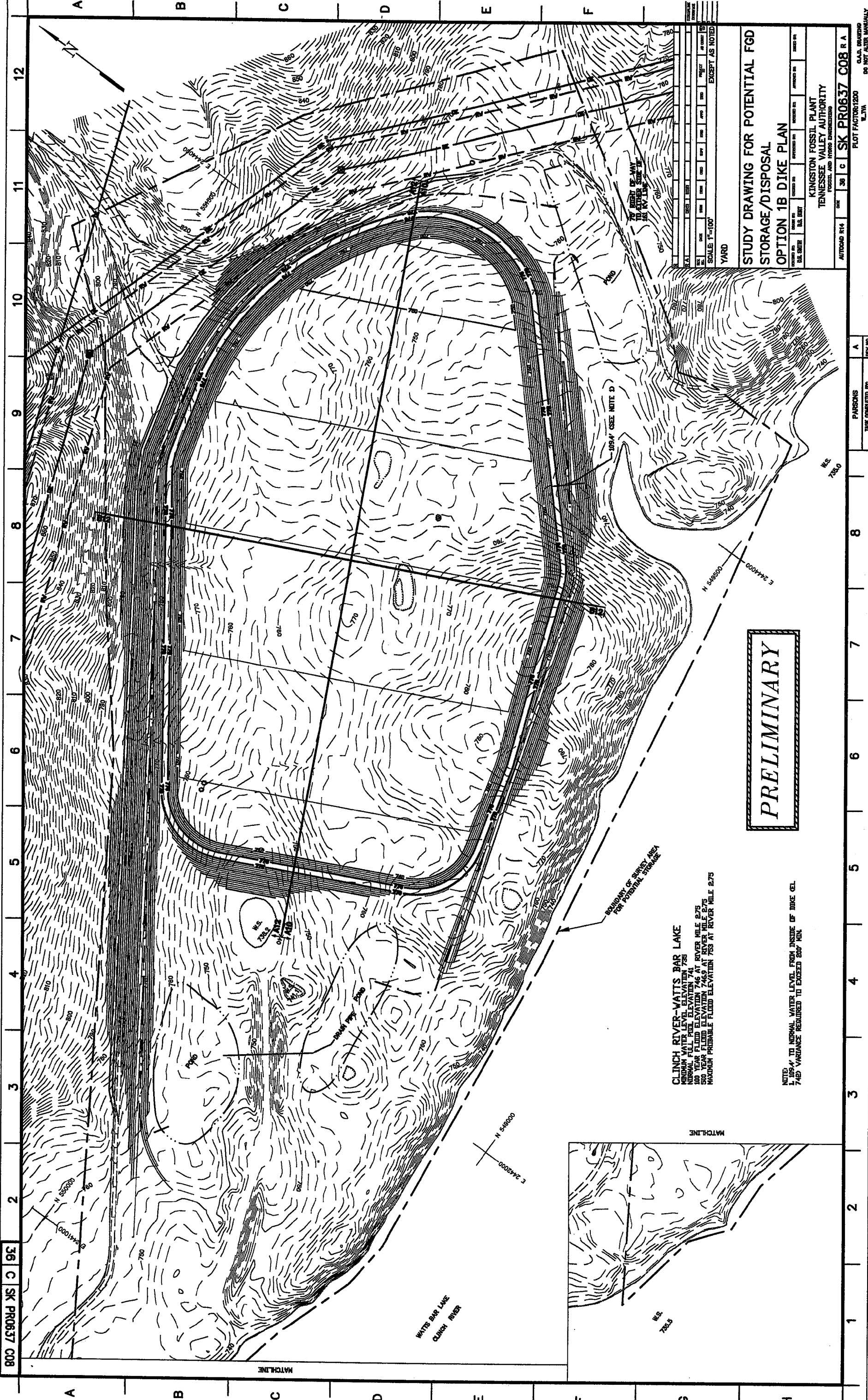

**PRELIMINARY**

CLINCH RIVER-WATTS BAR LAKE  
 MINIMUM WATER LEVEL ELEVATION 735  
 NORMAL FULL POOL ELEVATION 741  
 500 YEAR FLOOD ELEVATION 746 AT RIVER MILE 2.75  
 500 YEAR FLOOD ELEVATION 746.9 AT RIVER MILE 2.75  
 MAXIMUM PROBABLE FLOOD ELEVATION 753 AT RIVER MILE 2.75

NOTE:  
 1. 109'4" TO NORMAL WATER LEVEL FROM INSIDE OF DIKE CEL.  
 7'42" VARIANCE REQUIRED TO EXCEED 200' MIN.

**STUDY DRAWING FOR POTENTIAL FGD STORAGE/DISPOSAL  
 OPTION 1B DIKE PLAN**

KINGSTON FOSSIL PLANT  
 TENNESSEE VALLEY AUTHORITY  
 FUGRO ENGINEERING

AUTOCAD FILE: 361 C SK PR0637 C08 R A  
 PLOT FACTOR: 0.1250  
 C.A.G. BRANNING  
 DO NOT ALTER MANUALLY

SCALE: 1"=100'  
 YARD

NO.	DATE	BY	CHKD	DESCR

EXCEPT AS NOTED

PARSONS  
 TASK COMPLETED BY: A  
 REV. NO.