

UNITED STATES GOVERNMENT

Memorandum

TENNESSEE VALLEY AUTHORITY

B65 '86 0801 001

TO : Paul Wade, Director of Fossil & Hydro Power, LP 3S 58K-C

FROM : W. M. Bivens, Manager of Power Engineering, 12-113 SB-K

DATE AUG 04 1986

SUBJECT: KINGSTON STEAM PLANT - DREDGE CELL DIKE

STABILITY ANALYSIS - RESULTS

Reference your memorandum to me dated July 21, 1986 (M61 860714 986).

In accordance with your request, we have completed the stability analysis of the proposed typical dredge cell dike cross-section (see Attachment A) transmitted with the referenced memorandum. Our analysis indicates the factor of safety against failure exceeds 1.5 for all design cases with the assumption there will be no long-term ponding within this cell. In the event a long-term ponding condition did exist, the factor of safety would be less than 1.5.

Please note that normal operational procedures using dredge ponds recommend dewatering as soon as practical to avoid prolonged freestanding water. In addition, all ash/soil parameters were assumed utilizing historical soil investigation logs within ash pond sites and ash properties typically used for the various TVA fossil plants. Our analysis reflects these conditions.

Original Signed By
W. M. Bivens

W. M. Bivens

OPT:DRG:HLL

Attachment

cc (Attachment):

RIMS, SL 26 C-K

O. P. Thornton, W3 D224 C-K

This was principally prepared by D. R. Galloway, (extension 4359).



S76211.05

Buy U.S. Savings Bonds Regularly on the Payroll Savings Plan

TVA-00010928

SUBJECT

WEDGE CELL

PROJECT

KINGSTON S.P.

COMPUTED BY

M. KH

DATE

6-27-86

CHECKED BY

DATE

ATTACHMENT A

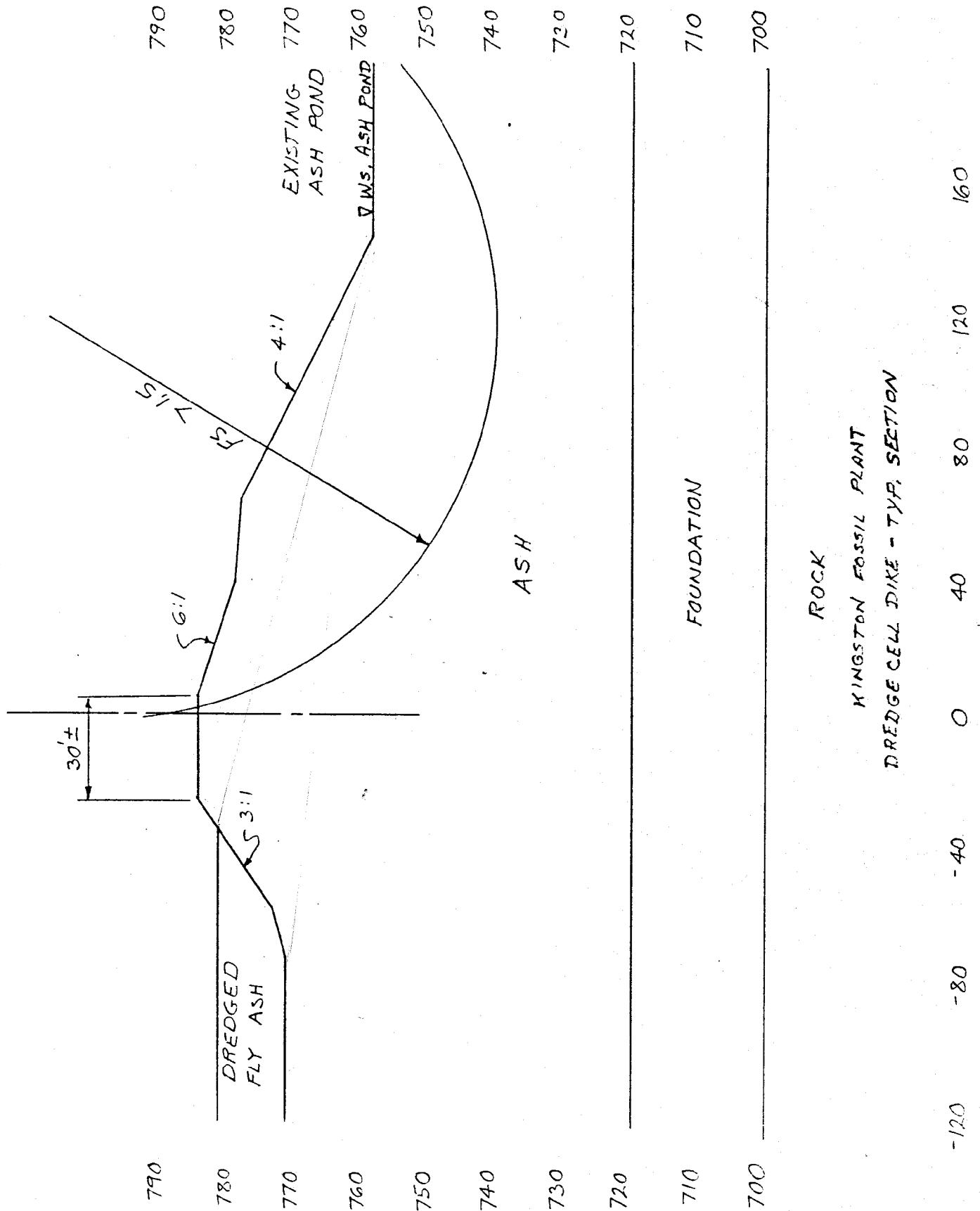

KINGSTON FOSSIL PLANT
DREDGE CELL DIKE - TYP. SECTION

NAME		DATE	
W. M. Bivens		AUG 01 1986	
ADDRESS		M. S. No.	
12-113 SB-K		Chatta 88 Knox 88	
NAME		EXTENSION	
O. P. Thornton		2638	
ADDRESS		M. S. No.	
W3 D224 C-K		Chatta 88 Knox 88	

Reference: Attached memo to Paul Wade

At this time we think it best not to include any statements in the memorandum regarding PE doing all engineering on future projects of this type. We understand that the working level engineers were only following their middle-management directives to "get it done".

I believe central office is starting to "come around" to PE performing all engineering for Power. In fact, the F&H PR coordinator for the KIF dike work has in the past two weeks verbally requested + 30% PE&C estimates for the following projects:

1. PAF - ASH DREDGE POND
2. PAF - AIR PREHEATER WASTE (CHEMICAL) TREATMENT POND
3. KIF - DRY FLY ASH FACILITY

Central office is preparing a formal request to you from Paul Wade to followup the verbal requests. PE will be providing scope, preliminary engineering, and the + 30% level cost estimate in FY86. A request for the budgeting (+ 10%) level estimates to be done in FY87 (Oct.-Dec. timeframe) will be forthcoming also. These projects are currently planned for FY88 budgeting.

NAME		DATE	
F O R		AUG 01 1986	
ADDRESS		M. S. No.	
		Chatta 88 Knox 88	
NAME		EXTENSION	
F R O M			
ADDRESS		M. S. No.	
		Chatta 88 Knox 88	

I suggest you sign the attached memorandum "as written". If we perceive any waiver in the current trend, which would effect PE's role as the engineering organization, we will bring it up to your attention and take the necessary action to turn it around.

[Signature]
O. P. Thornton

903 JMS OPT:JEB:HLL
Attachment

FOR	NAME	<i>Don Galloway</i>	DATE	<i>June 15, 1992</i>
	ADDRESS	<i>W 3A 55 C-K</i>	<input type="checkbox"/> Chatta <input type="checkbox"/> M. S. <input checked="" type="checkbox"/> Knox <input type="checkbox"/> Nor.	

Fold here for return

FROM	NAME	<i>Paul D. Paris</i>	EXTENSION	<i>3510</i>
	ADDRESS	<i>900 CST2-K</i>	<input checked="" type="checkbox"/> Chatta <input type="checkbox"/> M. S. <input type="checkbox"/> Knox <input type="checkbox"/> Nor.	

*Our sketches on King's
ash pond.*

Paul

KINGSTON

2,439,000

2,440,000

2,441,000

2,442,000

2,443,000

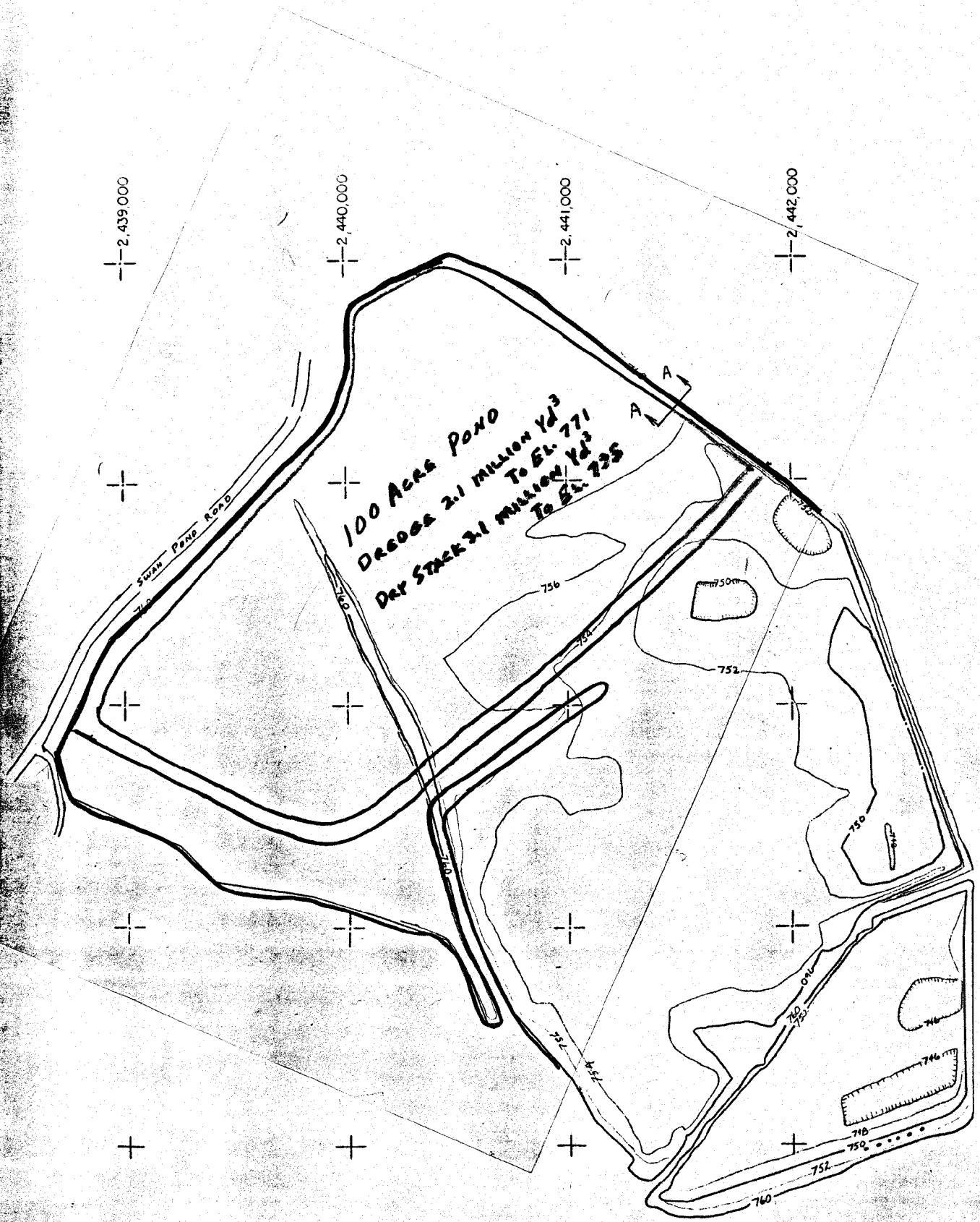

100 ACRES POND
DREDGE 2.1 MILLION YD³
TO EL. 771
DIP STACK 2.1 MILLION YD³
TO EL. 725

SKIMA W