

A

B

C

D

E

F

G

H

A

B

C

D

E

F

G

H

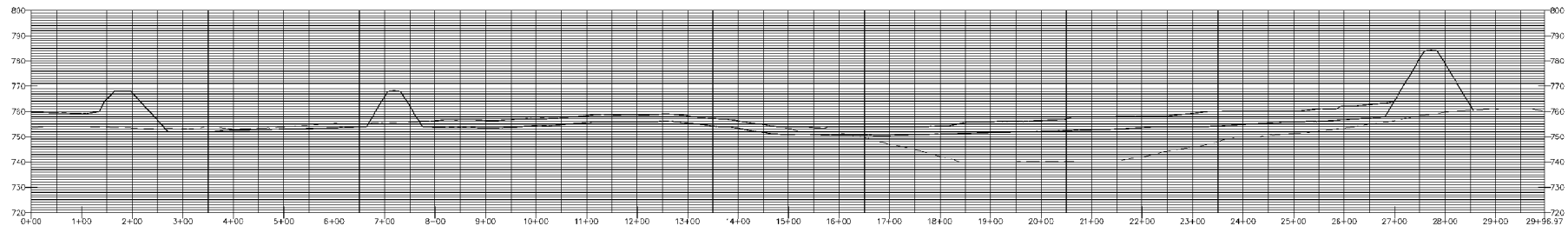

SECTION A12
 HORIZ: 1"=100'
 VERT: 1"=20'

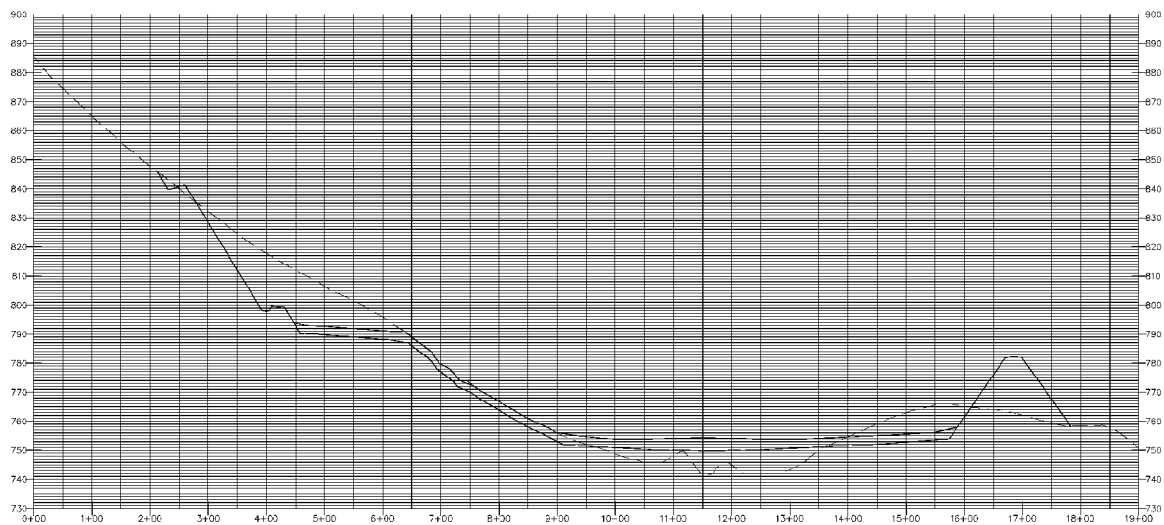

SECTION B12
 HORIZ: 1"=100'
 VERT: 1"=20'

| | | | | | | | | |
|---|------------|------------|---------------|------------|-------------|-----------|----------|------|
| REV | DATE | BY | CHKD | APPD | ISSD | PROJECT | AS SHOWN | DATE |
| 1 | 02/98 | JTS | SAH | JTS | HLF | BAK | | |
| INITIAL ISSUE FOR W.O.# KIF DB-590055-000 RD | | | | | | | | |
| SCALE: 1"=200' EXCEPT AS NOTED | | | | | | | | |
| YARD | | | | | | | | |
| FGD GYPSUM DISPOSAL FACILITY CROSS SECTIONS | | | | | | | | |
| DESIGNED BY | DRAWN BY | CHECKED BY | SUPERVISED BY | REVISED BY | APPROVED BY | ISSUED BY | | |
| J.T. STEIN | S.A. HANBY | J.T. STEIN | | | | | | |
| KINGSTON FOSSIL PLANT TENNESSEE VALLEY AUTHORITY FOSSIL AND HYDRO ENGINEERING | | | | | | | | |
| AUTOCAD JOB | DATE | REV | C | 10W428-9 | | | R.D. | |
| | 02/98 | 36 | | | | | | |

CONSOLIDATED TECH, INC.
 TASK COMPLETED BY: REV NO.

PLCT FACTOR: 1:1
 W_IVA C.A.D. DRAWING
 DO NOT ALTER MANUALLY