

A
B
C
D
E
F
G
H

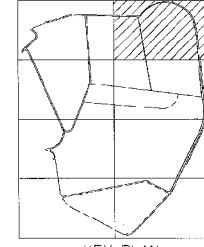
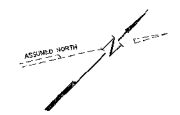
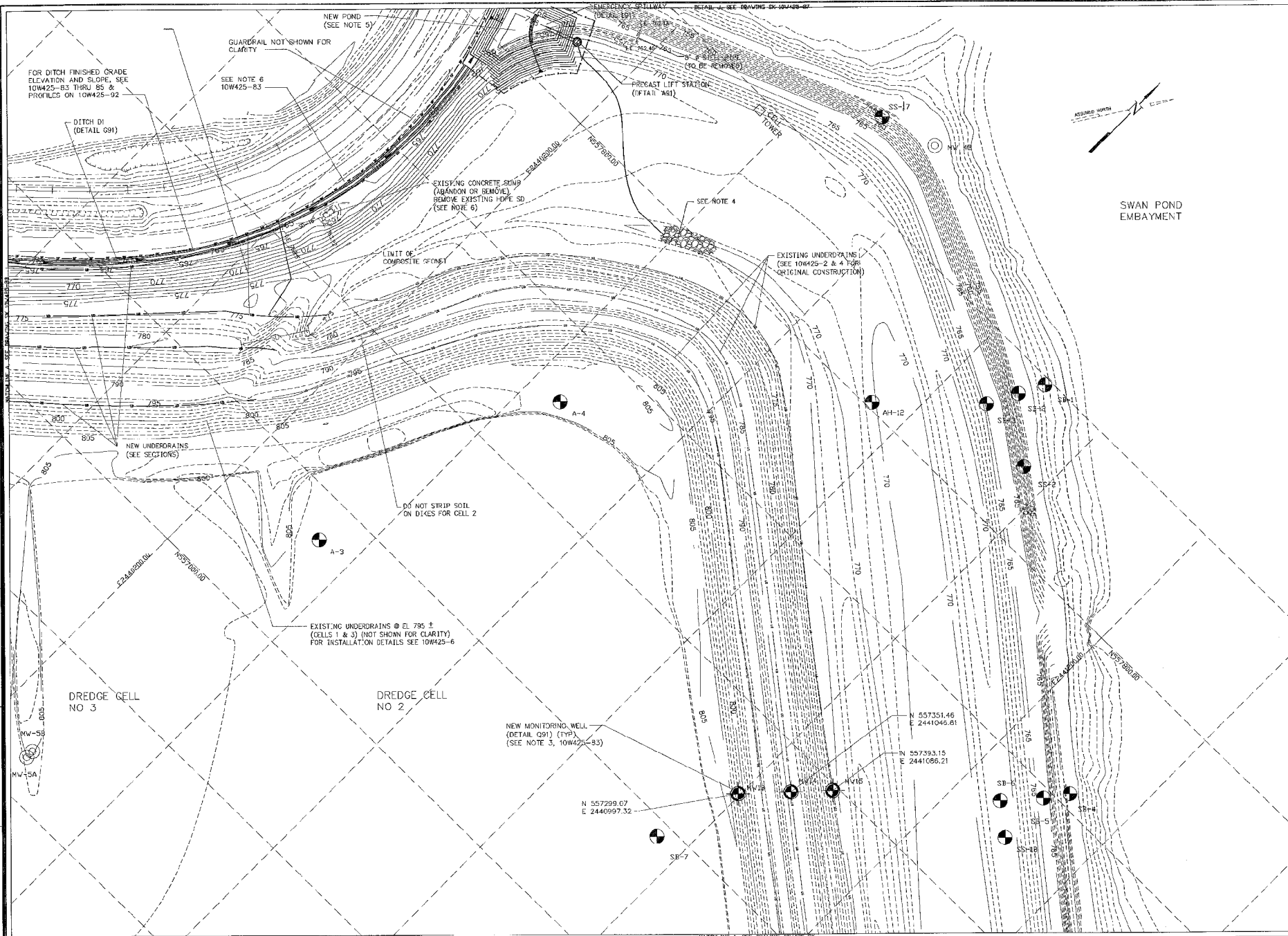

KEY PLAN

GRADING NOTES:

1. FOR PERMIT MINOR MODIFICATION DRAWING INDEX AND LEGEND, SEE DRAWING 10W425-81 FOR CONSTRUCTION NOTES, SEE 10W425-83.
2. INSTALL SILT FENCE IMMEDIATELY BEHIND GUARDRAILS ON SWAN POND ROAD.
3. PRECAST LIFT STATION TO BE INSTALLED DURING POND CONSTRUCTION. RELOCATE EXISTING SUBMERSIBLE PUMPS TO THE PERMANENT LIFT STATION. (INCLUDING TEMPORARY AND PERMANENT STRUCTURES).
4. PROVIDE RIPRAP AT END OF FORCE MAIN FOR EROSION PROTECTION. SIZE: D₅₀ = 6 INCHES. THICKNESS = 1FT.
5. CONSTRUCT THE NEW POND PRIOR TO DISTURBING OR REMOVING VEGETATION. RELOCATE EXISTING PUMPS & ELECTRICAL EQUIPMENT JUST PRIOR TO PLACING POND INTO SERVICE. THE POND SHALL FUNCTION AS A TEMPORARY SEDIMENT BASIN DURING CONSTRUCTION, AND WILL BE CONVERTED TO A PERMANENT POND AT THE COMPLETION OF CONSTRUCTION.
6. THE EXISTING CONCRETE SUMP SHALL BE REMOVED.

NO.	DATE	BY	DESCRIPTION
1	01/11/00	JMS	ISSUE FOR PERMIT
2	01/11/00	JMS	ISSUE FOR PERMIT
3	01/11/00	JMS	ISSUE FOR PERMIT
4	01/11/00	JMS	ISSUE FOR PERMIT
5	01/11/00	JMS	ISSUE FOR PERMIT
6	01/11/00	JMS	ISSUE FOR PERMIT
7	01/11/00	JMS	ISSUE FOR PERMIT
8	01/11/00	JMS	ISSUE FOR PERMIT
9	01/11/00	JMS	ISSUE FOR PERMIT
10	01/11/00	JMS	ISSUE FOR PERMIT
11	01/11/00	JMS	ISSUE FOR PERMIT
12	01/11/00	JMS	ISSUE FOR PERMIT
13	01/11/00	JMS	ISSUE FOR PERMIT
14	01/11/00	JMS	ISSUE FOR PERMIT
15	01/11/00	JMS	ISSUE FOR PERMIT
16	01/11/00	JMS	ISSUE FOR PERMIT
17	01/11/00	JMS	ISSUE FOR PERMIT
18	01/11/00	JMS	ISSUE FOR PERMIT
19	01/11/00	JMS	ISSUE FOR PERMIT
20	01/11/00	JMS	ISSUE FOR PERMIT

SCALE: 1" = 30'

DREDGE CELL DIKE RESTORATION PLAN - SHEET 2

DESIGNED BY	DRAWN BY	CHECKED BY	APPROVED BY	DATE
KINGSTON FOSSIL PLANT TENNESSEE VALLEY AUTHORITY FOSSIL AND HYDRO ENGINEERING				
AUTOCAD R2000	DATE	36 C	10W425-84	R 0