

- NOTES:**
- WORK SHALL BE IN ACCORDANCE WITH TVA GENERAL CONSTRUCTION SPECIFICATION T-1, UNLESS OTHERWISE NOTED.
 - FOR EXCAVATION, BACKFILL, AND BEDDING REFER TO SECTION 125, EXCEPT AS NOTED. BACKFILL SHALL BE COMPACTED IN 6-INCH (MAXIMUM) LIFTS TO 90% OF MAXIMUM DENSITY PER ASTM D698, STANDARD PROCTOR METHOD.
 - BACKFILL MATERIAL FOR PLASTIC PIPE SHALL CONFORM TO AASH-TM M 145 CLASSIFICATION GROUP A-1, A-2, OR A-3. AGGREGATE SIZE SHALL NOT EXCEED 1" DIAMETER.
 - RIPRAP (9" - 12" DIA.) SHALL CONFORM TO SECTION 575.
 - FILTER CLOTH SHALL BE NON-WOVEN GEOTEXTILE TYPE #41, AS MANUFACTURED BY SYNTHETIC INDUSTRIES, 4019 INDUSTRY DRIVE, CHATTANOOGA, TN 37416.
 - HIGH DENSITY POLYETHYLENE (HDPE) PIPE AND FITTINGS SHALL BE TYPE N-2 PIPE, AS MANUFACTURED BY ADVANCED DRAINAGE SYSTEMS, INC., 3300 RIVERSIDE DRIVE, COLUMBUS, OH 43221, OR EQUAL. FOLLOW MANUFACTURER'S INSTALLATION INSTRUCTIONS WHEN INSTALLING PIPE.
 - GROUTED GUTTERS SHALL CONFORM TO SECTION 512.
 - ALL DISTURBED AREAS (ROADWAYS, GRASS AREAS, ETC.) SHALL BE RETURNED TO THEIR ORIGINAL STATE AFTER CONSTRUCTION.
 - DISTURBED GRASSED AREAS AND FILL AREAS SHALL BE SEED WITH TYPE 8, MIXTURE 1 FOR FALL PLANTING AND TYPE 6, MIXTURE 1 FOR SPRING PLANTING. GRASSED AREAS ARE TO BE SEED, MULCHED, AND FERTILIZED IN ACCORDANCE WITH SECTION 580 AND 582.
 - PAVEMENT MATERIALS SHALL CONFORM TO SECTION 225 FOR STABILIZED BASE, SECTION 320 FOR PRIME COAT, SECTION 330 FOR BITUMINOUS LEVELING COURSE AND SECTION 345 FOR ASPHALTIC CONCRETE.
 - PERFORATED & NON-PERFORATED PIPE AND FITTINGS SHALL BE ADS SINGLE-WALL CORRUGATED HDPE PIPE AS MANUFACTURED BY ADVANCED DRAINAGE SYSTEMS, INC., 3300 RIVERSIDE DRIVE, COLUMBUS, OHIO 43221, OR EQUAL. FOLLOW MANUFACTURER'S INSTALLATION INSTRUCTIONS WHEN INSTALLING PIPE.
 - COMPACTED CLAY COVER SHALL CONSIST OF SOIL PLACED IN LAYERS WHOSE COMPACTED THICKNESS DOES NOT EXCEED 6 INCHES. EARTHFILL SHALL BE UNIFORMLY COMPACTED TO AT LEAST 95% OF MAX. DRY DENSITY AS DETERMINED BY ASTM D-698 PROCEDURES (STANDARD PROCTOR).
- (NOTES CONTINUED ON 10W441-2)

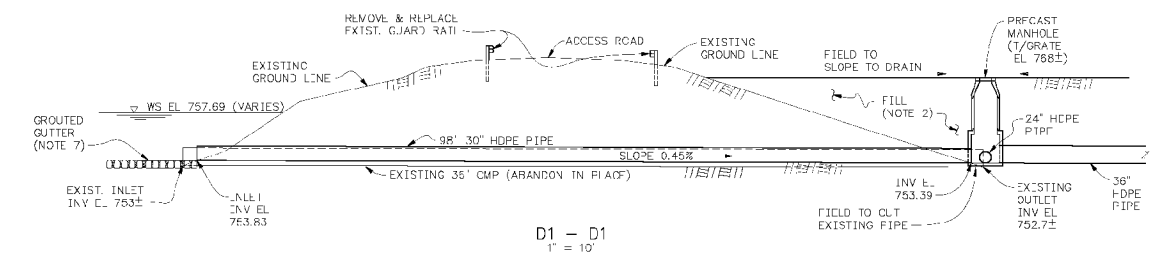
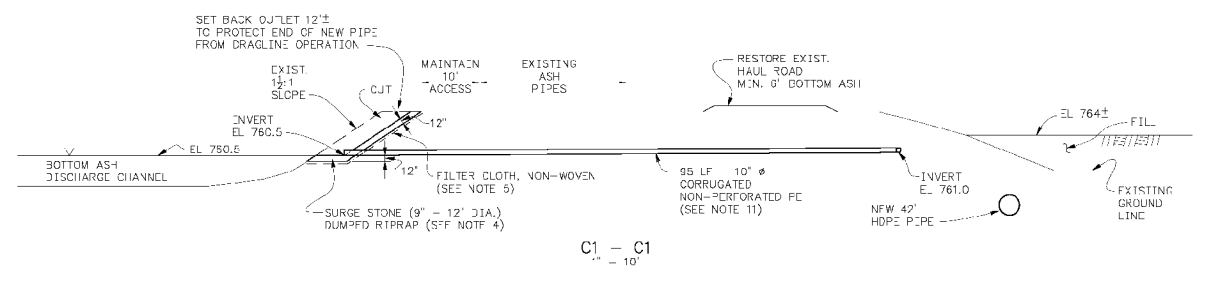
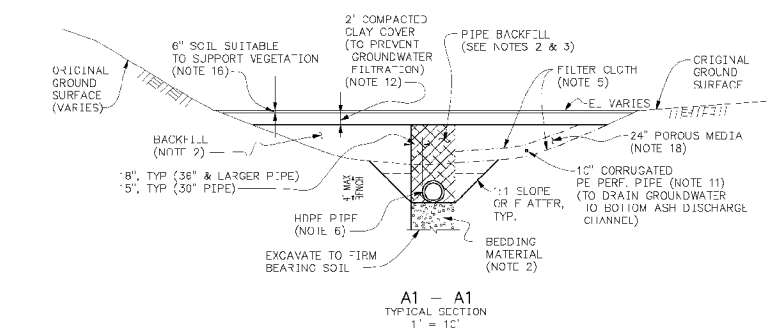

REVISIONS									
R.D.	C.V.M.	M.G.	H.L.P.	H.L.P.	REP.	J.A.N.	W.D.H.	K.H.B.	8
INITIAL ISSUE	DATE	BY	CHKD.	APPV.	REASON	NO.	DATE	BY	REASON
SCALE: 1" = 100' EXCEPT AS NOTED									
YARD									
ABANDONED ASH POND DRAINAGE DIVERSION PLAN & SECTIONS									
DESIGNED BY:	W.D.H.	CHECKED BY:	H.L.P.	APPROVED BY:	J.A.N.	DATE:	10/20/11		
DRAWN BY:	M.G.	PROJECT:	10W441-1	SCALE:	1" = 100'	DATE:	10/20/11		
KINGSTON FOSSIL PLANT TENNESSEE VALLEY AUTHORITY FOSSIL AND HYDRO ENGINEERING									
AUTOCAD R14		36		C		10W441-1		R 0	