



Public Notice

U.S. Army Corps
of Engineers
Tulsa District

Reply To:

U.S. Army Corps of Engineers
ATTN: Regulatory Office
1645 South 101st East Avenue
Tulsa, OK 74128-4609

SWT-2012-793
Public Notice No.

December 3, 2012
Public Notice Date

January 2, 2013
Expiration Date

PURPOSE

The purpose of this public notice is to inform you of a proposal for work in which you might be interested and to solicit your comments and information to better enable us to make a reasonable decision on factors affecting the public interest.

SECTION 10

The U.S. Army Corps of Engineers is directed by Congress through Section 10 of the Rivers and Harbors Act of 1899 (33 USC 403) to regulate all work or structures in or affecting the course, condition, or capacity of navigable waters of the United States. The intent of this law is to protect the navigable capacity of waters important to interstate commerce.

SECTION 404

The U.S. Army Corps of Engineers is directed by Congress through Section 404 of the Clean Water Act (33 USC 1344) to regulate the discharges of dredged and fill material into all waters of the United States. These waters include lakes, rivers, streams, mudflats, sandflats, sloughs, wet meadows, natural ponds, and wetlands adjacent to other waters. The intent of the law is to protect these waters from the indiscriminate discharge of material capable of causing pollution and to restore and maintain their chemical, physical, and biological integrity.

NOTICE TO PUBLISHERS

This public notice has been provided as a public service and may be reprinted at your discretion. However, any cost incurred as a result of reprinting or further distribution shall not be a basis for claim against the Government.



DEPARTMENT OF THE ARMY
CORPS OF ENGINEERS, TULSA DISTRICT
1645 SOUTH 101ST EAST AVENUE
TULSA, OKLAHOMA 74128-4609

Application Number SWT-2012-793

JOINT PUBLIC NOTICE
U.S. ARMY CORPS OF ENGINEERS
AND
OKLAHOMA DEPARTMENT OF ENVIRONMENTAL QUALITY (ODEQ)
(30-DAY COMMENT PERIOD)

Interested parties are hereby notified that the District Engineer (DE) has received an application for a Department of the Army (DA) permit and water quality certification pursuant to Sections 404 and 401 of the Clean Water Act (CWA). The ODEQ hereby incorporates this public notice and procedure as its own public notice and procedure by reference thereto.

The application is for improving the storm sewer conveyance system by widening an existing concrete lined channel and Reinforced Concrete Box (RCB) structure to increase flow capacity of the system.

Name of Applicant:

Mr. Eric Wenger, P.E.
City of Oklahoma City
420 West Main Street, Suite 700
Oklahoma City, OK 73102

Name of Agent:

Mr. Timothy W. Johnson, P.E.
Johnson & Associates, Inc.
1 East Sheridan Avenue, Second Floor
Oklahoma City, OK 73104

Location: The proposed project is located in Sections 7 and 8, Township 11 North, Range 3 West, within Twin Creek, Oklahoma County, Oklahoma. The project site can be found on the Oklahoma City, Oklahoma 7.5 Minute USGS Quadrangle map.

Latitude: 35.4470

Longitude: -97.5472 Decimal Degrees (NAD83)

Purpose: The basic purpose of this work is to increase flow capacity of the existing stream channel, which is part of the city's storm sewer conveyance system.

A water dependency determination will be made upon consideration of the basic purpose for the placement of fill material for the widening of existing concrete lined and RCB stream channel.

The overall purpose of this work is to alleviate storm sewer system flooding and the subsequent flooding of surrounding residential and commercial properties.

Description of Work: The applicant proposes the placement of fill material into jurisdictional waters located within Twin Creek. There are a total of 2,570 linear feet (lf) of stream proposed for widening by this project. Approximately 1,122 lf of existing concrete lined channel would be removed and widened from 15 to 25 feet (ft). The concrete lining would then be replaced within

the widened channel. Immediately downstream of the concrete lined channel the applicant proposes to add 1,448 lf of two 10 ft wide RCB's to the existing two 10 ft wide RCB's. The existing RCB's are not proposed to be removed. The streams existing alignment is not proposed to be altered just widened.

All demolition and dredge material would be removed from the project site and would be hauled off-site to an upland disposal area. The work would be performed using conventional earthmoving equipment.

Avoidance and Minimization Information: The applicant provided the following statement with regard to why avoidance and minimization of impacts to aquatic resources could not be incorporated into the project plan:

“Due to the location, nature, limits, and purpose of the project, disturbance to waters of the U.S. cannot be avoided or minimized.”

The applicant has not provided any alternative designs.

Mitigation: The applicant has not proposed any compensatory mitigation for unavoidable impacts to aquatic resources expected from the proposed project. The applicant provided the following statement regarding compensatory mitigation:

“This project will increase the area of waters of the U.S.; therefore, compensation or mitigation is not required.”

The Corps has made no determination at this time with regard to mitigation relative to the federal mitigation rules and guidance, including Tulsa District's Mitigation and Monitoring Guidelines. The Corps is accepting comments on the need for and nature of mitigation in addition to comments on the applicant's primary proposal. The Corps bears the final decision on the need for and extent of mitigation required if the project proposed herein is authorized.

Project Setting: This project is located within the limits of the State of Oklahoma, in the Cross Timbers Transition of the Central Great Plains ecoregion. The transition is nearly level and is susceptible to flooding. The area surrounding the project includes a mixture of residential and commercial properties.

Plans and Data: Plans showing the location of the proposed activity and other data are enclosed with this notice (Enclosures 1 through 4). If additional information is desired, it may be obtained from Mr. Jamie Hyslop, U.S. Army Corps of Engineers, Tulsa District, ATTN: Regulatory Office, 1645 South 101st East Avenue, Tulsa, OK 74128-4609, or telephone 918-669-7618.

Cultural Resources: The DE has consulted the National Register of Historic Places, and it has been determined that there are no properties currently listed in the National Register which

would be directly affected by the proposed work. Additionally, the proposed project is not known to be in the vicinity of properties eligible for listing. This public notice is also being sent to the State Historic Preservation Officer and to Native American Tribal governments to reveal if other known historic or archeological resources that might be eligible for listing in the National Register exist in the project area and which could be directly affected by the proposed work. This coordination is being done to fulfill our requirements under the National Historic Preservation Act of 1966 (Public Law 89-665) and associated historic preservation laws. If we are made aware, as a result of comments received in response to this notice, or by other means, of specific archeological or other historic properties which might be affected by the proposed work, the DE would immediately take the appropriate action necessary pursuant to the National Historic Preservation Act of 1966 (as amended) and 36 CFR Part 800 (Protection of Historic Properties), in accordance with implementing regulations 33 CFR Part 325, Appendix C (Procedures for the Protection of Historic Properties).

Threatened and Endangered Species: The following federally-listed species were generated utilizing the U.S. Fish and Wildlife Service's Information, Planning, and Consultation (IPAC) System. The IPAC system generated the following species list that may occur at the proposed project location: Interior Least tern (*Sterna antillarum*), Piping plover (*Charadrius melodus*), and Whooping crane (*Grus Americana*). A copy of this notice is being furnished to the U.S. Fish and Wildlife Service and appropriate state agencies. This notice constitutes a request to those agencies for information on whether any other listed or proposed-to-be-listed endangered or threatened species may be present in the area which would be affected by the proposed activity.

Environmental Considerations: The decision whether to issue a permit will be based on an evaluation of the probable impact including cumulative impacts of the proposed activity and its intended use on the public interest. That decision will reflect the national concern for both protection and utilization of important resources. The benefit which reasonably may be expected to accrue from the proposal must be balanced against its reasonably foreseeable detriments. All factors which may be relevant to the proposal will be considered, including the cumulative effects thereof; among those are conservation, economics, aesthetics, general environmental concerns, wetlands, historic properties, fish and wildlife values, flood hazards, flood plain values, land use, navigation, shoreline erosion and accretion, recreation, water supply and conservation, water quality, energy needs, safety, food and fiber production, mineral needs, considerations of property ownerships, and, in general, the needs and welfare of the people. A permit will be denied if the discharge does not comply with the Environmental Protection Agency's 404(b)(1) Guidelines. Subject to the 404(b)(1) Guidelines and any other applicable guidelines or criteria, a permit will be granted unless the DE determines that it would be contrary to the public interest.

Comments: The Corps is soliciting comments from the public; federal, state, and local agencies and officials; Indian tribes, and other interested parties in order to consider and evaluate the impacts of this proposed activity. Comments concerning the issuance of this permit should be received by the DE no later than 30 days from the date of this public notice. Any comments received will be considered by the Corps to determine whether to issue, modify, condition, or

deny a permit for this proposal. To make this decision, comments are used to assess impacts on endangered species, historic properties, water quality, general environmental effects, and the other public interest factors listed above. Comments are used in the preparation of an Environmental Assessment and/or an Environmental Impact Statement pursuant to the National Environmental Policy Act. Comments are also used to determine the need for a public hearing and to determine the overall public interest of the proposed activity. Any person may request in writing, within the comment period specified in this notice, that a public hearing be held to consider this application. Requests for public hearings shall state, with particularity, the reasons for holding a public hearing.

At the request of the Oklahoma Water Resources Board's National Flood Insurance Program State Coordinator, we are sending a copy of this notice to the local flood plain administrator to apprise the administrator of proposed development within their jurisdiction. In accordance with 44 CFR Part 60 (Flood Plain Management Regulations Criteria for Land Management and Use), participating communities are required to review all proposed development to determine if a flood plain development permit is required. The local Flood Plain Administrator is required to perform this review for all proposed development and maintain records of such review.

Comments concerning water quality impacts will be forwarded to the ODEQ for consideration in issuing a water quality Section 401 certification for the proposed project. Work may **not** commence until decisions have been made on both Sections 401 and 404 of the CWA.

Andrew R. Commer
Chief, Regulatory Office

Enclosures

PROJECT No. DC-0271

BROCK CREEK & TWIN CREEK IN THE VICINITY OF S.W. 19th ST. & S. WESTWOOD BLVD. TO S.W. 15th ST. & S. BARNES AVE.

DRAINAGE IMPROVEMENTS

TWIN CREEK DRAINAGE STUDY
FINAL REPORT
 For
PHASE I - SW 2ND & EAST AVENUE TO SW 15th & PORTLAND AVENUE
PHASE II - SW 2ND & EAST AVENUE TO SOUTHWESTERN OF BROCK CREEK & TWIN CREEK
 Prepared for
THE OKLAHOMA CITY MUNICIPAL FACILITIES AUTHORITY
 Project No. DC-0271
 FEBRUARY, 2014
 PREPARED BY
COOK ENGINEERING, INC.
 1000 N. WESTWOOD BLVD., SUITE 200
 OKLAHOMA CITY, OK 73120
REPORT AT WESTWOOD
 DEVELOPED FLOW WITHOUT DETENTION = 5206 CFS
 DEVELOPED FLOW WITH DETENTION = 3963 CFS
 (3 POND)

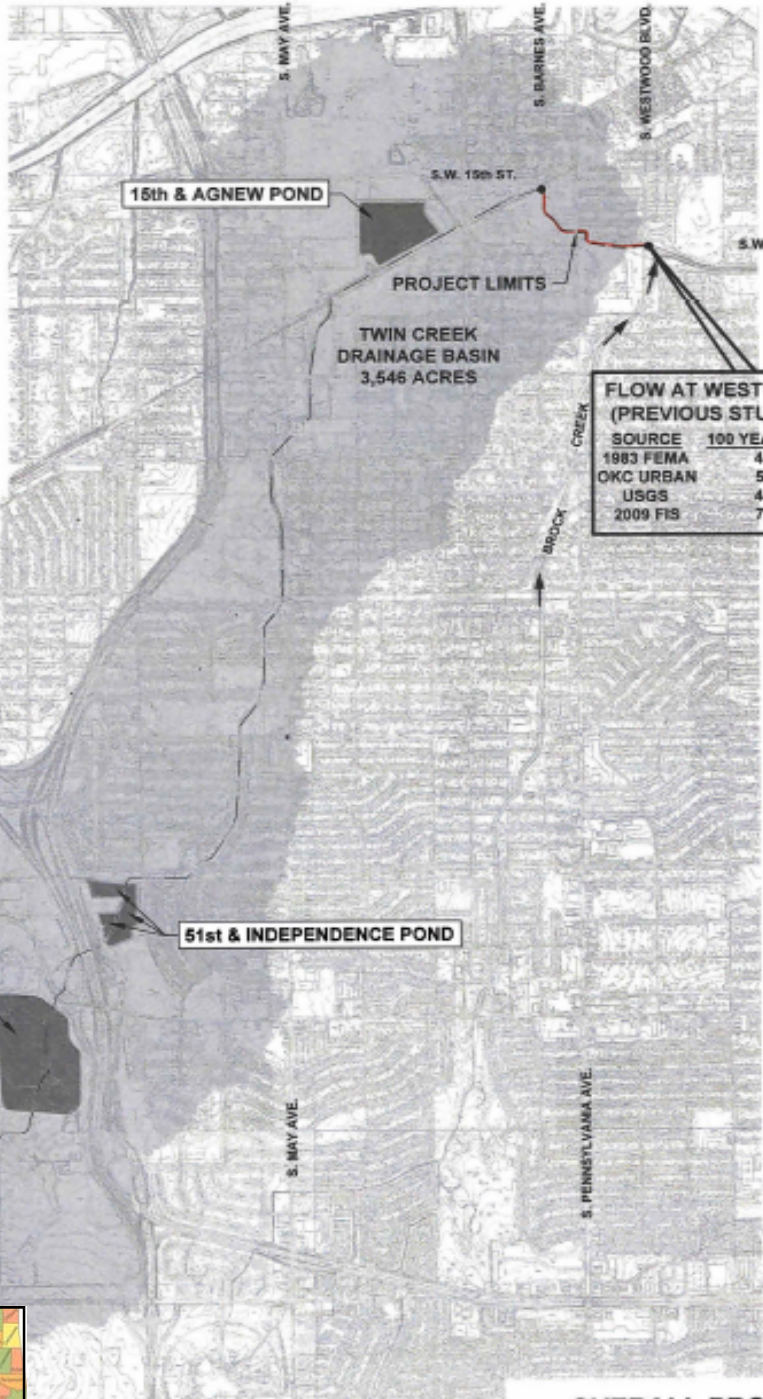

FLOW AT WESTWOOD (PREVIOUS STUDIES)

SOURCE	100 YEAR FLOW
1983 FEMA	4285
OKC URBAN	5681
USGS	4060
2009 FIS	7961



Project Location

SWT-2012-793
 Oklahoma City Twin Creek
 Drainage Improvements
 Oklahoma County, OK
 Enclosure 1 of 4

OVERALL PROJECT DESCRIPTION

Johnson & Associates, Inc.
 11 S. Sheridan Ave., Suite 200
 Oklahoma City, OK 73104
 (405) 241-1000
 www.ja-engineers.com

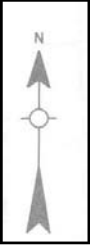

CITY OF OKLAHOMA CITY PROJECT DC-0271
TWIN CREEK DRAINAGE IMPROVEMENTS
SWT-2012-793

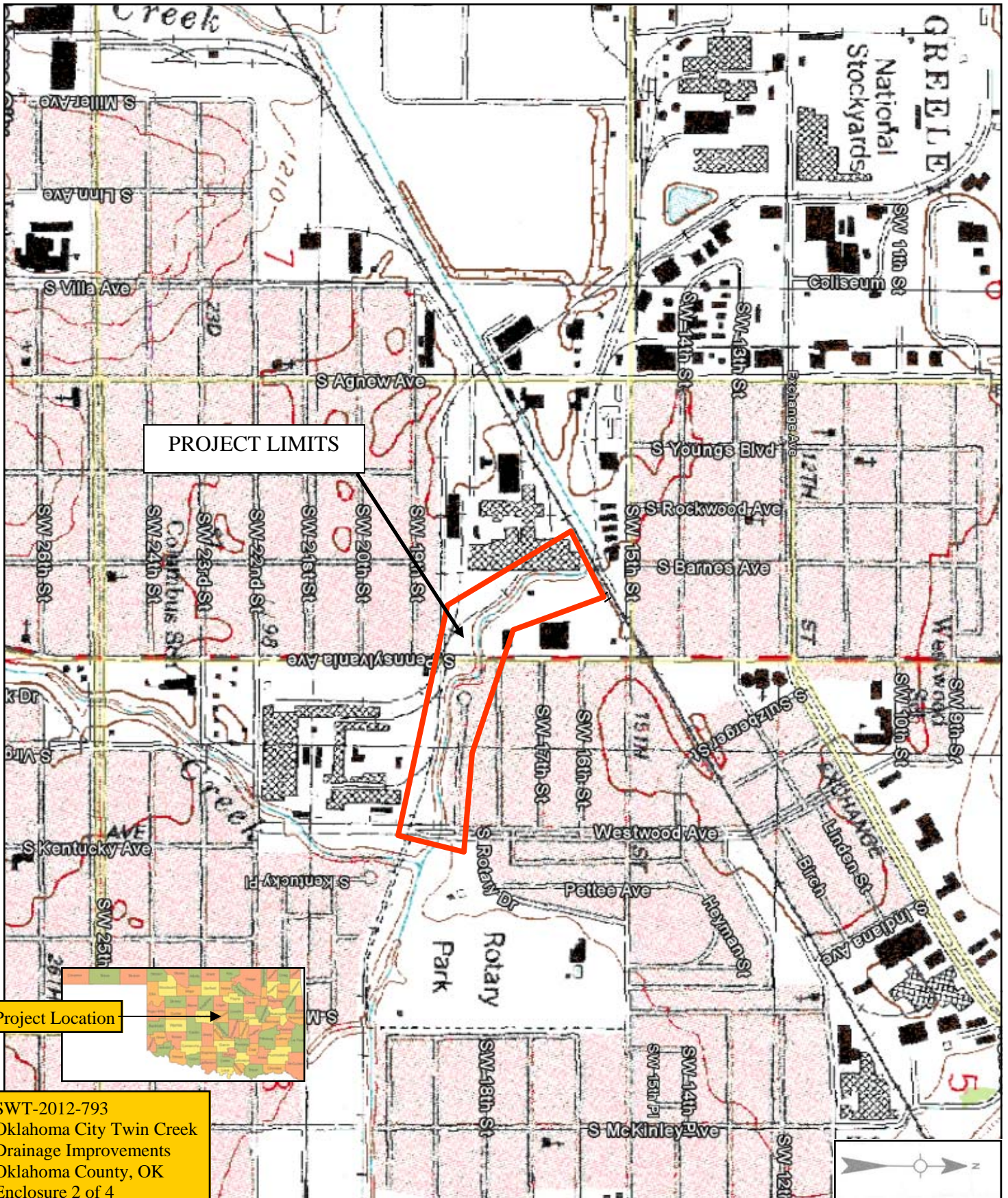

PROJECT LIMITS

Project Location

SWT-2012-793
Oklahoma City Twin Creek
Drainage Improvements
Oklahoma County, OK
Enclosure 2 of 4

PROJECT No. DC-0271

BROCK CREEK & TWIN CREEK IN THE VICINITY OF S.W. 19th ST. & S. WESTWOOD BLVD. TO S.W. 15th ST. & S. BARNES AVE. DRAINAGE IMPROVEMENTS



CHANNEL "N"
PROPOSED CHANNEL SECTION
25' BOTTOM 8' DEEP

STRUCTURE #15
ADDITIONAL (2) 10'x 7' RCB

APPROX. ±1448 LF

Project Location

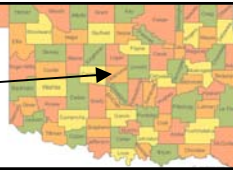

SWT-2012-793
Oklahoma City Twin Creek
Drainage Improvements
Oklahoma County, OK
Enclosure 3 of 4

SPECIFIC PROJECT DESCRIPTION

 Johnson & Associates, Inc.
1 E. Sheridan Ave., Suite 200
Oklahoma City, OK 73104
918.242.1111 Fax 918.242.1112
COURTESY OF J&A ASSOCIATES, INC. Rev. Date 06.20.2010
ENGINEER SURVEYOR PLANNER

PROJECT No. DC-0271

BROCK CREEK & TWIN CREEK IN THE VICINITY OF S.W. 19th ST. &
S. WESTWOOD BLVD. TO S.W. 15th ST. & S. BARNES AVE.

DRAINAGE IMPROVEMENTS

INCREASE IN WATERS OF THE UNITED STATES (WOUS)			
STRUCTURE TYPE	LENGTH (FT)	ADDITIONAL BOTTOM WIDTH	INCREASED AREAS (AC.)
CONCRETE LINED CHANNEL	1122'	10'	0.267
REINFORCED CONCRETE BOX	1448'	20'	0.664

TOTAL INCREASE IN WOUS = 0.921 AC.

CONFIGURATION



CONCRETE CHANNEL LINER JOINT DETAIL

FOR WALL HEIGHT ABOVE 5'
6" WALLS FOR 33 THE WALL HEIGHT ABOVE 5'
WALL DETAIL "C"

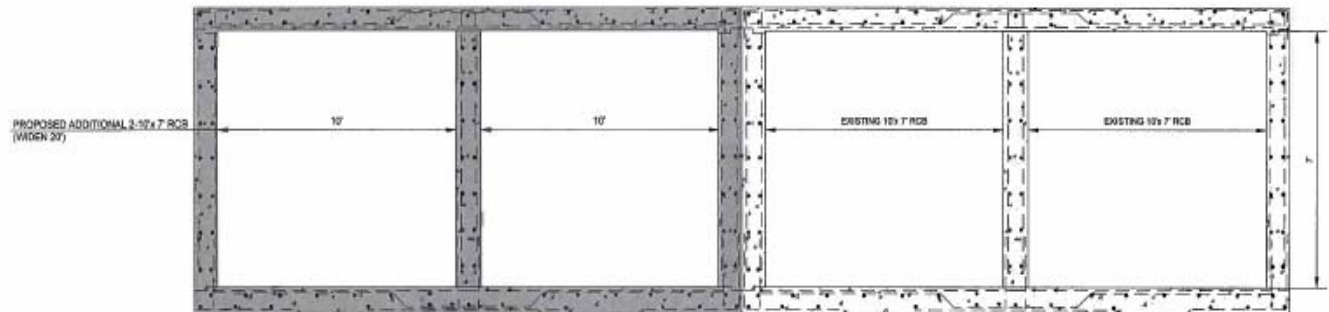

TYPICAL BARREL SECTION
2 - 10x7 RCB

Project Location



SWT-2012-793
Oklahoma City Twin Creek
Drainage Improvements
Oklahoma County, OK
Enclosure 4 of 4