

J.1 Hanford Site Map

The Hanford Site is located in southeastern Washington and covers 540 square miles of land north of Richland, Washington. The site is bounded on the north and east by the Columbia River. Within the Hanford Site are several areas where former defense production facilities are located.

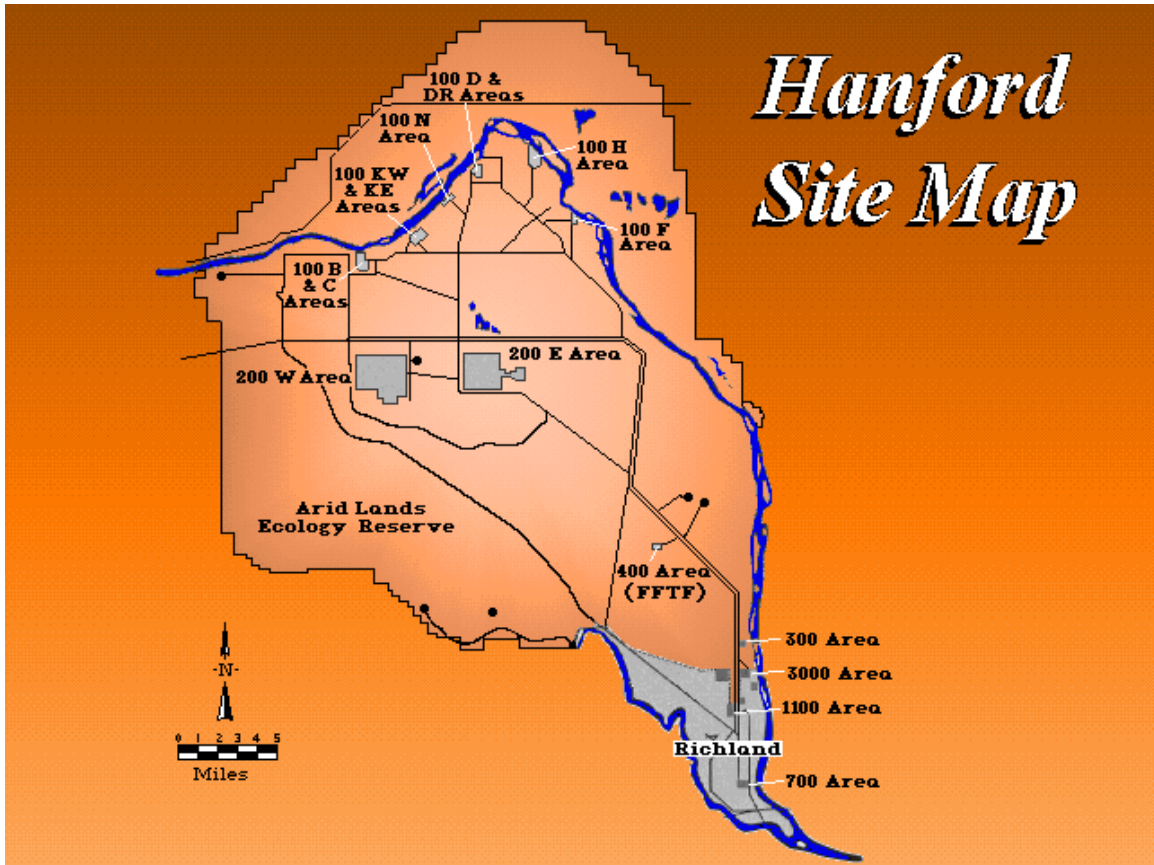

J.2 Government-Furnished Property

Government-furnished property associated with this contract may change during contract performance. The Government-furnished equipment as of February 24, 2003, is as follows:

Government-Furnished Property (GFP) Inventory							
Identifier	Official Name	Manufacturer	Model	Quantity	Site	Building	Room
WC36043	EMBOSSER	DATA CODE	220	1	RCHN	1979SNYDER	N20
WC45089	BOOTH	INDUSTRIAL ACOUSTIC	BOOTH	1	RCHN	1979SNYDER	142
WC54531	EXAMINATION TABLE	MIDMARK	411	1	200W	2719WB	W23
WC54532	EXAMINATION TABLE	MIDMARK	411	1	200W	2719WB	W24
WC54533	EXAMINATION TABLE	MIDMARK	411	1	RCHN	1979SNYDER	108
WC54534	EXAMINATION TABLE	MIDMARK	411	1	200W	2719WB	W25
WC54535	EXAMINATION TABLE	MIDMARK	411	1	RCHN	1979SNYDER	125
WC54536	EXAMINATION TABLE	MIDMARK	411	1	RCHN	1979SNYDER	123
WC54537	EXAMINATION TABLE	MIDMARK	411	1	RCHN	1979SNYDER	110
WC55152	EXAMINATION TABLE	MIDMARK	411009	1	RCHN	1979SNYDER	106
WC55153	EXAMINATION TABLE	MIDMARK	411009	1	RCHN	1979SNYDER	107
WC55154	EXAMINATION TABLE	MIDMARK	411009	1	RCHN	1979SNYDER	111
WC55155	EXAMINATION TABLE	MIDMARK	411009	1	RCHN	1979SNYDER	160
WC55176	WORK CUBE	ADVANCED THERAPY	WC100	1	RCHN	1979SNYDER	WORK COND BAY
WC56196	CARDIOGRAPH	HEWLETT PACKARD	M1700A	1	RCHN	1979SNYDER	125
WC66455	COMPUTER	DELL COMPUTER	GX1108860133	1	RCHN	1979SNYDER	N19
WC68896	COMPUTER	DELL COMPUTER	PRECISION 410	1	RCHN	1979SNYDER	C19
WC71013	COMPUTER	DELL COMPUTER	GX110	1	RCHN	1979SNYDER	N19
WC76510	COMPUTER	DELL COMPUTER	GX110	1	RCHN	1979SNYDER	N19
WC76512	COMPUTER	DELL COMPUTER	GX110	1	RCHN	1979SNYDER	N19
WC76569	CARDIOGRAPH	HEWLETT PACKARD	M1700A	1	200W	2719WB	W33
WC77902	LAPTOP	DELL COMPUTER	LATITUDE C810	1	RCHN	1979SNYDER	106
WC77906	COMPUTER	DELL COMPUTER	PRECISION 340	1	RCHN	1979SNYDER	C42
WC78003	AUDIO BOOTH	ECKOUSTIC	CL12	1	200W	2719WB	W28
WC78005	TONOMETER	LEICHA MICROSYSTEMS	AT550	1	200W	2719WB	W22
WC78006	XRAY SYSTEM	XRAY MARKETING ASSOC	A360	1	200W	2719WB	W31
WC78008	TONOMETER	LEICHA MICROSYSTEMS	XPRT NCT PLUS	1	200W	2719WB	W33
WC78010	STRESS TEST SYSTEM	QUINTON	NP200115	1	RCHN	1979SNYDER	N6
WC78013	TONOMETER	LEICHA MICROSYSTEMS	AT550	1	RCHN	1979SNYDER	125
WC78015	TONOMETER	LEICHA MICROSYSTEMS	XPRT NCT PLUS	1	RCHN	1979SNYDER	125
WC78017	TONOMETER	REICHERT	13900	1	RCHN	1979SNYDER	145
WC78021	TONOMETER	LEICHA MICROSYSTEMS	XPRT NCT PLUS	1	RCHN	1979SNYDER	144

Government-Furnished Property (GFP) Inventory							
Identifier	Official Name	Manufacturer	Model	Quantity	Site	Building	Room
WC78023	PLASMA MONITOR	NEC	42MP2	1	RCHN	1979SNYDER	WORK COND BAY
WC78025	SLIT LAMP	NIKON	NS1	1	RCHN	1979SNYDER	160
WC78044	MICRO PRINTER	CANON	DMP400	1	RCHN	1979SNYDER	N18
WC78048	FILESERVER	DELL COMPUTER	POWEREDGE 2550	1	RCHN	1979SNYDER	137
WC78049	FILESERVER	DELL COMPUTER	POWEREDGE 6450	1	RCHN	1979SNYDER	137
WC78076	TONOMETER	REICHERT	13900	1	RCHN	1979SNYDER	125
WC79114	FILESERVER	NETWORK APPLIANCE	F810	1	RCHN	1979SNYDER	137
WC79115	FILESERVER	DELL COMPUTER	POWEREDGE 1650	1	RCHN	1979SNYDER	137
WC79116	FILESERVER	DELL COMPUTER	POWEREDGE 1650	1	RCHN	1979SNYDER	137
WC79117	FILESERVER	DELL COMPUTER	POWEREDGE 2650	1	RCHN	1979SNYDER	137
WC79118	FILESERVER	COMPAQ	DL380 FILESERVER	1	RCHN	1979SNYDER	137
WC79130	COMPUTER	DELL COMPUTER	GX260S	1	700	825JADWIN	EOC
WC79561	COMPUTER	DELL COMPUTER	GX260S	1	RCHN	1979SNYDER	C22
WC79570	COMPUTER	DELL COMPUTER	GX260S	1	RCHN	1979SNYDER	C22
WC79584	LAPTOP	DELL COMPUTER	LATITUDE C400	1	RCHN	1979SNYDER	N18
WC79596	CAMERA	KODAK	DX4330	1	RCHN	1979SNYDER	N5
WC79611	CAMERA	KODAK	DX4900	1	RCHN	1979SNYDER	123
WC79612	CAMERA	KODAK	DX4900	1	200W	2719WB	W25
WC79613	CAMERA	KODAK	DX4900	1	RCHN	1979SNYDER	137
WC80556	EVALUATION SYSTEM	TRIFIT	600	1	RCHN	1979SNYDER	WORK COND BAY
WC80578	READER PRINTER	MINOLTA	MS6000	1	RCHN	1979SNYDER	C41
WC88086	FILESERVER	DELL COMPUTER	POWEREDGE 2650	1	RCHN	1979SNYDER	137
WC88172	LAPTOP	HEWLETT PACKARD	TC1100	1	RCHN	1979SNYDER	137
WC88173	PLASMA MONITOR	NEC	PX42XM2A	1	RCHN	1979SNYDER	159
WC88179	FILESERVER	DELL COMPUTER	POWEREDGE 2850	1	RCHN	1979SNYDER	137
WC90043	ECG TREADMILL	QUINTON	QSTRESS	1	RCHN	1979SNYDER	N7
WC90055	FILESERVER	DELL COMPUTER	POWEREDGE 2850	1	RCHN	1979SNYDER	137
WC90057	COMPUTER	DELL COMPUTER	PRECISION 380	1	RCHN	1979SNYDER	HOME
WC90058	COMPUTER	DELL COMPUTER	PRECISION 380	1	RCHN	1979SNYDER	HOME
WC90059	LAPTOP	DELL COMPUTER	PRECISION M70	1	RCHN	1979SNYDER	C22
WC90323	COMPUTER	DELL COMPUTER	PRECISION 380	1	RCHN	1979SNYDER	C18
WC90325	COMPUTER	DELL COMPUTER	PRECISION 380	1	RCHN	1979SNYDER	HOME

Government-Furnished Property (GFP) Inventory							
Identifier	Official Name	Manufacturer	Model	Quantity	Site	Building	Room
WC90328	LAPTOP	DELL COMPUTER	LATITUDE D510	1	RCHN	1979SNYDER	C22
WC90340	COMPUTER	DELL COMPUTER	GX520	1	RCHN	1979SNYDER	N13
WC91005	COMPUTER	DELL COMPUTER	GX620 SFF	1	RCHN	1979SNYDER	C19
WC91008	COMPUTER	DELL COMPUTER	GX620 SFF	1	RCHN	1979SNYDER	C22
WC91009	COMPUTER	DELL COMPUTER	GX620 SFF	1	RCHN	1979SNYDER	C22
WC91010	LAPTOP	DELL COMPUTER	LATITUDE D510	1	RCHN	1979SNYDER	C22
WC91011	LAPTOP	DELL COMPUTER	LATITUDE D820	1	RCHN	1979SNYDER	C22
WC91012	LAPTOP	DELL COMPUTER	LATITUDE D820	1	RCHN	1979SNYDER	C22
WC91013	FILESERVER	DELL COMPUTER	POWEREDGE 2850	1	RCHN	1979SNYDER	137
WC92025	COMPUTER	DELL COMPUTER	PRECISION 390	1	RCHN	1979SNYDER	C19
WC92065	DEFIBRILLATOR	MEDTRONIC PHYSIO CONTROL	LP12	1	RCHN	1979SNYDER	123
WC92066	DEFIBRILLATOR	MEDTRONIC PHYSIO CONTROL	LP12	1	200W	2719WB	W23
WC92067	PRINTER	DATACARD	275	1	RCHN	1979SNYDER	C4
WC92072	XRAY SYSTEM	XRAY MARKETING ASSOC	S210	1	RCHN	1979SNYDER	141
WC92074	FILESERVER	NETWORK APPLIANCE	FAS250	1	RCHN	1979SNYDER	137
WC92076	COMPUTER	DELL COMPUTER	OPTIPLEX 745	1	RCHN	1979SNYDER	N10
WC92077	COMPUTER	DELL COMPUTER	OPTIPLEX 745	1	RCHN	1979SNYDER	C22
WC92078	COMPUTER	DELL COMPUTER	OPTIPLEX 745	1	RCHN	1979SNYDER	C22
WC92079	COMPUTER	DELL COMPUTER	OPTIPLEX 745	1	RCHN	1979SNYDER	C22
WC92141	COMPUTER	DELL COMPUTER	OPTIPLEX 745	1	RCHN	1979SNYDER	C22
WC92142	COMPUTER	DELL COMPUTER	OPTIPLEX 745	1	RCHN	1979SNYDER	C22
WC92143	COMPUTER	DELL COMPUTER	OPTIPLEX 745	1	RCHN	1979SNYDER	C22
WC92144	COMPUTER	DELL COMPUTER	OPTIPLEX 745	1	RCHN	1979SNYDER	C22
WC92145	COMPUTER	DELL COMPUTER	OPTIPLEX 745	1	RCHN	1979SNYDER	C22
WC92146	COMPUTER	DELL COMPUTER	OPTIPLEX 745	1	RCHN	1979SNYDER	C22
WC92161	COMPUTER	DELL COMPUTER	PRECISION 390	1	RCHN	1979SNYDER	136
WC92162	PROJECTOR	PANASONIC	PT-D4000U	1	RCHN	1979SNYDER	136
WC92168	MICROFILM SCANNER	CANON	MS300II	1	RCHN	1979SNYDER	C41
WC92169	MICROFILM SCANNER	CANON	MS300II	1	RCHN	1979SNYDER	C42
WC92170	COMPUTER	DELL COMPUTER	OPTIPLEX 740SFF	1	RCHN	1979SNYDER	130
WC92171	COMPUTER	DELL COMPUTER	OPTIPLEX 740SFF	1	RCHN	1979SNYDER	N22
WC92172	COMPUTER	DELL COMPUTER	OPTIPLEX 740SFF	1	RCHN	1979SNYDER	N21

Government-Furnished Property (GFP) Inventory							
Identifier	Official Name	Manufacturer	Model	Quantity	Site	Building	Room
WC92173	COMPUTER	DELL COMPUTER	OPTIPLEX 740SFF	1	RCHN	1979SNYDER	133
WC92174	COMPUTER	DELL COMPUTER	OPTIPLEX 740SFF	1	RCHN	1979SNYDER	134
WC92175	COMPUTER	DELL COMPUTER	OPTIPLEX 740SFF	1	200W	2719WB	W28
WC92176	COMPUTER	DELL COMPUTER	OPTIPLEX 740SFF	1	RCHN	1979SNYDER	C35
WC92177	COMPUTER	DELL COMPUTER	OPTIPLEX 740SFF	1	RCHN	1979SNYDER	C22
WC92178	COMPUTER	DELL COMPUTER	OPTIPLEX 740SFF	1	RCHN	1979SNYDER	C22
WC92179	COMPUTER	DELL COMPUTER	OPTIPLEX 740SFF	1	RCHN	1979SNYDER	115
WC93021	CAMCORDER	SONY	HDR-HC3 HDV 1080	1	RCHN	1979SNYDER	137
WC95029	TAPE DRIVE	DELL COMPUTER	LT04-EH1	1	700	825JADWIN	3RD FLR VAULT
WC95030	POWER VAULT LIBRARY	DELL COMPUTER	TL4000	1	RCHN	1979SNYDER	137
WC95045	SPYROMETER	SENSORMEDICS	OMIS1022-OMI	1	RCHN	1979SNYDER	145
WC95046	SPYROMETER	SENSORMEDICS	OMIS1022-OMI	1	RCHN	1979SNYDER	144
WC95047	SPYROMETER	SENSORMEDICS	OMIS1022-OMI	1	RCHN	1979SNYDER	143
WC95048	SPYROMETER	SENSORMEDICS	OMIS1022-OMI	1	RCHN	1979SNYDER	125
WC95049	SPYROMETER	SENSORMEDICS	OMIS1022-OMI	1	RCHN	1979SNYDER	125
WC95050	SPYROMETER	SENSORMEDICS	OMIS1022-OMI	1	200W	2719WB	W30
WC95051	SPYROMETER	SENSORMEDICS	OMIS1022-OMI	1	200W	2719WB	W36
WC96401	COMPUTER	DELL COMPUTER	OPTIPLEX 760SFF	1	RCHN	1979SNYDER	C4
WC96402	COMPUTER	DELL COMPUTER	OPTIPLEX 760SFF	1	RCHN	1979SNYDER	N18
WC96403	COMPUTER	DELL COMPUTER	OPTIPLEX 760SFF	1	RCHN	1979SNYDER	N17
WC96404	COMPUTER	DELL COMPUTER	OPTIPLEX 760SFF	1	RCHN	1979SNYDER	N16
WC96405	COMPUTER	DELL COMPUTER	OPTIPLEX 760SFF	1	RCHN	1979SNYDER	N15
WF11040	FILESERVER	DELL COMPUTER	POWER EDGE 2950	1	RCHN	1979SNYDER	137
WF11041	FILESERVER	DELL COMPUTER	POWER EDGE 2950	1	RCHN	1979SNYDER	137
WF13134	FILESERVER	DELL COMPUTER	POWEREDGE R710	1	RCHN	1979SNYDER	137
WF18577	FILESERVER	DELL COMPUTER	POWEREDGE R710	1	RCHN	1979SNYDER	137
WF18578	FILESERVER	DELL COMPUTER	POWEREDGE R710	1	RCHN	1979SNYDER	137
WF18659	SERVER	DELL COMPUTER	POWERSVAULT MD3	1	RCHN	1979SNYDER	137
WF18660	FILESERVER	DELL COMPUTER	POWEREDGE R810	1	RCHN	1979SNYDER	137
WF18661	FILESERVER	DELL COMPUTER	POWEREDGE R810	1	RCHN	1979SNYDER	137
WF18662	FILESERVER	DELL COMPUTER	POWEREDGE R810	1	RCHN	1979SNYDER	137
WF19233	CARDIOGRAPH	PHILIPS	TC70	1	RCHN	1979SNYDER	125

Government-Furnished Property (GFP) Inventory							
Identifier	Official Name	Manufacturer	Model	Quantity	Site	Building	Room
WF19234	CARDIOGRAPH	PHILIPS	TC70	1	RCHN	1979SNYDER	143
WF19235	CARDIOGRAPH	PHILIPS	TC70	1	RCHN	1979SNYDER	144
WF19236	CARDIOGRAPH	PHILIPS	TC70	1	RCHN	1979SNYDER	145
WF19237	CARDIOGRAPH	PHILIPS	TC70	1	200W	2719WB	W30
WF19238	CARDIOGRAPH	PHILIPS	TC70	1	200W	2719WB	W36
WF19239	CARDIOGRAPH	PHILIPS	TC70	1	200W	2719WB	W25
WF19242	FILESERVER	DELL COMPUTER	POWEREDGE R710	1	RCHN	1979SNYDER	137
WF20000	COMPUTER	DELL COMPUTER	PRECISION T5500	1	RCHN	1979SNYDER	C20
WF20001	COMPUTER	DELL COMPUTER	PRECISION T5500	1	RCHN	1979SNYDER	N26
WF20002	COMPUTER	DELL COMPUTER	PRECISION T5500	1	RCHN	1979SNYDER	129
WF20003	COMPUTER	DELL COMPUTER	PRECISION T5500	1	RCHN	1979SNYDER	142
WF20004	COMPUTER	DELL COMPUTER	PRECISION T5500	1	RCHN	1979SNYDER	C24
WF20005	COMPUTER	DELL COMPUTER	PRECISION T5500	1	RCHN	1979SNYDER	N29
WF20006	COMPUTER	DELL COMPUTER	PRECISION T5500	1	RCHN	1979SNYDER	N29
WF20007	COMPUTER	DELL COMPUTER	PRECISION T5500	1	RCHN	1979SNYDER	C18
WF20008	COMPUTER	DELL COMPUTER	OPTIPLEX 760SFF	1	RCHN	1979SNYDER	C40
WF20009	COMPUTER	DELL COMPUTER	OPTIPLEX 760SFF	1	RCHN	1979SNYDER	C39
WF20010	COMPUTER	DELL COMPUTER	OPTIPLEX 760SFF	1	RCHN	1979SNYDER	C38
WF20011	COMPUTER	DELL COMPUTER	OPTIPLEX 760SFF	1	RCHN	1979SNYDER	107
WF20012	COMPUTER	DELL COMPUTER	OPTIPLEX 760SFF	1	RCHN	1979SNYDER	109
WF20013	COMPUTER	DELL COMPUTER	OPTIPLEX 760SFF	1	RCHN	1979SNYDER	110
WF20014	COMPUTER	DELL COMPUTER	OPTIPLEX 760SFF	1	RCHN	1979SNYDER	108
WF20015	COMPUTER	DELL COMPUTER	OPTIPLEX 760SFF	1	RCHN	1979SNYDER	106
WF20016	COMPUTER	DELL COMPUTER	OPTIPLEX 760SFF	1	RCHN	1979SNYDER	C36
WF20017	COMPUTER	DELL COMPUTER	OPTIPLEX 760SFF	1	RCHN	1979SNYDER	C25
WF20018	COMPUTER	DELL COMPUTER	OPTIPLEX 760SFF	1	RCHN	1979SNYDER	C26
WF20019	COMPUTER	DELL COMPUTER	OPTIPLEX 760SFF	1	RCHN	1979SNYDER	111
WF20020	COMPUTER	DELL COMPUTER	OPTIPLEX 760SFF	1	RCHN	1979SNYDER	112
WF20021	COMPUTER	DELL COMPUTER	OPTIPLEX 760SFF	1	RCHN	1979SNYDER	N24
WF20022	COMPUTER	DELL COMPUTER	OPTIPLEX 760SFF	1	RCHN	1979SNYDER	C37
WF20023	COMPUTER	DELL COMPUTER	OPTIPLEX 760SFF	1	RCHN	1979SNYDER	C2
WF20024	COMPUTER	DELL COMPUTER	OPTIPLEX 760SFF	1	RCHN	1979SNYDER	C5

Government-Furnished Property (GFP) Inventory							
Identifier	Official Name	Manufacturer	Model	Quantity	Site	Building	Room
WF20025	COMPUTER	DELL COMPUTER	OPTIPLEX 760SFF	1	RCHN	1979SNYDER	C6
WF20026	COMPUTER	DELL COMPUTER	OPTIPLEX 760SFF	1	RCHN	1979SNYDER	C3
WF20027	COMPUTER	DELL COMPUTER	OPTIPLEX 760SFF	1	RCHN	1979SNYDER	C4
WF20028	COMPUTER	DELL COMPUTER	OPTIPLEX 760SFF	1	RCHN	1979SNYDER	LOBBY
WF20029	COMPUTER	DELL COMPUTER	OPTIPLEX 760SFF	1	RCHN	1979SNYDER	LOBBY
WF20030	COMPUTER	DELL COMPUTER	OPTIPLEX 760SFF	1	200W	2719WB	W31
WF20031	COMPUTER	DELL COMPUTER	OPTIPLEX 760SFF	1	RCHN	1979SNYDER	C21
WF20032	COMPUTER	DELL COMPUTER	OPTIPLEX 760SFF	1	RCHN	1979SNYDER	113
WF20033	COMPUTER	DELL COMPUTER	OPTIPLEX 760SFF	1	RCHN	1979SNYDER	N33
WF20034	COMPUTER	DELL COMPUTER	OPTIPLEX 760SFF	1	RCHN	1979SNYDER	N14
WF20035	COMPUTER	DELL COMPUTER	OPTIPLEX 760SFF	1	RCHN	1979SNYDER	114
WF20036	COMPUTER	DELL COMPUTER	OPTIPLEX 760SFF	1	RCHN	1979SNYDER	129
WF20037	COMPUTER	DELL COMPUTER	OPTIPLEX 760SFF	1	RCHN	1979SNYDER	141
WF20038	COMPUTER	DELL COMPUTER	OPTIPLEX 760SFF	1	RCHN	1979SNYDER	C32
WF20039	COMPUTER	DELL COMPUTER	OPTIPLEX 760SFF	1	RCHN	1979SNYDER	143
WF20040	COMPUTER	DELL COMPUTER	OPTIPLEX 760SFF	1	RCHN	1979SNYDER	125
WF20041	COMPUTER	DELL COMPUTER	OPTIPLEX 760SFF	1	RCHN	1979SNYDER	145
WF20042	COMPUTER	DELL COMPUTER	OPTIPLEX 760SFF	1	RCHN	1979SNYDER	144
WF20043	COMPUTER	DELL COMPUTER	OPTIPLEX 760SFF	1	RCHN	1979SNYDER	161
WF20044	COMPUTER	DELL COMPUTER	OPTIPLEX 760SFF	1	RCHN	1979SNYDER	C13
WF20045	COMPUTER	DELL COMPUTER	OPTIPLEX 760SFF	1	RCHN	1979SNYDER	123
WF20046	COMPUTER	DELL COMPUTER	OPTIPLEX 760SFF	1	RCHN	1979SNYDER	160
WF20047	COMPUTER	DELL COMPUTER	OPTIPLEX 760SFF	1	RCHN	1979SNYDER	C22
WF20048	COMPUTER	DELL COMPUTER	OPTIPLEX 760SFF	1	RCHN	1979SNYDER	C22
WF20049	COMPUTER	DELL COMPUTER	OPTIPLEX 760SFF	1	RCHN	1979SNYDER	C22
WF20050	COMPUTER	DELL COMPUTER	OPTIPLEX 760SFF	1	RCHN	1979SNYDER	C7
WF20051	COMPUTER	DELL COMPUTER	OPTIPLEX 760SFF	1	RCHN	1979SNYDER	154
WF20052	COMPUTER	DELL COMPUTER	OPTIPLEX 760SFF	1	RCHN	1979SNYDER	133
WF20053	COMPUTER	DELL COMPUTER	OPTIPLEX 760SFF	1	RCHN	1979SNYDER	C9
WF20054	COMPUTER	DELL COMPUTER	OPTIPLEX 760SFF	1	RCHN	1979SNYDER	105
WF20055	COMPUTER	DELL COMPUTER	OPTIPLEX 760SFF	1	RCHN	1979SNYDER	N8
WF20056	COMPUTER	DELL COMPUTER	OPTIPLEX 760SFF	1	RCHN	1979SNYDER	159

Government-Furnished Property (GFP) Inventory							
Identifier	Official Name	Manufacturer	Model	Quantity	Site	Building	Room
WF20057	COMPUTER	DELL COMPUTER	OPTIPLEX 760SFF	1	RCHN	1979SNYDER	C14
WF20058	COMPUTER	DELL COMPUTER	OPTIPLEX 760SFF	1	RCHN	1979SNYDER	N4
WF20059	COMPUTER	DELL COMPUTER	OPTIPLEX 760SFF	1	RCHN	1979SNYDER	C16
WF20060	COMPUTER	DELL COMPUTER	OPTIPLEX 760SFF	1	RCHN	1979SNYDER	C17
WF20061	COMPUTER	DELL COMPUTER	OPTIPLEX 760SFF	1	RCHN	1979SNYDER	N9
WF20062	COMPUTER	DELL COMPUTER	OPTIPLEX 760SFF	1	RCHN	1979SNYDER	135
WF20063	COMPUTER	DELL COMPUTER	OPTIPLEX 760SFF	1	RCHN	1979SNYDER	105
WF20064	COMPUTER	DELL COMPUTER	OPTIPLEX 760SFF	1	RCHN	1979SNYDER	N1
WF20065	COMPUTER	DELL COMPUTER	OPTIPLEX 760SFF	1	RCHN	1979SNYDER	N2
WF20066	COMPUTER	DELL COMPUTER	OPTIPLEX 760SFF	1	RCHN	1979SNYDER	N5
WF20067	COMPUTER	DELL COMPUTER	OPTIPLEX 760SFF	1	RCHN	1979SNYDER	N11
WF20068	COMPUTER	DELL COMPUTER	OPTIPLEX 760SFF	1	RCHN	1979SNYDER	N12
WF20069	COMPUTER	DELL COMPUTER	OPTIPLEX 760SFF	1	RCHN	1979SNYDER	N11
WF20070	COMPUTER	DELL COMPUTER	OPTIPLEX 760SFF	1	RCHN	1979SNYDER	N25
WF20071	COMPUTER	DELL COMPUTER	OPTIPLEX 760SFF	1	RCHN	1979SNYDER	131
WF20072	COMPUTER	DELL COMPUTER	OPTIPLEX 760SFF	1	RCHN	1979SNYDER	C28
WF20073	COMPUTER	DELL COMPUTER	OPTIPLEX 760SFF	1	RCHN	1979SNYDER	C34
WF20074	COMPUTER	DELL COMPUTER	OPTIPLEX 760SFF	1	RCHN	1979SNYDER	C30
WF20075	COMPUTER	DELL COMPUTER	OPTIPLEX 760SFF	1	RCHN	1979SNYDER	C29
WF20076	COMPUTER	DELL COMPUTER	OPTIPLEX 760SFF	1	RCHN	1979SNYDER	132
WF20077	COMPUTER	DELL COMPUTER	OPTIPLEX 760SFF	1	RCHN	1979SNYDER	C15
WF22024	LAPTOP	DELL COMPUTER	PRECISION M6400	1	RCHN	1979SNYDER	HOME
WF22025	TELEVISION	SAMSUNG	PN58B650	1	RCHN	1979SNYDER	N21
WF22403	COMPUTER	APPLE	MAC MINI	1	RCHN	1979SNYDER	N29
WF22810	LAPTOP	DELL COMPUTER	STUDIO 15	1	RCHN	1979SNYDER	137
WF23204	COMPUTER	DELL COMPUTER	OPTIPLEX 780SFF	1	200W	2719WB	W36
WF23205	COMPUTER	DELL COMPUTER	OPTIPLEX 780SFF	1	200W	2719WB	W25
WF23206	COMPUTER	DELL COMPUTER	OPTIPLEX 780SFF	1	RCHN	1979SNYDER	N27
WF23207	COMPUTER	DELL COMPUTER	OPTIPLEX 780SFF	1	RCHN	1979SNYDER	N27
WF23208	COMPUTER	DELL COMPUTER	OPTIPLEX 780SFF	1	RCHN	1979SNYDER	N27
WF23209	COMPUTER	DELL COMPUTER	OPTIPLEX 780SFF	1	200W	2719WB	W30
WF23210	COMPUTER	DELL COMPUTER	OPTIPLEX 780SFF	1	RCHN	1979SNYDER	N27

Government-Furnished Property (GFP) Inventory							
Identifier	Official Name	Manufacturer	Model	Quantity	Site	Building	Room
WF23211	COMPUTER	DELL COMPUTER	OPTIPLEX 780SFF	1	200W	2719WB	W38
WF23212	COMPUTER	DELL COMPUTER	OPTIPLEX 780SFF	1	200W	2719WB	PATIENT LOBBY
WF23213	COMPUTER	DELL COMPUTER	OPTIPLEX 780SFF	1	200W	2719WB	PATIENT LOBBY
WF23214	COMPUTER	DELL COMPUTER	OPTIPLEX 780SFF	1	200W	2719WB	W33
WF23215	COMPUTER	DELL COMPUTER	OPTIPLEX 780SFF	1	200W	2719WB	W23
WF23216	COMPUTER	DELL COMPUTER	OPTIPLEX 780SFF	1	RCHN	1979SNYDER	N27
WF23217	COMPUTER	DELL COMPUTER	OPTIPLEX 780SFF	1	RCHN	1979SNYDER	N27
WF23218	COMPUTER	DELL COMPUTER	OPTIPLEX 780SFF	1	RCHN	1979SNYDER	N27
WF23219	COMPUTER	DELL COMPUTER	OPTIPLEX 780SFF	1	RCHN	1979SNYDER	N27
WF23220	COMPUTER	DELL COMPUTER	OPTIPLEX 780SFF	1	RCHN	1979SNYDER	N27
WF23221	COMPUTER	DELL COMPUTER	OPTIPLEX 780SFF	1	RCHN	1979SNYDER	N27
WF23222	COMPUTER	DELL COMPUTER	OPTIPLEX 780SFF	1	RCHN	1979SNYDER	C33
WF23223	COMPUTER	DELL COMPUTER	OPTIPLEX 780SFF	1	200W	2719WB	W32
WF23224	LAPTOP	DELL COMPUTER	PRECISION M6500	1	RCHN	1979SNYDER	137
WF23225	LAPTOP	DELL COMPUTER	PRECISION M6500	1	RCHN	1979SNYDER	137
WF23226	LAPTOP	DELL COMPUTER	PRECISION M6500	1	RCHN	1979SNYDER	N5
WF23227	LAPTOP	DELL COMPUTER	PRECISION M6500	1	RCHN	1979SNYDER	N1
WF23333	LAPTOP	DELL COMPUTER	STUDIO XPS 16	1	RCHN	1979SNYDER	C26
WF23334	DUPLEX SCANNER	DELL COMPUTER	FI-6770	1	RCHN	1979SNYDER	C42
WF23335	DUPLEX SCANNER	DELL COMPUTER	FI-6770	1	RCHN	1979SNYDER	C35
WF23669	LAPTOP	DELL COMPUTER	LATITUDE E6410	1	RCHN	1979SNYDER	137

J.3 Health Care Center Description

There is a Health Care Center located in the 200 West Area of the Hanford Site, that is staffed by the Occupational Medical Contractor to provide first aid services to workers in the adjacent areas. The 200 West Facility is Government-Furnished. The Health Care Center consists of office space, examination/treatment rooms, storage rooms, etc. as shown on the floor plan in Figure J.3-1, below.

J.4 Key Personnel

The key personnel in accordance with Section H.3, *Key Personnel Requirements*, are:

Principal Manager ¹	<u>George Baxter</u>
Site Medical Director	<u>Karen Phillips</u>
Clinic Director	<u>Kim Conley</u>

J.5 Small, Small Disadvantaged, Veteran, and Women-Owned Small Business Subcontracting Plan

Requirements for the preparation of this plan are found in Section I.1, *Clauses Incorporated by Reference*. The following 13 pages contain the Small, Small Disadvantaged, Veteran, Service Disabled Veteran, and Women-Owned Small Business Subcontracting Plan.

¹ Title is at the discretion of the contractor (e.g. CEO, President).

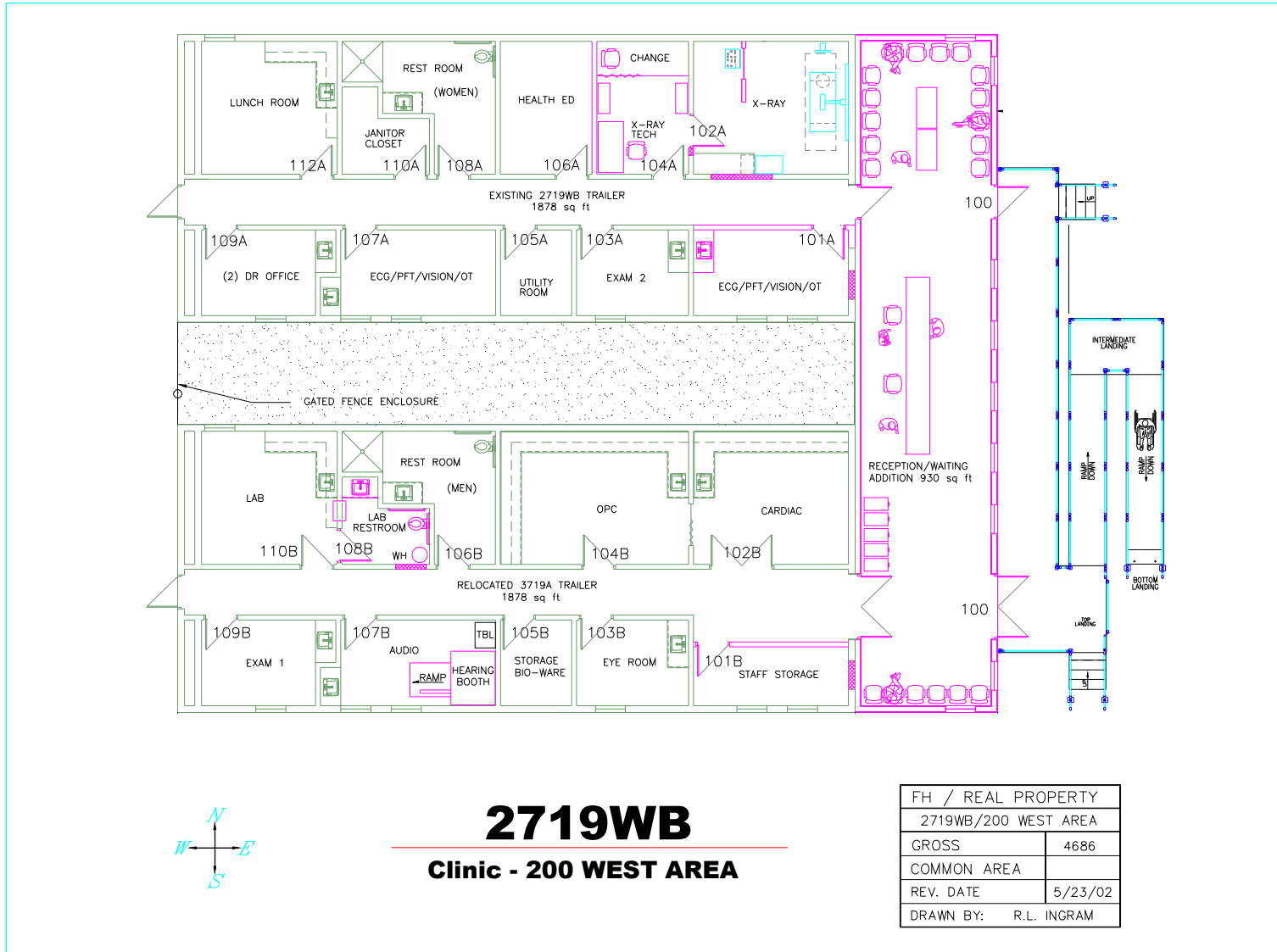

Figure J.3-1: 200 West Health Care Center Floor Plan

J.6 List of Applicable Directives

The Directives listed below can be obtained from the following websites:

DOE Directives: <http://www.directives.doe.gov/>

DOE-RL CRD Supplements:

<http://idmsweb/idmsprod/livmlink.exe?func=ll&objId=3423698&objAction=Open&viewType=1>

Directive Identifier	Title	Date of Order or CRD	CRD Supplement
RRD 002	The Department of Energy Richland Operations Office (RL) Software Quality Assurance Requirement Document (SQARD)	February 2002	Rev 0
RDD 005	Worker Safety	08/29/2007	Rev 3
RRD 006	Contractor Support to RL. Implement of CRD 470.3A	03/09/06	Rev 0
DOE/RL 94-02	Hanford Emergency Plan	June 2010	Rev 4
CRD O 130.1	Budget Formulation Process	09/29/95	N/A
CRD O 142.3A	Unclassified Foreign Visits and Assignments Program	10/14/10	N/A
CRD O 151.1C	Comprehensive Emergency Management System	11/02/05	N/A
CRD O 200.1A	Information Management Program	12/23/08	N/A
CRD O 205.1A	Department of Energy Cyber Security Management Program	12/04/06	Rev 3
CRD M 205.1-6	Media Sanitation Manual	12/23/08	Rev 0
CRD M 205.1-7	Security Controls for Unclassified Information Systems	01/05/09	Rev 0
CRD M 205.1-8	Cyber Security Incident Management Manual	01/08/09	Rev 0
CRD M 205.1-5	Cyber Security Process Requirements Manual	08/12/08	Rev 0
CRD N 206.4	Personal Identity Verification	11/22/05	Rev 0
CRD O 210.2A	DOE Corporate Operating Experience Program	04/08/11	N/A
CRD O 221.1A	Reporting Fraud, Waste, and Abuse to the Office of Inspector General	04/19/08	N/A
CRD O 221.2A	Cooperation With the Office of Inspector General	02/25/08	N/A
DOE-0223	RL Emergency Implementing Procedures	Current Version	N/A

Directive Identifier	Title	Date of Order or CRD	CRD Supplement
CRD O 225.1B	Accident Investigations	03/04/11	Rev 0
CRD M 231.1-1A, Chg 2	Environment, Safety, and Health Reporting Manual	03/19/04	N/A
CRD O 232.2	Occurrence Reporting and Processing of Operations Information	08/30/11	Rev 0
CRD O 241.1B	Scientific and Technical Information Management	12/13/10	N/A
CRO O 243.1A	Records Management Program	11/07/11	N/A
CRD O 243.2	Vital Records	08/31/10	Rev 1
CRD O 341.1A	Federal Employee Health Services	10/18/07	N/A
CRD O 413.1A	Management Control Program	04/18/02	N/A
CRD O 414.1B	Quality Assurance	04/29/04	N/A
CRD O 420.1B, Chg. 1	Facility Safety	04/19/10	Rev 0
CRD O 442.1A	Department of Energy Employee Concerns Program	06/06/01	Rev 2
CRD O 442.2	Differing Professional Opinions for Technical Issues Involving Environment, Safety and Health Technical Concerns	07/29/11	N/A
CRD O 443.1	Data Protection Board for Human Subjects Research	05/15/00	N/A
CRD DOE O 450.1A	Environmental Protection Program	06/04/08	N/A
CRD O 458.1, Chg. 2	Radiation Protection of the Public and the Environment	06/06/11	N/A
CRD O 470.2B	Independent Oversight and Performance Assurance Program	10/31/02	Rev 2
CRD M 470.4-1, Chg 1	Safeguards and Security Program Planning and Management	08/26/05	Rev 1
CRD M 470.4-2A	Physical Protection	07/23/09	Rev 0
CRD O 471.6	Information Security	06/20/11	N/A
CRD O 472.2	Personnel Security	07/27/11	N/A
CRD O 475.2A	Identifying Classified Information	02/01/11	N/A
CRD O 522.1	Pricing of Departmental Materials and Services	11/02/04	N/A

Directive Identifier	Title	Date of Order or CRD	CRD Supplement
CRD O 534.1A	Accounting	07/05/01	Rev 0
CRD O 551.1D	Official Foreign Travel	04/02/12	N/A
CRD O 580.1A	Department of Energy Personal Property Management Program	03/30/12	N/A
DOE SCSP	Site Counterintelligence Support Plan	N/A	N/A

J.7 Pension Plan

- a. General -- The Contractor shall assume the responsibility for management and oversight of the existing Hanford occupational medical contractor pension plan. The cost of the contractor's participation and management of the pension plan will be allowable for the purpose of providing retirement benefits only to employees under the Contract, and former employees of the predecessor Hanford occupational medical services provider, in accordance with the terms and conditions of the pension plan. The pension plan must be maintained as a qualified defined benefit pension plan under the regulations of the Internal Revenue Code (IRC). The pension plan and trust documents and any amendments thereto which effect substantive changes or increase costs are subject to the approval of the Contracting Officer. With respect to the pension plan, the parties agree as follows:
1. Administration of the Plan -- Costs of employer contributions incurred under the terms of the Plan and costs incurred in the course of administration of the Plan are allowable to the extent approved by the Contracting Officer. At DOE's request, the Contractor shall provide an itemization of costs incurred for administration. The Plan fund, not the Contractor, shall be liable for costs incurred in the course of administration.
 2. The Contractor will provide to DOE copies of the following annual reports:
 - i. Accounting reports and annual actuarial valuations. The reports and valuations will include at least the information specified in DOE Order 350.1, Ch 1 (see section J.7 above)
 - ii. Department of Labor (DOL) Form 5500 with schedules and attachments, as submitted to the DOL each year.
 - iii. Financial Accounting Standards Board (FASB) Statement 87 Report. A copy of the FASB 87 report is prepared each year to satisfy the expense-reporting requirement of the Office of Management and Budget.

The final accounting period shall end with the effective date of Contract termination or expiration.
 3. Actuarial gains and losses developed by annual valuations will be taken into account for purposes of establishing contributions to the Plan as soon as reasonably possible and consistent with requirements of the Employee Retirement Income Security Act (ERISA) of 1974, amendments thereto, and any other applicable laws.
 4. The aggregate annual contribution to the pension fund may range from the minimum specified by the Internal Revenue Code (IRC) Section 412(b) to the amount necessary to fully fund the year-end expected current liability. However, the aggregate annual contribution to the Plan shall be no greater than the tax-deductible limit specified by the IRC Section 404. The contributions will be based on the actuarial valuation, as determined by the ERISA, as amended valuation for the most recent plan year. The fund shall be a trust.
 5. If the Contractor and DOE agree to terminate the defined benefit pension plan, the provisions of Sections b. and c. below will apply.

6. Unless otherwise required by federal law or resulting from the collective bargaining process, no amendment to the pension plan shall result in allowable costs under this contract if the adoption date of such amendment is later than twelve (12) months before the termination or expiration date of the Contract.
- b. Actions Required at Contract Termination or Expiration:
 1. No Replacement Contractor -- If this contract expires or terminates without a replacement contractor, the DOE and the Contractor shall meet to determine the ultimate disposition of all pension, post-retirement welfare, and post-employment plans.
 2. Replacement Contractor Situation -- In the event of reassignment of all or a portion of the Contractor's work under this contract to a replacement Contractor(s) or upon termination or expiration of said contract followed by a replacement Contractor(s), the Contractor will assist DOE in the necessary arrangements for the replacement Contractor(s) to take over the Plan, plan assets and plan liabilities. Such arrangements shall include preserving for these employees their accrued pension benefit and vesting service time under the Contract by carrying forward Contractor pension service time to the replacement Contractor. Granting of such service credits shall not result in duplicate benefits for the same service time.
 3. Change of Plan Sponsor -- The DOE shall have the unilateral right to change a plan sponsor upon termination or expiration of the Contract.
 4. Determination of Contract Service Pension Plan Assets and Liabilities
 - i. Contract Service Assets -- Contract Service Assets shall be determined in accordance with subsection J.8.a.2.i. above and shall include all assets attributable to DOE-funded employer contributions (including investment earnings thereon) and the employee accumulations (including investment earnings thereon) determined at current market value until the date of payment or transfer.
 - ii. Liabilities for Present and Future Benefits -- The Contractor's actuary shall quantify liabilities for employee plan benefits as of the contract termination or expiration date.
 - c. Financial Requirements -- Funds to be paid or transferred to any party as a result of settlements relating to pension plan termination or spin-off shall be placed in short-term investment funds from a date stipulated by the Contracting Officer until the actual date of funds transfer.
 - d. Successor Contractor -- Any DOE-reimbursed assets awaiting transfer to a successor trustee or to DOE shall be actively managed by the Contractor until the successor trustee or DOE is able to assume stewardship of those assets.
 - e. Special Programs -- The Contractor shall request DOE prior approval for each early-out program, window benefit, disability program, plan-loan feature, employee contribution refund, asset reversion, or incidental benefit. Such costs are unallowable until specifically approved by the Contracting Officer.

J.8 Service Contract Act Wage Determination No. 05-2569, Revision No. 13, June 13, 2011

The following 11 pages constitute this attachment.

WD 05-2569 (Rev.-13) was first posted on www.wdol.gov on 06/17/2011

REGISTER OF WAGE DETERMINATIONS UNDER | U.S. DEPARTMENT OF LABOR
THE SERVICE CONTRACT ACT | EMPLOYMENT STANDARDS ADMINISTRATION
By direction of the Secretary of Labor | WAGE AND HOUR DIVISION

| WASHINGTON D.C. 20210

|

|

|

| Wage Determination No.: 2005-2569

Diane C. Koplewski | Division of | Revision No.: 13

Director | Wage Determinations | Date Of Revision: 06/13/2011

States: Oregon, Washington

Area: Oregon Counties of Baker, Grant, Harney, Malheur, Morrow, Umatilla,
Union, Wallowa, Wheeler
Washington Counties of Benton, Franklin, Walla Walla, Yakima

Fringe Benefits Required Follow the Occupational Listing

OCCUPATION CODE - TITLE	FOOTNOTE	RATE
01000 - Administrative Support And Clerical Occupations		
01011 - Accounting Clerk I		13.61
01012 - Accounting Clerk II		15.27
01013 - Accounting Clerk III		17.08
01020 - Administrative Assistant		22.41
01040 - Court Reporter		18.59
01051 - Data Entry Operator I		13.38
01052 - Data Entry Operator II		14.60
01060 - Dispatcher, Motor Vehicle		18.77
01070 - Document Preparation Clerk		12.94
01090 - Duplicating Machine Operator		12.94
01111 - General Clerk I		13.10
01112 - General Clerk II		14.30
01113 - General Clerk III		16.05
01120 - Housing Referral Assistant		20.52
01141 - Messenger Courier		11.95
01191 - Order Clerk I		12.44
01192 - Order Clerk II		13.57
01261 - Personnel Assistant (Employment) I		17.21
01262 - Personnel Assistant (Employment) II		19.25
01263 - Personnel Assistant (Employment) III		21.47
01270 - Production Control Clerk		26.54
01280 - Receptionist		12.83
01290 - Rental Clerk		15.00
01300 - Scheduler, Maintenance		16.45
01311 - Secretary I		16.45

01312 - Secretary II	18.40
01313 - Secretary III	20.52
01320 - Service Order Dispatcher	18.84
01410 - Supply Technician	22.80
01420 - Survey Worker	17.33
01531 - Travel Clerk I	14.84
01532 - Travel Clerk II	15.95
01533 - Travel Clerk III	17.09
01611 - Word Processor I	15.07
01612 - Word Processor II	16.91
01613 - Word Processor III	18.91
05000 - Automotive Service Occupations	
05005 - Automobile Body Repairer, Fiberglass	18.71
05010 - Automotive Electrician	18.82
05040 - Automotive Glass Installer	17.82
05070 - Automotive Worker	17.82
05110 - Mobile Equipment Servicer	15.82
05130 - Motor Equipment Metal Mechanic	19.80
05160 - Motor Equipment Metal Worker	17.82
05190 - Motor Vehicle Mechanic	19.80
05220 - Motor Vehicle Mechanic Helper	14.82
05250 - Motor Vehicle Upholstery Worker	16.81
05280 - Motor Vehicle Wrecker	17.82
05310 - Painter, Automotive	18.82
05340 - Radiator Repair Specialist	17.82
05370 - Tire Repairer	14.44
05400 - Transmission Repair Specialist	19.80
07000 - Food Preparation And Service Occupations	
07010 - Baker	17.23
07041 - Cook I	13.97
07042 - Cook II	15.66
07070 - Dishwasher	9.89
07130 - Food Service Worker	10.88
07210 - Meat Cutter	17.51
07260 - Waiter/Waitress	12.54
09000 - Furniture Maintenance And Repair Occupations	
09010 - Electrostatic Spray Painter	20.54
09040 - Furniture Handler	13.45
09080 - Furniture Refinisher	20.54
09090 - Furniture Refinisher Helper	16.17
09110 - Furniture Repairer, Minor	18.34
09130 - Upholsterer	20.54
11000 - General Services And Support Occupations	
11030 - Cleaner, Vehicles	11.95
11060 - Elevator Operator	11.95
11090 - Gardener	16.89
11122 - Housekeeping Aide	13.41
11150 - Janitor	16.03
11210 - Laborer, Grounds Maintenance	12.77
11240 - Maid or Houseman	9.88
11260 - Pruner	11.97

11270 - Tractor Operator	15.28
11330 - Trail Maintenance Worker	12.77
11360 - Window Cleaner	18.02
12000 - Health Occupations	
12010 - Ambulance Driver	16.83
12011 - Breath Alcohol Technician	17.22
12012 - Certified Occupational Therapist Assistant	23.78
12015 - Certified Physical Therapist Assistant	24.27
12020 - Dental Assistant	16.96
12025 - Dental Hygienist	43.92
12030 - EKG Technician	26.27
12035 - Electroneurodiagnostic Technologist	26.27
12040 - Emergency Medical Technician	16.83
12071 - Licensed Practical Nurse I	15.49
12072 - Licensed Practical Nurse II	17.33
12073 - Licensed Practical Nurse III	19.33
12100 - Medical Assistant	14.85
12130 - Medical Laboratory Technician	16.01
12160 - Medical Record Clerk	13.99
12190 - Medical Record Technician	15.65
12195 - Medical Transcriptionist	17.58
12210 - Nuclear Medicine Technologist	36.58
12221 - Nursing Assistant I	10.06
12222 - Nursing Assistant II	11.31
12223 - Nursing Assistant III	12.34
12224 - Nursing Assistant IV	13.85
12235 - Optical Dispenser	17.33
12236 - Optical Technician	16.27
12250 - Pharmacy Technician	15.67
12280 - Phlebotomist	13.85
12305 - Radiologic Technologist	26.57
12311 - Registered Nurse I	29.51
12312 - Registered Nurse II	36.10
12313 - Registered Nurse II, Specialist	36.10
12314 - Registered Nurse III	43.68
12315 - Registered Nurse III, Anesthetist	43.68
12316 - Registered Nurse IV	52.36
12317 - Scheduler (Drug and Alcohol Testing)	21.34
13000 - Information And Arts Occupations	
13011 - Exhibits Specialist I	20.38
13012 - Exhibits Specialist II	25.26
13013 - Exhibits Specialist III	30.90
13041 - Illustrator I	20.38
13042 - Illustrator II	25.26
13043 - Illustrator III	30.90
13047 - Librarian	27.96
13050 - Library Aide/Clerk	14.18
13054 - Library Information Technology Systems Administrator	25.26
13058 - Library Technician	18.10
13061 - Media Specialist I	18.22

13062 - Media Specialist II	20.40
13063 - Media Specialist III	22.73
13071 - Photographer I	16.41
13072 - Photographer II	18.36
13073 - Photographer III	22.74
13074 - Photographer IV	27.81
13075 - Photographer V	33.65
13110 - Video Teleconference Technician	17.69
14000 - Information Technology Occupations	
14041 - Computer Operator I	19.45
14042 - Computer Operator II	21.76
14043 - Computer Operator III	24.28
14044 - Computer Operator IV	26.98
14045 - Computer Operator V	29.87
14071 - Computer Programmer I	(see 1) 22.85
14072 - Computer Programmer II	(see 1)
14073 - Computer Programmer III	(see 1)
14074 - Computer Programmer IV	(see 1)
14101 - Computer Systems Analyst I	(see 1)
14102 - Computer Systems Analyst II	(see 1)
14103 - Computer Systems Analyst III	(see 1)
14150 - Peripheral Equipment Operator	19.45
14160 - Personal Computer Support Technician	26.98
15000 - Instructional Occupations	
15010 - Aircrew Training Devices Instructor (Non-Rated)	30.62
15020 - Aircrew Training Devices Instructor (Rated)	37.04
15030 - Air Crew Training Devices Instructor (Pilot)	44.39
15050 - Computer Based Training Specialist / Instructor	30.62
15060 - Educational Technologist	37.11
15070 - Flight Instructor (Pilot)	44.39
15080 - Graphic Artist	21.49
15090 - Technical Instructor	28.36
15095 - Technical Instructor/Course Developer	32.54
15110 - Test Proctor	21.49
15120 - Tutor	21.49
16000 - Laundry, Dry-Cleaning, Pressing And Related Occupations	
16010 - Assembler	10.90
16030 - Counter Attendant	10.90
16040 - Dry Cleaner	13.76
16070 - Finisher, Flatwork, Machine	10.90
16090 - Presser, Hand	10.90
16110 - Presser, Machine, Drycleaning	10.90
16130 - Presser, Machine, Shirts	10.90
16160 - Presser, Machine, Wearing Apparel, Laundry	10.90
16190 - Sewing Machine Operator	14.71
16220 - Tailor	15.67
16250 - Washer, Machine	11.84
19000 - Machine Tool Operation And Repair Occupations	
19010 - Machine-Tool Operator (Tool Room)	23.95
19040 - Tool And Die Maker	29.01
21000 - Materials Handling And Packing Occupations	

21020 - Forklift Operator	14.88
21030 - Material Coordinator	26.54
21040 - Material Expediter	26.54
21050 - Material Handling Laborer	13.19
21071 - Order Filler	13.22
21080 - Production Line Worker (Food Processing)	14.88
21110 - Shipping Packer	13.22
21130 - Shipping/Receiving Clerk	13.22
21140 - Store Worker I	11.35
21150 - Stock Clerk	16.17
21210 - Tools And Parts Attendant	14.88
21410 - Warehouse Specialist	14.88
23000 - Mechanics And Maintenance And Repair Occupations	
23010 - Aerospace Structural Welder	25.78
23021 - Aircraft Mechanic I	24.50
23022 - Aircraft Mechanic II	25.78
23023 - Aircraft Mechanic III	27.31
23040 - Aircraft Mechanic Helper	17.80
23050 - Aircraft, Painter	22.96
23060 - Aircraft Servicer	20.21
23080 - Aircraft Worker	21.45
23110 - Appliance Mechanic	22.36
23120 - Bicycle Repairer	14.44
23125 - Cable Splicer	34.15
23130 - Carpenter, Maintenance	22.89
23140 - Carpet Layer	20.37
23160 - Electrician, Maintenance	30.09
23181 - Electronics Technician Maintenance I	26.22
23182 - Electronics Technician Maintenance II	28.08
23183 - Electronics Technician Maintenance III	29.95
23260 - Fabric Worker	20.20
23290 - Fire Alarm System Mechanic	24.83
23310 - Fire Extinguisher Repairer	18.63
23311 - Fuel Distribution System Mechanic	25.43
23312 - Fuel Distribution System Operator	19.09
23370 - General Maintenance Worker	19.13
23380 - Ground Support Equipment Mechanic	24.50
23381 - Ground Support Equipment Servicer	20.21
23382 - Ground Support Equipment Worker	21.45
23391 - Gunsmith I	18.63
23392 - Gunsmith II	21.74
23393 - Gunsmith III	24.83
23410 - Heating, Ventilation And Air-Conditioning Mechanic	21.57
23411 - Heating, Ventilation And Air Contditioning Mechanic (Research Facility)	22.70
23430 - Heavy Equipment Mechanic	25.42
23440 - Heavy Equipment Operator	23.61
23460 - Instrument Mechanic	26.61
23465 - Laboratory/Shelter Mechanic	23.29
23470 - Laborer	12.28

23510 - Locksmith	20.45
23530 - Machinery Maintenance Mechanic	25.56
23550 - Machinist, Maintenance	22.78
23580 - Maintenance Trades Helper	16.87
23591 - Metrology Technician I	26.61
23592 - Metrology Technician II	28.00
23593 - Metrology Technician III	29.66
23640 - Millwright	30.04
23710 - Office Appliance Repairer	22.32
23760 - Painter, Maintenance	19.88
23790 - Pipefitter, Maintenance	29.30
23810 - Plumber, Maintenance	27.84
23820 - Pneudraulic Systems Mechanic	24.83
23850 - Rigger	24.83
23870 - Scale Mechanic	21.74
23890 - Sheet-Metal Worker, Maintenance	25.26
23910 - Small Engine Mechanic	19.59
23931 - Telecommunications Mechanic I	25.46
23932 - Telecommunications Mechanic II	26.79
23950 - Telephone Lineman	23.94
23960 - Welder, Combination, Maintenance	21.15
23965 - Well Driller	24.83
23970 - Woodcraft Worker	24.83
23980 - Woodworker	18.63
24000 - Personal Needs Occupations	
24570 - Child Care Attendant	10.04
24580 - Child Care Center Clerk	13.63
24610 - Chore Aide	11.35
24620 - Family Readiness And Support Services Coordinator	13.44
24630 - Homemaker	14.44
25000 - Plant And System Operations Occupations	
25010 - Boiler Tender	27.31
25040 - Sewage Plant Operator	23.29
25070 - Stationary Engineer	27.31
25190 - Ventilation Equipment Tender	20.58
25210 - Water Treatment Plant Operator	23.29
27000 - Protective Service Occupations	
27004 - Alarm Monitor	22.01
27007 - Baggage Inspector	17.55
27008 - Corrections Officer	23.96
27010 - Court Security Officer	25.24
27030 - Detection Dog Handler	22.01
27040 - Detention Officer	23.96
27070 - Firefighter	25.75
27101 - Guard I	17.55
27102 - Guard II	22.01
27131 - Police Officer I	28.67
27132 - Police Officer II	31.84
28000 - Recreation Occupations	
28041 - Carnival Equipment Operator	15.64

28042 - Carnival Equipment Repairer	16.71
28043 - Carnival Equipment Worker	11.72
28210 - Gate Attendant/Gate Tender	14.01
28310 - Lifeguard	11.90
28350 - Park Attendant (Aide)	15.66
28510 - Recreation Aide/Health Facility Attendant	11.35
28515 - Recreation Specialist	19.27
28630 - Sports Official	12.47
28690 - Swimming Pool Operator	22.22
29000 - Stevedoring/Longshoremen Occupational Services	
29010 - Blocker And Bracer	27.81
29020 - Hatch Tender	27.81
29030 - Line Handler	27.81
29041 - Stevedore I	25.82
29042 - Stevedore II	29.78
30000 - Technical Occupations	
30010 - Air Traffic Control Specialist, Center (HFO) (see 2)	35.77
30011 - Air Traffic Control Specialist, Station (HFO) (see 2)	24.66
30012 - Air Traffic Control Specialist, Terminal (HFO) (see 2)	27.16
30021 - Archeological Technician I	16.14
30022 - Archeological Technician II	18.43
30023 - Archeological Technician III	24.07
30030 - Cartographic Technician	25.48
30040 - Civil Engineering Technician	24.78
30061 - Drafter/CAD Operator I	16.14
30062 - Drafter/CAD Operator II	18.43
30063 - Drafter/CAD Operator III	20.55
30064 - Drafter/CAD Operator IV	24.77
30081 - Engineering Technician I	16.35
30082 - Engineering Technician II	18.35
30083 - Engineering Technician III	20.53
30084 - Engineering Technician IV	25.43
30085 - Engineering Technician V	31.11
30086 - Engineering Technician VI	38.46
30090 - Environmental Technician	22.34
30210 - Laboratory Technician	23.90
30240 - Mathematical Technician	22.36
30361 - Paralegal/Legal Assistant I	17.77
30362 - Paralegal/Legal Assistant II	22.02
30363 - Paralegal/Legal Assistant III	26.94
30364 - Paralegal/Legal Assistant IV	32.59
30390 - Photo-Optics Technician	22.36
30461 - Technical Writer I	22.20
30462 - Technical Writer II	27.15
30463 - Technical Writer III	32.85
30491 - Unexploded Ordnance (UXO) Technician I	22.74
30492 - Unexploded Ordnance (UXO) Technician II	27.51
30493 - Unexploded Ordnance (UXO) Technician III	32.97
30494 - Unexploded (UXO) Safety Escort	22.74
30495 - Unexploded (UXO) Sweep Personnel	22.74
30620 - Weather Observer, Combined Upper Air Or (see 2)	20.55

Surface Programs	
30621 - Weather Observer, Senior	(see 2) 20.75
31000 - Transportation/Mobile Equipment Operation Occupations	
31020 - Bus Aide	11.43
31030 - Bus Driver	16.99
31043 - Driver Courier	12.52
31260 - Parking and Lot Attendant	10.69
31290 - Shuttle Bus Driver	13.65
31310 - Taxi Driver	11.88
31361 - Truckdriver, Light	13.65
31362 - Truckdriver, Medium	14.80
31363 - Truckdriver, Heavy	21.02
31364 - Truckdriver, Tractor-Trailer	21.02
99000 - Miscellaneous Occupations	
99030 - Cashier	10.64
99050 - Desk Clerk	9.81
99095 - Embalmer	24.57
99251 - Laboratory Animal Caretaker I	12.19
99252 - Laboratory Animal Caretaker II	13.28
99310 - Mortician	24.57
99410 - Pest Controller	21.01
99510 - Photofinishing Worker	11.95
99710 - Recycling Laborer	16.23
99711 - Recycling Specialist	19.82
99730 - Refuse Collector	14.49
99810 - Sales Clerk	12.30
99820 - School Crossing Guard	14.43
99830 - Survey Party Chief	23.63
99831 - Surveying Aide	14.85
99832 - Surveying Technician	20.32
99840 - Vending Machine Attendant	16.41
99841 - Vending Machine Repairer	20.45
99842 - Vending Machine Repairer Helper	16.41

ALL OCCUPATIONS LISTED ABOVE RECEIVE THE FOLLOWING BENEFITS:

HEALTH & WELFARE: \$3.59 per hour or \$143.60 per week or \$622.27 per month

VACATION: 2 weeks paid vacation after 1 year of service with a contractor or successor; 3 weeks after 5 years, 4 weeks after 10 years, and 5 weeks after 20 years.

Length of service includes the whole span of continuous service with the present contractor or successor, wherever employed, and with the predecessor contractors in the performance of similar work at the same Federal facility. (Reg. 29 CFR 4.173)

HOLIDAYS: A minimum of ten paid holidays per year, New Year's Day, Martin Luther King Jr's Birthday, Washington's Birthday, Memorial Day, Independence Day, Labor Day, Columbus Day, Veterans' Day, Thanksgiving Day, and Christmas Day. (A contractor may substitute for any of the named holidays another day off with pay in accordance with a plan communicated to the employees involved.) (See 29 CFR 4174)

THE OCCUPATIONS WHICH HAVE NUMBERED FOOTNOTES IN PARENTHESES RECEIVE THE FOLLOWING:

1) Does not apply to employees employed in a bona fide executive, administrative, or professional capacity as defined and delineated in 29 CFR 541. (See CFR 4.156)

2) AIR TRAFFIC CONTROLLERS AND WEATHER OBSERVERS - NIGHT PAY & SUNDAY PAY: If you

work at night as part of a regular tour of duty, you will earn a night differential and receive an additional 10% of basic pay for any hours worked between 6pm and 6am.

If you are a full-time employed (40 hours a week) and Sunday is part of your regularly scheduled workweek, you are paid at your rate of basic pay plus a Sunday premium of 25% of your basic rate for each hour of Sunday work which is not overtime (i.e. occasional work on Sunday outside the normal tour of duty is considered overtime work).

HAZARDOUS PAY DIFFERENTIAL: An 8 percent differential is applicable to employees employed in a position that represents a high degree of hazard when working with or in close proximity to ordnance, explosives, and incendiary materials. This includes work such as screening, blending, dying, mixing, and pressing of sensitive ordnance, explosives, and pyrotechnic compositions such as lead azide, black powder and photoflash powder. All dry-house activities involving propellants or explosives. Demilitarization, modification, renovation, demolition, and maintenance operations on sensitive ordnance, explosives and incendiary materials. All operations involving regrading and cleaning of artillery ranges.

A 4 percent differential is applicable to employees employed in a position that represents a low degree of hazard when working with, or in close proximity to ordnance, (or employees possibly adjacent to) explosives and incendiary materials which involves potential injury such as laceration of hands, face, or arms of the employee engaged in the operation, irritation of the skin, minor burns and the like; minimal damage to immediate or adjacent work area or equipment being used. All operations involving, unloading, storage, and hauling of ordnance, explosive, and incendiary ordnance material other than small arms ammunition. These differentials are only applicable to work that has been specifically designated by the agency for ordnance, explosives, and incendiary material differential pay.

**** UNIFORM ALLOWANCE ****

If employees are required to wear uniforms in the performance of this contract (either by the terms of the Government contract, by the employer, by the state or local law, etc.), the cost of furnishing such uniforms and maintaining (by laundering or dry cleaning) such uniforms is an expense that may not be borne by an employee where such cost reduces the hourly rate below that required by the wage determination. The Department of Labor will accept payment in accordance with the following standards as compliance:

The contractor or subcontractor is required to furnish all employees with an adequate number of uniforms without cost or to reimburse employees for the actual cost of the uniforms. In addition, where uniform cleaning and maintenance is made

the responsibility of the employee, all contractors and subcontractors subject to this wage determination shall (in the absence of a bona fide collective bargaining agreement providing for a different amount, or the furnishing of contrary affirmative proof as to the actual cost), reimburse all employees for such cleaning and maintenance at a rate of \$3.35 per week (or \$.67 cents per day). However, in those instances where the uniforms furnished are made of "wash and wear" materials, may be routinely washed and dried with other personal garments, and do not require any special treatment such as dry cleaning, daily washing, or commercial laundering in order to meet the cleanliness or appearance standards set by the terms of the Government contract, by the contractor, by law, or by the nature of the work, there is no requirement that employees be reimbursed for uniform maintenance costs.

The duties of employees under job titles listed are those described in the "Service Contract Act Directory of Occupations", Fifth Edition, April 2006, unless otherwise indicated. Copies of the Directory are available on the Internet. A links to the Directory may be found on the WHD home page at <http://www.dol.gov/esa/whd/> or through the Wage Determinations On-Line (WDOL) Web site at <http://wdol.gov/>.

REQUEST FOR AUTHORIZATION OF ADDITIONAL CLASSIFICATION AND WAGE RATE { Standard Form 1444 (SF 1444) }

Conformance Process:

The contracting officer shall require that any class of service employee which is not listed herein and which is to be employed under the contract (i.e., the work to be performed is not performed by any classification listed in the wage determination), be classified by the contractor so as to provide a reasonable relationship (i.e., appropriate level of skill comparison) between such unlisted classifications and the classifications listed in the wage determination. Such conformed classes of employees shall be paid the monetary wages and furnished the fringe benefits as are determined. Such conforming process shall be initiated by the contractor prior to the performance of contract work by such unlisted class(es) of employees. The conformed classification, wage rate, and/or fringe benefits shall be retroactive to the commencement date of the contract. { See Section 4.6 (C)(vi) } When multiple wage determinations are included in a contract, a separate SF 1444 should be prepared for each wage determination to which a class(es) is to be conformed.

The process for preparing a conformance request is as follows:

- 1) When preparing the bid, the contractor identifies the need for a conformed occupation(s) and computes a proposed rate(s).
- 2) After contract award, the contractor prepares a written report listing in order proposed classification title(s), a Federal grade equivalency (FGE) for each proposed classification(s), job description(s), and rationale for proposed wage rate(s), including information regarding the agreement or disagreement of the authorized representative of the employees involved, or where there is no authorized representative, the employees themselves. This report should be submitted to the contracting officer no later than 30 days after such unlisted class(es) of employees

performs any contract work.

3) The contracting officer reviews the proposed action and promptly submits a report of the action, together with the agency's recommendations and pertinent information including the position of the contractor and the employees, to the Wage and Hour Division, Employment Standards Administration, U.S. Department of Labor, for review. (See section 4.6(b)(2) of Regulations 29 CFR Part 4).

4) Within 30 days of receipt, the Wage and Hour Division approves, modifies, or disapproves the action via transmittal to the agency contracting officer, or notifies the contracting officer that additional time will be required to process the request.

5) The contracting officer transmits the Wage and Hour decision to the contractor.

6) The contractor informs the affected employees.

Information required by the Regulations must be submitted on SF 1444 or bond paper.

When preparing a conformance request, the "Service Contract Act Directory of Occupations" (the Directory) should be used to compare job definitions to insure that duties requested are not performed by a classification already listed in the wage determination. Remember, it is not the job title, but the required tasks that determine whether a class is included in an established wage determination. Conformances may not be used to artificially split, combine, or subdivide classifications listed in the wage determination.

J.9 Performance Evaluation and Measurement Plan

**Occupational Medical Services Contract
Fiscal Year (FY) 2012 Performance Evaluation and Measurement Plan (PEMP)**

The PEMP details the administration of performance incentives and allocation of total available fee as defined in Section B, Supplies or Services and Prices/Costs.

1. PERFORMANCE INCENTIVES

This PEMP contains both objective and subjective performance incentives in order to maximize the efficacy of the Occupational Health Services Contract. The completion criteria for objective incentives consist of the successful completion of specified activities. The completion criteria for subjective incentives are focused on the achievement of high-level strategies, outcomes, and envisioned end states. The evaluation of all incentives will include a subjective determination regarding quality and effectiveness.

2. ALLOCATION OF AVAILABLE FEE

Because the services to be determined under this contract directly support the mission contractors, and because such services are integral to the environmental cleanup mission at Hanford, DOE will heavily weight the assignment of fee toward the following strategic areas of the contract: Worker health and well-being, customer satisfaction, and operational effectiveness. The objective performance incentives are allocated 70 percent of the available fee and the remaining 30 percent is allocated to the subjective performance incentives.

3. PERFORMANCE INCENTIVE RATINGS

Payment of fee is subject to the fee reduction terms of this contract, and fee determining official approval that the contractor has achieved the stated outcome for the specific performance incentive. The criteria listed in Table 3.1, Performance Ratings and Definitions, will be used in the evaluation of any subjective elements of the objective incentives as well as for the subjective incentive 4.0, Comprehensive Performance.

Table 3.1, Performance Incentive Ratings and Definitions

Adjectival Rating	Definition	Percentage of Fee Earned
Excellent	Contractor has exceeded almost all of the completion criteria in the subjective performance incentive, including overall cost, schedule, and technical performance requirements of the contract for this evaluation period. Contractor's work is highly professional. Contractor solves problems with very little, if any, Government involvement. Contractor is proactive and takes an aggressive approach in identifying problems and their resolution, including those identified in the risk management process, with a substantial emphasis on performing quality work in a safe manner within cost/schedule requirements. No significant re-work.	91% to 100%
Very Good	Contractor has exceeded many of the completion criteria in the subjective performance incentive, including overall cost, schedule, and technical performance requirements of the contract for this evaluation period. Contractor solves problems with minimal Government involvement. Contractor is usually proactive and demonstrates an aggressive approach in identifying problems and their resolution, including those identified in the risk management process, with an emphasis on performing quality work in a safe manner within cost/schedule requirements. Problems are usually self-identified and resolution is self-initiated. Some limited, low-impact rework within normal expectations.	76% to 90%
Good	Contractor has exceeded some of the completion criteria in the subjective performance incentive, including overall cost, schedule, and technical performance requirements of the contract for this evaluation period. Contractor is able to solve basic problems with adequate emphasis on performing quality work in a safe manner within cost/schedule objectives. The rating within this range will be determined by level of necessary Government involvement in problem resolution, including those problems identified in the risk management process, and extent to which the performance problem is self-identified vs. Government-identified. Some re-work required that unfavorably impacted cost and/or schedule.	51% to 75%
Satisfactory	Contractor has met overall cost, schedule, and technical performance requirements of the contract for this evaluation period. Contractor has some difficulty solving basic problems, and cost, schedule, safety, and technical performance needs improvement to avoid further performance risk. Government involvement in problem resolution, including those problems identified in the risk management process, is necessary. Excessive rework required that unfavorably impacted cost and/or schedule.	≤ 50%
Unsatisfactory	Contractor has failed to meet overall cost, schedule, and technical performance requirements of the contract for this evaluation period. Contractor does not demonstrate an emphasis on performing quality work in a safe manner within cost/schedule objectives. Contractor is unable to solve problems and Government involvement in problem resolution, including those problems identified in the risk management process, is necessary. Excessive rework required that had significant unfavorable impact on cost and/or schedule.	0%

4. PERFORMANCE INCENTIVE FEE CALCULATION METHODOLOGY

Table 4.1, Fee Calculation Methodology

Objective	Performance Incentive	Allocated Percent
1.0: Worker Health and Well-Being	1.1: Provide quality clinical services	30%
2.0: Customer Satisfaction	2.1: Conduct customer satisfaction survey.	20%
3.0: Operational Effectiveness	3.1: Implement process improvements.	20%
Objective PI Fee Allocation: \$916,130 X 70% = \$641,291		
4.0: Comprehensive Performance	4.1: Subjective PI elements.	30%
Subjective PI Fee Allocation: \$916,130 X 30% = \$274,839		

5. PERFORMANCE INCENTIVES

Table 5.1, Performance Incentives

Fee determination and payment will be made in accordance with the Section B clause entitled Fee Determination and Payment. The completion criteria for objective incentives consist of the successful completion of specified activities. The completion criteria for subjective incentives are focused on the achievement of high-level strategies, outcomes, and envisioned end states. The evaluation of all incentives will include a subjective determination regarding quality and effectiveness.

PERFORMANCE INCENTIVE		FY12 PI COMPLETION CRITERIA	INCENTIVE DUE DATE	DOE LEAD	CSC LEAD
OBJECTIVE 1.0: Worker Health and Well-Being					
1.1	Provide quality clinical services.	Achieve an FOH evaluation rating of “very good” to “excellent” in the two scheduled reviews for FY12.	9-30-12	Slade	Conley
		Conduct medical surveillances to identify early negative health trends.			Phillips
		Perform epidemiology surveillances, issue reports, identify trends, and make appropriate recommendations.			Phillips
OBJECTIVE 2.0: Customer Satisfaction					
2.1	Conduct customer satisfaction survey.	Achieve a rating of 90% or higher for best-in-class performance on an RL-approved patient satisfaction survey.	9-30-12	Slade	Conley
		Achieve a rating of 80% or higher for best-in-class performance on a joint RL/ORP-conducted assessment of site contractor satisfaction.			Conley
OBJECTIVE 3.0: Operational Effectiveness					
3.1	Implement process improvements.	Implement the two-encounter exam.	9-30-12	Slade	Baxter
		Complete implementation of digital x-ray.			Conley
		Fully implement electronic medical records.			Baxter
4.0: Comprehensive Performance – Subjective Performance Incentive					
4.1	<ul style="list-style-type: none"> Operate in a manner conducive to excellence and quality by delivering occupational medical services to Hanford Site workers; and maintaining relationships with DOE, customers, and stakeholders based on transparent and effective communication via appropriate means (e.g., site visits and outreach awareness) Work with DOE in a spirit of cooperation during the negotiation process, including timely submission of requests for additional data, timely counteroffers, and conveying a positive and professional attitude to achieve fair and timely settlement of change order proposals or requests for equitable adjustment. Integrate and coordinate all activities required to execute the contract with DOE and Hanford contractors, specifically the timeliness, completeness, and quality of problem identification; and corrective action plans. Comply with federal and departmental acquisition regulations, procedures, and guidance (including contract change proposal timeliness and quality pursuant to DOE Policy Flash 2008-39, dated April 25, 2008). Comply with contract requirements not covered by other performance incentives. 			Walter	Baxter