

## Hunter Point Air Monitoring Summary

**Objective-Locations** - Air monitoring is performed to ensure worker and community safety in accordance with NIOSH approved air sampling methodology. Air samplers and monitoring stations are located upwind and downwind from the work areas based on wind direction data. Locations of air monitoring stations are presented on a separate Tab. Each monitoring station includes three different monitoring systems: one each for TSP with manganese and lead), PM10, and asbestos.

**Total Suspended Particulates, Manganese, and Lead** - TSP is sampled in accordance with EPA's reference sampling method for TSP, described in Title 40 *Code of Federal Regulations* Part 50, Subpart B. Each sample is collected on a filter over the course of a period not to exceed 54 hours. TSP is based on the filter weight. Manganese concentration is calculated in accordance with one of the IO-3 methods identified in EPA's Compendium of Methods for the Determination of Inorganic Compounds in Ambient Air and lead in accordance with a modified EPA Method 12.

**PM10** - PM<sub>10</sub> is sampled in accordance with EPA's reference sampling method for PM<sub>10</sub>, described in 40 CFR 50, Subpart J. Each sample is collected on a filter over a period not to exceed 54 hours; the filter is then weighed to determine the amount of PM<sub>10</sub> collected.

**Asbestos** - Asbestos is sampled and analyzed in accordance with the National Institute for Occupational Safety and Health (NIOSH) Method 7400, from the NIOSH Manual of Analytical Methods (NIOSH 1994). Method 7400 requires that samples be collected on three-piece cellulose ester filters fitted with conductive cowlings at a sampling rate of between 0.5 liter per minute (L/min) and 16 L/min. Each sample is collected over a period not to exceed 54 hours.

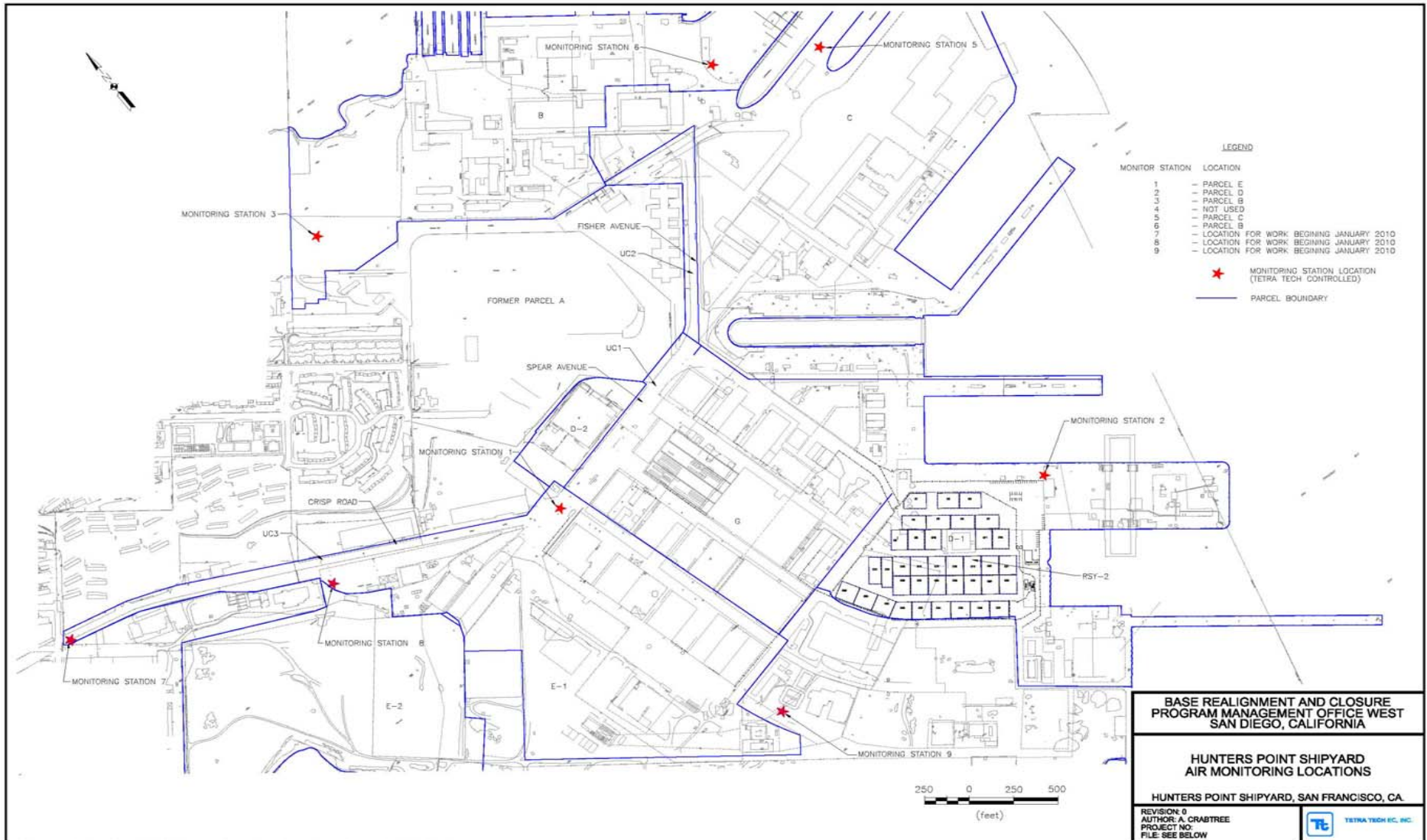

**Cal-OSHA Permissible Exposure Limits: TSP - 10 mg/m3; Manganese - 200 ug/m3; Lead - 50 ug/m3**

Sample ID	Sample Field ID	Sample Date	Sampler Location	Ambient Pressure in (Hg)	Ambient Temperature (C)	Cubic Feet	Ave Mag Pressure (in H2O)	Minutes Operated	Volume (m3)	Total Suspended Particulate (mg)	Conc TSP (mg/m3)	Manganese (ug)	Conc Mang (ug/m3)	Lead (ug)	Conc Lead (ug/m3)
1	3-TSP-255	3/23/2007	3	30.14	21.1	1.02	19.6	3,031	3,549.8	158	0.045	45	0.0127	0	0.0000
4	5-TSP-255	3/23/2007	5	30.14	21.1	1.02	18.3	3,022	3,551.7	212	0.060	74	0.0208	26	0.0073
7	3-TSP-256	3/30/2007	3	30.38	15.0	1.05	18.8	3,168	3,792.8	124	0.033	44	0.0116	0	0.0000
10	5-TSP-256	3/30/2007	5	30.38	15.0	1.05	20.3	3,183	3,795.5	180	0.047	86	0.0227	27	0.0071
13	3-TSP-257	4/6/2007	3	30.16	11.7	1.06	18.5	1,585	1,896.8	32	0.017	0	0.0000	0	0.0000
16	3-TSP-258	4/11/2007	3	30.23	15.0	1.05	18.8	3,091	3,681.4	105	0.029	32	0.0087	0	0.0000
19	5-TSP-258	4/11/2007	5	30.23	15.0	1.05	19.9	3,081	3,658.7	226	0.062	140	0.0383	49	0.0134
22	5-TSP-259	4/13/2007	5	30.24	17.8	1.04	20.1	3,013	3,558.3	175	0.049	79	0.0222	0	0.0000
25	3-TSP-260	5/3/2007	3	30.24	14.2	1.05	19.3	6,130	7,304.9	65	0.009	0	0.0000	0	0.0000
31	3-TSP-261	5/5/2007	3	30.21	21.7	1.02	18.7	2,880	3,385.6	66	0.019	0	0.0000	0	0.0000
34	5-TSP-261	5/5/2007	5	30.21	21.7	1.02	20.5	2,874	3,362.3	75	0.022	0	0.0000	0	0.0000
37	3-TSP-262	5/9/2007	3	30.14	22.5	1.02	19.5	2,962	3,460.9	115	0.033	52	0.0150	0	0.0000
40	5-TSP-262	5/9/2007	5	30.14	22.5	1.02	19.9	2,968	3,464.2	138	0.040	76	0.0219	0	0.0000
43	3-TSP-263	5/11/2007	3	30.17	16.4	1.04	19.9	3,066	3,623.6	100	0.028	0	0.0000	0	0.0000
46	5-TSP-263	5/11/2007	5	30.17	16.4	1.04	18.9	3,066	3,633.3	199	0.055	100	0.0275	35	0.0096
49	3-TSP-264	5/12/2007	3	30.22	15.6	1.04	19.8	1,453	1,723.3	52	0.030	0	0.0000	0	0.0000
52	5-TSP-264	5/12/2007	5	30.22	15.6	1.04	19.1	1,474	1,751.5	131	0.075	83	0.0474	34	0.0194
55	3-TSP-265	5/16/2007	3	30.19	15.8	1.04	19.7	3,094	3,665.4	128	0.035	0	0.0000	0	0.0000
58	5-TSP-265	5/16/2007	5	30.19	15.8	1.04	19.9	2,926	3,464.5	344	0.099	230	0.0664	98	0.0283
64	5-TSP-266	5/18/2007	5	30.16	17.4	1.03	17.5	3,121	3,704.1	235	0.063	130	0.0351	45	0.0121
70	5-TSP-267	5/19/2007	5	30.22	18.6	1.03	19.8	1,197	1,411.6	45	0.032	28	0.0198	0	0.0000
73	3-TSP-268	5/23/2007	3	30.10	21.8	1.02	20.7	2,928	3,409.8	214	0.063	98	0.0287	0	0.0000
76	5-TSP-268	5/23/2007	5	30.10	21.8	1.02	18.9	2,929	3,427.6	308	0.090	180	0.0525	46	0.0134
79	3-TSP-269	5/25/2007	3	30.10	22.3	1.02	19.4	3,164	3,694.2	130	0.035	47	0.0127	0	0.0000
82	5-TSP-269	5/25/2007	5	30.10	22.3	1.02	18.6	3,156	3,692.8	208	0.056	110	0.0298	30	0.0081
85	5-TSP-270	6/1/2007	5	30.16	14.1	1.05	19.3	3,162	3,758.3	197	0.052	140	0.0373	42	0.0112
88	5-TSP-271	6/2/2007	5	30.08	14.6	1.04	20.0	1,653	1,953.7	65	0.033	44	0.0225	0	0.0000
91	5-TSP-272	6/6/2007	5	30.17	14.7	1.04	19.5	2,957	3,509.9	135	0.038	100	0.0285	29	0.0083
94	5-TSP-273	6/8/2007	5	30.15	18.5	1.03	20.3	2,945	3,460.6	164	0.047	58	0.0168	0	0.0000
97	5-TSP-275	6/15/2007	5	30.07	22.6	1.01	21.3	2,980	3,455.9	327	0.095	140	0.0405	38	0.0110
100	3-TSP-276	6/16/2007	3	30.05	21.6	1.02	19.4	1,738	2,028.3	92	0.045	31	0.0153	0	0.0000
103	5-TSP-276	6/16/2007	5	30.05	21.6	1.02	17.6	1,685	1,976.0	102	0.052	51	0.0258	0	0.0000
106	5-TSP-277	6/20/2007	5	30.13	17.5	1.03	18.7	2,983	3,524.6	191	0.054	95	0.0270	34	0.0096
109	3-TSP-278	6/22/2007	3	30.21	20.0	1.03	21.5	2,970	3,476.2	111	0.032	36	0.0104	0	0.0000
112	5-TSP-278	6/22/2007	5	30.21	20.0	1.03	17.0	2,930	3,471.1	153	0.044	63	0.0181	0	0.0000
115	3-TSP-279	6/23/2007	3	30.13	21.4	1.02	21.0	1,464	1,706.6	112	0.066	33	0.0193	0	0.0000
118	5-TSP-279	6/23/2007	5	30.13	21.4	1.02	17.0	1,485	1,749.8	153	0.087	70	0.0400	28	0.0160
121	3-TSP-280	6/27/2007	3	30.18	15.5	1.04	21.0	3,063	3,616.8	170	0.047	43	0.0119	0	0.0000
124	5-TSP-280	6/27/2007	5	30.18	15.5	1.04	17.0	3,057	3,648.7	230	0.063	99	0.0271	33	0.0090
127	3-TSP-281	6/29/2007	3	30.21	16.8	1.04	21.3	2,809	3,309.4	64	0.019	34	0.0103	0	0.0000
130	3-TSP-282	6/30/2007	3	30.24	19.0	1.03	20.8	1,625	1,911.1	54	0.028	29	0.0152	0	0.0000
133	5-TSP-282	6/30/2007	5	30.24	19.0	1.03	18.2	1,568	1,857.0	53	0.029	35	0.0188	0	0.0000
136	3-TSP-283	7/3/2007	3	30.22	17.8	1.04	21.9	1,853	2,176.2	58	0.027	41	0.0188	0	0.0000
139	5-TSP-283	7/3/2007	5	30.22	17.8	1.04	21.2	1,844	2,169.7	109	0.050	92	0.0424	26	0.0120

Sample ID	Sample Field ID	Sample Date	Sampler Location	Ambient Pressure in (Hg)	Ambient Temperature (C)	Cubic Feet	Ave Mag Pressure (in H2O)	Minutes Operated (min)	Volume (m3)	Total		Conc Mang (ug/m3)	Lead (ug)	Conc Lead (ug/m3)	
										Suspended Particulate (mg)	Conc TSP (mg/m3)				
142	3-TSP-284	7/6/2007	3	30.00	18.9	1.02	21.8	1,865	2,169.5	64	0.029	34	0.0157	0	0.0000
145	5-TSP-284	7/6/2007	5	30.00	18.9	1.02	16.3	1,913	2,258.7	138	0.061	130	0.0576	48	0.0213
148	3-TSP-285	7/11/2007	3	30.10	19.3	1.03	22.0	1,582	1,844.4	85	0.046	27	0.0146	0	0.0000
151	5-TSP-285	7/11/2007	5	30.10	19.3	1.03	20.0	3,147	3,688.9	112	0.030	68	0.0184	25	0.0068
154	3-TSP-286	7/13/2007	3	30.18	24.3	1.01	23.2	2,992	3,454.6	83	0.024	41	0.0119	28	0.0081
157	5-TSP-286	7/13/2007	5	30.18	24.3	1.01	16.5	2,984	3,508.1	106	0.030	97	0.0277	35	0.0100
160	2-TSP-287	7/20/2007	2	30.10	21.5	1.02	21.9	1,787	2,075.4	158	0.076	210	0.1012	44	0.0212
163	2-TSP-288	7/25/2007	2	30.10	17.1	1.03	20.8	3,173	3,726.8	240	0.064	190	0.0510	42	0.0113
166	2-TSP-289	7/27/2007	2	30.07	19.3	1.02	21.7	3,110	3,625.0	247	0.068	210	0.0579	42	0.0116
169	1-TSP-290	8/1/2007	1	29.98	19.3	1.02	20.1	3,115	3,635.1	203	0.056	81	0.0223	26	0.0072
172	2-TSP-290	8/1/2007	2	29.98	19.3	1.02	22.0	3,119	3,621.0	230	0.064	140	0.0387	27	0.0075
175	1-TSP-291	8/3/2007	1	30.04	20.6	1.02	20.1	3,134	3,656.1	187	0.051	100	0.0274	33	0.0090
178	2-TSP-291	8/3/2007	2	30.04	20.6	1.02	21.8	3,101	3,600.9	174	0.048	120	0.0333	28	0.0078
181	1-TSP-292	8/8/2007	1	30.13	16.0	1.04	18.9	3,176	3,761.3	195	0.052	140	0.0372	44	0.0117
184	2-TSP-292	8/8/2007	2	30.13	16.0	1.04	20.9	3,172	3,736.4	149	0.040	100	0.0268	0	0.0000
187	1-TSP-293	8/10/2007	1	30.10	18.6	1.03	19.5	3,107	3,651.8	275	0.075	140	0.0383	42	0.0115
190	2-TSP-293	8/10/2007	2	30.10	18.6	1.03	21.4	3,113	3,640.0	169	0.046	120	0.0330	28	0.0077
193	1-TSP-294	8/15/2007	1	30.14	17.9	1.03	20.0	3,185	3,748.6	319	0.085	230	0.0614	59	0.0157
196	1-TSP-295	8/17/2007	1	30.06	20.2	1.02	18.7	3,059	3,587.3	212	0.059	170	0.0474	37	0.0103
199	2-TSP-295	8/17/2007	2	30.06	20.2	1.02	22.1	3,087	3,586.9	136	0.038	85	0.0237	26	0.0072
202	1-TSP-296	8/22/2007	1	30.02	20.4	1.02	20.4	3,166	3,689.2	366	0.099	230	0.0623	53	0.0144
205	2-TSP-296	8/22/2007	2	30.02	20.4	1.02	22.1	3,160	3,665.2	216	0.059	140	0.0382	28	0.0076
208	1-TSP-297	8/24/2007	1	29.91	23.9	1.00	19.7	3,063	3,539.1	440	0.124	280	0.0791	62	0.0175
211	2-TSP-297	8/24/2007	2	29.91	23.9	1.00	22.5	3,077	3,528.3	261	0.074	170	0.0482	41	0.0116
214	1-TSP-298	8/29/2007	1	30.00	21.9	1.01	21.6	3,164	3,662.0	381	0.104	230	0.0628	54	0.0147
217	2-TSP-298	8/29/2007	2	30.00	21.9	1.01	22.5	3,157	3,645.0	172	0.047	100	0.0274	30	0.0082
220	1-TSP-299	8/30/2007	1	30.01	27.9	0.99	20.9	1,698	1,948.3	191	0.098	130	0.0667	30	0.0154
223	2-TSP-299	8/30/2007	2	30.01	27.9	0.99	21.9	1,711	1,957.8	104	0.053	62	0.0317	0	0.0000
226	1-TSP-300	9/6/2007	1	30.03	21.7	1.01	21.2	3,137	3,639.9	167	0.046	220	0.0604	58	0.0159
229	2-TSP-300	9/6/2007	2	30.03	21.7	1.01	22.5	3,112	3,598.2	110	0.031	140	0.0389	46	0.0128
232	1-TSP-301	9/14/2007	1	30.16	20.8	1.02	18.9	3,203	3,763.1	211	0.056	120	0.0319	26	0.0069
235	2-TSP-301	9/14/2007	2	30.16	20.8	1.02	20.9	3,203	3,742.8	136	0.036	87	0.0232	0	0.0000
238	5-TSP-301	9/14/2007	5	30.16	20.8	1.02	21.4	3,199	3,733.1	130	0.035	68	0.0182	0	0.0000
241	1-TSP-303	10/3/2007	1	30.17	19.1	1.03	17.8	3,145	3,718.9	461	0.124	280	0.0753	56	0.0151
244	2-TSP-303	10/3/2007	2	30.17	19.1	1.03	19.5	3,165	3,725.5	319	0.086	270	0.0725	47	0.0126
247	3-TSP-303	10/3/2007	3	30.17	19.1	1.03	23.5	3,160	3,679.6	157	0.043	63	0.0171	26	0.0071
250	5-TSP-303	10/3/2007	5	30.17	19.1	1.03	20.3	3,170	3,723.4	57	0.015	42	0.0113	0	0.0000
253	1-TSP-307	10/24/2007	1	30.33	20.0	1.03	15.6	3,166	3,780.3	462	0.122	250	0.0661	65	0.0172
256	2-TSP-307	10/24/2007	2	30.33	20.0	1.03	19.8	3,167	3,739.4	180	0.048	85	0.0227	27	0.0072
259	1-TSP-308	10/26/2007	1	30.14	22.5	1.02	14.8	3,116	3,687.0	664	0.180	290	0.0787	76	0.0206
265	1-TSP-309	11/7/2007	1	30.19	15.0	1.04	15.4	3,036	3,643.9	400	0.110	150	0.0412	47	0.0129
268	2-TSP-309	11/7/2007	2	30.19	15.0	1.04	15.6	3,041	3,648.0	153	0.042	56	0.0154	27	0.0074
271	1-TSP-310	11/9/2007	1	30.15	17.5	1.03	15.7	3,013	3,591.3	262	0.073	100	0.0278	37	0.0103
274	2-TSP-310	11/9/2007	2	30.15	17.5	1.03	15.5	2,998	3,575.3	106	0.030	42	0.0117	26	0.0073
277	1-TSP-311	11/14/2007	1	30.26	17.2	1.04	15.8	3,159	3,780.7	198	0.052	110	0.0291	37	0.0098
280	2-TSP-311	11/14/2007	2	30.26	17.2	1.04	16.2	3,165	3,783.9	92	0.024	34	0.0090	0	0.0000

Sample ID	Sample Field ID	Sample Date	Sampler Location	Ambient Pressure in (Hg)	Ambient Temperature (C)	Cubic Feet	Ave Mag Pressure (in H2O)	Minutes Operated (min)	Volume (m3)	Total Suspended		Conc Mang (ug/m3)	Lead (ug)	Conc Lead (ug/m3)	
										Particulate (mg)	Conc TSP (mg/m3)				
283	1-TSP-312	11/15/2007	1	30.19	19.2	1.03	15.5	1,546	1,840.3	292	0.159	150	0.0815	44	0.0239
286	2-TSP-312	11/15/2007	2	30.19	19.2	1.03	16.2	1,544	1,834.5	87	0.047	52	0.0283	30	0.0164
289	1-TSP-313	11/21/2007	1	30.25	14.4	1.05	15.7	3,125	3,759.8	199	0.053	120	0.0319	37	0.0098
292	5-TSP-313	11/21/2007	5	30.25	14.4	1.05	15.4	3,108	3,742.3	139	0.037	56	0.0150	27	0.0072
295	1-TSP-314	11/28/2007	1	30.37	14.4	1.05	15.9	3,195	3,857.9	292	0.076	140	0.0363	43	0.0111
298	5-TSP-314	11/28/2007	5	30.37	14.4	1.05	15.2	3,180	3,846.9	141	0.037	75	0.0195	48	0.0125
301	1-TSP-315	11/30/2007	1	30.17	17.5	1.03	15.9	2,979	3,551.3	287	0.081	120	0.0338	34	0.0096
304	2-TSP-315	11/30/2007	2	30.17	17.5	1.03	16.1	3,019	3,597.1	156	0.043	82	0.0228	0	0.0000
310	1-TSP-316	12/12/2007	1	30.32	11.9	1.06	22.2	3,240	3,858.8	223	0.058	130	0.0337	44	0.0114
313	1-TSP-317	12/14/2007	2	30.40	15.0	1.05	22.0	2,907	3,453.0	304	0.088	170	0.0492	56	0.0162
319	1-TSP-318	1/16/2008	1	30.33	12.5	1.06	9.2	3,195	3,935.5	127	0.032	38	0.0097	45	0.0114
322	2-TSP-318	1/16/2008	2	30.33	12.5	1.06	21.6	3,200	3,814.2	276	0.072	220	0.0577	92	0.0241
325	1-TSP-319	1/17/2008	1	30.24	15.8	1.04	9.6	1,465	1,785.8	91	0.051	48	0.0269	0	0.0000
328	2-TSP-319	1/17/2008	2	30.24	15.8	1.04	21.4	1,450	1,712.9	24	0.014	0	0.0000	0	0.0000
331	1-TSP-320	2/7/2008	1	30.32	13.6	1.05	12.6	3,180	3,872.7	362	0.093	160	0.0413	45	0.0116
334	1-TSP-321	2/8/2008	1	30.40	14.7	1.05	12.6	1,555	1,894.9	199	0.105	110	0.0581	28	0.0148
337	2-TSP-321	2/8/2008	2	30.40	14.7	1.05	21.1	1,556	1,853.8	55	0.030	0	0.0000	0	0.0000
340	1-TSP-322	2/13/2008	1	30.36	12.7	1.06	11.3	3,205	3,928.7	319	0.081	190	0.0484	43	0.0109
343	2-TSP-322	2/13/2008	2	30.36	12.7	1.06	21.2	3,155	3,767.1	148	0.039	52	0.0138	0	0.0000
346	3-TSP-322	2/13/2008	3	30.36	12.7	1.06	23.2	3,135	3,723.1	142	0.038	46	0.0124	0	0.0000
349	5-TSP-322	2/13/2008	5	30.36	12.7	1.06	21.3	3,145	3,754.2	152	0.040	60	0.0160	0	0.0000
352	1-TSP-323	2/15/2008	1	30.14	18.6	1.03	23.0	2,879	3,356.5	334	0.100	150	0.0447	36	0.0107
355	2-TSP-323	2/15/2008	2	30.14	18.6	1.03	22.5	2,875	3,356.4	133	0.040	61	0.0182	0	0.0000
358	3-TSP-323	2/15/2008	3	30.14	18.6	1.03	23.4	2,900	3,377.3	143	0.042	79	0.0234	0	0.0000
361	5-TSP-323	2/15/2008	5	30.14	18.6	1.03	21.5	2,886	3,378.4	112	0.033	46	0.0136	26	0.0077
364	1-TSP-324	2/20/2008	1	30.24	11.9	1.06	22.6	3,020	3,582.9	86	0.024	28	0.0078	0	0.0000
367	3-TSP-324	2/20/2008	3	30.24	11.9	1.06	23.1	3,060	3,625.4	48	0.013	0	0.0000	0	0.0000
370	5-TSP-324	2/20/2008	5	30.24	11.9	1.06	21.6	3,063	3,643.7	60	0.016	0	0.0000	0	0.0000
373	1-TSP-325	2/29/2008	1	30.30	13.6	1.05	23.1	3,180	3,763.1	431	0.115	170	0.0452	41	0.0109
376	1-TSP-326	3/5/2008	1	30.34	18.6	1.04	23.5	3,117	3,654.7	391	0.107	150	0.0410	40	0.0109
379	2-TSP-326	3/5/2008	2	30.34	18.6	1.04	23.2	3,135	3,678.8	187	0.051	64	0.0174	0	0.0000
382	5-TSP-326	3/5/2008	5	30.34	18.6	1.04	23.0	3,140	3,686.7	173	0.047	50	0.0136	0	0.0000
385	1-TSP-327	3/7/2008	1	30.22	23.3	1.02	23.3	2,942	3,406.9	318	0.093	130	0.0382	49	0.0144
388	2-TSP-327	3/7/2008	2	30.22	23.3	1.02	22.5	2,920	3,388.8	182	0.054	67	0.0198	31	0.0091
391	3-TSP-327	3/7/2008	3	30.22	23.3	1.02	24.5	2,910	3,358.9	162	0.048	68	0.0202	43	0.0128
394	5-TSP-327	3/7/2008	5	30.22	23.3	1.02	21.9	2,882	3,350.1	199	0.059	75	0.0224	33	0.0099
397	3-TSP-328	3/12/2008	3	30.37	15.8	1.05	24.4	3,035	3,572.6	147	0.041	41	0.0115	25	0.0070
400	5-TSP-328	3/12/2008	5	30.37	15.8	1.05	22.6	3,032	3,586.4	149	0.042	48	0.0134	0	0.0000
406	2-TSP-329	3/20/2008	2	30.43	16.3	1.05	22.8	3,110	3,680.9	173	0.047	65	0.0177	0	0.0000
409	3-TSP-329	3/20/2008	3	30.43	16.3	1.05	22.9	3,125	3,697.7	95	0.026	28	0.0076	0	0.0000
412	5-TSP-329	3/20/2008	5	30.43	16.3	1.05	22.5	3,120	3,695.7	134	0.036	50	0.0135	0	0.0000
415	1-TSP-330	3/21/2008	1	30.44	15.6	1.05	23.2	1,515	1,794.2	102	0.057	51	0.0284	0	0.0000
418	2-TSP-330	3/21/2008	2	30.44	15.6	1.05	22.5	1,495	1,773.9	62	0.035	34	0.0192	0	0.0000
421	1-TSP-331	3/26/2008	1	30.37	13.3	1.06	23.4	3,175	3,765.5	144	0.038	94	0.0250	0	0.0000
424	2-TSP-331	3/26/2008	2	30.37	13.3	1.06	22.8	3,190	3,789.5	162	0.043	79	0.0208	0	0.0000
430	5-TSP-331	3/26/2008	5	30.37	13.3	1.06	22.6	3,200	3,803.4	104	0.027	54	0.0142	0	0.0000

Sample ID	Sample Field ID	Sample Date	Sampler Location	Ambient Pressure in (Hg)	Ambient Temperature (C)	Cubic Feet	Ave Mag Pressure (in H2O)	Minutes Operated (min)	Volume (m3)	Total Suspended		Conc Mang (ug/m3)	Lead (ug)	Conc Lead (ug/m3)	
										Particulate (mg)	Conc TSP (mg/m3)				
433	1-TSP-332	3/28/2008	1	30.29	18.0	1.04	23.2	2,895	3,395.1	161	0.047	57	0.0168	0	0.0000
436	2-TSP-332	3/28/2008	2	30.29	18.0	1.04	23.6	2,890	3,385.5	111	0.033	43	0.0127	0	0.0000
442	5-TSP-332	3/28/2008	5	30.29	18.0	1.04	22.9	2,835	3,327.4	104	0.031	34	0.0102	0	0.0000
445	1-TSP-333	4/2/2008	1	30.26	11.9	1.06	22.8	3,165	3,755.5	201	0.054	75	0.0200	0	0.0000
448	2-TSP-333	4/2/2008	2	30.26	11.9	1.06	22.1	3,165	3,762.6	130	0.035	55	0.0146	0	0.0000
451	1-TSP-335	4/26/2008	1	30.10	18.0	1.03	22.9	2,927	3,412.5	207	0.061	71	0.0208	0	0.0000
454	2-TSP-335	4/26/2008	2	30.10	18.0	1.03	23.5	2,918	3,396.4	177	0.052	65	0.0191	0	0.0000
457	2-TSP-336	4/30/2008	2	29.97	11.9	1.05	22.0	2,992	3,521.8	135	0.038	63	0.0179	0	0.0000
460	1-TSP-337	5/2/2008	1	30.17	12.5	1.05	23.9	3,086	3,635.0	241.8	0.067	79	0.0217	25	0.0069
463	2-TSP-337	5/2/2008	2	30.17	12.5	1.05	19.2	3,083	3,678.0	180	0.049	76	0.0207	0	0.0000
466	1-TSP-338	5/3/2008	1	29.94	13.0	1.04	23.2	1,380	1,613.9	107.7	0.067	37	0.0229	0	0.0000
469	2-TSP-338	5/3/2008	2	29.94	13.0	1.04	21.6	1,370	1,609.2	79.5	0.049	37	0.0230	0	0.0000
472	1-TSP-339	5/7/2008	1	29.86	14.1	1.04	23.8	3,158	3,668.8	265.5	0.072	140	0.0382	35	0.0095
475	2-TSP-339	5/7/2008	2	29.86	14.1	1.04	21.5	3,154	3,687.3	181.7	0.049	71	0.0193	0	0.0000
481	1-TSP-340	5/9/2008	1	29.92	15.3	1.03	22.8	2,920	3,401.0	386.6	0.114	140	0.0412	36	0.0106
484	2-TSP-340	5/9/2008	2	29.92	15.3	1.03	21.9	2,913	3,401.3	234.8	0.069	76	0.0223	0	0.0000
487	5-TSP-340	5/9/2008	5	29.92	15.3	1.03	20.9	2,913	3,410.6	267.4	0.078	98	0.0287	26	0.0076
490	1-TSP-341	5/10/2008	1	29.89	14.7	1.03	23.3	1,440	1,675.1	190.2	0.114	74	0.0442	0	0.0000
493	2-TSP-341	5/10/2008	2	29.89	14.7	1.03	21.8	1,435	1,676.1	128.9	0.077	62	0.0370	0	0.0000
499	2-TSP-342	5/14/2008	2	29.88	20.3	1.01	22.8	3,305	3,807.8	236.5	0.062	100	0.0263	27	0.0071
502	5-TSP-342	5/14/2008	5	29.88	20.3	1.01	21.6	3,295	3,808.8	311.4	0.082	170	0.0446	47	0.0123
505	1-TSP-343	5/16/2008	1	29.89	29.7	0.98	23.9	2,870	3,241.7	267	0.082	210	0.0648	44	0.0136
508	2-TSP-343	5/16/2008	2	29.89	29.7	0.98	23.0	2,875	3,255.4	182.1	0.056	98	0.0301	0	0.0000
514	1-TSP-344	5/17/2008	1	29.93	24.6	1.00	24.0	1,396	1,593.2	136.1	0.085	53	0.0333	0	0.0000
517	2-TSP-344	5/17/2008	2	29.93	24.6	1.00	23.0	1,395	1,596.5	92.1	0.058	53	0.0332	0	0.0000
529	1-TSP-346	5/23/2008	1	29.68	16.6	1.02	25.1	2,993	3,425.9	426.3	0.124	170	0.0496	43	0.0126
532	2-TSP-346	5/23/2008	2	29.68	16.6	1.02	23.0	2,982	3,433.2	319.1	0.093	110	0.0320	56	0.0163
535	5-TSP-346	5/23/2008	5	29.68	16.6	1.02	23.6	2,997	3,444.8	311.2	0.090	130	0.0377	65	0.0189
538	1-TSP-347	5/29/2008	1	29.95	13.8	1.04	23.4	3,173	3,704.2	177.8	0.048	140	0.0378	39	0.0105
544	5-TSP-347	5/29/2008	5	29.95	13.8	1.04	21.0	3,171	3,726.3	144.4	0.039	88	0.0236	27	0.0072
547	1-TSP-348	5/31/2008	1	30.02	14.1	1.04	23.7	2,868	3,351.8	191.6	0.057	100	0.0298	71	0.0212
550	2-TSP-348	5/31/2008	2	30.02	14.1	1.04	22.2	2,865	3,362.1	118.3	0.035	67	0.0199	0	0.0000
553	5-TSP-348	5/31/2008	5	30.02	14.1	1.04	20.4	2,870	3,384.5	103.4	0.031	75	0.0222	25	0.0074
556	1-TSP-349	6/4/2008	1	29.89	14.4	1.04	23.1	3,121	3,634.6	265.5	0.073	150	0.0413	48	0.0132
559	2-TSP-349	6/4/2008	2	29.89	14.4	1.04	21.8	3,115	3,640.5	181.5	0.050	92	0.0253	37	0.0102
562	5-TSP-349	6/4/2008	5	29.89	14.4	1.04	21.9	3,116	3,640.7	194.7	0.053	100	0.0275	34	0.0093
565	1-TSP-350	6/6/2008	1	29.83	17.9	1.02	23.6	2,933	3,381.0	253	0.075	93	0.0275	29	0.0086
568	2-TSP-350	6/6/2008	2	29.83	17.9	1.02	22.6	2,954	3,414.6	216	0.063	120	0.0351	64	0.0187
571	1-TSP-351	6/7/2008	1	29.85	18.6	1.02	23.4	1,479	1,704.8	147.8	0.087	55	0.0323	0	0.0000
574	2-TSP-351	6/7/2008	2	29.85	18.6	1.02	22.1	1,466	1,695.9	154.8	0.091	78	0.0460	41	0.0242
577	1-TSP-352	6/11/2008	1	29.84	19.1	1.02	24.8	3,039	3,485.0	309	0.089	93	0.0267	44	0.0126
580	2-TSP-352	6/11/2008	2	29.84	19.1	1.02	23.2	3,040	3,501.5	225	0.064	79	0.0226	61	0.0174
583	1-TSP-353	6/13/2008	1	29.85	18.8	1.02	24.6	3,190	3,663.5	350	0.096	160	0.0437	54	0.0147
586	2-TSP-353	6/13/2008	2	29.85	18.8	1.02	23.8	3,170	3,648.6	256	0.070	120	0.0329	43	0.0118
589	1-TSP-354	6/16/2008	1	29.90	10.2	1.05	23.1	2,880	3,382.6	188	0.056	88	0.0260	37	0.0109
592	2-TSP-354	6/16/2008	2	29.90	10.2	1.05	22.4	2,879	3,387.9	131	0.039	45	0.0133	0	0.0000

Sample ID	Sample Field ID	Sample Date	Sampler Location	Ambient Pressure in (Hg)	Ambient Temperature (C)	Cubic Feet	Ave Mag Pressure (in H2O)	Minutes Operated	Volume (m3)	Total Suspended		Conc Manganese (ug)	Conc Mang (ug/m3)	Lead (ug)	Conc Lead (ug/m3)
										Particulate (mg)	Conc TSP (mg/m3)				
595	1-TSP-355	6/18/2008	1	29.94	16.1	1.03	24.0	3,089	3,583.1	239	0.067	100	0.0279	42	0.0117
598	2-TSP-355	6/18/2008	2	29.94	16.1	1.03	23.0	3,186	3,705.8	222	0.060	88	0.0237	73	0.0197
601	1-TSP-356	6/20/2008	1	29.89	28.4	0.99	25.7	3,068	3,456.2	220	0.064	96	0.0278	36	0.0104
604	2-TSP-356	6/20/2008	2	29.89	28.4	0.99	23.8	3,040	3,442.7	168	0.049	82	0.0238	44	0.0128
607	3-TSP-356	6/20/2008	3	29.89	28.4	0.99	21.8	3,048	3,470.8	146	0.042	63	0.0182	35	0.0101
610	5-TSP-356	6/20/2008	5	29.89	28.4	0.99	24.0	3,050	3,452.1	161	0.047	71	0.0206	43	0.0125
616	2-TSP-357	6/23/2008	2	29.92	20.0	1.02	23.0	3,090	3,565.2	151	0.042	69	0.0194	27	0.0076
619	3-TSP-357	6/23/2008	3	29.92	20.0	1.02	21.5	3,100	3,591.5	96	0.027	31	0.0086	0	0.0000
622	5-TSP-357	6/23/2008	5	29.92	20.0	1.02	20.3	3,085	3,585.8	153	0.043	61	0.0170	0	0.0000
625	1-TSP-358	6/25/2008	1	29.90	20.0	1.02	22.4	3,040	3,510.8	275	0.078	81	0.0231	0	0.0000
628	2-TSP-358	6/25/2008	2	29.90	20.0	1.02	22.9	3,037	3,502.5	278	0.079	130	0.0371	26	0.0074
631	3-TSP-358	6/25/2008	3	29.90	20.0	1.02	21.7	3,006	3,478.2	246	0.071	85	0.0244	37	0.0106
634	5-TSP-358	6/25/2008	5	29.90	20.0	1.02	22.0	3,070	3,549.3	274	0.077	110	0.0310	0	0.0000
637	1-TSP-359	6/27/2008	1	29.77	15.0	1.03	23.0	2,750	3,186.0	239	0.075	85	0.0267	0	0.0000
640	2-TSP-359	6/27/2008	2	29.77	15.0	1.03	23.3	2,750	3,183.4	278	0.087	110	0.0346	0	0.0000
643	3-TSP-359	6/27/2008	3	29.77	15.0	1.03	22.4	2,760	3,202.9	201	0.063	61	0.0190	0	0.0000
646	5-TSP-359	6/27/2008	5	29.77	15.0	1.03	22.6	2,715	3,149.0	216	0.069	71	0.0225	25	0.0079
649	1-TSP-360	6/28/2008	1	29.77	15.0	1.03	22.3	1,742	2,022.1	206	0.102	93	0.0460	27	0.0134
652	2-TSP-360	6/28/2008	2	29.77	15.0	1.03	22.1	1,713	1,989.5	169	0.085	98	0.0493	0	0.0000
655	3-TSP-360	6/28/2008	3	29.77	15.0	1.03	21.6	1,663	1,934.1	125	0.065	45	0.0233	0	0.0000
658	5-TSP-360	6/28/2008	5	29.77	15.0	1.03	22.2	1,690	1,962.3	179	0.091	98	0.0499	33	0.0168
661	1-TSP-362	7/9/2008	1	29.31	24.5	0.98	23.5	3,202	3,579.4	307	0.086	60	0.0168	25	0.0070
664	2-TSP-362	7/9/2008	2	29.31	24.5	0.98	23.3	3,178	3,554.6	245	0.069	100	0.0281	33	0.0093
667	1-TSP-363	7/11/2008	1	29.79	21.8	1.01	22.7	2,995	3,431.0	226	0.066	110	0.0321	35	0.0102
670	2-TSP-363	7/11/2008	2	29.79	21.8	1.01	22.9	3,000	3,434.8	234	0.068	160	0.0466	38	0.0111
673	1-TSP-364	7/12/2008	1	29.91	20.0	1.02	22.5	1,435	1,657.4	81	0.049	61	0.0368	0	0.0000
679	1-TSP-365	7/16/2008	1	29.98	16.8	1.03	23.2	3,189	3,707.6	197	0.053	110	0.0297	29	0.0078
682	2-TSP-365	7/16/2008	2	29.98	16.8	1.03	22.2	3,184	3,711.9	197	0.053	120	0.0323	26	0.0070
685	1-TSP-366	7/18/2008	1	29.98	16.8	1.03	22.5	2,795	3,255.7	293	0.090	190	0.0584	59	0.0181
688	2-TSP-366	7/18/2008	2	29.98	16.8	1.03	22.5	2,790	3,249.9	234	0.072	170	0.0523	39	0.0120
691	1-TSP-367	7/19/2008	1	29.92	20.0	1.02	22.5	1,605	1,854.4	104	0.056	55	0.0297	0	0.0000
694	2-TSP-367	7/19/2008	2	29.92	20.0	1.02	23.1	1,605	1,851.3	147	0.079	83	0.0448	0	0.0000
697	1-TSP-368	7/23/2008	1	29.80	18.3	1.02	23.0	3,060	3,526.8	196	0.056	100	0.0284	36	0.0102
700	2-TSP-368	7/23/2008	2	29.80	18.3	1.02	23.7	3,055	3,514.2	366	0.104	390	0.1110	110	0.0313
703	1-TSP-369	7/25/2008	1	29.80	18.3	1.02	22.7	2,900	3,345.2	270	0.081	140	0.0419	52	0.0155
706	2-TSP-369	7/25/2008	2	29.80	18.3	1.02	23.0	2,905	3,348.2	312	0.093	220	0.0657	84	0.0251
709	1-TSP-370	7/30/2008	1	29.89	16.7	1.03	22.1	3,195	3,714.6	158	0.043	100	0.0269	50	0.0135
712	2-TSP-370	7/30/2008	2	29.89	16.7	1.03	22.3	3,195	3,712.6	142	0.038	100	0.0269	29	0.0078
715	1-TSP-371	8/1/2008	1	29.88	17.2	1.03	22.7	2,990	3,466.0	133	0.038	74	0.0214	27	0.0078
718	2-TSP-371	8/1/2008	2	29.88	17.2	1.03	22.8	2,995	3,470.9	147	0.042	75	0.0216	0	0.0000
721	1-TSP-372	8/2/2008	1	29.86	17.7	1.02	22.8	1,445	1,671.8	88	0.053	62	0.0371	0	0.0000
724	2-TSP-372	8/2/2008	2	29.86	17.7	1.02	22.7	1,415	1,637.6	64	0.039	46	0.0281	0	0.0000
727	1-TSP-373	8/6/2008	1	29.92	15.0	1.03	21.8	3,315	3,873.9	113	0.029	67	0.0173	29	0.0075
730	2-TSP-373	8/4/2008	2	29.92	14.4	1.04	22.2	500	584.3	103.2	0.177	75	0.1284	0	0.0000
733	1-TSP-374	8/8/2008	1	29.92	15.8	1.03	22.3	2,890	3,367.5	87.1	0.026	48	0.0143	0	0.0000
736	2-TSP-374	8/8/2008	2	29.92	15.8	1.03	23.0	2,870	3,337.8	74.7	0.022	52	0.0156	0	0.0000

Sample ID	Sample Field ID	Sample Date	Sampler Location	Ambient Pressure in (Hg)	Ambient Temperature (C)	Cubic Feet	Ave Mag Pressure (in H2O)	Minutes Operated (min)	Volume (m3)	Total		Conc Mang (ug/m3)	Lead (ug)	Conc Lead (ug/m3)	
										Suspended Particulate (mg)	Conc TSP (mg/m3)				
739	1-TSP-375	8/9/2008	1	29.92	16.7	1.03	23.2	1,425	1,653.5	44.7	0.027	27	0.0163	0	0.0000
742	2-TSP-375	8/9/2008	2	29.92	16.7	1.03	22.1	1,425	1,658.5	47.9	0.029	48	0.0289	0	0.0000
745	1-TSP-376	8/13/2008	1	29.92	20.0	1.02	22.3	2,920	3,375.5	200.3	0.059	100	0.0296	37	0.0110
748	2-TSP-376	8/13/2008	2	29.92	20.0	1.02	22.0	2,908	3,364.4	136.6	0.041	82	0.0244	0	0.0000
751	1-TSP-377	8/15/2008	1	29.92	17.2	1.03	23.0	1,350	1,565.9	196.1	0.125	110	0.0702	44	0.0281
754	2-TSP-377	8/15/2008	2	29.92	17.2	1.03	23.1	3,145	3,646.9	138.7	0.038	97	0.0266	27	0.0074
760	2-TSP-378	8/20/2008	2	29.92	18.7	1.02	22.5	3,155	3,654.1	111.2	0.030	72	0.0197	0	0.0000
763	1-TSP-379	8/22/2008	1	29.92	17.8	1.02	23.3	3,115	3,606.0	147.9	0.041	72	0.0200	29	0.0080
766	2-TSP-379	8/22/2008	2	29.92	17.8	1.02	23.6	3,115	3,603.0	169.7	0.047	89	0.0247	31	0.0086
769	1-TSP-380	8/23/2008	1	29.92	18.3	1.02	22.8	1,405	1,627.2	73.9	0.045	28	0.0172	0	0.0000
772	2-TSP-380	8/23/2008	2	29.92	18.3	1.02	22.7	1,410	1,633.4	57.5	0.035	0	0.0000	0	0.0000
778	1-TSP-383	9/5/2008	1	29.74	22.9	1.00	23.8	3,170	3,606.6	280	0.078	130	0.0360	31	0.0086
781	1-TSP-384	9/6/2008	1	29.72	28.6	0.98	23.4	1,500	1,689.7	133	0.079	63	0.0373	0	0.0000
784	1-TSP-385	9/10/2008	1	29.72	15.8	1.02	23.1	3,094	3,571.7	180	0.050	98	0.0274	47	0.0132
787	2-TSP-385	9/10/2008	2	29.72	15.8	1.02	23.3	3,110	3,588.2	147	0.041	80	0.0223	0	0.0000
790	1-TSP-386	9/12/2008	1	29.78	14.4	1.03	22.8	3,039	3,528.1	234	0.066	100	0.0283	42	0.0119
793	2-TSP-386	9/12/2008	2	29.78	14.4	1.03	23.9	3,036	3,514.0	223	0.063	100	0.0285	35	0.0100
796	1-TSP-387	9/13/2008	1	29.72	15.7	1.03	21.9	1,445	1,674.0	73	0.044	34	0.0203	0	0.0000
799	2-TSP-387	9/13/2008	2	29.72	15.7	1.03	24.1	1,435	1,652.3	64	0.039	36	0.0218	0	0.0000
802	1-TSP-388	9/17/2008	1	29.94	14.6	1.04	23.2	3,236	3,772.7	239	0.063	160	0.0424	82	0.0217
805	2-TSP-388	9/17/2008	2	29.94	14.6	1.04	23.5	3,233	3,766.1	173	0.046	75	0.0199	0	0.0000
808	1-TSP-389	9/19/2008	1	29.93	17.8	1.03	22.8	2,895	3,357.1	179	0.053	110	0.0328	42	0.0125
811	2-TSP-389	9/19/2008	2	29.93	17.8	1.03	24.5	2,915	3,364.6	122	0.036	62	0.0184	0	0.0000
814	1-TSP-390	9/20/2008	1	29.93	18.7	1.02	23.2	1,425	1,647.9	49	0.030	28	0.0170	0	0.0000
817	2-TSP-390	9/20/2008	2	29.93	18.7	1.02	23.7	1,420	1,639.8	33	0.020	0	0.0000	0	0.0000
820	1-TSP-391	9/24/2008	1	29.90	17.8	1.02	23.4	3,120	3,608.2	203	0.056	110	0.0305	36	0.0100
823	2-TSP-391	9/24/2008	2	29.90	17.8	1.02	24.2	3,125	3,606.1	182	0.050	71	0.0197	0	0.0000
826	1-TSP-392	9/26/2008	1	29.85	20.6	1.01	23.5	3,033	3,482.1	274	0.079	130	0.0373	38	0.0109
829	2-TSP-392	9/26/2008	2	29.85	20.6	1.01	23.0	3,001	3,450.1	169	0.049	78	0.0226	29	0.0084
832	1-TSP-393	10/1/2008	1	29.87	17.6	1.02	23.3	3,161	3,654.1	203	0.056	91	0.0249	31	0.0085
835	2-TSP-393	10/1/2008	2	29.87	17.6	1.02	23.4	3,160	3,652.0	130	0.036	74	0.0203	26	0.0071
838	1-TSP-394	10/3/2008	1	29.79	20.9	1.01	22.8	2,965	3,401.4	297	0.087	170	0.0500	50	0.0147
841	2-TSP-394	10/3/2008	2	29.79	20.9	1.01	23.4	2,975	3,407.2	93	0.027	49	0.0144	0	0.0000
844	1-TSP-395	10/8/2008	1	29.83	15.8	1.03	23.7	3,195	3,696.7	303	0.082	130	0.0352	41	0.0111
847	2-TSP-395	10/8/2008	2	29.83	15.8	1.03	23.3	3,200	3,706.6	157	0.042	76	0.0205	31	0.0084
850	1-TSP-396	10/10/2008	1	29.79	16.4	1.03	24.0	2,960	3,413.2	298	0.087	130	0.0381	39	0.0114
853	2-TSP-396	10/10/2008	2	29.79	16.4	1.03	24.1	2,950	3,400.7	189	0.056	78	0.0229	0	0.0000
856	1-TSP-397	10/15/2008	1	30.03	20.6	1.02	24.2	3,260	3,759.5	230	0.061	120	0.0319	32	0.0085
862	1-TSP-398	10/17/2008	1	29.90	25.2	1.00	24.8	2,920	3,318.0	350	0.105	120	0.0362	33	0.0099
865	2-TSP-398	10/17/2008	2	29.90	25.2	1.00	23.4	2,920	3,330.9	203	0.061	76	0.0228	0	0.0000
868	1-TSP-399	10/22/2008	1	30.02	18.0	1.03	23.6	3,265	3,788.5	154	0.041	77	0.0203	26	0.0069
871	2-TSP-399	10/22/2008	2	30.02	18.0	1.03	23.2	3,270	3,798.5	260	0.068	130	0.0342	42	0.0111
877	2-TSP-400	10/24/2008	2	29.97	25.0	1.00	24.3	2,935	3,349.2	193	0.058	100	0.0299	0	0.0000
880	1-TSP-401	10/29/2008	1	30.10	10.2	1.06	24.3	3,230	3,808.2	229	0.060	56	0.0147	0	0.0000
883	2-TSP-401	10/29/2008	2	30.10	10.2	1.06	21.9	3,245	3,851.0	100	0.026	49	0.0127	0	0.0000
886	1-TSP-402	10/31/2008	1	30.03	18.9	1.02	24.9	2,910	3,360.1	190	0.057	78	0.0232	28	0.0083



Sample ID	Sample Field ID	Sample Date	Sampler Location	Ambient Pressure in (Hg)	Ambient Temperature (C)	Cubic Feet	Ave Mag Pressure (in H2O)	Minutes Operated (min)	Volume (m3)	Total Suspended		Conc		Lead (ug)	Conc Lead (ug/m3)
										Particulate (mg)	Conc TSP (mg/m3)	Manganese (ug)	Mang (ug/m3)		
889	2-TSP-402	10/31/2008	2	30.03	18.9	1.02	23.3	2,905	3,369.1	116	0.034	45	0.0134	0	0.0000
892	1-TSP-404	11/12/2008	1	30.07	14.1	1.04	24.5	3,250	3,796.7	234	0.062	95	0.0250	27	0.0071
895	2-TSP-404	11/12/2008	2	30.07	14.1	1.04	22.8	3,240	3,802.6	114	0.030	38	0.0100	0	0.0000
898	1-TSP-405	11/14/2008	1	30.04	20.9	1.02	24.6	2,915	3,357.2	131	0.039	66	0.0197	0	0.0000
901	2-TSP-405	11/14/2008	2	30.04	20.9	1.02	22.7	2,918	3,378.2	103	0.030	58	0.0172	0	0.0000
904	1-TSP-406	11/19/2008	1	30.06	14.9	1.04	24.5	3,024	3,526.0	267	0.076	140	0.0397	46	0.0130
907	2-TSP-406	11/19/2008	2	30.06	14.9	1.04	22.4	3,031	3,554.5	180	0.051	75	0.0211	28	0.0079
910	1-TSP-407	11/21/2008	1	30.05	12.1	1.05	24.4	3,005	3,522.5	185	0.053	72	0.0204	0	0.0000
913	2-TSP-407	11/21/2008	2	30.05	12.1	1.05	22.4	3,000	3,536.0	85	0.024	35	0.0099	0	0.0000
916	1-TSP-408	11/24/2008	1	29.90	16.6	1.03	24.5	2,988	3,453.0	228	0.066	100	0.0290	31	0.0090
919	2-TSP-408	11/24/2008	2	29.90	16.6	1.03	22.6	2,988	3,471.1	130	0.037	35	0.0101	0	0.0000
922	1-TSP-409	11/26/2008	1	29.90	16.6	1.03	24.6	2,895	3,344.6	287	0.086	100	0.0299	36	0.0108
925	2-TSP-409	11/26/2008	2	29.90	16.6	1.03	22.8	2,885	3,349.6	189	0.056	33	0.0099	0	0.0000
928	1-TSP-410	12/3/2008	1	30.05	10.8	1.05	24.2	3,185	3,745.1	234	0.062	92	0.0246	28	0.0075
931	2-TSP-410	12/3/2008	2	30.05	10.8	1.05	22.9	3,185	3,758.4	113	0.030	50	0.0133	0	0.0000
934	1-TSP-411	12/5/2008	1	30.06	13.5	1.04	24.6	3,069	3,587.1	154	0.043	95	0.0265	27	0.0075
937	2-TSP-411	12/5/2008	2	30.06	13.5	1.04	23.1	3,043	3,571.4	123	0.034	35	0.0098	0	0.0000
940	1-TSP-412	12/8/2008	1	30.08	9.7	1.06	24.3	2,856	3,368.1	248	0.074	86	0.0255	27	0.0080
946	1-TSP-413	12/10/2008	1	30.22	13.8	1.05	21.3	3,280	3,888.0	283	0.073	170	0.0437	48	0.0123
952	1-TSP-414	12/12/2008	1	30.22	13.8	1.05	21.0	2,910	3,452.2	276	0.080	140	0.0406	45	0.0130
955	2-TSP-414	12/12/2008	2	30.22	13.8	1.05	19.4	2,911	3,468.3	197	0.057	91	0.0262	34	0.0098
958	1-TSP-416	1/8/2009	1	30.14	9.3	1.06	21.2	3,165	3,775.2	168	0.045	52	0.0138	0	0.0000
961	2-TSP-416	1/8/2009	2	30.14	9.3	1.06	18.4	3,160	3,797.8	112	0.029	0	0.0000	0	0.0000
964	1-TSP-417	1/10/2009	1	30.09	10.9	1.06	21.2	3,010	3,572.7	118	0.033	50	0.0140	0	0.0000
967	2-TSP-417	1/10/2009	2	30.09	10.9	1.06	18.8	3,000	3,584.0	61	0.017	0	0.0000	0	0.0000
970	1-TSP-418	1/14/2009	1	30.19	18.3	1.03	21.0	3,170	3,724.6	249	0.067	100	0.0268	65	0.0175
973	2-TSP-418	1/14/2009	2	30.19	18.3	1.03	19.3	3,180	3,753.5	130	0.035	57	0.0152	26	0.0069
976	1-TSP-419	1/16/2009	1	30.08	18.4	1.03	21.9	2,990	3,490.3	270	0.077	120	0.0344	53	0.0152
979	2-TSP-419	1/16/2009	2	30.08	18.4	1.03	19.8	2,990	3,510.3	157	0.045	52	0.0148	29	0.0083
982	1-TSP-420	1/17/2009	1	30.08	16.6	1.03	21.3	1,385	1,624.9	122	0.075	57	0.0351	0	0.0000
985	2-TSP-420	1/17/2009	2	30.08	16.6	1.03	19.3	1,390	1,639.7	72	0.044	29	0.0177	0	0.0000
988	1-TSP-421	1/21/2009	1	30.08	11.9	1.05	20.8	3,216	3,812.6	295	0.077	170	0.0446	63	0.0165
991	2-TSP-421	1/21/2009	2	30.08	11.9	1.05	19.1	3,214	3,827.8	162	0.042	95	0.0248	32	0.0084
994	1-TSP-422	1/28/2009	1	30.14	9.8	1.06	21.4	3,190	3,799.2	268	0.071	170	0.0447	63	0.0166
997	2-TSP-422	1/28/2009	2	30.14	9.8	1.06	19.1	3,185	3,816.9	96	0.025	47	0.0123	0	0.0000
1000	1-TSP-423	1/30/2009	1	30.20	13.7	1.05	21.4	2,920	3,458.5	243	0.070	110	0.0318	38	0.0110
1003	2-TSP-423	1/30/2009	2	30.20	13.7	1.05	19.4	2,925	3,483.2	107	0.031	36	0.0103	0	0.0000
1006	1-TSP-424	2/4/2009	1	30.01	10.7	1.05	21.1	3,180	3,766.4	335	0.089	170	0.0451	54	0.0143
1009	2-TSP-424	2/4/2009	2	30.01	10.7	1.05	19.1	3,185	3,792.8	185	0.049	59	0.0156	0	0.0000
1012	1-TSP-425	2/6/2009	1	29.80	11.7	1.04	20.4	2,725	3,203.5	88	0.027	37	0.0115	0	0.0000
1015	2-TSP-425	2/6/2009	2	29.80	11.7	1.04	19.1	2,720	3,209.0	58	0.018	0	0.0000	0	0.0000
1018	1-TSP-426	2/12/2009	1	30.09	7.8	1.07	20.0	3,280	3,929.8	84	0.021	26	0.0066	34	0.0087
1021	2-TSP-426	2/12/2009	2	30.09	7.8	1.07	18.6	3,275	3,938.7	67	0.017	0	0.0000	0	0.0000
1024	1-TSP-427	3/11/2009	1	30.05	14.4	1.04	20.8	3,270	3,853.8	252	0.065	88	0.0228	28	0.0073
1027	2-TSP-427	3/11/2009	2	30.05	14.4	1.04	19.3	3,260	3,857.7	115	0.030	52	0.0135	0	0.0000
1030	1-TSP-428	3/13/2009	1	30.01	11.8	1.05	20.8	2,995	3,542.5	180	0.051	99	0.0279	31	0.0088

Sample ID	Sample Field ID	Sample Date	Sampler Location	Ambient Pressure in (Hg)	Ambient Temperature (C)	Cubic Feet	Ave Mag Pressure (in H2O)	Minutes Operated (min)	Volume (m3)	Total			Conc Mang (ug/m3)	Lead (ug)	Conc Lead (ug/m3)
										Suspended Particulate (mg)	Conc TSP (mg/m3)	Manganese (ug)			
1033	2-TSP-428	3/13/2009	2	30.01	11.8	1.05	19.3	2,995	3,557.0	183	0.051	100	0.0281	26	0.0073
1036	1-TSP-429	3/16/2009	1	29.96	9.2	1.06	20.6	3,135	3,722.6	76	0.020	37	0.0099	0	0.0000
1039	2-TSP-429	3/16/2009	2	29.96	9.2	1.06	19.2	3,130	3,730.8	89	0.024	51	0.0137	0	0.0000
1042	1-TSP-430	3/18/2009	1	30.16	13.3	1.05	21.0	2,950	3,495.7	131	0.037	62	0.0177	0	0.0000
1045	2-TSP-430	3/18/2009	2	30.16	13.3	1.05	19.5	2,960	3,521.7	90	0.026	44	0.0125	0	0.0000
1048	6-TSP-430	3/18/2009	6	30.16	13.3	1.05	20.9	2,975	3,526.2	123	0.035	52	0.0147	0	0.0000
1051	2-TSP-431	3/20/2009	2	29.98	12.1	1.05	19.4	2,910	3,449.5	241	0.070	110	0.0319	27	0.0078
1054	6-TSP-431	3/20/2009	6	29.98	12.1	1.05	21.4	2,905	3,424.9	410	0.120	200	0.0584	35	0.0102
1057	1-TSP-432	3/25/2009	1	30.16	12.5	1.05	20.1	3,086	3,671.4	192	0.052	96	0.0261	39	0.0106
1060	2-TSP-432	3/25/2009	2	30.16	12.5	1.05	19.5	3,155	3,759.6	206	0.055	130	0.0346	26	0.0069
1063	6-TSP-432	3/25/2009	6	30.16	12.5	1.05	20.6	3,151	3,743.7	243	0.065	150	0.0401	26	0.0069
1066	2-TSP-433	3/27/2009	2	29.96	17.1	1.03	20.0	2,936	3,439.0	224	0.065	140	0.0407	26	0.0076
1069	6-TSP-433	3/27/2009	6	29.96	17.1	1.03	21.2	2,889	3,372.9	392	0.116	230	0.0682	34	0.0101
1072	1-TSP-434	4/1/2009	1	29.94	13.9	1.04	21.1	3,202	3,759.6	257	0.068	130	0.0346	43	0.0114
1075	2-TSP-434	4/1/2009	2	29.94	13.9	1.04	19.7	3,198	3,769.3	262	0.070	140	0.0371	32	0.0085
1078	6-TSP-434	4/1/2009	6	29.94	13.9	1.04	20.5	3,188	3,749.3	259	0.069	170	0.0453	29	0.0077
1081	1-TSP-435	4/3/2009	1	29.89	13.7	1.04	21.4	2,982	3,493.6	373	0.107	200	0.0572	100	0.0286
1084	2-TSP-435	4/3/2009	2	29.89	13.7	1.04	19.9	2,985	3,511.5	389	0.111	270	0.0769	53	0.0151
1087	6-TSP-435	4/3/2009	6	29.89	13.7	1.04	21.6	2,987	3,497.6	401	0.115	210	0.0600	34	0.0097
1090	1-TSP-436	4/8/2009	1	29.97	14.1	1.04	20.6	3,200	3,764.9	154	0.041	32	0.0085	0	0.0000
1093	2-TSP-436	4/8/2009	2	29.97	14.1	1.04	19.2	3,200	3,779.3	137	0.036	27	0.0071	0	0.0000
1096	6-TSP-436	4/8/2009	6	29.97	14.1	1.04	20.4	3,191	3,756.4	220	0.059	63	0.0168	0	0.0000
1099	2-TSP-437	4/10/2009	2	29.90	12.6	1.04	19.4	2,975	3,513.2	64	0.018	0	0.0000	0	0.0000
1105	1-TSP-438	4/15/2009	1	29.89	11.9	1.04	20.4	3,293	3,882.0	434	0.112	96	0.0247	84	0.0216
1111	6-TSP-438	4/15/2009	6	29.89	11.9	1.04	20.9	3,285	3,867.3	346	0.089	92	0.0238	0	0.0000
1114	1-TSP-439	4/17/2009	1	30.05	15.7	1.04	19.8	2,885	3,400.8	176	0.052	68	0.0200	31	0.0091
1117	2-TSP-439	4/17/2009	2	30.05	15.7	1.04	19.6	2,911	3,433.3	162	0.047	70	0.0204	0	0.0000
1120	6-TSP-439	4/17/2009	6	30.05	15.7	1.04	20.4	2,910	3,424.7	182	0.053	77	0.0225	0	0.0000
1123	1-TSP-440	4/22/2009	1	29.89	20.2	1.02	20.3	3,106	3,605.1	201	0.056	86	0.0239	26	0.0072
1126	2-TSP-440	4/22/2009	2	29.89	20.2	1.02	19.9	3,165	3,677.5	194	0.053	95	0.0258	0	0.0000
1129	6-TSP-440	4/22/2009	6	29.89	20.2	1.02	20.9	3,157	3,658.3	168	0.046	79	0.0216	0	0.0000
1132	1-TSP-441	4/24/2009	1	29.88	15.5	1.03	20.0	2,994	3,507.7	355	0.101	130	0.0371	75	0.0214
1135	2-TSP-441	4/24/2009	2	29.88	15.5	1.03	20.0	2,980	3,491.3	239	0.068	110	0.0315	0	0.0000
1138	6-TSP-441	4/24/2009	6	29.88	15.5	1.03	20.6	2,976	3,480.9	278	0.080	99	0.0284	0	0.0000
1141	1-TSP-442	4/29/2009	1	29.98	10.9	1.05	19.4	3,210	3,814.0	203	0.053	100	0.0262	64	0.0168
1144	2-TSP-442	4/29/2009	2	29.98	10.9	1.05	19.1	3,230	3,840.9	172	0.045	93	0.0242	0	0.0000
1147	6-TSP-442	4/29/2009	6	29.98	10.9	1.05	20.7	3,220	3,812.4	277	0.073	150	0.0393	26	0.0068
1150	1-TSP-443	5/1/2009	1	29.98	12.8	1.04	19.4	2,940	3,480.3	145	0.042	70	0.0201	40	0.0115
1153	2-TSP-443	5/1/2009	2	29.98	12.8	1.04	19.2	2,934	3,475.1	116	0.033	62	0.0178	0	0.0000
1156	6-TSP-443	5/1/2009	6	29.98	12.8	1.04	21.0	2,959	3,487.6	195	0.056	110	0.0315	0	0.0000
1168	1-TSP-445	5/8/2009	1	29.96	18.2	1.02	19.9	3,034	3,547.3	158	0.045	66	0.0186	26	0.0073
1171	2-TSP-445	5/8/2009	2	29.96	18.2	1.02	20.0	3,013	3,521.8	160	0.045	71	0.0202	0	0.0000
1174	6-TSP-445	5/8/2009	6	29.96	18.2	1.02	20.8	2,994	3,492.0	229	0.066	92	0.0263	0	0.0000
1177	1-TSP-446	5/13/2009	1	29.94	15.7	1.03	20.0	3,185	3,737.9	252	0.067	110	0.0294	77	0.0206
1180	2-TSP-446	5/13/2009	2	29.94	15.7	1.03	19.6	3,202	3,762.0	261	0.069	130	0.0346	28	0.0074
1183	6-TSP-446	5/13/2009	6	29.94	15.7	1.03	21.5	3,222	3,766.0	390	0.104	180	0.0478	29	0.0077

Sample ID	Sample Field ID	Sample Date	Sampler Location	Ambient Pressure in (Hg)	Ambient Temperature (C)	Cubic Feet	Ave Mag Pressure (in H2O)	Minutes Operated	Volume (m3)	Total Suspended		Conc		Lead (ug)	Conc Lead (ug/m3)
										Particulate (mg)	Conc TSP (mg/m3)	Manganese (ug)	Mang (ug/m3)		
1186	1-TSP-447	5/15/2009	1	29.90	16.4	1.03	20.2	2,957	3,459.0	285	0.082	160	0.0463	250	0.0723
1189	2-TSP-447	5/15/2009	2	29.90	16.4	1.03	19.5	2,954	3,462.0	264	0.076	170	0.0491	37	0.0107
1192	6-TSP-447	5/15/2009	6	29.90	16.4	1.03	21.3	2,944	3,433.4	263	0.077	180	0.0524	27	0.0079
1195	1-TSP-448	5/20/2009	1	29.83	12.3	1.04	19.7	3,208	3,778.1	228	0.060	120	0.0318	390	0.1032
1198	2-TSP-448	5/20/2009	2	29.83	12.3	1.04	19.0	3,210	3,787.7	214	0.056	93	0.0246	27	0.0071
1201	6-TSP-448	5/20/2009	6	29.83	12.3	1.04	19.4	3,216	3,790.6	240	0.063	98	0.0259	0	0.0000
1204	1-TSP-449	5/22/2009	1	29.85	14.3	1.03	19.7	3,005	3,527.9	262	0.074	86	0.0244	190	0.0539
1207	2-TSP-449	5/22/2009	2	29.85	14.3	1.03	19.9	3,000	3,520.1	224	0.064	89	0.0253	25	0.0071
1210	6-TSP-449	5/22/2009	6	29.85	14.3	1.03	20.8	2,990	3,499.7	245	0.070	90	0.0257	0	0.0000
1213	1-TSP-450	5/28/2009	1	29.81	13.4	1.04	19.8	3,228	3,789.8	272	0.072	120	0.0317	180	0.0475
1216	2-TSP-450	5/28/2009	2	29.81	13.4	1.04	19.8	3,229	3,791.0	225	0.059	110	0.0290	34	0.0090
1219	6-TSP-450	5/28/2009	6	29.81	13.4	1.04	20.7	3,219	3,770.0	221	0.059	76	0.0202	0	0.0000
1222	1-TSP-451	5/29/2009	1	29.86	16.0	1.03	19.6	1,564	1,831.3	106	0.058	53	0.0289	130	0.0710
1225	2-TSP-451	5/29/2009	2	29.86	16.0	1.03	19.9	1,561	1,826.3	224	0.123	56	0.0307	26	0.0142
1228	6-TSP-451	5/29/2009	6	29.86	16.0	1.03	21.0	1,559	1,818.5	255	0.140	45	0.0247	0	0.0000
1231	1-TSP-452	6/3/2009	1	29.82	14.2	1.03	19.6	3,208	3,763.9	257	0.068	80	0.0213	140	0.0372
1234	2-TSP-452	6/3/2009	2	29.82	14.2	1.03	19.8	3,216	3,771.3	271	0.072	54	0.0143	0	0.0000
1237	6-TSP-452	6/3/2009	6	29.82	14.2	1.03	20.0	3,221	3,775.1	249	0.066	45	0.0119	0	0.0000
1240	1-TSP-453	6/5/2009	1	29.84	17.6	1.02	19.7	2,989	3,485.8	155	0.044	94	0.0270	99	0.0284
1243	2-TSP-453	6/5/2009	2	29.84	17.6	1.02	19.5	2,985	3,483.0	101	0.029	67	0.0192	0	0.0000
1246	6-TSP-453	6/5/2009	6	29.84	17.6	1.02	20.6	2,976	3,462.1	101	0.029	56	0.0162	0	0.0000
1249	1-TSP-454	6/10/2009	1	29.84	14.9	1.03	19.7	3,218	3,772.2	205	0.054	77	0.0204	120	0.0318
1252	2-TSP-454	6/10/2009	2	29.84	14.9	1.03	19.3	3,224	3,783.4	115	0.030	44	0.0116	0	0.0000
1255	6-TSP-454	6/10/2009	6	29.84	14.9	1.03	20.0	3,225	3,777.3	95	0.025	49	0.0130	0	0.0000
1258	1-TSP-455	6/12/2009	1	29.86	16.9	1.03	20.4	3,000	3,499.1	217	0.062	92	0.0263	110	0.0314
1261	2-TSP-455	6/12/2009	2	29.86	16.9	1.03	18.9	2,990	3,501.7	133	0.038	67	0.0191	0	0.0000
1264	6-TSP-455	6/12/2009	6	29.86	16.9	1.03	20.7	2,985	3,478.7	136	0.039	48	0.0138	0	0.0000
1267	1-TSP-456	6/17/2009	1	29.85	15.1	1.03	19.6	3,123	3,661.8	204	0.056	110	0.0300	120	0.0328
1270	2-TSP-456	6/17/2009	2	29.85	15.1	1.03	19.3	3,125	3,667.1	158	0.043	86	0.0235	0	0.0000
1273	6-TSP-456	6/17/2009	6	29.85	15.1	1.03	20.5	3,165	3,701.9	138	0.037	56	0.0151	0	0.0000
1276	1-TSP-457	6/19/2009	1	29.75	16.8	1.02	20.1	3,064	3,563.4	337	0.095	160	0.0449	190	0.0533
1279	2-TSP-457	6/19/2009	2	29.75	16.8	1.02	20.0	3,063	3,563.2	249	0.070	120	0.0337	33	0.0093
1282	6-TSP-457	6/19/2009	6	29.75	16.8	1.02	21.2	3,016	3,497.0	272	0.078	140	0.0400	29	0.0083
1285	1-TSP-458	6/24/2009	1	29.77	16.2	1.03	20.1	3,218	3,749.5	326	0.087	110	0.0293	110	0.0293
1288	2-TSP-458	6/24/2009	2	29.77	16.2	1.03	19.4	3,220	3,759.0	238	0.063	65	0.0173	0	0.0000
1291	6-TSP-458	6/24/2009	6	29.77	16.2	1.03	21.6	3,197	3,709.7	248	0.067	62	0.0167	0	0.0000
1294	1-TSP-459	6/26/2009	1	29.80	19.1	1.02	20.3	2,992	3,468.8	224	0.065	83	0.0239	71	0.0205
1297	2-TSP-459	6/26/2009	2	29.80	19.1	1.02	19.5	2,990	3,474.1	175	0.050	53	0.0153	0	0.0000
1300	6-TSP-459	6/26/2009	6	29.80	19.1	1.02	21.4	2,983	3,448.0	226	0.066	83	0.0241	0	0.0000
1303	1-TSP-460	7/1/2009	1	29.74	15.7	1.03	19.7	3,178	3,706.5	245	0.066	90	0.0243	78	0.0210
1309	6-TSP-460	7/1/2009	6	29.74	15.7	1.03	21.4	2,995	3,476.8	229	0.066	83	0.0239	0	0.0000
1312	1-TSP-461	7/2/2009	1	29.78	18.3	1.02	21.2	1,558	1,803.3	155	0.086	90	0.0499	81	0.0449
1315	2-TSP-461	7/2/2009	2	29.78	18.3	1.02	19.3	1,550	1,803.4	100	0.055	45	0.0250	0	0.0000
1318	1-TSP-462	7/8/2009	1	29.90	16.2	1.03	20.1	3,185	3,728.1	250	0.067	130	0.0349	100	0.0268
1321	2-TSP-462	7/8/2009	2	29.90	16.2	1.03	19.3	3,174	3,723.3	178	0.048	81	0.0218	0	0.0000
1324	1-TSP-463	7/10/2009	1	29.89	17.8	1.02	19.8	2,991	3,492.0	220	0.063	130	0.0372	98	0.0281

Sample ID	Sample Field ID	Sample Date	Sampler Location	Ambient Pressure in (Hg)	Ambient Temperature (C)	Cubic Feet	Ave Mag Pressure (in H2O)	Minutes Operated (min)	Volume (m3)	Total Suspended		Conc		Lead (ug)	Conc Lead (ug/m3)
										Particulate (mg)	Conc TSP (mg/m3)	Manganese (ug)	Mang (ug/m3)		
1327	2-TSP-463	7/10/2009	2	29.89	17.8	1.02	20.1	2,990	3,488.0	251	0.072	110	0.0315	31	0.0089
1330	1-TSP-464	7/15/2009	1	29.90	15.9	1.03	20.2	3,145	3,682.4	254	0.069	69	0.0187	39	0.0106
1333	2-TSP-464	7/15/2009	2	29.90	15.9	1.03	19.4	3,152	3,698.6	215	0.058	57	0.0154	0	0.0000
1336	6-TSP-464	7/15/2009	6	29.90	15.9	1.03	21.5	3,152	3,677.5	261	0.071	77	0.0209	0	0.0000
1339	1-TSP-465	7/17/2009	1	29.88	18.6	1.02	20.5	3,029	3,523.1	161	0.046	91	0.0258	59	0.0167
1342	2-TSP-465	7/17/2009	2	29.88	18.6	1.02	19.4	3,021	3,524.3	135	0.038	93	0.0264	0	0.0000
1348	1-TSP-466	7/22/2009	1	29.87	12.9	1.04	20.3	3,221	3,788.2	154	0.041	72	0.0190	48	0.0127
1351	2-TSP-466	7/22/2009	2	29.87	12.9	1.04	18.9	3,223	3,805.0	131	0.034	71	0.0187	0	0.0000
1354	6-TSP-466	7/22/2009	6	29.87	12.9	1.04	19.4	3,221	3,797.5	116	0.031	53	0.0140	0	0.0000
1357	1-TSP-467	7/24/2009	1	29.88	13.6	1.04	19.8	2,746	3,230.7	100	0.031	42	0.0130	31	0.0096
1360	2-TSP-467	7/24/2009	2	29.88	13.6	1.04	19.3	2,740	3,228.0	100	0.031	62	0.0192	0	0.0000
1363	6-TSP-467	7/24/2009	6	29.88	13.6	1.04	19.1	2,735	3,223.9	116	0.036	60	0.0186	0	0.0000
1366	1-TSP-468	7/29/2009	1	29.84	14.4	1.03	20.0	3,192	3,742.3	118	0.032	72	0.0192	57	0.0152
1369	2-TSP-468	7/29/2009	2	29.84	14.4	1.03	19.6	3,200	3,755.8	110	0.029	49	0.0130	0	0.0000
1372	6-TSP-468	7/29/2009	6	29.84	14.4	1.03	19.2	3,199	3,758.7	142	0.038	110	0.0293	0	0.0000
1375	1-TSP-469	7/31/2009	1	29.83	17.0	1.02	19.7	2,991	3,490.9	155	0.044	110	0.0315	83	0.0238
1378	2-TSP-469	7/31/2009	2	29.83	17.0	1.02	19.3	2,984	3,486.5	84	0.024	73	0.0209	0	0.0000
1381	6-TSP-469	7/31/2009	6	29.83	17.0	1.02	19.7	2,977	3,474.5	116	0.033	91	0.0262	0	0.0000
1384	1-TSP-470	8/5/2009	1	29.93	16.2	1.03	19.6	3,194	3,747.7	220	0.059	140	0.0374	100	0.0267
1387	2-TSP-470	8/5/2009	2	29.93	16.2	1.03	19.2	3,197	3,755.3	100	0.027	98	0.0261	0	0.0000
1390	6-TSP-470	8/5/2009	6	29.93	16.2	1.03	19.7	3,195	3,747.8	214	0.057	99	0.0264	0	0.0000
1393	1-TSP-471	8/7/2009	1	29.95	18.7	1.02	19.9	2,950	3,444.7	152	0.044	65	0.0189	43	0.0125
1396	2-TSP-471	8/7/2009	2	29.95	18.7	1.02	19.3	2,949	3,449.1	132	0.038	56	0.0162	0	0.0000
1399	1-TSP-472	8/12/2009	1	29.86	19.1	1.02	20.4	3,180	3,693.6	175	0.047	93	0.0252	48	0.0130
1402	2-TSP-472	8/12/2009	2	29.86	19.1	1.02	19.5	3,181	3,703.9	166	0.045	78	0.0211	0	0.0000
1405	6-TSP-472	8/12/2009	6	29.86	19.1	1.02	18.8	3,173	3,701.6	157	0.042	0	0.0000	0	0.0000
1408	1-TSP-473	8/14/2009	1	29.89	20.7	1.01	20.3	3,002	3,481.1	228	0.065	86	0.0247	53	0.0152
1411	2-TSP-473	8/14/2009	2	29.89	20.7	1.01	19.7	3,001	3,485.6	272	0.078	180	0.0516	42	0.0120
1414	6-TSP-473	8/14/2009	6	29.89	20.7	1.01	19.3	3,002	3,490.6	382	0.109	280	0.0802	44	0.0126
1417	1-TSP-474	8/19/2009	1	29.80	14.9	1.03	19.1	3,218	3,773.1	127	0.034	65	0.0172	40	0.0106
1420	2-TSP-474	8/19/2009	2	29.80	14.9	1.03	19.9	3,215	3,761.3	136	0.036	80	0.0213	0	0.0000
1423	6-TSP-474	8/19/2009	6	29.80	14.9	1.03	18.4	3,218	3,780.3	210	0.056	110	0.0291	0	0.0000
1426	1-TSP-475	8/21/2009	1	29.77	20.3	1.01	19.6	3,000	3,473.3	101	0.029	59	0.0170	29	0.0083
1429	2-TSP-475	8/21/2009	2	29.77	20.3	1.01	19.9	3,005	3,476.2	100	0.029	56	0.0161	0	0.0000
1432	6-TSP-475	8/21/2009	6	29.77	20.3	1.01	17.9	2,995	3,483.6	178	0.051	92	0.0264	0	0.0000
1435	1-TSP-476	8/26/2009	1	29.89	14.7	1.03	19.1	3,205	3,771.2	132	0.035	72	0.0191	32	0.0085
1438	2-TSP-476	8/26/2009	2	29.89	14.7	1.03	19.3	3,184	3,744.5	128	0.034	70	0.0187	0	0.0000
1441	6-TSP-476	8/26/2009	6	29.89	14.7	1.03	17.4	3,161	3,736.6	165	0.044	110	0.0294	0	0.0000
1444	1-TSP-477	8/28/2009	1	29.90	24.6	1.00	20.6	3,012	3,466.0	161	0.046	75	0.0216	30	0.0087
1447	2-TSP-477	8/28/2009	2	29.90	24.6	1.00	20.3	3,026	3,485.0	148	0.042	100	0.0287	26	0.0075
1450	6-TSP-477	8/28/2009	6	29.90	24.6	1.00	19.4	3,046	3,516.6	150	0.043	91	0.0258	0	0.0000
1453	1-TSP-478	9/2/2009	1	29.81	19.0	1.02	20.0	3,202	3,717.4	141	0.038	84	0.0226	28	0.0075
1456	2-TSP-478	9/2/2009	2	29.81	19.0	1.02	19.6	3,201	3,720.3	136	0.037	87	0.0234	0	0.0000
1459	6-TSP-478	9/2/2009	6	29.81	19.0	1.02	18.8	3,204	3,731.9	177	0.047	92	0.0247	0	0.0000
1462	1-TSP-479	9/3/2009	1	29.84	25.3	1.00	20.4	1,541	1,768.2	115	0.065	36	0.0204	0	0.0000
1465	2-TSP-479	9/3/2009	2	29.84	25.3	1.00	20.3	1,540	1,767.6	101	0.057	32	0.0181	0	0.0000

Sample ID	Sample Field ID	Sample Date	Sampler Location	Ambient Pressure in (Hg)	Ambient Temperature (C)	Cubic Feet	Ave Mag Pressure (in H2O)	Minutes Operated (min)	Volume (m3)	Total Suspended		Conc		Lead (ug)	Conc Lead (ug/m3)
										Particulate (mg)	Conc TSP (mg/m3)	Manganese (ug)	Mang (ug/m3)		
1468	6-TSP-479	9/3/2009	6	29.84	25.3	1.00	19.3	1,534	1,765.5	122	0.069	33	0.0187	0	0.0000
1471	1-TSP-480	9/10/2009	1	29.83	16.6	1.03	19.6	3,198	3,736.3	148	0.040	45	0.0120	0	0.0000
1474	2-TSP-480	9/10/2009	2	29.83	16.6	1.03	19.5	3,211	3,752.5	157	0.042	59	0.0157	0	0.0000
1477	6-TSP-480	9/10/2009	6	29.83	16.6	1.03	18.5	3,201	3,751.1	270	0.072	130	0.0347	31	0.0083
1480	1-TSP-481	9/11/2009	1	29.84	22.2	1.01	20.6	1,558	1,797.0	76	0.042	38	0.0211	0	0.0000
1483	2-TSP-481	9/11/2009	2	29.84	22.2	1.01	19.4	1,551	1,794.8	78	0.043	49	0.0273	0	0.0000
1486	6-TSP-481	9/11/2009	6	29.84	22.2	1.01	18.6	1,541	1,787.1	83	0.046	59	0.0330	0	0.0000
1489	1-TSP-482	9/16/2009	1	29.91	17.1	1.03	19.7	3,201	3,745.8	95	0.025	41	0.0109	0	0.0000
1492	2-TSP-482	9/16/2009	2	29.91	17.1	1.03	19.2	3,204	3,754.4	107	0.028	54	0.0144	0	0.0000
1495	6-TSP-482	9/16/2009	6	29.91	17.1	1.03	18.6	3,211	3,768.8	154	0.041	86	0.0228	0	0.0000
1498	1-TSP-483	9/18/2009	1	29.83	23.9	1.00	21.2	2,933	3,365.6	134	0.040	41	0.0122	0	0.0000
1501	2-TSP-483	9/18/2009	2	29.83	23.9	1.00	19.8	2,933	3,378.5	155	0.046	34	0.0101	0	0.0000
1504	6-TSP-483	9/18/2009	6	29.83	23.9	1.00	19.8	2,929	3,373.9	251	0.074	110	0.0326	51	0.0151
1507	1-TSP-484	9/23/2009	1	29.94	14.4	1.04	19.3	3,194	3,765.0	104	0.028	45	0.0120	0	0.0000
1510	2-TSP-484	9/23/2009	2	29.94	14.4	1.04	19.2	3,200	3,773.1	142	0.038	89	0.0236	0	0.0000
1513	6-TSP-484	9/23/2009	6	29.94	14.4	1.04	18.2	3,200	3,783.4	201	0.053	87	0.0230	0	0.0000
1519	2-TSP-485	9/25/2009	2	29.85	19.9	1.02	19.2	2,999	3,488.3	130	0.037	58	0.0166	0	0.0000
1522	6-TSP-485	9/25/2009	6	29.85	19.9	1.02	18.6	2,991	3,484.7	145	0.042	58	0.0166	31	0.0089
1525	1-TSP-486	9/30/2009	1	29.90	15.3	1.03	19.0	3,210	3,775.1	181	0.048	61	0.0162	44	0.0117
1528	2-TSP-486	9/30/2009	2	29.90	15.3	1.03	19.1	3,234	3,802.3	223	0.059	90	0.0237	0	0.0000
1531	6-TSP-486	9/30/2009	6	29.90	15.3	1.03	18.2	3,257	3,838.7	284	0.074	120	0.0313	34	0.0089
1534	1-TSP-487	10/2/2009	1	29.93	19.8	1.02	19.4	3,003	3,501.6	215	0.061	33	0.0094	0	0.0000
1537	2-TSP-487	10/2/2009	2	29.93	19.8	1.02	19.6	2,998	3,493.9	202	0.058	86	0.0246	0	0.0000
1552	1-TSP-489	10/9/2009	1	29.85	17.5	1.02	18.7	3,025	3,539.3	147	0.042	55	0.0155	28	0.0079
1561	1-TSP-490	10/16/2009	1	29.94	20.5	1.02	19.3	1,884	2,195.3	64	0.029	29	0.0132	0	0.0000
1564	2-TSP-490	10/16/2009	2	29.94	20.5	1.02	17.7	1,884	2,204.8	51	0.023	0	0.0000	0	0.0000
1567	6-TSP-490	10/16/2009	6	29.94	20.5	1.02	20.2	1,880	2,185.3	50	0.023	0	0.0000	0	0.0000
1570	1-TSP-491	10/21/2009	1	29.87	16.1	1.03	19.0	3,352	3,931.9	143	0.036	63	0.0160	33	0.0084
1573	2-TSP-491	10/21/2009	2	29.87	16.1	1.03	17.0	3,349	3,949.8	58	0.015	0	0.0000	0	0.0000
1576	6-TSP-491	10/21/2009	6	29.87	16.1	1.03	19.7	3,349	3,920.9	92	0.023	36	0.0092	0	0.0000
1579	1-TSP-492	10/23/2009	1	29.90	19.5	1.02	18.9	2,880	3,361.1	295	0.088	110	0.0327	47	0.0140
1582	2-TSP-492	10/23/2009	2	29.90	19.5	1.02	17.7	2,876	3,367.3	135	0.040	47	0.0140	0	0.0000
1585	6-TSP-492	10/23/2009	6	29.90	19.5	1.02	20.7	2,872	3,335.4	189	0.057	71	0.0213	25	0.0075
1588	1-TSP-493	10/28/2009	1	29.95	14.9	1.04	19.0	3,191	3,762.3	295	0.078	150	0.0399	52	0.0138
1591	2-TSP-493	10/28/2009	2	29.95	14.9	1.04	17.4	3,195	3,783.3	165	0.044	74	0.0196	0	0.0000
1594	6-TSP-493	10/28/2009	6	29.95	14.9	1.04	20.1	3,195	3,755.7	228	0.061	110	0.0293	0	0.0000
1597	1-TSP-494	10/30/2009	1	30.00	17.4	1.03	19.7	2,975	3,490.4	259	0.074	120	0.0344	33	0.0095
1600	2-TSP-494	10/30/2009	2	30.00	17.4	1.03	17.7	2,971	3,504.6	128	0.037	53	0.0151	0	0.0000
1603	6-TSP-494	10/30/2009	6	30.00	17.4	1.03	20.6	2,963	3,467.8	137	0.040	52	0.0150	0	0.0000
1606	1-TSP-495	11/4/2009	1	29.92	15.4	1.03	19.3	3,217	3,782.2	259	0.068	110	0.0291	33	0.0087
1609	2-TSP-495	11/4/2009	2	29.92	15.4	1.03	17.6	3,215	3,797.3	149	0.039	52	0.0137	0	0.0000
1612	6-TSP-495	11/4/2009	6	29.92	15.4	1.03	20.2	3,217	3,773.0	189	0.050	73	0.0193	0	0.0000
1615	1-TSP-496	11/6/2009	1	29.91	15.9	1.03	18.6	2,961	3,483.3	89	0.026	34	0.0098	0	0.0000
1618	2-TSP-496	11/6/2009	2	29.91	15.9	1.03	17.3	2,960	3,494.4	35	0.010	0	0.0000	0	0.0000
1621	6-TSP-496	11/6/2009	6	29.91	15.9	1.03	19.9	2,954	3,462.8	97	0.028	45	0.0130	0	0.0000
1624	1-TSP-497	11/11/2009	1	29.92	12.7	1.04	19.0	3,202	3,787.3	254	0.067	86	0.0227	30	0.0079

Sample ID	Sample Field ID	Sample Date	Sampler Location	Ambient Pressure in (Hg)	Ambient Temperature (C)	Cubic Feet	Ave Mag Pressure (in H2O)	Minutes Operated (min)	Volume (m3)	Total			Conc Mang (ug/m3)	Lead (ug)	Conc Lead (ug/m3)
										Suspended Particulate (mg)	Conc TSP (mg/m3)	Manganese (ug)			
1627	2-TSP-497	11/11/2009	2	29.92	12.7	1.04	17.1	3,203	3,808.0	117	0.031	42	0.0110	28	0.0074
1630	6-TSP-497	11/11/2009	6	29.92	12.7	1.04	20.8	3,204	3,771.1	157	0.042	61	0.0162	41	0.0109
1633	1-TSP-498	11/13/2009	1	29.86	14.4	1.03	19.0	3,012	3,543.4	189	0.053	77	0.0217	58	0.0164
1636	2-TSP-498	11/13/2009	2	29.86	14.4	1.03	17.5	3,017	3,563.7	109	0.031	42	0.0118	31	0.0087
1639	6-TSP-498	11/13/2009	6	29.86	14.4	1.03	21.0	3,013	3,525.3	104	0.030	31	0.0088	31	0.0088
1642	1-TSP-499	11/18/2009	1	30.08	10.7	1.06	18.9	3,209	3,832.9	186	0.049	75	0.0196	35	0.0091
1645	2-TSP-499	11/18/2009	2	30.08	10.7	1.06	17.2	3,215	3,857.6	78	0.020	28	0.0073	0	0.0000
1648	6-TSP-499	11/18/2009	6	30.08	10.7	1.06	20.3	3,216	3,826.7	118	0.031	47	0.0123	37	0.0097
1651	1-TSP-500	11/20/2009	1	29.92	12.2	1.04	19.4	2,776	3,283.0	251	0.076	63	0.0192	36	0.0110
1654	2-TSP-500	11/20/2009	2	29.92	12.2	1.04	18.1	2,802	3,325.5	184	0.055	51	0.0153	30	0.0090
1657	6-TSP-500	11/20/2009	6	29.92	12.2	1.04	20.2	2,801	3,305.4	206	0.062	110	0.0333	52	0.0157
1660	1-TSP-501	11/24/2009	1	30.07	12.7	1.05	19.0	1,852	2,202.1	101	0.046	50	0.0227	69	0.0313
1663	2-TSP-501	11/24/2009	2	30.07	12.7	1.05	19.3	1,866	2,216.9	59	0.027	34	0.0153	53	0.0239
1666	6-TSP-501	11/24/2009	6	30.07	12.7	1.05	20.1	1,863	2,208.6	63	0.029	34	0.0154	94	0.0426
1669	1-TSP-502	12/2/2009	1	29.95	9.7	1.06	18.8	3,204	3,818.0	210	0.055	73	0.0191	40	0.0105
1672	2-TSP-502	12/2/2009	2	29.95	9.7	1.06	19.4	3,199	3,805.9	125	0.033	44	0.0116	58	0.0152
1675	6-TSP-502	12/2/2009	6	29.95	9.7	1.06	20.2	3,195	3,792.9	167	0.044	56	0.0148	65	0.0171
1678	1-TSP-503	12/4/2009	1	29.95	9.9	1.05	18.9	2,993	3,564.2	138	0.039	53	0.0149	0	0.0000
1681	2-TSP-503	12/4/2009	2	29.95	9.9	1.05	19.5	2,982	3,545.3	86	0.024	0	0.0000	0	0.0000
1684	6-TSP-503	12/4/2009	6	29.95	9.9	1.05	20.1	2,980	3,537.2	179	0.051	68	0.0192	0	0.0000
1687	1-TSP-504	12/9/2009	1	29.80	5.7	1.06	19.1	3,228	3,853.8	106	0.028	30	0.0078	0	0.0000
1690	2-TSP-504	12/9/2009	2	29.80	5.7	1.06	19.3	3,263	3,893.5	78	0.020	0	0.0000	0	0.0000
1696	1-TSP-505	12/11/2009	1	29.90	7.1	1.06	18.6	2,988	3,574.7	98	0.027	0	0.0000	0	0.0000
1699	2-TSP-505	12/11/2009	2	29.90	7.1	1.06	19.0	2,957	3,533.8	86	0.024	0	0.0000	0	0.0000
1705	1-TSP-506	12/16/2009	1	30.09	10.4	1.06	18.4	3,179	3,805.7	66	0.017	0	0.0000	35	0.0092
1708	2-TSP-506	12/16/2009	2	30.09	10.4	1.06	19.1	3,177	3,796.1	52	0.014	0	0.0000	30	0.0079
1714	2-TSP-507	12/18/2009	2	30.09	12.7	1.05	19.1	2,961	3,522.2	64	0.018	0	0.0000	38	0.0108

**Cal-OSHA Permissible Exposure Limit: 5,000 ug/m3**

Sample ID	Sample Field ID	Sample Date	Sampler Location	Ambient Pressure in (Hg)	Ambient Temperature (C)	Cubic Feet	PM10 (mg)	Ave Mag Pressure (in H2O)	Minutes Operated (min)	Volume (m3)	Conc PM10 (ug/m3)
2	3-PM10-255	3/23/2007	3	30.14	21.1	1.02	128	19.7	3,031	3,527.9	36.3
8	3-PM10-256	3/30/2007	3	30.38	15.0	1.05	100	19.4	3,158	3,752.2	26.7
11	5-PM10-256	3/30/2007	5	30.38	15.0	1.05	122	20.9	3,183	3,766.8	32.4
14	3-PM10-257	4/6/2007	3	30.16	11.7	1.06	26	17.5	1,585	1,890.4	13.8
17	3-PM10-258	4/11/2007	3	30.23	15.0	1.05	77	17.4	3,091	3,673.2	21.0
20	5-PM10-258	4/11/2007	5	30.23	15.0	1.05	86	20.7	3,081	3,629.0	23.7
23	5-PM10-259	4/13/2007	5	30.24	17.8	1.04	90	21.0	3,013	3,528.5	25.5
26	3-PM10-260	5/3/2007	3	30.24	14.2	1.05	57	18.7	3,160	3,749.2	15.2
29	5-PM10-260	5/3/2007	5	30.24	14.2	1.05	63	20.5	3,179	3,753.5	16.8
32	3-PM10-261	5/5/2007	3	30.21	21.7	1.02	53	19.0	2,880	3,362.9	15.8
35	5-PM10-261	5/5/2007	5	30.21	21.7	1.02	46	21.3	2,874	3,335.2	13.8
38	3-PM10-262	5/9/2007	3	30.14	22.5	1.02	75	19.7	2,962	3,438.7	21.8
41	5-PM10-262	5/9/2007	5	30.14	22.5	1.02	69	21.5	2,968	3,428.9	20.1
44	3-PM10-263	5/11/2007	3	30.17	16.4	1.04	88	19.1	3,066	3,609.8	24.4
47	5-PM10-263	5/11/2007	5	30.17	16.4	1.04	99	20.3	3,063	3,594.6	27.5
50	3-PM10-264	5/12/2007	3	30.22	15.6	1.04	43	18.5	1,453	1,719.0	25.0
53	5-PM10-264	5/12/2007	5	30.22	15.6	1.04	52	20.2	1,474	1,735.9	30.0
56	3-PM10-265	5/16/2007	3	30.19	15.8	1.04	100	18.9	3,094	3,651.4	27.4
59	5-PM10-265	5/16/2007	5	30.19	15.8	1.04	137	20.4	2,926	3,439.2	39.8
62	3-PM10-266	5/18/2007	3	30.16	17.4	1.03	75	17.8	3,142	3,703.9	20.2
65	5-PM10-266	5/18/2007	5	30.16	17.4	1.03	123	20.9	3,121	3,648.5	33.7
68	3-PM10-267	5/19/2007	3	30.22	18.6	1.03	22	18.7	1,194	1,403.9	15.7
74	3-PM10-268	5/23/2007	3	30.10	21.8	1.02	129	19.7	2,928	3,398.8	38.0
80	3-PM10-269	5/25/2007	3	30.10	22.3	1.02	93	19.6	3,164	3,670.4	25.3
86	5-PM10-270	6/1/2007	5	30.16	14.1	1.05	75	18.5	3,162	3,743.9	20.0
89	5-PM10-271	6/2/2007	5	30.08	14.6	1.04	25	18.5	1,653	1,949.9	12.8
92	5-PM10-272	6/6/2007	5	30.17	14.7	1.04	58	18.5	2,957	3,498.3	16.6
95	5-PM10-273	6/8/2007	5	30.15	18.5	1.03	82	18.5	2,945	3,456.8	23.7
98	5-PM10-275	6/15/2007	5	30.07	22.6	1.01	174	19.2	2,980	3,455.2	50.4
101	3-PM10-276	6/16/2007	3	30.05	21.6	1.02	73	19.2	1,738	2,017.4	36.2
104	5-PM10-276	6/16/2007	5	30.05	21.6	1.02	61	18.8	1,685	1,958.0	31.2
107	5-PM10-277	6/20/2007	5	30.13	17.5	1.03	101	18.8	2,983	3,502.7	28.8
110	3-PM10-278	6/22/2007	3	30.21	20.0	1.03	64	18.8	2,970	3,480.8	18.4
113	5-PM10-278	6/22/2007	5	30.21	20.0	1.03	70	18.8	2,930	3,433.9	20.4
116	3-PM10-279	6/23/2007	3	30.13	21.4	1.02	61	19.1	1,464	1,705.2	35.8
119	5-PM10-279	6/23/2007	5	30.13	21.4	1.02	64	18.8	1,485	1,731.1	37.0
122	3-PM10-280	6/27/2007	3	30.18	15.5	1.04	106	18.9	3,063	3,615.6	29.3
125	5-PM10-280	6/27/2007	5	30.18	15.5	1.04	123	18.7	3,057	3,610.4	34.1
128	3-PM10-281	6/29/2007	3	30.21	16.8	1.04	36	19.5	2,809	3,305.7	10.9
131	3-PM10-282	6/30/2007	3	30.24	19.0	1.03	34	18.8	1,625	1,910.0	17.8
134	5-PM10-282	6/30/2007	5	30.24	19.0	1.03	27	18.7	1,568	1,843.5	14.6
137	3-PM10-283	7/3/2007	3	30.22	17.8	1.04	32	18.4	1,853	2,183.8	14.7
140	5-PM10-283	7/3/2007	5	30.22	17.8	1.04	40	19.1	1,844	2,169.1	18.4
146	5-PM10-284	7/6/2007	5	30.00	18.9	1.02	92	18.4	1,913	2,232.6	41.2
149	3-PM10-185	7/11/2007	3	30.10	19.3	1.03	44	19.2	3,142	3,669.2	12.0

Sample ID	Sample Field ID	Sample Date	Sampler Location	Ambient Pressure in (Hg)	Ambient Temperature (C)	Cubic Feet	PM10 (mg)	Ave Mag Pressure (in H2O)	Minutes Operated (min)	Volume (m3)	Conc PM10 (ug/m3)
152	5-PM10-285	7/11/2007	5	30.10	19.3	1.03	44	19.0	3,147	3,677.0	12.0
155	3-PM10-286	7/13/2007	3	30.18	24.3	1.01	46	20.0	2,992	3,464.1	13.3
158	5-PM10-286	7/13/2007	5	30.18	24.3	1.01	54	19.0	2,984	3,464.2	15.6
161	2-PM10-287	7/20/2007	2	30.10	21.5	1.02	58	17.8	1,787	2,086.2	27.8
164	2-PM10-288	7/25/2007	2	30.10	17.1	1.03	72	17.7	3,173	3,735.7	19.3
167	2-PM10-289	7/27/2007	2	30.07	19.3	1.02	80	17.6	3,110	3,643.7	22.0
170	1-PM10-290	8/1/2007	1	29.98	19.3	1.02	135	18.9	3,115	3,625.3	37.2
173	2-PM10-290	8/1/2007	2	29.98	19.3	1.02	102	17.9	3,119	3,639.8	28.0
176	1-PM10-291	8/3/2007	1	30.04	20.6	1.02	58	19.2	3,134	3,643.3	15.9
179	2-PM10-291	8/3/2007	2	30.04	20.6	1.02	84	18.1	3,101	3,615.7	23.2
182	1-PM10-292	8/8/2007	1	30.13	16.0	1.04	96	18.7	3,176	3,740.9	25.7
185	2-PM10-292	8/8/2007	2	30.13	16.0	1.04	56	18.0	3,172	3,743.2	15.0
188	1-PM10-293	8/10/2007	1	30.10	18.6	1.03	137	19.1	3,107	3,634.0	37.7
191	2-PM10-293	8/10/2007	2	30.10	18.6	1.03	70	18.0	3,113	3,651.8	19.2
194	1-PM10-294	8/15/2007	1	30.14	17.9	1.03	150	19.2	3,185	3,734.3	40.2
197	1-PM10-295	8/17/2007	1	30.06	20.2	1.02	325	22.0	3,059	3,534.3	92.0
200	2-PM10-295	8/17/2007	2	30.06	20.2	1.02	87	21.2	3,087	3,574.4	24.3
206	2-PM10-296	8/22/2007	2	30.02	20.4	1.02	94	20.3	3,160	3,661.4	25.7
209	1-PM10-297	8/24/2007	1	29.91	23.9	1.00	181	20.1	3,063	3,514.5	51.5
212	2-PM10-297	8/24/2007	2	29.91	23.9	1.00	117	20.2	3,077	3,529.6	33.1
215	1-PM10-298	8/29/2007	1	30.00	21.9	1.01	156	19.6	3,164	3,660.3	42.6
218	2-PM10-298	8/29/2007	2	30.00	21.9	1.01	69	20.0	3,157	3,648.2	18.9
221	1-PM10-299	8/30/2007	1	30.01	27.9	0.99	95	19.7	1,698	1,943.2	48.9
224	2-PM10-299	8/30/2007	2	30.01	27.9	0.99	44	20.2	1,711	1,955.4	22.5
227	1-PM10-300	9/6/2007	1	30.03	21.7	1.01	167	20.2	3,137	3,628.3	46.0
230	2-PM10-300	9/6/2007	2	30.03	21.7	1.01	110	19.8	3,112	3,603.3	30.5
233	1-PM10-301	9/14/2007	1	30.16	20.8	1.02	101	18.3	3,203	3,746.9	27.0
236	2-PM10-301	9/14/2007	2	30.16	20.8	1.02	66	19.8	3,203	3,731.7	17.7
239	5-PM10-301	9/14/2007	5	30.16	20.8	1.02	61	18.4	3,199	3,741.2	16.3
242	1-PM10-303	10/3/2007	1	30.17	19.1	1.03	102	16.8	3,145	3,707.3	27.5
245	2-PM10-303	10/3/2007	2	30.17	19.1	1.03	119	20.0	3,165	3,698.5	32.2
248	3-PM10-303	10/3/2007	3	30.17	19.1	1.03	83	16.0	3,160	3,732.5	22.2
251	5-PM10-303	10/3/2007	5	30.17	19.1	1.03	19	18.6	3,170	3,718.3	5.1
254	1-PM10-307	10/24/2007	1	30.33	20.0	1.03	238	21.1	3,166	3,703.1	64.3
257	2-PM10-307	10/24/2007	2	30.33	20.0	1.03	106	19.9	3,167	3,716.2	28.5
260	1-PM10-308	10/26/2007	1	30.14	22.5	1.02	221	20.5	3,116	3,609.7	61.2
263	2-PM10-308	10/26/2007	2	30.14	22.5	1.02	120	21.6	3,148	3,635.9	33.0
266	1-PM10-309	11/7/2007	1	30.19	15.0	1.04	221	21.2	3,036	3,566.2	62.0
269	2-PM10-309	11/7/2007	2	30.19	15.0	1.04	93	21.3	3,041	3,571.1	26.0
272	1-PM10-310	11/9/2007	1	30.15	17.5	1.03	106	21.9	3,013	3,510.8	30.2
275	2-PM10-310	11/9/2007	2	30.15	17.5	1.03	68	20.9	2,998	3,502.8	19.4
278	1-PM10-311	11/14/2007	1	30.26	17.2	1.04	91	21.4	3,159	3,702.3	24.6
281	2-PM10-311	11/14/2007	2	30.26	17.2	1.04	60	21.4	3,165	3,709.3	16.2
284	1-PM10-312	11/15/2007	1	30.19	19.2	1.03	191	22.1	1,546	1,797.3	106.3
287	2-PM10-312	11/15/2007	2	30.19	19.2	1.03	46	21.0	1,544	1,800.3	25.6
290	1-PM10-313	11/21/2007	1	30.25	14.4	1.05	107	22.3	3,125	3,671.7	29.1
293	5-PM10-313	11/21/2007	5	30.25	14.4	1.05	63	23.1	3,108	3,643.8	17.3



Sample ID	Sample Field ID	Sample Date	Sampler Location	Ambient Pressure in (Hg)	Ambient Temperature (C)	Cubic Feet	PM10 (mg)	Ave Mag Pressure (in H2O)	Minutes Operated (min)	Volume (m3)	Conc PM10 (ug/m3)
296	1-PM10-314	11/28/2007	1	30.37	14.4	1.05	126	21.8	3,195	3,774.8	33.4
299	5-PM10-314	11/28/2007	5	30.37	14.4	1.05	85	20.0	3,180	3,775.3	22.5
302	1-PM10-315	11/30/2007	1	30.17	17.5	1.03	124	21.5	2,979	3,477.4	35.7
305	2-PM10-315	11/30/2007	2	30.17	17.5	1.03	88	21.2	3,019	3,527.0	25.0
311	1-PM10-316	12/12/2007	1	30.32	11.9	1.06	183	21.1	3,240	3,847.0	47.6
314	1-PM10-317	12/14/2007	1	30.40	15.0	1.05	139	21.8	2,907	3,434.2	40.5
320	1-PM10-318	1/16/2008	1	30.33	12.5	1.06	96	19.4	3,195	3,807.9	25.2
323	2-PM10-318	1/16/2008	2	30.33	12.5	1.06	165	20.5	3,200	3,802.6	43.4
326	1-PM10-319	1/17/2008	1	30.24	15.8	1.04	55	20.2	1,465	1,725.9	31.9
329	2-PM10-319	1/17/2008	2	30.24	15.8	1.04	17	20.3	1,450	1,707.7	10.0
332	1-PM10-320	2/7/2008	1	30.32	13.6	1.05	163	19.6	3,180	3,778.6	43.1
335	1-PM10-321	2/8/2008	1	30.40	14.7	1.05	67	20.1	1,555	1,846.5	36.3
338	2-PM10-321	2/8/2008	2	30.40	14.7	1.05	42	20.3	1,556	1,846.7	22.7
341	1-PM10-322	2/13/2008	1	30.36	12.7	1.06	206	19.6	3,205	3,820.2	53.9
344	2-PM10-322	2/13/2008	2	30.36	12.7	1.06	84	21.3	3,155	3,743.5	22.4
347	3-PM10-322	2/13/2008	3	30.36	12.7	1.06	57	12.5	3,135	3,807.8	15.0
350	5-PM10-322	2/13/2008	5	30.36	12.7	1.06	59	19.5	3,145	3,749.7	15.7
353	1-PM10-323	2/15/2008	1	30.14	18.6	1.03	159	20.7	2,879	3,357.5	47.4
356	2-PM10-323	2/15/2008	2	30.14	18.6	1.03	71	20.6	2,875	3,353.7	21.2
359	3-PM10-323	2/15/2008	3	30.14	18.6	1.03	87	21.2	2,900	3,377.4	25.8
365	1-PM10-324	2/20/2008	1	30.24	11.9	1.06	46	20.0	3,020	3,586.4	12.8
371	5-PM10-324	2/20/2008	5	30.24	11.9	1.06	42	21.6	3,063	3,621.8	11.6
374	1-PM10-325	2/29/2008	1	30.30	13.6	1.05	201	19.5	3,180	3,777.0	53.2
377	1-PM10-326	3/5/2008	1	30.34	18.6	1.04	215	20.9	3,117	3,658.6	58.8
380	2-PM10-326	3/5/2008	2	30.34	18.6	1.04	108	21.8	3,135	3,670.8	29.4
383	5-PM10-326	3/5/2008	5	30.34	18.6	1.04	103	21.2	3,160	3,706.0	27.8
386	1-PM10-327	3/7/2008	1	30.22	23.3	1.02	191	20.5	2,942	3,412.6	56.0
389	2-PM10-327	3/7/2008	2	30.22	23.3	1.02	105	20.5	2,920	3,387.1	31.0
392	3-PM10-327	3/7/2008	3	30.22	23.3	1.02	117	21.2	2,910	3,369.1	34.7
395	5-PM10-327	3/7/2008	5	30.22	23.3	1.02	109	21.4	2,882	3,334.9	32.7
398	3-PM10-328	3/12/2008	3	30.37	15.8	1.05	101	21.7	3,035	3,577.2	28.2
401	5-PM10-328	3/12/2008	5	30.37	15.8	1.05	165	23.8	3,032	3,553.5	46.4
404	1-PM10-329	3/20/2008	1	30.43	16.3	1.05	119	23.1	3,110	3,656.0	32.5
407	2-TSP-329	3/20/2008	2	30.43	16.3	1.05	80	21.7	3,110	3,669.8	21.8
410	3-TSP-329	3/20/2008	3	30.43	16.3	1.05	69	18.8	3,125	3,716.2	18.6
413	5-PM10-329	3/20/2008	5	30.43	16.3	1.05	96	23.3	3,120	3,665.8	26.2
416	1-PM10-330	3/21/2008	1	30.44	15.6	1.05	67	23.4	1,515	1,782.5	37.6
419	2-PM10-330	3/21/2008	2	30.44	15.6	1.05	36	22.0	1,495	1,765.6	20.4
425	2-PM10-331	3/26/2008	2	30.37	13.3	1.06	69	20.7	3,190	3,788.1	18.2
428	3-PM10-331	3/26/2008	3	30.37	13.3	1.06	58	20.8	3,210	3,810.8	15.2
431	5-PM10-331	3/26/2008	5	30.37	13.3	1.06	74	22.1	3,200	3,785.7	19.5
434	1-PM10-332	3/28/2008	1	30.29	18.0	1.04	88	18.3	2,885	3,407.9	25.8
440	3-PM10-332	3/28/2008	3	30.29	18.0	1.04	67	20.7	2,805	3,292.1	20.4
443	5-PM10-332	3/28/2008	5	30.29	18.0	1.04	70	21.5	2,835	3,320.1	21.1
446	1-PM10-333	4/2/2008	1	30.26	11.9	1.06	97	18.9	3,165	3,772.4	25.7
449	2-PM10-333	4/2/2008	2	30.26	11.9	1.06	69	22.5	3,165	3,735.9	18.5
452	1-PM10-335	4/26/2008	1	30.10	18.0	1.03	96	17.9	2,927	3,438.4	27.9

Sample ID	Sample Field ID	Sample Date	Sampler Location	Ambient Pressure in (Hg)	Ambient Temperature (C)	Cubic Feet	PM10 (mg)	Ave Mag Pressure (in H2O)	Minutes Operated (min)	Volume (m3)	Conc PM10 (ug/m3)
455	2-PM10-335	4/26/2008	2	30.10	18.0	1.03	106	23.8	2,918	3,373.5	31.4
458	2-PM10-336	4/30/2008	2	29.97	11.9	1.05	97	23.8	2,992	3,483.4	27.8
461	1-PM10-337	5/2/2008	1	30.17	12.5	1.05	126	22.6	3,086	3,626.0	34.9
464	2-PM10-337	5/2/2008	2	30.17	12.5	1.05	117	22.8	3,083	3,620.5	32.3
467	1-PM10-338	5/3/2008	1	29.94	13.0	1.04	57	21.4	1,380	1,612.1	35.2
470	2-PM10-338	5/3/2008	2	29.94	13.0	1.04	50	22.6	1,370	1,595.2	31.2
473	1-PM10-339	5/7/2008	1	29.86	14.1	1.04	207	21.9	3,158	3,665.9	56.4
476	2-PM10-339	5/7/2008	2	29.86	14.1	1.04	118	22.8	3,154	3,652.2	32.2
482	1-PM10-340	5/9/2008	1	29.92	15.3	1.03	231	23.1	2,920	3,377.9	68.3
485	2-PM10-340	5/9/2008	2	29.92	15.3	1.03	167	22.6	2,913	3,374.5	49.5
488	5-PM10-340	5/9/2008	5	29.92	15.3	1.03	181	21.6	2,913	3,383.7	53.6
491	1-PM10-341	5/10/2008	1	29.89	14.7	1.03	91	20.6	1,440	1,677.4	54.4
494	2-PM10-341	5/10/2008	2	29.89	14.7	1.03	75	20.6	1,435	1,671.6	45.1
500	2-PM10-342	5/14/2008	2	29.88	20.3	1.01	182	22.9	3,305	3,784.2	48.0
503	5-PM10-342	5/14/2008	5	29.88	20.3	1.01	188	21.7	3,295	3,785.2	49.6
506	1-PM10-343	5/16/2008	1	29.89	29.7	0.98	191	24.0	2,870	3,222.0	59.4
509	2-PM10-343	5/16/2008	2	29.89	29.7	0.98	115	24.3	2,875	3,224.9	35.7
515	1-PM10-344	5/17/2008	1	29.93	24.6	1.00	70	19.8	1,396	1,602.2	43.4
518	2-PM10-344	5/17/2008	2	29.93	24.6	1.00	57	21.4	1,395	1,594.1	35.9
530	1-PM10-346	5/23/2008	1	29.68	16.6	1.02	210	19.3	2,993	3,460.4	60.7
533	2-PM10-346	5/23/2008	2	29.68	16.6	1.02	185	20.8	2,982	3,433.5	53.9
536	5-PM10-346	5/23/2008	5	29.68	16.6	1.02	178	21.9	2,997	3,440.4	51.6
539	1-PM10-347	5/29/2008	1	29.95	13.8	1.04	90	18.7	3,173	3,729.5	24.1
545	5-PM10-347	5/29/2008	5	29.95	13.8	1.04	56	18.5	3,171	3,729.2	15.0
548	1-PM10-348	5/31/2008	1	30.02	14.1	1.04	93	18.7	2,868	3,377.4	27.5
557	1-PM10-349	6/4/2008	1	29.89	14.4	1.04	143	19.0	3,121	3,653.5	39.2
560	2-PM10-349	6/4/2008	2	29.89	14.4	1.04	89	18.1	3,115	3,655.4	24.4
563	5-PM10-349	6/4/2008	5	29.89	14.4	1.04	90	18.8	3,116	3,649.6	24.6
566	1-PM10-350	6/6/2008	1	29.83	17.9	1.02	155	20.2	2,933	3,392.4	45.6
569	2-PM10-350	6/6/2008	2	29.83	17.9	1.02	138	19.1	2,954	3,427.0	40.3
572	1-PM10-351	6/7/2008	1	29.85	18.6	1.02	88	19.6	1,479	1,712.4	51.5
575	2-PM10-351	6/7/2008	2	29.85	18.6	1.02	96	19.0	1,466	1,700.2	56.6
578	1-PM10-352	6/11/2008	1	29.84	19.1	1.02	181	20.0	3,039	3,510.3	51.6
581	2-PM10-352	6/11/2008	2	29.84	19.1	1.02	142	18.9	3,040	3,522.0	40.3
584	1-TSP-353	6/13/2008	1	29.85	18.8	1.02	197	19.9	3,190	3,689.1	53.4
587	2-PM10-353	6/13/2008	2	29.85	18.8	1.02	161	19.0	3,170	3,674.9	43.8
590	1-PM10-354	6/16/2008	1	29.90	10.2	1.05	106	21.3	2,880	3,378.8	31.4
593	2-PM10-354	6/16/2008	2	29.90	10.2	1.05	78	20.6	2,879	3,384.1	23.0
596	1-PM10-355	6/18/2008	1	29.94	16.1	1.03	164	22.1	3,189	3,696.2	44.4
599	2-PM10-355	6/18/2008	2	29.94	16.1	1.03	132	21.7	3,186	3,696.8	35.7
602	1-PM10-356	6/20/2008	1	29.89	28.4	0.99	141	23.3	3,068	3,458.9	40.8
605	2-PM10-356	6/20/2008	2	29.89	28.4	0.99	114	21.8	3,040	3,441.4	33.1
608	3-PM10-356	6/20/2008	3	29.89	28.4	0.99	109	20.4	3,048	3,463.7	31.5
611	5-PM10-356	6/20/2008	5	29.89	28.4	0.99	110	22.9	3,050	3,442.4	32.0
614	1-PM10-357	6/23/2008	1	29.92	20.0	1.02	113	19.4	3,070	3,555.9	31.8
617	2-PM10-357	6/23/2008	2	29.92	20.0	1.02	93	21.1	3,090	3,562.6	26.1
623	5-PM10-357	6/23/2008	5	29.92	20.0	1.02	94	19.7	3,085	3,570.4	26.3

Sample ID	Sample Field ID	Sample Date	Sampler Location	Ambient Pressure in (Hg)	Ambient Temperature (C)	Cubic Feet	PM10 (mg)	Ave Mag Pressure (in H2O)	Minutes Operated (min)	Volume (m3)	Conc PM10 (ug/m3)
626	1-PM10-358	6/25/2008	1	29.90	20.0	1.02	168	21.4	3,040	3,499.6	48.0
629	2-PM10-358	6/25/2008	2	29.90	20.0	1.02	162	21.9	3,037	3,491.3	46.4
632	3-PM10-358	6/25/2008	3	29.90	20.0	1.02	157	18.1	3,006	3,491.7	45.0
635	5-PM10-358	6/25/2008	5	29.90	20.0	1.02	152	21.6	3,070	3,532.2	43.0
638	1-PM10-359	6/27/2008	1	29.77	15.0	1.03	128	21.0	2,750	3,184.5	40.2
641	2-PM10-359	6/27/2008	2	29.77	15.0	1.03	154	21.5	2,750	3,180.1	48.4
644	3-PM10-359	6/27/2008	3	29.77	15.0	1.03	137	20.7	2,760	3,198.7	42.8
647	5-PM10-359	6/27/2008	5	29.77	15.0	1.03	137	21.9	2,715	3,136.2	43.7
650	1-PM10-360	6/28/2008	1	29.77	15.0	1.03	92	18.8	1,742	2,029.4	45.3
653	2-PM10-360	6/28/2008	2	29.77	15.0	1.03	90	21.2	1,713	1,982.5	45.4
656	3-PM10-360	6/28/2008	3	29.77	15.0	1.03	84	20.7	1,663	1,927.3	43.6
659	5-PM10-360	6/28/2008	5	29.77	15.0	1.03	98	21.0	1,690	1,957.0	50.1
662	1-PM10-362	7/9/2008	1	29.31	24.5	0.98	165	20.4	3,202	3,589.3	46.0
665	2-PM10-362	7/9/2008	2	29.31	24.5	0.98	186	23.4	3,178	3,532.7	52.7
668	1-PM10-363	7/11/2008	1	29.79	21.8	1.01	138	19.9	2,995	3,437.0	40.2
671	2-PM10-363	7/11/2008	2	29.79	21.8	1.01	137	22.9	3,000	3,414.5	40.1
674	1-PM10-364	7/12/2008	1	29.91	20.0	1.02	35	20.5	1,435	1,656.6	21.1
680	1-PM10-365	7/16/2008	1	29.98	16.8	1.03	92	20.2	3,189	3,715.8	24.8
683	2-PM10-365	7/16/2008	2	29.98	16.8	1.03	96	23.1	3,184	3,680.7	26.1
686	1-PM10-366	7/18/2008	1	29.98	16.8	1.03	107	19.3	2,795	3,264.7	32.8
689	2-PM10-366	7/18/2008	2	29.98	16.8	1.03	89	22.2	2,790	3,233.2	27.5
692	1-PM10-367	7/19/2008	1	29.92	20.0	1.02	66	20.7	1,605	1,852.5	35.6
695	2-PM10-367	7/19/2008	2	29.92	20.0	1.02	66	22.1	1,605	1,845.4	35.8
698	1-PM10-368	7/23/2008	1	29.80	18.3	1.02	110	20.7	3,060	3,528.1	31.2
701	2-PM10-368	7/23/2008	2	29.80	18.3	1.02	179	22.7	3,055	3,503.0	51.1
704	1-PM10-369	7/25/2008	1	29.80	18.3	1.02	176	21.7	2,900	3,334.4	52.8
707	2-PM10-369	7/25/2008	2	29.80	18.3	1.02	185	22.4	3,005	3,448.5	53.6
710	1-PM10-370	7/30/2008	1	29.89	16.7	1.03	92	20.0	3,195	3,713.7	24.8
713	2-PM10-370	7/30/2008	2	29.89	16.7	1.03	77	22.2	3,195	3,691.4	20.9
716	1-PM10-371	8/1/2008	1	29.88	17.2	1.03	104	19.5	2,990	3,475.6	29.9
719	2-PM10-371	8/1/2008	2	29.88	17.2	1.03	93	22.8	2,995	3,450.2	27.0
722	1-PM10-372	8/2/2008	1	29.86	17.7	1.02	39	20.5	1,445	1,672.4	23.3
725	2-PM10-372	8/2/2008	2	29.86	17.7	1.02	37	22.4	141	162.3	227.9
728	1-PM10-373	8/6/2008	1	29.92	15.0	1.03	73	18.9	3,315	3,881.3	18.7
731	2-PM10-373	8/4/2008	2	29.92	14.4	1.04	62	21.9	500	581.3	106.8
734	1-PM10-374	8/8/2008	1	29.92	15.8	1.03	54	18.2	2,890	3,385.0	16.1
737	2-PM10-374	8/8/2008	2	29.92	15.8	1.03	43	19.2	2,870	3,352.5	12.9
740	1-PM10-375	8/9/2008	1	29.92	16.7	1.03	19	15.9	1,425	1,676.6	11.5
743	2-PM10-375	8/9/2008	2	29.92	16.7	1.03	23	16.7	1,425	1,673.0	13.7
746	1-PM10-376	8/13/2008	1	29.92	20.0	1.02	106	20.1	2,920	3,375.8	31.3
752	1-PM10-377	8/15/2008	1	29.92	17.2	1.03	91	20.0	1,350	1,569.3	58.1
755	2-PM10-377	8/15/2008	2	29.92	17.2	1.03	84	19.3	3,145	3,663.0	22.8
758	1-PM10-378	8/20/2008	1	29.92	18.7	1.02	57	19.6	3,150	3,655.5	15.7
761	2-PM10-378	8/20/2008	2	29.92	18.7	1.02	62	18.9	3,155	3,668.3	16.9
764	1-PM10-379	8/22/2008	1	29.92	17.8	1.02	114	20.1	3,115	3,616.1	31.6
767	2-PM10-379	8/22/2008	2	29.92	17.8	1.02	130	19.3	3,115	3,623.9	35.8
770	1-PM10-380	8/23/2008	1	29.92	18.3	1.02	45	20.1	1,405	1,629.5	27.8

Sample ID	Sample Field ID	Sample Date	Sampler Location	Ambient Pressure in (Hg)	Ambient Temperature (C)	Cubic Feet	PM10 (mg)	Ave Mag Pressure (in H2O)	Minutes Operated (min)	Volume (m3)	Conc PM10 (ug/m3)
773	2-PM10-380	8/23/2008	2	29.92	18.3	1.02	39	20.0	1,410	1,635.7	23.7
776	2-PM10-381	8/27/2008	2	29.92	20.1	1.02	131	19.6	3,080	3,564.9	36.7
779	1-PM10-383	9/5/2008	1	29.74	22.9	1.00	161	21.5	3,170	3,608.2	44.6
782	1-PM10-384	9/6/2008	1	29.72	28.6	0.98	81	19.2	1,500	1,699.3	47.7
785	1-PM10-385	9/10/2008	1	29.72	15.8	1.02	89	18.7	3,094	3,593.6	24.8
788	2-PM10-385	9/10/2008	2	29.72	15.8	1.02	63	18.6	3,110	3,613.2	17.4
791	1-PM10-386	9/12/2008	1	29.78	14.4	1.03	115	18.7	3,039	3,546.7	32.4
794	2-PM10-386	9/12/2008	2	29.78	14.4	1.03	85	18.9	3,036	3,541.2	24.0
797	1-PM10-387	9/13/2008	1	29.72	15.7	1.03	39	21.7	1,445	1,664.9	23.4
800	2-PM10-387	9/13/2008	2	29.72	15.7	1.03	18	21.3	1,435	1,655.2	10.9
803	1-PM10-388	9/17/2008	1	29.94	14.6	1.04	115	21.8	3,236	3,764.5	30.5
806	2-PM10-388	9/17/2008	2	29.94	14.6	1.04	73	22.2	3,233	3,756.9	19.4
809	1-PM10-389	9/19/2008	1	29.93	17.8	1.03	95	22.7	2,895	3,338.1	28.5
812	2-PM10-389	9/19/2008	2	29.93	17.8	1.03	46	22.6	2,915	3,362.0	13.7
815	1-PM10-390	9/20/2008	1	29.93	18.7	1.02	26	22.6	1,425	1,640.8	15.8
818	2-PM10-390	9/20/2008	2	29.93	18.7	1.02	19	22.6	1,420	1,635.0	11.6
821	1-PM10-391	9/24/2008	1	29.90	17.8	1.02	152	22.3	3,120	3,597.6	42.3
824	2-PM10-391	9/24/2008	2	29.90	17.8	1.02	100	22.7	3,125	3,599.4	27.8
827	1-PM10-392	9/26/2008	1	29.85	20.6	1.01	168	22.5	3,033	3,471.0	48.4
830	2-PM10-392	9/26/2008	2	29.85	20.6	1.01	97	23.2	3,001	3,427.7	28.3
833	1-PM10-393	10/1/2008	1	29.87	17.6	1.02	121	22.6	3,161	3,639.4	33.2
836	2-PM10-393	10/1/2008	2	29.87	17.6	1.02	64	22.6	3,160	3,638.2	17.6
839	1-PM10-394	10/3/2008	1	29.79	20.9	1.01	136	25.5	2,965	3,356.1	40.5
842	2-PM10-394	10/3/2008	2	29.79	20.9	1.01	42	21.6	2,975	3,403.9	12.3
845	1-PM10-395	10/8/2008	1	29.83	15.8	1.03	144	22.4	3,195	3,687.8	39.0
848	2-PM10-395	10/8/2008	2	29.83	15.8	1.03	72	22.2	3,200	3,695.6	19.5
851	1-PM10-396	10/10/2008	1	29.79	16.4	1.03	197	22.6	2,960	3,406.0	57.8
854	2-PM10-396	10/10/2008	2	29.79	16.4	1.03	111	22.6	2,950	3,394.5	32.7
857	1-PM10-397	10/15/2008	1	30.03	20.6	1.02	61	23.1	3,280	3,771.5	16.2
860	2-PM10-397	10/15/2008	2	30.03	20.6	1.02	124	22.2	3,255	3,751.9	33.0
863	1-PM10-398	10/17/2008	1	29.90	25.2	1.00	209	23.7	2,920	3,308.6	63.2
866	2-PM10-398	10/17/2008	2	29.90	25.2	1.00	122	22.9	2,920	3,315.8	36.8
869	1-PM10-399	10/22/2008	1	30.02	18.0	1.03	172	23.1	3,265	3,771.2	45.6
872	2-PM10-399	10/22/2008	2	30.02	18.0	1.03	82	22.2	3,270	3,786.2	21.7
878	2-PM10-400	10/24/2008	2	29.97	25.0	1.00	133	22.9	2,935	3,342.4	39.8
881	1-PM10-401	10/29/2008	1	30.10	10.2	1.06	95	21.3	3,230	3,816.3	24.9
884	2-PM10-401	10/29/2008	2	30.10	10.2	1.06	50	21.8	3,245	3,828.8	13.1
887	1-PM10-402	10/31/2008	1	30.03	18.9	1.02	88	23.2	2,910	3,355.7	26.2
890	2-PM10-402	10/31/2008	2	30.03	18.9	1.02	61	21.7	2,905	3,363.7	18.1
893	1-PM10-404	11/12/2008	1	30.07	14.1	1.04	112	22.3	3,250	3,796.7	29.5
896	2-PM10-404	11/12/2008	2	30.07	14.1	1.04	68	22.0	3,240	3,788.1	18.0
899	1-PM10-405	11/14/2008	1	30.04	20.9	1.02	84	23.2	2,915	3,350.2	25.1
902	2-PM10-405	11/14/2008	2	30.04	20.9	1.02	63	22.2	2,918	3,362.8	18.7
905	1-PM10-406	11/19/2008	1	30.06	14.9	1.04	142	22.6	3,024	3,523.1	40.3
908	2-PM10-406	11/19/2008	2	30.06	14.9	1.04	109	22.0	3,031	3,537.1	30.8
911	1-PM10-407	11/21/2008	1	30.05	12.1	1.05	101	22.3	3,005	3,521.5	28.7
914	2-PM10-407	11/21/2008	2	30.05	12.1	1.05	53	22.1	3,000	3,517.6	15.1

Sample ID	Sample Field ID	Sample Date	Sampler Location	Ambient Pressure in (Hg)	Ambient Temperature (C)	Cubic Feet	PM10 (mg)	Ave Mag Pressure (in H2O)	Minutes Operated (min)	Volume (m3)	Conc PM10 (ug/m3)
917	1-PM10-408	11/24/2008	1	29.90	16.6	1.03	147	22.0	2,988	3,456.0	42.5
920	2-PM10-408	11/24/2008	2	29.90	16.6	1.03	109	21.3	2,988	3,462.7	31.5
923	1-PM10-409	11/26/2008	1	29.90	16.6	1.03	200	22.6	2,895	3,343.0	59.8
929	1-PM10-410	12/3/2008	1	30.05	10.8	1.05	145	22.2	3,185	3,742.9	38.7
932	2-PM10-410	12/3/2008	2	30.05	10.8	1.05	89	20.8	3,185	3,757.2	23.7
938	2-PM10-411	12/5/2008	2	30.06	13.5	1.04	112	21.7	3,043	3,563.5	31.4
941	1-PM10-412	12/8/2008	1	30.08	9.7	1.06	145	21.8	2,856	3,370.7	43.0
944	2-PM10-412	12/8/2008	2	30.08	9.7	1.06	119	22.1	2,857	3,369.2	35.3
947	1-PM10-413	12/10/2008	1	30.22	13.8	1.05	154	22.4	3,280	3,853.2	40.0
950	2-PM10-413	12/10/2008	2	30.22	13.8	1.05	105	21.2	3,270	3,853.9	27.2
953	1-PM10-414	12/12/2008	1	30.22	13.8	1.05	149	22.5	2,910	3,417.6	43.6
956	2-PM10-414	12/12/2008	2	30.22	13.8	1.05	129	22.4	2,911	3,419.7	37.7
959	1-PM10-416	1/8/2009	1	30.14	9.3	1.06	110	22.0	3,165	3,744.2	29.4
962	2-PM10-416	1/8/2009	2	30.14	9.3	1.06	94	21.6	3,170	3,754.2	25.0
965	1-PM10-417	1/10/2009	1	30.09	10.9	1.06	66	21.5	3,010	3,548.3	18.6
968	2-PM10-417	1/10/2009	2	30.09	10.9	1.06	39	21.7	3,000	3,534.6	11.0
971	1-PM10-418	1/14/2009	1	30.19	18.3	1.03	138	22.4	3,170	3,688.4	37.4
974	2-PM10-418	1/14/2009	2	30.19	18.3	1.03	82	22.0	3,180	3,704.1	22.1
977	1-PM10-419	1/16/2009	1	30.08	18.4	1.03	152	22.2	2,990	3,466.8	43.8
980	2-PM10-419	1/16/2009	2	30.08	18.4	1.03	105	22.2	2,990	3,466.8	30.3
983	1-PM10-420	1/17/2009	1	30.08	16.6	1.03	73	22.6	1,385	1,609.5	45.4
986	2-PM10-420	1/17/2009	2	30.08	16.6	1.03	55	21.6	1,390	1,619.8	34.0
989	1-PM10-421	1/21/2009	1	30.08	11.9	1.05	145	21.5	3,216	3,782.5	38.3
992	2-PM10-421	1/21/2009	2	30.08	11.9	1.05	97	21.2	3,214	3,783.2	25.6
995	1-PM10-422	1/28/2009	1	30.14	9.8	1.06	147	22.1	3,190	3,769.1	39.0
998	2-PM10-422	1/28/2009	2	30.14	9.8	1.06	48	21.9	3,185	3,765.2	12.7
1001	1-PM10-423	1/30/2009	1	30.20	13.7	1.05	143	22.3	2,920	3,429.4	41.7
1004	2-PM10-423	1/30/2009	2	30.20	13.7	1.05	78	21.8	2,925	3,440.0	22.7
1007	1-PM10-424	2/4/2009	1	30.01	10.7	1.05	201	22.1	3,180	3,733.5	53.8
1010	2-PM10-424	2/4/2009	2	30.01	10.7	1.05	123	21.7	3,185	3,743.5	32.9
1013	1-PM10-425	2/6/2009	1	29.80	11.7	1.04	54	22.1	2,725	3,169.4	17.0
1016	2-PM10-425	2/6/2009	2	29.80	11.7	1.04	39	21.6	2,720	3,167.9	12.3
1019	1-PM10-426	2/12/2009	1	30.09	7.8	1.07	65	20.8	3,280	3,897.6	16.7
1022	2-PM10-426	2/12/2009	2	30.09	7.8	1.07	41	21.3	3,275	3,886.4	10.5
1025	1-PM10-427	3/11/2009	1	30.05	14.4	1.04	152	21.6	3,270	3,822.4	39.8
1028	2-PM10-427	3/11/2009	2	30.05	14.4	1.04	64	21.3	3,260	3,813.9	16.8
1031	1-PM10-428	3/13/2009	1	30.01	11.8	1.05	130	21.8	2,995	3,511.7	37.0
1034	2-PM10-428	3/13/2009	2	30.01	11.8	1.05	94	21.3	2,995	3,516.5	26.7
1037	1-PM10-429	3/16/2009	1	29.96	9.2	1.06	61	21.9	3,135	3,687.0	16.5
1040	2-PM10-429	3/16/2009	2	29.96	9.2	1.06	35	21.4	3,130	3,686.1	9.5
1043	1-PM10-430	3/18/2009	1	30.16	13.3	1.05	95	21.9	2,950	3,466.2	27.4
1046	2-PM10-430	3/18/2009	2	30.16	13.3	1.05	39	21.8	2,960	3,478.9	11.2
1049	6-PM10-430	3/18/2009	6	30.16	13.3	1.05	83	20.2	2,975	3,511.7	23.6
1052	2-PM10-431	3/20/2009	2	29.98	12.1	1.05	95	22.2	2,910	3,402.7	27.9
1055	6-PM10-431	3/20/2009	6	29.98	12.1	1.05	158	20.6	2,905	3,411.7	46.3
1058	1-PM10-432	3/25/2009	1	30.16	12.5	1.05	91	21.9	3,086	3,631.6	25.1
1061	2-PM10-432	3/25/2009	2	30.16	12.5	1.05	121	21.7	3,155	3,714.8	32.6

Sample ID	Sample Field ID	Sample Date	Sampler Location	Ambient Pressure in (Hg)	Ambient Temperature (C)	Cubic Feet	PM10 (mg)	Ave Mag Pressure (in H2O)	Minutes Operated (min)	Volume (m3)	Conc PM10 (ug/m3)
1064	6-PM10-432	3/25/2009	6	30.16	12.5	1.05	196	20.7	3,151	3,720.2	52.7
1067	2-PM10-433	3/27/2009	2	29.96	17.1	1.03	113	21.9	2,936	3,400.8	33.2
1070	6-PM10-433	3/27/2009	6	29.96	17.1	1.03	181	21.0	2,889	3,354.6	54.0
1073	1-PM10-434	4/1/2009	1	29.94	13.9	1.04	166	22.2	3,202	3,725.9	44.6
1079	6-PM10-434	4/1/2009	6	29.94	13.9	1.04	160	20.0	3,188	3,731.9	42.9
1082	1-PM10-435	4/3/2009	1	29.89	13.7	1.04	227	22.7	2,978	3,455.7	65.7
1085	2-PM10-435	4/3/2009	2	29.89	13.7	1.04	212	21.6	2,985	3,474.3	61.0
1088	6-PM10-435	4/3/2009	6	29.89	13.7	1.04	343	22.2	2,987	3,470.9	98.8
1091	1-PM10-436	4/8/2009	1	29.97	14.1	1.04	110	21.6	3,200	3,732.2	29.5
1094	2-PM10-436	4/8/2009	2	29.97	14.1	1.04	76	21.8	3,200	3,730.2	20.4
1097	6-PM10-436	4/8/2009	6	29.97	14.1	1.04	192	20.5	3,191	3,732.9	51.4
1100	2-PM10-437	4/10/2009	2	29.90	12.6	1.04	40	21.8	2,975	3,469.3	11.5
1103	6-PM10-437	4/10/2009	6	29.90	12.6	1.04	81	21.1	2,975	3,476.0	23.3
1109	2-PM10-438	4/15/2009	2	29.89	11.9	1.04	225	21.7	3,295	3,847.4	58.5
1112	6-PM10-438	4/15/2009	6	29.89	11.9	1.04	361	21.4	3,285	3,838.8	94.0
1118	2-PM10-439	4/17/2009	2	30.05	15.7	1.04	100	22.9	2,911	3,382.4	29.6
1121	6-PM10-439	4/17/2009	6	30.05	15.7	1.04	156	21.4	2,910	3,395.0	45.9
1124	1-PM10-440	4/22/2009	1	29.89	20.2	1.02	116	18.3	3,106	3,603.3	32.2
1127	2-PM10-440	4/22/2009	2	29.89	20.2	1.02	127	22.8	3,165	3,626.9	35.0
1130	6-PM10-440	4/22/2009	6	29.89	20.2	1.02	142	22.0	3,157	3,625.7	39.2
1133	1-PM10-441	4/24/2009	1	29.88	15.5	1.03	232	22.4	2,994	3,464.0	67.0
1136	2-PM10-441	4/24/2009	2	29.88	15.5	1.03	156	22.9	2,980	3,443.0	45.3
1139	6-PM10-441	4/24/2009	6	29.88	15.5	1.03	213	17.6	2,976	3,488.5	61.1
1142	1-PM10-442	4/29/2009	1	29.98	10.9	1.05	162	22.6	3,210	3,758.1	43.1
1145	2-PM10-442	4/29/2009	2	29.98	10.9	1.05	128	22.4	3,230	3,783.6	33.8
1148	6-PM10-442	4/29/2009	6	29.98	10.9	1.05	227	20.4	3,220	3,792.5	59.9
1151	1-PM10-443	5/1/2009	1	29.98	12.8	1.04	78	21.4	2,940	3,440.6	22.7
1154	2-PM10-443	5/1/2009	2	29.98	12.8	1.04	65	22.7	2,934	3,421.4	19.0
1157	6-PM10-443	5/1/2009	6	29.98	12.8	1.04	143	20.1	2,959	3,475.1	41.1
1160	1-PM10-444	5/6/2009	1	30.01	17.8	1.03	20	22.8	3,137	3,626.4	5.5
1163	2-PM10-444	5/6/2009	2	30.01	17.8	1.03	13	23.5	3,146	3,629.8	3.6
1166	6-PM10-444	5/6/2009	6	30.01	17.8	1.03	37	20.0	3,174	3,697.2	10.0
1169	1-PM10-445	5/8/2009	1	29.96	18.2	1.02	110	23.0	3,034	3,496.5	31.5
1172	2-PM10-445	5/8/2009	2	29.96	18.2	1.02	85	22.8	3,013	3,474.2	24.5
1175	6-PM10-445	5/8/2009	6	29.96	18.2	1.02	165	21.1	2,994	3,468.4	47.6
1178	1-PM10-446	5/13/2009	1	29.94	15.7	1.03	205	20.8	3,185	3,707.6	55.3
1181	2-PM10-446	5/13/2009	2	29.94	15.7	1.03	166	20.6	3,202	3,729.4	44.5
1184	6-PM10-446	5/13/2009	6	29.94	15.7	1.03	210	21.9	3,222	3,739.4	56.2
1187	1-PM10-447	5/15/2009	1	29.90	16.4	1.03	182	22.4	2,957	3,417.7	53.3
1190	2-PM10-447	5/15/2009	2	29.90	16.4	1.03	120	23.3	2,954	3,405.8	35.2
1193	6-PM10-447	5/15/2009	6	29.90	16.4	1.03	138	21.1	2,944	3,414.8	40.4
1196	1-PM10-448	5/20/2009	1	29.83	12.3	1.04	146	21.7	3,208	3,734.9	39.1
1199	2-PM10-448	5/20/2009	2	29.83	12.3	1.04	99	22.8	3,220	3,737.6	26.5
1202	6-PM10-448	5/20/2009	6	29.83	12.3	1.04	94	21.9	3,216	3,742.2	25.1
1205	1-PM10-449	5/22/2009	1	29.85	14.3	1.03	153	21.9	3,005	3,485.7	43.9
1208	2-PM10-449	5/22/2009	2	29.85	14.3	1.03	116	22.7	3,000	3,472.3	33.4
1211	6-PM10-449	5/22/2009	6	29.85	14.3	1.03	134	20.6	2,990	3,480.7	38.5

Sample ID	Sample Field ID	Sample Date	Sampler Location	Ambient Pressure in (Hg)	Ambient Temperature (C)	Cubic Feet	PM10 (mg)	Ave Mag Pressure (in H2O)	Minutes Operated (min)	Volume (m3)	Conc PM10 (ug/m3)
1214	1-PM10-450	5/28/2009	1	29.81	13.4	1.04	174	20.9	3,228	3,755.8	46.3
1217	2-PM10-450	5/28/2009	2	29.81	13.4	1.04	143	20.9	3,229	3,757.0	38.1
1220	6-PM10-450	5/28/2009	6	29.81	13.4	1.04	133	19.9	3,219	3,755.6	35.4
1223	1-PM10-451	5/29/2009	1	29.86	16.0	1.03	59	21.2	1,564	1,812.4	32.6
1226	2-PM10-451	5/29/2009	2	29.86	16.0	1.03	49	21.7	1,561	1,806.5	27.1
1229	6-PM10-451	5/29/2009	6	29.86	16.0	1.03	47	19.4	1,559	1,815.6	25.9
1232	1-PM10-452	6/3/2009	1	29.82	14.2	1.03	98	20.9	3,208	3,728.1	26.3
1235	2-PM10-452	6/3/2009	2	29.82	14.2	1.03	65	21.7	3,216	3,729.3	17.4
1238	6-PM10-452	6/3/2009	6	29.82	14.2	1.03	69	17.4	3,221	3,779.1	18.3
1241	1-PM10-453	6/5/2009	1	29.84	17.6	1.02	90	20.1	2,989	3,461.3	26.0
1244	2-PM10-453	6/5/2009	2	29.84	17.6	1.02	59	21.8	2,985	3,440.6	17.1
1247	6-PM10-453	6/5/2009	6	29.84	17.6	1.02	73	18.5	2,976	3,461.3	21.1
1250	1-PM10-454	6/10/2009	1	29.84	14.9	1.03	90	17.6	3,218	3,771.2	23.9
1253	2-PM10-454	6/10/2009	2	29.84	14.9	1.03	50	20.7	3,224	3,746.4	13.3
1256	6-PM10-454	6/10/2009	6	29.84	14.9	1.03	74	18.4	3,225	3,771.2	19.6
1259	1-PM10-455	6/12/2009	1	29.86	16.9	1.03	120	20.5	3,000	3,477.3	34.5
1262	2-PM10-455	6/12/2009	2	29.86	16.9	1.03	78	20.8	2,990	3,462.9	22.5
1265	6-PM10-455	6/12/2009	6	29.86	16.9	1.03	76	19.1	2,985	3,473.1	21.9
1268	1-PM10-456	6/17/2009	1	29.85	15.1	1.03	118	20.5	3,124	3,632.1	32.5
1271	2-PM10-456	6/17/2009	2	29.85	15.1	1.03	72	20.5	3,125	3,633.3	19.8
1274	6-PM10-456	6/17/2009	6	29.85	15.1	1.03	86	19.4	3,165	3,690.8	23.3
1277	1-PM10-457	6/19/2009	1	29.75	16.8	1.02	232	20.6	3,064	3,537.3	65.6
1280	2-PM10-457	6/19/2009	2	29.75	16.8	1.02	161	24.1	3,063	3,502.2	46.0
1283	6-PM10-457	6/19/2009	6	29.75	16.8	1.02	115	23.2	3,016	3,457.1	33.3
1286	1-PM10-458	6/24/2009	1	29.77	16.2	1.03	214	23.2	3,218	3,695.5	57.9
1289	2-PM10-458	6/24/2009	2	29.77	16.2	1.03	160	23.5	3,220	3,694.7	43.3
1292	6-PM10-458	6/24/2009	6	29.77	16.2	1.03	156	23.2	3,197	3,671.4	42.5
1295	1-PM10-459	6/26/2009	1	29.80	19.1	1.02	142	24.0	2,992	3,413.4	41.6
1298	2-PM10-459	6/26/2009	2	29.80	19.1	1.02	94	23.3	2,990	3,417.7	27.5
1301	6-PM10-459	6/26/2009	6	29.80	19.1	1.02	120	23.2	2,983	3,410.6	35.2
1304	1-PM10-460	7/1/2009	1	29.74	15.7	1.03	151	24.0	3,178	3,641.0	41.5
1307	2-PM10-460	7/1/2009	2	29.74	15.7	1.03	138	23.8	3,183	3,648.8	37.8
1310	6-PM10-460	7/1/2009	6	29.74	15.7	1.03	138	22.8	2,995	3,442.8	40.1
1313	1-PM10-461	7/2/2009	1	29.78	18.3	1.02	132	23.9	1,558	1,779.3	74.2
1319	1-PM10-462	7/8/2009	1	29.90	16.2	1.03	130	22.7	3,185	3,679.6	35.3
1322	2-PM10-462	7/8/2009		29.90	16.2	1.03	101	22.9	3,174	3,664.9	27.6
1328	2-PM10-463	7/10/2009	2	29.89	17.8	1.02	110	23.6	2,990	3,434.2	32.0
1331	1-PM10-464	7/15/2009	1	29.90	15.9	1.03	145	23.7	3,145	3,625.5	40.0
1334	2-PM10-464	7/15/2009	2	29.90	15.9	1.03	126	22.7	3,152	3,643.6	34.6
1337	6-PM10-464	7/15/2009	6	29.90	15.9	1.03	149	23.2	3,152	3,638.6	41.0
1340	1-PM10-465	7/17/2009	1	29.88	18.6	1.02	76	23.5	3,029	3,473.5	21.9
1343	2-PM10-465	7/17/2009	2	29.88	18.6	1.02	42	23.0	3,021	3,469.1	12.1
1346	6-PM10-465	7/17/2009	6	29.88	18.6	1.02	55	22.8	3,015	3,464.1	15.9
1349	1-PM10-466	7/22/2009	1	29.87	12.9	1.04	60	23.1	3,221	3,736.7	16.1
1352	2-PM10-466	7/22/2009	2	29.87	12.9	1.04	22	21.2	3,223	3,758.5	5.9
1355	6-PM10-466	7/22/2009	6	29.87	12.9	1.04	54	20.5	3,221	3,763.4	14.3
1358	1-PM10-467	7/24/2009	1	29.88	13.6	1.04	43	20.7	2,746	3,203.5	13.4

Sample ID	Sample Field ID	Sample Date	Sampler Location	Ambient Pressure in (Hg)	Ambient Temperature (C)	Cubic Feet	PM10 (mg)	Ave Mag Pressure (in H2O)	Minutes Operated (min)	Volume (m3)	Conc PM10 (ug/m3)
1361	2-PM10-467	7/24/2009	2	29.88	13.6	1.04	31	21.5	2,740	3,189.5	9.7
1364	6-PM10-467	7/24/2009	6	29.88	13.6	1.04	48	21.4	2,735	3,184.5	15.1
1367	1-PM10-468	7/29/2009	1	29.84	14.4	1.03	73	20.6	3,192	3,713.8	19.7
1370	2-PM10-468	7/29/2009	2	29.84	14.4	1.03	36	21.4	3,200	3,715.0	9.7
1373	6-PM10-468	7/29/2009	6	29.84	14.4	1.03	62	21.1	3,199	3,716.9	16.7
1376	1-PM10-469	7/31/2009	1	29.83	17.0	1.02	74	20.5	2,991	3,462.5	21.4
1379	2-PM10-469	7/31/2009	2	29.83	17.0	1.02	27	21.9	2,984	3,441.2	7.8
1382	6-PM10-469	7/31/2009	6	29.83	17.0	1.02	48	21.2	2,977	3,439.7	14.0
1385	1-PM10-470	8/5/2009	1	29.93	16.2	1.03	98	20.5	3,194	3,716.2	26.4
1388	2-PM10-470	8/5/2009	2	29.93	16.2	1.03	35	21.6	3,197	3,708.6	9.4
1391	6-PM10-470	8/5/2009	6	29.93	16.2	1.03	60	21.3	3,195	3,709.3	16.2
1394	1-PM10-471	8/7/2009	1	29.95	18.7	1.02	71	21.4	2,950	3,410.2	20.8
1397	2-PM10-471	8/7/2009	2	29.95	18.7	1.02	52	21.9	2,949	3,404.4	15.3
1400	1-PM10-472	8/12/2009	1	29.86	19.1	1.02	79	22.0	3,180	3,655.7	21.6
1403	2-PM10-472	8/12/2009	2	29.86	19.1	1.02	69	21.7	3,181	3,659.8	18.9
1406	6-PM10-472	8/12/2009	6	29.86	19.1	1.02	84	21.6	3,173	3,651.6	23.0
1409	1-PM10-473	8/14/2009	1	29.89	20.7	1.01	129	21.7	3,002	3,447.3	37.4
1412	2-PM10-473	8/14/2009	2	29.89	20.7	1.01	128	22.3	3,001	3,440.5	37.2
1415	6-PM10-473	8/14/2009	6	29.89	20.7	1.01	218	22.2	3,002	3,442.6	63.3
1418	1-PM10-474	8/19/2009	1	29.80	14.9	1.03	65	21.9	3,218	3,721.9	17.5
1421	2-PM10-474	8/19/2009	2	29.80	14.9	1.03	66	21.0	3,215	3,727.6	17.7
1424	6-PM10-474	8/19/2009	6	29.80	14.9	1.03	101	21.1	3,218	3,730.1	27.1
1427	1-PM10-475	8/21/2009	1	29.77	20.3	1.01	53	21.3	3,000	3,436.7	15.4
1430	2-PM10-475	8/21/2009	2	29.77	20.3	1.01	42	21.9	3,005	3,436.7	12.2
1433	6-PM10-475	8/21/2009	6	29.77	20.3	1.01	76	20.6	2,995	3,437.5	22.1
1436	1-PM10-476	8/26/2009	1	29.89	14.7	1.03	66	20.6	3,205	3,733.4	17.7
1439	2-PM10-476	8/26/2009	2	29.89	14.7	1.03	63	21.5	3,184	3,699.8	17.0
1442	6-PM10-476	8/26/2009	6	29.89	14.7	1.03	94	21.2	3,161	3,676.1	25.6
1445	1-PM10-477	8/28/2009	1	29.90	24.6	1.00	74	21.8	3,012	3,434.4	21.5
1448	2-PM10-477	8/28/2009	2	29.90	24.6	1.00	62	21.9	3,026	3,449.4	18.0
1451	6-PM10-477	8/28/2009	6	29.90	24.6	1.00	84	21.7	3,046	3,474.1	24.2
1454	1-PM10-478	9/2/2009	1	29.81	19.0	1.02	67	21.4	3,202	3,681.2	18.2
1457	2-PM10-478	9/2/2009	2	29.81	19.0	1.02	63	21.9	3,201	3,675.0	17.1
1460	6-PM10-478	9/2/2009	6	29.81	19.0	1.02	85	21.0	3,204	3,687.5	23.1
1463	1-PM10-479	9/3/2009	1	29.84	25.3	1.00	65	22.4	1,541	1,748.3	37.2
1466	2-PM10-479	9/3/2009	2	29.84	25.3	1.00	58	22.5	1,540	1,746.6	33.2
1469	6-PM10-479	9/3/2009	6	29.84	25.3	1.00	70	21.3	1,534	1,745.6	40.1
1472	1-PM10-480	9/10/2009	1	29.83	16.6	1.03	81	21.4	3,198	3,695.8	21.9
1475	2-PM10-480	9/10/2009	2	29.83	16.6	1.03	85	22.0	3,211	3,704.8	22.9
1481	1-PM10-481	9/11/2009	1	29.84	22.2	1.01	44	21.7	1,558	1,781.0	24.7
1484	2-PM10-481	9/11/2009	2	29.84	22.2	1.01	29	22.1	1,551	1,771.0	16.4
1487	6-PM10-481	9/11/2009	6	29.84	22.2	1.01	48	20.0	1,541	1,769.8	27.1
1490	1-PM10-482	9/16/2009	1	29.91	17.1	1.03	54	21.0	3,201	3,710.4	14.6
1493	2-PM10-482	9/16/2009	2	29.91	17.1	1.03	56	21.9	3,204	3,704.7	15.1
1496	6-PM10-482	9/16/2009	6	29.91	17.1	1.03	86	20.7	3,211	3,725.0	23.1
1499	1-PM10-483	9/18/2009	1	29.83	23.9	1.00	91	21.7	2,933	3,341.2	27.2
1502	2-PM10-483	9/18/2009	2	29.83	23.9	1.00	92	22.7	2,933	3,332.0	27.6



Sample ID	Sample Field ID	Sample Date	Sampler Location	Ambient Pressure in (Hg)	Ambient Temperature (C)	Cubic Feet	PM10 (mg)	Ave Mag Pressure (in H2O)	Minutes Operated (min)	Volume (m3)	Conc PM10 (ug/m3)
1505	6-PM10-483	9/18/2009	6	29.83	23.9	1.00	126	22.8	2,929	3,326.5	37.9
1508	1-PM10-484	9/23/2009	1	29.94	14.4	1.04	55	20.6	3,194	3,729.3	14.7
1511	2-PM10-484	9/23/2009	2	29.94	14.4	1.04	67	21.6	3,200	3,726.1	18.0
1514	6-PM10-484	9/23/2009	6	29.94	14.4	1.04	83	20.8	3,200	3,734.3	22.2
1517	1-PM10-485	9/25/2009	1	29.85	19.9	1.02	73	20.5	3,005	3,462.3	21.1
1520	2-PM10-485	9/25/2009	2	29.85	19.9	1.02	58	21.8	2,999	3,443.1	16.8
1523	6-PM10-485	9/25/2009	6	29.85	19.9	1.02	72	21.3	2,991	3,438.7	20.9
1526	1-PM10-486	9/30/2009	1	29.90	15.3	1.03	162	20.3	3,210	3,739.3	43.3
1529	2-PM10-486	9/30/2009	2	29.90	15.3	1.03	160	21.7	3,234	3,752.9	42.6
1532	6-PM10-486	9/30/2009	6	29.90	15.3	1.03	186	20.7	3,257	3,789.9	49.1
1535	1-PM10-487	10/2/2009	1	29.93	19.8	1.02	126	21.5	3,003	3,461.0	36.4
1541	6-PM10-487	10/2/2009	6	29.93	19.8	1.02	142	21.8	2,992	3,445.5	41.2
1544	1-PM10-488	10/7/2009	1	29.83	14.7	1.03	141	21.1	3,167	3,676.3	38.4
1547	2-PM10-488	10/7/2009	2	29.83	14.7	1.03	122	18.6	3,163	3,696.8	33.0
1550	6-PM10-488	10/7/2009	6	29.83	14.7	1.03	165	21.7	3,167	3,670.2	45.0
1556	2-PM10-489	10/9/2009	2	29.85	17.5	1.02	57	18.5	3,024	3,519.0	16.2
1559	6-PM10-489	10/9/2009	6	29.85	17.5	1.02	101	21.2	3,026	3,495.5	28.9
1562	1-PM10-490	10/16/2009	1	29.94	20.5	1.02	42	21.3	1,884	2,170.5	19.4
1565	2-PM10-490	10/16/2009	2	29.94	20.5	1.02	31	18.1	1,884	2,189.4	14.2
1568	6-PM10-490	10/16/2009	6	29.94	20.5	1.02	36	21.3	1,880	2,165.9	16.6
1571	1-PM10-491	10/21/2009	1	29.87	16.1	1.03	66	21.2	3,352	3,885.1	17.0
1574	2-PM10-491	10/21/2009	2	29.87	16.1	1.03	37	17.9	3,349	3,916.7	9.4
1577	6-PM10-491	10/21/2009	6	29.87	16.1	1.03	60	20.8	3,349	3,885.9	15.4
1580	1-PM10-492	10/23/2009	1	29.90	19.5	1.02	133	21.7	2,880	3,315.8	40.1
1583	2-PM10-492	10/23/2009	2	29.90	19.5	1.02	72	18.8	2,876	3,337.4	21.6
1586	6-PM10-492	10/23/2009	6	29.90	19.5	1.02	96	21.8	2,872	3,305.6	29.0
1589	1-PM10-493	10/28/2009	1	29.95	14.9	1.04	161	21.1	3,191	3,718.5	43.3
1592	2-PM10-493	10/28/2009	2	29.95	14.9	1.04	71	18.3	3,195	3,751.6	18.9
1595	6-PM10-493	10/28/2009	6	29.95	14.9	1.04	98	21.2	3,195	3,722.1	26.3
1598	1-PM10-494	10/30/2009	1	30.00	17.4	1.03	134	21.6	2,975	3,451.8	38.8
1601	2-PM10-494	10/30/2009	2	30.00	17.4	1.03	76	18.8	2,971	3,473.4	21.9
1604	6-PM10-494	10/30/2009	6	30.00	17.4	1.03	94	21.6	2,963	3,437.8	27.3
1607	1-PM10-495	11/4/2009	1	29.92	15.4	1.03	121	21.4	3,217	3,738.2	32.4
1610	2-PM10-495	11/4/2009	2	29.92	15.4	1.03	82	18.6	3,215	3,764.4	21.8
1616	1-PM10-496	11/6/2009	1	29.91	15.9	1.03	54	21.8	2,961	3,432.5	15.7
1619	2-PM10-496	11/6/2009	2	29.91	15.9	1.03	31	18.6	2,960	3,461.3	9.0
1622	6-PM10-496	11/6/2009	6	29.91	15.9	1.03	57	21.0	2,954	3,431.8	16.6
1625	1-PM10-497	11/11/2009	1	29.92	12.7	1.04	112	21.2	3,202	3,742.1	29.9
1628	2-PM10-497	11/11/2009	2	29.92	12.7	1.04	70	18.7	3,203	3,768.8	18.6
1631	6-PM10-497	11/11/2009	6	29.92	12.7	1.04	93	20.9	3,204	3,747.5	24.8
1634	1-PM10-498	11/13/2009	1	29.86	14.4	1.03	91	21.7	3,012	3,496.3	26.0
1637	2-PM10-498	11/13/2009	2	29.86	14.4	1.03	59	19.1	3,017	3,527.1	16.7
1640	6-PM10-498	11/13/2009	6	29.86	14.4	1.03	71	21.2	3,013	3,502.3	20.3
1643	1-PM10-499	11/18/2009	1	30.08	10.7	1.06	84	21.4	3,209	3,784.1	22.2
1646	2-PM10-499	11/18/2009	2	30.08	10.7	1.06	48	18.6	3,215	3,820.0	12.6
1649	6-PM10-499	11/18/2009	6	30.08	10.7	1.06	68	20.7	3,216	3,799.5	17.9
1652	1-PM10-500	11/20/2009	1	29.92	12.2	1.04	90	21.5	2,776	3,244.7	27.7

Sample ID	Sample Field ID	Sample Date	Sampler Location	Ambient Pressure in (Hg)	Ambient Temperature (C)	Cubic Feet	PM10 (mg)	Ave Mag Pressure (in H2O)	Minutes Operated (min)	Volume (m3)	Conc PM10 (ug/m3)
1655	2-PM10-500	11/20/2009	2	29.92	12.2	1.04	51	19.0	2,802	3,297.5	15.5
1658	6-PM10-500	11/20/2009	6	29.92	12.2	1.04	114	20.8	2,801	3,280.2	34.8
1661	1-PM10-501	11/24/2009	1	30.07	12.7	1.05	66	21.0	1,852	2,177.0	30.3
1664	2-PM10-501	11/24/2009	2	30.07	12.7	1.05	32	18.8	1,866	2,206.6	14.5
1667	6-PM10-501	11/24/2009	6	30.07	12.7	1.05	37	20.9	1,863	2,190.6	16.9
1670	1-PM10-502	12/2/2009	1	29.95	9.7	1.06	116	20.9	3,204	3,773.4	30.7
1673	2-PM10-502	12/2/2009	2	29.95	9.7	1.06	88	18.4	3,199	3,793.2	23.2
1676	6-PM10-502	12/2/2009	6	29.95	9.7	1.06	103	20.6	3,195	3,765.9	27.4
1679	1-PM10-503	12/4/2009	1	29.95	9.9	1.05	79	21.0	2,993	3,522.6	22.4
1682	2-PM10-503	12/4/2009	2	29.95	9.9	1.05	58	18.5	2,982	3,533.5	16.4
1685	6-PM10-503	12/4/2009	6	29.95	9.9	1.05	89	21.0	2,980	3,507.3	25.4
1688	1-PM10-504	12/9/2009	1	29.80	5.7	1.06	64	20.4	3,228	3,816.8	16.8
1691	2-PM10-504	12/9/2009	2	29.80	5.7	1.06	50	18.5	3,263	3,878.3	12.9
1694	6-PM10-504	12/9/2009	6	29.80	5.7	1.06	59	20.0	3,259	3,857.7	15.3
1697	1-PM10-505	12/11/2009	1	29.90	7.1	1.06	95	21.0	2,988	3,529.9	26.9
1703	6-PM10-505	12/11/2009	6	29.90	7.1	1.06	95	20.8	2,951	3,488.1	27.2
1706	1-PM10-506	12/16/2009	1	30.09	10.4	1.06	53	20.2	3,179	3,764.4	14.1
1709	2-PM10-506	12/16/2009	2	30.09	10.4	1.06	38	18.7	3,177	3,777.4	10.1
1712	1-PM10-507	12/18/2009	1	30.09	12.7	1.05	78	21.2	2,980	3,503.6	22.3
1715	2-PM10-507	12/18/2009	2	30.09	12.7	1.05	50	19.4	2,961	3,498.2	14.3

**Cal-OSHA Permissible Exposure Limit: 0.1 fiber/cc**

Sample ID	Sample Field ID	Sample Date	Sampler Location	Ambient Pressure in (Hg)	Ambient Temperature (C)	Cubic Feet	Asbestos (fibers)	Ave Flow Rate (l/min)	Minutes Operated (min)	Volume (m3)	Conc Asbestos (fibers/cc)
0039-0003	3-A-255	3/23/2007	3	30.14	21.1	1.02	2,827	2.00	3,031	6.19	0.0005
0039-0006	5-A-255	3/23/2007	5	30.14	21.1	1.02	3,299	2.00	3,022	6.17	0.0005
0039-0009	3-A-256	3/30/2007	3	30.38	15.0	1.05	0	2.00	3,158	6.64	0.0000
0039-0012	5-A-256	3/30/2007	5	30.38	15.0	1.05	0	2.00	3,183	6.69	0.0000
0039-0015	3-A-257	4/6/2007	3	30.16	11.7	1.06	0	2.00	1,585	3.34	0.0000
0039-0018	3-A-258	4/11/2007	3	30.23	15.0	1.05	3,063	2.00	3,091	6.46	0.0005
0039-0021	5-A-258	4/11/2007	5	30.23	15.0	1.05	5,655	2.00	3,081	6.44	0.0009
0039-0024	5-A-259	4/13/2007	5	30.24	17.8	1.04	3,063	2.00	3,013	6.24	0.0005
0039-0027	3-A-260	5/3/2007	3	30.24	14.2	1.05	0	2.00	3,160	6.63	0.0000
0039-0030	5-A-260	5/3/2007	5	30.24	14.2	1.05	0	2.00	3,179	6.67	0.0000
0039-0033	3-A-261	5/5/2007	3	30.21	21.7	1.02	0	2.00	2,880	5.88	0.0000
0039-0036	5-A-261	5/5/2007	5	30.21	21.7	1.02	0	2.00	2,874	5.87	0.0000
0039-0039	3-A-262	5/9/2007	3	30.14	22.5	1.02	3,534	2.00	2,962	6.02	0.0006
0039-0042	5-A-262	5/9/2007	5	30.14	22.5	1.02	4,477	2.00	2,968	6.03	0.0007
0039-0045	3-A-263	5/11/2007	3	30.17	16.4	1.04	0	2.00	3,066	6.37	0.0000
0039-0048	5-A-263	5/11/2007	5	30.17	16.4	1.04	0	2.00	3,066	6.37	0.0000
0039-0051	3-A-264	5/12/2007	3	30.22	15.6	1.04	0	2.00	1,453	3.03	0.0000
0039-0054	5-A-264	5/12/2007	5	30.22	15.6	1.04	0	2.00	1,474	3.07	0.0000
0039-0057	3-A-265	5/16/2007	3	30.19	15.8	1.04	0	2.00	3,094	6.44	0.0000
0039-0060	5-A-265	5/16/2007	5	30.19	15.8	1.04	2,827	2.00	2,926	6.09	0.0005
0039-0063	3-A-266	5/18/2007	3	30.16	17.4	1.03	0	2.00	3,142	6.50	0.0000
0039-0066	5-A-266	5/18/2007	5	30.16	17.4	1.03	3,770	2.00	3,121	6.46	0.0006
0039-0069	3-A-267	5/19/2007	3	30.22	18.6	1.03	0	2.00	1,194	2.46	0.0000
0039-0072	5-A-267	5/19/2007	5	30.22	18.6	1.03	0	2.00	1,197	2.47	0.0000
0039-0075	3-A-268	5/23/2007	3	30.10	21.8	1.02	4,241	2.00	2,928	5.96	0.0007
0039-0078	5-A-268	5/23/2007	5	30.10	21.8	1.02	5,184	2.00	2,929	5.96	0.0009
0039-0081	3-A-269	5/25/2007	3	30.10	22.3	1.02	0	2.00	3,164	6.42	0.0000
0039-0084	5-A-269	5/25/2007	5	30.10	22.3	1.02	0	2.00	3,156	6.41	0.0000
0039-0087	5-A-270	6/1/2007	5	30.16	14.1	1.05	0	2.00	3,162	6.62	0.0000
0039-0090	5-A-271	6/2/2007	5	30.08	14.6	1.04	0	2.00	1,653	3.44	0.0000
0039-0093	5-A-272	6/6/2007	5	30.17	14.7	1.04	0	2.00	2,957	6.18	0.0000
0039-0096	5-A-273	6/8/2007	5	30.15	18.5	1.03	5,890	2.00	2,945	6.07	0.0010
0039-0099	5-A-275	6/15/2007	5	30.07	22.6	1.01	8,718	2.00	2,980	6.04	0.0014
0039-0102	3-A-276	6/16/2007	3	30.05	21.6	1.02	0	2.00	1,738	3.53	0.0000
0039-0105	5-A-276	6/16/2007	5	30.05	21.6	1.02	4,006	2.00	1,685	3.42	0.0012
0039-0108	5-A-277	6/20/2007	5	30.13	17.5	1.03	3,063	2.00	2,983	6.16	0.0005
0039-0111	3-A-278	6/22/2007	3	30.21	20.0	1.03	0	2.00	2,970	6.10	0.0000
0039-0114	5-A-278	6/22/2007	5	30.21	20.0	1.03	4,241	2.00	2,930	6.02	0.0007
0039-0117	3-A-279	6/23/2007	3	30.13	21.4	1.02	0	2.00	1,464	2.98	0.0000
0039-0123	3-A-280	6/27/2007	3	30.18	15.5	1.04	3,770	2.00	3,063	6.38	0.0006
0039-0129	3-A-281	6/29/2007	3	30.21	16.8	1.04	3,770	2.00	2,809	5.83	0.0006
0039-0132	3-A-282	6/30/2007	3	30.24	19.0	1.03	5,184	2.00	1,625	3.35	0.0015
0039-0135	5-A-282	6/30/2007	5	30.24	19.0	1.03	0	2.00	1,568	3.23	0.0000
0039-0138	3-A-283	7/3/2007	3	30.22	17.8	1.04	4,948	2.00	1,853	3.84	0.0013
0039-0141	5-A-283	7/3/2007	5	30.22	17.8	1.04	3,299	2.00	1,844	3.82	0.0009

Sample ID	Sample Field ID	Sample Date	Sampler Location	Ambient Pressure in (Hg)	Ambient Temperature (C)	Cubic Feet	Asbestos (fibers)	Ave Flow Rate (l/min)	Minutes Operated (min)	Volume (m3)	Conc Asbestos (fibers/cc)
0039-0144	3-A-284	7/6/2007	3	30.00	18.9	1.02	0	2.00	1,865	3.82	0.0000
0039-0147	5-A-284	7/6/2007	5	30.00	18.9	1.02	11,310	2.00	1,913	3.92	0.0029
0039-0150	3-A-285	7/11/2007	3	30.10	19.3	1.03	0	2.00	3,142	6.45	0.0000
0039-0153	5-A-285	7/11/2007	5	30.10	19.3	1.03	3,770	2.00	3,147	6.46	0.0006
0039-0156	3-A-286	7/13/2007	3	30.18	24.3	1.01	0	2.00	2,992	6.05	0.0000
0039-0159	5-A-286	7/13/2007	5	30.18	24.3	1.01	0	2.00	2,984	6.03	0.0000
0039-0162	2-A-287	7/20/2007	2	30.10	21.5	1.02	0	2.00	1,787	3.64	0.0000
0039-0165	2-A-288	7/25/2007	2	30.10	17.1	1.03	4,006	2.00	3,173	6.56	0.0006
0039-0168	2-A-289	7/27/2007	2	30.07	19.3	1.02	0	2.00	3,110	6.37	0.0000
0039-0171	1-A-290	8/1/2007	1	29.98	19.3	1.02	12,488	2.00	3,115	6.36	0.0020
0039-0174	2-A-290	8/1/2007	2	29.98	19.3	1.02	2,827	2.00	3,119	6.37	0.0004
0039-0177	1-A-291	8/3/2007	1	30.04	20.6	1.02	11,545	2.00	3,134	6.39	0.0018
0039-0180	2-A-291	8/3/2007	2	30.04	20.6	1.02	0	2.00	3,101	6.32	0.0000
0039-0183	1-A-292	8/8/2007	1	30.13	16.0	1.04	10,132	2.00	3,176	6.60	0.0015
0039-0186	2-A-292	8/8/2007	2	30.13	16.0	1.04	4,948	2.00	3,172	6.59	0.0008
0039-0189	1-A-293	8/10/2007	1	30.10	18.6	1.03	14,844	2.00	3,107	6.39	0.0023
0039-0192	2-A-293	8/10/2007	2	30.10	18.6	1.03	0	2.00	3,113	6.40	0.0000
0039-0195	1-A-294	8/15/2007	1	30.14	17.9	1.03	14,844	2.00	3,185	6.57	0.0023
0039-0198	1-A-295	8/17/2007	1	30.06	20.2	1.02	12,017	2.00	3,059	6.25	0.0019
0039-0201	2-A-295	8/17/2007	2	30.06	20.2	1.02	5,419	2.10	3,087	6.62	0.0008
0039-0204	1-A-296	8/22/2007	1	30.02	20.4	1.02	13,666	2.00	3,166	6.45	0.0021
0039-0207	2-A-296	8/22/2007	2	30.02	20.4	1.02	4,241	2.00	3,160	6.44	0.0007
0039-0210	1-A-297	8/24/2007	1	29.91	23.9	1.00	7,775	2.00	3,063	6.15	0.0013
0039-0213	2-A-297	8/24/2007	2	29.91	23.9	1.00	3,299	2.00	3,077	6.17	0.0005
0039-0216	1-A-298	8/29/2007	1	30.00	21.9	1.01	0	2.00	3,164	6.41	0.0000
0039-0219	2-A-298	8/29/2007	2	30.00	21.9	1.01	9,660	2.00	3,157	6.40	0.0015
0039-0222	1-A-299	8/30/2007	1	30.01	27.9	0.99	4,712	2.00	1,698	3.37	0.0014
0039-0225	2-A-299	8/30/2007	2	30.01	27.9	0.99	0	2.00	1,711	3.40	0.0000
0039-0228	1-A-300	9/6/2007	1	30.03	21.7	1.01	13,666	2.00	3,138	6.37	0.0021
0039-0231	2-A-300	9/6/2007	2	30.03	21.7	1.01	3,299	2.00	3,112	6.32	0.0005
0039-0234	1-A-301	9/14/2007	1	30.16	20.8	1.02	8,718	2.00	3,203	6.55	0.0013
0039-0237	2-A-301	9/14/2007	2	30.16	20.8	1.02	2,827	2.00	3,203	6.55	0.0004
0039-0240	5-A-301	9/14/2007	5	30.16	20.8	1.02	0	2.00	3,199	6.54	0.0000
0039-0243	1-A-303	10/3/2007	1	30.17	19.1	1.03	4,006	2.00	3,145	6.47	0.0006
0039-0246	2-A-303	10/3/2007	2	30.17	19.1	1.03	4,712	2.00	3,105	6.39	0.0007
0039-0249	3-A-303	10/3/2007	3	30.17	19.1	1.03	3,063	2.00	3,160	6.50	0.0005
0039-0252	5-A-303	10/3/2007	5	30.17	19.1	1.03	0	2.00	3,170	6.52	0.0000
0039-0255	1-A-307	10/24/2007	1	30.33	20.0	1.03	10,132	2.00	3,166	6.53	0.0016
0039-0258	2-A-307	10/24/2007	2	30.33	20.0	1.03	5,184	2.00	3,167	6.53	0.0008
0039-0261	1-A-308	10/26/2007	1	30.14	22.5	1.02	3,770	2.00	3,116	6.33	0.0006
0039-0264	2-A-308	10/26/2007	2	30.14	22.5	1.02	2,827	2.00	3,148	6.40	0.0004
0039-0267	1-A-309	11/7/2007	1	30.19	15.0	1.04	8,953	2.00	3,036	6.34	0.0014
0039-0270	2-A-309	11/7/2007	2	30.19	15.0	1.04	0	2.00	3,041	6.35	0.0000
0039-0273	1-A-310	11/9/2007	1	30.15	17.5	1.03	0	2.00	3,013	6.23	0.0000
0039-0276	2-A-310	11/9/2007	2	30.15	17.5	1.03	0	2.00	2,998	6.20	0.0000
0039-0279	1-A-311	11/14/2007	1	30.26	17.2	1.04	4,948	2.00	3,159	6.56	0.0008
0039-0282	2-A-311	11/14/2007	2	30.26	17.2	1.04	4,006	2.00	3,165	6.57	0.0006

Sample ID	Sample Field ID	Sample Date	Sampler Location	Ambient Pressure in (Hg)	Ambient Temperature (C)	Cubic Feet	Asbestos (fibers)	Ave Flow Rate (l/min)	Minutes Operated (min)	Volume (m3)	Conc Asbestos (fibers/cc)
0039-0285	1-A-312	11/15/2007	1	30.19	19.2	1.03	6,833	2.00	1,546	3.18	0.0021
0039-0288	2-A-312	11/15/2007	2	30.19	19.2	1.03	0	2.00	1,544	3.18	0.0000
0039-0291	1-A-313	11/21/2007	1	30.25	14.4	1.05	7,069	2.00	3,125	6.55	0.0011
0039-0294	5-A-313	11/21/2007	5	30.25	14.4	1.05	2,827	2.00	3,108	6.52	0.0004
0039-0297	1-A-314	11/28/2007	1	30.37	14.4	1.05	5,184	2.00	3,195	6.73	0.0008
0039-0300	5-A-314	11/28/2007	5	30.37	14.4	1.05	7,069	2.00	3,180	6.69	0.0011
0039-0303	1-A-315	11/30/2007	1	30.17	17.5	1.03	8,011	2.00	2,979	6.16	0.0013
0039-0306	2-A-315	11/30/2007	2	30.17	17.5	1.03	0	2.00	3,019	6.25	0.0000
0039-0309	5-A-315	11/30/2007	5	30.17	17.5	1.03	0	2.00	3,000	6.21	0.0000
0039-0315	1-A-317	12/14/2007	1	30.40	15.0	1.05	6,362	2.00	2,907	6.11	0.0010
0039-0318	2-A-317	12/14/2007	2	30.40	15.0	1.05	5,184	2.00	2,912	6.12	0.0008
0039-0321	1-A-318	1/16/2008	1	30.33	12.5	1.06	0	2.00	3,195	6.76	0.0000
0039-0324	2-A-318	1/16/2008	2	30.33	12.5	1.06	0	2.00	3,200	6.77	0.0000
0039-0327	1-A-319	1/17/2008	1	30.24	15.8	1.04	4,477	2.00	1,465	3.06	0.0015
0039-0330	2-A-319	1/17/2008	2	30.24	15.8	1.04	4,948	2.00	1,450	3.02	0.0016
0039-0333	1-A-320	2/7/2008	1	30.32	13.6	1.05	4,948	2.00	3,180	6.70	0.0007
0039-0336	1-A-321	2/8/2008	1	30.40	14.7	1.05	0	2.00	1,555	3.27	0.0000
0039-0339	2-A-321	2/8/2008	2	30.40	14.7	1.05	0	2.00	1,556	3.28	0.0000
0039-0342	1-A-322	2/13/2008	1	30.36	12.7	1.06	5,890	2.00	3,205	6.78	0.0009
0039-0345	2-A-322	2/13/2008	2	30.36	12.7	1.06	0	2.00	3,155	6.68	0.0000
0039-0348	3-A-322	2/13/2008	3	30.36	12.7	1.06	0	2.00	3,135	6.64	0.0000
0039-0351	5-A-322	2/13/2008	5	30.36	12.7	1.06	0	2.00	3,145	6.66	0.0000
0039-0354	1-A-323	2/15/2008	1	30.14	18.6	1.03	4,006	2.00	2,879	5.93	0.0007
0039-0357	2-A-323	2/15/2008	2	30.14	18.6	1.03	0	2.00	2,875	5.92	0.0000
0039-0360	3-A-323	2/15/2008	3	30.14	18.6	1.03	0	1.50	2,900	4.48	0.0000
0039-0363	5-A-323	2/15/2008	5	30.14	18.6	1.03	0	2.10	2,886	6.24	0.0000
0039-0366	1-A-324	2/20/2008	1	30.24	11.9	1.06	0	2.00	3,020	6.39	0.0000
0039-0369	3-A-324	2/20/2008	3	30.24	11.9	1.06	0	1.50	3,060	4.85	0.0000
0039-0372	5-A-324	2/20/2008	5	30.24	11.9	1.06	0	2.00	3,063	6.48	0.0000
0039-0375	1-A-325	2/29/2008	1	30.30	13.6	1.05	5,890	2.00	3,180	6.70	0.0009
0039-0378	1-A-326	3/5/2008	1	30.34	18.6	1.04	4,948	2.00	3,117	6.46	0.0008
0039-0381	2-A-326	3/5/2008	2	30.34	18.6	1.04	0	2.00	3,135	6.50	0.0000
0039-0384	5-A-326	3/5/2008	5	30.34	18.6	1.04	0	2.00	3,140	6.51	0.0000
0039-0387	1-A-327	3/7/2008	1	30.22	23.3	1.02	7,069	2.00	2,942	5.98	0.0012
0039-0390	2-A-327	3/7/2008	2	30.22	23.3	1.02	0	2.00	2,920	5.93	0.0000
0039-0393	3-A-327	3/7/2008	3	30.22	23.3	1.02	2,827	2.00	2,910	5.91	0.0005
0039-0396	5-A-327	3/7/2008	5	30.22	23.3	1.02	0	2.00	2,882	5.86	0.0000
0039-0399	3-A-328	3/12/2008	3	30.37	15.8	1.05	0	2.00	3,035	6.36	0.0000
0039-0402	5-A-328	3/12/2008	5	30.37	15.8	1.05	0	2.00	3,032	6.35	0.0000
0039-0405	1-A-329	3/20/2008	1	30.43	16.3	1.05	5,184	2.00	3,110	6.52	0.0008
0039-0408	2-A-329	3/20/2008	2	30.43	16.3	1.05	0	2.00	3,110	6.52	0.0000
0039-0411	3-A-329	3/20/2008	3	30.43	16.3	1.05	0	2.00	3,125	6.55	0.0000
0039-0414	5-A-329	3/20/2008	5	30.43	16.3	1.05	3,063	2.00	3,120	6.54	0.0005
0039-0417	1-A-330	3/21/2008	1	30.44	15.6	1.05	3,299	2.00	1,515	3.18	0.0010
0039-0423	1-A-331	3/26/2008	1	30.37	13.3	1.06	5,890	2.00	3,175	6.71	0.0009
0039-0429	3-A-331	3/26/2008	3	30.37	13.3	1.06	0	2.00	3,205	6.77	0.0000
0039-0432	5-A-331	3/26/2008	5	30.37	13.3	1.06	0	2.00	3,200	6.76	0.0000

Sample ID	Sample Field ID	Sample Date	Sampler Location	Ambient Pressure in (Hg)	Ambient Temperature (C)	Cubic Feet	Asbestos (fibers)	Ave Flow Rate (l/min)	Minutes Operated (min)	Volume (m3)	Conc Asbestos (fibers/cc)
0039-0435	1-A-332	3/28/2008	1	30.29	18.0	1.04	9,896	2.00	2,895	6.00	0.0016
0039-0441	3-A-332	3/28/2008	3	30.29	18.0	1.04	0	2.00	2,805	5.82	0.0000
0039-0444	5-A-332	3/28/2008	5	30.29	18.0	1.04	3,063	2.00	2,835	5.88	0.0005
0039-0447	1-A-333	4/2/2008	1	30.26	11.9	1.06	7,540	2.00	3,165	6.70	0.0011
0039-0453	1-A-335	4/26/2008	1	30.10	18.0	1.03	5,890	2.00	2,927	6.03	0.0010
0039-0459	2-A-336	4/30/2008	2	29.97	11.9	1.05	0	2.00	2,992	6.27	0.0000
0039-0462	1-A-337	5/2/2008	1	30.17	12.5	1.05	4,006	2.00	3,086	6.50	0.0006
0039-0465	2-A-337	5/2/2008	2	30.17	12.5	1.05	4,006	2.00	3,083	6.49	0.0006
0039-0468	1-A-338	5/3/2008	1	29.94	13.0	1.04	0	2.00	1,380	2.88	0.0000
0039-0471	2-A-338	5/3/2008	2	29.94	13.0	1.04	0	2.00	1,370	2.86	0.0000
0039-0474	1-A-339	5/7/2008	1	29.86	14.1	1.04	5,655	2.00	3,158	6.54	0.0009
0039-0477	2-A-339	5/7/2008	2	29.86	14.1	1.04	0	2.00	3,154	6.53	0.0000
0039-0483	1-A-340	5/9/2008	1	29.92	15.3	1.03	3,063	2.00	2,920	6.04	0.0005
0039-0486	2-A-340	5/9/2008	2	29.92	15.3	1.03	0	2.00	2,913	6.02	0.0000
0039-0489	5-A-340	5/9/2008	5	29.92	15.3	1.03	0	2.00	2,913	6.02	0.0000
0039-0492	1-A-341	5/10/2008	1	29.89	14.7	1.03	4,006	2.00	1,440	2.98	0.0013
0039-0495	2-A-341	5/10/2008	2	29.89	14.7	1.03	0	2.00	1,435	2.97	0.0000
0039-0501	2-A-342	5/14/2008	2	29.88	20.3	1.01	6,126	2.00	3,305	6.71	0.0009
0039-0504	5-A-342	5/14/2008	5	29.88	20.3	1.01	3,063	2.00	3,295	6.69	0.0005
0039-0507	1-A-343	5/16/2008	1	29.89	29.7	0.98	18,378	2.00	2,870	5.65	0.0033
0039-0510	2-A-343	5/16/2008	2	29.89	29.7	0.98	0	2.00	2,875	5.66	0.0000
0039-0516	1-A-344	5/17/2008	1	29.93	24.6	1.00	5,184	2.00	1,396	2.80	0.0019
0039-0519	2-A-344	5/17/2008	2	29.93	24.6	1.00	0	2.00	1,395	2.79	0.0000
0039-0522	1-A-345	5/21/2008	1	29.88	14.3	1.04	14,373	2.00	3,142	6.51	0.0022
0039-0525	2-A-345	5/21/2008	2	29.88	14.3	1.04	0	2.00	3,160	6.55	0.0000
0039-0528	5-A-345	5/21/2008	5	29.88	14.3	1.04	0	2.00	3,145	6.52	0.0000
0039-0531	1-A-346	5/23/2008	1	29.68	16.6	1.02	8,953	2.00	2,993	6.11	0.0015
0039-0534	2-A-346	5/23/2008	2	29.68	16.6	1.02	0	2.00	2,982	6.09	0.0000
0039-0537	5-A-346	5/23/2008	5	29.68	16.6	1.02	3,063	2.00	2,997	6.12	0.0005
0039-0540	1-A-347	5/29/2008	1	29.95	13.8	1.04	7,775	2.00	3,173	6.60	0.0012
0039-0546	5-A-347	5/29/2008	5	29.95	13.8	1.04	5,184	2.00	3,171	6.60	0.0008
0039-0549	1-A-348	5/31/2008	1	30.02	14.1	1.04	2,827	2.00	2,868	5.97	0.0005
0039-0552	2-A-348	5/31/2008	2	30.02	14.1	1.04	0	2.00	2,865	5.97	0.0000
0039-0555	5-A-348	5/31/2008	5	30.02	14.1	1.04	3,770	2.00	2,870	5.98	0.0006
0039-0558	1-A-349	6/4/2008	1	29.89	14.4	1.04	7,540	2.00	3,121	6.47	0.0012
0039-0561	2-A-349	6/4/2008	2	29.89	14.4	1.04	0	2.00	3,115	6.45	0.0000
0039-0564	5-A-349	6/4/2008	5	29.89	14.4	1.04	3,299	2.00	3,116	6.46	0.0005
0039-0567	1-A-350	6/6/2008	1	29.83	17.9	1.02	4,241	2.00	2,933	5.99	0.0007
0039-0570	2-A-350	6/6/2008	2	29.83	17.9	1.02	0	2.00	2,954	6.03	0.0000
0039-0573	1-A-351	6/7/2008	1	29.85	18.6	1.02	2,827	2.00	1,479	3.02	0.0009
0039-0576	2-A-351	6/7/2008	2	29.85	18.6	1.02	3,770	2.00	1,466	2.99	0.0013
0039-0579	1-A-352	6/11/2008	1	29.84	19.1	1.02	4,477	2.00	3,039	6.18	0.0007
0039-0582	2-A-352	6/11/2008	2	29.84	19.1	1.02	0	2.00	3,040	6.19	0.0000
0039-0585	1-A-353	6/13/2008	1	29.85	18.8	1.02	10,132	2.00	3,190	6.50	0.0016
0039-0588	2-A-353	6/13/2008	2	29.85	18.8	1.02	0	2.00	3,170	6.46	0.0000
0039-0591	1-A-354	6/16/2008	1	29.90	10.2	1.05	2,827	2.00	2,880	6.06	0.0005
0039-0594	2-A-354	6/16/2008	2	29.90	10.2	1.05	0	2.00	2,879	6.05	0.0000

Sample ID	Sample Field ID	Sample Date	Sampler Location	Ambient Pressure in (Hg)	Ambient Temperature (C)	Cubic Feet	Asbestos (fibers)	Ave Flow Rate (l/min)	Minutes Operated (min)	Volume (m3)	Conc Asbestos (fibers/cc)
0039-0597	1-A-355	6/18/2008	1	29.94	16.1	1.03	5,655	2.00	3,189	6.58	0.0009
0039-0600	2-A-355	6/18/2008	2	29.94	16.1	1.03	3,063	2.00	3,186	6.57	0.0005
0039-0603	1-A-356	6/20/2008	1	29.89	28.4	0.99	8,718	2.00	3,068	6.06	0.0014
0039-0606	2-A-356	6/20/2008	2	29.89	28.4	0.99	4,006	2.00	3,040	6.01	0.0007
0039-0612	5-A-356	6/20/2008	5	29.89	28.4	0.99	4,241	2.00	3,050	6.03	0.0007
0039-0615	1-A-357	6/23/2008	1	29.92	20.0	1.02	6,597	2.00	3,070	6.24	0.0011
0039-0618	2-A-357	6/23/2008	2	29.92	20.0	1.02	4,241	2.00	3,090	6.29	0.0007
0039-0624	5-A-357	6/23/2008	5	29.92	20.0	1.02	0	2.00	3,085	6.28	0.0000
0039-0627	1-A-358	6/25/2008	1	29.90	20.0	1.02	5,890	2.00	3,040	6.18	0.0010
0039-0630	2-A-358	6/25/2008	2	29.90	20.0	1.02	3,534	2.00	3,037	6.17	0.0006
0039-0636	5-A-358	6/25/2008	5	29.90	20.0	1.02	4,006	2.00	3,070	6.24	0.0006
0039-0639	1-A-359	6/27/2008	1	29.77	15.0	1.03	6,362	2.00	2,750	5.66	0.0011
0039-0648	5-A-359	6/27/2008	5	29.77	15.0	1.03	0	2.00	2,715	5.59	0.0000
0039-0651	1-A-360	6/28/2008	1	29.77	15.0	1.03	4,712	2.00	1,742	3.59	0.0013
0039-0654	2-A--360	6/28/2008	2	29.77	15.0	1.03	0	2.00	1,713	3.53	0.0000
0039-0660	5-A-360	6/28/2008	5	29.77	15.0	1.03	0	2.00	1,690	3.48	0.0000
0039-0663	1-A-362	7/9/2008	1	29.31	24.5	0.98	7,540	2.00	3,202	6.28	0.0012
0039-0666	2-A-362	7/9/2008	2	29.31	24.5	0.98	0	1.75	3,178	5.46	0.0000
0039-0669	1-A-363	7/11/2008	1	29.79	21.8	1.01	12,723	2.00	2,995	6.03	0.0021
0039-0672	2-A-363	7/11/2008	2	29.79	21.8	1.01	0	2.00	3,000	6.04	0.0000
0039-0675	1-A-364	7/12/2008	1	29.91	20.0	1.02	3,534	2.00	1,435	2.92	0.0012
0039-0681	1-A-365	7/16/2008	1	29.98	16.8	1.03	7,540	2.00	3,189	6.57	0.0011
0039-0684	2-A-365	7/16/2008	2	29.98	16.8	1.03	0	1.88	3,184	6.17	0.0000
0039-0687	1-A-366	7/18/2008	1	29.98	16.8	1.03	9,896	2.00	2,785	5.74	0.0017
0039-0690	2-A-366	7/18/2008	2	29.98	16.8	1.03	0	1.88	2,790	5.40	0.0000
0039-0693	1-A-367	7/19/2008	1	29.92	20.0	1.02	4,241	2.00	1,605	3.26	0.0013
0039-0696	2-A-367	7/19/2008	2	29.92	20.0	1.02	0	1.75	1,605	2.86	0.0000
0039-0699	1-A-368	7/23/2008	1	29.80	18.3	1.02	7,775	2.00	3,060	6.24	0.0012
0039-0702	2-A-368	7/23/2008	2	29.80	18.3	1.02	0	1.75	3,055	5.45	0.0000
0039-0705	1-A-369	7/25/2008	1	29.80	18.3	1.02	9,660	2.00	2,900	5.91	0.0016
0039-0708	2-A-369	7/25/2008	2	29.80	18.3	1.02	3,299	1.88	2,905	5.56	0.0006
0039-0711	1-A-370	7/30/2008	1	29.89	16.7	1.03	14,608	2.00	3,195	6.57	0.0022
0039-0714	2-A-370	7/30/2008	2	29.89	16.7	1.03	0	1.88	3,195	6.17	0.0000
0039-0717	1-A-371	8/1/2008	1	29.88	17.2	1.03	8,953	2.00	2,990	6.13	0.0015
0039-0720	2-A-371	8/1/2008	2	29.88	17.2	1.03	0	1.88	2,995	5.77	0.0000
0039-0723	1-A-372	8/2/2008	1	29.86	17.7	1.02	4,948	2.00	1,445	2.96	0.0017
0039-0726	2-A-372	8/2/2008	2	29.86	17.7	1.02	0	1.93	1,415	2.79	0.0000
0039-0729	1-A-373	8/6/2008	1	29.92	15.0	1.03	9,425	2.00	3,315	6.86	0.0014
0039-0732	2-A-373	8/6/2008	2	29.92	15.0	1.03	0	1.90	500	0.98	0.0000
0039-0735	1-A-374	8/8/2008	1	29.92	15.8	1.03	0	2.00	2,890	5.96	0.0000
0039-0738	2-A-374	8/8/2008	2	29.92	15.8	1.03	0	1.90	2,870	5.63	0.0000
0039-0741	1-A-375	8/9/2008	1	29.92	16.7	1.03	0	2.00	1,425	2.93	0.0000
0039-0744	2-A-375	8/9/2008	2	29.92	16.7	1.03	0	2.00	1,425	2.93	0.0000
0039-0747	1-A-376	8/13/2008	1	29.92	20.0	1.02	7,540	2.00	2,920	5.94	0.0013
0039-0750	2-A-376	8/13/2008	2	29.92	20.0	1.02	0	2.00	2,908	5.92	0.0000
0039-0753	1-A-377	8/15/2008	1	29.92	17.2	1.03	4,241	2.00	1,350	2.77	0.0015
0039-0756	2-A-377	8/15/2008	2	29.92	17.2	1.03	3,063	1.90	3,145	6.14	0.0005

Sample ID	Sample Field ID	Sample Date	Sampler Location	Ambient Pressure in (Hg)	Ambient Temperature (C)	Cubic Feet	Asbestos (fibers)	Ave Flow Rate (l/min)	Minutes Operated (min)	Volume (m3)	Conc Asbestos (fibers/cc)
0039-0759	1-A-378	8/20/2008	1	29.92	18.7	1.02	4,712	2.00	3,150	6.44	0.0007
0039-0762	2-A-378	8/20/2008	2	29.92	18.7	1.02	0	2.00	3,155	6.45	0.0000
0039-0765	1-A-379	8/22/2008	1	29.92	17.8	1.02	6,362	2.00	3,115	6.38	0.0010
0039-0768	2-A-379	8/22/2008	2	29.92	17.8	1.02	0	2.00	3,115	6.38	0.0000
0039-0771	1-A-380	8/23/2008	1	29.92	18.3	1.02	3,534	2.00	1,405	2.87	0.0012
0039-0774	2-A-380	8/23/2008	2	29.92	18.3	1.02	0	2.00	1,410	2.88	0.0000
0039-0777	2-A-381	8/27/2008	2	29.92	20.1	1.02	0	2.00	3,080	6.26	0.0000
0039-0780	1-A-383	9/5/2008	1	29.74	22.9	1.00	11,310	2.00	3,170	6.35	0.0018
0039-0783	1-A-384	9/6/2008	1	29.72	28.6	0.98	5,890	2.00	1,500	2.94	0.0020
0039-0786	1-A-385	9/10/2008	1	29.72	15.8	1.02	8,953	2.00	3,094	6.34	0.0014
0039-0789	2-A-385	9/10/2008	2	29.72	15.8	1.02	0	2.00	3,110	6.38	0.0000
0039-0792	1-A-386	9/12/2008	1	29.78	14.4	1.03	7,069	2.00	3,039	6.27	0.0011
0039-0795	2-A-386	9/12/2008	2	29.78	14.4	1.03	0	2.00	3,036	6.27	0.0000
0039-0798	1-A-387	9/13/2008	1	29.72	15.7	1.03	0	2.00	1,445	2.96	0.0000
0039-0801	2-A-387	9/13/2008	2	29.72	15.7	1.03	0	2.00	1,435	2.94	0.0000
0039-0804	1-A-388	9/17/2008	1	29.94	14.6	1.04	8,482	2.00	3,236	6.71	0.0013
0039-0807	2-A-388	9/17/2008	2	29.94	14.6	1.04	0	1.88	3,233	6.30	0.0000
0039-0810	1-A-389	9/19/2008	1	29.93	17.8	1.03	5,419	2.00	2,895	5.94	0.0009
0039-0813	2-A-389	9/19/2008	2	29.93	17.8	1.03	2,827	2.00	2,915	5.98	0.0005
0039-0816	1-A-390	9/20/2008	1	29.93	18.7	1.02	2,827	2.00	1,425	2.91	0.0010
0039-0819	2-A-390	9/20/2008	2	29.93	18.7	1.02	0	2.00	1,420	2.90	0.0000
0039-0822	1-A-391	9/24/2008	1	29.90	17.8	1.02	6,597	2.00	3,120	6.39	0.0010
0039-0825	2-A-391	9/24/2008	2	29.90	17.8	1.02	0	2.00	3,125	6.40	0.0000
0039-0828	1-A-392	9/26/2008	1	29.85	20.6	1.01	11,074	2.00	3,033	6.14	0.0018
0039-0831	2-A-392	9/26/2008	2	29.85	20.6	1.01	3,063	2.00	3,001	6.08	0.0005
0039-0834	1-A-393	10/1/2008	1	29.87	17.6	1.02	10,838	2.00	3,161	6.47	0.0017
0039-0837	2-A-393	10/1/2008	2	29.87	17.6	1.02	0	2.00	3,160	6.47	0.0000
0039-0840	1-A-394	10/3/2008	1	29.79	20.9	1.01	14,844	2.00	2,965	5.99	0.0025
0039-0843	2-A-394	10/3/2008	2	29.79	20.9	1.01	0	2.00	2,975	6.01	0.0000
0039-0846	1-A-395	10/8/2008	1	29.83	15.8	1.03	4,006	2.00	3,195	6.57	0.0006
0039-0849	2-A-395	10/8/2008	2	29.83	15.8	1.03	2,827	2.00	3,200	6.58	0.0004
0039-0852	1-A-396	10/10/2008	1	29.79	16.4	1.03	8,247	2.00	2,980	6.11	0.0013
0039-0855	2-A-396	10/10/2008	2	29.79	16.4	1.03	5,419	2.00	2,950	6.05	0.0009
0039-0858	1-A-397	10/15/2008	1	30.03	20.6	1.02	9,896	2.00	3,260	6.64	0.0015
0039-0861	2-A-397	10/15/2008	2	30.03	20.6	1.02	4,948	2.00	3,255	6.63	0.0007
0039-0864	1-A-398	10/17/2008	1	29.90	25.2	1.00	8,953	2.00	2,920	5.83	0.0015
0039-0867	2-A-398	10/17/2008	2	29.90	25.2	1.00	7,304	2.00	2,920	5.83	0.0013
0039-0870	1-A-399	10/22/2008	1	30.02	18.0	1.03	16,729	2.00	3,265	6.71	0.0025
0039-0873	2-A-399	10/22/2008	2	30.02	18.0	1.03	0	2.00	3,270	6.72	0.0000
0039-0879	2-A-400	10/24/2008	2	29.97	25.0	1.00	4,006	2.00	2,935	5.88	0.0007
0039-0882	1-A-401	10/29/2008	1	30.10	10.2	1.06	0	2.00	3,230	6.84	0.0000
0039-0885	2-A-401	10/29/2008	2	30.10	10.2	1.06	2,827	2.00	3,245	6.87	0.0004
0039-0888	1-A-402	10/31/2008	1	30.03	18.9	1.02	8,953	2.00	2,910	5.96	0.0015
0039-0891	2-A-402	10/31/2008	2	30.03	18.9	1.02	0	2.00	2,905	5.95	0.0000
0039-0894	1-A-404	11/12/2008	1	30.07	14.1	1.04	6,126	2.00	3,250	6.78	0.0009
0039-0897	2-A-404	11/12/2008	2	30.07	14.1	1.04	0	2.00	3,240	6.76	0.0000
0039-0900	1-A-405	11/14/2008	1	30.04	20.9	1.02	3,534	2.00	2,915	5.93	0.0006



Sample ID	Sample Field ID	Sample Date	Sampler Location	Ambient Pressure in (Hg)	Ambient Temperature (C)	Cubic Feet	Asbestos (fibers)	Ave Flow Rate (l/min)	Minutes Operated (min)	Volume (m3)	Conc Asbestos (fibers/cc)
0039-0903	2-A-405	11/14/2008	2	30.04	20.9	1.02	0	2.00	2,918	5.94	0.0000
0039-0906	1-A-406	11/19/2008	1	30.06	14.9	1.04	6,362	2.00	3,024	6.29	0.0010
0039-0909	2-A-406	11/19/2008	2	30.06	14.9	1.04	3,063	2.00	3,031	6.30	0.0005
0039-0912	1-A-407	11/21/2008	1	30.05	12.1	1.05	0	2.00	3,005	6.31	0.0000
0039-0915	2-A-407	11/21/2008	2	30.05	12.1	1.05	0	2.00	3,000	6.30	0.0000
0039-0918	1-A-408	11/24/2008	1	29.90	16.6	1.03	3,770	2.00	2,988	6.15	0.0006
0039-0921	2-A-408	11/24/2008	2	29.90	16.6	1.03	0	2.00	2,988	6.15	0.0000
0039-0924	1-A-409	11/26/2008	1	29.90	16.6	1.03	0	2.00	2,895	5.95	0.0000
0039-0927	2-A-409	11/26/2008	2	29.90	16.6	1.03	0	2.00	2,885	5.93	0.0000
0039-0930	1-A-410	12/3/2008	1	30.05	10.8	1.05	3,534	2.00	3,185	6.72	0.0005
0039-0933	2-A-410	12/3/2008	2	30.05	10.8	1.05	2,827	2.00	3,185	6.72	0.0004
0039-0939	2-A-411	12/5/2008	2	30.06	13.5	1.04	0	2.00	3,043	6.36	0.0000
0039-0945	2-A-412	12/8/2008	2	30.08	9.7	1.06	3,770	2.00	2,857	6.06	0.0006
0039-0951	2-A-413	12/10/2008	2	30.22	13.8	1.05	4,948	2.00	3,270	6.86	0.0007
0039-0957	2-A-414	12/12/2008	2	30.22	13.8	1.05	0	2.00	2,911	6.11	0.0000
0039-0960	1-A-416	1/8/2009	1	30.14	9.3	1.06	5,655	2.75	3,165	9.26	0.0006
0039-0963	2-A-416	1/8/2009	2	30.14	9.3	1.06	0	2.00	3,160	6.72	0.0000
0039-0966	1-A-417	1/10/2009	1	30.09	10.9	1.06	0	2.00	3,010	6.35	0.0000
0039-0969	2-A-417	1/10/2009	2	30.09	10.9	1.06	2,827	2.00	3,000	6.33	0.0004
0039-0972	1-A-418	1/14/2009	1	30.19	18.3	1.03	5,184	2.00	3,170	6.54	0.0008
0039-0975	2-A-418	1/14/2009	2	30.19	18.3	1.03	3,299	2.00	3,180	6.56	0.0005
0039-0978	1-A-419	1/16/2009	1	30.08	18.4	1.03	7,540	2.00	2,990	6.15	0.0012
0039-0981	2-A-419	1/16/2009	2	30.08	18.4	1.03	3,299	2.00	2,990	6.15	0.0005
0039-0984	1-A-420	1/17/2009	1	30.08	16.6	1.03	3,299	2.00	1,385	2.87	0.0012
0039-0987	2-A-420	1/17/2009	2	30.08	16.6	1.03	2,827	2.00	1,390	2.88	0.0010
0039-0990	1-A-421	1/21/2009	1	30.08	11.9	1.05		2.05	3,216	6.93	
0039-0993	2-A-421	1/21/2009	2	30.08	11.9	1.05	10,132	2.00	3,214	6.76	0.0015
0039-0996	1-A-422	1/28/2009	1	30.14	9.8	1.06	7,069	2.00	3,190	6.77	0.0010
0039-0999	2-A-422	1/28/2009	2	30.14	9.8	1.06	4,006	2.00	3,185	6.76	0.0006
0039-1002	1-A-423	1/30/2009	1	30.20	13.7	1.05	4,948	2.00	2,920	6.13	0.0008
0039-1005	2-A-423	1/30/2009	2	30.20	13.7	1.05	0	2.00	2,925	6.14	0.0000
0039-1008	1-A-424	2/4/2009	1	30.01	10.7	1.05		3.00	3,180	10.05	
0039-1011	2-A-424	2/4/2009	2	30.01	10.7	1.05	0	2.00	3,185	6.71	0.0000
0039-1014	1-A-425	2/6/2009	1	29.80	11.7	1.04	0	2.00	2,725	5.68	0.0000
0039-1017	2-A-425	2/6/2009	2	29.80	11.7	1.04	0	2.00	2,720	5.67	0.0000
0039-1020	1-A-426	2/12/2009	1	30.09	7.8	1.07	0	2.00	3,280	7.00	0.0000
0039-1023	2-A-426	2/12/2009	2	30.09	7.8	1.07	0	2.00	3,275	6.99	0.0000
0039-1026	1-A-427	3/11/2009	1	30.05	14.4	1.04	10,367	2.38	3,270	8.10	0.0013
0039-1032	1-A-428	3/13/2009	1	30.01	11.8	1.05	2,827	2.00	2,995	6.29	0.0004
0039-1038	1-A-429	3/16/2009	1	29.96	9.2	1.06	0	2.00	3,135	6.63	0.0000
0039-1041	2-A-429	3/16/2009	2	29.96	9.2	1.06	0	2.00	3,130	6.62	0.0000
0039-1044	1-A-430	3/18/2009	1	30.16	13.3	1.05	0	2.00	2,950	6.19	0.0000
0039-1047	2-A-430	3/18/2009	2	30.16	13.3	1.05	0	2.00	2,960	6.21	0.0000
0039-1050	6-A-430	3/18/2009	6	30.16	13.3	1.05	0	2.00	2,975	6.24	0.0000
0039-1053	2-A-431	3/20/2009	2	29.98	12.1	1.05	0	2.00	2,910	6.10	0.0000
0039-1056	6-A-431	3/20/2009	6	29.98	12.1	1.05	0	2.00	2,905	6.08	0.0000
0039-1059	1-A-432	3/25/2009	1	30.16	12.5	1.05	0	2.05	3,086	6.66	0.0000

Sample ID	Sample Field ID	Sample Date	Sampler Location	Ambient Pressure in (Hg)	Ambient Temperature (C)	Cubic Feet	Asbestos (fibers)	Ave Flow Rate (l/min)	Minutes Operated (min)	Volume (m3)	Conc Asbestos (fibers/cc)
0039-1062	2-A-432	3/25/2009	2	30.16	12.5	1.05	4,241	2.05	3,150	6.79	0.0006
0039-1065	6-A-432	3/25/2009	6	30.16	12.5	1.05	0	1.95	3,151	6.46	0.0000
0039-1068	2-A-433	3/27/2009	2	29.96	17.1	1.03	0	2.30	2,936	6.95	0.0000
0039-1071	6-A-433	3/27/2009	6	29.96	17.1	1.03	5,184	2.05	2,889	6.09	0.0009
0039-1074	1-A-434	4/1/2009	1	29.94	13.9	1.04	0	2.00	3,202	6.66	0.0000
0039-1077	2-A-434	4/1/2009	2	29.94	13.9	1.04	0	2.00	3,198	6.65	0.0000
0039-1080	6-A-434	4/1/2009	6	29.94	13.9	1.04	4,006	2.15	3,188	7.12	0.0006
0039-1083	1-A-435	4/3/2009	1	29.89	13.7	1.04	3,534	2.00	2,992	6.21	0.0006
0039-1086	2-A-435	4/3/2009	2	29.89	13.7	1.04	0	2.00	2,985	6.20	0.0000
0039-1089	6-A-435	4/3/2009	6	29.89	13.7	1.04	4,948	2.00	2,987	6.20	0.0008
0039-1092	1-A-436	4/8/2009	1	29.97	14.1	1.04	0	2.00	3,200	6.65	0.0000
0039-1095	2-A-436	4/8/2009	2	29.97	14.1	1.04	0	2.00	3,200	6.65	0.0000
0039-1098	6-A-436	4/8/2009	6	29.97	14.1	1.04	0	2.00	3,191	6.64	0.0000
0039-1101	2-A-437	4/10/2009	2	29.90	12.6	1.04	0	2.00	2,975	6.20	0.0000
0039-1104	6-A-437	4/10/2009	6	29.90	12.6	1.04	0	2.00	2,975	6.20	0.0000
0039-1107	1-A-438	4/15/2009	1	29.89	11.9	1.04	0	2.00	3,293	6.88	0.0000
0039-1110	2-A-438	4/15/2009	2	29.89	11.9	1.04	0	2.00	3,295	6.89	0.0000
0039-1113	6-A-438	4/15/2009	6	29.89	11.9	1.04	0	2.00	3,285	6.87	0.0000
0039-1116	1-A-439	4/17/2009	1	30.05	15.7	1.04	0	1.95	2,885	5.83	0.0000
0039-1119	2-A-439	4/17/2009	2	30.05	15.7	1.04	0	1.95	2,911	5.88	0.0000
0039-1122	6-A-439	4/17/2009	6	30.05	15.7	1.04	0	2.00	2,910	6.03	0.0000
0039-1125	1-A-440	4/22/2009	1	29.89	20.2	1.02	0	1.95	3,106	6.15	0.0000
0039-1128	2-A-440	4/22/2009	2	29.89	20.2	1.02	0	2.00	3,165	6.43	0.0000
0039-1131	6-A-440	4/22/2009	6	29.89	20.2	1.02	0	2.00	3,157	6.41	0.0000
0039-1134	1-A-441	4/24/2009	1	29.88	15.5	1.03	0	2.10	2,994	6.49	0.0000
0039-1137	2-A-441	4/24/2009	2	29.88	15.5	1.03	0	2.00	2,990	6.17	0.0000
0039-1140	6-A-441	4/24/2009	6	29.88	15.5	1.03	0	2.00	2,976	6.14	0.0000
0039-1143	1-A-442	4/29/2009	1	29.98	10.9	1.05	2,827	2.00	3,210	6.75	0.0004
0039-1146	2-A-442	4/29/2009	2	29.98	10.9	1.05	0	2.05	3,230	6.96	0.0000
0039-1149	6-A-442	4/29/2009	6	29.98	10.9	1.05	0	2.00	3,220	6.77	0.0000
0039-1152	1-A-443	5/1/2009	1	29.98	12.8	1.04	0	2.00	2,940	6.14	0.0000
0039-1155	2-A-443	5/1/2009	2	29.98	12.8	1.04	0	2.00	2,934	6.13	0.0000
0039-1158	6-A-443	5/1/2009	6	29.98	12.8	1.04	0	2.00	2,959	6.18	0.0000
0039-1161	1-A-444	5/6/2009	1	30.01	17.8	1.03	0	2.00	3,137	6.45	0.0000
0039-1164	2-A-444	5/6/2009	2	30.01	17.8	1.03	0	2.05	3,146	6.63	0.0000
0039-1167	6-A-444	5/6/2009	6	30.01	17.8	1.03	0	2.00	3,174	6.52	0.0000
0039-1170	1-A-445	5/8/2009	1	29.96	18.2	1.02	0	1.95	3,034	6.06	0.0000
0039-1173	2-A-445	5/8/2009	2	29.96	18.2	1.02	0	1.95	3,013	6.02	0.0000
0039-1176	6-A-445	5/8/2009	6	29.96	18.2	1.02	2,827	2.00	2,994	6.14	0.0005
0039-1179	1-A-446	5/13/2009	1	29.94	15.7	1.03	3,770	2.00	3,185	6.58	0.0006
0039-1182	2-A-446	5/13/2009	2	29.94	15.7	1.03	5,419	2.00	3,202	6.61	0.0008
0039-1185	6-A-446	5/13/2009	6	29.94	15.7	1.03	4,006	2.00	3,222	6.66	0.0006
0039-1188	1-A-447	5/15/2009	1	29.90	16.4	1.03	0	2.00	2,957	6.09	0.0000
0039-1191	2-A-447	5/15/2009	2	29.90	16.4	1.03	0	2.00	2,954	6.08	0.0000
0039-1194	6-A-447	5/15/2009	6	29.90	16.4	1.03	0	2.00	2,944	6.06	0.0000
0039-1197	1-A-448	5/20/2009	1	29.83	12.3	1.04	2,827	1.90	3,208	6.35	0.0004
0039-1200	2-A-448	5/20/2009	2	29.83	12.3	1.04	0	2.00	3,210	6.69	0.0000

Sample ID	Sample Field ID	Sample Date	Sampler Location	Ambient Pressure in (Hg)	Ambient Temperature (C)	Cubic Feet	Asbestos (fibers)	Ave Flow Rate (l/min)	Minutes Operated (min)	Volume (m3)	Conc Asbestos (fibers/cc)
0039-1203	6-A-448	5/20/2009	6	29.83	12.3	1.04	0	2.00	3,216	6.70	0.0000
0039-1206	1-A-449	5/22/2009	1	29.85	14.3	1.03	0	1.90	3,005	5.91	0.0000
0039-1209	2-A-449	5/22/2009	2	29.85	14.3	1.03	0	2.00	3,000	6.21	0.0000
0039-1212	6-A-449	5/22/2009	6	29.85	14.3	1.03	0	2.00	2,990	6.19	0.0000
0039-1215	1-A-450	5/28/2009	1	29.81	13.4	1.04	0	2.00	3,228	6.69	0.0000
0039-1218	2-A-450	5/28/2009	2	29.81	13.4	1.04	0	2.00	3,229	6.69	0.0000
0039-1221	6-A-450	5/28/2009	6	29.81	13.4	1.04	0	2.00	3,219	6.67	0.0000
0039-1224	1-A-451	5/29/2009	1	29.86	16.0	1.03	0	2.00	1,564	3.22	0.0000
0039-1227	2-A-451	5/29/2009	2	29.86	16.0	1.03	0	2.00	1,561	3.21	0.0000
0039-1230	6-A-451	5/29/2009	6	29.86	16.0	1.03	0	2.00	1,559	3.21	0.0000
0039-1233	1-A-452	6/3/2009	1	29.82	14.2	1.03	0	2.00	3,208	6.63	0.0000
0039-1239	6-A-452	6/3/2009	6	29.82	14.2	1.03	0	1.90	3,221	6.33	0.0000
0039-1242	1-A-453	6/5/2009	1	29.84	17.6	1.02	0	1.95	2,989	5.96	0.0000
0039-1245	2-A-453	6/5/2009	2	29.84	17.6	1.02	0	2.00	2,985	6.11	0.0000
0039-1248	6-A-453	6/5/2009	6	29.84	17.6	1.02	0	2.00	2,976	6.09	0.0000
0039-1251	1-A-454	6/10/2009	1	29.84	14.9	1.03	0	2.00	3,218	6.64	0.0000
0039-1254	2-A-454	6/10/2009	2	29.84	14.9	1.03	0	2.00	3,224	6.66	0.0000
0039-1257	6-A-454	6/10/2009	6	29.84	14.9	1.03	0	2.00	3,225	6.66	0.0000
0039-1260	1-A-455	6/12/2009	1	29.86	16.9	1.03	0	2.00	3,000	6.16	0.0000
0039-1263	2-A-455	6/12/2009	2	29.86	16.9	1.03	0	2.00	2,990	6.13	0.0000
0039-1266	6-A-455	6/12/2009	6	29.86	16.9	1.03	0	2.00	2,985	6.12	0.0000
0039-1269	1-A-456	6/17/2009	1	29.85	15.1	1.03	0	2.00	3,123	6.45	0.0000
0039-1272	2-A-456	6/17/2009	2	29.85	15.1	1.03	0	2.00	3,125	6.45	0.0000
0039-1275	6-A-456	6/17/2009	6	29.85	15.1	1.03	0	2.00	3,165	6.53	0.0000
0039-1278	1-A-457	6/19/2009	1	29.75	16.8	1.02	0	1.95	3,064	6.11	0.0000
0039-1281	2-A-457	6/19/2009	2	29.75	16.8	1.02	0	2.00	3,063	6.26	0.0000
0039-1284	6-A-457	6/19/2009	6	29.75	16.8	1.02	0	2.00	3,016	6.17	0.0000
0039-1287	1-A-458	6/24/2009	1	29.77	16.2	1.03	0	2.00	3,218	6.60	0.0000
0039-1290	2-A-458	6/24/2009	2	29.77	16.2	1.03	0	2.00	3,220	6.60	0.0000
0039-1293	6-A-458	6/24/2009	6	29.77	16.2	1.03	0	2.00	3,197	6.56	0.0000
0039-1296	1-A-459	6/26/2009	1	29.80	19.1	1.02	0	2.00	2,992	6.08	0.0000
0039-1299	2-A-459	6/26/2009	2	29.80	19.1	1.02	0	2.00	2,990	6.08	0.0000
0039-1302	6-A-459	6/26/2009	6	29.80	19.1	1.02	0	2.00	2,983	6.06	0.0000
0039-1305	1-A-460	7/1/2009	1	29.74	15.7	1.03	0	2.00	3,178	6.52	0.0000
0039-1308	2-A-460	7/1/2009	2	29.74	15.7	1.03	0	2.00	3,183	6.53	0.0000
0039-1311	6-A-460	7/1/2009	6	29.74	15.7	1.03	0	2.00	2,995	6.15	0.0000
0039-1314	1-A-461	7/2/2009	1	29.78	18.3	1.02	0	2.00	1,558	3.17	0.0000
0039-1317	2-A-461	7/2/2009	2	29.78	18.3	1.02	0	2.00	1,550	3.16	0.0000
0039-1320	1-A-462	7/8/2009	1	29.90	16.2	1.03	0	2.00	3,185	6.56	0.0000
0039-1323	2-A-462	7/8/2009	2	29.90	16.2	1.03	0	2.00	3,174	6.54	0.0000
0039-1326	1-A-463	7/10/2009	1	29.89	17.8	1.02	0	2.00	2,991	6.12	0.0000
0039-1329	2-A-463	7/10/2009	2	29.89	17.8	1.02	0	2.00	2,990	6.12	0.0000
0039-1332	1-A-464	7/15/2009	1	29.90	15.9	1.03	0	2.00	3,145	6.48	0.0000
0039-1335	2-A-464	7/15/2009	2	29.90	15.9	1.03	0	2.00	3,152	6.50	0.0000
0039-1338	6-A-464	7/15/2009	6	29.90	15.9	1.03	0	2.00	3,152	6.50	0.0000
0039-1341	1-A-465	7/17/2009	1	29.88	18.6	1.02	0	2.00	3,029	6.18	0.0000
0039-1344	2-A-465	7/17/2009	2	29.88	18.6	1.02	0	2.00	3,021	6.17	0.0000

Sample ID	Sample Field ID	Sample Date	Sampler Location	Ambient Pressure in (Hg)	Ambient Temperature (C)	Cubic Feet	Asbestos (fibers)	Ave Flow Rate (l/min)	Minutes Operated (min)	Volume (m3)	Conc Asbestos (fibers/cc)
0039-1347	6-A-465	7/17/2009	6	29.88	18.6	1.02	0	1.95	3,015	6.00	0.0000
0039-1350	1-A-466	7/22/2009	1	29.87	12.9	1.04	0	2.00	3,221	6.70	0.0000
0039-1353	2-A-466	7/22/2009	2	29.87	12.9	1.04	0	2.00	3,223	6.71	0.0000
0039-1356	6-A-466	7/22/2009	6	29.87	12.9	1.04	5,655	2.00	3,221	6.70	0.0008
0039-1359	1-A-467	7/24/2009	1	29.88	13.6	1.04	4,477	2.05	2,746	5.85	0.0008
0039-1362	2-A-467	7/24/2009	2	29.88	13.6	1.04	0	2.05	2,740	5.83	0.0000
0039-1365	6-A-468	7/24/2009	6	29.88	13.6	1.04	0	2.00	2,735	5.68	0.0000
0039-1368	1-A-468	7/29/2009	1	29.84	14.4	1.03	0	2.00	3,192	6.60	0.0000
0039-1371	2-A-468	7/29/2009	2	29.84	14.4	1.03	0	2.00	3,200	6.62	0.0000
0039-1374	6-A-468	7/29/2009	6	29.84	14.4	1.03	2,827	1.95	3,199	6.45	0.0004
0039-1377	1-A-469	7/31/2009	1	29.83	17.0	1.02	0	2.00	2,991	6.13	0.0000
0039-1380	2-A-469	7/31/2009	2	29.83	17.0	1.02	0	2.00	2,984	6.11	0.0000
0039-1383	6-A-469	7/31/2009	6	29.83	17.0	1.02	4,241	2.00	2,977	6.10	0.0007
0039-1386	1-A-470	8/5/2009	1	29.93	16.2	1.03	3,770	2.00	3,194	6.58	0.0006
0039-1389	2-A-470	8/5/2009	2	29.93	16.2	1.03	0	2.00	3,197	6.59	0.0000
0039-1392	6-A-470	8/5/2009	6	29.93	16.2	1.03	0	1.95	3,195	6.42	0.0000
0039-1395	1-A-471	8/7/2009	1	29.95	18.7	1.02	0	2.05	2,950	6.18	0.0000
0039-1398	2-A-471	8/7/2009	2	29.95	18.7	1.02	0	2.00	2,949	6.03	0.0000
0039-1401	1-A-472	8/12/2009	1	29.86	19.1	1.02	0	2.00	3,180	6.48	0.0000
0039-1404	2-A-472	8/12/2009	2	29.86	19.1	1.02	0	2.00	3,181	6.48	0.0000
0039-1407	6-A-472	8/12/2009	6	29.86	19.1	1.02	0	1.80	3,173	5.82	0.0000
0039-1410	1-A-473	8/14/2009	1	29.89	20.7	1.01	0	2.00	3,002	6.09	0.0000
0039-1413	2-A-473	8/14/2009	2	29.89	20.7	1.01	0	1.95	3,001	5.93	0.0000
0039-1416	6-A-473	8/14/2009	6	29.89	20.7	1.01	9,425	1.88	3,002	5.71	0.0017
0039-1419	1-A-474	8/19/2009	1	29.80	14.9	1.03	3,770	2.00	3,218	6.63	0.0006
0039-1422	2-A-474	8/19/2009	2	29.80	14.9	1.03	0	2.00	3,215	6.63	0.0000
0039-1425	6-A-474	8/19/2009	6	29.80	14.9	1.03	4,477	1.80	3,218	5.97	0.0007
0039-1428	1-A-475	8/21/2009	1	29.77	20.3	1.01	0	2.00	3,000	6.07	0.0000
0039-1431	2-A-475	8/21/2009	2	29.77	20.3	1.01	0	2.00	3,005	6.08	0.0000
0039-1434	6-A-475	8/21/2009	6	29.77	20.3	1.01	3,299	2.00	2,995	6.06	0.0005
0039-1437	1-A-476	8/26/2009	1	29.89	14.7	1.03	2,827	2.00	3,205	6.63	0.0004
0039-1440	2-A-476	8/26/2009	2	29.89	14.7	1.03	0	2.00	3,184	6.59	0.0000
0039-1443	6-A-476	8/26/2009	6	29.89	14.7	1.03	0	1.90	3,161	6.21	0.0000
0039-1446	1-A-477	8/28/2009	1	29.90	24.6	1.00	4,006	2.00	3,012	6.03	0.0007
0039-1449	2-A-477	8/28/2009	2	29.90	24.6	1.00	3,299	2.00	3,026	6.06	0.0005
0039-1455	1-A-478	9/2/2009	1	29.81	19.0	1.02	5,655	2.00	3,202	6.51	0.0009
0039-1458	2-A-478	9/2/2009	2	29.81	19.0	1.02	4,006	2.00	3,201	6.51	0.0006
0039-1461	6-A-478	9/2/2009	6	29.81	19.0	1.02	4,006	1.90	3,204	6.19	0.0006
0039-1464	1-A-479	9/3/2009	1	29.84	25.3	1.00	5,419	2.00	1,541	3.07	0.0018
0039-1467	2-A-479	9/3/2009	2	29.84	25.3	1.00	3,063	2.00	1,540	3.07	0.0010
0039-1470	6-A-479	9/3/2009	6	29.84	25.3	1.00	7,775	2.00	1,534	3.06	0.0025
0039-1473	1-A-480	9/10/2009	1	29.83	16.6	1.03	4,948	2.00	3,198	6.56	0.0008
0039-1476	2-A-480	9/10/2009	2	29.83	16.6	1.03	0	2.00	3,211	6.59	0.0000
0039-1479	6-A-480	9/10/2009	6	29.83	16.6	1.03	0	2.00	3,201	6.57	0.0000
0039-1482	1-A-481	9/11/2009	1	29.84	22.2	1.01	6,126	2.00	1,558	3.14	0.0020
0039-1485	2-A-481	9/11/2009	2	29.84	22.2	1.01	3,063	2.00	1,551	3.12	0.0010
0039-1488	6-A-481	9/11/2009	6	29.84	22.2	1.01	3,770	1.95	1,537	3.02	0.0012

Sample ID	Sample Field ID	Sample Date	Sampler Location	Ambient Pressure in (Hg)	Ambient Temperature (C)	Cubic Feet	Asbestos (fibers)	Ave Flow Rate (l/min)	Minutes Operated (min)	Volume (m3)	Conc Asbestos (fibers/cc)
0039-1491	1-A-482	9/16/2009	1	29.91	17.1	1.03	0	2.00	3,201	6.57	0.0000
0039-1494	2-A-482	9/16/2009	2	29.91	17.1	1.03	0	2.00	3,204	6.58	0.0000
0039-1497	6-A-482	9/16/2009	6	29.91	17.1	1.03	4,712	2.00	3,211	6.59	0.0007
0039-1500	1-A-483	9/18/2009	1	29.83	23.9	1.00	3,299	2.00	2,933	5.87	0.0006
0039-1503	2-A-483	9/18/2009	2	29.83	23.9	1.00	0	2.00	2,933	5.87	0.0000
0039-1506	6-A-483	9/18/2009	6	29.83	23.9	1.00	3,534	1.90	2,929	5.57	0.0006
0039-1509	1-A-484	9/23/2009	1	29.94	14.4	1.04	3,770	2.00	3,194	6.63	0.0006
0039-1512	2-A-484	9/23/2009	2	29.94	14.4	1.04	0	2.00	3,200	6.64	0.0000
0039-1515	6-A-484	9/23/2009	6	29.94	14.4	1.04	0	1.85	3,200	6.14	0.0000
0039-1518	1-A-485	9/25/2009	1	29.85	19.9	1.02	3,299	2.00	3,005	6.10	0.0005
0039-1521	2-A-485	9/25/2009	2	29.85	19.9	1.02	0	2.10	2,999	6.39	0.0000
0039-1524	6-A-485	9/25/2009	6	29.85	19.9	1.02	0	2.00	2,991	6.07	0.0000
0039-1527	1-A-486	9/30/2009	1	29.90	15.3	1.03	4,006	2.00	3,210	6.63	0.0006
0039-1530	2-A-486	9/30/2009	2	29.90	15.3	1.03	11,310	2.10	3,234	7.02	0.0016
0039-1533	6-A-486	9/30/2009	6	29.90	15.3	1.03	12,017	1.90	3,257	6.39	0.0019
0039-1536	1-A-487	10/2/2009	1	29.93	19.8	1.02	4,241	2.00	3,003	6.11	0.0007
0039-1539	2-A-487	10/2/2009	2	29.93	19.8	1.02	3,534	1.90	2,998	5.80	0.0006
0039-1542	6-A-487	10/2/2009	6	29.93	19.8	1.02	5,890	2.00	2,992	6.09	0.0010
0039-1545	1-A-488	10/7/2009	1	29.83	14.7	1.03	10,838	2.00	3,167	6.54	0.0017
0039-1548	2-A-488	10/7/2009	2	29.83	14.7	1.03	15,315	2.00	3,163	6.53	0.0023
0039-1551	6-A-488	10/7/2009	6	29.83	14.7	1.03	12,017	1.88	3,167	6.13	0.0020
0039-1554	1-A-489	10/9/2009	1	29.85	17.5	1.02	4,241	2.00	3,025	6.19	0.0007
0039-1557	2-A-489	10/9/2009	2	29.85	17.5	1.02	3,299	2.00	3,024	6.19	0.0005
0039-1563	1-A-490	10/16/2009	1	29.94	20.5	1.02	0	2.00	1,884	3.83	0.0000
0039-1566	2-A-490	10/16/2009	2	29.94	20.5	1.02	0	2.00	1,884	3.83	0.0000
0039-1569	6-A-490	10/16/2009	6	29.94	20.5	1.02	3,063	2.00	1,880	3.82	0.0008
0039-1572	1-A-491	10/21/2009	1	29.87	16.1	1.03	0	2.00	3,352	6.90	0.0000
0039-1575	2-A-491	10/21/2009	2	29.87	16.1	1.03	0	2.00	3,349	6.89	0.0000
0039-1578	6-A-491	10/21/2009	6	29.87	16.1	1.03	0	1.90	3,349	6.55	0.0000
0039-1581	1-A-492	10/23/2009	1	29.90	19.5	1.02	3,299	1.95	2,880	5.72	0.0006
0039-1584	2-A-492	10/23/2009	2	29.90	19.5	1.02	0	2.00	2,876	5.86	0.0000
0039-1587	6-A-492	10/23/2009	6	29.90	19.5	1.02	0	2.00	2,872	5.85	0.0000
0039-1590	1-A-493	10/28/2009	1	29.95	14.9	1.04	5,184	2.00	3,191	6.61	0.0008
0039-1593	2-A-493	10/28/2009	2	29.95	14.9	1.04	5,890	2.00	3,195	6.62	0.0009
0039-1596	6-A-493	10/28/2009	6	29.95	14.9	1.04	4,948	1.90	3,195	6.29	0.0008
0039-1599	1-A-494	10/30/2009	1	30.00	17.4	1.03	3,063	1.95	2,975	5.97	0.0005
0039-1602	2-A-494	10/30/2009	2	30.00	17.4	1.03	0	2.00	2,971	6.11	0.0000
0039-1605	6-A-494	10/30/2009	6	30.00	17.4	1.03	4,477	2.00	2,963	6.10	0.0007
0039-1608	1-A-495	11/4/2009	1	29.92	15.4	1.03	0	2.00	3,217	6.65	0.0000
0039-1611	2-A-495	11/4/2009	2	29.92	15.4	1.03	4,712	2.00	3,215	6.64	0.0007
0039-1614	6-A-495	11/4/2009	6	29.92	15.4	1.03	4,712	1.88	3,217	6.23	0.0008
0039-1617	1-A-496	11/6/2009	1	29.91	15.9	1.03	6,833	2.00	2,961	6.11	0.0011
0039-1620	2-A-496	11/6/2009	2	29.91	15.9	1.03	0	2.00	2,960	6.10	0.0000
0039-1623	6-A-496	11/6/2009	6	29.91	15.9	1.03	4,241	1.95	2,954	5.94	0.0007
0039-1626	1-A-497	11/11/2009	1	29.92	12.7	1.04	4,712	2.10	3,202	7.01	0.0007
0039-1629	2-A-497	11/11/2009	2	29.92	12.7	1.04	3,299	2.00	3,203	6.68	0.0005
0039-1632	6-A-497	11/11/2009	6	29.92	12.7	1.04	3,063	1.90	3,204	6.35	0.0005

Sample ID	Sample Field ID	Sample Date	Sampler Location	Ambient Pressure in (Hg)	Ambient Temperature (C)	Cubic Feet	Asbestos (fibers)	Ave Flow Rate (l/min)	Minutes Operated (min)	Volume (m3)	Conc Asbestos (fibers/cc)
0039-1635	1-A-498	11/13/2009	1	29.86	14.4	1.03	0	1.95	3,012	6.08	0.0000
0039-1638	2-A-498	11/13/2009	2	29.86	14.4	1.03	0	2.00	3,017	6.24	0.0000
0039-1641	6-A-498	11/13/2009	6	29.86	14.4	1.03	4,712	2.00	3,013	6.24	0.0008
0039-1644	1-A-499	11/18/2009	1	30.08	10.7	1.06	7,540	2.10	3,209	7.12	0.0011
0039-1647	2-A-499	11/18/2009	2	30.08	10.7	1.06	3,770	2.00	3,215	6.79	0.0006
0039-1650	6-A-499	11/18/2009	6	30.08	10.7	1.06	8,247	1.90	3,216	6.45	0.0013
0039-1653	1-A-500	11/20/2009	1	29.92	12.2	1.04	3,063	2.00	2,776	5.80	0.0005
0039-1656	2-A-500	11/20/2009	2	29.92	12.2	1.04	2,827	2.00	2,802	5.86	0.0005
0039-1659	6-A-500	11/20/2009	6	29.92	12.2	1.04	7,304	2.00	2,801	5.85	0.0012
0039-1662	1-A-501	11/24/2009	1	30.07	12.7	1.05	3,534	2.10	1,852	4.08	0.0009
0039-1665	2-A-501	11/24/2009	2	30.07	12.7	1.05	4,477	2.00	1,866	3.91	0.0011
0039-1668	6-A-501	11/24/2009	6	30.07	12.7	1.05	4,006	2.00	1,863	3.91	0.0010
0039-1671	1-A-502	12/2/2009	1	29.95	9.7	1.06	4,712	2.10	3,204	7.10	0.0007
0039-1674	2-A-502	12/2/2009	2	29.95	9.7	1.06	2,827	2.00	3,199	6.75	0.0004
0039-1677	6-A-502	12/2/2009	6	29.95	9.7	1.06	3,770	1.90	3,195	6.41	0.0006
0039-1680	1-A-503	12/4/2009	1	29.95	9.9	1.05	2,827	1.95	2,993	6.15	0.0005
0039-1683	2-A-503	12/4/2009	2	29.95	9.9	1.05	3,299	2.00	2,982	6.29	0.0005
0039-1686	6-A-503	12/4/2009	6	29.95	9.9	1.05	3,299	2.00	2,980	6.28	0.0005
0039-1689	1-A-504	12/9/2009	1	29.80	5.7	1.06	4,477	2.10	3,228	7.22	0.0006
0039-1692	2-A-504	12/9/2009	2	29.80	5.7	1.06	3,299	2.00	3,263	6.95	0.0005
0039-1695	6-A-504	12/9/2009	6	29.80	5.7	1.06	0	2.00	3,259	6.94	0.0000
0039-1698	1-A-505	12/11/2009	1	29.90	7.1	1.06	3,770	2.00	2,988	6.35	0.0006
0039-1701	2-A-505	12/11/2009	2	29.90	7.1	1.06	4,006	2.00	2,957	6.29	0.0006
0039-1704	6-A-505	12/11/2009	6	29.90	7.1	1.06	5,419	2.00	2,951	6.27	0.0009
0039-1707	1-A-506	12/16/2009	1	30.09	10.4	1.06	0	2.10	3,179	7.06	0.0000
0039-1710	2-A-506	12/16/2009	2	30.09	10.4	1.06	0	2.00	3,177	6.72	0.0000
0039-1713	1-A-507	12/18/2009	1	30.09	12.7	1.05	7,069	2.00	2,980	6.25	0.0011
0039-1716	2-A-507	12/18/2009	2	30.09	12.7	1.05	3,534	2.00	2,961	6.21	0.0006