

AVAILABLE SPACE

USDA FOREST SERVICE ROUGH MILL FACILITY



PRINCETON, WEST VIRGINIA

LOCATION

Building Address - 301 Hardwood Lane
Located in City Limits - No
County - Mercer
Located in Business/Industrial Park - No
Can the Building be Multi-Tenant - No

SIZE

Total Sq. Ft. - 42,674
Total Available Sq. Ft. - 42,674
Total Leased Sq. Ft. - 0
Acres - 1.5
Total Manufacturing Sq. Ft. - 37,032
Available Manufacturing Sq. Ft. - 37,032
Total Warehouse Sq. Ft. - 0
Available Warehouse Sq. Ft. - 0
Total Office Sq. Ft. - 2,442
Available Office Sq. Ft. - 2,442
Total Other Sq. Ft. - 3,200 mezzanine space
Available Other Sq. Ft. - 3,200

CEILING HEIGHT

Manufacturing Space - 19'-4"
Warehouse Space - N/A
Office Space - 8'
Other Space -

SPECIFICATIONS

Can the Building be Expanded - No
Number of Additional Sq. Ft. Building can be Expanded - 0
Is There Additional Land Available - No
Number of Additional Acres - 0
Date of Construction - 1996
Dates of Expansion - None
Date Vacated - 1999
Floor Thickness and Composition - 6" & 8" reinforced concrete
Wall Composition - Block & metal
Wall Insulation (Thickness & Type) - Fiberglass with vinyl backing
Roof Composition - Metal
Roof Insulation (Thickness & Type) - Fiberglass with vinyl backing
Column Spacing - 40' X 40'
Type of Sprinkler System (What Spaces Served) - Wet type system serves entire building
Office HVAC - Mezzanine mounted AC units
Manufacturing HVAC - Gas fired space heaters
Warehouse HVAC - N/A
Type of Lighting in Manufacturing Space - Halogen lamps
Type of Lighting in Warehouse Space - N/A
Number and Capacity of Overhead Cranes - 0
Number of Truck Docks - 2
Number and Size of Drive-Through Bay Doors - 2 (18' wide X 15' high)
Number of Parking Spaces - 40
Previous use of the Building - Rough mill



DUST COLLECTION SYSTEM

Building use is Best Suited for - Light manufacturing

TRANSPORTATION

Interstate/4 Lane Highway - .7 mile to I-77 Interchange Exit 14
Commercial Airport - miles to Raleigh County Memorial Airport
Railroad - None
Railroad Siding - None
Navigable Waterway - None
On-Site Barge Facility - None

UTILITIES

Electricity - American Electric Power
Voltage - 460
Phase - 3

Gas - Mountaineer Gas
Size of Service Line -
Gas Pressure -

Water - Town of Athens
Size of Service Line -
Static Pressure -
Residual Pressure -
Excess Capacity of Treatment Plant (GPD) -

Sewer - Oakvale Road Public Service District
Size of Service Line -
Excess Capacity of Treatment Plant (GPD) -

Telephone Supplier - Frontier Communications
Switching -
Broadband Service -

SALE/LEASE

Sale Price - N/A
Sale Terms - N/A
Lease Price - Special permit
Lease Terms - Special permit
Available Purchase or Lease Date - In Prospectus

FOR FURTHER INFORMATION CONTACT

Steve Milauskas, Director
USDA Forest Service
301 Hardwood Lane
Princeton, WV 24740
Phone: (304) 487-1510
Fax: (304) 487-6661
E-mail: smilauskas@fs.fed.us

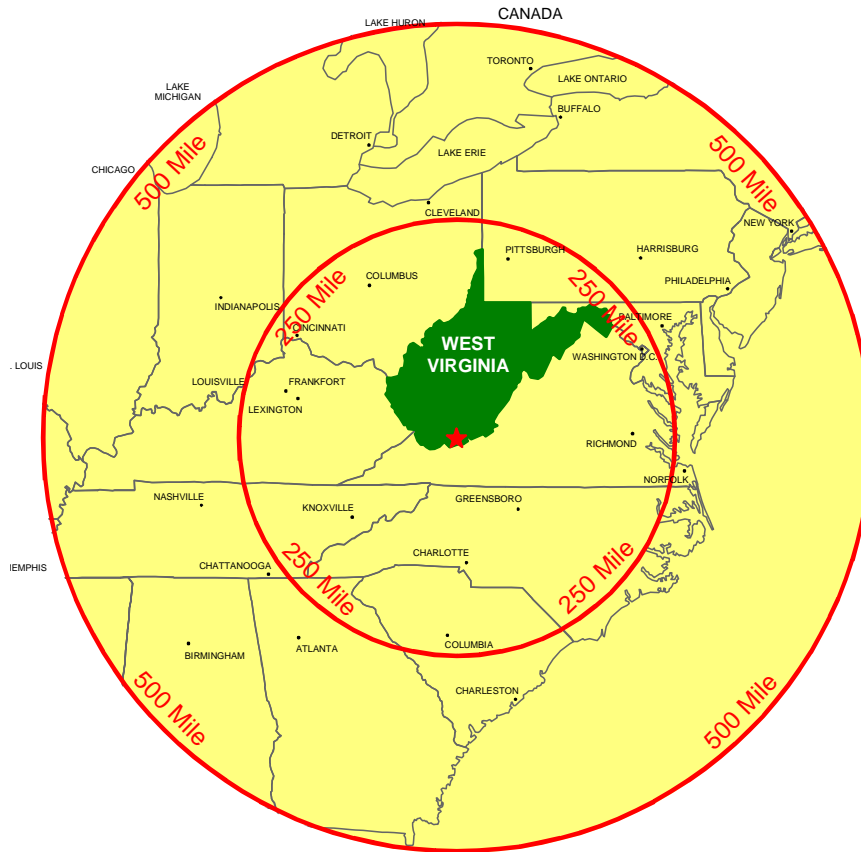

REMARKS

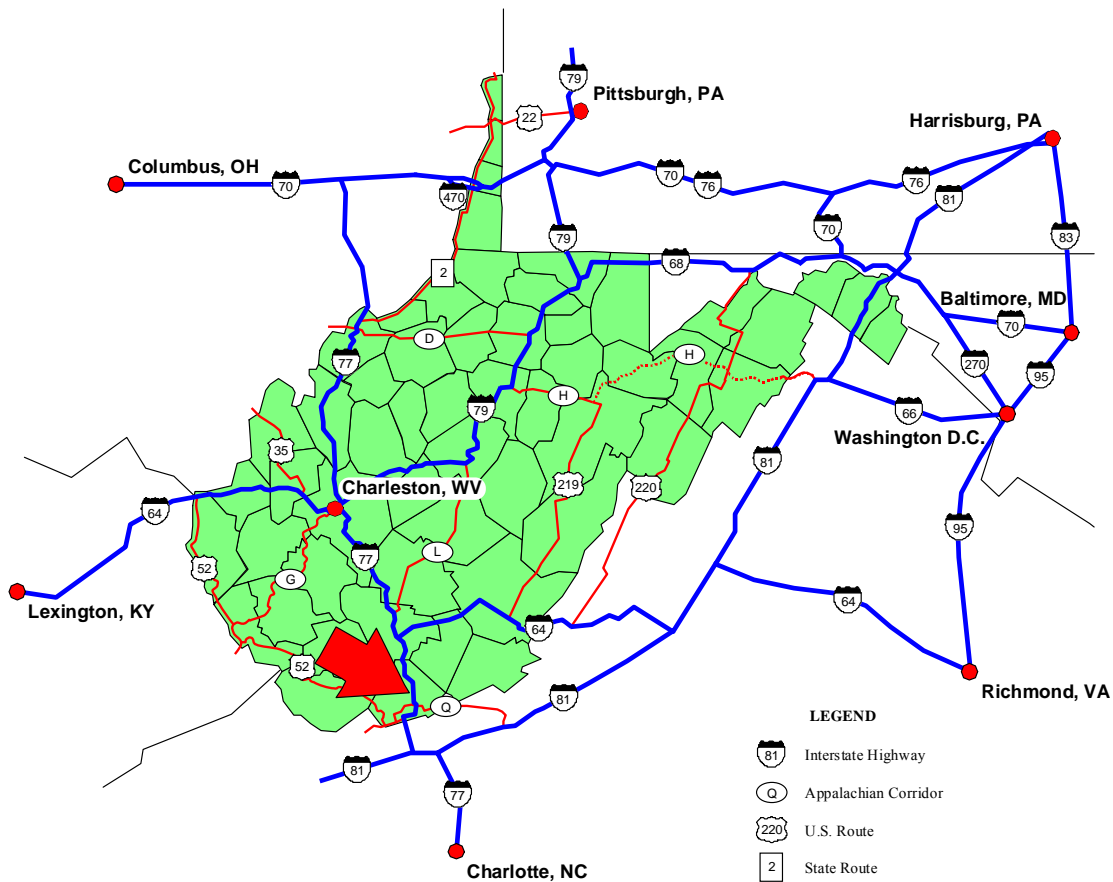

250 & 500 MILE RADIUS FROM PRINCETON, WEST VIRGINIA

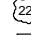
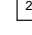

LEGEND

-  Interstate Highway
-  Appalachian Corridor
-  U.S. Route
-  State Route

PRINCETON, WEST VIRGINIA



DUST COLLECTION SYSTEM



OFFICE SPACE



CONFERENCE ROOM



BREAK ROOM



OFFICE SPACE WITH MEZZANINE



MANUFACTURING SPACE

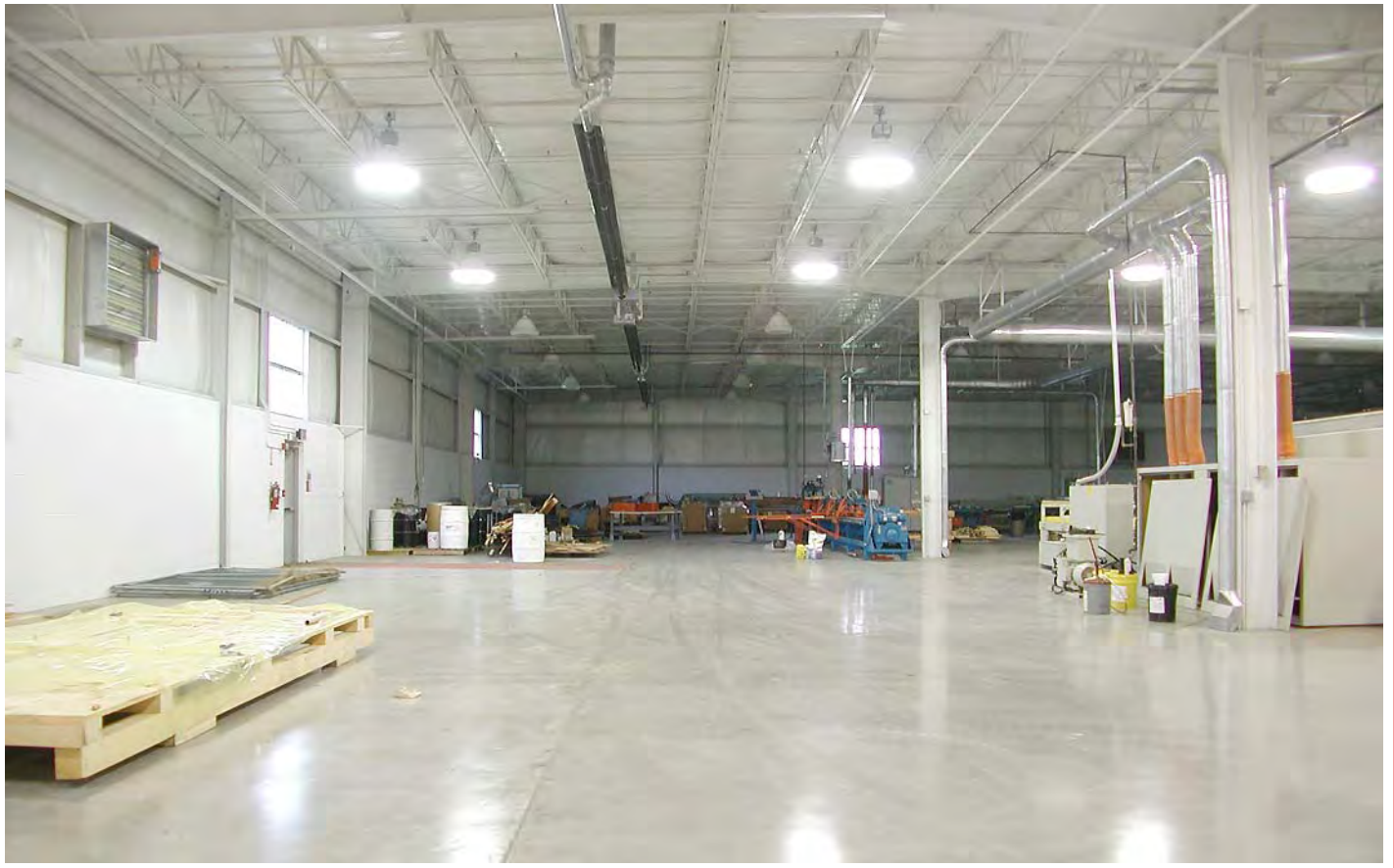

MANUFACTURING SPACE



MANUFACTURING SPACE



MANUFACTURING SPACE



MANUFACTURING SPACE

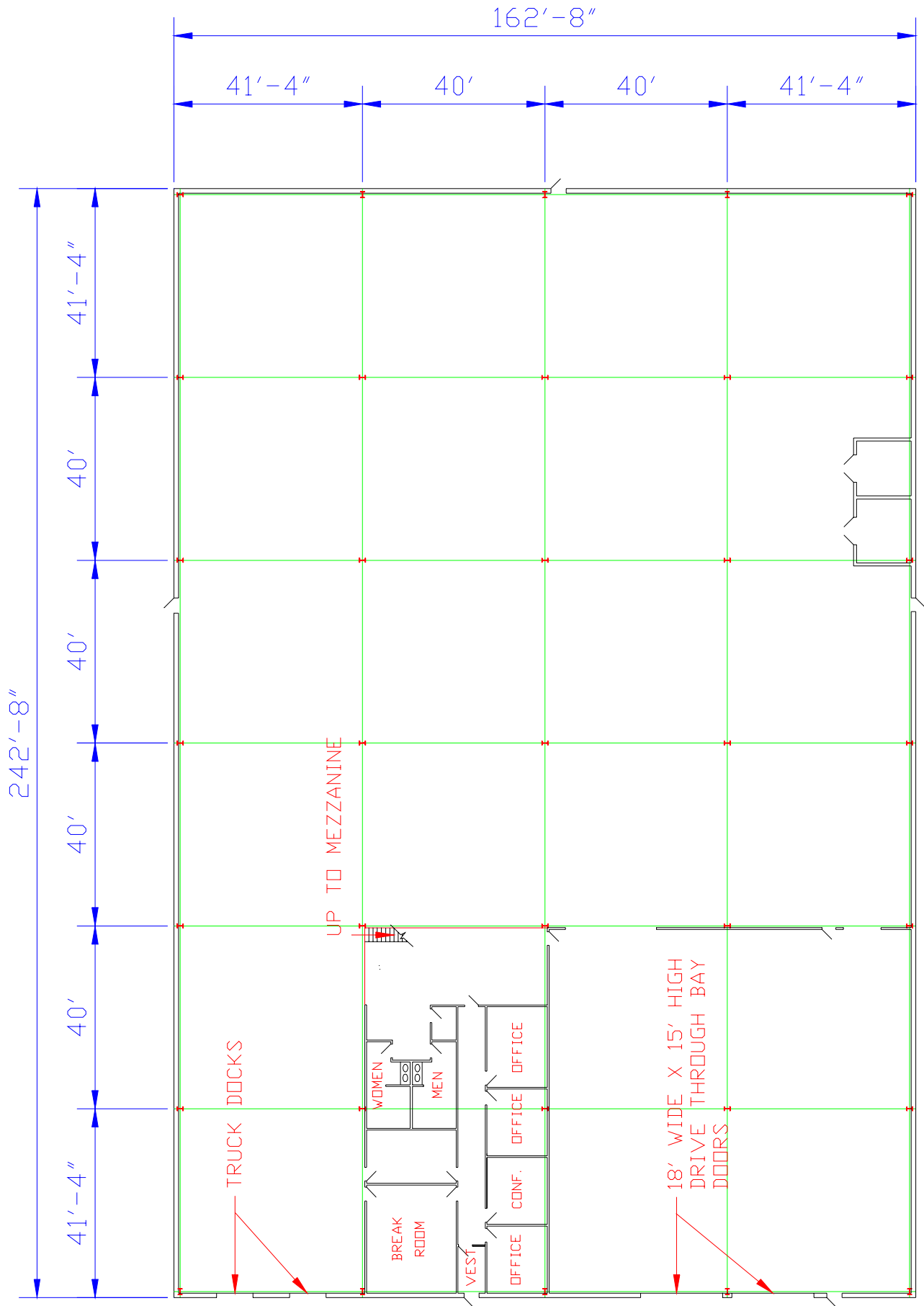

FLOOR PLAN (NOT TO SCALE)