

CORRECTED CARD

1. ACTIVITY Camp Lejeune		2. CITY Onslow		3. COUNTY N.C.		4. STATE/COUNTRY None		5. COMPONENT		
6. ACCTG. NO. 67001	7. MGMT. BUREAU (Code) USMC	8. FIN. BUREAU (Code) 9	9. STATE USMC	10. CO. 9	11. CITY 32	12. DATE PREPARED 133	13. DIST. 735	14. ACTIVITY CODE 8 Nov 60	15. CARD NO. K-05	
16. BUILT ON LAND (Type ownership) OWNED <input checked="" type="checkbox"/> OTHER <input type="checkbox"/>		17. YEAR BUILT 911 40	18. EST. LIFE 1942	19. TYPE OF CONSTRUCTION PERM. <input checked="" type="checkbox"/> SEMI. <input type="checkbox"/> TEMP. <input type="checkbox"/>			20. UTILIZATION IN USE <input checked="" type="checkbox"/> NOT IN USE <input type="checkbox"/>		21. CONDITION USABLE <input checked="" type="checkbox"/> UNUSABLE <input type="checkbox"/>	
22. DESCRIPTION Sewage Pumping Station				23. NAVY CODE 832 30	24. AREA MEASURE QUANTITY (Sym)	25. OTHER MEASURE QUANTITY (Sym)	26. CAPACITY QUANTITY (Sym) 2,100			
27. PAVED AREAS				28. DIMENSIONS			29. MATERIAL CODES (Exclude paved areas)			
30. ELEVATION (If applicable) 0.44	31. MAP GRID NO. (If applicable) 12-0 Page 23			32. STRUCTURE NO. (If applicable) S-47			33. TOTAL COST \$9,079.00			
	34. IN PROCESS OF DISPOSAL DATE			35. DATE REPORTED TO GSA			36. DATE DETERMINED SURPLUS			
37. SURVEY OR DISPOSAL DATE				38. TYPE OF ACTION <input type="checkbox"/> 1. ACQUISITION <input checked="" type="checkbox"/> 2. CORRECTION <input type="checkbox"/> 3. CANCELLATION <input type="checkbox"/> 4. DISPOSITION						

CLASS 2 PAO VDU# 18 Oct 61

COMPLETE REVERSE SIDE AS NECESSARY

MAJOR CONSTRUCTION BY

39. (a) CONTRACT NO. NOy 4750		(b) TYPE OF CONTRACT Fixed Fee	(c) YARD LABOR J. O. NO. None	(d) SPECIFICATION NO. 403	(e) YARDS AND DOCKS DRAWING NO.(S) 162115-162119 Incl. 229695
(f) CONTRACTOR (Name) Goode Const. Co., Blythe Bros., Harrison Wright, Charlotte, N.C.					

40. DESIGN	(a) COST None	(b) CONTRACT NO. None
------------	-------------------------	---------------------------------

41. ACQUISITION INFORMATION			
(a) DATE	(b) METHOD	(Code) (c) APPROPRIATION	(d) PROJECT NO.

42. DISPOSITION INFORMATION				
(a) DISPOSED OF TO:	(b) DISPOSAL NO.	(c) METHOD	(Code) (d) DATE DISPOSED OF	(e) CONSIDERATION

43. NET CHANGE ON CANCELLED CARDS					
(a) REASON FOR CANCELLATION	(b) CODE	(c) NEW CARD NO.	(e) NET CHANGE COST TO GOVERNMENT		(f) APPROPRIATION AND PROJECT NUMBER
	<input type="checkbox"/> CORR.	(d) FORM NO.	<input type="checkbox"/> INCR.	\$ _____	
	<input type="checkbox"/> CAP. IMPR.		<input type="checkbox"/> DECR.	\$ _____	

44. STRUCTURE TITLE Sewage Pumping Station	REMARKS: Add to Cost of Structure (3) Pumps Sewer, dropped from Class 3 on POA Vou# 424 Oct 61, Total Cost \$2,754.00
--	---

CORRECTED CARD

1. ACTIVITY: **SEWAGE PUMP**

2. CITY: **Onslow**

3. COUNTY: **N.C.**

4. STATE/COUNTRY: **None**

5. COMPONENT: **None**

6. ACCTG. NO.: **67001**

7. MGMT. BUREAU (Code): **USMC**

8. FIN. BUREAU (Code): **9**

9. STATE: **32**

10. CO.: **133**

11. CITY: **735**

12. DATE PREPARED: **8 Nov 60**

13. DIST.: **M-05**

14. ACTIVITY CODE: **8270-175**

15. CARD NO.: **2-00478**

16. BUILT ON LAND (Type ownership): **OWNED** **OTHER** **11 40**

17. YEAR BUILT: **1942**

18. EST. LIFE: **25**

19. TYPE OF CONSTRUCTION: PERM. SEMI. TEMP.

20. UTILIZATION: IN USE NOT IN USE

21. CONDITION: USABLE UNUSABLE

22. DESCRIPTION: **Sewage Pumping Station**

23. NAVY CODE: **832 30**

24. AREA MEASURE QUANTITY (Sym):

25. OTHER MEASURE QUANTITY (Sym):

26. CAPACITY QUANTITY (Sym): **2,100**

27. PAVED AREAS

(a) MATERIAL CODE	(b) NO.		P. S. I.	(d) WHEEL LOAD	28. DIMENSIONS			29. MATERIAL CODES (Exclude paved areas)		
	(b) NO.	(c)			(a) LENGTH	(b) WIDTH	(c) HEIGHT	(a) FOUNDATION	(b) SUPER-STRUC. OR DECK	(c) ROOF
					30	23	22	JJP	JJ	CJ

30. ELEVATION (if applicable): **0.44**

31. MAP GRID NO. (if applicable): **12-0 Page 23**

32. STRUCTURE NO. (if applicable): **S-47**

33. TOTAL COST: **\$9,079.00**

34. IN PROCESS OF DISPOSAL DATE:

35. DATE REPORTED TO GSA: **16-R PAGE 18 14**

36. DATE DETERMINED SURPLUS:

37. SURVEY OR DISPOSAL DATE:

38. TYPE OF ACTION: 1. ACQUISITION 2. CORRECTION 3. CANCELLATION 4. DISPOSITION

COMPLETE REVERSE SIDE AS NECESSARY

STRUCTURES AND MISCELLANEOUS UTILITIES - NAVCOMPT FORM 267 (5 FT) (REV. 8-57)

Bldg. No. **S-17**

MAJOR CONSTRUCTION BY

39.

(a) CONTRACT NO.
NOy 4750

(b) TYPE OF CONTRACT
Fixed Fee

(c) YARD LABOR J. O. NO.
None

(d) SPECIFICATION NO.
403

(e) YARDS AND DOCKS DRAWING NO. (S)
162115-162119 Incl. 229695

(f) CONTRACTOR (Name)

Goode Const. Co., Blythe Bros., Harrison Wright, Charlotte, N.C.

40. DESIGN

(a) COST
None

(b) CONTRACT NO.
None

41.

(a) DATE

(b) METHOD

ACQUISITION INFORMATION

(Code)

(c) APPROPRIATION

(d) PROJECT NO.

42.

(a) DISPOSED OF TO:

(b) DISPOSAL NO.

(c) METHOD

(Code)

(d) DATE DISPOSED OF

(e) CONSIDERATION

43.

(a) REASON FOR CANCELLATION

(b) CODE

CORR.

CAP. IMPR.

(c) NEW CARD NO.

(d) FORM NO.

(e) NET CHANGE COST TO GOVERNMENT

INCR. \$ _____

DECR. \$ _____

(f) APPROPRIATION AND PROJECT NUMBER

44. STRUCTURE TITLE

Sewage Pumping Station

REMARKS:

Add to Cost of Structure (3) Pump Sewer, dropped from Class 3 on POA Voul 424 Oct 61, Total Cost \$2,754.00

71-8 .04 .400

ACTIVITY NAME AND LOCATION: **Marine Barracks, Camp Lejeune, N. C.**

ACCOUNTING NO. _____ DATE OF CARD: **14 November 1948**

Reserved for Bureau Use ↑

CARD NUMBER _____
 EXPENSE GROUP _____
 TOTAL COST \$ **6,325.00**
 YEAR BUILT **1942**
 ESTIMATED LIFE _____ YRS.
 MONTHLY DEPR'N \$ _____
 YR. FULLY DEPR'D _____
 ANNUAL MAINT. \$ **50.00**

IDENTIFICATION: **47** BLDG. NO. **47** USE OF BUILDING: **Sewage Pumping Station**

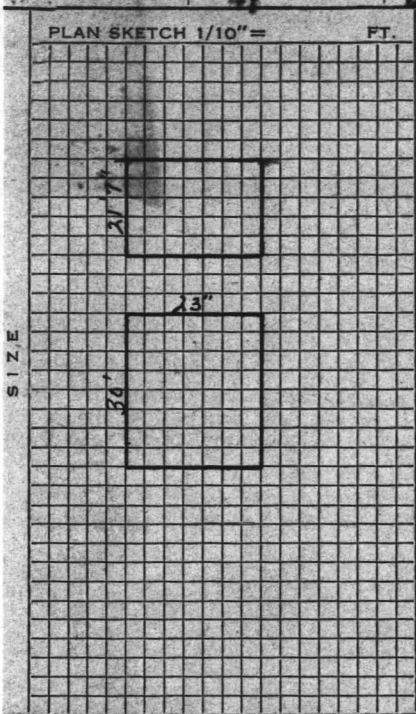

CONSTRUCTION	ITEMS		MATERIAL CODE	
	FOUNDATION			0
EXTERIOR WALLS	THICKNESS		0	
	12"		0	
ROOF			0	
FLOORS	NO.	LIVE LOAD (LB/SP)	FL. AREA (SQ. FT.)	MAT. CODE
	B			
	1	600	292	0
	2	300	310	0
	Net Wall	304	0	

CAPACITY: **2 Pumps and Motors**

LENGTH (FT.)	WIDTH (FT.)	HEIGHT TO		NO. OF STORIES
		EAVES	RIDGE	
30'	23'	21'7"	22'	1-2

TOTAL GROSS FLOOR AREA (SQ. FT.): **946**

TOTAL GROSS CUBIC VOLUME (CU. FT.): **12,650**

TEMPORARY _____
 PERMANENT
 LEASED _____ TO _____
 SURVEYED DATE _____
 CUBIC FT. COST \$ _____

Sewage Pumping Station Bldg. No. **47** **Camp Lejeune**

MISCELLANEOUS	HEATING SYSTEM		ELECTRICAL CURRENT			SPRINKLER SYS
	FUEL	TYPE	VOLTS	PHASES	CYCLES	
	None	None	208	3	60	None
	HOT WATER		*NO. OF CRANES	NO. OF ELEVATORS		OTHER
FUEL	STORAGE CAPACITY				TELEPHONE: YES <input type="checkbox"/>	
None	None	None	None	None		

MAJOR CONSTRUCTION BY	FIXED FEE NO.	LUMP SUM NO.	YARD LABOR-JOB ORDER NO.	DATE CONSTRUCTION STARTED
	None-1750			
	SPECIFICATION NO.	Y & D DRAWING NOS.	DATE CONSTRUCTION COMPLETED	
403	(162115 - 162119) (22695)	6-1-54		
CONTRACTOR AND ADDRESS (City and State) Operating as Contractor of Contracts - Seale Contracting Corp., Mythe Bros. Co., Harrison-Wright Co., Charlotte, N. C.				

METHOD OF ACQUISITION AND DATE (If acquired other than by construction.)

PURCHASED
 TRANSFERRED TO NAVY
 OTHER (Specify)

REMARKS:

202 sq ft operating room
 654 " " Pump pit and wet well

* FOR INFORMATION PURPOSES ONLY (Do not include in cost of building reported on front side hereof.)