

VALUABLE

Return To
Public Works
Office
Camp Lejeune
North Carolina

SUBJECT

Stake-out
~~Location~~ of Pump
House & Elevation
Pipe & Corner of Bldg

FIELD PARTY

T. J. Ingram In Charge
Morton Instrument
Notes
Tape Read
Ketchum Tape or Rod
Tape or Rod
Turnment No.
Tape No.

WEATHER

Clear
Cloudy
Windy
Rain
Fair

Snow
Hot
Moderate
Cold
Fog

FILE No. 140-R

Fldr. No. _____

Sheet 1-1

Date 4-23 1946

Figured By _____

Notes Checked By _____

Plotted By _____

Quad. No. 140

Station	Dist.	Angle "	+	H. I. Bearing	Ver: Ang. Diff.	Elevation
BM						35.13
	143	36.56				
①	TOP PIPE Ground				14.72	21.84
					11.2	25.4
②	TOP PIPE Ground				15.90	20.66
					12.5	24.1
Bldg cor	A				11.8	24.8
	B				11.7	24.9
	C				12.5	24.1
	D				12.3	24.3
Valve	TOP PIPE Ground				10.83	25.73
					7.4	29.2
BM					143	

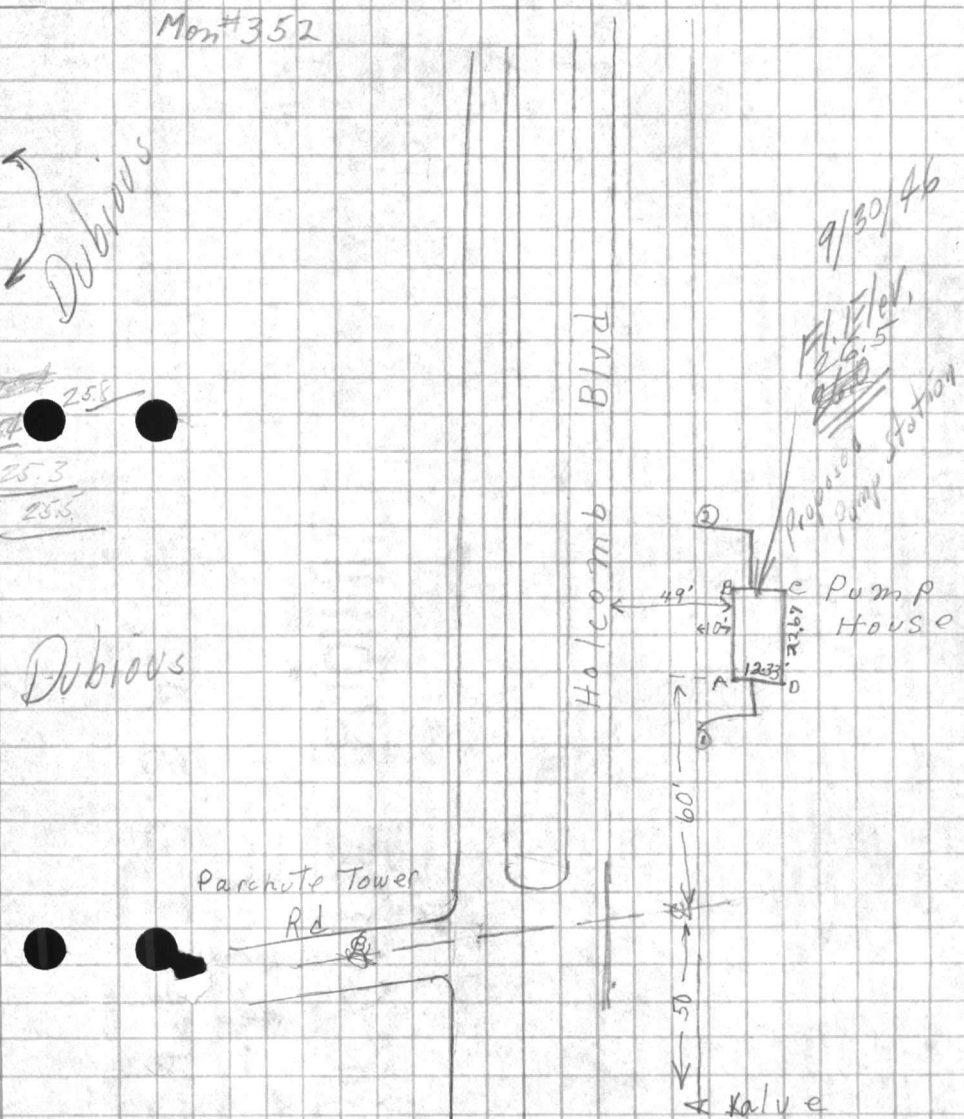

VALIABLE

Return To
Public Works
Office
Camp Lejeune
North Carolina

SUBJECT

Station Dial Angle H. V. Elevation
Sighting Dist.

WEATHER

FIELD PARTY

Clouds in Clouds
Wind Direction
Rain Intensity
Fog Density
Temp Time Read
Type of Soil
Notes Checked by
Printed by

25.7
25.4

35.13
1955
37.115
11.43
25.685

VALUABLE

Return To
Public Works
Office
Camp Lejeune
North Carolina

SUBJECT B.M. For Pump
Station - Holcomb Blvd +
Smead Ferry Rd

FIELD PARTY

____ In Charge
____ Instrument
____ Notes
____ Tape Read
____ Tape or Rod
____ Instrument No.
____ Tape No.

WEATHER

Clear
Cloudy
Windy
Rain
Fair
Snow
Hot
Moderate
Cold
Fog
Figured By _____
Notes Checked By _____
Plotted By _____

¹³
₂₇
FILE No. 140-12
Fldr. No. _____
Sheet 1-1
Date 9-30 1946

Quad. No. _____

Station	Dist.	Angle " "	+	H. I. Bearing	Ver: Ang. Diff.	Elevation	
BM						3513	Mon # 352
			5005				
TP				40135	670	33.435	
			2125	35560			
BM					985	2571	Spike in pole 25' North of NE corner of Pump Station
			950	3521			³⁵⁵⁰ <u>985</u> <u>2571</u>
TP					178	33.43	
			617	3960			
BM					446	3514	Mon 352

Return to
Public Works
Office
Camp Johnson
North Carolina

Subject

Station _____ Dir. _____ Angle _____ H.T. _____ M.T. _____
Feeling _____ V.A.R. _____ Elevation _____

FIELD PARTY
In Charge _____
Inspector _____
Notes _____
Type of Rod _____
Type of Rod _____
Treatment No. _____
Tape No. _____

WEATHER
Clear _____
Snow _____
Cloudy _____
Hot _____
Moderate _____
Cold _____
Rain _____
Fog _____
Thunder _____
Checked By _____
Date _____

FILE No. _____
Title No. _____
Sheet _____
Date _____

REPRODUCED FROM



VALUABLE

Return To
Public Works
Office
Camp Lejeune
North Carolina

Pump Station
SUBJECT WELL HOUSE PIPE LOCATION
AT HOLCOMB BLVD. AND SNEADS
FCRR3 ROAD INTERSECTION.

FIELD PARTY
KELUM In Charge
Instrument _____
Notes _____
Tape Read _____
Tape or Rod _____
Tape or Rod _____
Instrument No. _____
Tape No. _____

WEATHER
Clear _____
Cloudy _____
Windy _____
Rain _____
Fair _____
Snow _____
Hot _____
Moderate _____
Cold _____
Fog _____
Figured By _____
Notes Checked By _____
Plotted By _____

FILE No. 140-R
Fldr. No. _____
Sheet 1-01-1
Date 11-27 1956
Quad. No. 140

Station	Dist.	Angle ' "	+	H. I. Bearing	Ver: Ang. Diff.	Elevation
B.M.			4.80	30.51		25.71
"A"					5.10	25.41
"B"					5.15	25.33
"C" ON 12" MAIN					7.75	22.76
"D" ON 12" MAIN					8.40	22.11
B.M.			4.80	30.51		25.71

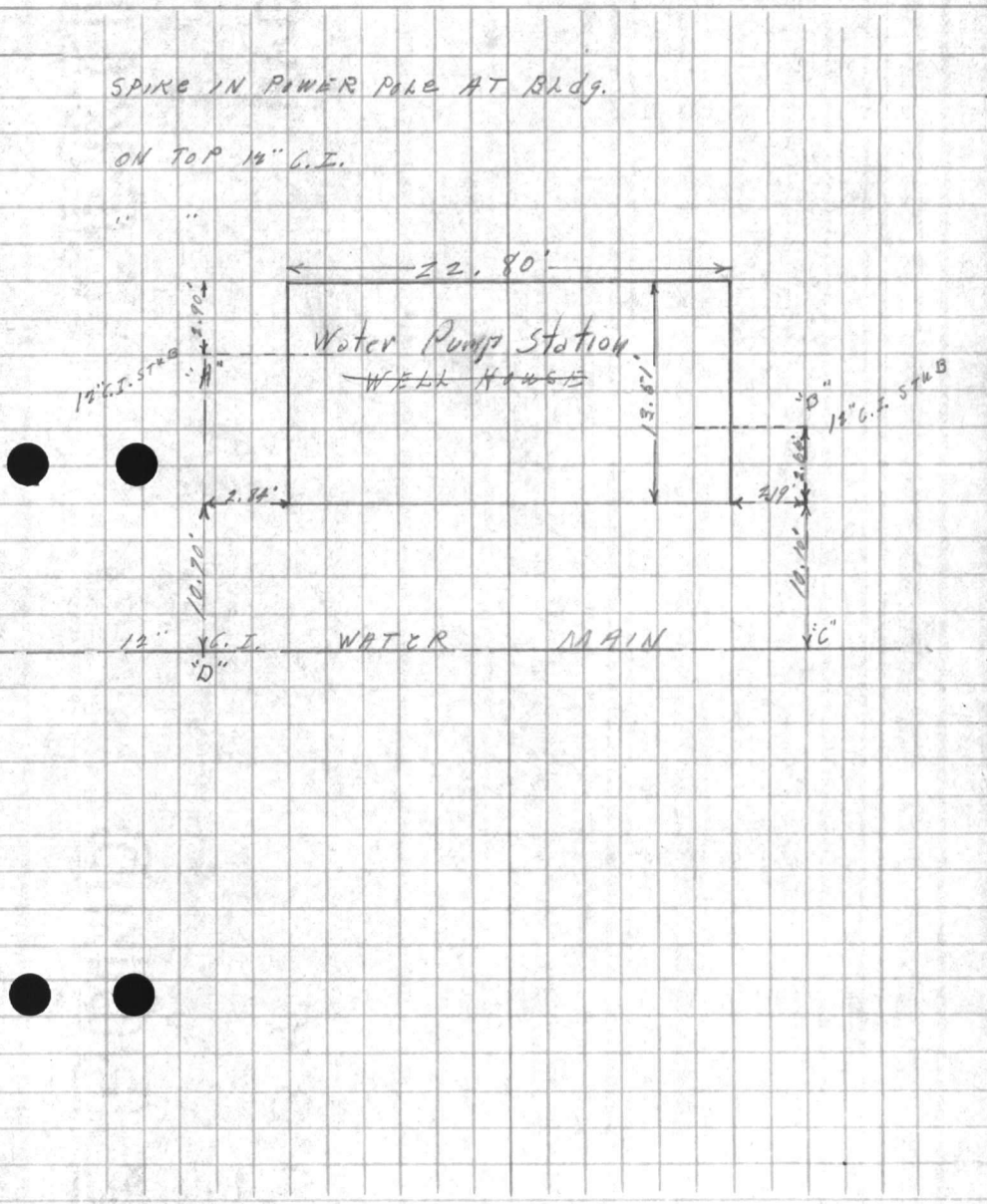

AVAILABLE

Return To
Public Works
Office
Camp Lejeune
North Carolina

PROJECT

Station

Date

ADVIS

Base and
Elevation

Height
Vertical

Tag No.
Treatment No.

Type of Rod

Time of Day

Direction

In Charge

FIELD PARTY

WEATHER

Clear
Partly
Cloudy
Wind
Rain
Fog

Figured By

Notes Checked By

Plotted By

FILE No.

Field No.

Sheet

Date

Quad No.

VALUABLE

SUBJECT Check Elevation
New Pump House

Return To
 Public Works
 Office
 Camp Lejeune
 North Carolina

FIELD PARTY

_____ In Charge
 _____ Instrument
 _____ Notes
 _____ Tape Read
 _____ Tape or Rod
 _____ Tape or Rod
 _____ Instrument No.
 _____ Tape No.

WEATHER

Clear _____
 Cloudy _____
 Windy _____
 Rain _____
 Fair _____
 Snow _____
 Hot _____
 Moderate _____
 Cold _____
 Fog _____
 Figured By _____
 Notes Checked By _____
 Plotted By _____

FILE No. 140-R
 Fldr. No. _____
 Sheet 1-1
 Date 7-25 1947
 Quad. No. 140

Station	Dist.	Angle	+	H. I. Bearing	Ver: Ang. Diff.	Elevation	
B.M. on P. Pole						25.71	Elev 25.71
	6.36			32.07			
					5.59	26.49	Floor Elev.
					4.99	27.08	Pump Foundation
					4.09	27.98	Top of discharge line
					<u>2.7.78</u>		Pump Discharge
					4.49	27.58	Bottom of pump discharge line.
T.P.					4.99	27.08	
	4.80			31.48			
					6.19	25.29	TOP under floor feeder line
					5.96	24.52	Top of under floor discharge line
B.M.						25.71	
					5.77	25.71	

WATERVILLE

Return to
Public Works
Office
Camp Lejeune
New River

SUBJECT

Station

Dist.

Angle

Reading

Vertical
Elevation

Tap No.

Item No.

Tap No.

Time

Type

Water

Temperature

Flow

Party

WATERVILLE

Checked By

Date

Time

Type

Water

Temperature

Flow

Party

WATERVILLE

Checked By

Date

Time

Type

Water

Temperature

Flow

Party

VALUABLE

SUBJECT

AMPITHEATER

RETURN TO
PUBLIC WORKS
OFFICE
CAMP LEJEUNE
NORTH CAROLINA

PARACUTE AREA
Relocation of Road "B"

FIELD PARTY

Sanchley IN CHARGE
Cault INSTRUMENT
S NOTES
Ratchun TAPE READ
Carney TAPE OR ROD
Tape or Rod
INSTRUMENT No.
Tape No.

WEATHER

CLEAR
CLOUDY
WINDY
RAIN
FAIR
SNOW
HOT
MODERATE
COLD
FOG

FILE No. 140-R
FLDR. No.
SHEET 1 of 2
DATE 6/12 1952
FIGURED BY
NOTES CHECKED BY
PLOTTED BY

Quad. No.

STATION	DIST.	ANGLE ° ' "	+	H. I. BEARING	VER. ANG. DIFF.	ELEVATION
---------	-------	----------------	---	------------------	--------------------	-----------

see sheet 2

A=30° RT.

D=17°04'01"

ZI. Δ

47.49
6.255
619.3.29

210 00 00 (1)

T=90.0

L=175.58

R=275.88

6+95.50 90.0

210 00 00 M

P.I.

270 00 00 (3)

+05.50 90.0

P.C.

Δ P.C.

6

5

4

3

+27.55 317.95 P.O.T

2

90 00 00 (1)

15400 (orig. location)

← 0+00 (orig. location)

1162.08

10190.08

0+00

Δ P.O.T

Δ 0+00

227.55 90 00 00 M

270 00 00 (3)

90 00 00 (1)

90 00 00 P.I. on Orig. Location

270 00 00 (3)

P.O.T on " "

For original location see Notes
dated - 5/29/52

11-11-10

SUBJECT

REPORT TO
FIELD WORKS
OFFICE
CAMP CHIEF
LOCATION

STATION DIST

SEARCH

INDEX AND EVALUATION

FIELD PARTY
IN CHARGE
INSTRUMENT
METERS
TAPES
TAPES
TAPES
TAPES
TAPES
TAPES

AM-DIR
CAMP
AGENCY
CAMP
CAMP
CAMP
CAMP
CAMP
CAMP
CAMP

11-11-10

FIELD NO

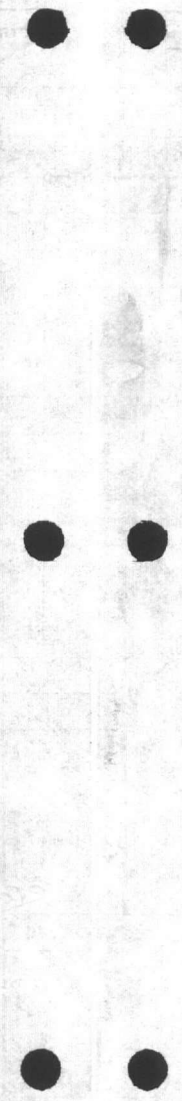

VALUABLE

SUBJECT

AMPHITHEATER
PARACHUTE AREA
RELOCATION OF "B" Rsl.

RETURN TO
PUBLIC WORKS
OFFICE
CAMP LEJEUNE
NORTH CAROLINA

FIELD PARTY

Sandberg
Coulb
5
Ketchum
Canochy Jr
IN CHARGE
INSTRUMENT
NOTES
TAPE READ
TAPE OR ROD
INSTRUMENT NO.
TAPE NO.

WEATHER

CLEAR
CLOUDY
WINDY
RAIN
FAIR
SNOW
HOT
MODERATE
COLD
FOG

FILE No. _____
FLDR. No. _____
SHEET 2 of 2
DATE 6/18 1952
FIGURED BY _____
NOTES CHECKED BY _____
PLOTTED BY _____

Quad. No. _____

STATION	DIST.	ANGLE			H. I. BEARING	VER: ANG. DIFF.	ELEVATION
		°	'	"			
F.S. on USMC Mon # 126							
USMC MON 17B		171	10	20 (1)			
		171	10	20 M			
		153	31	00 (3)			
		72	01	00 (1)			
10+73.91	1245.67	72	01	00 M	EXTERNAL P.O.T		
		216	03	00 (3)			
10+029	71.51				P.O.T (END LOCATION)		
10							
9							
8							
7+81.08	22032				P.T.		
6+95.50	900				P.L.		

171 10 20
171 10 20
153 31 00
72 01 00

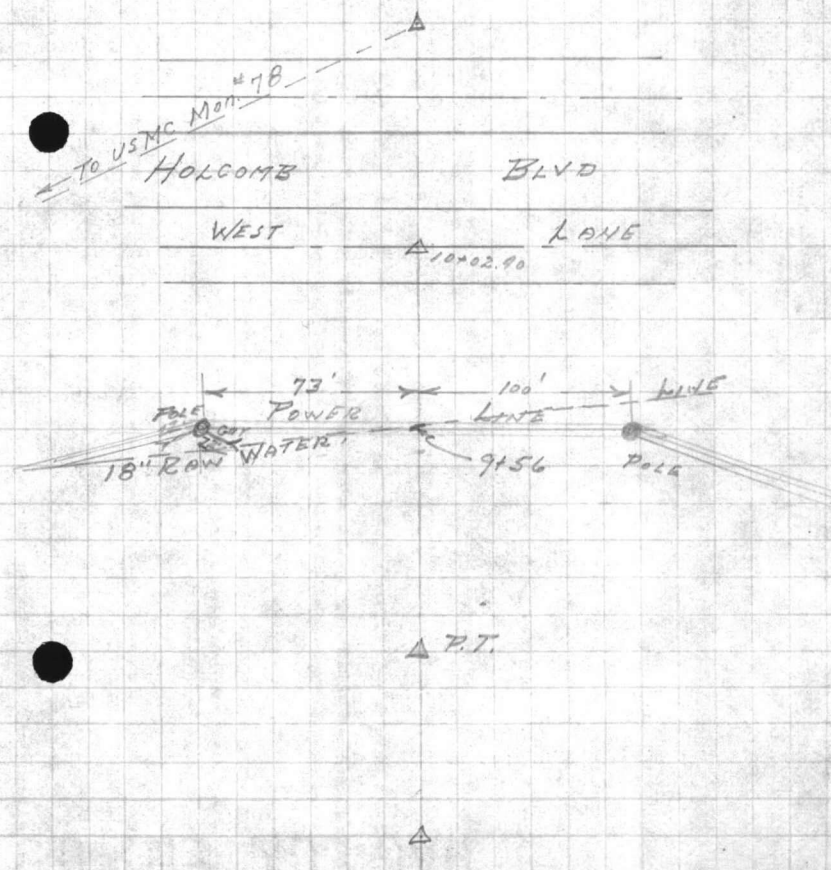

781.08
220.32
1001.40
221.32
90.00
311.32

RECORD TO
SPECIAL WORKS
OFFICE
RECORDS SECTION
CIVIL ENGINEERING

DATE: _____

NO. _____

BRANCH _____

DATE _____

REVISION _____

NO. _____
TO _____
FROM _____
DATE OF ISSUE _____
DATE OF DUE _____
TYPE OF JOB _____
APPROVED BY _____
CHECKED BY _____
DATE _____

REVISION NO. _____
REVISION BY _____
REVISION DATE _____
CHECKED BY _____
DATE _____

PLANT NO. _____
DATE _____

VALUABLE

SUBJECT

AMPITHEATERPARADISE AREALevels on Revision #2 Road "B"RETURN TO
PUBLIC WORKS
OFFICE
CAMP LEJEUNE
NORTH CAROLINA

FIELD PARTY

Sawatch IN CHARGECault INSTRUMENTS NOTESKatchum TAPE READCountry TAPE OR ROD

TAPE OR ROD

INSTRUMENT No.

TAPE No.

WEATHER

CLEAR
CLOUDY
WINDY
RAIN
FAIRSNOW
HOT
MODERATE
COLD
FOG

FIGURED BY

NOTES CHECKED BY

PLOTTED BY

FILE No.

FLDR. No.

SHEET 1DATE 6/12 1952

Quad. No.

STATION	DIST.	ANGLE		+	H. I. BEARING	VER. ANG. DIFF.	ELEVATION	
		°	' "					
T.B.M				3 19	33 93		29.74 30.74	Tack in E.S.T. - E West Lane of Holcomb Blvd on Orig. location - See Notes dated
10+02.90						3 36	29.57 30.57	E W Lane of Holcomb Blvd
9+91						3 48	29.45 30.45	edge E.S.T
9+82						3 9	29.03 30.03	Shoulder
9+75						5 6	27.33 28.33	Ditch line
9+69						4 9	29.03 28.03	Top slope
9+48						4 7	29.23 28.23	E 18" Row Water line - Top ground
9						9 0	24.93 23.93	Top 18" " " "
8						4 4	29.53 28.53	
8						4 6	29.33 28.33	
7+81.08						4 52	29.41 28.41	P.T.
T.P.				5 27	34 67	4 53	29 40	Top hub P.I. - 6+95
6+93.29						5 4	29.29 28.27	Mid Point curve
6+05.50						4 60	30.07 29.07	P.C.
5						4 4	29.27 30.27	
4						5 5	28.17 29.17	
3						8 2	25.47 26.47	

RECEIVED
OFFICE
MAY 19 1964

STATION DIST

SUBJECT

SEARCHED INDEXED
SERIALIZED FILED

FIELD PARTY

DATE OF REPORT

REPORT MADE AT

REPORT MADE BY

DATE OF FIELD WORK

LOCALITY

PLANT OR ANIMAL

COLLECTOR

WEATHER

MOON

WIND

TEMPERATURE

RELATIVE HUMIDITY

WIND DIRECTION

WIND VELOCITY

OTHER

FIELD NO.

OR NO.

SHEET

13

VALUABLE

SUBJECT AMPITHEATER

RETURN TO
PUBLIC WORKS
OFFICE
CAMP LEJEUNE
NORTH CAROLINA

PARACHUTE AREA
Levels - Relocation #2 of Road "B"

FIELD PARTY

Sandifer IN CHARGE
Coyle INSTRUMENT
5 NOTES
Ketchum TAPE READ
TAPE OR ROD
TAPE OR ROD
INSTRUMENT NO.
TAPE NO.

WEATHER

CLEAR
CLOUDY
WINDY
RAIN
FAIR

SNOW
HOT
MODERATE
COLD
FOG

FILE No. _____
FLDR. No. _____
SHEET 2 of 2
DATE 6/12 1952

FIGURED BY _____
NOTES CHECKED BY _____
PLOTTED BY _____
Quad. No. _____

STATION	DIST.	ANGLE ° ' "	+	H. I. BEARING	VER. ANG. DIFF.	ELEVATION
				34 67		26.17
2					7.5	29.17
						26.77
1					6.9	27.77
+50					8.4	26.29 25.27
0+00					9.88	20.79 23.79 Top of hub
T.P.				388 34 16	4.29	30.28
T.P.M.					3.42	30.74

Orig. elev. = 30.74
30.74
ERROR = 0.00

REPORT TO
PHYSIC WORKS
OFFICE
BAPT. LEVINE
PORT CHARLTON

STATION Dist

ABUSE

BEARING

EXCAVATION

INSTRUMENT NO.

TAKE OR FOR

BEAD ID.

TAKE FROM

FIELD NO.

FIELD PARTY

WEATHER

IN CRACK

WIND

INSTRUMENT

MOON

WATER

TEMPERATURE

TAKE OR FOR

DATE

INSTRUMENT NO.

FIELD NO.

TAKE OR FOR

DATE

INSTRUMENT NO.

FIELD NO.

TAKE OR FOR

DATE

INSTRUMENT NO.

FIELD NO.

TAKE OR FOR

DATE

INSTRUMENT NO.

FIELD NO.

TAKE OR FOR

DATE

INSTRUMENT NO.

FIELD NO.

TAKE OR FOR

DATE

INSTRUMENT NO.

FIELD NO.

TAKE OR FOR

DATE

INSTRUMENT NO.

FIELD NO.

TAKE OR FOR

DATE

INSTRUMENT NO.

FIELD NO.

TAKE OR FOR

DATE

INSTRUMENT NO.

FIELD NO.

TAKE OR FOR

DATE

INSTRUMENT NO.

FIELD NO.

TAKE OR FOR

DATE

INSTRUMENT NO.

FIELD NO.

TAKE OR FOR

DATE

INSTRUMENT NO.

FIELD NO.

TAKE OR FOR

DATE

INSTRUMENT NO.

FIELD NO.

TAKE OR FOR

DATE

INSTRUMENT NO.

FIELD NO.

TAKE OR FOR

DATE

VALUABLE

RETURN TO
PUBLIC WORKS
OFFICE
CAMP LEONARD
ROCKHILL, CAROLINA

STATION DIST. ANGLES

ED. HARTY
IN CHARGE
CLEAR
CLOUDY
WINDY
RAINY
FOG
STATE ROAD
NOTICE ON ROAD
TYPE ON ROAD
ROAD NO.

TEMPERATURE
WIND
WINDY
RAINY
FOG
NOTICE ON ROAD
TYPE ON ROAD
ROAD NO.

WILL 140
TEMPERATURE
WIND
WINDY
RAINY
FOG
NOTICE ON ROAD
TYPE ON ROAD
ROAD NO.



140 140

VALUABLE

SUBJECT Elev. Holcomb Blvd, Camp
Lejeune R.C. at Bearhead Creek
High Water, Hurricanes 1955

RETURN TO
 PUBLIC WORKS
 OFFICE
 CAMP LEJEUNE
 NORTH CAROLINA

FIELD PARTY
Marton IN CHARGE
 _____ INSTRUMENT
 _____ NOTES
 _____ TAPE READ
 _____ TAPE OR ROD
 _____ TAPE OR ROD
 _____ INSTRUMENT NO.
 _____ TAPE NO.

WEATHER
 CLEAR _____
 CLOUDY _____
 WINDY _____
 RAIN _____
 FAIR _____
 SNOW _____
 HOT _____
 MODERATE _____
 COLD _____
 FOG _____
 FIGURED BY _____
 NOTES CHECKED BY _____
 PLOTTED BY _____

FILE No. 190-12
 FLDR. No. _____
 SHEET 20f
 DATE _____ 19__

Quad. No. _____

STATION	DIST.	ANGLE ° ' "	+	H. I. BEARING	VER: ANG. DIFF.	ELEVATION
B.M.						25.71
				0.5326.24	✓	
T.P.				11.62	✓	14.62
				1.67	✓	16.29
①				Inv. 48" R.C.P.	5.30	10.99 ✓
②				" "	14.41	1.88
③				" "	14.70	1.59
④				" "	14.33	1.96
⑤				" "	13.67	2.62
T.P.					7.30	8.99 ✓
				10.97	✓	19.96

Spike in power pole A.F. 1 near
 Bldg. # 742 (water pumping sta.)

← Holcom Blvd.

← Holcom Blvd.

To Gate

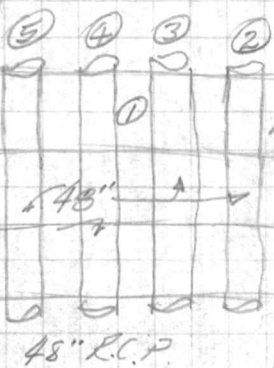

11.0
 10.0
 21.0

11.0 Road
 + 10.0 Approx. Height of Debris after Hurricane watchout 1955.
 21.0

100,
44
1441

1036
90
14.7

9.27
8.4
13.67

993
90
14.33

VALUABLE

SUBJECT _____

 RETURN TO
 PUBLIC WORKS
 OFFICE
 CAMP LEJEUNE
 NORTH CAROLINA

FIELD PARTY

 IN CHARGE

 INSTRUMENT

 NOTES

 TAPE READ

 TAPE OR ROD

 TAPE OR ROD

 INSTRUMENT NO.

 TAPE NO. _____

WEATHER

CLEAR
 CLOUDY
 WINDY
 RAIN
 FAIR
 SNOW
 HOT
 MODERATE
 COLD
 FOG

FILE No. _____
 FLDR. No. _____
 SHEET 3 of
 FIGURED BY _____
 NOTES CHECKED BY _____
 PLOTTED BY _____
 DATE _____ 19__

Quad. No. _____

STATION	DIST.	ANGLE ° ' "	+	H. I. BEARING	VER: ANG. DIFF.	ELEVATION	
①				19.96	✓	1.41 18.55	✓ Top RR Tie
②		9.24				16.86 3.10	1 1/2" Metal pipe
③		9.5				16.80 3.16	" " "
④		9.34				17.02 2.94	" " "
⑤		9.0				16.71 3.25	" " "
TP.						8.30 11.66	✓
TP.		9.63		21.29	✓	1.64 19.65	✓
		7.41		27.06	✓		
P. M.						1.34 25.72	✓

Camp Lejeune RR
To Jacksonville

⑤ ④ ③ ②
 ①
 48" Metal pipe

Adams, Camp R.R. Foreman, states water during Hurricanes 1955,
 was approx. 4ft. over Track when RR Fill gave way.

18.6
 4.0

 22.6 High Water

VALUABLE

RETURN TO
PUBLIC WORKS
OFFICE
CAMP LEJEUNE
NORTH CAROLINA

SUBJECT

*Projection Bldg.
Outdoor Theatre
Holcomb Blvd. & Parachute Tower Road*

FIELD PARTY

IN CHARGE

INSTRUMENT

NOTES

TAPE READ

TAPE OR ROD

TAPE OR ROD

INSTRUMENT NO.

TAPE NO.

WEATHER

CLEAR
CLOUDY
WINDY
RAIN
FAIR
SNOW
HOT
MODERATE
COLD
FOG
FIGURED BY _____
NOTES CHECKED BY _____
PLOTTED BY _____

FILE No. *140-10*

FLDR. No. _____

SHEET *2 of*

DATE _____ 19__

Quad. No. _____

STATION	DIST.	ANGLE ° ' "	+	H. I. BEARING	VER. ANG. DIFF.	ELEVATION	
<i>B.M.</i>				<i>130 33 15</i> ✓		<i>31 85</i>	<i>SPIKE IN 6" DOGWOOD TREE N. COR. OPEN THREATRE</i>
				<i>731 33 20</i> ✓	<i>7.26</i>	<i>25.89</i> ✓	<i>FLOOR 770</i>
				<i>135 31 85</i> ✓			

VALUABLE

RETURN TO
PUBLIC WORKS
OFFICE
CAMP LEJEUNE
NORTH CAROLINA

SUBJECT

*Parachute Tower and
Heating Plant.*

FIELD PARTY

IN CHARGE

INSTRUMENT

NOTES

TAPE READ

TAPE OR ROD

TAPE OR ROD

INSTRUMENT NO.

TAPE NO.

WEATHER

CLEAR _____
CLOUDY _____
WINDY _____
RAIN _____
FAIR _____
SNOW _____
HOT _____
MODERATE _____
COLD _____
FOG _____
FIGURED BY _____
NOTES CHECKED BY _____
PLOTTED BY _____

FILE No. *140-R*
FLDR. No. _____
SHEET *3 of*
DATE _____ 19__

Quad. No. _____

STATION	DIST.	ANGLE ° ' "	+	H. I. BEARING	VER. ANG. DIFF.	ELEVATION
B.M.			465	36.50	✓	31.85 ✓
T.P.			483	34.09	✓	7.24 29.26 ✓
T.P.			132	31.50	✓	3.91 30.18 ✓
TP			573	31.70	✓	5.53 <u>25.97</u> ✓
T.P.			402	34.12	✓	1.60 30.10 ✓
T.P.			758	38.33	✓	3.37 30.75 ✓
T.P.			538	39.84	✓	3.87 34.46 ✓
T.P.			429	39.82	✓	4.31 <u>35.53</u> ✓
T.P.			510	36.46	✓	8.46 31.36 ✓
					✓	4.43 31.83 ✓

*SPIKE IN 6" DOGWOOD NORTH COR.
AREA OPEN THEATRE
ON HEAD WALL (EAST) FRONT PT #1*

FLOOR PT # 5

FLOOR PT # 3

(31.85) SAME AS ABOVE

*3046
3185
C1*

VALUABLE

RECEIVED
FEDERAL BUREAU OF INVESTIGATION
WASHINGTON, D. C.

STATION

DIST

NO.

DATE

RECEIVED BY

DATE

TIME

PLACE

REMARKS

WEATHER

NO.

RECEIVED BY

DATE

TIME

PLACE

REMARKS

WEATHER

NO.

RECEIVED BY

DATE

TIME

PLACE

REMARKS

WEATHER

NO.