

REVISIONS			
SYM.	DESCRIPTION	DATE	APPROVED

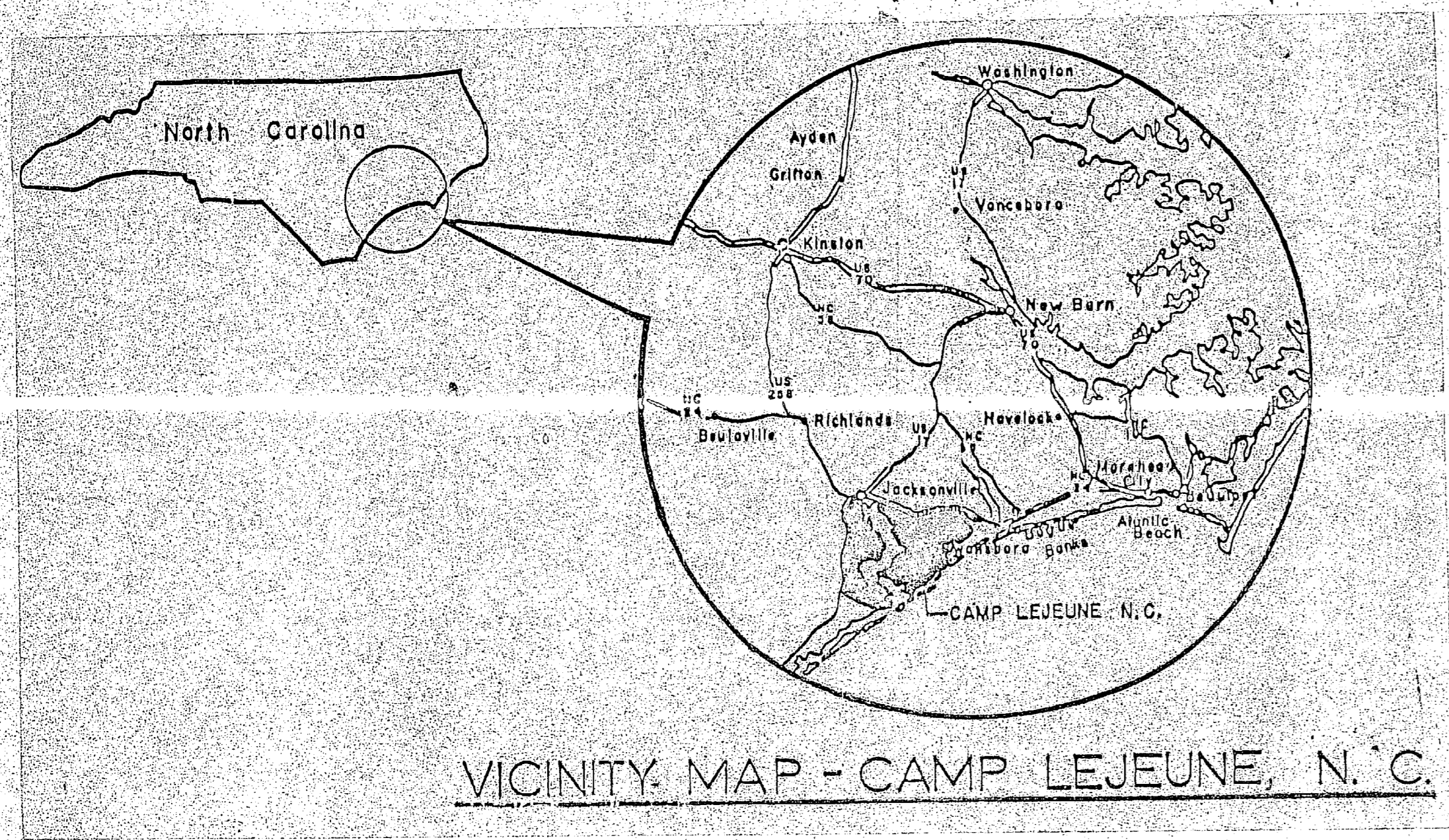

VICINITY MAP - CAMP LEJEUNE, N. C.

RECARBONATION SYSTEM, BLDG. 20

CONTRACT NO. N62470-84-B-7886

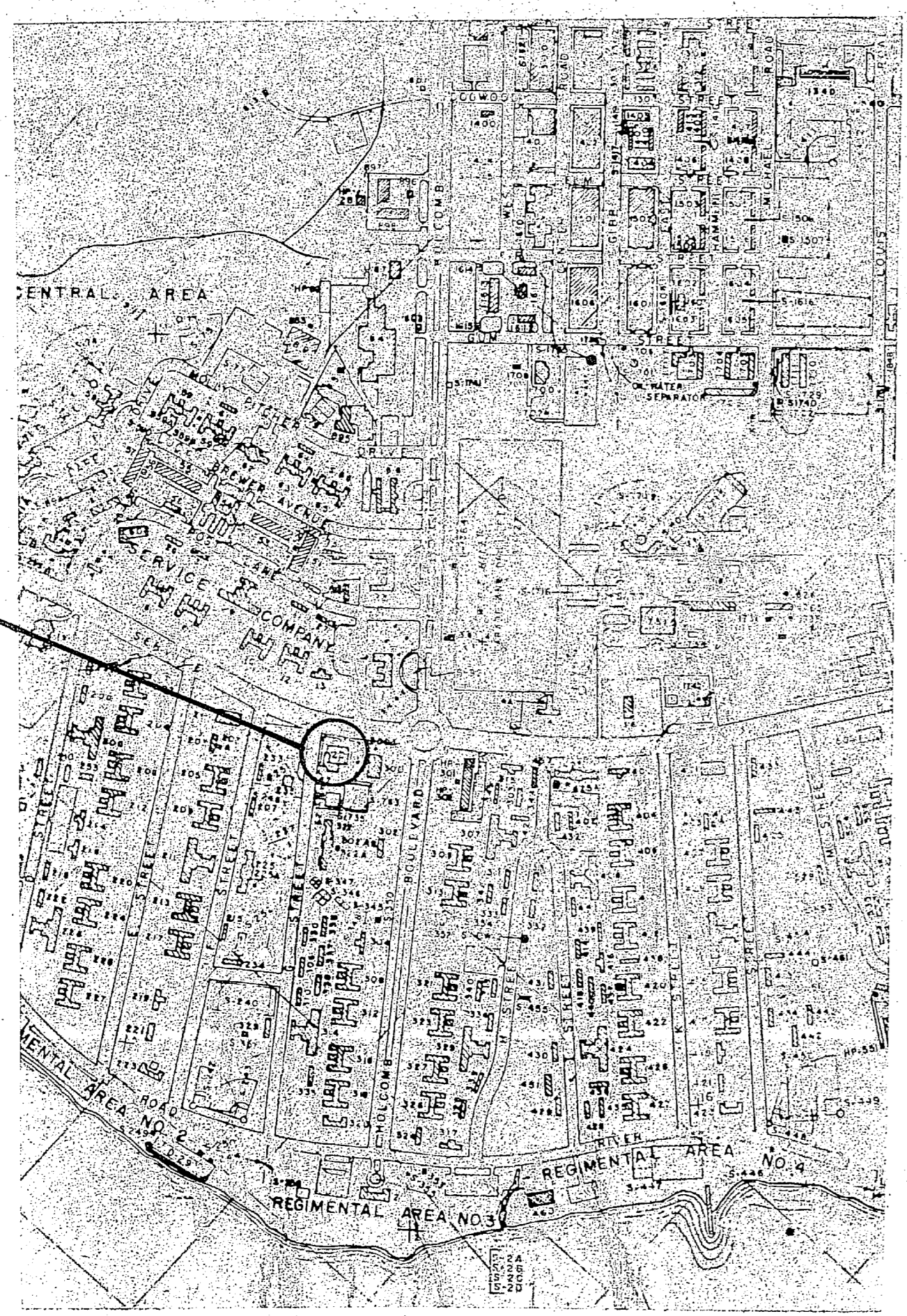

BLDG. 20

HADNOT PT. PLAN

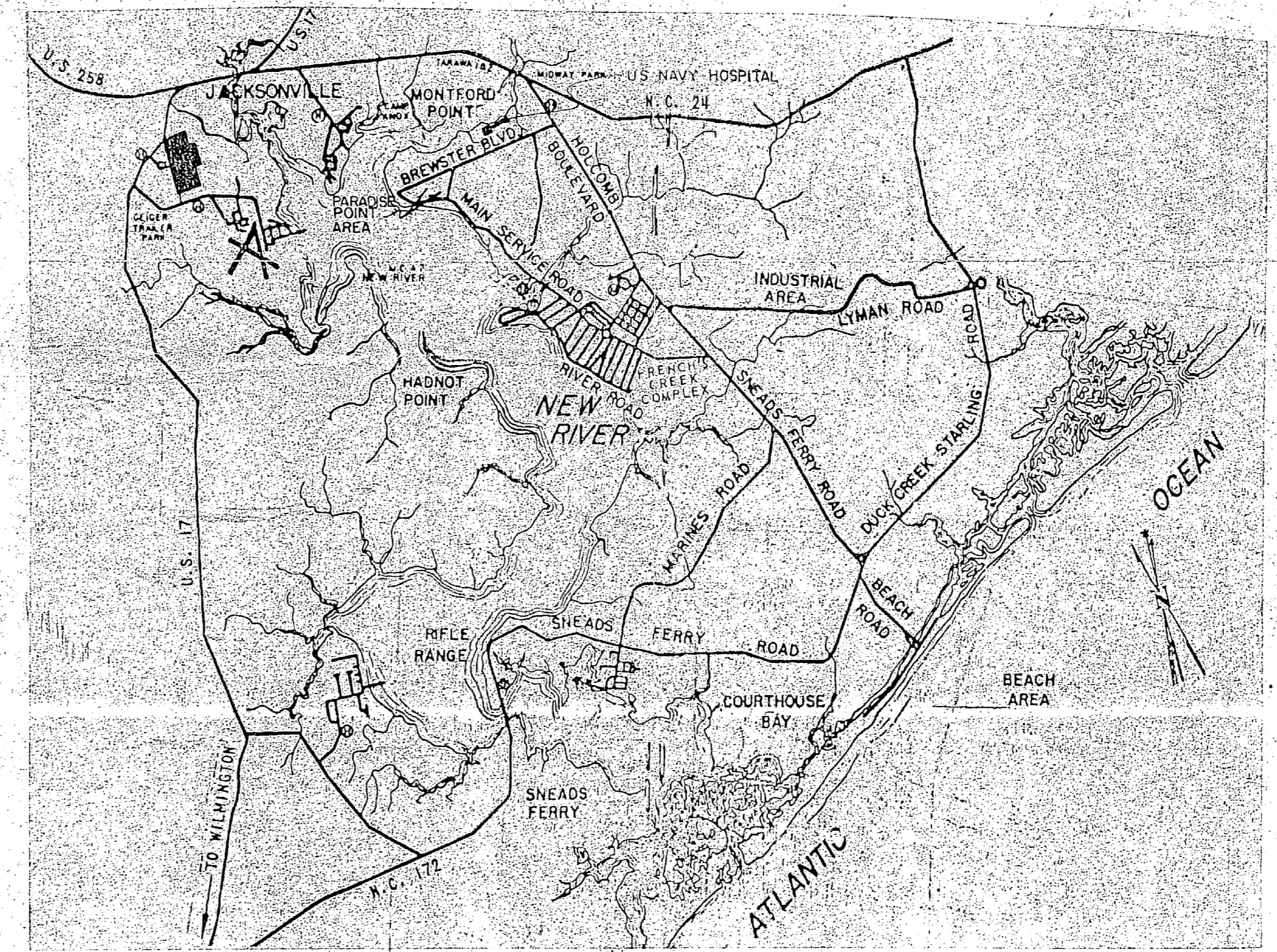

LOCATION MAP

DESIGNER: BASHTON		CHECKER: BASHTON		APPROVED: PWO OR DIC		DATE	SIZE: F	CODE IDENT. NO.: 80091	NAVAC DRAWING NO.
SUBMITTED BY:		DESIGN DIR.:		SATISFACTORY TO:		DATE	SCALE: NOTED	SPEC. 05-84-7886	SHEET 1 OF 2
DEPARTMENT OF THE NAVY NAVAL FACILITIES ENGINEERING COMMAND MARINE CORPS BASE CAMP LEJEUNE, NORTH CAROLINA				RECARBONATION SYSTEM, BLDG. 20 VICINITY, LOCATION MAP					

C-1



REVISIONS			
SYM.	DESCRIPTION	DATE	APPROVED

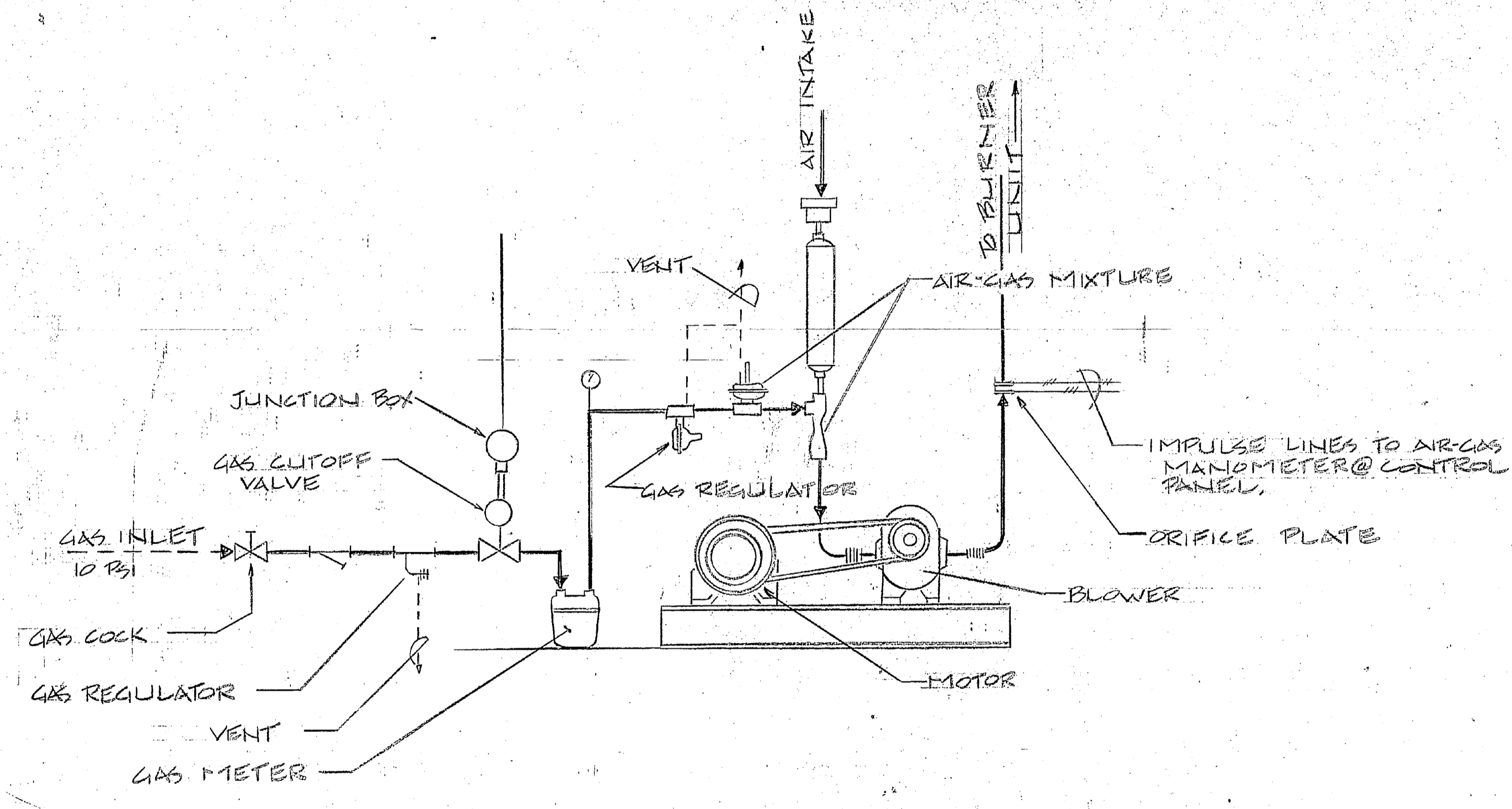
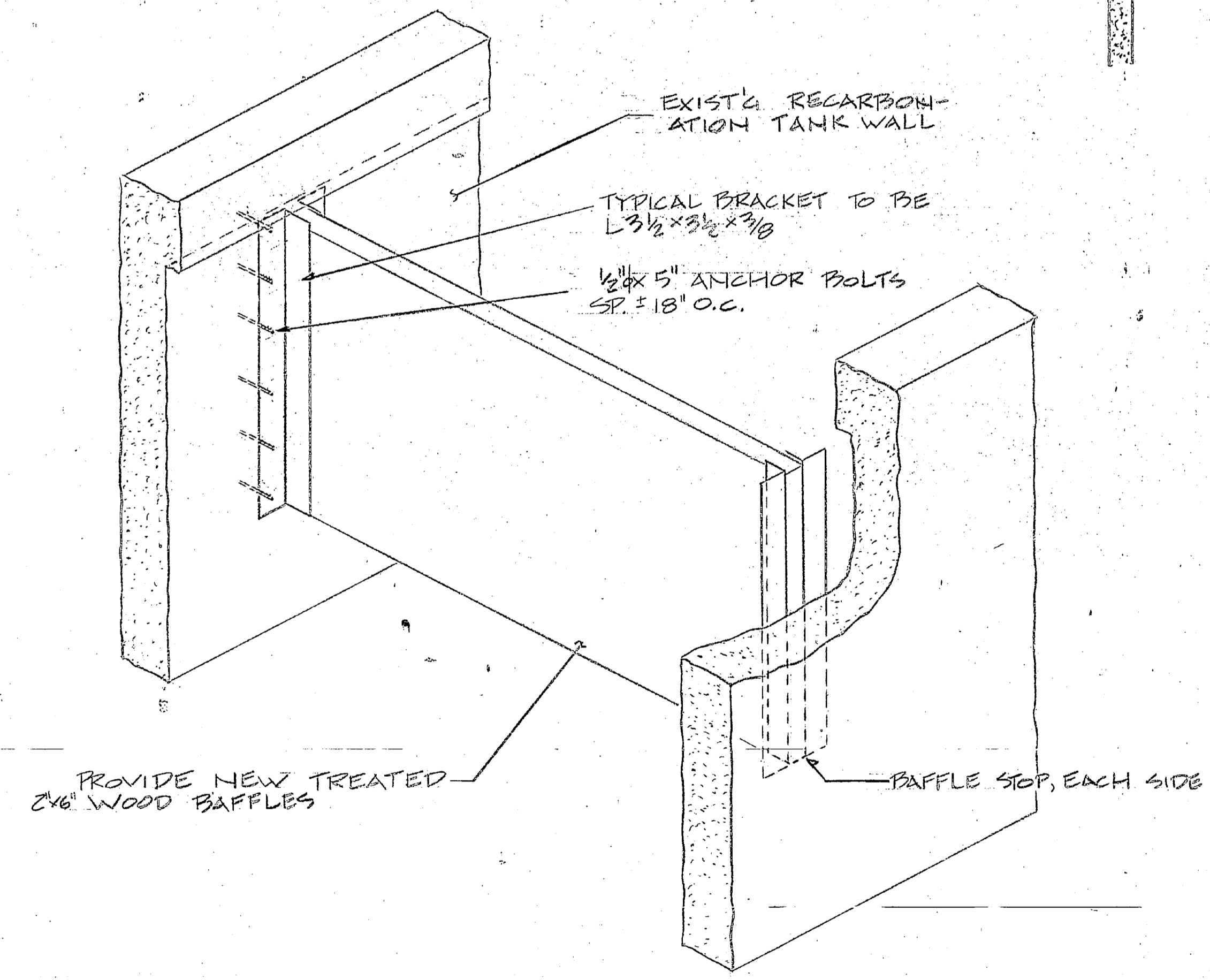
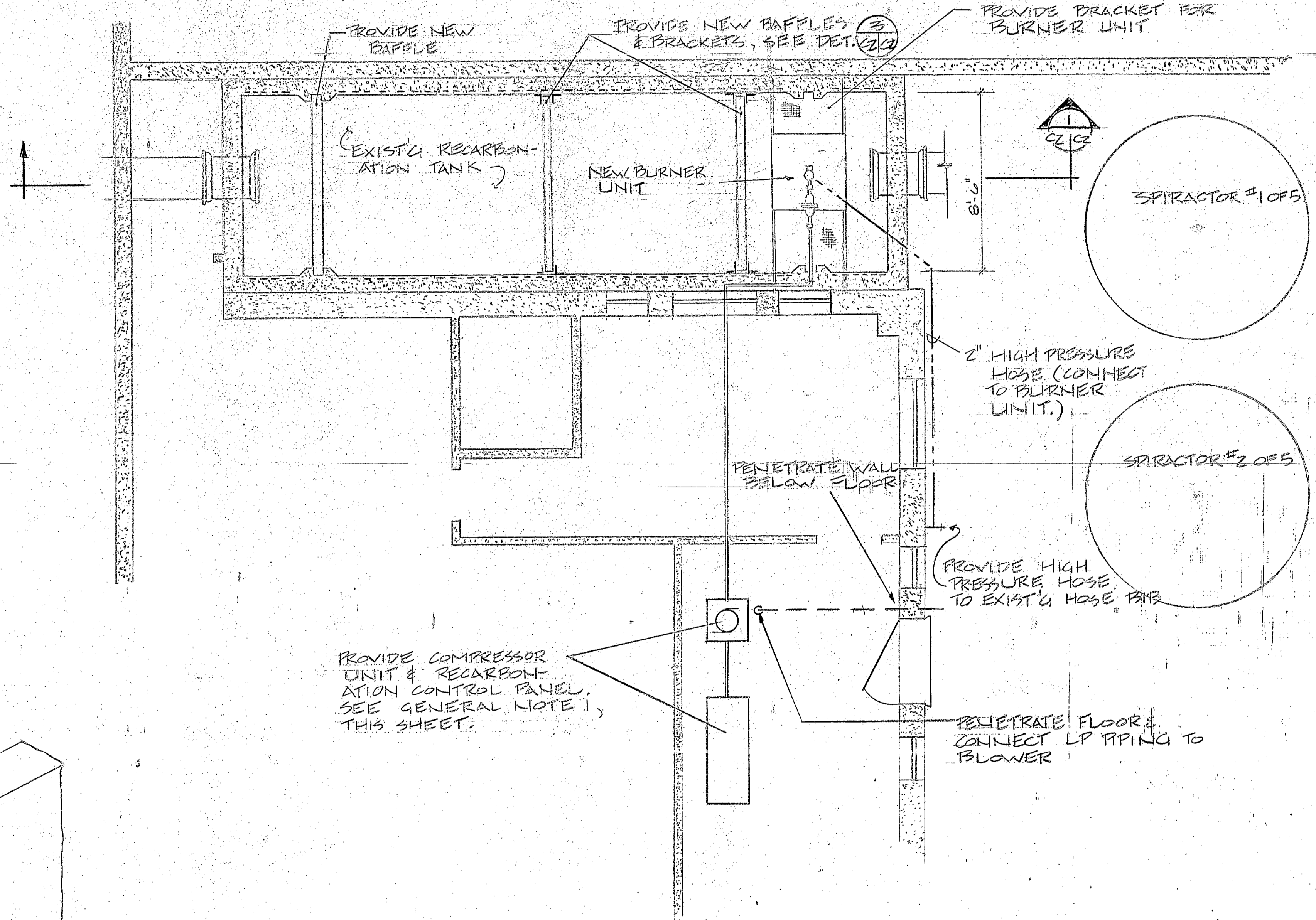
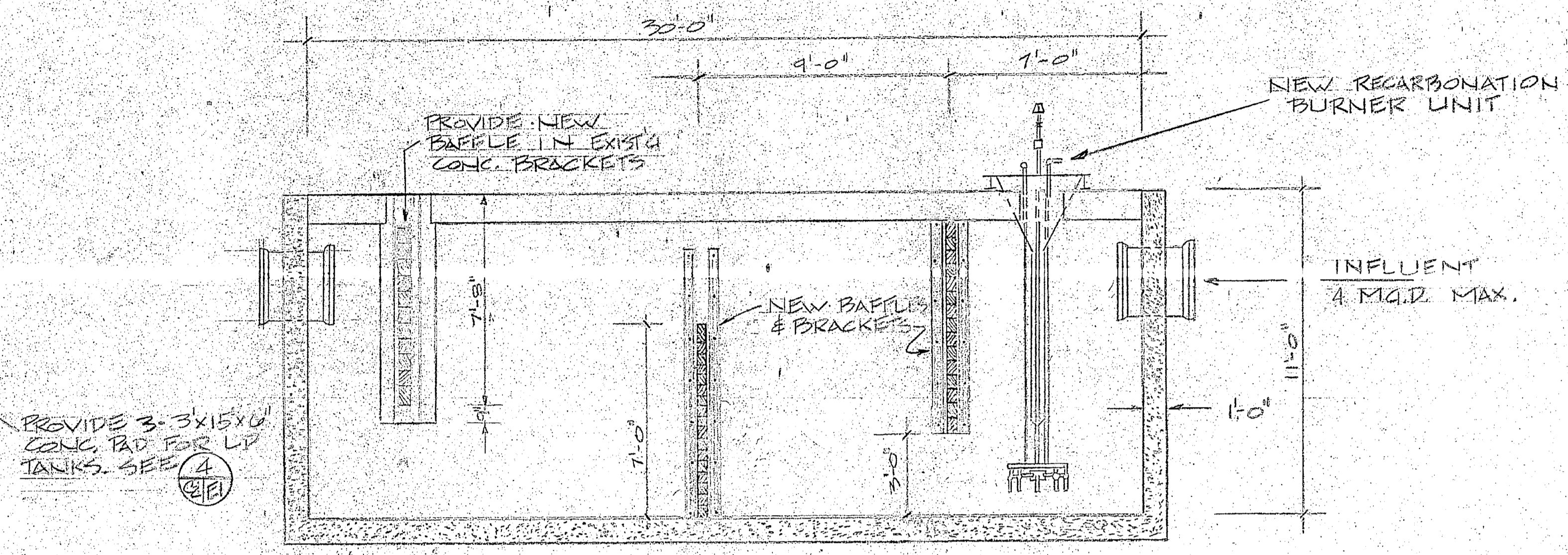
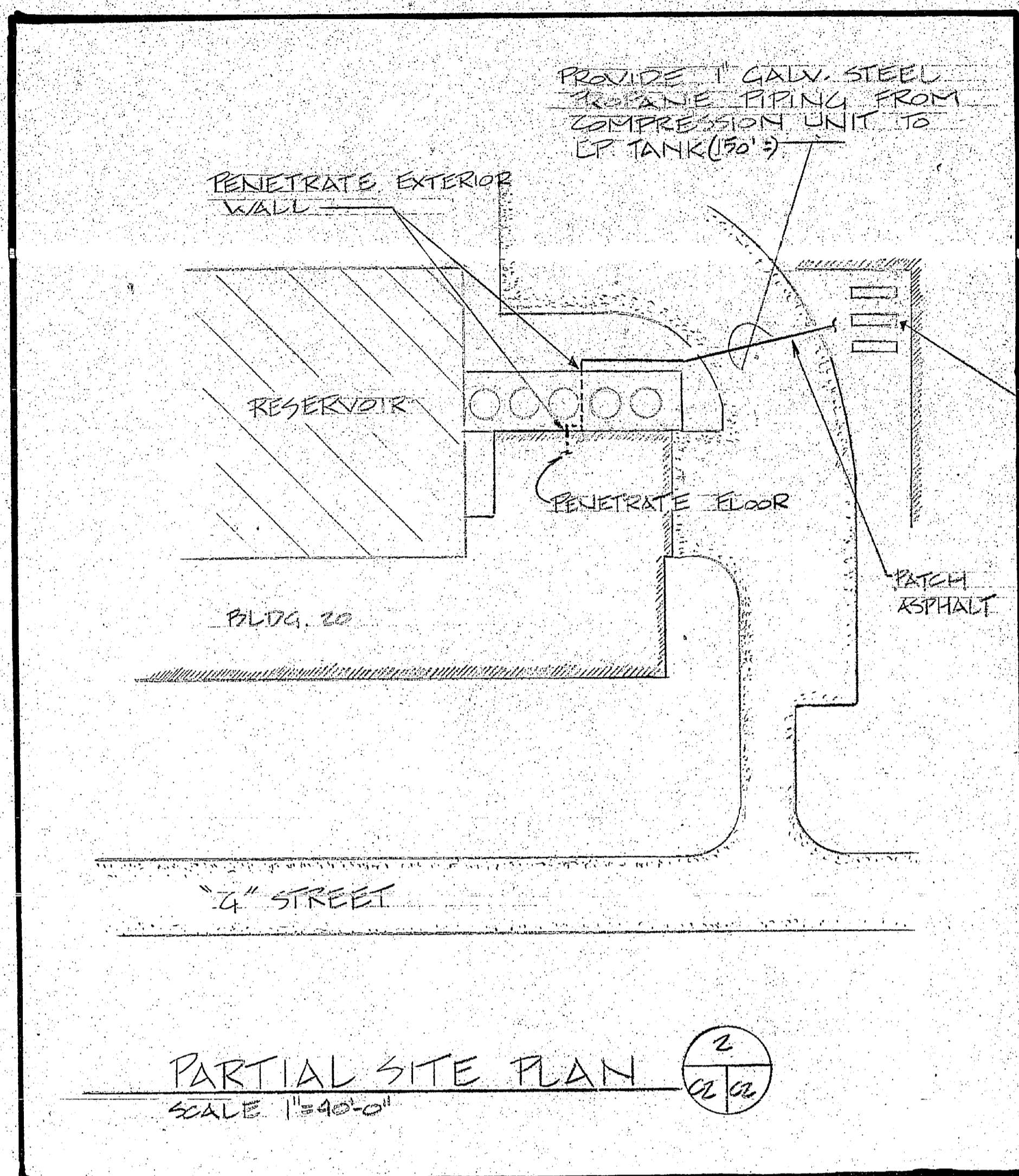

- GENERAL NOTES**
1. PROVIDE WATER TREATMENT RECARBONATION SYSTEM CAPABLE OF PRODUCING 1000 GALLONS OF CO₂ PER HOUR. TYPICAL SYSTEM SHALL INCLUDE A SUBMERGED COMBUSTION BURNER UNIT W/ STAINLESS STEEL COMBUSTION CHAMBER, A COMPRESSOR UNIT, CONNECTION PIPING TO BLEND, METER & DELIVER THE AIR-PROPANE FUEL TO THE BURNER, A CONTROL PANEL W/ AIR-GAS MANOMETERS, GAS MANOMETERS, AIR-GAS GAUGES, GAS GAUGES, FLAME INDICATORS, PH CONTROLLERS, ETC. (PER MANUFACTURER'S RECOMMENDATIONS). SYSTEM SHALL BE AN AUTOMATIC PH CONTROLLED SYSTEM.
 2. PROVIDE 5000 GALLONS LIQUID PROPANE STORAGE CAPACITY FOR RECARBONATION BURNER. SEE DET. ALL PROPANE PIPING & APPLIANCEANCES TO BE SUPPLIED BY CONTRACTOR.

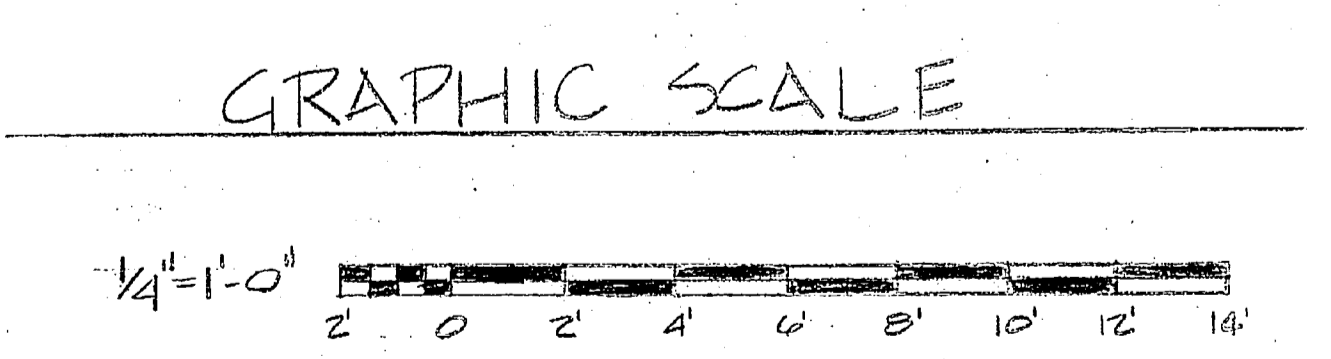

DES. P. ASHTON		DR. P. ASHTON		CHK.		SUBMITTED BY:		DESIGN DIR.		APPROVED: PWO OR OIC		DATE		SIZE		CODE IDENT. NO.		NAVFAC DRAWING NO.	
SATSFACTORY TO:		DATE		F		80091		CONSTR. CONTR. NO. 101-84-1000		SHEET 2 OF 2		SCALE: GRAPHIC SPEC. 01-84-1000		SHEET 2 OF 2		C-2		DEPARTMENT OF THE NAVY NAVAL FACILITIES ENGINEERING COMMAND MARINE CORPS BASE CAMP LEJEUNE, NORTH CAROLINA RECARBONATION SYSTEM, BLDG 20	



REVISIONS			
SYM.	DESCRIPTION	DATE	APPROVED

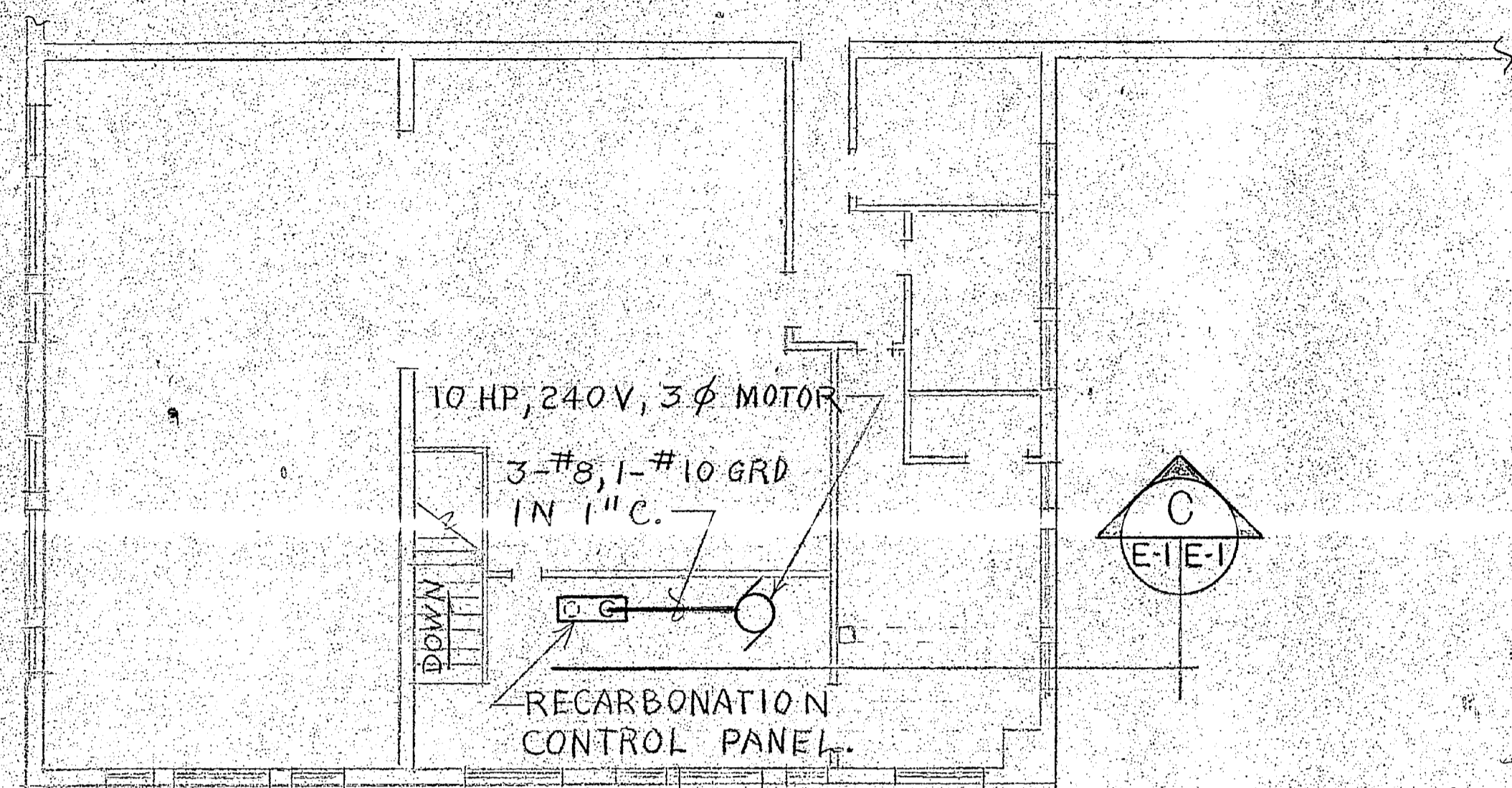

ELECTRICAL PLAN - 2ND FLOOR (PARTIAL)
SCALE: 1/8" = 1'-0"

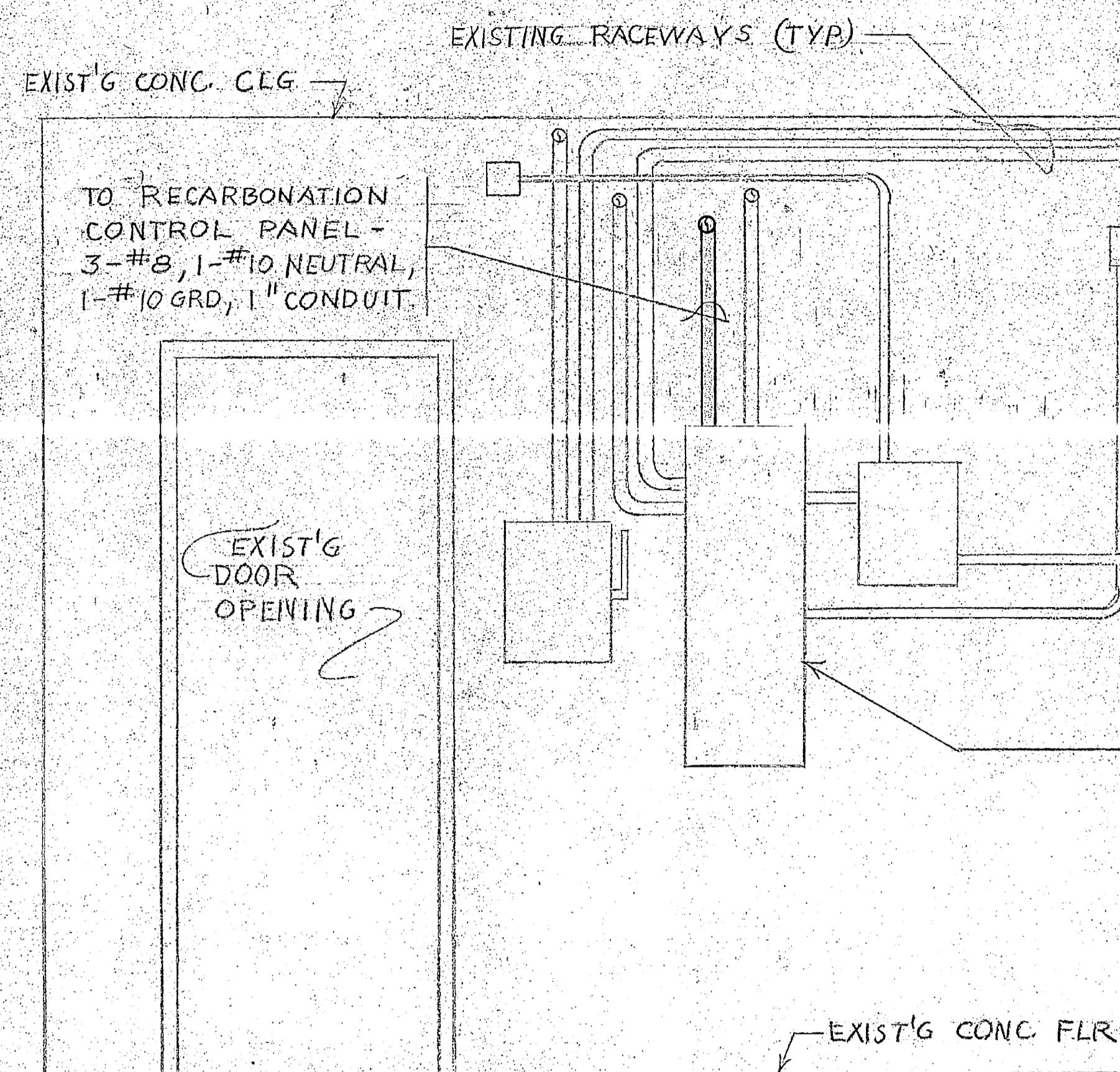

EXIST'G PANEL: GENERAL ELECTRIC-NLAB
STYLE 5, 3Ø, 4-W, 240 VOLTS.
PROVIDE 3 POLE, 60 AMP BRANCH
BREAKER.

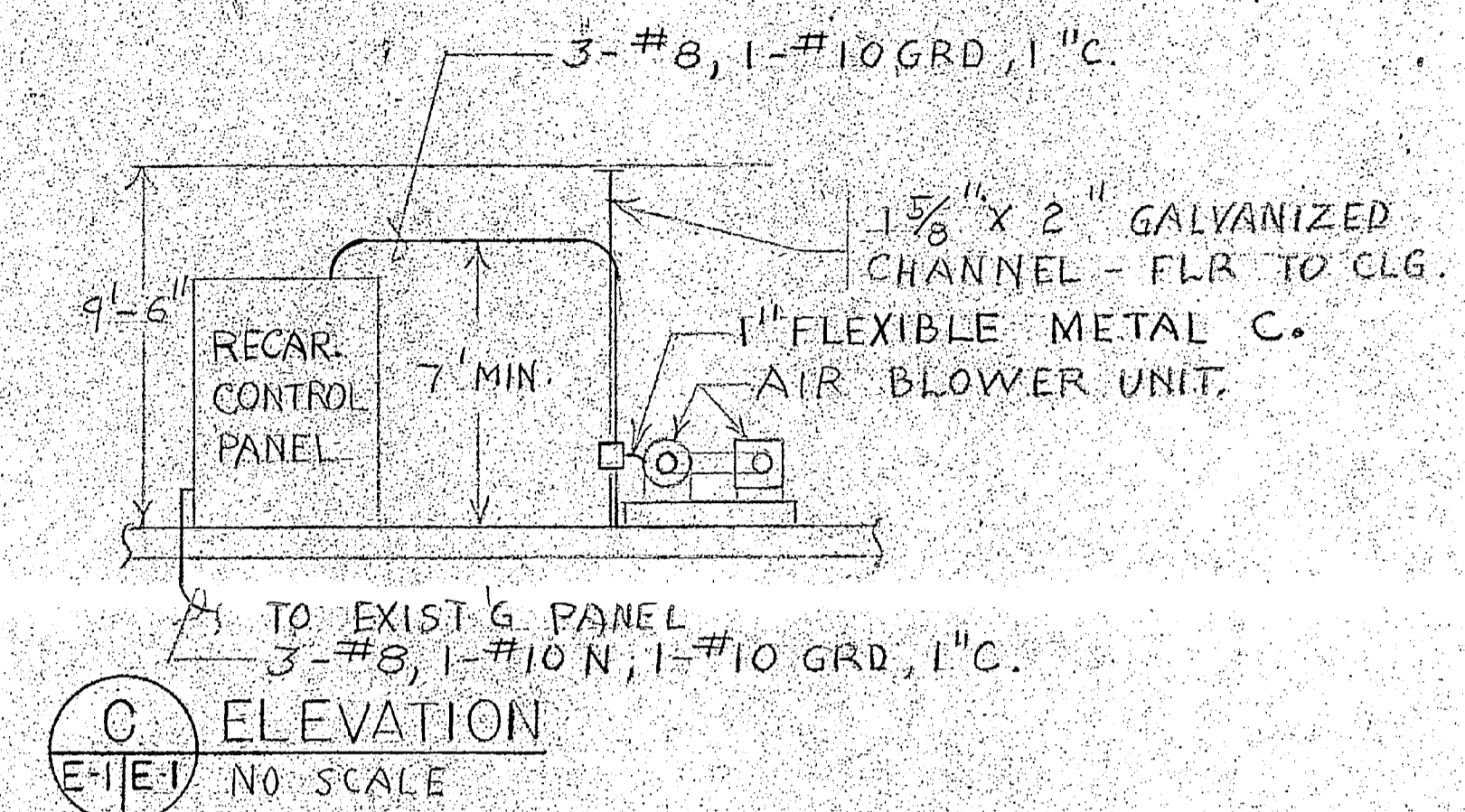

ELEVATION
NO SCALE

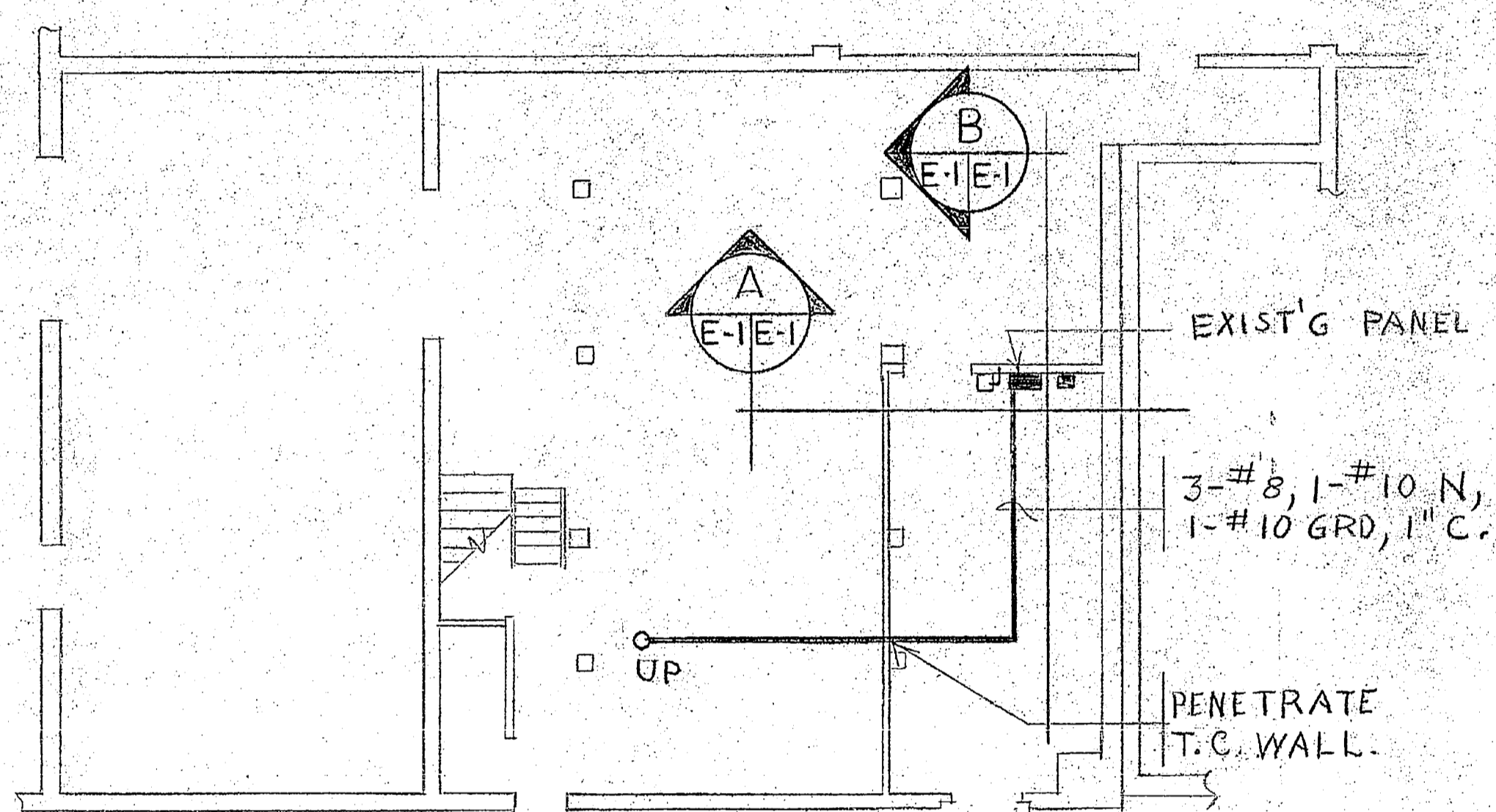

ELECTRICAL PLAN - 1ST FLOOR (PARTIAL)
SCALE: 1/8" = 1'-0"

ELEVATION
NO SCALE

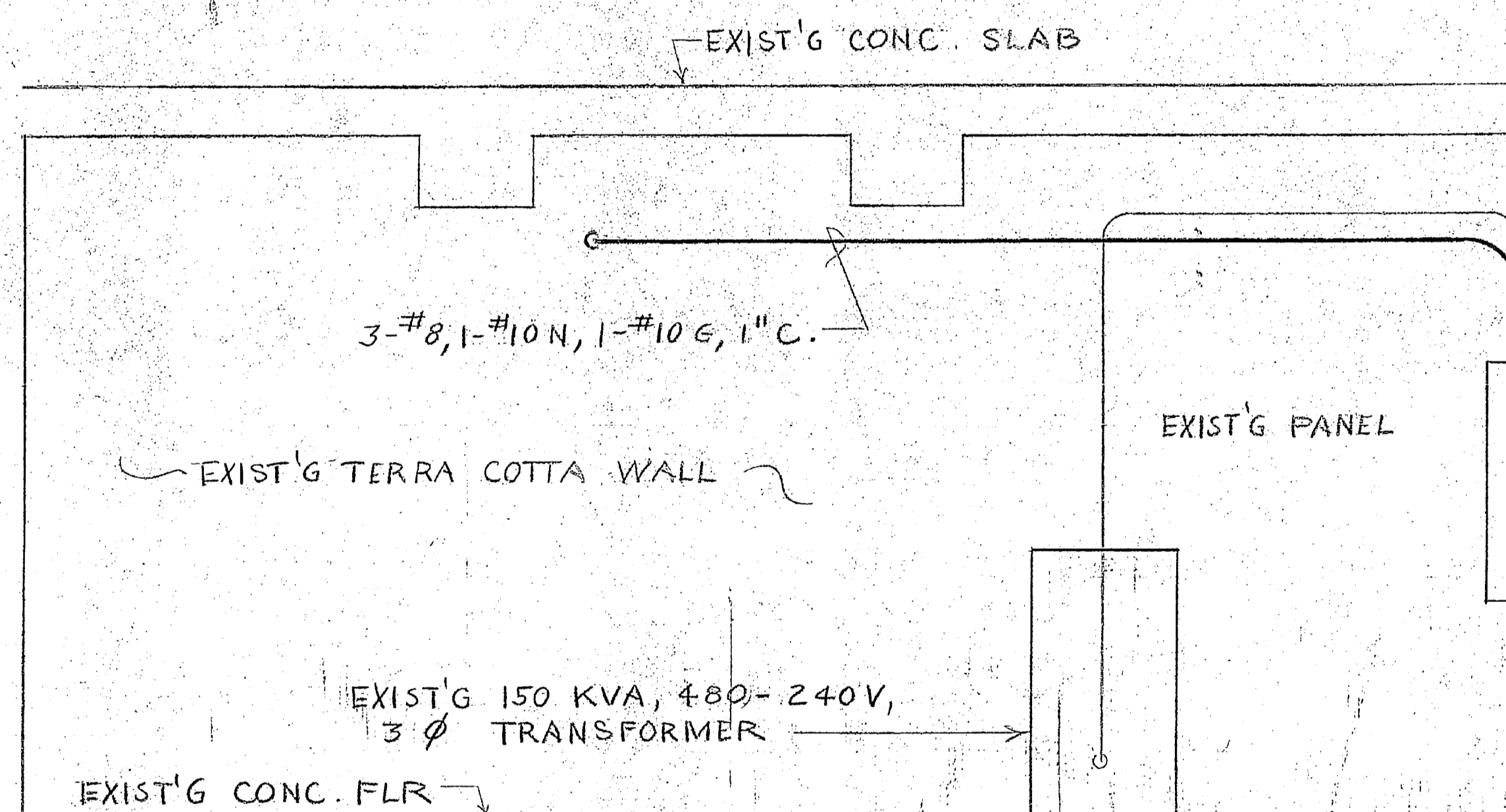

ELEVATION
NO SCALE

GENERAL NOTES

1. ALL WORK & MATERIALS, UNLESS NOTED OTHERWISE AS EXISTING, ARE NEW & SHALL BE PROVIDED BY THE CONTRACTOR.
2. EXISTING EQUIPMENT IS TO REMAIN UNLESS NOTED OTHERWISE.

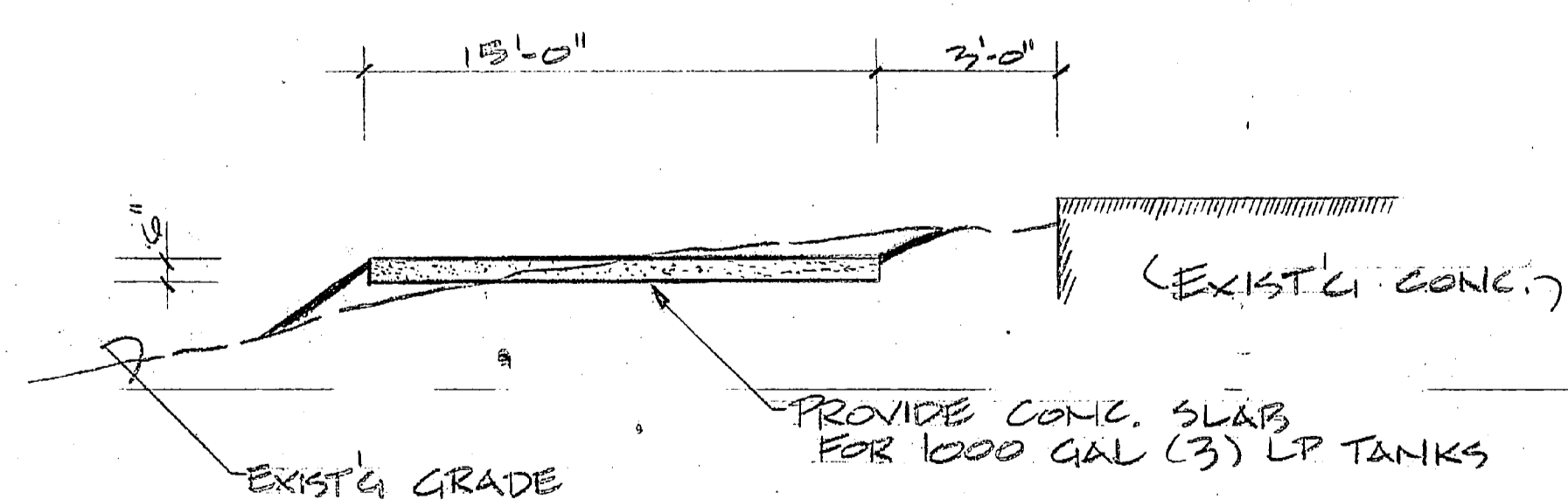

DETAIL (TYPICAL)
HPS

		E-1	
DEPARTMENT OF THE NAVY - NAVAL FACILITIES ENGINEERING COMMAND MARINE CORPS BASE CAMP LEJEUNE, NORTH CAROLINA			
DES. A. YOUNG	RECARBONATION SYSTEM, BLDG 20. ELECTRICAL PLAN		
DR. A. Y.			
CHK.			
SUBMITTED BY:			
DESIGN DIR.	APPROVER: PWD OR OICC	DATE	SIZE
SATISFACTORY TO:	DATE	F	80091
		NAVAC DRAWING NO.	CONSTR. CONTR. NO. N62470-04-B-7836
		SCALE: GRAPHIC	SPEC: 05-84-7886 SHEET OF

NEW
RECARB.
SYST.

TO Mr.
FRANK

NO.	DESCRIPTION	QTY	UNIT PRICE	TOTAL
1				
2				
3				
4				
5				
6				
7				
8				
9				
10				
11				
12				
13				
14				
15				
16				
17				
18				
19				
20				
21				
22				
23				
24				
25				
26				
27				
28				
29				
30				
31				
32				
33				
34				
35				
36				
37				
38				
39				
40				
41				
42				
43				
44				
45				
46				
47				
48				
49				
50				
51				
52				
53				
54				
55				
56				
57				
58				
59				
60				
61				
62				
63				
64				
65				
66				
67				
68				
69				
70				
71				
72				
73				
74				
75				
76				
77				
78				
79				
80				
81				
82				
83				
84				
85				
86				
87				
88				
89				
90				
91				
92				
93				
94				
95				
96				
97				
98				
99				
100				