

REVISIONS			
SYM	DESCRIPTION	DATE	APPROVED

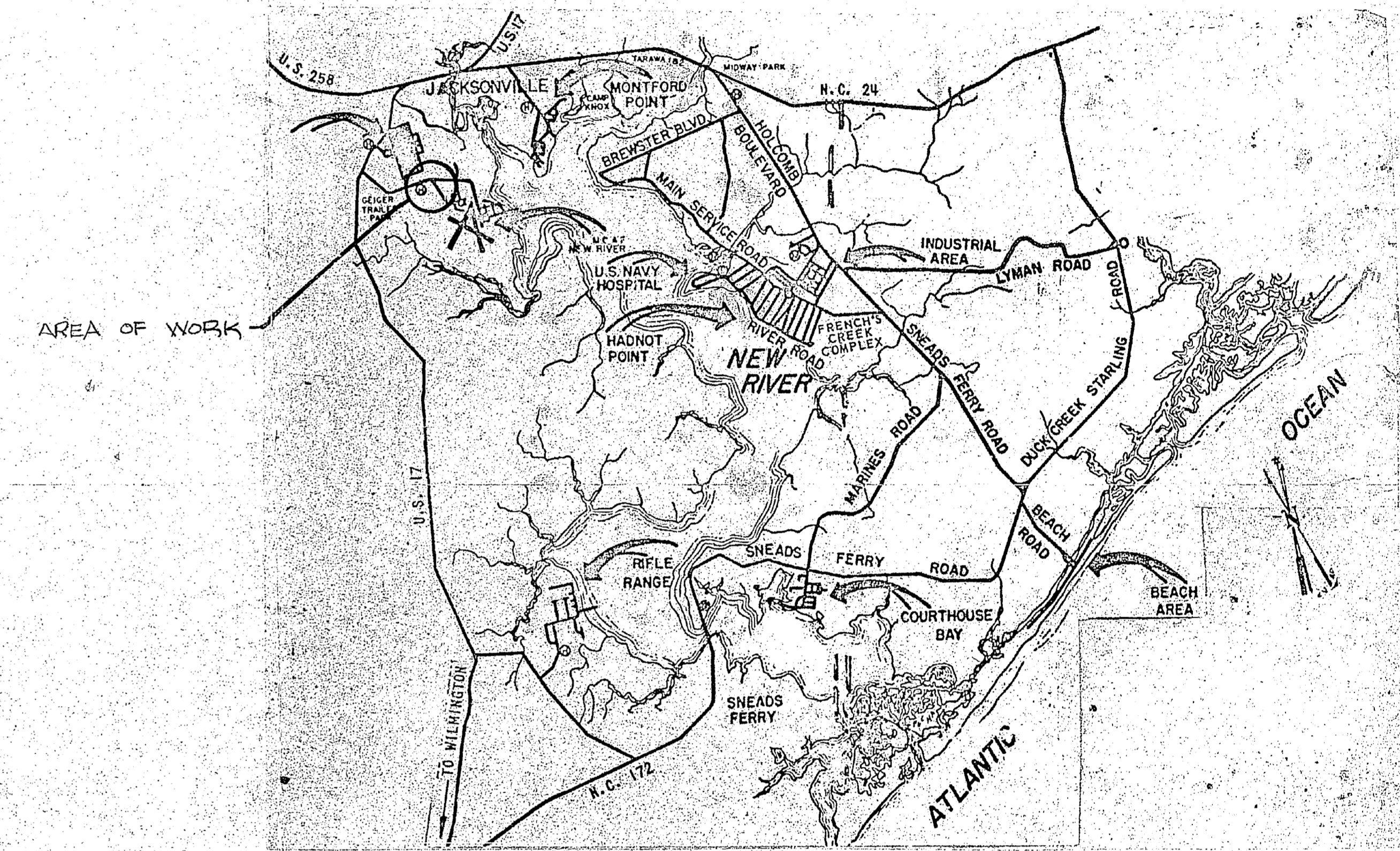

BASE VICINITY MAP

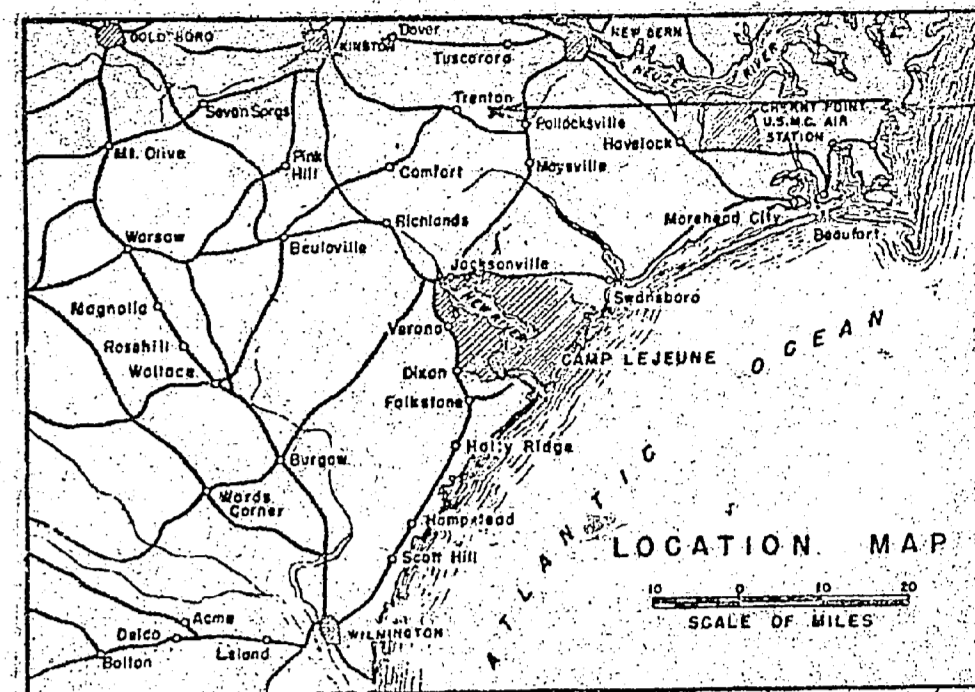
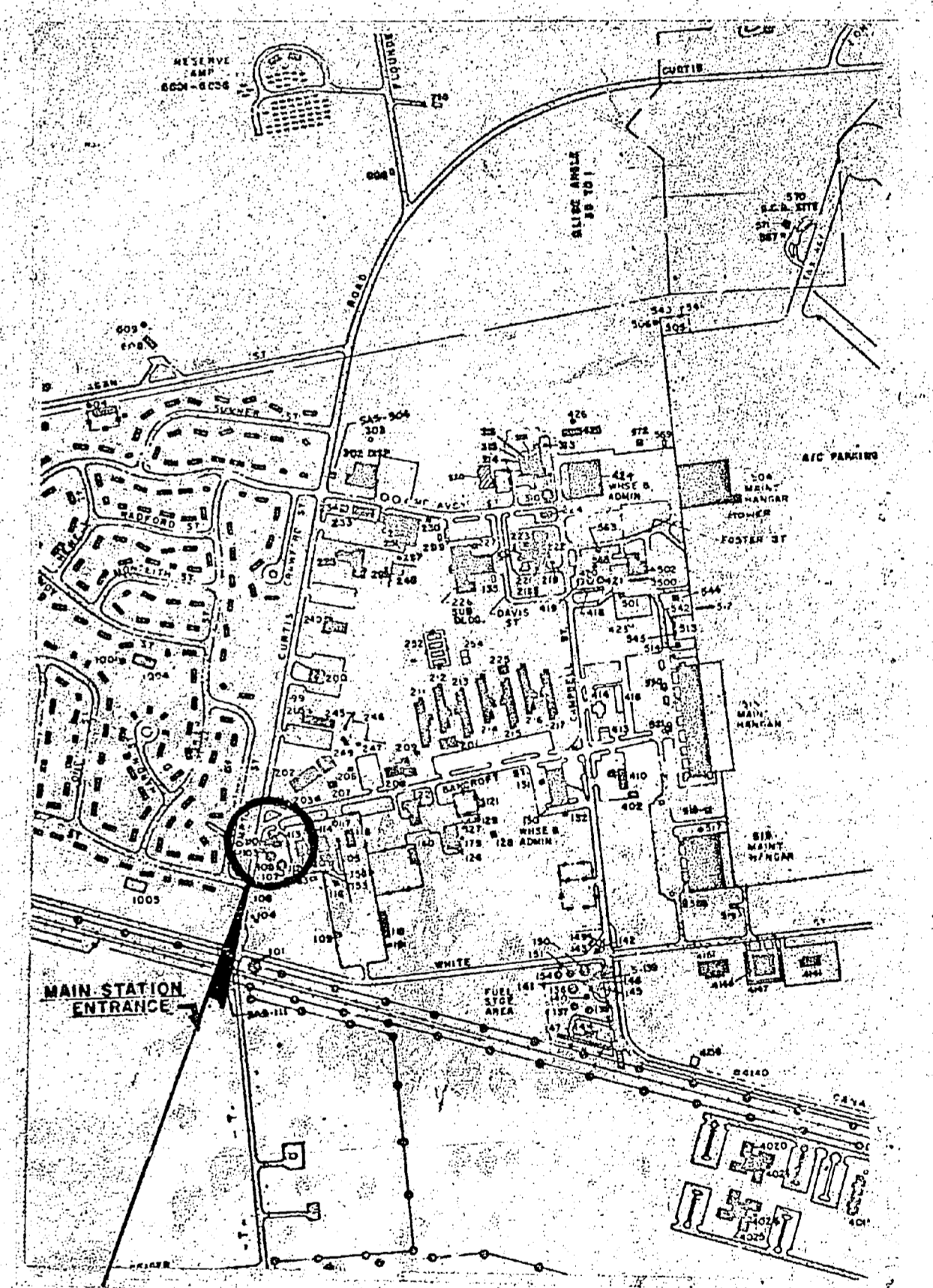

SITE LOCATION

C I

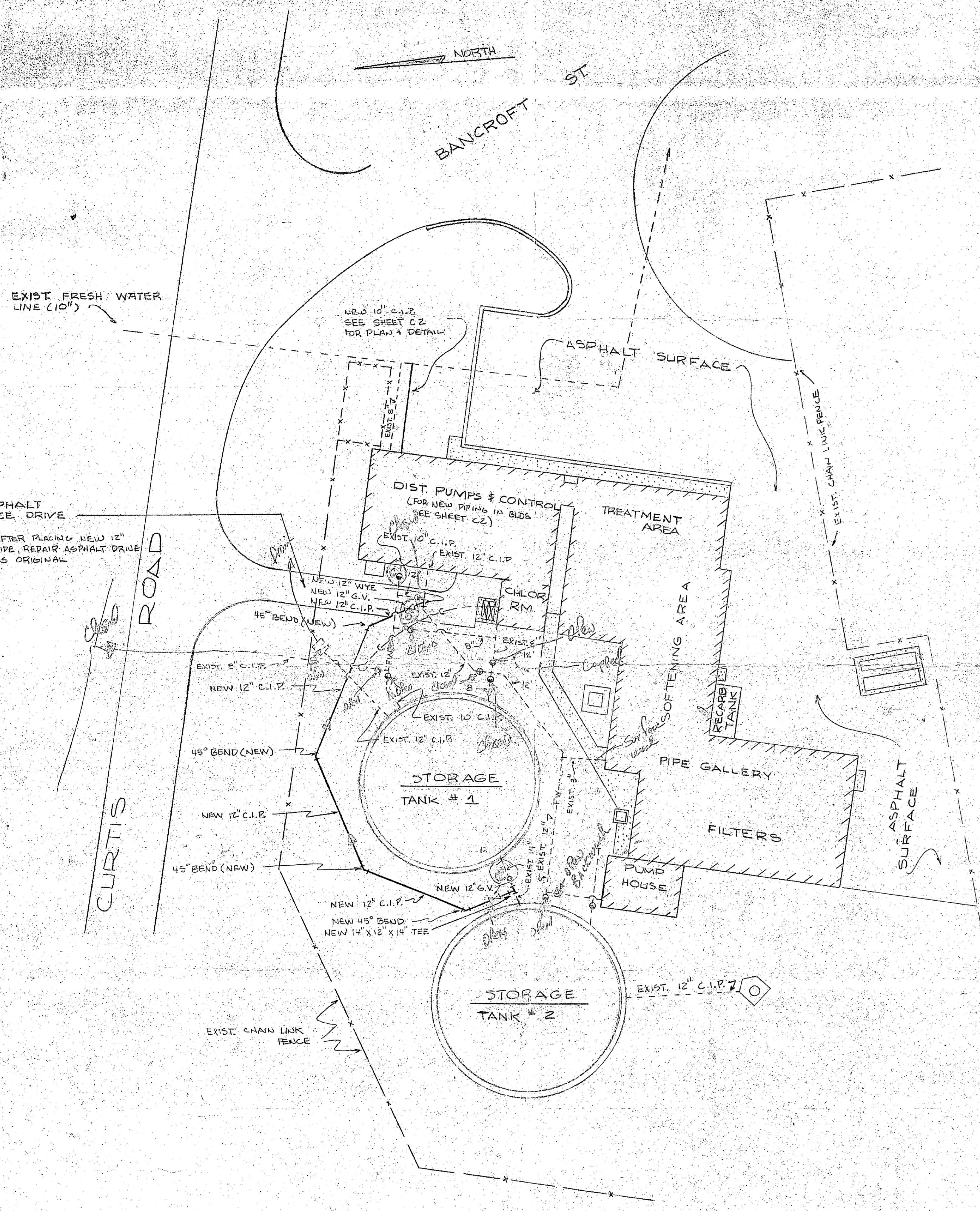

SITE PLAN  
SCALE: 1" = 20'

- LEGEND (FOR SHEET 1 ONLY)**
- - - - - EXISTING WATER LINES
  - — — — NEW WATER LINE
  - — — — EXISTING GATE VALVE
  - — — — NEW GATE VALVE (G.V.)
  - — — — EXISTING CONCRETE WALKS & PADS
  - — — — EXISTING MANHOLE
  - x — — EXISTING CHAIN LINK FENCE
  - ▨ — — — EXISTING BUILDING
  - - - - - EXISTING CHLORINE HOSE

- NOTES**
- 1) CONTRACTOR SHALL LOCATE ALL EXISTING WATER LINES PRIOR TO LAYING OF NEW PIPE
  - 2) FITTINGS SHOWN ARE FOR BIDDING PURPOSES ONLY. ACTUAL FITTINGS MAY HAVE TO BE MODIFIED SUBJECT TO FIELD CONDITIONS.
  - 3) ALL UNDERGROUND VALVES SHALL BE EQUIPPED WITH VALVE BOXES & COPS EXTENDING FROM WATER MAIN TO TOP OF GROUND.
  - 4) ALL BENDS IN WATER MAINS SHALL BE EQUIPPED WITH THURSTY BLOCKS. (SEE THURSTY BLOCK DETAIL - SHEET 2)

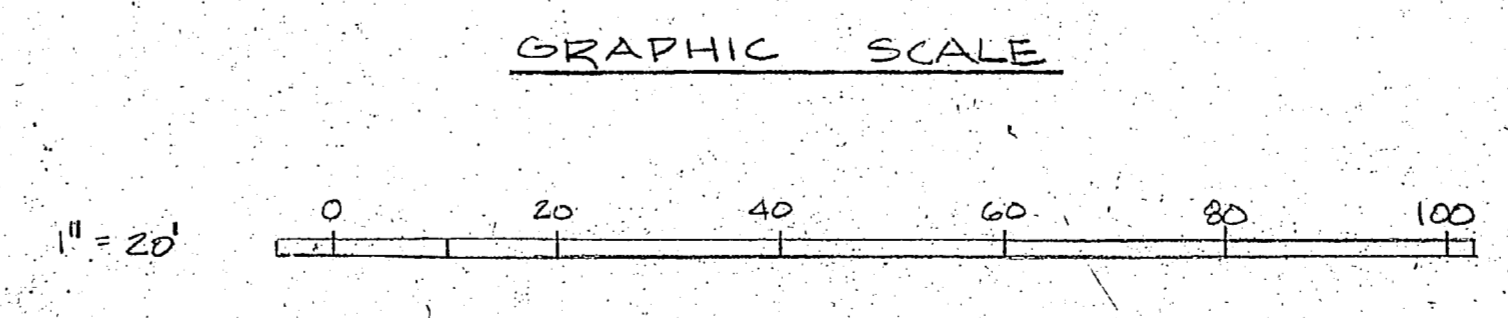

SATISFACTORY TO  
DATE

PUBLIC WORKS DEPT. MARINE CORPS BASE CAMP LEJUNE, N.C.		DEPARTMENT OF THE NAVY NAVAL FACILITIES ENGINEERING COMMAND ATLANTIC DIVISION NORFOLK, VIRGINIA	
DES: DRGJ	DRGJ	MARINE CORPS BASE, CAMP LEJUNE, N.C.	
REPLACE WATER PIPING AS - 110		SIZE: F	CODE IDENT NO: 80091
NAVAL FACILITIES ENGINEERING COMMAND		NAVFAC DRAWING NO: 4068671	
CONSTRUCTION CONTRACT NO: N62470-81-B-3663		SCALE: 1" = 20'	
DATE: 07/28/81		SHEET 1 OF 2	

