

SEE P.W. DRAWING NO. 14405

Scale is Approximate Only - Not to be used for Firing  
SCALE OF FEET  
0 2000 4000 6000 8000 10000

REVISIONS			
SYM	DESCRIPTION	DATE	APPROVED
1	REVISED TO REFLECT RY-86 THRU RY-90 FIVE YEAR NCON PROGRAM	7-88	EGC

PUBLIC WORKS DEPT. MARINE CORPS BASE CAMP LEJUNE, N.C.		DEPARTMENT OF THE NAVY NAVAL FACILITIES ENGINEERING COMMAND ATLANTIC DIVISION NORFOLK, VIRGINIA	
DES: DR: CHK: EGV	MARINE CORPS BASE - CAMP LEJUNE, N.C.		
PROGRAM: EGV	CH ENG: CRESSMAN	GENERAL DEVELOPMENT MAP REGIONAL & VICINITY	
APPROVED: [Signature]	DATE: 7/88	SIZE: F	CODE IDENT NO: 80091
PUBLIC WORKS OFFICER FOR THE C.G. SATISFACTORY TO: DATE:		DRAWING NO: 14393	CONSTR. CONTR NO:
COMMANDED GENERAL: EFD	RVD	SHEET 1 of 17	
NO: DIR: DATE:	SCALE: 1/5000	SPEC:	LANTDIV DWG NO:

SEE P.W. DRAWING NO. 14409

SEE P.W. DRAWING NO. 14404

SEE P.W. DRAWING NO. 14397

SEE P.W. DRAWING NO. 14396

SEE P.W. DRAWING NO. 14402

SEE P.W. DRAWING NO. 14400

SEE P.W. DRAWING NO. 14398

SEE P.W. DRAWING NO. 14394

SEE P.W. DRAWING NO. 14401

SEE P.W. DRAWING NO. 14394

SEE P.W. DRAWING NO. 14395

SEE P.W. DRAWING NO. 14393

SEE P.W. DRAWING NO. 14406

SEE P.W. DRAWING NO. 14407

SEE P.W. DRAWING NO. 14408

SEE P.W. DRAWING NO. 14403

SEE P.W. DRAWING NO. 14404













1 2 3 4 5



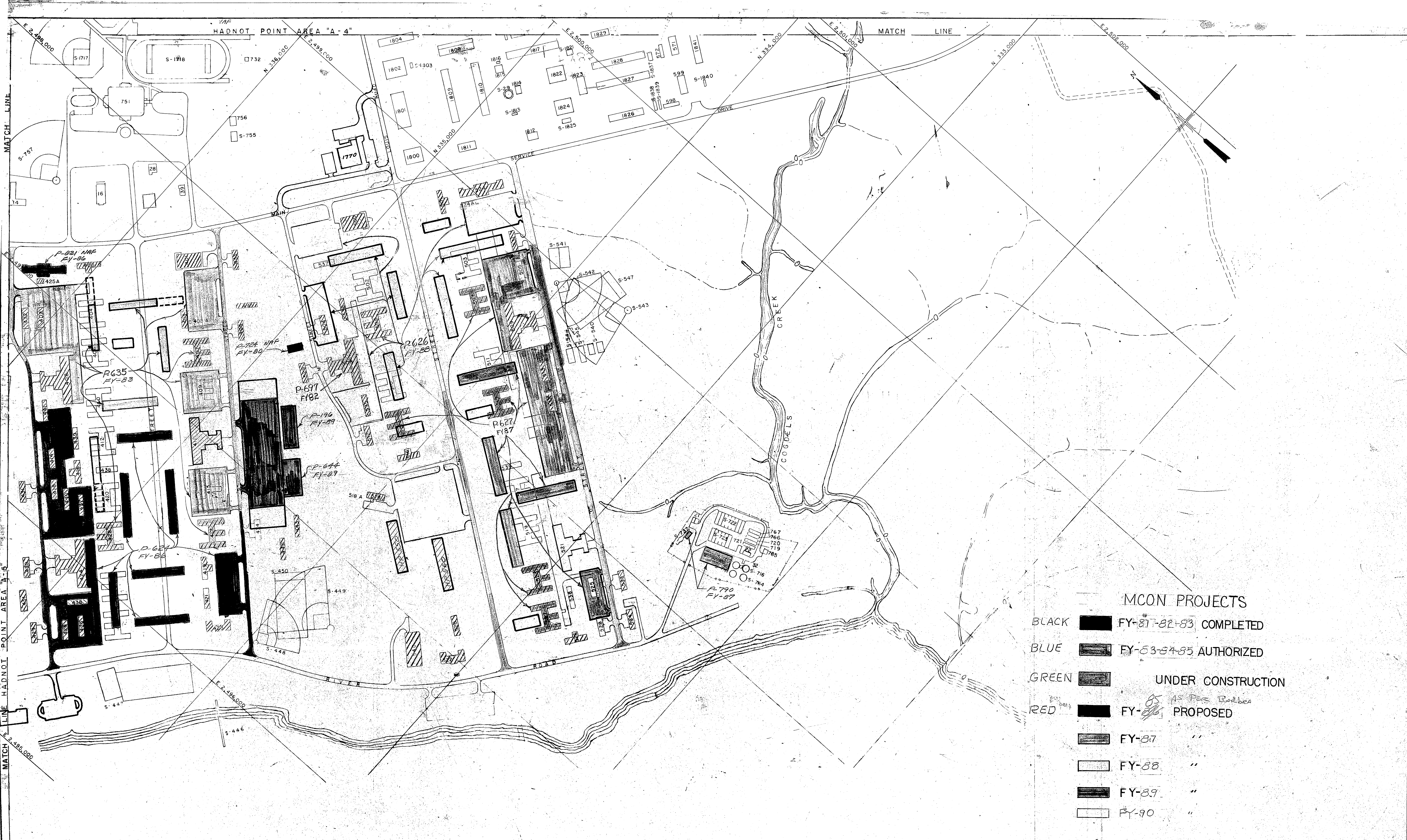

- MCON PROJECTS**
- BLACK ■ FY-81-82-83 COMPLETED
  - BLUE ■ FY-83-84-85 AUTHORIZED
  - GREEN ■ UNDER CONSTRUCTION
  - RED ■ FY-86 AS PER BARBER PROPOSED
  - FY-87 "
  - FY-88 "
  - FY-89 "
  - FY-90 "

N E W R I V E R

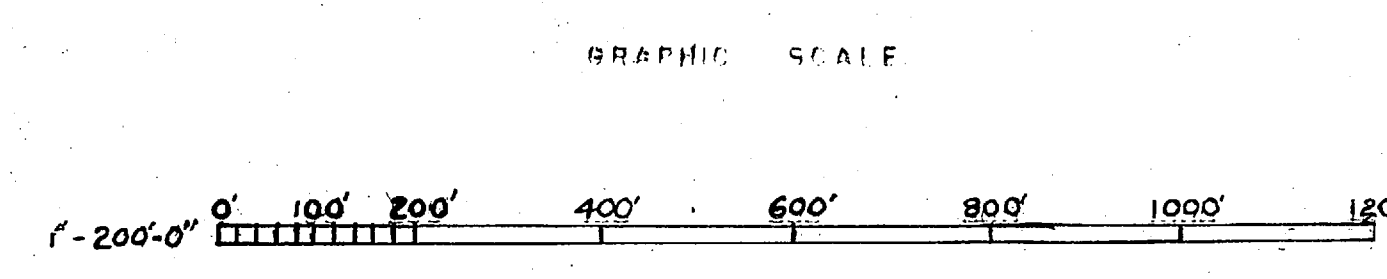

REVISIONS		
SYM	DESCRIPTION	DATE APPROVED
	REVISED TO REFLECT FY-86 THRU FY-90 FIVE-YEAR MCON PROGRAM	7-8-83 EJM

PUBLIC WORKS DEPT. MARINE CORPS BASE CAMP LEJEUNE, N.C.		DEPARTMENT OF THE NAVY NAVAL FACILITIES ENGINEERING COMMAND ATLANTIC DIVISION NORFOLK, VIRGINIA	
MARINE CORPS BASE, CAMP LEJEUNE, N.C.		HADNOT POINT AREA 2ND DIVISION 400 B 500 AREA	
GENERAL DEVELOPMENT MAP		14395	
DESIGNER	CHKD BY	DATE	SCALE
APPROVED	DATE	DATE	CONSTR CONTR NO
FOR COMMANDER, NAVFAC		SCALE 1"=200'	SPEC SHEET 3 OF 17



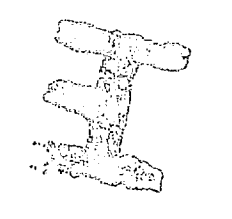
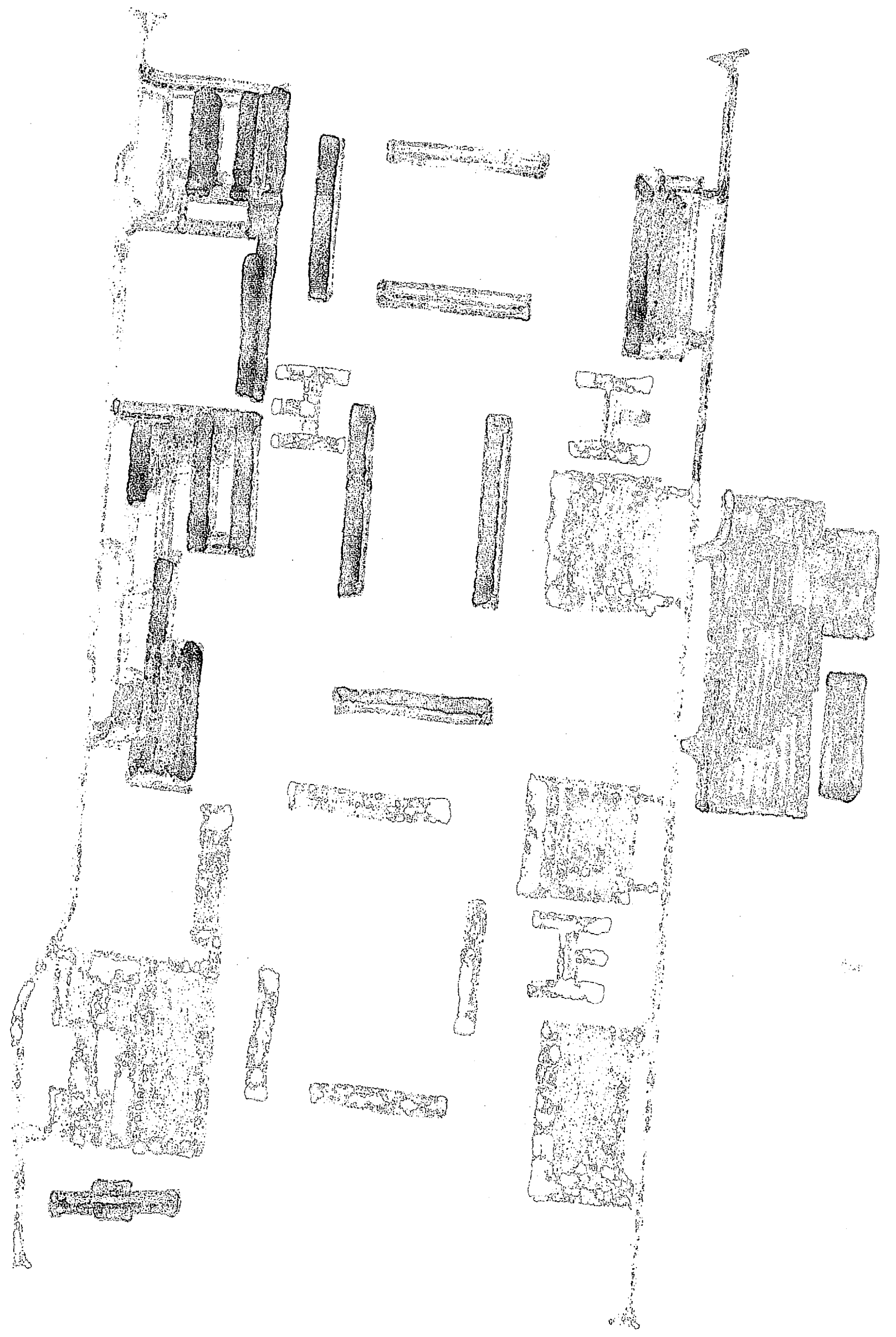







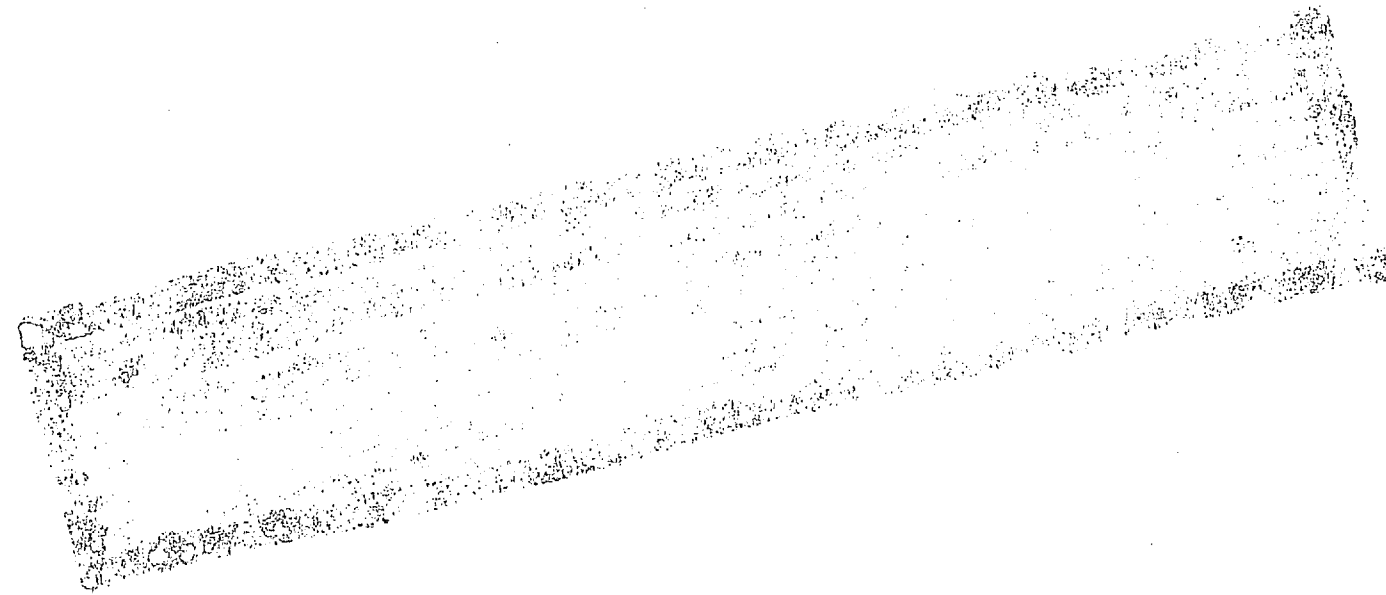
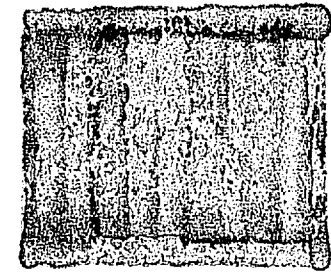
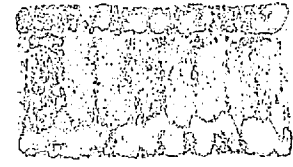
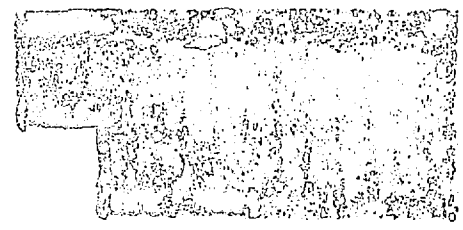



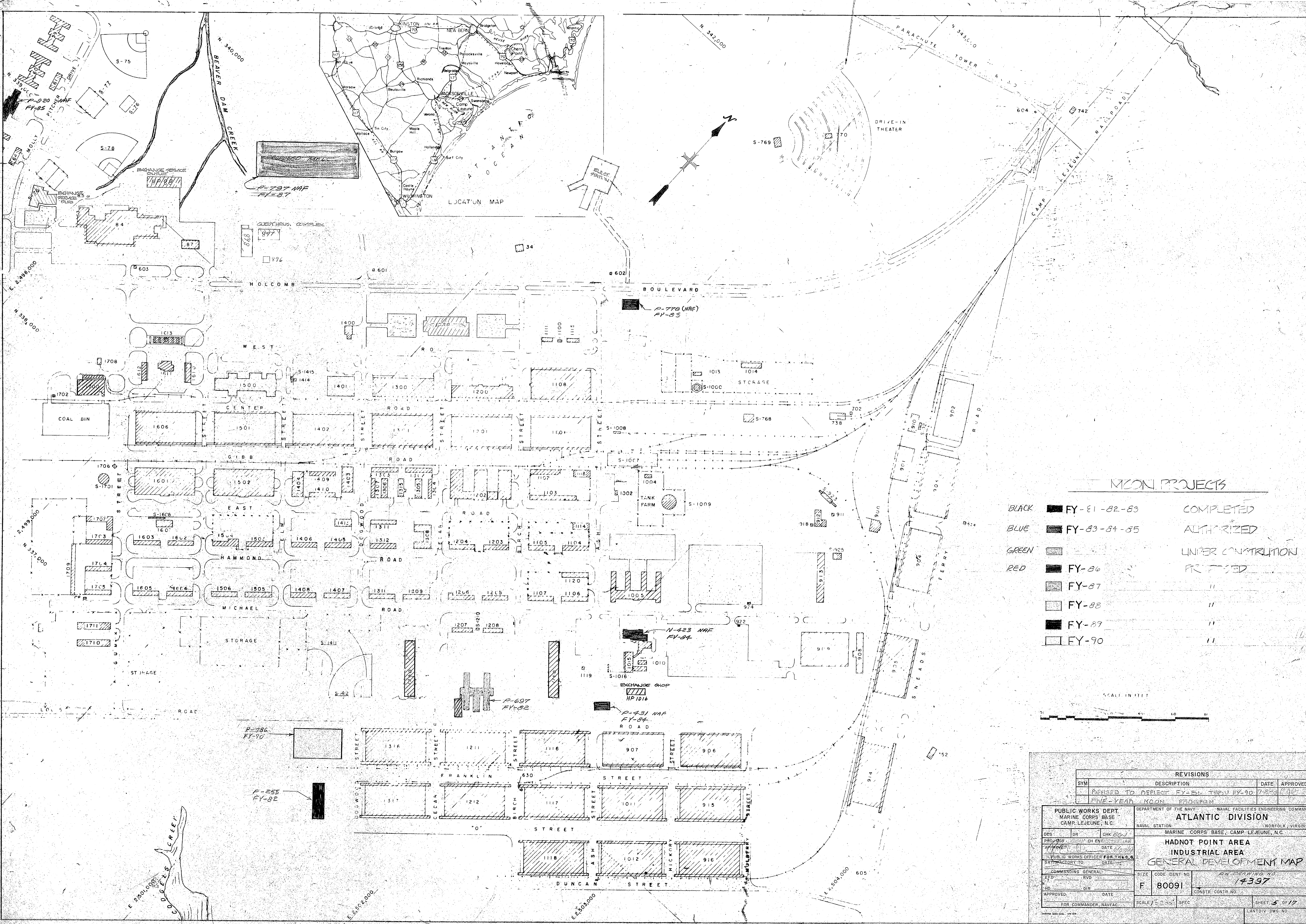

**MOON PROJECTS**

BLACK	FY-81-82-83	COMPLETED
BLUE	FY-83-84-85	AUTHORIZED
GREEN		UNDER CONSTRUCTION
RED	FY-86	PROMISED
	FY-87	"
	FY-88	"
	FY-89	"
	FY-90	"

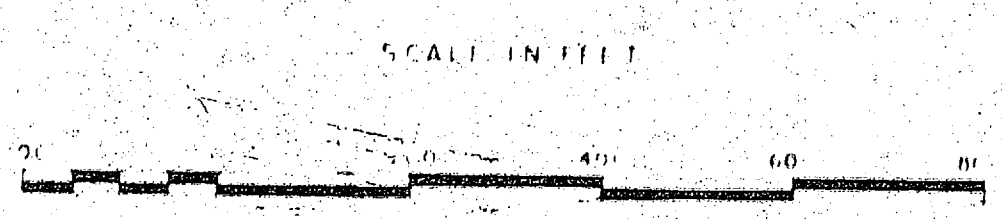

REVISIONS		DATE	APPROVED
SYM	DESCRIPTION		
	REVISED TO REFLECT FY-84 THROUGH FY-90	7-2-82	[Signature]
	FIVE-YEAR MOON PROGRAM		

PUBLIC WORKS DEPT. MARINE CORPS BASE CAMP LEJEUNE, N.C.		DEPARTMENT OF THE NAVY NAVAL FACILITIES ENGINEERING COMMAND ATLANTIC DIVISION NAVAL STATION NORFOLK, VIRGINIA	
DESIGNED BY: [Signature]		MARINE CORPS BASE, CAMP LEJEUNE, N.C.	
DRAWN BY: [Signature]		HADNOT POINT AREA INDUSTRIAL AREA GENERAL DEVELOPMENT MAP	
CHECKED BY: [Signature]		SIZE: F	CODE IDENT. NO.: 80091
DATE: [Date]		CONSTR. CONTR. NO.: 14397	
APPROVED BY: [Signature]		SCALE: 1" = 200'	SHEET: 5 OF 17
DATE: [Date]		LANTDIV DWG. NO.	



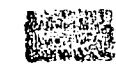
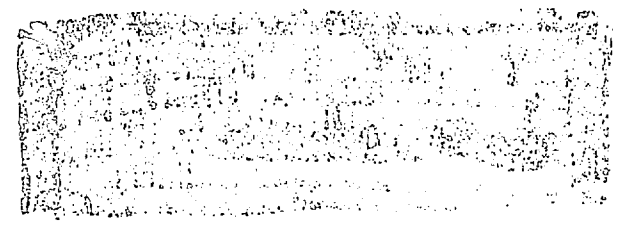



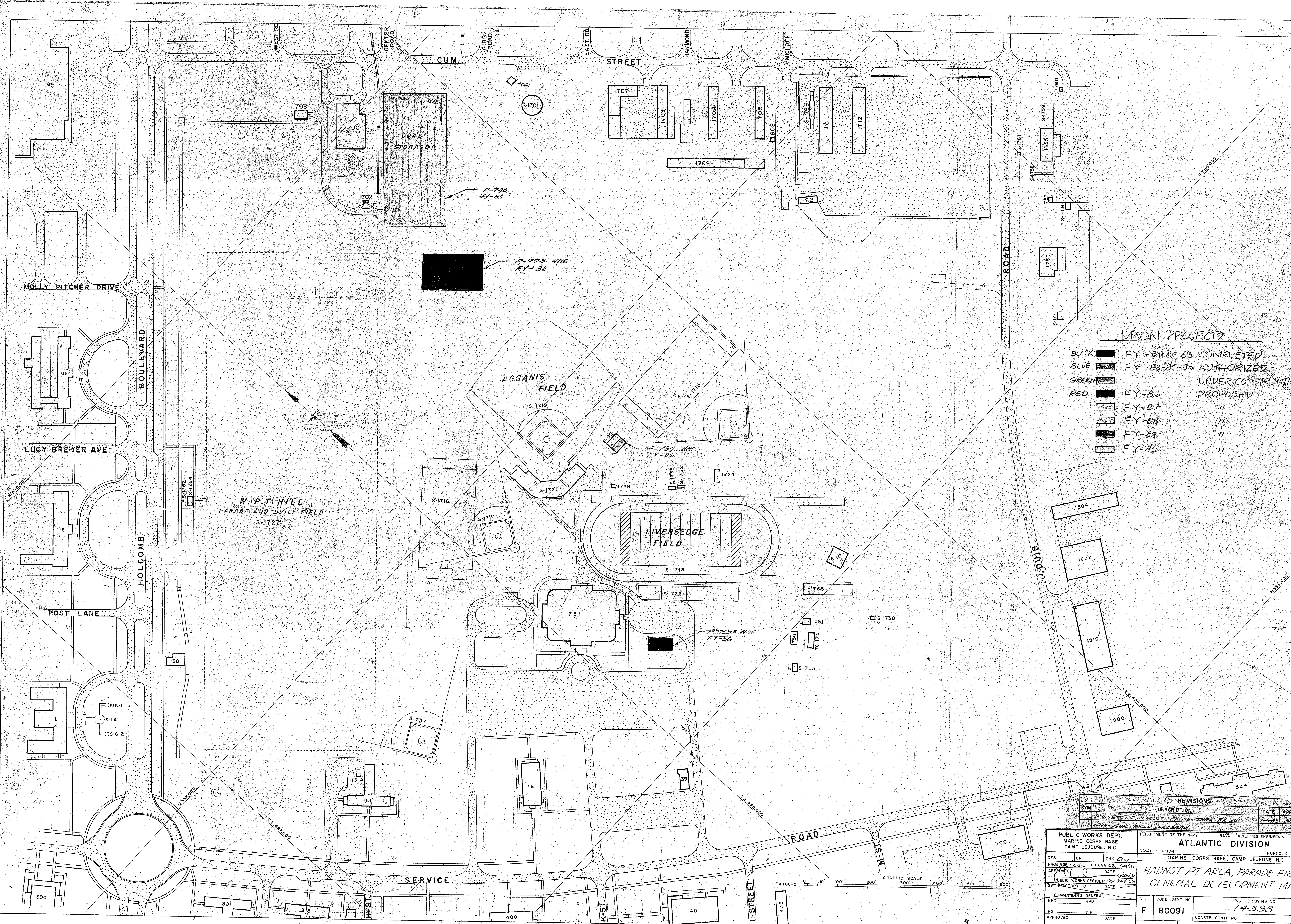

**MCON PROJECTS**

- BLACK [ ] FY-80-82-83 COMPLETED
- BLUE [ ] FY-83-84-85 AUTHORIZED
- GREEN [ ] UNDER CONSTRUCTION
- RED [ ] FY-86 PROPOSED
- [ ] FY-87 "
- [ ] FY-88 "
- [ ] FY-89 "
- [ ] FY-90 "

SYM	DESCRIPTION	DATE	APPROVE
	REVISION TO REPORT FY-86 THRU FY-90	7-9-83	EGJ
	FIVE-YEAR MCON PROGRAM		

**PUBLIC WORKS DEPT.**  
MARINE CORPS BASE  
CAMP LEJEUNE, N.C.

DEPARTMENT OF THE NAVY  
NAVAL FACILITIES ENGINEERING COMMND  
**ATLANTIC DIVISION**  
NORFOLK, VIRGINIA

NAVAL STATION  
MARINE CORPS BASE, CAMP LEJEUNE, N.C.

PROJ MGR: EGJ CH ENGR: CRESSMAN  
APPROVED: [Signature] DATE: 7-9-83  
PUBLIC WORKS OFFICER FOR THE CG: [Signature]  
SATISFACTORY TO: [Signature] DATE: [ ]

COMMANDING GENERAL: [ ]  
EFD: [ ] RVD: [ ]  
HD: [ ] DIR: [ ]  
APPROVED: [ ] DATE: [ ]

FOR COMMANDER, NAVFAC

SIZE: CODE IDENT NO: F 80091  
DRAWING NO: 14398  
CONSTR CONTR NO: [ ]

SCALE: GRAPHIC SPEC SHEET 6 OF 17

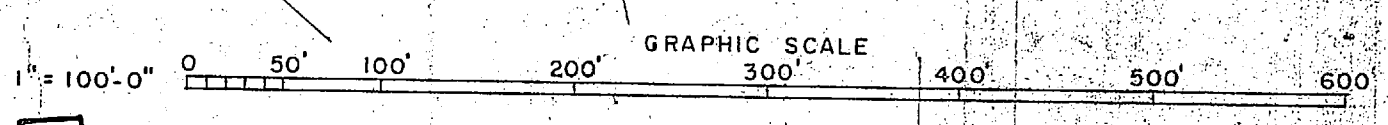



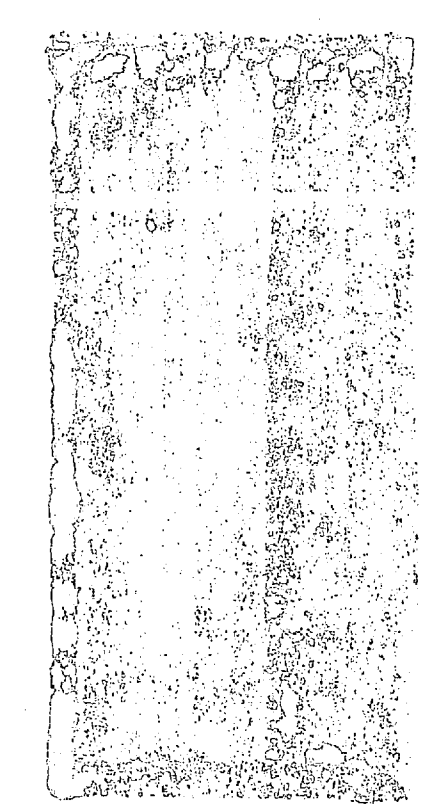
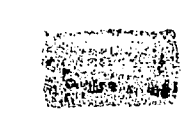



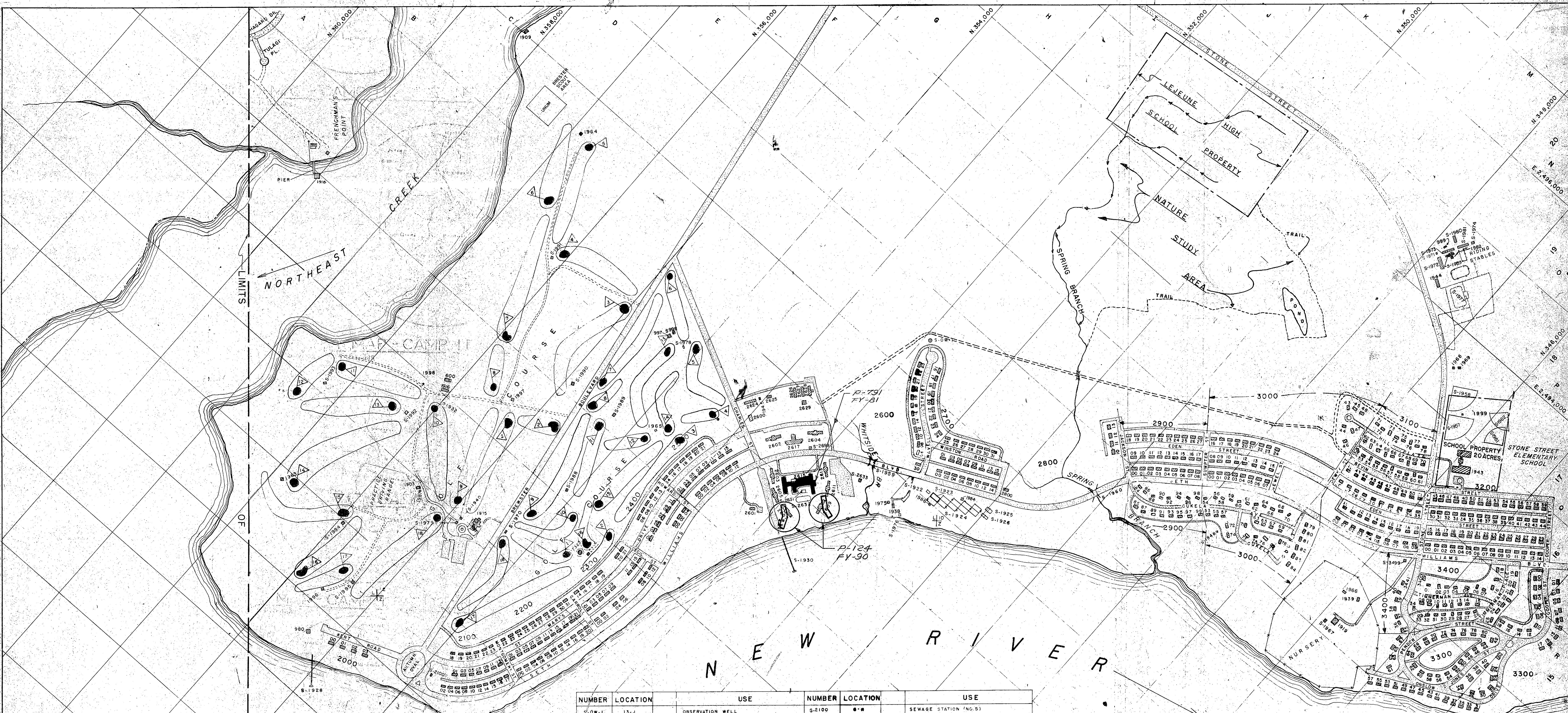

NUMBER	LOCATION	USE
S-1988	9-G	SHELTER
S-1989	10-G	"
S-1990	10-G	"
S-1991	8-F	"
S-1992	11-F	"
S-1993	8-F	"
S-1994	8-F	"
S-1995	6-F	"
S-1996	7-F	"
S-1997	7-F	"
S-1998	8-E	CONCESSION STAND - MCX GOLF COURSE
S-1999	17-O	STORAGE
S-2000	15-P	BUS STOP SHELTER

NUMBER	LOCATION	USE	NUMBER	LOCATION	USE
S-0W-1	13-J	OBSERVATION WELL	S-2100	8-M	SEWAGE STATION (NO. 5)
1000	7-G	GOLF COURSE CLUBHOUSE	S-2322	8-H	PUMP HOUSE FOR DEEP WELL #
S-991	7-G	SHELTER	S-2323	8-M	200,000 GALL ELEVATED WATER TANK
1000	7-G	SHELTER	S-2699	11-I	BUS STOP SHELTER
1003	7-F	RANGE HOUSE, GOLF COURSE	2600	11-I	WIRE HOUSE/ KINDERGARTEN
4-904	6-E	SHELTER (GOLF COURSE)	2601	10-I	GUEST HOUSE
4-906	6-E	SHELTER	2602	11-I	BACHELOR OFFICERS' QUARTERS
1909	13-C	BOY SCOUT HUT (EXISTING BUILDING)	2603	10-I	OFFICERS' GUEST HOUSE
4-910	11-E	SHELTER (GOLF COURSE)	2604	11-I	BACHELOR OFFICERS' QUARTERS
4-911	10-G	SHELTER	2605	10-E	BACHELOR OFFICERS' QUARTERS
4-914	7-G	SHELTER	2607	10-J	BACHELOR OFFICERS' QUARTERS
1915	8-G	CLUB HOUSE-GOLF	2608	11-J	BACHELOR OFFICERS' QUARTERS
1916	9-E	STORAGE COV ORG/OTH	2611	11-J	BACHELOR OFFICERS' QUARTERS
1918	9-B	BOAT HOUSE	2613	11-J	BACHELOR OFFICERS' QUARTERS
1919	14-P	PW/MAINT SHOP	2615	11-J	OFFICERS' CLUB (OPEN)
1920	10-A	STORAGE-OUTDRG	2617	11-I	BACHELOR OFFICERS' QUARTERS
1921	15-N	MAINTENANCE BUILDING	2624	11-M	DEPT SCH/NRSY
S-1922	12-K	BADMINTON COURT	2625	11-I	RECREATION BUILDING
S-1923	12-K	TENNIS COURT	2627	11-B	P W MNT SHOP
S-1924	12-K	TENNIS COURTS	2628	12-I	RETAIL WAREHOUSE
S-1925	12-L	VOLLEY BALL COURT	2629	11-E	ST CO, ORG/OTH
S-1926	12-L	HANDBALL COURTS	S-2631	11-J	WADING POOL
4-927	13-N	SAW SHED	S-2632	10-J	SWIMMING POOL OUTDR
S-1928	9-J	PIER	S-2633	11-J	SEWAGE PUMPING STATION (NO. 4)
S-1929	5-H	PIER	S-2634	11-J	OUTDOOR THEATER
S-1930	10-J	PIER	2635	11-J	PROJECTION ROOM
1931	14-P	STORAGE-COV ORG/OTH	S-2636	14-A	FOODING-POWER
1932	8-F	OFFICE	ALL QUARTERS IN BLOCKS 2600, 2100, 2200, 2300, 2400, 2500, 2600, 2700, 2800, 2900, 3000, 3100, 3200, 3300, 3400 ARE MARRIED OFFICERS' QUARTERS EXCEPT AS OTHERWISE SHOWN OR NOTED.		
4-934	6-F	SHELTER (GOLF COURSE)	S-1971	18-N	FEED HOPPER
4-936	8-E	SHELTER	S-1972	18-N	RIDING STABLES (SPEC SERV)
4-938	9-G	SHELTER	S-1973	18-N	" (RENTAL)
4-939	9-G	SHELTER	S-1974	18-N	" (ISOLATION)
4-941	10-E	SHELTER	CG-043	18-N	DUFF/PER-SHELTER (FRANKS)
1938	11-K	REC BUILDING	1975	11-K	STORAGE BLDG
1939	14-P	STORAGE COV ORG/OTH	S-1976	11-K	COVERED PATIO
1940	7-G	STARTER SHED (GOLF COURSE)	S-1977	18-N	ROOF CORRAL
1941	10-B	STORAGE-COV ORG/OTH	CG-061	18-M	STORAGE (FRANKS)
1942	10-B	BARBACUE	S-1978	11-G	CONCESSION STAND
1943	10-P	DEPT SCH/GRADE	S-1979	7-G	PATIO
1944	18-N	STORAGE COV ORG/OTH	S-1980	18-N	STORAGE
1945	11-H	PER SUP FAC OTH	S-1981	18-N	STABLE
CG-062	18-N	SPRINKLER FIELD	1982	18-N	TOILET
S-1946	14-N	SEWAGE LIFT STATION	S-1983	18-N	HITCHING SHELTER
S-1947	11-L	VEHICULAR BRIDGE	S-1984	18-M	TOILET
S-1948	11-L	VEHICULAR BRIDGE	1985	11-K	STORAGE
S-1949	11-L	SUBBALL FIELD	1986	11-K	RECREATION BLDG.
S-1950	11-L	SUBBALL FIELD	1987	7-F	STORAGE
S-1951	11-P	TOILET	999	18-N	POW STABLE
S-1952	11-L	TOILET	S-990	11-G	STORAGE
S-1953	6-E	TOILET	S-991	11-G	STORAGE
S-1954	12-L	TOILET	S-992	11-G	STORAGE
S-1955	10-H	TOILET	S-993	11-G	STORAGE
S-1956	14-P	STORAGE COV ORG/OTH	S-994	11-G	STORAGE
S-1957	14-P	STORAGE COV ORG/OTH	S-995	11-G	STORAGE
S-1958	14-P	STORAGE COV ORG/OTH	S-996	11-G	STORAGE
S-1959	14-P	STORAGE COV ORG/OTH	S-997	11-G	STORAGE
S-1960	14-P	STORAGE COV ORG/OTH			
S-1961	14-P	STORAGE COV ORG/OTH			
S-1962	14-P	STORAGE COV ORG/OTH			
S-1963	14-P	STORAGE COV ORG/OTH			
S-1964	14-P	STORAGE COV ORG/OTH			
S-1965	14-P	STORAGE COV ORG/OTH			
S-1966	14-P	STORAGE COV ORG/OTH			
S-1967	14-P	STORAGE COV ORG/OTH			
S-1968	14-P	STORAGE COV ORG/OTH			
S-1969	14-P	STORAGE COV ORG/OTH			
S-1970	14-P	STORAGE COV ORG/OTH			

LEGEND

- BUILDINGS
- ASPHALT SURFACED
- SHELL ROCK SURFACED
- FENCE
- HELICOPTER/LANDING ZONE

MCON PROJECTS

BLACK	FY-81-82-83 COMPLETED
BLUE	FY-83-84-85 AUTHORIZED
GREEN	UNDER CONSTRUCTION
RED	PROPOSED
WHITE	FY-87
WHITE	FY-88
WHITE	FY-89
WHITE	FY-90

REVISIONS

SYM	DESCRIPTION	DATE	APPROVED
REVISED	TO REFLECT FY-86 THRU FY-90	10/83	EM
FIVE YEAR MCON PROGRAM			

PUBLIC WORKS DEPT.  
MARINE CORPS BASE  
CAMP LEJEUNE, N.C.

DEPARTMENT OF THE NAVY  
NAVAL FACILITIES ENGINEERING COMMAND  
ATLANTIC DIVISION  
NORFOLK, VIRGINIA

NAVAL STATION  
MARINE CORPS BASE, CAMP LEJEUNE, N.C.

PARADISE POINT AREA  
GENERAL DEVELOPMENT MAP

SIZE CODE IDENT NO  
F 80091

DRAWING NO  
14399

CONSTR CONTR NO

SCALE 1" = 500'

SHEET 7 OF 17



11

11



REVISIONS			
SYM	DESCRIPTION	DATE	APPROVED

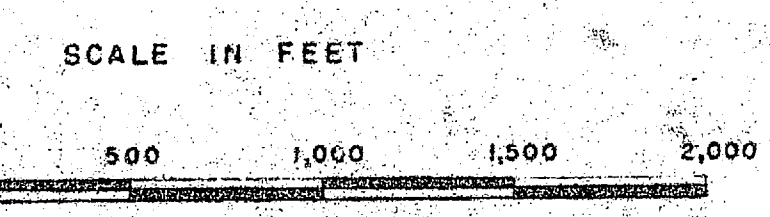
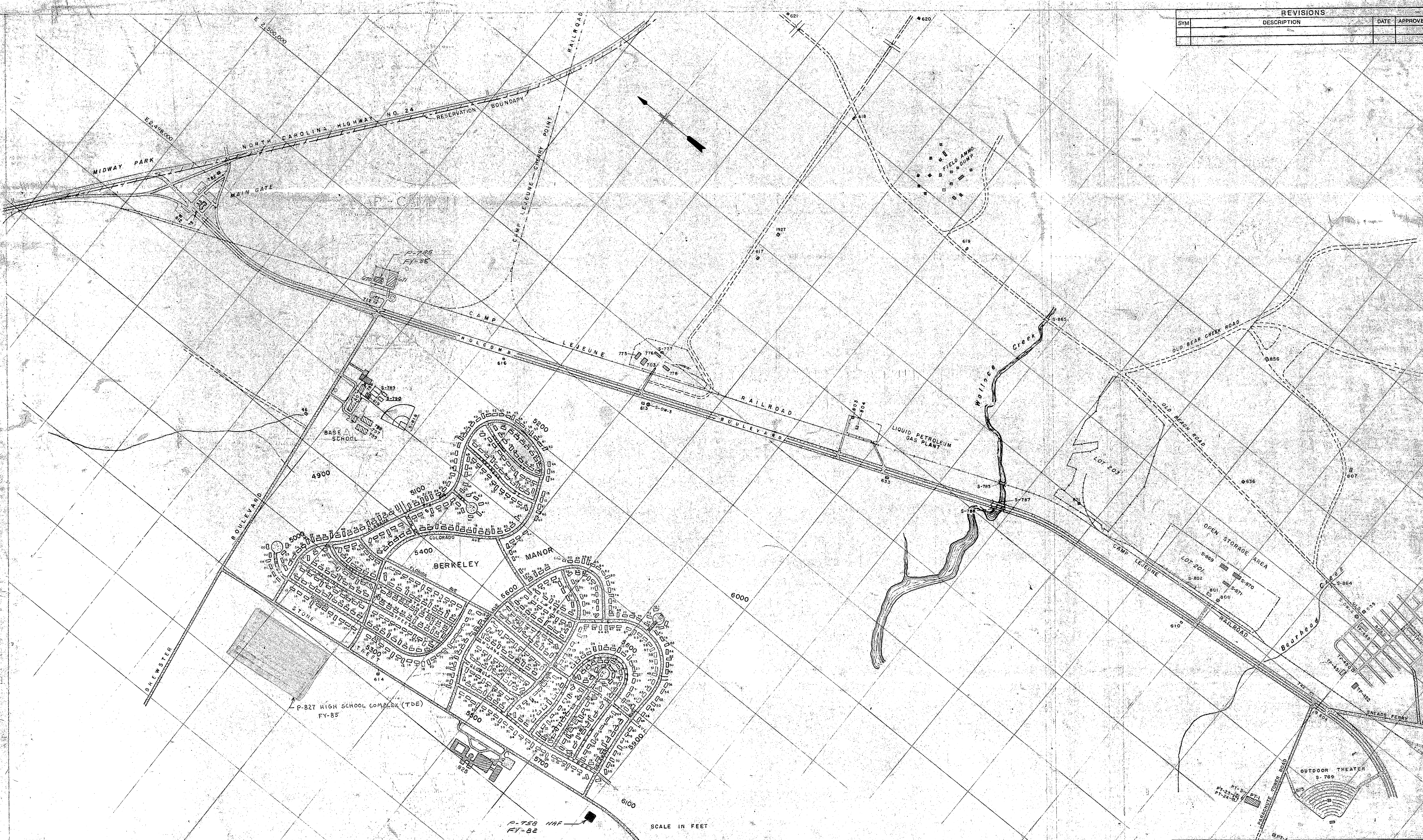

**MCON PROJECTS**

- BLACK ■ FY-81-82-83 COMPLETED
- BLUE ■ FY-83-84-85 AUTHORIZED
- GREEN ■ UNDER CONSTRUCTION
- RED ■ FY-86 PROPOSED
- FY-87 //
- FY-88 //
- FY-89 //
- FY-90 //

REVISIONS			
SYM	DESCRIPTION	DATE	APPROVED
	REVISED TO REFLECT FY-86 THRU FY-90	7-8-83	
	FIVE-YEAR MCON PROGRAM		

PUBLIC WORKS DEPT. MARINE CORPS BASE CAMP LEJUNE, N.C.		DEPARTMENT OF THE NAVY NAVAL FACILITIES ENGINEERING COMMAND ATLANTIC DIVISION	
DES. BY: <i>ESJ</i>	CHK. BY: <i>ESJ</i>	PROJECT NO. <i>EG-1</i>	
APPROVED BY: <i>ESJ</i>	DATE: <i>8/29/81</i>	PROJECT TITLE: <i>BERKELEY MANOR HSG AREA GENERAL DEVELOPMENT MAP</i>	
COMMISSIONING GENERAL	DATE	SCALE: <i>GRAPHIC</i>	SHEET NO. <i>14400</i>
APPROVED BY: <i>ESJ</i>	DATE	SCALE: <i>GRAPHIC</i>	SHEET NO. <i>14400</i>
SPECIAL INSTRUCTIONS		SHEET NO. <i>14400</i>	



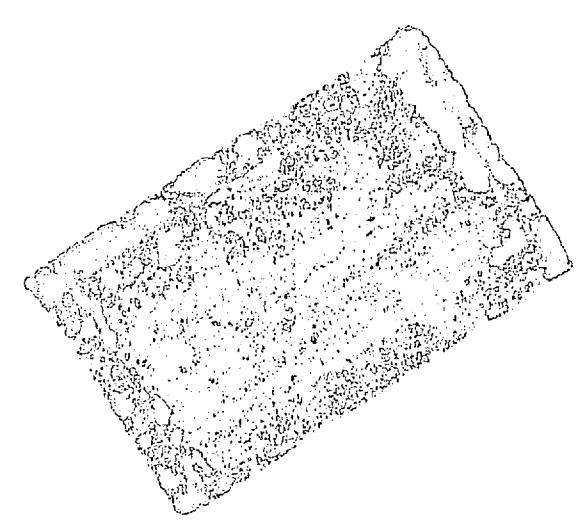

11  
12  
13



NUMBER	LOCAT.	USE	NUMBER	LOCAT.	USE
H-1	2-D	HOSPITAL	H-41	2-C	GARAGE
H-2	2-D	WARDS AND CLINIC	H-42	2-C	GARAGE
H-3	3-D	WARDS AND CLINIC	H-43	2-D	WARDS
H-4	3-D	ADMINISTRATION BLDG.	H-44	2-D	WARDS
H-5	3-D	WARDS	H-45	2-D	WARDS
H-6	2-D	WARDS	H-46	2-D	WARDS
H-7	2-D	WARDS	H-47	2-D	PERSONNEL AND RECORDS BLDG.
H-8	2-D	WARDS RED-CROSS	H-48	4-C	ANIMAL HOUSE
H-9	3-D	WARDS	H-49	4-C	MEDICAL OFFICERS' QUARTERS
H-10	3-C	MESS HALL AND RECREATION BLDG.	H-50	5-C	MEDICAL OFFICERS' QUARTERS
H-11	3-D	WARDS	H-51	5-C	MEDICAL OFFICERS' QUARTERS
H-12	3-D	WARDS	H-52	5-C	MEDICAL OFFICERS' QUARTERS
H-13	2-D	WARDS	H-53	5-C	MEDICAL OFFICERS' QUARTERS
H-14	4-D	BACHELOR OFFICERS QUARTERS	H-54	5-C	MEDICAL OFFICERS' QUARTERS
H-15	4-C	FAMILY HOSPITAL	H-55	5-C	MEDICAL OFFICERS' QUARTERS
H-16	4-C	WAVE ENLISTED HOOP CORPS BKS.	H-56	5-C	MEDICAL OFFICERS' QUARTERS
H-17	3-C	MEDICAL WAREHOUSE	H-57	5-C	MEDICAL OFFICERS' QUARTERS
H-18	3-C	GARAGE	H-58	5-C	MEDICAL OFFICERS' QUARTERS
H-19	2-C	SHOPS	H-59	5-C	MEDICAL OFFICERS' QUARTERS
H-20	4-C	POWER PLANT	H-60	5-C	MEDICAL OFFICERS' QUARTERS
H-21	4-C	LAUNDRY	H-61	5-C	MEDICAL OFFICERS' QUARTERS
H-22	4-C	WAREHOUSE	H-62	5-C	MEDICAL OFFICERS' QUARTERS
H-23	3-C	CORPSMENS' BARRACKS	H-63	5-C	MEDICAL OFFICERS' QUARTERS
H-24	3-C	CORPSMENS' BARRACKS	H-65	5-C	MEDICAL OFFICERS' QUARTERS
H-25	2-C	MEDICAL OFFICERS' QUARTERS	H-66	5-C	MEDICAL OFFICERS' QUARTERS
H-26	2-C	MEDICAL OFFICERS' QUARTERS	H-67	5-C	MEDICAL OFFICERS' QUARTERS
H-27	2-C	MEDICAL OFFICERS' QUARTERS	H-68	4-C	MEDICAL OFFICERS' QUARTERS
H-28	4-C	MEDICAL OFFICERS' QUARTERS	H-69	4-C	MEDICAL OFFICERS' QUARTERS
H-29	4-D	SEWAGE PUMPING STATION NO.2	H-70	5-C	TRANSFORMER HOUSE
H-30	5-C	INDY HOUSEKEEPING QUARTERS	S-H-72	4-D	BASKETBALL COURTS
H-31	5-C	INDY HOUSEKEEPING QUARTERS	S-H-73	4-C	TENNIS COURTS
H-32	5-D	BACHELOR OFFICERS QUARTERS	S-H-74	4-G	TENNIS COURTS
H-33	4-C	TRANSFORMER HOUSE 'B'	S-H-75	3-C	TENNIS COURTS
H-34	4-C	TRANSFORMER HOUSE 'E'	H-76	4-C	PAINT & INFLAMMABLE STORAGE BLDG.
H-35	2-C	TRANSFORMER HOUSE 'D'	H-77	4-C	GENERATOR HOUSE
H-36	3-C	GARAGE	H-78	4-C	PATHOLOGICAL WASTE INCINER. BLDG.
H-37	3-C	WELL 'E'	H-79	5-C	BULK OXYGEN STORAGE SHED
H-38	5-D	TRANSFORMER HOUSE	S-H-80	3-D	FLAGPOLE
H-39	3-C	NIGHT CORPSMENS' BARRACKS	S-H-81	1-D	PLAYING COURT
H-40	3-C	MEDICAL WAREHOUSE	H-82	5-D	PICNIC COOKOUT FACILITY
			H-83	2-C	STORAGE SHED
			H-84	3-C	GARDENERS STORAGE BUILDING
			S-H-85	3-D	HELICOPTER LANDING PAD (CONC.)

NUMBER	LOCAT.	USE
H-86	4-C	STORAGE
H-87	4-C	"
H-88	5-C	"
H-89	5-C	"
H-90	5-C	"
H-91	5-C	"
H-92	5-C	"
H-93	5-C	"
H-94	5-C	"
H-95	5-C	"
H-96	5-C	"
H-97	5-C	"
H-98	5-C	"
H-99	5-C	"
H-100	5-C	"
H-101	5-C	"
H-102	5-C	"
H-103	5-C	"
H-104	5-C	"
S-H-105	3-C	PLATFORM, OXYGEN FACILITY
H-106	3-D	HELICOPTER LANDING PAD LZ-2
H-107	5-D	ELECT. SWITCHING STA.
H-108	4-C	SUB-STATION
H-109	4-C	TRANSFORMER PAD
H-110	4-C	VEHICLE WASH RACK
H-111	3-C	BAR-B-QUE PIT
H-112	3-C	GREASE RACK
H-113	3-C	READY VEH STORAGE TANK
H-114	3-C	FILLING STATION
H-115	3-C	DUST COLLECTOR SYSTEM
H-116	3-D	TRANSFORMER PAD
H-117	1-D	PICNIC SHELTER
H-118	3-C	HEATING OIL TANK
H-119	3-C	"
H-120	3-C	GENERATOR OIL TANK
H-121	3-C	HEATING OIL TANK
H-122	1-D	WOMENS TOILET
H-123	1-D	MENS
H-124	5-C	HEATING OIL TANK
H-125	5-C	"
H-126	5-C	SIGN
H-127	1-D	TOILET FACILITIES

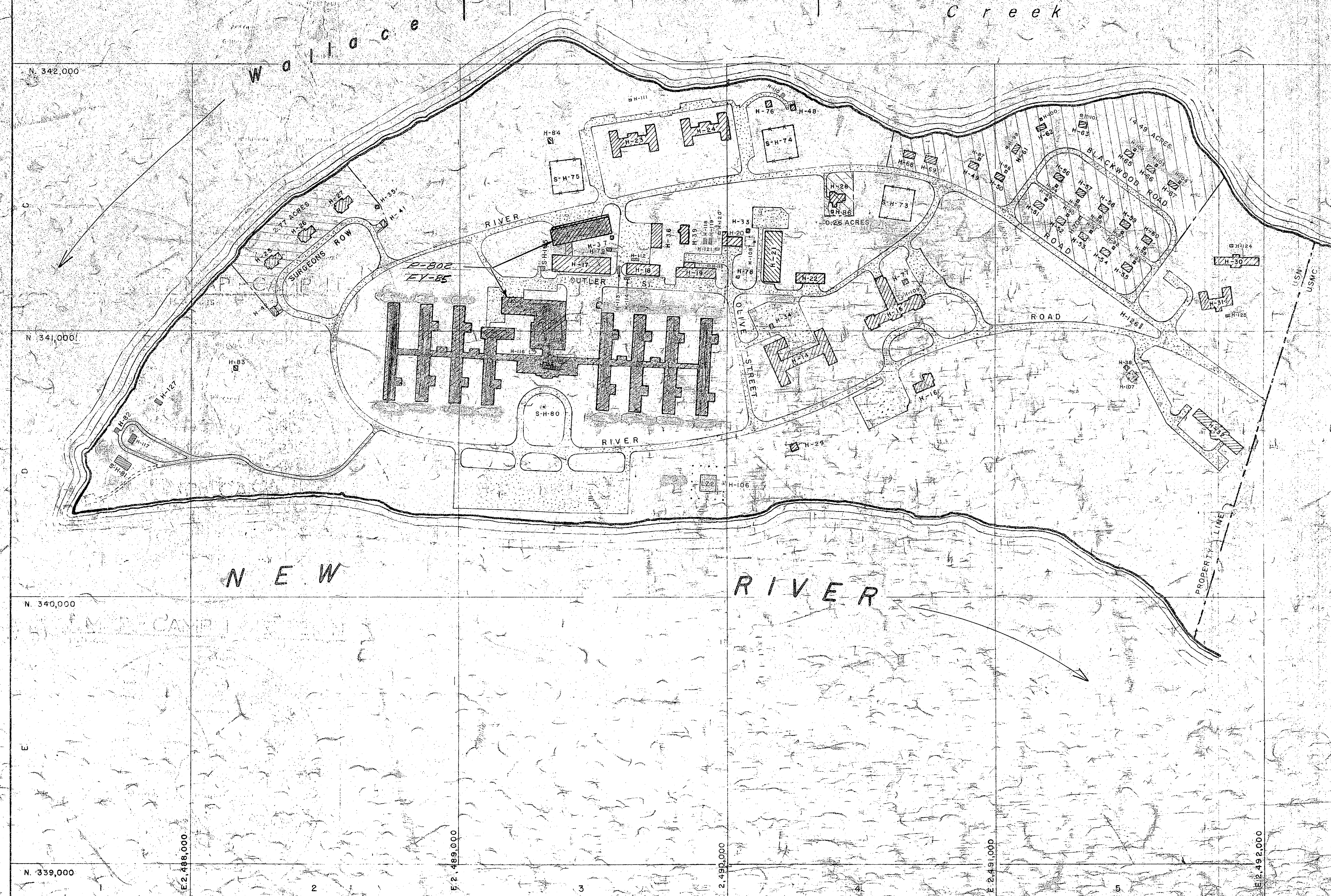

**LEGEND**

- BUILDINGS
- ASPHALT SURFACED
- SHORE LINE
- HELICOPTER LANDING ZONE
- STONE SURFACED ROAD
- EARTH ROAD
- MARINE CORPS BASE PROPERTY

**REVISED PROPERTY DELINEATION**

NAVAL HOSPITAL	127.1 ACRES
MARINE CORPS BASE	17.5 "
TOTAL HOSPITAL AREA	144.6 "

**MCON PROJECTS**

BLACK	■	FY-81-82-83	COMPLETED
BLUE	■	FY-83-84-85	AUTHORIZED
GREEN	■		UNDER CONSTRUCTION
RED	■	FY-86	PROPOSED
	■	FY-87	//
	■	FY-88	//
	■	FY-89	//
	■	FY-90	//

REVISIONS		DATE	APPROVED
SYM	DESCRIPTION		
	REVISED TO REFLECT FY-86 THRU FY-90 FIVE-YEAR MCON PROGRAM	7-8-83	EGJ

PUBLIC WORKS DEPT. MARINE CORPS BASE CAMP LEJEUNE, N.C.		DEPARTMENT OF THE NAVY NAVAL FACILITIES ENGINEERING COMMAND ATLANTIC DIVISION NORFOLK, VIRGINIA	
DES	DR	CHK	EGJ
PROJ	EGJ	CH	ENG CAPTAIN
APPROVED	DATE		
	7/8/83		
PUBLIC WORKS OFFICER FOR THE CG		SATISFACTORY TO	
COMMANDING GENERAL	DATE	SIZE	CODE IDENT NO.
EFD	RVD	F	80091
NO	DIR		
APPROVED	DATE	CONSTR CONTR NO.	
FOR COMMANDER, NAVFAC		SCALE 1"=200'	SPEC
			SHEET 9 OF 17







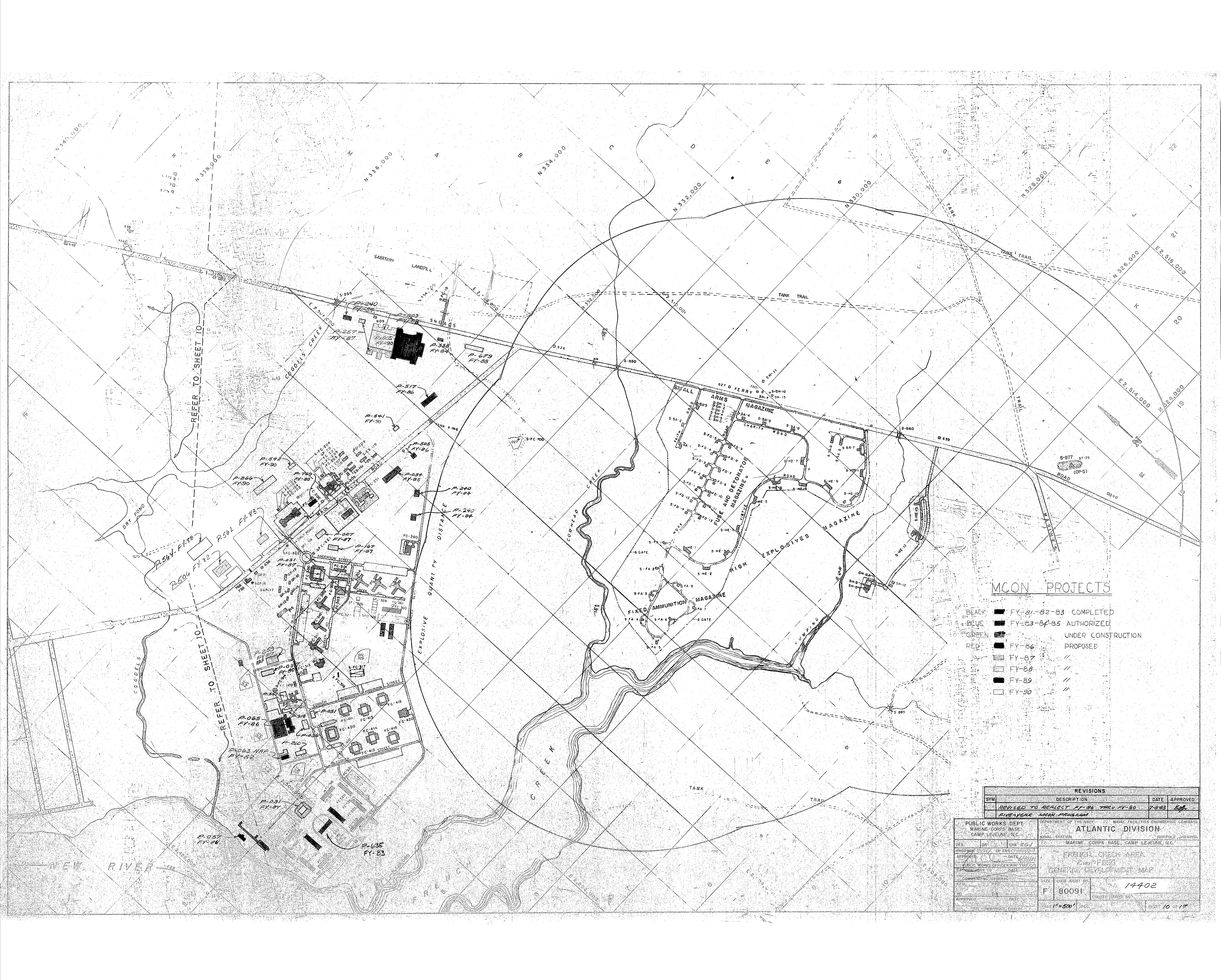

REFER TO SHEET IO

REFER TO SHEET IO

**MCON PROJECTS**

- BLACK ■ FY-81-82-83 COMPLETED
- BLUE ■ FY-83-84-85 AUTHORIZED
- GREEN ■ UNDER CONSTRUCTION
- RED ■ FY-86 PROPOSED
- /// FY-87
- /// FY-88
- /// FY-89
- /// FY-90

REVISIONS			
SYM	DESCRIPTION	DATE	APPROVED
	REVISED TO REFLECT FY-86 THRU FY-90 FIVE-YEAR MCON PROGRAM	7-83	EM

PUBLIC WORKS DEPT. MARINE CORPS BASE CAMP LEJEUNE, NC		DEPARTMENT OF THE NAVY NAVAL FACILITIES ENGINEERING COMMAND ATLANTIC DIVISION	
DESIGNED BY: DR. CHR. EGW.		MARINE CORPS BASE, CAMP LEJEUNE, ILC.	
APPROVED BY: DATE: 1/81		NORFOLK, VIRGINIA	
PUBLIC WORKS OFFICER: F. J. [unclear]		FRENCH, CRACK AREA	
DATE: 1/81		GEN. PRG	
COMMITTING GENERAL		GEN. DEV. MAP	
NO. 100091		14402	
APPROVED BY: DATE: 1/81		COST: \$500,000	
SUPERVISOR: [unclear]		SHEET 10 OF 17	



•

•  
•  
•  
•

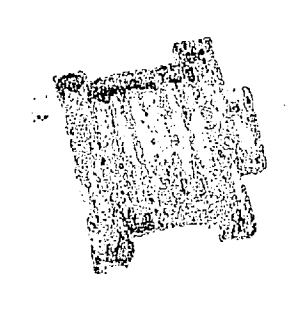











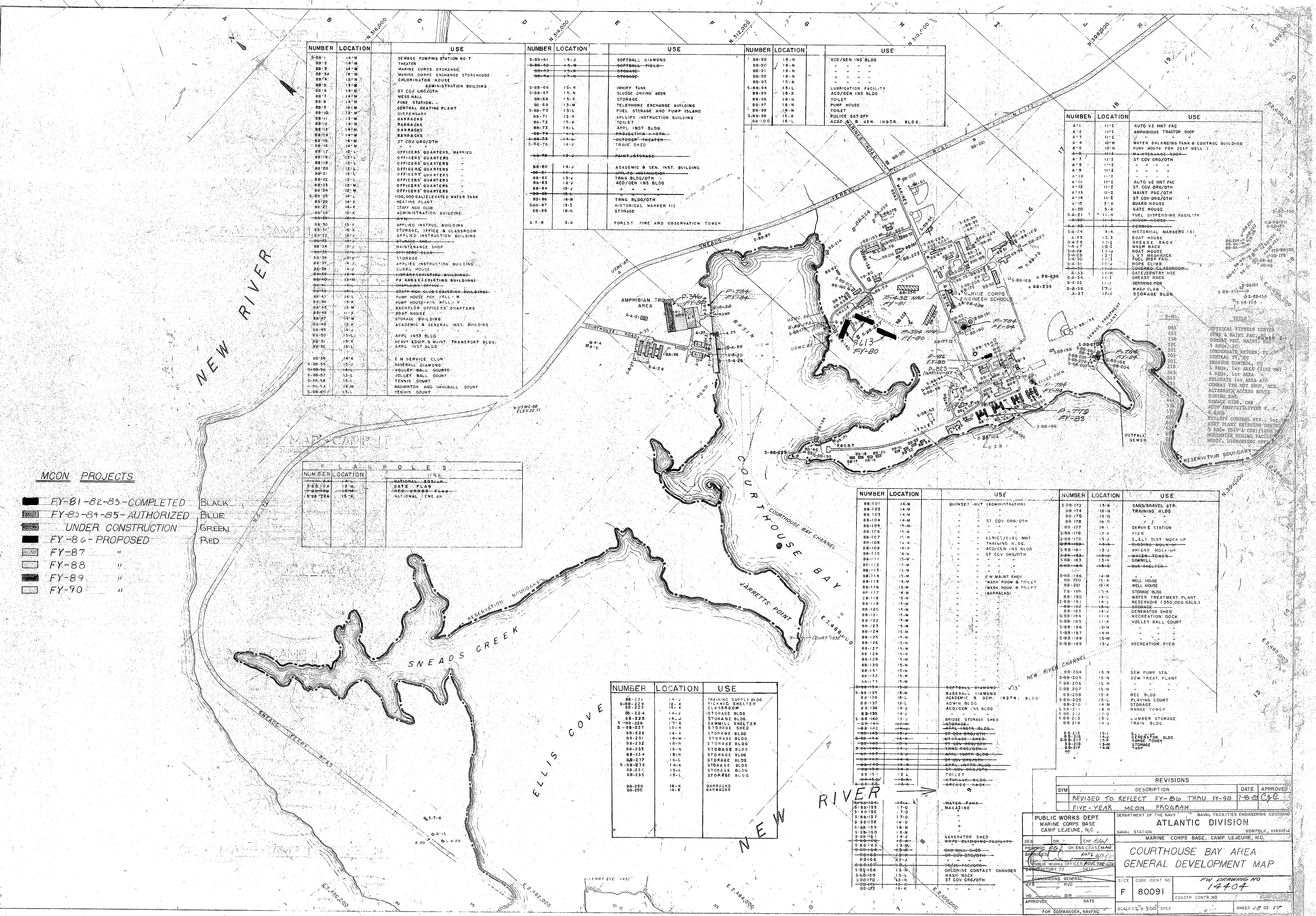

NUMBER	LOCATION	USE	NUMBER	LOCATION	USE	NUMBER	LOCATION	USE
S-BB-1	14-M	SEWAGE PUMPING STATION NO. 7	S-BB-61	15-J	SOFTBALL DIAMOND	S-BB-89	18-N	ACD/GEN IN'S BLDG
BB-2	14-M	THEATER	S-BB-62	15-M	SOFTBALL FIELD	BB-90	18-N	"
BB-3	14-M	MARINE CORPS EXCHANGE	S-BB-63	15-K	STORAGE	BB-91	18-N	"
BB-4	14-M	CHLORINATOR HOUSE	S-BB-64	15-K	STORAGE	BB-92	18-N	"
BB-5	13-M	ADMINISTRATION BUILDING	S-BB-65	15-N	IMHOFF TANK	BB-93	15-K	"
BB-6	14-M	ST. COV. ORG/OTH	S-BB-66	15-N	SLUDGE DRYING BEDS	S-BB-94	13-L	LUBRICATION FACILITY
BB-7	14-M	MESS HALL	BB-67	15-N	STORAGE	BB-95	15-K	ACD/GEN IN'S BLDG
BB-8	14-M	FIRE STATION	BB-68	15-N	TELEPHONE EXCHANGE BUILDING	BB-96	18-N	TOILET
BB-9	14-M	CENTRAL HEATING PLANT	S-BB-69	15-M	FUEL STORAGE AND PUMP ISLAND	BB-97	18-N	PUMP HOUSE
BB-10	13-M	DISPENSARY	S-BB-70	15-L	APPLIED INSTRUCTION BUILDING	BB-98	18-N	TOILET
BB-11	14-M	BARRACKS	BB-71	15-K	TOILET	S-BB-99	15-K	POLICE STATION
BB-12	14-M	BARRACKS	BB-72	15-L	APPL. INST. BLDG.	BB-100	16-L	ACAD. & GEN. INSTR. BLDG.
BB-13	14-M	BARRACKS	S-BB-73	14-L	OUTDOOR THEATER			
BB-14	14-M	BARRACKS	S-BB-74	14-J	TRAIN SHED			
BB-15	14-M	OFFICERS' QUARTERS, MARRIED	S-BB-75	14-J	PAINT STORAGE			
BB-16	12-L	OFFICERS' QUARTERS	BB-80	14-J	ACADEMIC & GEN. INST. BUILDING			
BB-17	12-L	OFFICERS' QUARTERS	BB-81	13-J	TRNG BLDG/OTH			
BB-18	12-L	OFFICERS' QUARTERS	BB-82	13-J	ACD/GEN IN'S BLDG			
BB-19	12-L	OFFICERS' QUARTERS	BB-83	13-J	TRNG BLDG/OTH			
BB-20	12-M	OFFICERS' QUARTERS	BB-84	13-J	STORAGE			
BB-21	12-M	OFFICERS' QUARTERS	S-BB-85	13-L	HISTORICAL MARKER (1)			
BB-22	12-M	OFFICERS' QUARTERS	BB-86	18-N	HISTORICAL MARKER (1)			
BB-23	12-M	OFFICERS' QUARTERS	BB-87	18-N	FOREST FIRE AND OBSERVATION TOWER			
BB-24	14-M	100,000 GALLON ELEVATED WATER TANK	S-T-8	3-K				
BB-25	14-M	HEATING PLANT						
BB-26	14-K	STAFF ROD CLUB						
BB-27	14-K	ADMINISTRATION BUILDING						
BB-28	15-K	APPLIED INSTRU. BUILDING						
BB-29	15-K	STORAGE, OFFICE & CLASSROOM						
BB-30	15-K	APPLIED INSTRUCTION BUILDING						
BB-31	15-K	STORAGE SHED						
BB-32	15-K	MAINTENANCE SHOP						
BB-33	15-K	OFFICERS' QUARTERS						
BB-34	15-K	OFFICERS' QUARTERS						
BB-35	15-K	OFFICERS' QUARTERS						
BB-36	15-K	OFFICERS' QUARTERS						
BB-37	15-K	OFFICERS' QUARTERS						
BB-38	15-K	OFFICERS' QUARTERS						
BB-39	15-K	OFFICERS' QUARTERS						
BB-40	15-K	OFFICERS' QUARTERS						
BB-41	15-K	OFFICERS' QUARTERS						
BB-42	15-K	OFFICERS' QUARTERS						
BB-43	15-K	OFFICERS' QUARTERS						
BB-44	15-K	OFFICERS' QUARTERS						
BB-45	15-K	OFFICERS' QUARTERS						
BB-46	15-K	OFFICERS' QUARTERS						
BB-47	15-K	OFFICERS' QUARTERS						
BB-48	15-K	OFFICERS' QUARTERS						
BB-49	15-K	OFFICERS' QUARTERS						
BB-50	15-K	OFFICERS' QUARTERS						
BB-51	15-K	OFFICERS' QUARTERS						
BB-52	15-K	OFFICERS' QUARTERS						
BB-53	15-K	OFFICERS' QUARTERS						
BB-54	15-K	OFFICERS' QUARTERS						
BB-55	15-K	OFFICERS' QUARTERS						
BB-56	15-K	OFFICERS' QUARTERS						
BB-57	15-K	OFFICERS' QUARTERS						
BB-58	15-K	OFFICERS' QUARTERS						
BB-59	15-K	OFFICERS' QUARTERS						
BB-60	15-K	OFFICERS' QUARTERS						

NUMBER	LOCATION	USE
A-1	11-I	AUTO VE MNT FAC
A-2	11-I	AMPHIBIOUS TRACTOR SHOP
A-3	11-I	WATER BALANCING TANK & CONTROL BUILDING
A-4	10-H	PUMP HOUSE FOR DEEP WELL J
A-5	10-H	M-TECH-86 SHOP
A-6	11-I	ST COV ORG/OTH
A-7	11-I	"
A-8	11-I	"
A-9	11-I	"
A-10	11-I	"
A-11	11-I	AUTO VE MNT FAC
A-12	11-I	ST COV ORG/OTH
A-13	11-I	MAINTY FAC/OTH
A-14	11-I	BUCK HOUSE
A-15	3-K	ST COV ORG/OTH
A-20	3-K	GATE HOUSE
S-A-21	11-I	FUEL DISPENSING FACILITY
S-A-22	11-I	WASH-HOUSE
S-A-23	11-I	PERMANENT
S-A-24	3-K	HISTORICAL MARKERS (3)
S-A-25	12-I	BOAT HOUSE
S-A-26	11-I	GREASE RACK
S-A-27	10-I	WASH RACK
S-A-28	11-I	BOAT HOUSE
S-A-29	12-I	WASH RACK
S-A-30	11-I	ROPE CLIMB
S-A-31	11-I	COVERED CLASSROOM
S-A-32	11-I	GATE/ENTRY HSE
S-A-33	11-I	GREASE RACK
S-A-34	11-I	BERTHING PIER
S-A-35	17-I	WASH HOUSE
S-A-36	17-I	STORAGE BLDG
S-A-37	17-I	STORAGE BLDG

NUMBER	LOCATION	NATIONAL FLAG	DATE FLAG	FLAG
S-BB-104	13-M	NATIONAL FLAG		
S-BB-105	13-M	NATIONAL FLAG		
S-BB-106	15-K	NATIONAL FLAG		

- MCON PROJECTS**
- FY-81-82-83-COMPLETED
  - FY-83-84-85-AUTHORIZED
  - UNDER CONSTRUCTION
  - FY-86-PROPOSED
  - FY-87
  - FY-88
  - FY-89
  - FY-90

NUMBER	LOCATION	USE
BB-225	14-J	TRAINING SUPPLY BLDG
BB-226	14-K	PICKNICK SHELTER
BB-227	14-J	CLASSROOM
BB-228	14-J	STORAGE BLDG
BB-229	14-K	STORAGE BLDG
S-BB-230	17-K	SAWMILL SHELTER
S-BB-231	13-K	STORAGE SHED
BB-232	14-K	STORAGE BLDG
BB-233	14-M	STORAGE BLDG
BB-234	18-N	STORAGE BLDG
BB-235	18-N	STORAGE BLDG
S-BB-236	16-L	STORAGE BLDG
S-BB-237	16-L	STORAGE BLDG
S-BB-238	16-L	STORAGE BLDG
BB-239	15-L	STORAGE BLDG
BB-240	15-L	STORAGE BLDG
BB-241	14-K	BARRACKS
BB-242	14-K	BARRACKS

NUMBER	LOCATION	USE	NUMBER	LOCATION	USE
BB-101	14-M	QUONSET HUT (ADMINISTRATION)	S-BB-173	13-K	SAND/GRAVEL STR.
BB-102	14-M	"	BB-174	18-U	TRAINING BLDG
BB-103	14-M	"	BB-175	18-U	"
BB-104	14-M	"	BB-176	18-U	"
BB-105	14-M	"	BB-177	14-I	PIER
BB-106	14-M	"	S-BB-178	12-J	SERVE STATION
BB-107	14-M	"	S-BB-179	15-J	ELECT. DIST. MCK. UP
BB-108	14-M	"	S-BB-180	14-M	RECREATION MCK. UP
BB-109	14-M	"	S-BB-181	13-I	RECREATION MCK. UP
BB-110	14-M	"	S-BB-182	13-I	RECREATION MCK. UP
BB-111	14-M	"	S-BB-183	13-K	RECREATION MCK. UP
BB-112	14-M	"	S-BB-184	14-M	RECREATION MCK. UP
BB-113	14-M	"	S-BB-185	14-M	RECREATION MCK. UP
BB-114	14-M	"	S-BB-186	14-M	RECREATION MCK. UP
BB-115	14-M	"	BB-220	15-K	WELL HOUSE
BB-116	14-M	"	BB-221	15-K	WELL HOUSE
BB-117	14-M	"	BB-189	15-K	STORAGE BLDG
BB-118	14-M	"	BB-190	15-K	STORAGE BLDG
BB-119	14-M	"	BB-191	14-L	RECREATION DOCK
BB-120	14-M	"	BB-192	14-L	RECREATION DOCK
BB-121	14-M	"	BB-193	14-L	RECREATION DOCK
BB-122	14-M	"	S-BB-194	11-K	RECREATION DOCK
BB-123	14-M	"	S-BB-195	11-K	RECREATION DOCK
BB-124	14-M	"	S-BB-196	13-M	RECREATION DOCK
BB-125	14-M	"	S-BB-197	14-M	RECREATION DOCK
BB-126	14-M	"	S-BB-198	15-M	RECREATION DOCK
BB-127	14-M	"	S-BB-199	13-J	RECREATION DOCK
BB-128	14-M	"			
BB-129	14-M	"			
BB-130	14-M	"			
BB-131	14-M	"			
BB-132	14-M	"			
BB-133	14-M	"			
BB-134	14-M	"			
BB-135	14-M	"			
BB-136	14-M	"			
BB-137	14-M	"			
BB-138	14-M	"			
BB-139	14-M	"			
BB-140	14-M	"			
BB-141	14-M	"			
BB-142	14-M	"			
BB-143	14-M	"			
BB-144	14-M	"			
BB-145	14-M	"			
BB-146	14-M	"			
BB-147	14-M	"			
BB-148	14-M	"			
BB-149	14-M	"			
BB-150	14-M	"			
BB-151	14-M	"			
BB-152	14-M	"			
BB-153	14-M	"			
BB-154	14-M	"			
BB-155	14-M	"			
BB-156	14-M	"			
BB-157	14-M	"			
BB-158	14-M	"			
BB-159	14-M	"			
BB-160	14-M	"			
BB-161	14-M	"			
BB-162	14-M	"			
BB-163	14-M	"			
BB-164	14-M	"			
BB-165	14-M	"			
BB-166	14-M	"			
BB-167	14-M	"			
BB-168	14-M	"			
BB-169	14-M	"			
BB-170	14-M	"			
BB-171	14-M	"			
BB-172	14-M	"			

**REVISIONS**

SYM	DESCRIPTION	DATE	APPROVED
	REVISED TO REFLECT FY-86 THRU FY-90	7-8-89	CJE

**FIVE-YEAR MCON PROGRAM**

**PUBLIC WORKS DEPT. MARINE CORPS BASE CAMP LEJUNE, N.C.**

**DEPARTMENT OF THE NAVY NAVAL FACILITIES ENGINEERING COMMAND**

**ATLANTIC DIVISION**

**CAMP LEJUNE, VIRGINIA**

**MARINE CORPS BASE, CAMP LEJUNE, N.C.**

**COURTHOUSE BAY AREA GENERAL DEVELOPMENT MAP**

**DESIGNED BY: [Signature]**

**CHECKED BY: [Signature]**

**APPROVED BY: [Signature]**

**DATE: [Date]**

**PUBLIC WORKS OFFICER: [Signature]**

**DATE: [Date]**

**SCALE: 1" = 500' SPEC**

**SHEET 12 OF 17**

FOR OFFICIAL USE ONLY



1  
2  
3  
4  
5

1  
2  
3  
4  
5

1  
2  
3  
4  
5



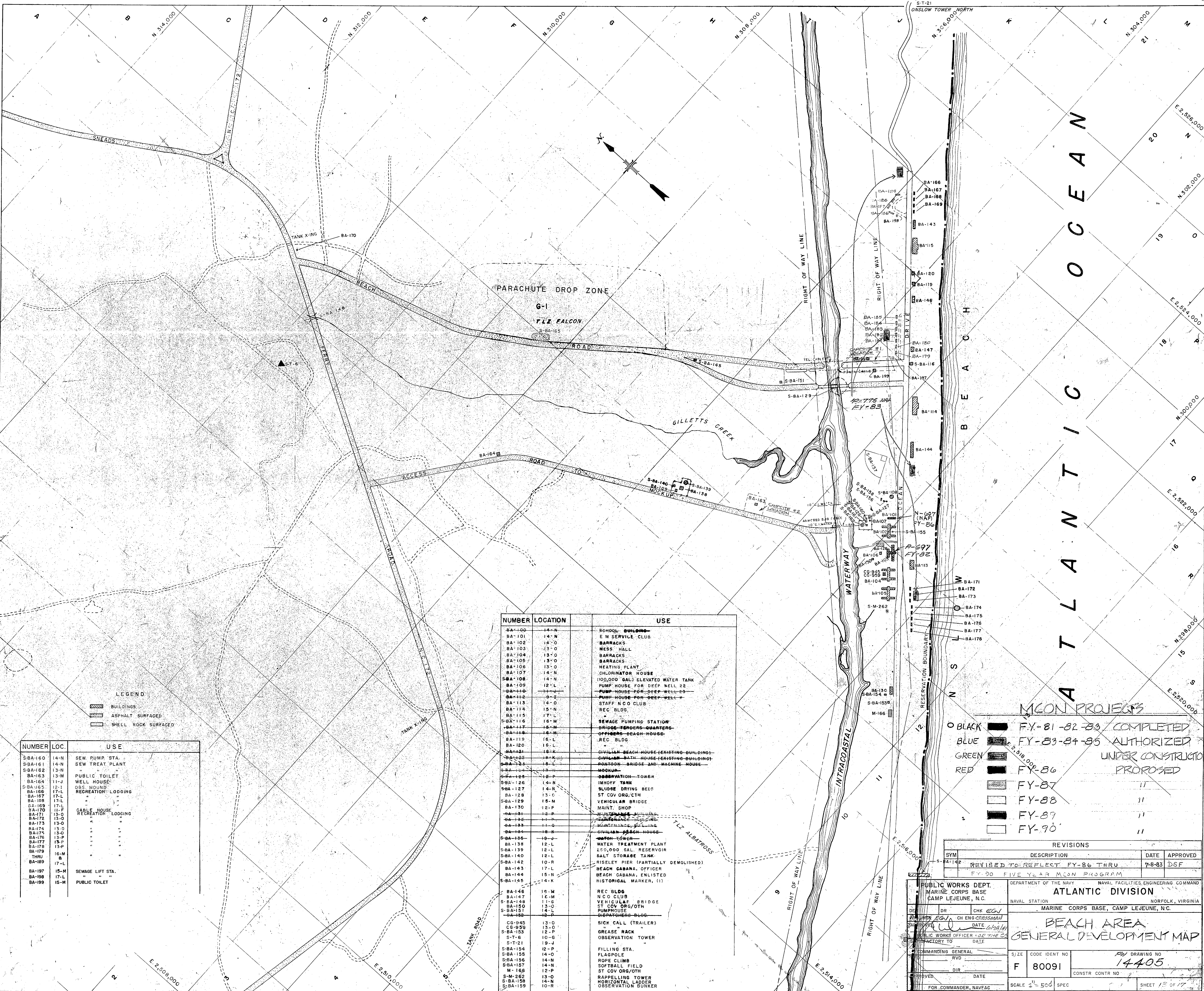

**LEGEND**

BUILDINGS  
 ASPHALT SURFACED  
 SHELL ROCK SURFACED

NUMBER	LOC.	USE
S-BA-160	14-N	SEW PUMP STA.
S-BA-161	14-N	SEW TREAT PLANT
S-BA-162	13-N	"
BA-163	13-M	PUBLIC TOILET
BA-164	11-J	WELL HOUSE
S-BA-165	12-I	QSS. MOUND
BA-166	17-L	RECREATION LODGING
BA-167	17-L	"
BA-168	17-L	"
BA-169	17-L	"
BA-170	11-F	CABLE HOUSE
BA-171	13-O	RECREATION LODGING
BA-172	13-O	"
BA-173	13-O	"
BA-174	13-O	"
BA-175	13-P	"
BA-176	13-P	"
BA-177	13-P	"
BA-178	13-P	"
BA-179	16-M	"
THRU	8	"
BA-189	17-L	"
BA-197	15-M	SEWAGE LIFT STA.
BA-198	17-L	"
BA-199	15-M	PUBLIC TOILET

NUMBER	LOCATION	USE
BA-100	14-N	SCHOOL BUILDING
BA-101	14-N	S M SERVICE CLUB
BA-102	14-O	BARRACKS
BA-103	13-O	MESS HALL
BA-104	13-O	BARRACKS
BA-105	13-O	BARRACKS
BA-106	13-O	HEATING PLANT
BA-107	14-N	CHLORINATOR HOUSE
BA-108	14-N	105,000 GAL. ELEVATED WATER TANK
BA-109	12-L	PUMP HOUSE FOR DEEP WELL 22
BA-110	11-J	PUMP HOUSE FOR DEEP WELL 23
BA-112	19-T	PUMP HOUSE FOR DEEP WELL 24
BA-113	14-O	STAFF MESS CLUB
BA-114	15-N	REC BLDG.
BA-115	17-L	SEWAGE PUMPING STATION
S-BA-116	16-M	BRIDGE
BA-117	16-M	OFFICERS BEACH HOUSE
BA-118	16-M	OFFICERS BEACH HOUSE
BA-119	16-L	REC BLDG.
BA-120	16-L	REC BLDG.
BA-121	16-K	CIVILIAN BEACH HOUSE (EXISTING BUILDING)
BA-122	16-K	CIVILIAN BEACH HOUSE (EXISTING BUILDING)
BA-123	16-L	ROBSON BRIDGE AND MACHINE HOUSE
BA-124	16-L	MOON
S-BA-125	12-P	OBSERVATION TOWER
S-BA-126	14-N	IMHOFF TANK
S-BA-127	14-N	SLUDGE DRIVING BESS
BA-128	13-O	ST COV ORG/OTH
S-BA-129	15-M	VEHICULAR BRIDGE
BA-130	12-P	MAINT. SHOP
BA-131	12-P	MAINTENANCE BUILDING
BA-132	11-P	MAINTENANCE BUILDING
BA-133	11-O	MAINTENANCE BUILDING
S-BA-134	12-P	VEHICULAR BRIDGE
BA-138	12-L	WATER TREATMENT PLANT
S-BA-139	12-L	250,000 GAL. RESERVOIR
S-BA-140	12-L	SALT STORAGE TANK
S-BA-142	10-R	RISELEY PIER (PARTIALLY DEMOLISHED)
BA-143	17-L	BEACH CABANA, OFFICER
BA-144	15-M	BEACH CABANA, ENLISTED
S-BA-145	14-K	HISTORICAL MARKER, (1)
BA-146	16-M	REC BLDG.
BA-147	16-M	S M CLUB
S-BA-148	11-G	VEHICULAR BRIDGE
S-BA-149	12-L	ST COV ORG/OTH
S-BA-151	14-L	PUMP HOUSE
S-BA-152	14-L	PUMP HOUSE
CG-945	13-O	SICK CALL (TRAILER)
CG-949	13-O	"
S-BA-153	12-L	GRASSY RACK
S-T-8	10-G	OBSERVATION TOWER
S-T-21	19-J	"
S-BA-154	12-P	FILLING STA.
S-BA-155	14-O	FLAGPOLE
S-BA-156	14-N	ROPE CLIMB
S-BA-157	14-N	SOFTBALL FIELD
M-166	12-P	ST COV ORG/OTH
S-M-262	13-O	RAPPPELLING TOWER
S-BA-158	14-N	HORIZONTAL LADDER
S-BA-159	10-R	OBSERVATION BUNKER

**MCN PROJECTS**

BLACK FY-81-82-83 COMPLETED  
 BLUE FY-83-84-85 AUTHORIZED  
 GREEN UNDER CONSTRUCTION  
 RED PROPOSED

FY-86  
 FY-87  
 FY-88  
 FY-89  
 FY-90

REVISIONS			
SYM	DESCRIPTION	DATE	APPROVED
BA-142	REVISED TO REFLECT FY-86 THRU	7-8-83	DSF

PUBLIC WORKS DEPT.  
 MARINE CORPS BASE  
 CAMP LEJEUNE, N.C.

DEPARTMENT OF THE NAVY  
 NAVAL FACILITIES ENGINEERING COMMAND  
 ATLANTIC DIVISION  
 NORFOLK, VIRGINIA

MARINE CORPS BASE, CAMP LEJEUNE, N.C.

**BEACH AREA**  
**GENERAL DEVELOPMENT MAP**

DRAWING NO. 14405  
 SIZE CODE IDENT NO. F 80091  
 CONSTR. CONTR NO.

SCALE 2" = 500' SPEC. SHEET 13 OF 17

FOR OFFICIAL USE ONLY CAMP LEJEUNE, N.C.







FOR ENLARGEMENT KNOX AREA  
PRIVATELY OWNED TRAILERS  
REFER TO SHEET 2-B

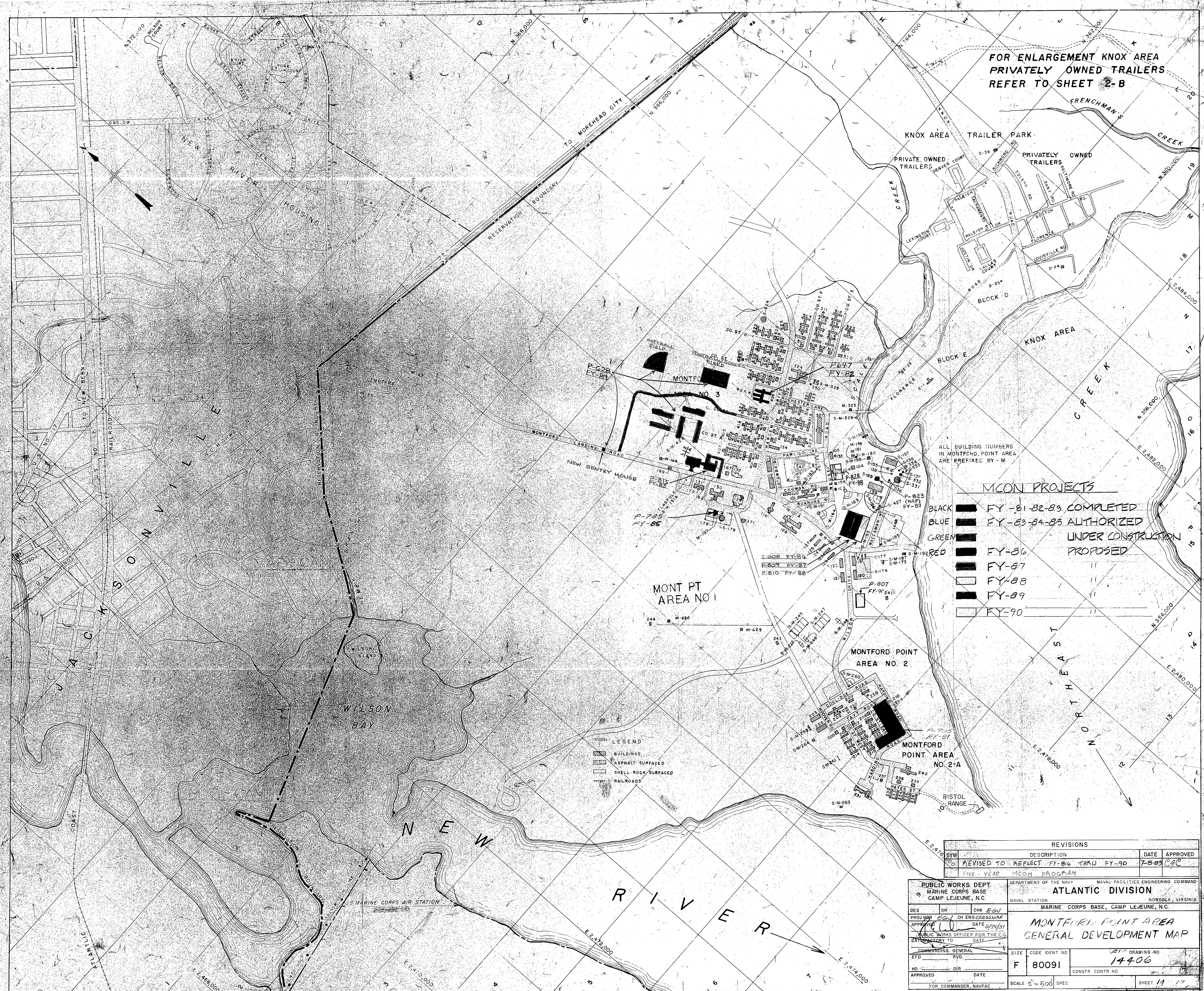

ALL BUILDING NUMBERS  
IN MONTFORD POINT AREA  
ARE PREFIXED BY - M

**MCON PROJECTS**

- BLACK ■ FY-81-82-83 COMPLETED
- BLUE ■ FY-83-84-85 AUTHORIZED
- GREEN ■ UNDER CONSTRUCTION
- RED ■ PROPOSED
- FY-86
- FY-87
- FY-88
- FY-89
- FY-90

**LEGEND**  
 ■ BUILDINGS  
 ■ ASPHALT SURFACED  
 ■ SHELL ROCK SURFACED  
 ■ RAILROADS

REVISIONS			
SYM	DESCRIPTION	DATE	APPROVED
01	REVISED TO REFLECT FY-86 THRU FY-90 FIVE YEAR MCON PROGRAM	7-8-83	CJC

PUBLIC WORKS DEPT. MARINE CORPS BASE CAMP LEJEUNE, N.C.		DEPARTMENT OF THE NAVY NAVAL FACILITIES ENGINEERING COMMAND ATLANTIC DIVISION	
NAVAL STATION MARINE CORPS BASE, CAMP LEJEUNE, N.C.		NORFOLK, VIRGINIA	
<b>MONTFORD POINT AREA GENERAL DEVELOPMENT MAP</b>			
DESIGNED BY CHKD BY PROJ MGR APPROVED DATE DATE SATISFACTORY TO COMMISSIONING GENERAL NO. APPROVED	DATE DATE DATE DATE DATE	SIZE F	CODE IDENT NO. 80091
DRAWING NO. 14406		CONSTR CONTR NO.	
SCALE 1"=500'		SHEET 11 OF 17	

FOR OFFICIAL USE ONLY CAMP LEJEUNE, N.C.



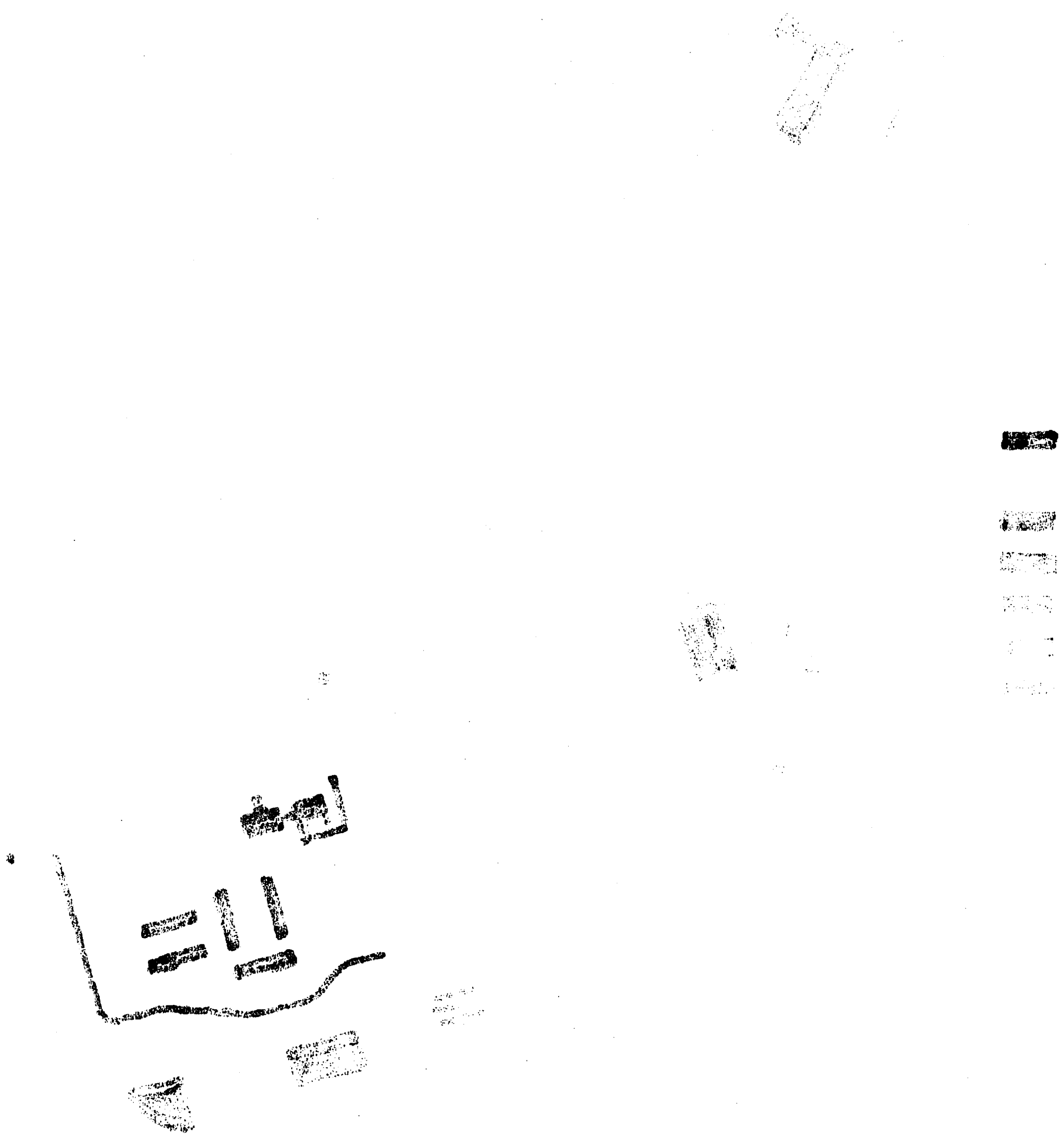



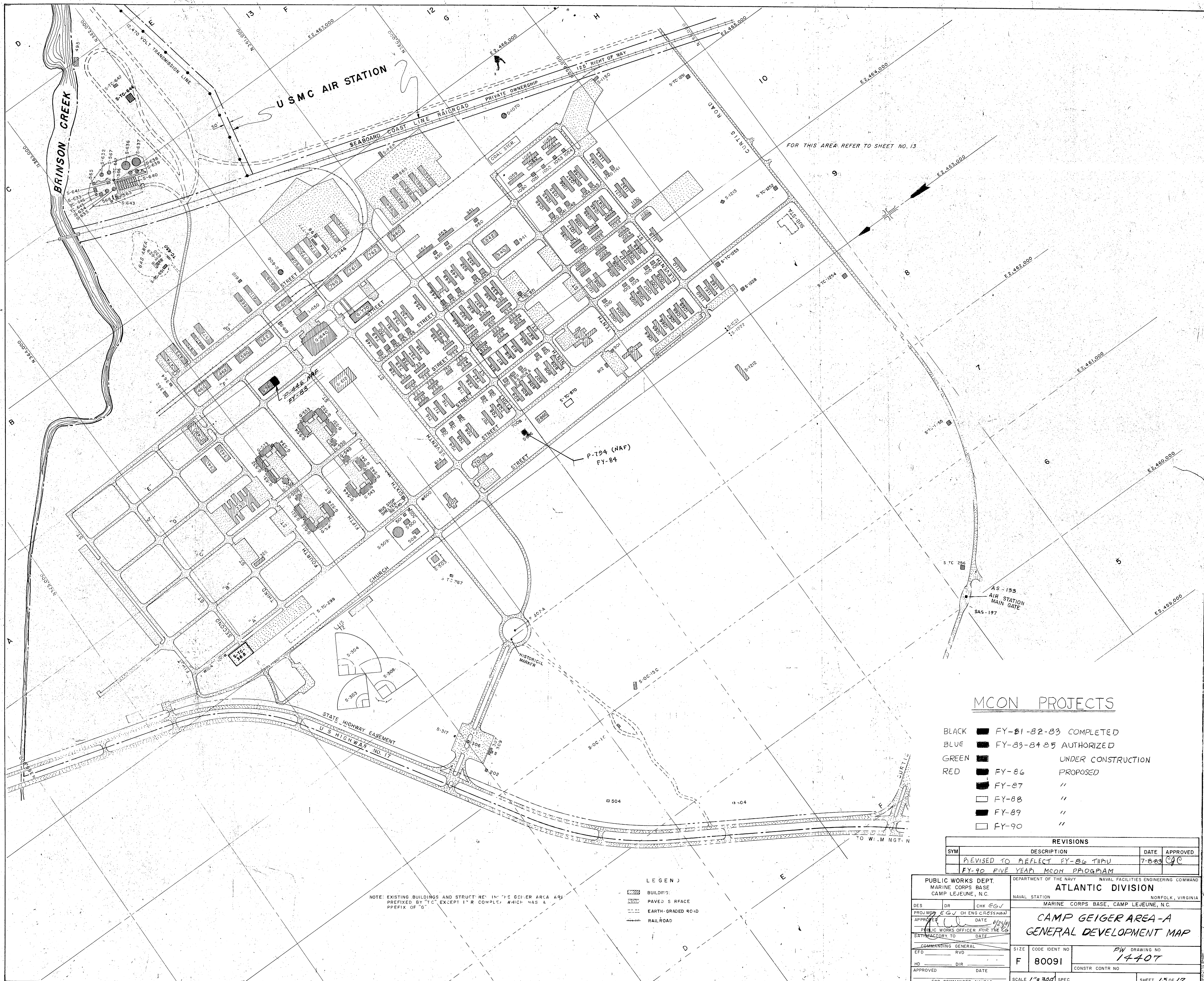

**MCON PROJECTS**

- BLACK ■ FY-81-82-83 COMPLETED
- BLUE ■ FY-83-84-85 AUTHORIZED
- GREEN ■ UNDER CONSTRUCTION
- RED ■ FY-86 PROPOSED
- FY-87 "
- FY-88 "
- FY-89 "
- FY-90 "

REVISIONS			
SYM	DESCRIPTION	DATE	APPROVED
	REVISED TO REFLECT FY-86 THRU	7-8-88	CJC
	FY-90 FIVE YEAR MCON PROGRAM		

PUBLIC WORKS DEPT. MARINE CORPS BASE CAMP LEJEUNE, N.C.		NAVAL FACILITIES ENGINEERING COMMAND ATLANTIC DIVISION NORFOLK, VIRGINIA	
DESIGNER: EGV		MARINE CORPS BASE, CAMP LEJEUNE, N.C.	
PROJECT: EGV CH ENG CRESSMAN		DRAWING NO: 14407	
APPROVED: [Signature]		CONSTR CONTR NO:	
DATE: 8/25/88		SCALE: 1"=300'	
PUBLIC WORKS OFFICER FOR THE CG		SHEET 15 OF 17	
DATE: [Blank]		FOR OFFICIAL USE ONLY	
COMMITTEE GENERAL		CAMP LEJEUNE, N.C.	
EFD: [Blank]			
HD: [Blank]			
APPROVED: [Blank]			
DATE: [Blank]			
FOR COMMANDER, NAVFAC			

- LEGEND**
- BUILDING
  - PAVED SURFACE
  - EARTH-GRADED ROAD
  - RAILROAD

NOTE: EXISTING BUILDINGS AND STRUCTURES IN THE GEIGER AREA ARE PREFIXED BY 'TC' EXCEPT 'R' COMPLEX WHICH HAS A PREFIX OF 'O'







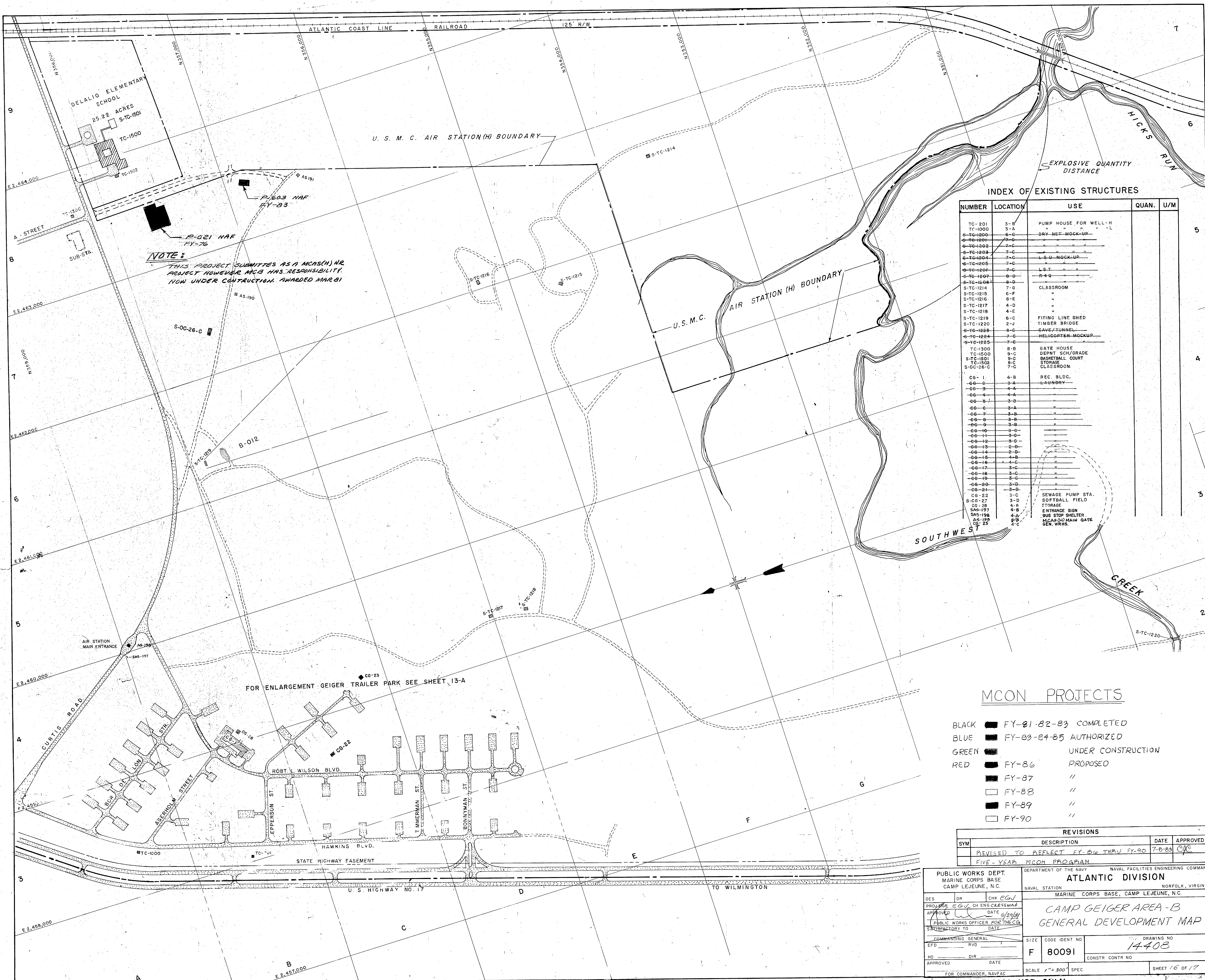

**NOTE:**  
 THIS PROJECT SUBMITTED AS AN MCON(SH) NR  
 PROJECT HOWEVER MCB HAS RESPONSIBILITY  
 NOW UNDER CONSTRUCTION AWARDED MAR 81

**INDEX OF EXISTING STRUCTURES**

NUMBER	LOCATION	USE	QUAN.	U/M
TC-201	3-B	PUMP HOUSE FOR WELL-H		
TC-1000	3-A	DRY-NET-MOCK-UP		
S-TC-1200	7-C			
S-TC-1201	7-C			
S-TC-1202	7-C			
S-TC-1203	7-C			
S-TC-1204	7-C			
S-TC-1205	7-C			
S-TC-1206	7-C			
S-TC-1207	7-C			
S-TC-1208	7-C			
S-TC-1209	7-C			
S-TC-1210	7-C			
S-TC-1211	7-C			
S-TC-1212	7-C			
S-TC-1213	7-C			
S-TC-1214	7-C			
S-TC-1215	7-C			
S-TC-1216	7-C			
S-TC-1217	7-C			
S-TC-1218	7-C			
S-TC-1219	7-C			
S-TC-1220	7-C			
S-TC-1221	7-C			
S-TC-1222	7-C			
S-TC-1223	7-C			
S-TC-1224	7-C			
S-TC-1225	7-C			
TC-1300	8-B	GATE HOUSE		
TC-1500	9-C	DEPT SCH/GRADE		
S-TC-1501	9-C	BASKETBALL COURT		
TC-1502	8-C	STORAGE		
S-OC-26-C	7-C	CLASSROOM		
CG-1	4-B	REC. BLDG.		
CG-2	3-A			
CG-3	4-A			
CG-4	4-A			
CG-5	3-B			
CG-6	3-A			
CG-7	3-B			
CG-8	3-B			
CG-9	3-B			
CG-10	3-C			
CG-11	3-C			
CG-12	3-C			
CG-13	2-D			
CG-14	2-D			
CG-15	4-B			
CG-16	4-C			
CG-17	3-C			
CG-18	3-C			
CG-19	3-C			
CG-20	3-D			
CG-21	3-D			
CG-22	3-C	SEWAGE PUMP STA.		
S-CD-27	3-D	SOFTBALL FIELD		
CG-28	4-B	STORAGE		
SAS-197	4-B	ENTRANCE SIGN		
SAS-198	4-B	BUS STOP SHELTER		
AS-199	4-B	MCAO MAIN GATE		
CG-23	4-C	GEN. WHRS.		

**MCON PROJECTS**

- BLACK ■ FY-81-82-83 COMPLETED
- BLUE ■ FY-83-84-85 AUTHORIZED
- GREEN ■ UNDER CONSTRUCTION
- RED ■ FY-86 PROPOSED
- FY-87 "
- FY-88 "
- FY-89 "
- FY-90 "

REVISIONS			
SYM	DESCRIPTION	DATE	APPROVED
	REVISED TO REFLECT FY-86 THRU FY-90 FIVE-YEAR MCON PROGRAM	7-8-89	CJC

PUBLIC WORKS DEPT. MARINE CORPS BASE CAMP LEJEUNE, N.C.		DEPARTMENT OF THE NAVY NAVAL FACILITIES ENGINEERING COMMAND ATLANTIC DIVISION NORFOLK, VIRGINIA	
DESIGNER: CHR EGV		NAVAL STATION MARINE CORPS BASE, CAMP LEJEUNE, N.C.	
PROJECT: CAMP GEIGER AREA-B		DRAWING NO. 14408	
APPROVED: [Signature]		CONSTR CONTR NO.	
DATE: 6/29/81		SCALE: 1"=300' SPEC	
PUBLIC WORKS OFFICER FOR THE CG		SHEET 16 OF 17	
SATISFACTORY TO: [Signature]		FOR COMMANDER, NAVFAC	
COMMITTEE GENERAL		SCALE 1"=300' SPEC	
EFD: RVD		SHEET 16 OF 17	
HD: DIR		FOR OFFICIAL USE ONLY	
APPROVED: [Signature]		CAMP LEJEUNE, N.C.	



100  
101  
102  
103  
104

105







