

1/8" SECOND FLOOR PLAN

KEY TO MATERIALS
 BRICK
 HOLLOW TILE
 WOOD STIP

GENERAL NOTES:
 * TILE AT EXTERIOR WALLS TO LAY BRICK VENEER BY AT LEAST 2 COURSES OF TILE. PERGE OUTER FACE OF TILE BEFORE CARRYING UP BRICKWORK.
 * INTERIOR FACE OF TILE AT EXTERIOR WALL TO BE WATERPROOFED. SEE SPEC.
 * BOND TILE & BRICK AT EXTERIOR WALLS WITH CORRUGATED GALVANIZED METAL TIES - EVERY 2ND COURSE NOT MORE THAN 24" ON CENTERS.
 * WHERE JOINTS OCCUR IN CLOSETS, DOOR SWEPTES SHALL BE PLACED IN CLOSETS, DOOR KEYPING LAMB TO BE IN POSITION TO CENTER OVER SWEEP. SEE 1ST FLOOR FOR DETAILS.
 * WHEREVER STUD WALLS INTERSECT WITH TILE THE END OF STUD WALL SHALL BE SECURELY ANCHORED TO TILE WITH NAILING INSERTS, TOGGLE BOLTS, ETC.

REVISION
 D
 AUGUST 25, 1943

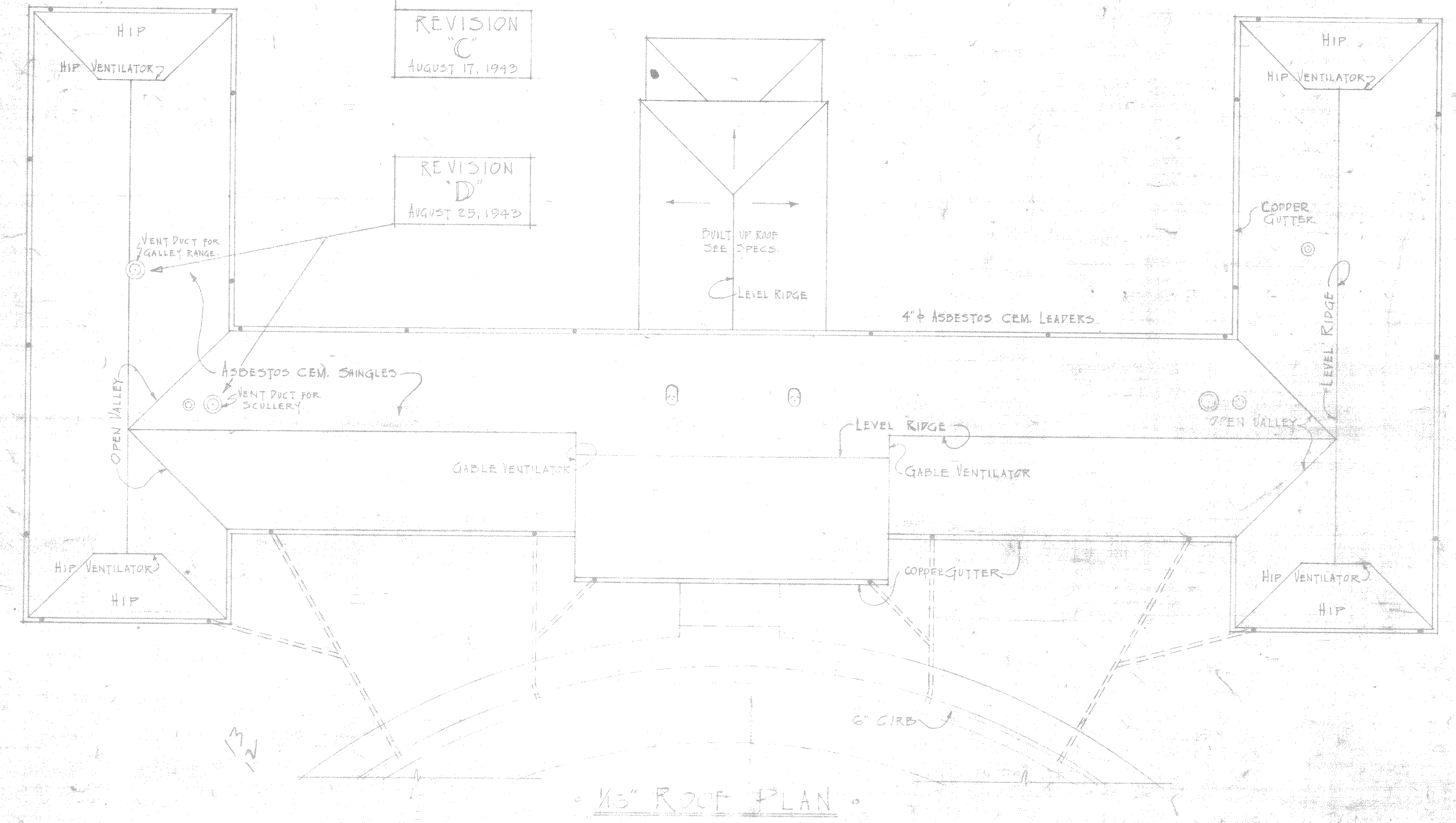

1/8" ROOF PLAN

REVISION
 C
 AUGUST 17, 1943

REVISION
 D
 AUGUST 23, 1943

#67

DRAWN BY: J. R. RIVERS	CARR & J. E. GREINER CO.—ARCHITECT-ENGINEERS DURHAM, N. C.
TRACED BY: J. R. RIVERS	CAMP LEJEUNE — NEW RIVER, N. C. BUREAU OF YARDS AND DOCKS — U. S. NAVY
CHECKED BY: J. R. RIVERS	MARINE CORPS WOMEN'S RESERVE B.O.Q.
IN CHARGE: J. R. RIVERS	SECOND FLOOR PLAN ROOF PLAN
DATE: JULY 9, 1943	267064
SCALE: AS NOTED	APPROVED: [Signature] 10/23
Y. & D. DRAWING NO.	NO. 533
SHEET NO. 1	OF 1

REV.	BY	DATE	DESCRIPTION	SCALE
E	LEE	6-13-43	PROJECT NO. CHANGED FROM T-702 TO P-1200-9A	3/4"
D	TRING	8-23-43	RELOCATED 1 DOWN DUCTS ON ROOF PLAN. RELOCATED WITHIN 96"	3/4"
C	WING	8-17-43	CHANGED 1 WALL BETWEEN RMS. 243 & 249 FROM TILE TO STIP DIMENSION IN R.M. 249	3/4"
B	WING	8-11-43	CHANGED 1 WALL BETWEEN RMS. 243 & 249 FROM TILE TO STIP DIMENSION IN R.M. 249	3/4"
A	WING	7-21-43	CHANGED 1 WALL BETWEEN RMS. 243 & 249 FROM TILE TO STIP DIMENSION IN R.M. 249	3/4"

