

**VALUABLE**

RETURN TO  
PUBLIC WORKS  
OFFICE  
CAMP LEJEUNE  
NORTH CAROLINA

SUBJECT PROPOSED RAW WATER  
LOCATION AND NEW WELL  
SITE ALONG SNEADS FERRY  
ROAD, BETWEEN MARINES  
ROAD & ENGINEER STOCKADE RD.

FIELD PARTY  
SSGT SNIPES IN CHARGE  
SSGT SZABO INSTRUMENT  
SSGT SNIPES NOTES  
Tape Read  
Pvt. MOORMAN Tape or Rod  
Pvt. WHITE Tape or Rod  
Instrument No. PLUFF  
Tape No. \_\_\_\_\_

WEATHER  
CLEAR  
CLOUDY  
WINDY  
RAIN  
FAIR  
SNOW  
HOT  
MODERATE  
COLD  
FOG  
FIGURED BY \_\_\_\_\_  
NOTES CHECKED BY \_\_\_\_\_  
PLOTTED BY \_\_\_\_\_

FILE No. \_\_\_\_\_  
FLDR. No. \_\_\_\_\_  
SHEET 1 OF \_\_\_\_\_  
DATE 8-13- 1956

Quad. No. \_\_\_\_\_

STATION	DIST.	ANGLE ° ' "	+	H. I. BEARING	VER. ANG. DIFF.	ELEVATION
---------	-------	----------------	---	------------------	--------------------	-----------

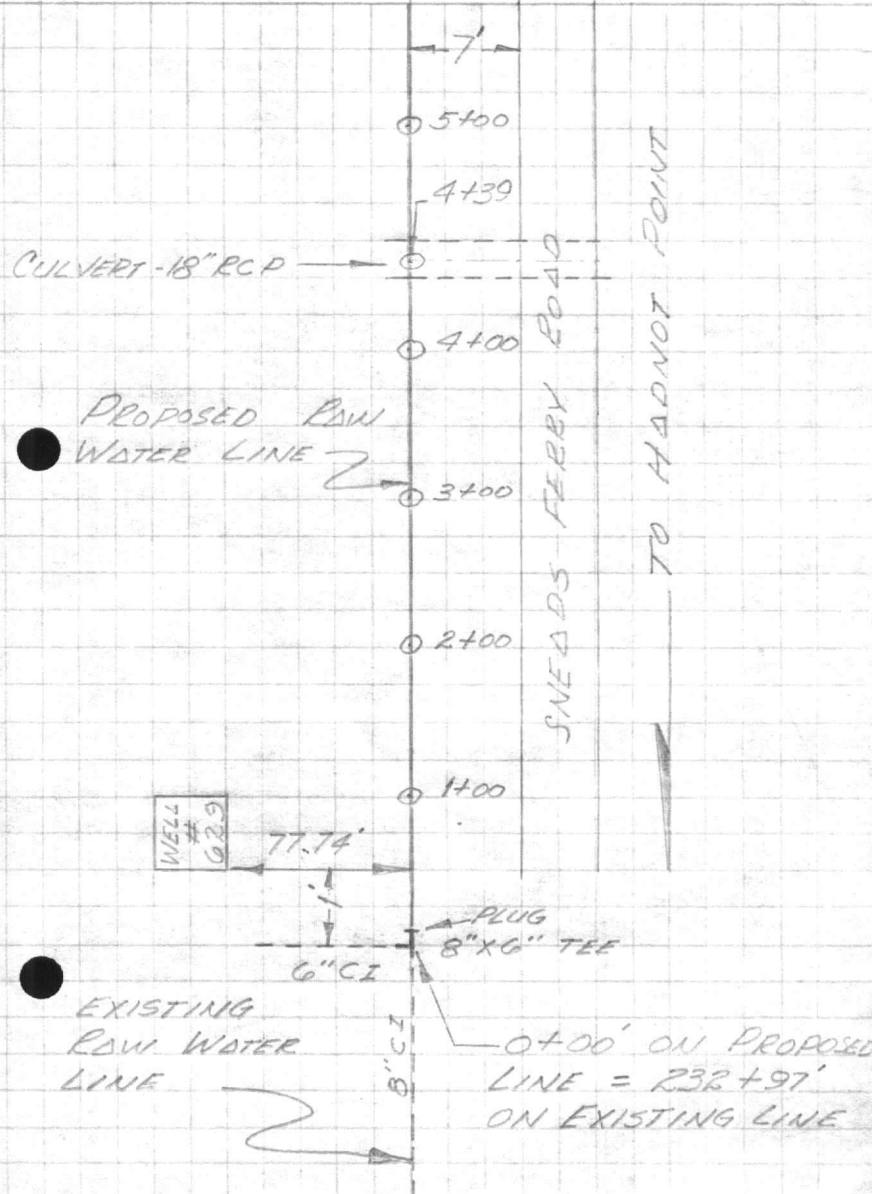

WEATHER  
CLEAR  
BROOK  
COOL  
WINDY  
MIST  
RAIN  
SUN  
CLOUDS  
MOON  
STARS  
PLANETS  
COMETS  
METEORS  
AURORA  
AUGUST 1954

PLANETARY  
IN CLARITY  
MAGNITUDE  
POSITION  
DISTANCE  
PERIOD  
ECCENTRICITY  
INCLINATION  
NODAL PERIOD  
ASCENDING NODE  
DESCENDING NODE  
PERIHELION  
APHELION  
SPEED  
ACCELERATION

STATION  
DATE  
TIME  
OBSERVER  
EQUATORIAL  
RIGHT ASCENSION  
DECLINATION  
AZIMUTH  
ALTITUDE  
PARALLAX  
REFRACTION  
CORRECTIONS  
RESULTS



**VALUABLE**

RETURN TO  
PUBLIC WORKS  
OFFICE  
CAMP LEJEUNE  
NORTH CAROLINA

SUBJECT PROPOSED RAW WATER LINE  
AND WELL SITE ALONG SNEADS  
FERRY ROAD, BETWEEN MARINES ROAD  
AND ENGINEER STOCKADE ROAD

FIELD PARTY

SNIPES IN CHARGE  
SCABO INSTRUMENT  
SNIPES NOTES  
SKI TAPE READ  
MORIMAN TAPE OR ROD  
WHITE TAPE OR ROD  
INSTRUMENT NO. BLUFF  
TAPE NO. \_\_\_\_\_

WEATHER

CLEAR  
 CLOUDY  
 WINDY  
 RAIN  
 FAIR  
 SNOW  
 HOT  
 MODERATE  
 COLD  
 FOG

FILE No. \_\_\_\_\_

FLDR. No. \_\_\_\_\_

SHEET 2 OF

DATE 8-14- 1956

FIGURED BY \_\_\_\_\_  
NOTES CHECKED BY \_\_\_\_\_  
PLOTTED BY \_\_\_\_\_  
Quad. No. \_\_\_\_\_

STATION	DIST.	ANGLE ° ' "	+	H. I. BEARING	VER: ANG. DIFF.	ELEVATION
						12+00
						11+00
						10+00
						9+00
						8+00
						7+00
						6+00
						5+00

SNEADS FERRY ROAD

TO HAGNOT POINT





WALLACE

REPORT TO:  
SUNNY  
DATE:  
PLACE:  
SUNNY

LOCATION: SUNNY

DATE: 10/10/50  
TIME: 10:00 AM  
PLACE: SUNNY

FIELD PARTY

LEADER: [unclear]

MEMBERS: [unclear]

DATE: [unclear]

TIME: [unclear]

PLACE: [unclear]

LOCATION: [unclear]

WEATHER: [unclear]

WEATHER

TEMP: [unclear]

WIND: [unclear]

MOON: [unclear]

STAR: [unclear]

PLANET: [unclear]

CONSTELLATION: [unclear]

OTHER: [unclear]

10/10/50

SUNNY

10:00 AM

SUNNY

SUNNY





**VALUABLE**

RETURN TO  
PUBLIC WORKS  
OFFICE  
CAMP LEJEUNE  
NORTH CAROLINA

SUBJECT PROPOSED RAW WATER LOCATION  
ALONG SNEADS FERRY ROAD  
BETWEEN MARINES ROAD &  
ENGINEER ENGINEER ROAD  
ENGINEER STOCKADE ROAD

**FIELD PARTY**

SWIPES IN CHARGE  
STABO INSTRUMENT  
SWIPES NOTES  
SKI TAPE READ  
WHITE TAPE OR ROD  
TAPE OR ROD  
INSTRUMENT NO.  
TAPE NO.

**WEATHER**

CLEAR  
CLOUDY  
WINDY  
RAIN  
FAIR  
SNOW  
HOT  
MODERATE  
COLD  
FOG  
FIGURED BY  
NOTES CHECKED BY  
PLOTTED BY

FILE No. \_\_\_\_\_  
FLDR. No. \_\_\_\_\_  
SHEET 3 OF  
DATE 8-19 1952

Quad. No. \_\_\_\_\_

STATION	DIST.	ANGLE ° ' "	+	H. I. BEARING	VER. ANG. DIFF.	ELEVATION
						CULVERT 19+10.73 18" RCP
						19+00
						18+00
						17+00
						16+00
						P.O.T. # 1 15+20.39
						15+00
						14+00
						13+00
						CULVERT 24" RCP → 12+36.25

SNEADS FERRY ROAD  
TO HADNOT POINT



WILLIAMSON  
PUBLIC WORKS  
SECTION  
STATIONER

STATIONER

1250 PARTIAL  
CITY OF CHICAGO  
INSTRUMENT  
STATE OF ILLINOIS  
NOTARIAL PUBLIC  
COMMISSION EXPIRES  
MAY 15 1964

WEATHER  
CLEAR  
TEMP  
70  
WIND  
S.W. 10  
HUMIDITY  
60  
PRESSURE  
30.0  
WIND CHILL  
65  
HEAT INDEX  
70  
DEW POINT  
55  
VISIBLE  
10

DATE  
10/10/63  
TIME  
10:00 AM  
PLACE  
CHICAGO  
BY  
JAMES W. HARRIS

INSTRUMENT NO. 1250 PARTIAL

STATE OF ILLINOIS

NOTARIAL PUBLIC

COMMISSION EXPIRES

MAY 15 1964

DATE

TIME

PLACE

BY

JAMES W. HARRIS

CHICAGO

10:00 AM

10/10/63

10:00 AM

10/10/63

10:00 AM

10/10/63

10:00 AM

10/10/63

10:00 AM

10/10/63

10:00 AM

10/10/63

10:00 AM

10/10/63

10:00 AM

10/10/63

10:00 AM



**VALUABLE**

SUBJECT \_\_\_\_\_

RETURN TO  
PUBLIC WORKS  
OFFICE  
CAMP LEJEUNE  
NORTH CAROLINA

## FIELD PARTY

SNIPES IN CHARGE  
SEABO INSTRUMENT  
SNIPES NOTES  
SKL TAPE READ  
WHITE TAPE OR ROD  
TAPE OR ROD  
INSTRUMENT No. \_\_\_\_\_  
TAPE No. \_\_\_\_\_

## WEATHER

CLEAR  
CLOUDY  
WINDY  
RAIN  
FAIR  
SNOW  
HOT  
MODERATE  
COLD  
FOG  
FIGURED BY \_\_\_\_\_  
NOTES CHECKED BY \_\_\_\_\_  
PLOTTED BY \_\_\_\_\_

FILE No. \_\_\_\_\_

FLDR. No. \_\_\_\_\_

SHEET 4 OF \_\_\_\_\_DATE 8-14-1932

Quad. No. \_\_\_\_\_

STATION	DIST.	ANGLE			H. I. BEARING	VER. ANG. DIFF.	ELEVATION
		°	'	"			
				+			

HUB - END OF LINE  
P.O.T. # 32770267025702670Proposed  
WELL SITE

P.O.T. # 2

82.53  
100 from E  
of 10002470

SNEADS FERRY ROAD

TO HADNOT POINT

2370227021702070





**VALUABLE**

SUBJECT \_\_\_\_\_

RETURN TO  
PUBLIC WORKS  
OFFICE  
CAMP LEJEUNE  
NORTH CAROLINA

**FIELD PARTY**

\_\_\_\_\_  
IN CHARGE  
\_\_\_\_\_  
INSTRUMENT  
\_\_\_\_\_  
NOTES  
\_\_\_\_\_  
TAPE READ  
\_\_\_\_\_  
TAPE OR ROD  
\_\_\_\_\_  
TAPE OR ROD  
\_\_\_\_\_  
INSTRUMENT NO.  
\_\_\_\_\_  
TAPE NO.

**WEATHER**

CLEAR  
CLOUDY  
WINDY  
RAIN  
FAIR  
SNOW  
HOT  
MODERATE  
COLD  
FOG

FILE No. \_\_\_\_\_

FLDR. No. \_\_\_\_\_

SHEET 5-0f

FIGURED BY \_\_\_\_\_  
NOTES CHECKED BY \_\_\_\_\_

PLOTTED BY \_\_\_\_\_ DATE \_\_\_\_\_ 19\_\_

Quad. No. \_\_\_\_\_

STATION	DIST.	ANGLE " "	+	H. I. BEARING	VER. ANG. DIFF.	ELEVATION
---------	-------	--------------	---	------------------	--------------------	-----------

① 0 5600  
 ③ 024815  
 (M) 0 5605  
 Not Mon #122  
 B.S. P.O.T.#3  
 To OBSERVATION Tower

1238.06

① 35659 15  
 ③ 35057 15  
 (M) 35659 05

Not P.O.T.#3 Sta. 28100  
 B.S. P.O.T.#2  
 To Mon #122

Sta. 28100 P.O.T.#3

Fire tower  
 Eng. Stockade  
 Rd.

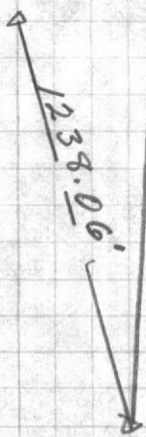

Mon. 122

NO.	DATE	DESCRIPTION	AMOUNT	BALANCE
1			120	
2			48	
			168	

$0^{\circ} 56' 15''$   
 $2^{\circ} 48' 15''$

①  $0^{\circ} 56' 00''$   
 ③  $2^{\circ} 48' 15''$   
 M  $0^{\circ} 56' 05''$

~~$790^{\circ} 13' 15''$~~   
 $356^{\circ} 59' 45''$   
 $350^{\circ} 57' 15''$

$120^{\circ}$   
 $48$   
 $3 \overline{) 168} (56''$

$356^{\circ} 59' 15''$   
 $350^{\circ} 57' 15''$

$350$   
 $720$   
 $3 \overline{) 1070} (356$   
 $9$

~~$350$   
 $720$   
 $3 \overline{) 1070} (356$   
 $9$   
 $17$   
 $15$   
 $20$   
 $18$~~

$60 \overline{) 168} (2$   
 $120$   
 $48$

$17$   
 $15$   
 $20$   
 $120$   
 $57$

$120$   
 $57$   
 $3 \overline{) 174} (59$   
 $15$

$3 \overline{) 177} (59$   
 $15$

$91$   
 $15$   
 $3 \overline{) 167} (55$   
 $47$   
 $120$

$27$   
 $15$   
 $3 \overline{) 177} (59$   
 $47$   
 $120$

$15$   
 $15$   
 $3 \overline{) 167} (55$   
 $47$   
 $120$

$2^{\circ} 47' 45''$

$0^{\circ} 55' 30''$   
 $2^{\circ} 48' 15''$



**VALUABLE**

SUBJECT \_\_\_\_\_

RETURN TO  
PUBLIC WORKS  
OFFICE  
CAMP LEJEUNE  
NORTH CAROLINA

## FIELD PARTY

\_\_\_\_\_  
IN CHARGE  
\_\_\_\_\_  
INSTRUMENT  
\_\_\_\_\_  
NOTES  
\_\_\_\_\_  
TAPE READ  
\_\_\_\_\_  
TAPE OR ROD  
\_\_\_\_\_  
TAPE OR ROD  
\_\_\_\_\_  
INSTRUMENT NO.  
\_\_\_\_\_  
TAPE NO.

## WEATHER

CLEAR  
CLOUDY  
WINDY  
RAIN  
FAIR  
SNOW  
HOT  
MODERATE  
COLD  
FOG

FILE No. \_\_\_\_\_

FLDR. No. \_\_\_\_\_

SHEET 6 ofFIGURED BY \_\_\_\_\_  
NOTES CHECKED BY \_\_\_\_\_  
PLOTTED BY \_\_\_\_\_ DATE \_\_\_\_\_ 19\_\_

Quad. No. \_\_\_\_\_

STATION	DIST.	ANGLE			H. I. BEARING	VER. ANG. DIFF.	ELEVATION
		°	'	"			
				+			

① 175° 46' 00"  
 ② 169° 17' 30"  
 (M) 175° 45' 50"

Not Mon. # 105  
 B.S. 0+00 Water line  
 To: Nail Int. of Sneads Ferry Road and Virtue Rd.

1142.84  
942.9

① 176 27 15  
 ② 169 21 30  
 (M) 176 27 10

Not 0+00 on Water Line  
 E.S. P.O.T. # 1  
 To Mon. # 105

✓ ✓ ✓  
① 176° 27' 15"

③ 169 21 30

✓ 45' 00"  
173° 46' 15"  
161 17' 30"

$$\begin{array}{r} 169 \\ 360 \\ \hline 3 \overline{) 529} 176 \\ \underline{3} \end{array}$$

$$3 \overline{) 30} 10''$$

$$\begin{array}{r} 161 \\ 360 \\ \hline 3 \overline{) 521} \\ \underline{173} 2' \end{array}$$

$$\begin{array}{r} 22 \\ \underline{21} \\ 19 \\ \underline{18} \end{array}$$

$$\begin{array}{r} 60 \\ 21 \\ \hline 3 \overline{) 81} 27 \\ \underline{6} \\ 21 \end{array}$$

$$\begin{array}{r} 120 \\ 17 \\ \hline 3 \overline{) 137} \\ \underline{45} 2' \end{array}$$

$$\begin{array}{r} 120 \\ 30 \\ \hline 3 \overline{) 58} \\ \underline{50} \end{array}$$

① 173.46.00

③ 161.17.30

⑭ 173 45 50

**VALUABLE**

RETURN TO  
PUBLIC WORKS  
OFFICE  
CAMP LEJEUNE  
NORTH CAROLINA

SUBJECT pro-life New Well on  
Sneads Ferry Rd Between  
Court House Rd & Stockade  
Rd.

**FIELD PARTY**

\_\_\_\_\_  
IN CHARGE  
\_\_\_\_\_  
INSTRUMENT  
\_\_\_\_\_  
NOTES  
\_\_\_\_\_  
TAPE READ  
\_\_\_\_\_  
TAPE OR ROD  
\_\_\_\_\_  
TAPE OR ROD  
\_\_\_\_\_  
INSTRUMENT NO.  
\_\_\_\_\_  
TAPE NO.

**WEATHER**

CLEAR  
CLOUDY  
WINDY  
RAIN  
FAIR  
SNOW  
HOT  
MODERATE  
COLD  
FOG

FILE No. 181-N  
FLDR. No. \_\_\_\_\_  
FIGURED BY \_\_\_\_\_ SHEET 10f  
NOTES CHECKED BY \_\_\_\_\_  
PLOTTED BY \_\_\_\_\_ DATE 8/17 1956

Quad. No. \_\_\_\_\_

STATION	DIST.	ANGLE " "	+	H. I. BEARING	VER. ANG. DIFF.	ELEVATION	
B.M.				35.97 26.0		30.30	spike in power pole #5-141 NW Cor. Well House #629 Top 6x8" Tee.
0+00					9.32	26.65	
0+00					5.9	30.1	on ground
1+0					5.6	30.4	
2+0					5.2	30.8	
3+0					5.0	31.0	
4+0					4.6	31.4	
4+34 <sup>3</sup>					6.31	29.66	5.7' Lt. Cor. H.W.
4+39					4.6	31.4	Ground
4+39					7.20	28.77	Top 18" R.C.P.
4+43 <sup>3</sup>							5.5' Lt. Cor. H.W.
5+0					4.5	31.5	
6+0					4.1	31.9	
TP					3.04	32.93	
7+0				38.5	6.1	32.4	
8+0					5.3	33.2	





**VALUABLE**

SUBJECT \_\_\_\_\_  
 \_\_\_\_\_  
 \_\_\_\_\_  
 \_\_\_\_\_

RETURN TO  
 PUBLIC WORKS  
 OFFICE  
 CAMP LEJEUNE  
 NORTH CAROLINA

**FIELD PARTY**

\_\_\_\_\_ IN CHARGE  
 \_\_\_\_\_ INSTRUMENT  
 \_\_\_\_\_ NOTES  
 \_\_\_\_\_ TAPE READ  
 \_\_\_\_\_ TAPE OR ROD  
 \_\_\_\_\_ TAPE OR ROD  
 \_\_\_\_\_ INSTRUMENT NO.  
 \_\_\_\_\_ TAPE NO.

**WEATHER**

CLEAR  
 CLOUDY  
 RAIN  
 FAIR

SNOW  
 HOT  
 MODERATE  
 COLD  
 FOG

FILE No. \_\_\_\_\_

F.L.R. No. \_\_\_\_\_

FIGURED BY \_\_\_\_\_ SHEET 205

NOTES CHECKED BY \_\_\_\_\_

PLOTTED BY \_\_\_\_\_ DATE \_\_\_\_\_ 19\_\_

Quad. No. \_\_\_\_\_

STATION	DIST.	ANGLE ° ' "	+	H. I. BEARING	VER: ANG. DIFF.	ELEVATION	
				38.51			
9+0					4.9	33.6	
10+0					4.6	33.9	
11+0					4.1	34.4	
12+0					3.3	35.2	
T.P.					2.17	36.34	
		5.5		41.49 41.5			
12+31					7.52	33.97	12.7' Lt. Cor. H.W
12+36 <sup>25</sup>					6.00	35.49	Ground
12+36 <sup>25</sup>					8.50	32.99	Top 24" R.C.P on E.
12+42							12.9' Lt Cor H.W
13+0					5.60	35.9	
14+0					5.4	36.1	
15+0					4.8	36.7	
16+0					4.6	37.0	
17.0					4.9	36.6	
18.0					5.5	36.0	
TP					4.65	36.84	
				3.16		40.00	

3625-  
V-21-  
~~3160~~



**VALUABLE**

SUBJECT \_\_\_\_\_  
 \_\_\_\_\_  
 \_\_\_\_\_  
 \_\_\_\_\_  
 \_\_\_\_\_

RETURN TO  
 PUBLIC WORKS  
 OFFICE  
 CAMP LEJEUNE  
 NORTH CAROLINA

**FIELD PARTY**

\_\_\_\_\_  
 IN CHARGE  
 \_\_\_\_\_  
 INSTRUMENT  
 \_\_\_\_\_  
 NOTES  
 \_\_\_\_\_  
 TAPE READ  
 \_\_\_\_\_  
 TAPE OR ROD  
 \_\_\_\_\_  
 TAPE OR ROD  
 \_\_\_\_\_  
 INSTRUMENT No. \_\_\_\_\_  
 TAPE No. \_\_\_\_\_

**WEATHER**

CLEAR  
 CLOUDY  
 WINDY  
 RAIN  
 FAIR

SNOW  
 HOT  
 MODERATE  
 COLD  
 FOG

FILE No. \_\_\_\_\_  
 FLDR. No. \_\_\_\_\_  
 SHEET 3 of  
 FIGURED BY \_\_\_\_\_  
 NOTES CHECKED BY \_\_\_\_\_  
 PLOTTED BY \_\_\_\_\_ DATE \_\_\_\_\_ 19\_\_

Quad. No. \_\_\_\_\_

STATION	DIST.	ANGLE ° ' "	+	H. I. BEARING	VER. ANG. DIFF.	ELEVATION	
19+0				10.00	4.6	35.4	
19+05 <sup>73</sup>					5.35	34.60	3' Lt Cor HW
19+10 <sup>73</sup>					4.6	35.4	Ground
19+10 <sup>73</sup>					6.2	33.8	Top 18" R.C.P
19+14 <sup>73</sup>							3' Left Corner of Head wall
20+0					4.6	35.4	
21+0					4.8	35.2	
22+0					5.0	35.0	
23+0					5.0	35.0	
PTFO					4.41	35.59	Top of hub 24+0
24+0				5.94 41.5	41.5		
24+0					5.94	35.6	
25+0					6.0	35.5	
26+0					5.9	35.6	
27+0					5.9	35.6	

10.73  
~~4.9~~  
5.83

0.583  
9  
1983

**VALUABLE**

SUBJECT \_\_\_\_\_  
 \_\_\_\_\_  
 \_\_\_\_\_  
 \_\_\_\_\_  
 \_\_\_\_\_

RETURN TO  
 PUBLIC WORKS  
 OFFICE  
 CAMP LEJEUNE  
 NORTH CAROLINA

**FIELD PARTY**

\_\_\_\_\_  
 IN CHARGE  
 \_\_\_\_\_  
 INSTRUMENT  
 \_\_\_\_\_  
 NOTES  
 \_\_\_\_\_  
 TAPE READ  
 \_\_\_\_\_  
 TAPE OR ROD  
 \_\_\_\_\_  
 TAPE OR ROD  
 \_\_\_\_\_  
 INSTRUMENT NO. \_\_\_\_\_  
 TAPE NO. \_\_\_\_\_

**WEATHER**

CLEAR  
 CLOUDY  
 WINDY  
 RAIN  
 FAIR

SNOW  
 HOT  
 MODERATE  
 COLD  
 FOG

FILE No. \_\_\_\_\_  
 FLDR. No. \_\_\_\_\_  
 SHEET 4 of \_\_\_\_\_  
 DATE \_\_\_\_\_ 19\_\_\_\_

FIGURED BY \_\_\_\_\_  
 NOTES CHECKED BY \_\_\_\_\_  
 PLOTTED BY \_\_\_\_\_  
 Quad. No. \_\_\_\_\_

STATION	DIST.	ANGLE ° ' "	+	H. I. BEARING	VER. ANG. DIFF.	ELEVATION	
24+00 = 0+00				41.53	5.9	35.6	Well Line
0+09					7.0	34.5	
0+20					4.7	36.8	
0+45					4.7	36.8	
0+50					3.2	38.3	
0+76					3.0	38.5	
0+82.55					3.0	38.5	hub at well site
BM					4.39	37.14	(37.06) on Power Pole S152





VALUABLE

SUBJECT

Bench Levels

RETURN TO  
PUBLIC WORKS  
OFFICE  
CAMP LEJEUNE  
NORTH CAROLINA

New Row Water Line  
Sneads Ferry Rd.

## FIELD PARTY

\_\_\_\_ IN CHARGE  
\_\_\_\_ INSTRUMENT  
\_\_\_\_ NOTES  
\_\_\_\_ TAPE READ  
\_\_\_\_ TAPE OR ROD  
\_\_\_\_ STRUMENT NO.  
\_\_\_\_ TAPE NO.

## WEATHER

CLEAR  
CLOUDY  
WINDY  
RAIN  
FAIR

SNOW  
HOT  
MODERATE  
COLD  
FOG

FILE No. \_\_\_\_\_

FLDR. No. \_\_\_\_\_

SHEET

1-07-2

NOTES CHECKED BY \_\_\_\_\_

PLOTTED BY \_\_\_\_\_

DATE

8-17-56

Quad. No. \_\_\_\_\_

STATION	DIST.	ANGLE " "	+	H. I. BEARING	VER: ANG. DIFF.	ELEVATION
B.M. SPIKE IN POLE S 141 T.P.			6.25	36.55		30.30
T.P.			6.27	38.90	3.92	32.63
T.P.			7.77	43.48	3.19	35.71
T.P.			2.72	43.68	2.52	40.96
T.P.			4.50	40.10	8.08	35.60
T.B.M.			3.37	40.43	3.04	37.06
T.P.			4.44	41.27	3.60	36.83
T.P.			3.10	37.80	6.57	34.70

MON. No. 122

Nail in Power Pole S 152

STATE OF NORTH CAROLINA  
COUNTY OF \_\_\_\_\_  
PUBLIC WORKS  
DIVISION  
CANTONMENT  
NORTH CAROLINA

STATE OF NORTH CAROLINA  
COUNTY OF \_\_\_\_\_  
PUBLIC WORKS  
DIVISION  
CANTONMENT  
NORTH CAROLINA

STATE OF NORTH CAROLINA  
COUNTY OF \_\_\_\_\_  
PUBLIC WORKS  
DIVISION  
CANTONMENT  
NORTH CAROLINA

STATE OF NORTH CAROLINA  
COUNTY OF \_\_\_\_\_  
PUBLIC WORKS  
DIVISION  
CANTONMENT  
NORTH CAROLINA

STATE OF NORTH CAROLINA  
COUNTY OF \_\_\_\_\_  
PUBLIC WORKS  
DIVISION  
CANTONMENT  
NORTH CAROLINA

STATE OF NORTH CAROLINA  
COUNTY OF \_\_\_\_\_  
PUBLIC WORKS  
DIVISION  
CANTONMENT  
NORTH CAROLINA



**VALUABLE**

SUBJECT \_\_\_\_\_  
 \_\_\_\_\_  
 \_\_\_\_\_  
 \_\_\_\_\_

RETURN TO  
 PUBLIC WORKS  
 OFFICE  
 CAMP LEJEUNE  
 NORTH CAROLINA

**FIELD PARTY**

\_\_\_\_\_ IN CHARGE  
 \_\_\_\_\_ INSTRUMENT  
 \_\_\_\_\_ NOTES  
 \_\_\_\_\_ TAPE READ  
 \_\_\_\_\_ TAPE OR ROD  
 \_\_\_\_\_ TAPE OR ROD  
 \_\_\_\_\_ INSTRUMENT NO.  
 \_\_\_\_\_ TAPE NO.

**WEATHER**

CLEAR SNOW  
 CLOUDY HOT  
 WINDY MODERATE  
 RAIN COLD  
 FAIR FOG

FILE No. \_\_\_\_\_  
 FLDR. No. \_\_\_\_\_  
 SHEET 2-072  
 DATE 8-17 1956

FIGURED BY \_\_\_\_\_  
 NOTES CHECKED BY \_\_\_\_\_  
 PLOTTED BY \_\_\_\_\_  
 Quad. No. \_\_\_\_\_

STATION	DIST.	ANGLE ° ' "	+	H. I. BEARING	VER: ANG. DIFF.	ELEVATION
				37.80		
T.P.				5.81	31.99	
				3.89	35.88	
B.M. Power Pole 5141				5.60	30.28	(30.30)

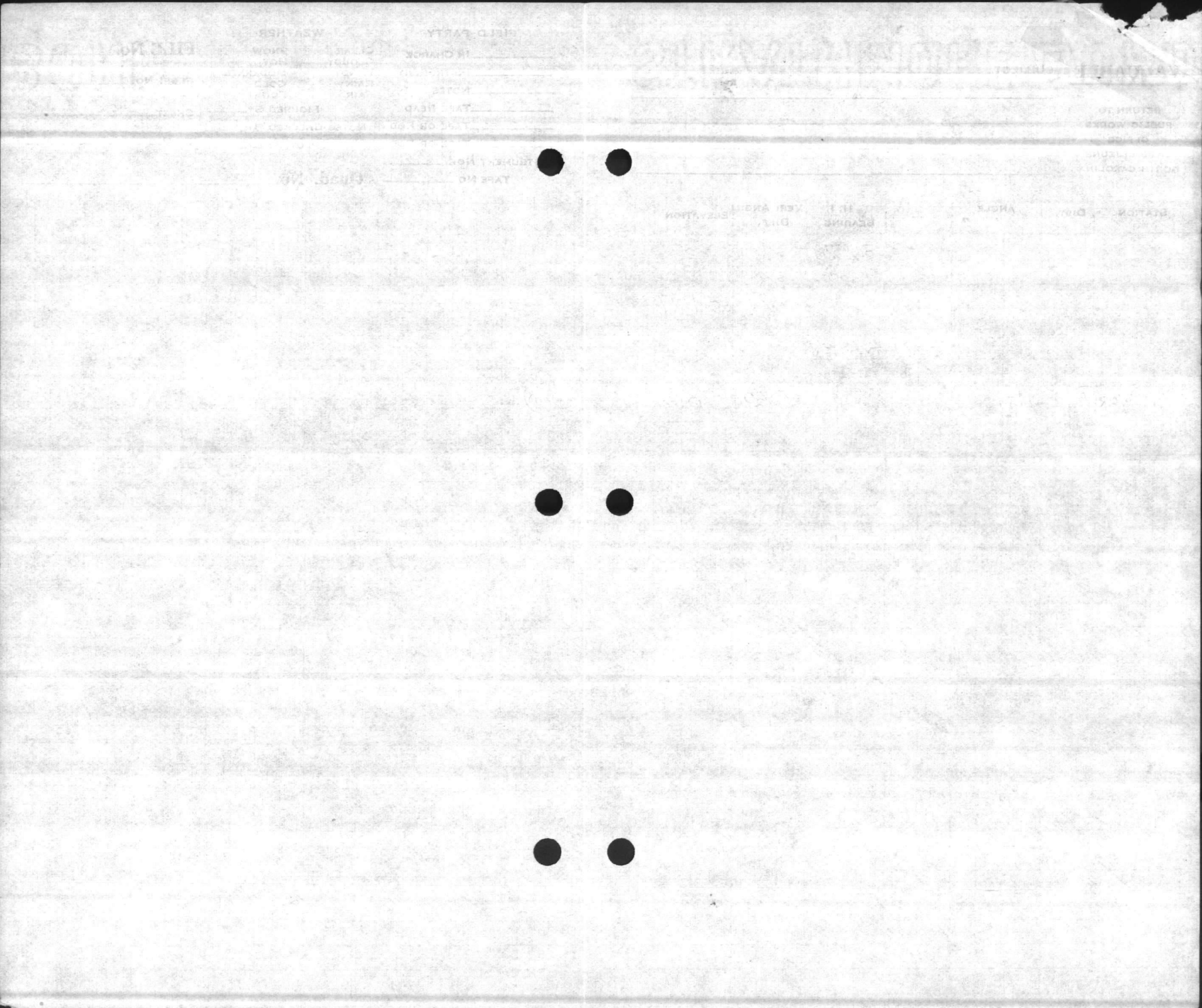

FIELD PARTY

IN CHARGE

TAP HEAD

TAP NO.

STATION

DIP

BEARING

ELEVATION

WIND DIRECTION

WIND FORCE

WIND VELOCITY

WIND PERIOD

WIND TYPE

PUBLIC WORKS DEPARTMENT  
Camp Lejeune, North Carolina  
Survey Department

File 181-8  
Quadrangle \_\_\_\_\_  
Date 8-17-56  
Sheet 1 of 1

Traverse Computation  
Description

*coords. Proposed RAW Water Line*

Station	Distance	Bearing	Cosine	Sine	Latitude	Departure	Y Coordinate North	X Coordinate East
MON. # 105		S 27-48-54 E					324,781.89	2,512,060.11
0+00 NEW WATER LINE = 232+97 EXIST. LINE	1142.84 <del>772.78</del>	S 21-34-44 E	929912	367782	1062.88 <del>747.14</del>	.09 <del>23</del>	323,719.01	2,512,480.20
P.O.T. #3 = 27+00	2700.00 <del>2864.88</del>	S 18-01-54 E	950886	309543	2567.74 <del>294.35</del>	.31 <del>46</del>	321,151.27	2,513,315.51
USMC. MON. # 122	1238.06	N 21-02-49 W	933286	359133	1155.13 <del>46.15</del>	.88 <del>25</del>	322,306.58	2,512,870.62
Fire observation tower S.F. Rd. & Stockade Rd.		S 20-06-29 E						
		20-06-24			-3630.13 +1155.46	+1256.09 -444.63		
					-2474.67	+811.46		
	ERROR	0° 0' 15"	Not Adj.					
P.O.T. #3 27+00		S 18-01-54 E					321,151.27	2,513,315.51
Proposed Well Site 90' Lft. Sta. 27+00	82.55	N 71-58-06 E	309543	950886	25.55	78.50	321,176.82	2,513,394.01

265  
 311  
 515  
 115  
 315  
 515  
 115  
 315



