

PLAN OF NEW DITCH  
NOT TO SCALE

SECTION OF SANITARY PIPING TO PROPOSED 12" DRAINAGE  
SCALE 1/4" = 1'-0"

PROPOSED LABORATORY BUILDING  
REL. 126.6

CLEAR WATER RESERVOIR

CLEAR WATER RESERVOIR

OPEN THIS VALVE FIRST  
CLOSE THE ONE NEXT

NOTES  
All existing sanitary sewer and drainage manholes that are to be relocated or abandoned shall be removed and all pipes, openings or cuttings shall be securely plugged with concrete.  
Foundations of sanitary sewer and drainage structures see Y80 Dwg. N 4886.  
For details of Cast Iron pipe connections between Proposed 2,000,000 Reservoir and existing reservoir see Y80 Dwg. N 4886.

ELECTRIC WORK DATA

- Post Letters
- A. To be inserted in 3/4" dia. base and both sides double arm 1/2" suspension insulators 2" diameter assembly.
  - B. Remove existing 40' 3 Pole.
  - C. New inserted 40' 3 Pole Dead end post insulators double arm wires as supported by vertical insulators.
  - D. Existing 40' 3 Pole as above with 3/4" Transformer 3 Pole dead end and 3/4" 8' x 1/2" 1/2" suspension insulators 2" diameter complete 2" diameter insulator assembly.

ELECTRICAL NOTES  
The symbol indicates the location of the existing pole line to be retained under this contract. It is to be set at the end of existing line to  
The new open between Point A & C to be 3' 6" wide. The existing line will be 4' 6" wide.

LEGEND

- Existing underground Electric Lines
- Existing overhead Electric Lines
- Existing underground Tele. Lines
- Existing overhead Tele. Lines
- Existing High Pressure Gas Meters
- Existing Water Lines
- Existing Sanitary Sewer Manholes
- Existing Storm Sewer
- Proposed overhead Electric Lines
- Proposed Water Lines
- Proposed Sanitary Sewer Manholes
- Proposed Storm Sewer

C	11/51	JTC	RELOCATION 24" CONC. DRAIN & 6" SANITARY SEWER	11/51
B	8/15	JTC	RELOCATION 30" AND 18" CONC. PIPE	8/15
A	5/26	JTC	ADDITION OF NOTES & ALTERATION OF PIPE SIZE	5/26
REVISION DATE / APPD.			DESCRIPTION	
P.W. DRAWING NO. 7869			MARINE BARRACKS CAMP LEVEUNE, N. C.	
DES. BY			CORRECTION OF DEFICIENCIES IN RAW WATER SYSTEM	
DRWN. BY			2,000,000 GALLON RESERVOIR SITE AND UTILITIES PLAN	
CHK. BY			APPROVED	
SUPV. BY			DATE 11/7/51	
IN CHARGE			PUBLIC WORKS OFFICER	
APPROVED			SCALE 1/4" = 1'-0" SHEET 12 OF 20 SPEC 2707.9 NOV 24 1951	
THE QUARTERMASTER GENERAL OF THE MARINE CORPS			Y. & O. DRAWING NO. 4886	
DATE				

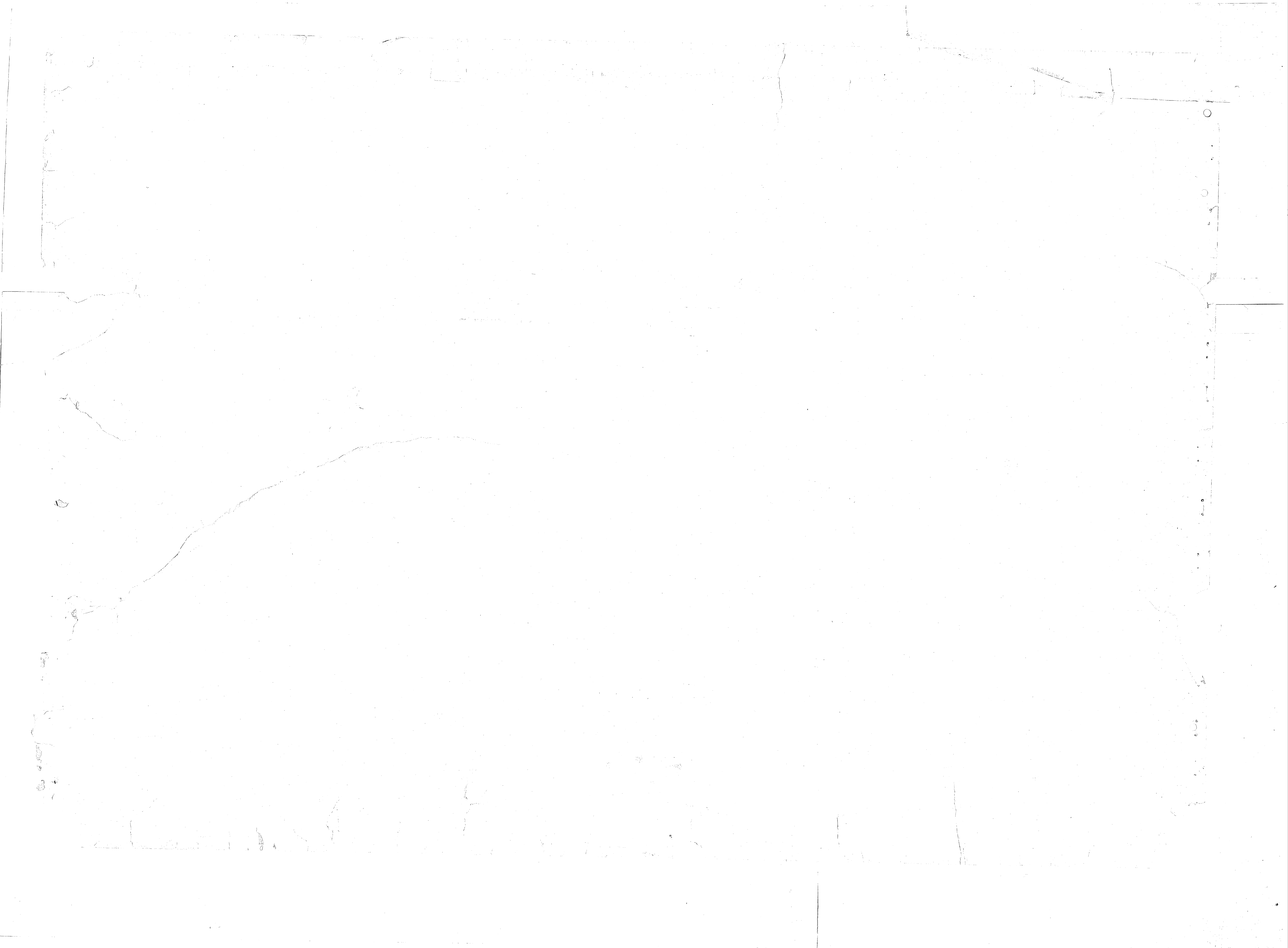

OPEN THIS VALVE FIRST  
←  
CLOSE THIS ONE  
↓ NEXT

NOV 19 1954  
GOSPEL  
1954

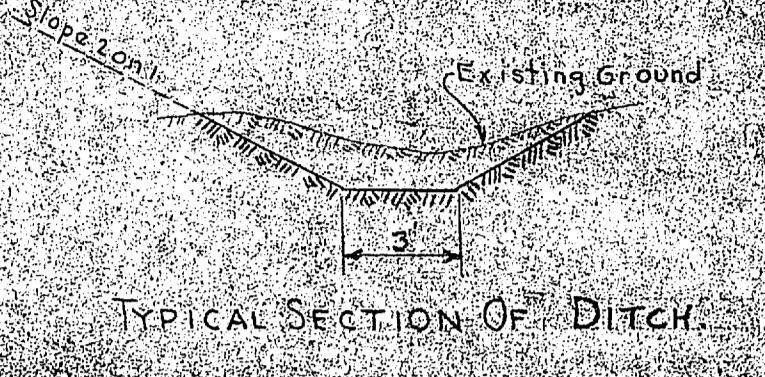

TYPICAL SECTION OF DITCH

PLAN OF NEW DITCH  
DIA. TO SCALE

See Note 1. Ditch to be located between Station 5+00 and Station 5+10. Ditch to be 3 feet wide at top and 1 foot wide at bottom. Ditch to be 1 foot deep. Ditch to be 3:1 slope. Ditch to be 1 foot wide at top and 1 foot wide at bottom. Ditch to be 1 foot deep. Ditch to be 3:1 slope.

RELOCATION OF CONC. DRAIN & SANITARY SEWER  
LEJEUNE

Scale: 1" = 20'

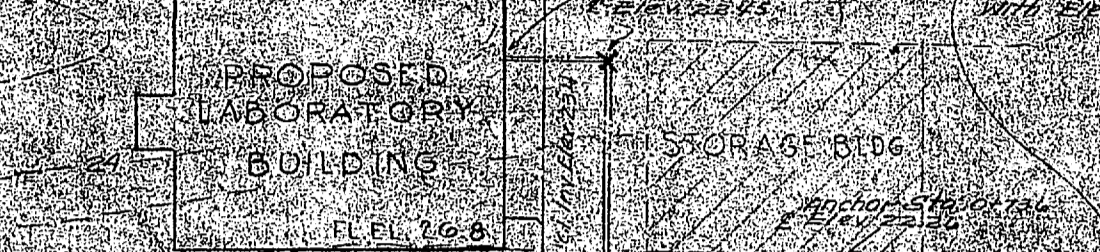

PROPOSED LABORATORY BUILDING  
STORAGE SHED

Scale: 1" = 20'

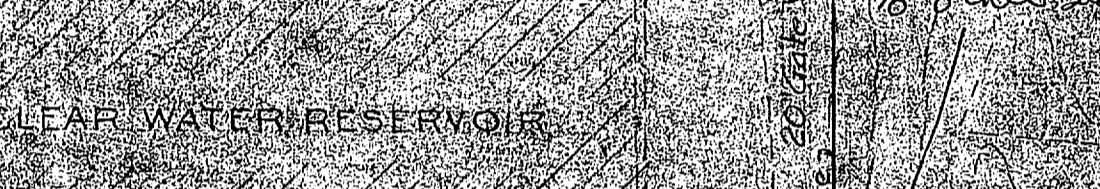

CLEAR WATER RESERVOIR

Scale: 1" = 20'



WATER PLANT

Scale: 1" = 20'

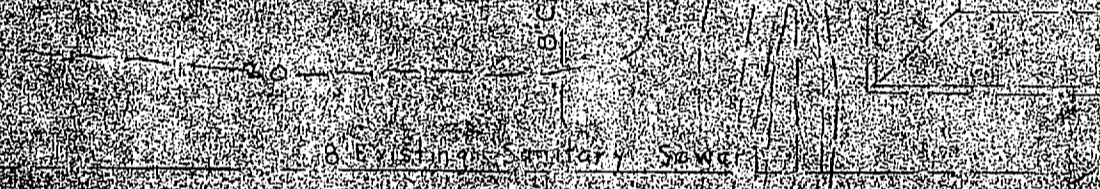

VALVE HOUSE

Scale: 1" = 20'

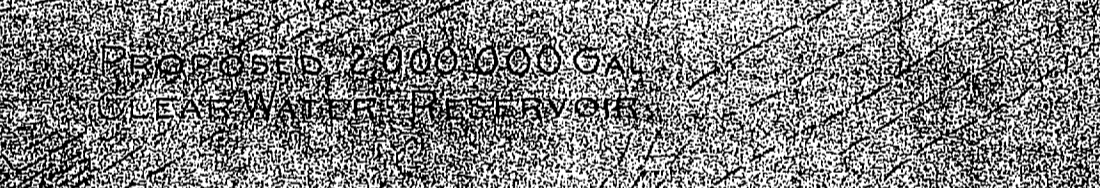

CLEAR WATER RESERVOIR

Scale: 1" = 20'

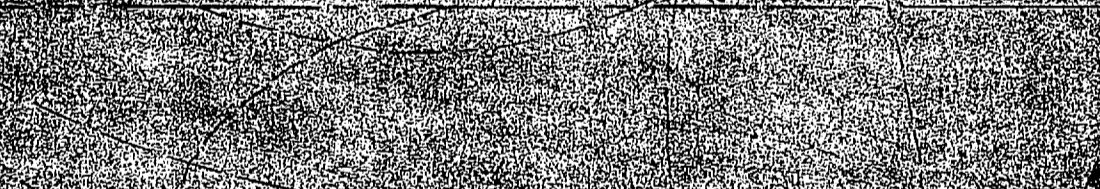

CLEAR WATER RESERVOIR

Scale: 1" = 20'



CLEAR WATER RESERVOIR

Scale: 1" = 20'



CLEAR WATER RESERVOIR

Scale: 1" = 20'

1-15  
2-10

**NOTES**  
All existing sanitary sewer and drain manholes that are to be relocated or abandoned shall be removed and all pipes, incoming or outgoing, shall be securely plugged with concrete.  
For details of sanitary sewer and drainage structures see Y&D 4000.  
For details of Cast Iron Pipe connections between Proposed 2,000,000 Gallon Reservoir and existing reservoir, see Y&D 4000.

**Electric Work DATA**  
Point Lines  
A. No. 14 wire used for 3 poles. Use and both 1000 Volt 4" x 7" Substation Insulators 2" on each side. Complete with Anchor and Insulator Assembly.  
B. Remove existing 40-3 Pole.  
C. New inserted 40-3 Pole. Use and both 1000 Volt Double Arm Wires. 2" on each side by Vertical Insulator.  
D. Existing 40-3 Pole. Use and both 1000 Volt Double Arm Wires. 2" on each side by Vertical Insulator. Complete with Anchor and Insulator Assembly.

**ELECTRICAL NOTES**  
This symbol indicates that the utility is to be revised under this contract in order to affect the change of existing poles.  
The arrow points to the pole to be removed. The arrow points to the pole to be added.

**LEGEND**  
Existing underground Electric Line  
Existing overhead Electric Line  
Existing underground Telephone Line  
Existing overhead Telephone Line  
Existing High Pressure Steam Pipe  
Existing High Pressure Steam Return  
Existing Water Line  
Existing Sanitary Sewer Manhole  
Existing Storm Sewer  
Proposed overhead Electric Line  
Proposed Raw Water Line  
Proposed sanitary sewer Manhole  
Proposed storm Sewer

NO.	DATE	DESCRIPTION
1	9/15/51	RELOCATION OF CONC. DRAIN & SANITARY SEWER
2	8/1/54	RELOCATION OF CONC. DRAIN & SANITARY SEWER
3	10/1/54	ADDITION OF NOTES & ALTERATION OF PIPE SIZE
REVISION DATE / APPD.		DESCRIPTION
7869		MARINE BARRACKS CAMP LEJEUNE, N. C.
DES. L.L.V.		CORRECTION OF DEFICIENCIES IN RAW WATER SYSTEM 2,000,000 GALLON RESERVOIR SITE AND UTILITIES PLAN
DRWN. J.S.		
TR. J.S.		
CHKD. L.L.V.		
SUPV. J.S.		
IN CHARGE		APPROVED: <i>E. R. Remitt</i> DATE: 9/1/54
APPROVED		PUBLIC WORKS OFFICER
THE QUARTERMASTER GENERAL OF THE MARINE CORPS		SCALE: 1" = 20' SPEC: 27079
DATE		SHEET 12 OF 20 NO. 24977
		Y & D DRAWING NO. 4868F

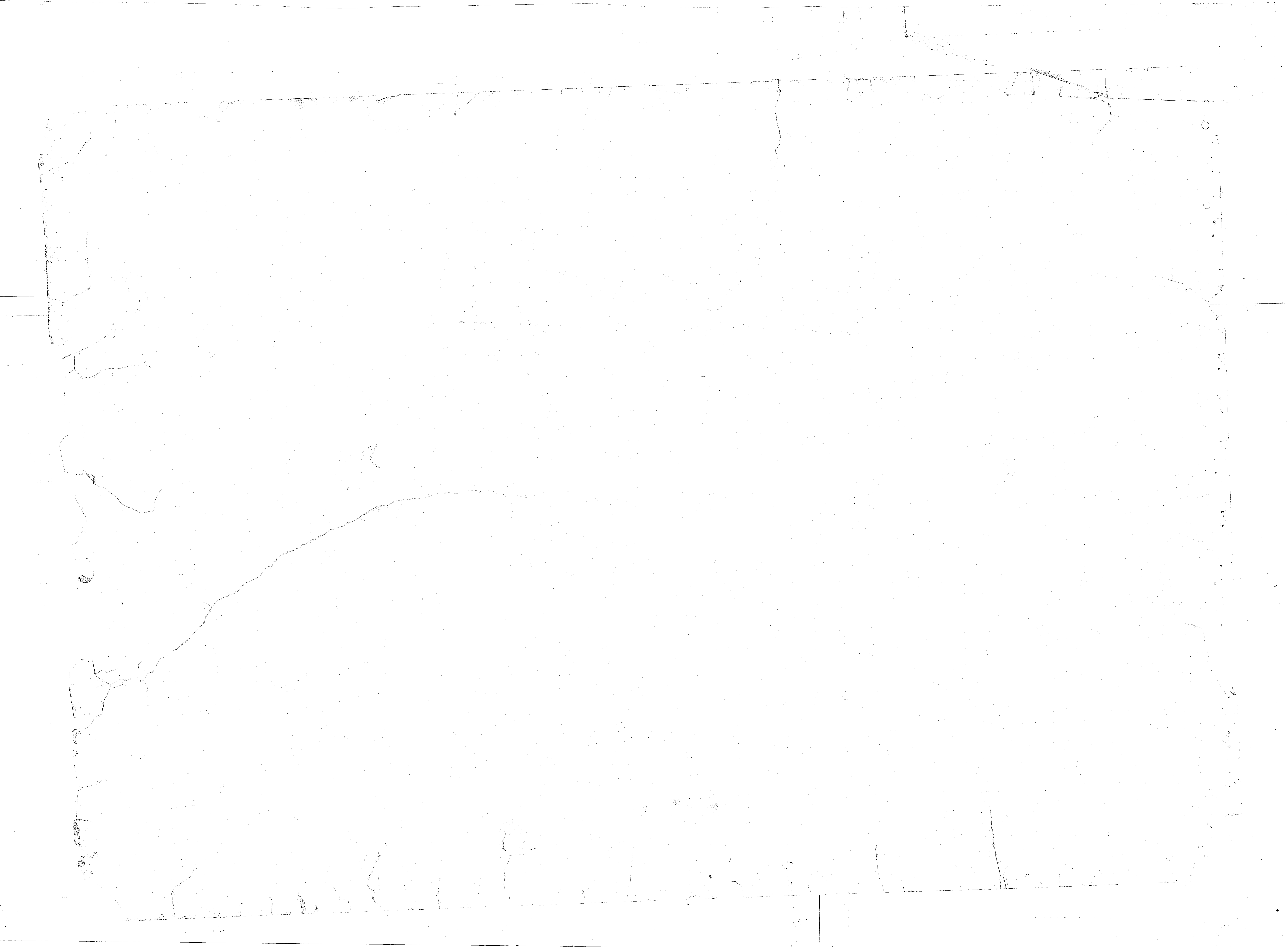

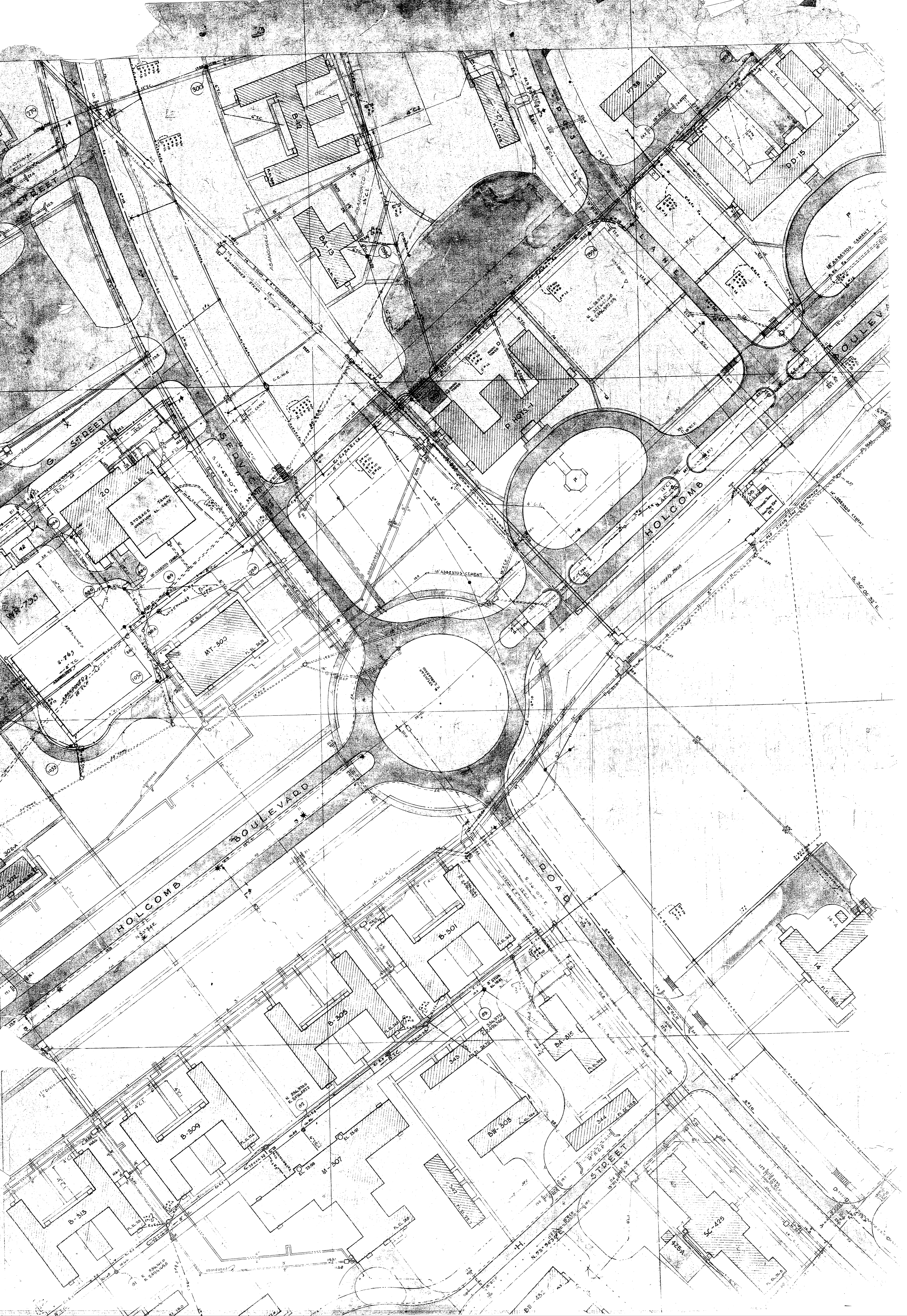

R.P. Pool



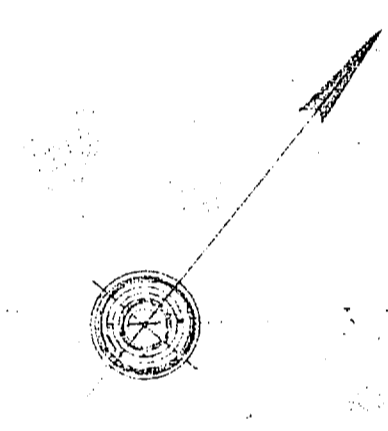
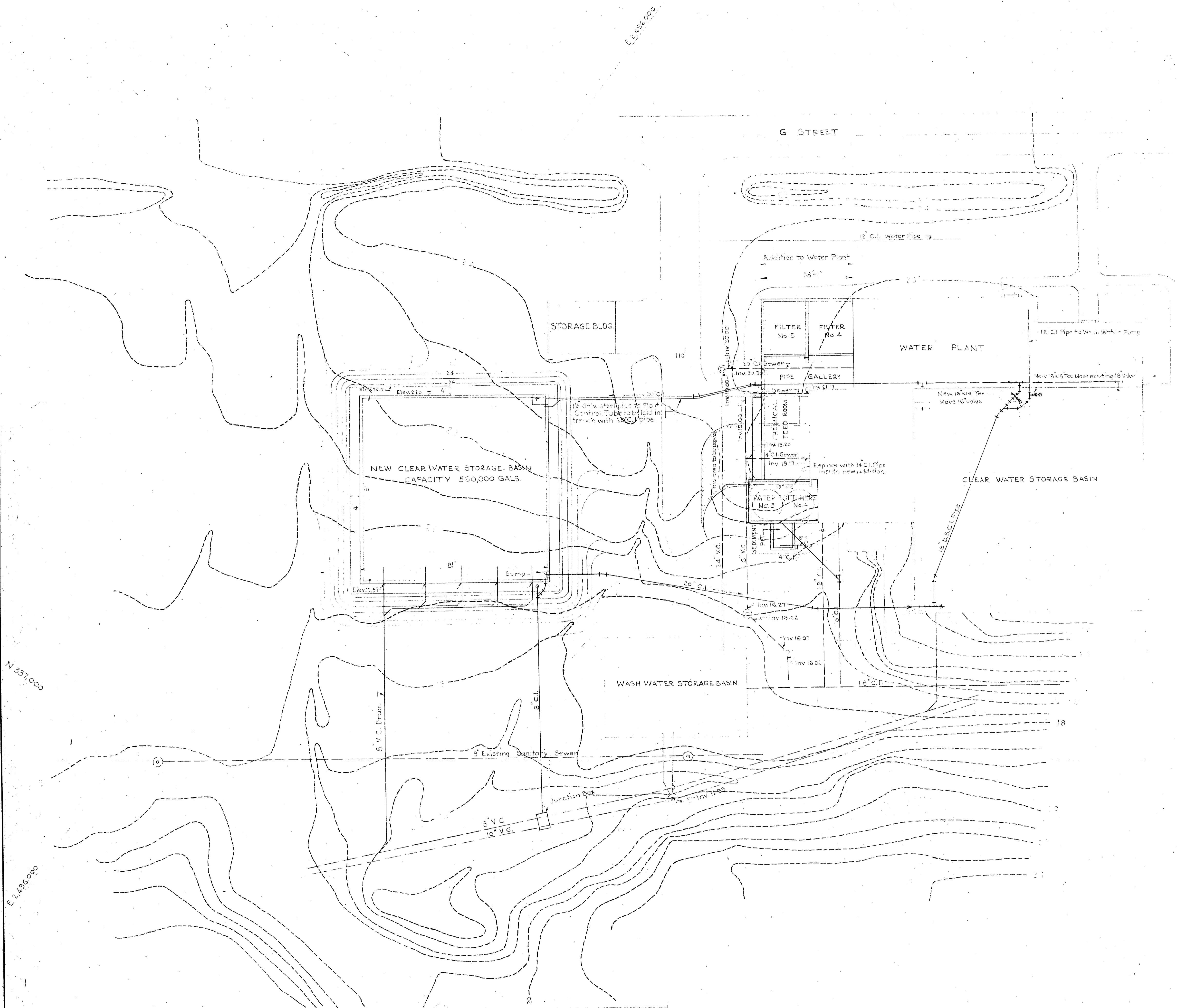

**LEGEND**  
 --- Denotes existing contours  
 - - - - - New contours  
 --- Denotes existing pipe  
 --- New pipe  
 --- Denotes new construction

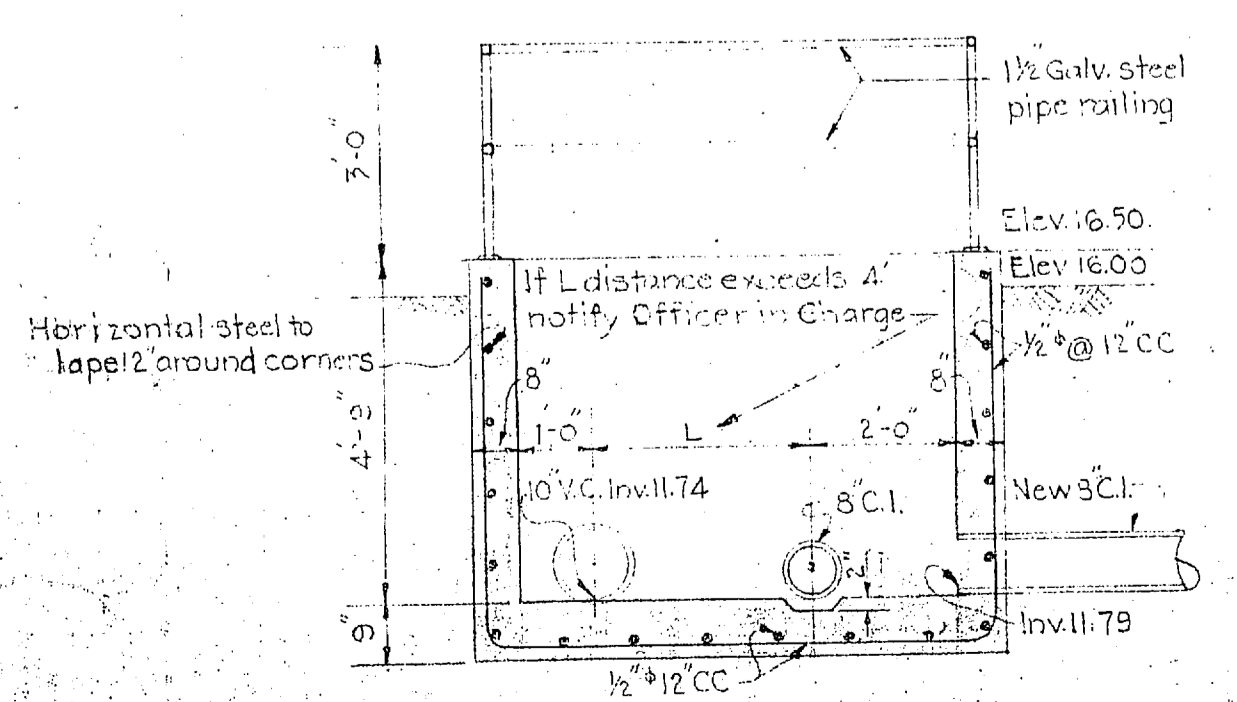

**SECTION A-A**  
 Scale 3/8"=1'-0"

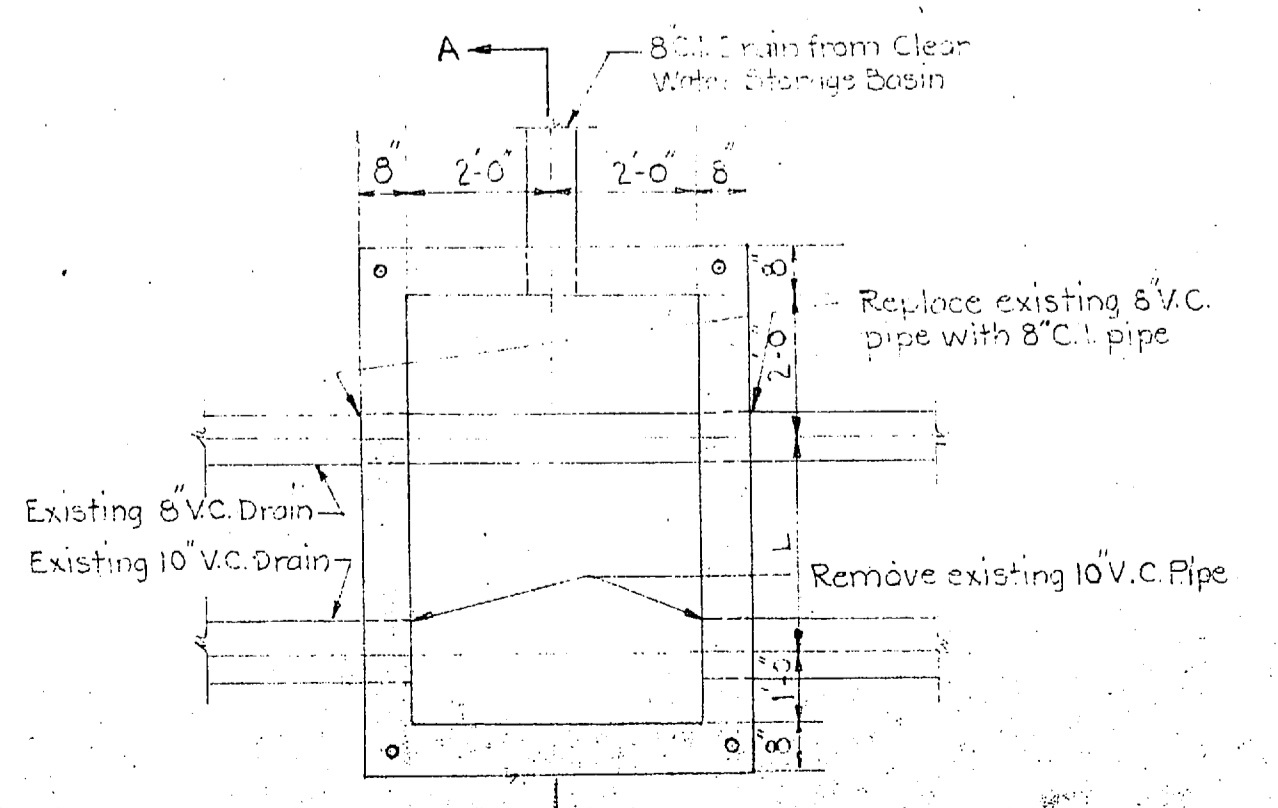

**PLAN OF JUNCTION BOX**  
 Scale 3/8"=1'-0"

CONTRACT NOY - 11255

DRAWN BY I.S.K. TRACED BY I.S.K. CHECKED BY M.F.W. CHIEF DFMN E.W.L. IN CHARGE DATE Sept. 13, 1944 SCALE 1"=20' Y. & D. DRAWING NO. <b>304810</b>	<b>CARR &amp; J. E. GREINER CO.—ARCHITECT-ENGINEERS</b> DURHAM, N. C. BALTIMORE, MD. <b>CAMP LEJEUNE — NEW RIVER, N. C.</b> BUREAU OF YARDS AND DOCKS — U. S. NAVY <b>ADDITION TO WATER TREATMENT PLANT</b> DIVISION TRAINING AREA <b>GENERAL LOCATION</b> <b>AND GRADING PLAN</b> PROJECT NO. P-1517 A.E. CONT. NO. C-441 SHEET 11 OF 17 P.W. DRG. NO. 304
ARCHITECT-ENGINEERS SPECIFICATION NO. 1558	APPROVED 19 Feb 1945 BY <i>[Signature]</i> OFFICER IN CHARGE

REVISION	DATE	BRIEF	BY	IN CHARGE



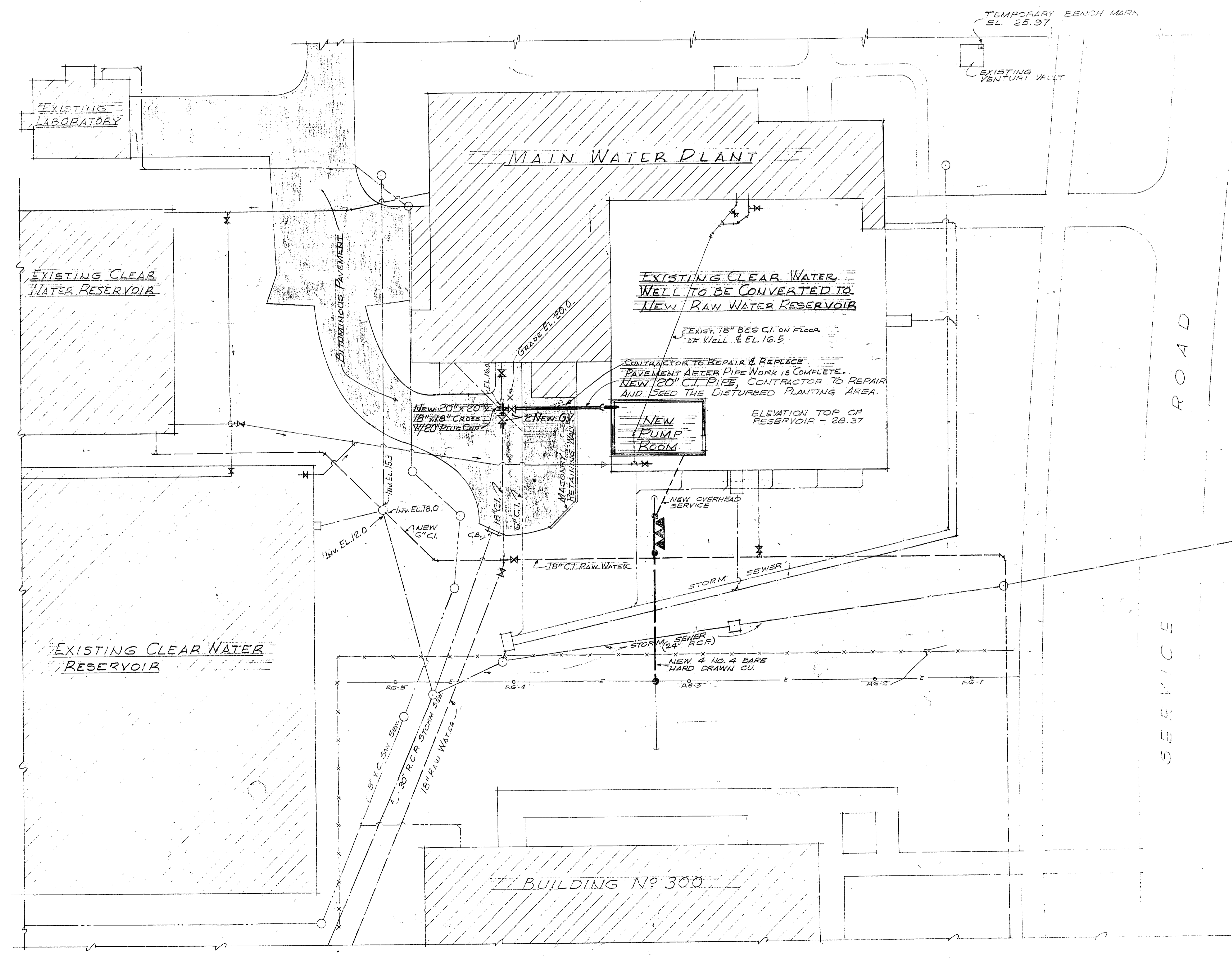
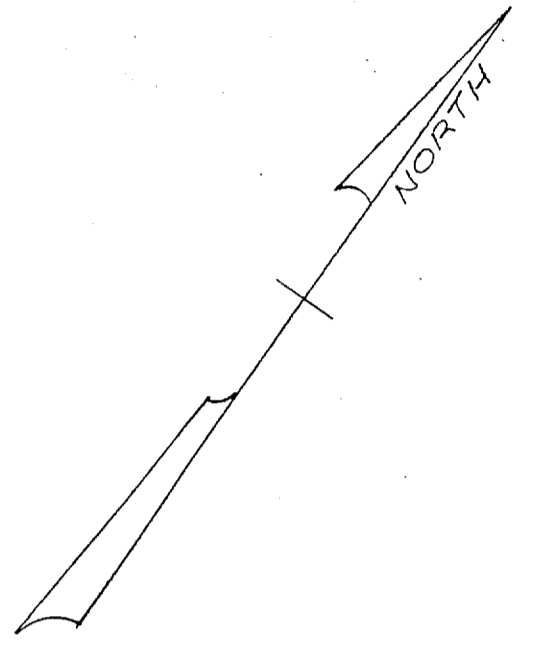

TEMPORARY BENCH MARK  
EL. 25.37

EXISTING  
VENTURI VALVE

MAIN WATER PLANT

EXISTING  
LABORATORY

EXISTING CLEAR  
WATER RESERVOIR

EXISTING CLEAR WATER  
WELL TO BE CONVERTED TO  
NEW RAW WATER RESERVOIR

EXIST. 18" BES CI. ON FLOOR  
OF WELL @ EL. 16.5

CONTRACTOR TO REPAIR & REPLACE  
PAVEMENT AFTER PIPE WORK IS COMPLETE.  
NEW 120" CI. PIPE, CONTRACTOR TO REPAIR  
AND SEED THE DISTURBED PLANTING AREA.

NEW  
PUMP  
ROOM

ELEVATION TOP OF  
RESERVOIR - 25.37

NEW 20" x 20" x 18" x 18" CROSS  
1/2" RCP

NEW 18" CI

NEW 18" CI

NEW 18" CI

NEW 18" CI

NEW 18" CI

NEW 18" CI

NEW 18" CI

NEW 18" CI

NEW 18" CI

NEW 18" CI

NEW 18" CI

NEW 18" CI

NEW 18" CI

NEW 18" CI

NEW 18" CI

BUILDING NO. 300

ROAD  
SERVICE

- LEGEND**
- EXISTING SAN SEWER
  - EXISTING STORM SEWER
  - EXISTING RAW WATER
  - EXISTING FRESH WATER
  - EXISTING OVERHEAD ELECTRIC
  - NEW FRESH WATER
  - NEW OVERHEAD ELECTRIC
  - NEW OVERHEAD ELECTRIC SERVICE

**PLOT PLAN**  
SCALE 1" = 20'

SCALE 1" = 20'

AS BUILT		DATE	APPROVAL
REVISIONS			
SYMBOL	DESCRIPTION	DATE	APPROVAL
DPW DRAWING NO.	DEPARTMENT OF THE NAVY DISTRICT PUBLIC WORKS OFFICE	BUREAU OF YARDS & DOCKS 5 TH RD. NORFOLK, VA.	
50750	L. E. WOOTEN & COMPANY CONSULTING ENGINEERS	RALEIGH, N.C.	
DES.	U. S. MARINE CORPS BASE		
DRWN.	CAMP LEJEUNE	NORTH CAROLINA	
CHK.	REHABILITATION RAW WATER SUPPLY		
PROJ. MGR.	DPWO		
CHK.			
SR. MGR.			
SP. ASST.			
DIR. DES.			
APPROVED	OFFICER IN CHARGE	DATE	
SUBMITTED BY L. E. WOOTEN & CO.	APPROVED FOR BUREAU OF YARDS & DOCKS	SCALE 1" = 20'	SPEC. 28210.51
DATE	FOR CHIEF OF BUREAU	SHEET 2 OF 14	JBY
DATE	B. D. DRAWING NO. 2425		

SATISFACTORY TO  
AS/5, 6-4 FOR COMMANDING GENERAL  
DATE

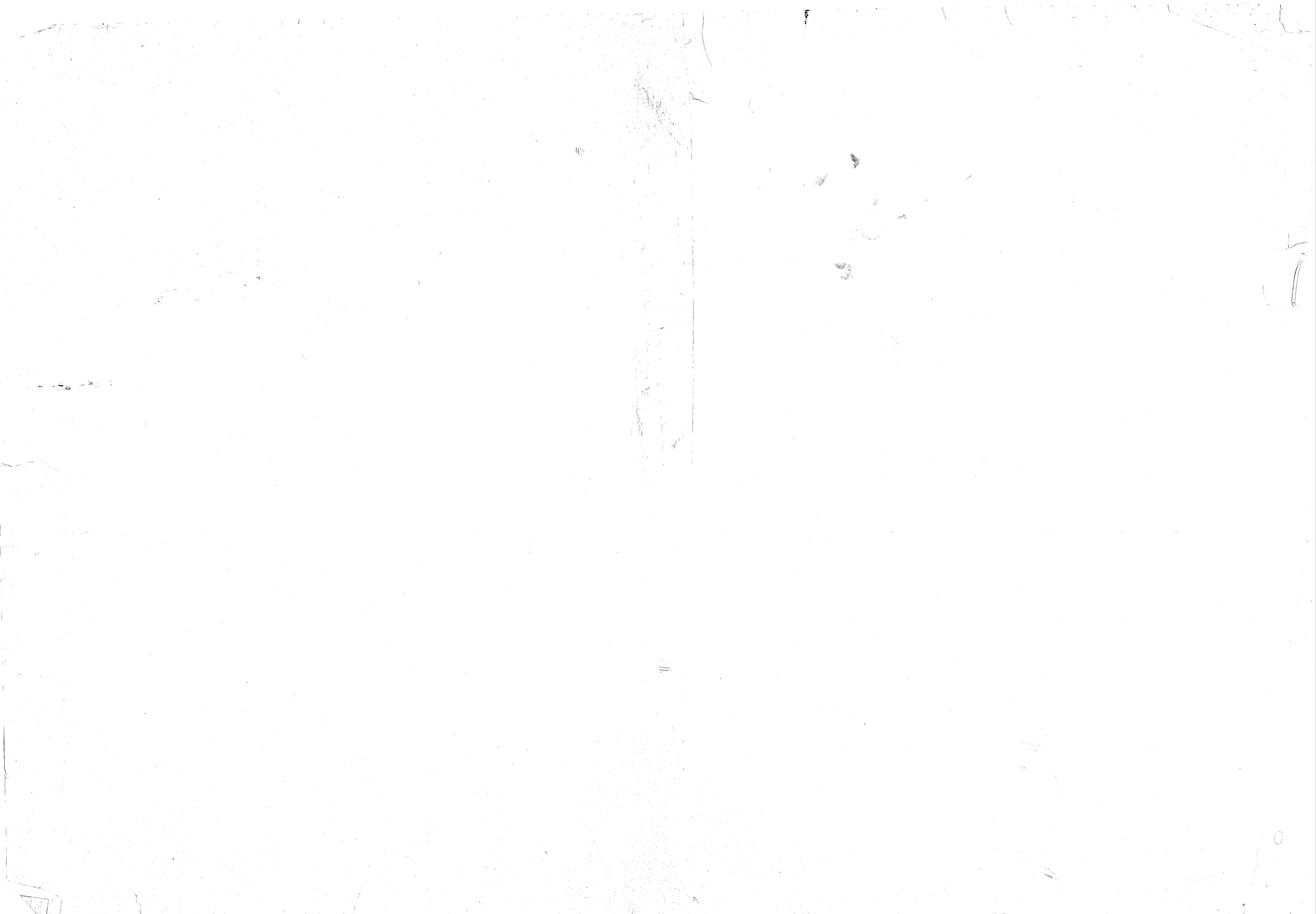

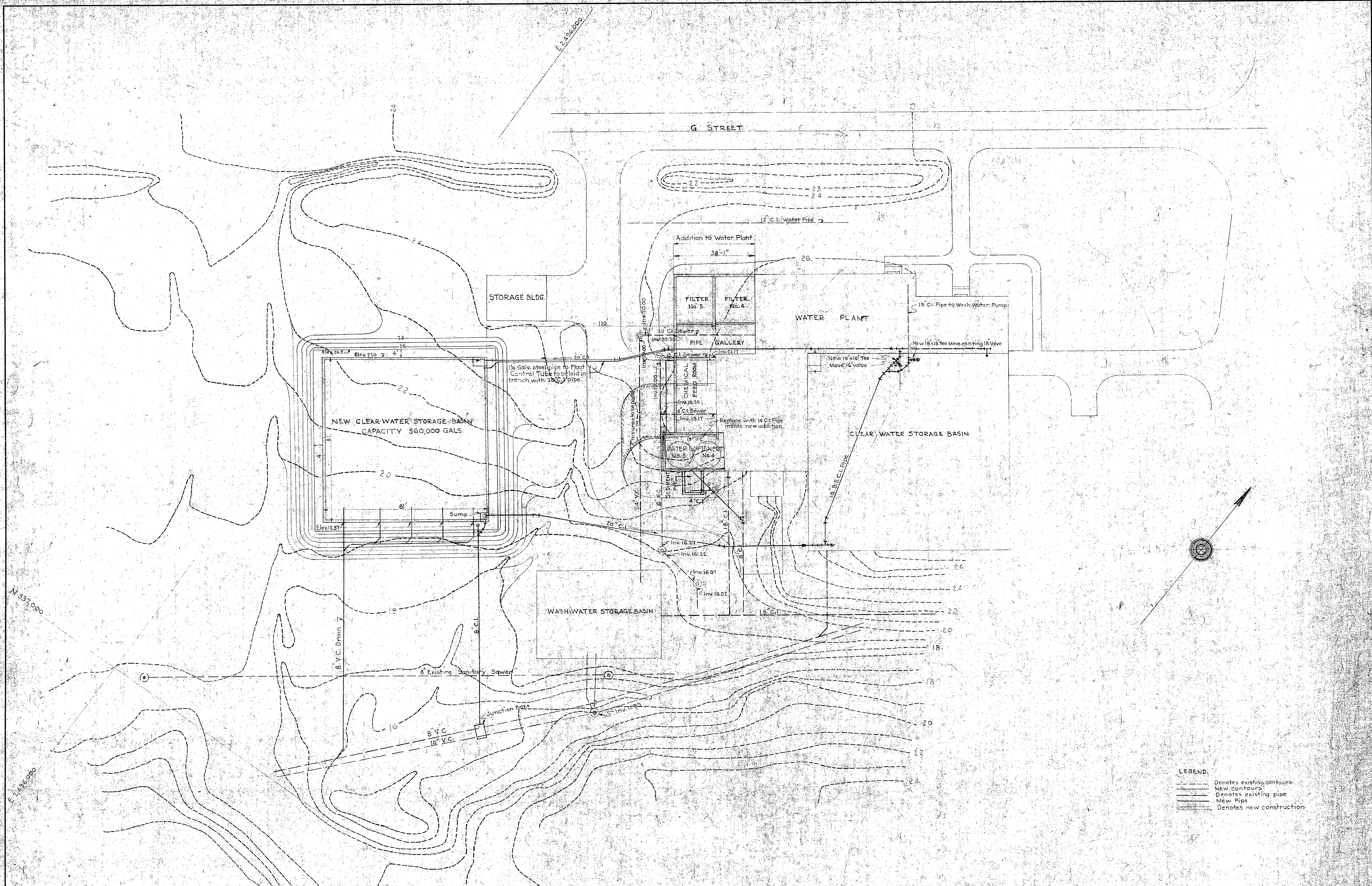

**LEGEND**  
 --- Denotes existing contours  
 - - - - - New contours  
 ——— Denotes existing pipe  
 - - - - - New Pipe  
 [ ] Denotes new construction

CONTRACT NOY-11255

CARR & J. E. GREINER CO.—ARCHITECT-ENGINEERS  
 DURHAM, N. C. BALTIMORE, MD.  
**CAMP LEJEUNE — NEW RIVER, N. C.**  
 BUREAU OF YARDS AND DOCKS — U. S. NAVY

ADDITION TO WATER TREATMENT PLANT  
 DIVISION TRAINING AREA

**GENERAL LOCATION AND GRADING PLAN**

DRAWN BY J. S. K.  
 TRACED BY S. K.  
 CHECKED BY M. F. W.  
 CHIEF DEPT. B. W. L.  
 IN CHARGE [Signature]  
 DATE Sept. 13, 1944  
 SCALE 1" = 10'

**304810**

APPROVED 19 Feb 1945  
 [Signature]  
 PROJECT NO. 304810  
 REPORT NO. C-441  
 SHEET 11 of 17  
 DRAWING NO. 304

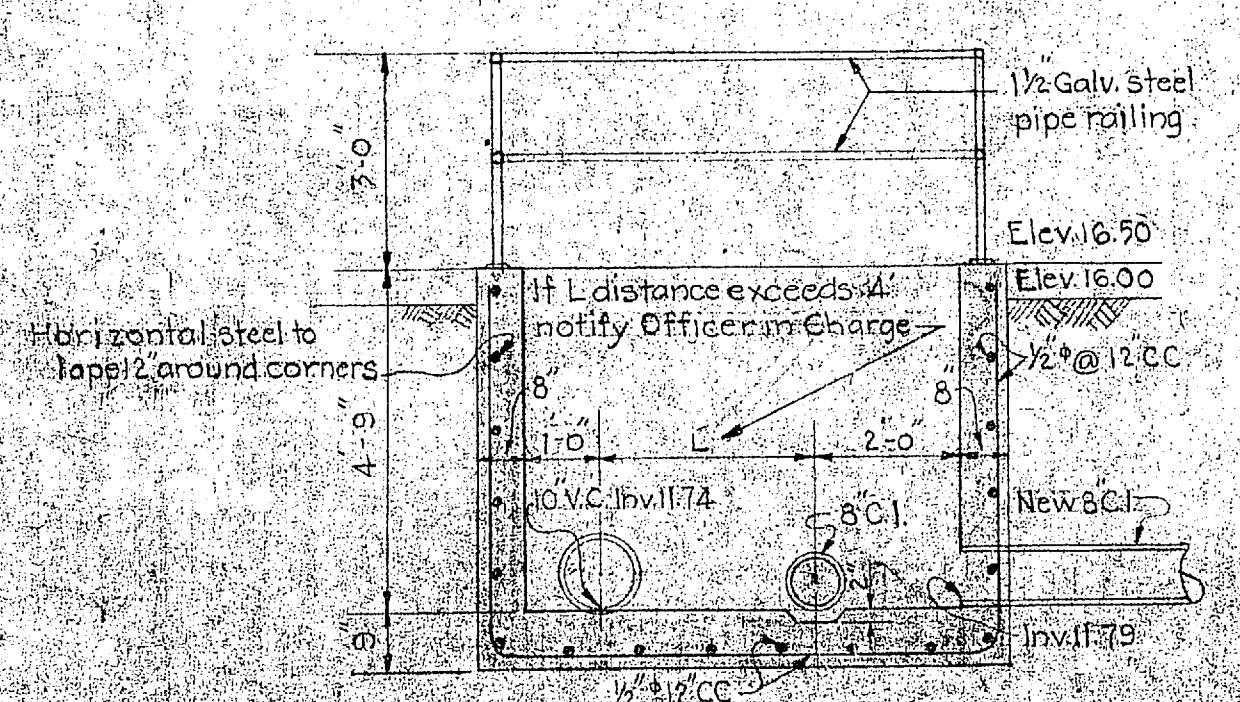

SECTION A-A  
 Scale 1/8" = 1'-0"

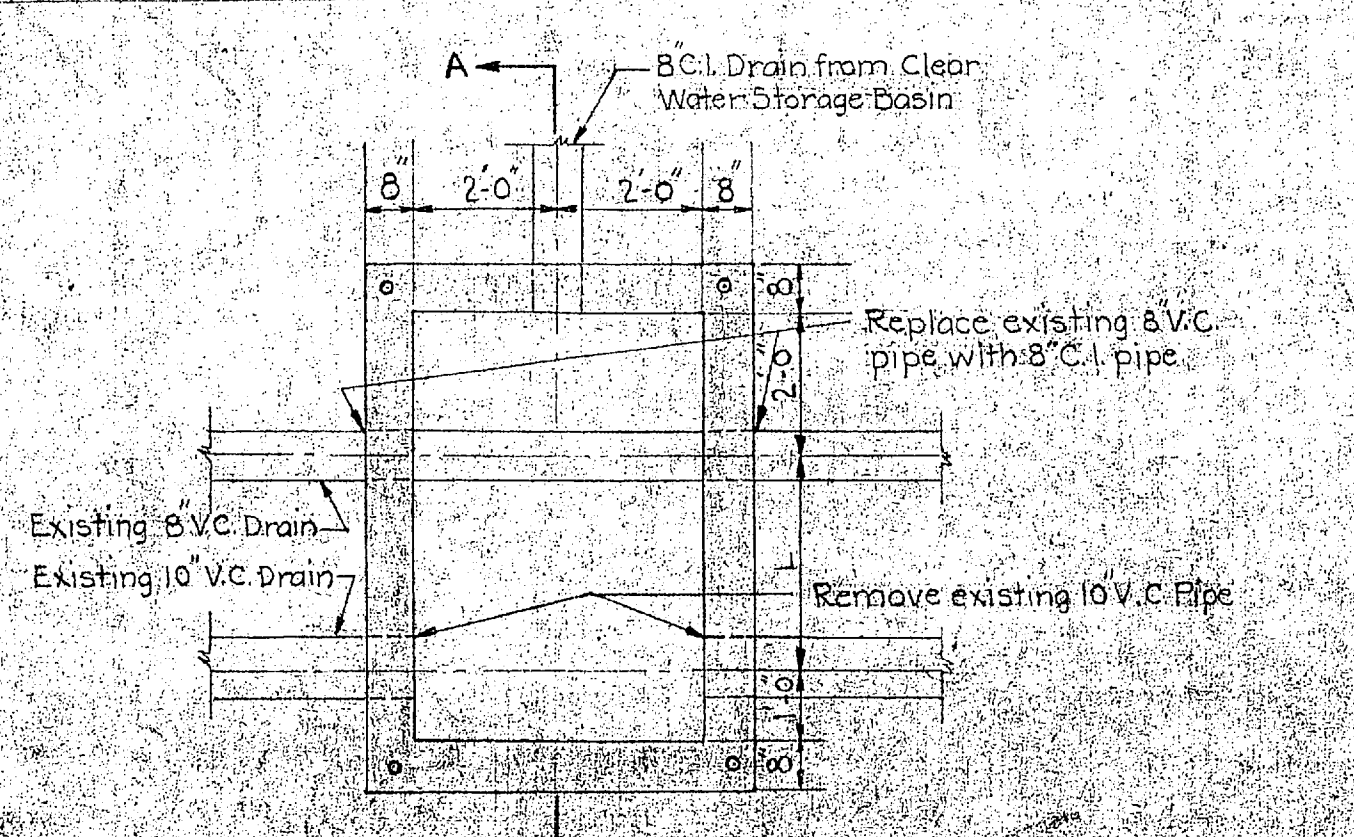

PLAN OF JUNCTION BOX  
 Scale 1/8" = 1'-0"

REVISION	DATE	BY	IN CHARGE

