

E014

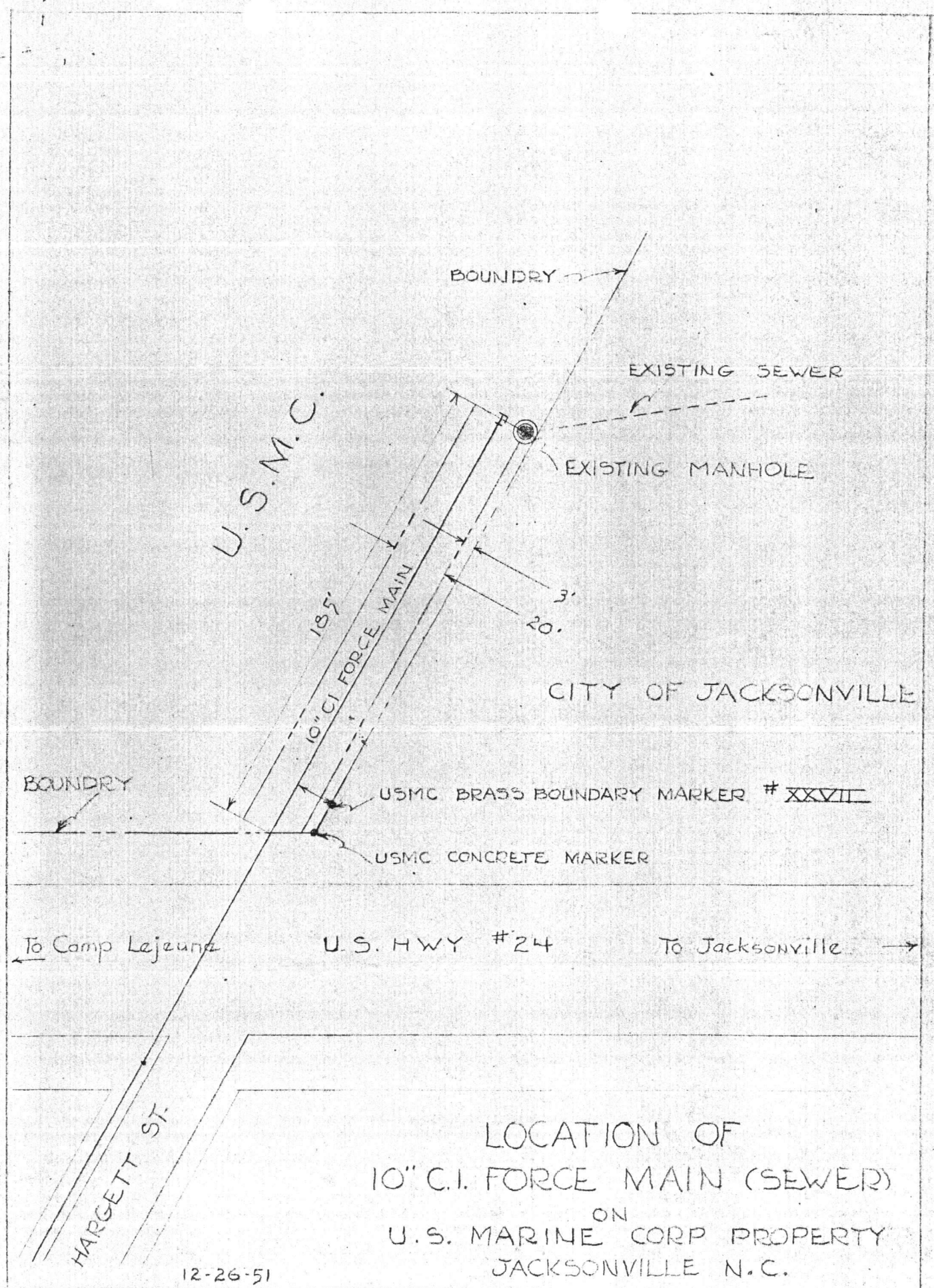

LOCATION OF
 10" C.I. FORCE MAIN (SEWER)
 ON
 U.S. MARINE CORP PROPERTY
 JACKSONVILLE N.C.

E014

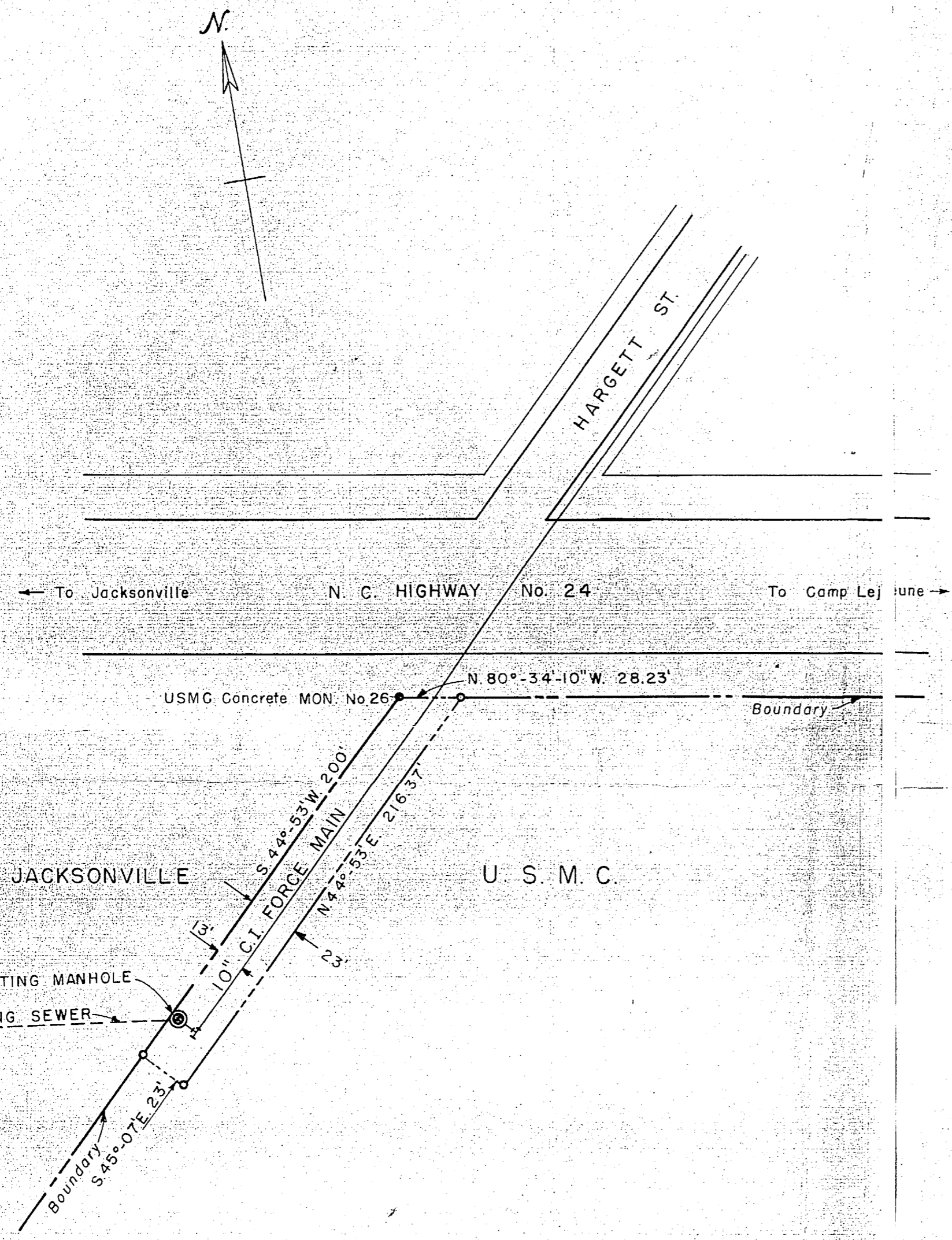

DESCRIPTION

BEGINNING at a point, said point being designated as USMC Monument No. 26 and located 50' South of the center line of N. C. Route 24, being also on the Right of Way of the North Carolina State Highway Commission and the division line of lands belonging to private individuals; thence along the division line, being also the boundary of lands belonging to the USMC S44°53'W. a distance of 200.0' to an angle point; thence S45°07'E. a distance of 23'0' to an angle point; thence N.44°53'E. a distance of 216.37' to a point in the boundary line of the USMC, said point being also on the Right of Way of the North Carolina State Highway Commission; thence along said boundary and Right of Way line N.80°34'10\" W. a distance of 28.23' more or less to POINT OF BEGINNING. Containing 0.11 Acres more or less.

REVISION	DATE	APPD.	DESCRIPTION	BY
P. W. DRAWING NO.		MARINE CORPS BASE		
9695		CAMP LEJEUNE, N. C.		
DES	CITY OF JACKSONVILLE, N. C. NEW RIVER SEWER MAIN PLAT AND DESCRIPTION			
DRWN				
TR <i>Fairman</i>				
CHK <i>Fairman</i>				
SUPV				
IN CHARGE <i>Fairman</i>		APPROVED	DATE 9 Oct. 1953	
APPROVED		PUBLIC WORKS OFFICER		
THE QUARTERMASTER GENERAL OF THE MARINE CORPS		SCALE 1" = 50'	SPEC	
DATE		SHEET 1 OF 1 NOY		
		Y & D DRAWING NO. 613795		

5

