

REVISIONS			
SYM	DESCRIPTION	DATE	APPROVED

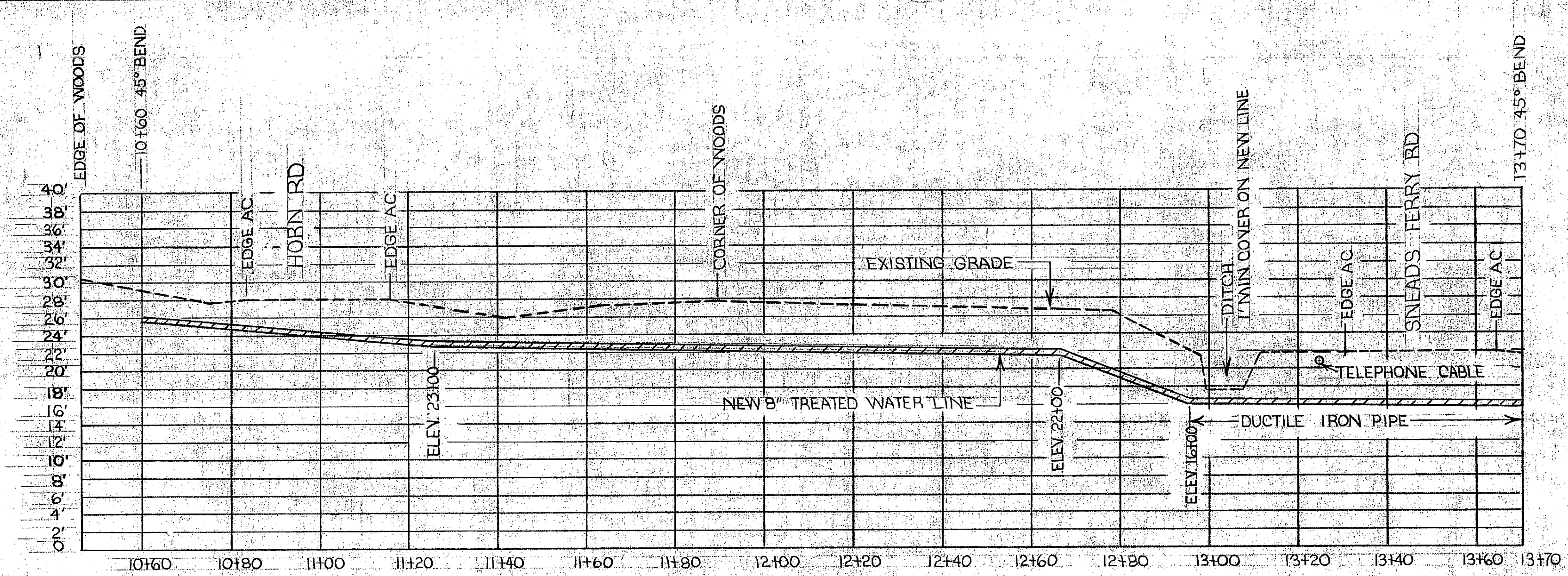

PROFILE OF HORN ROAD - SNEADS FERRY ROAD INTERSECTION
 SCALE: 1"=10'-0" VERTICAL
 1"=20'-0" HORIZONTAL

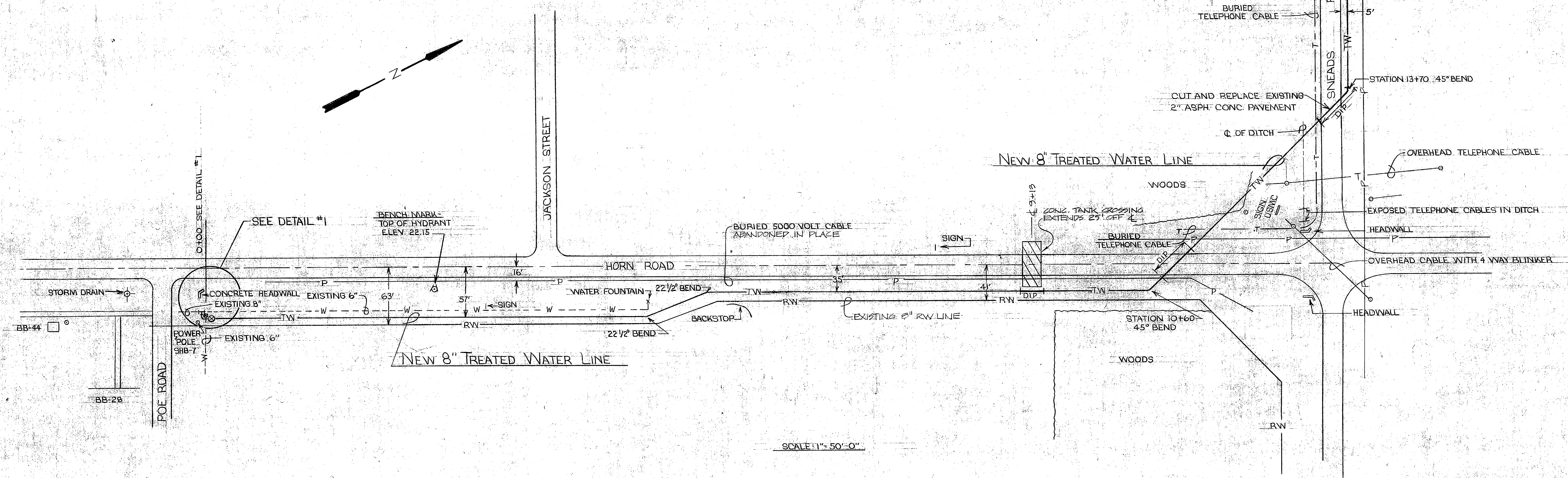

SCALE 1"=50'-0"

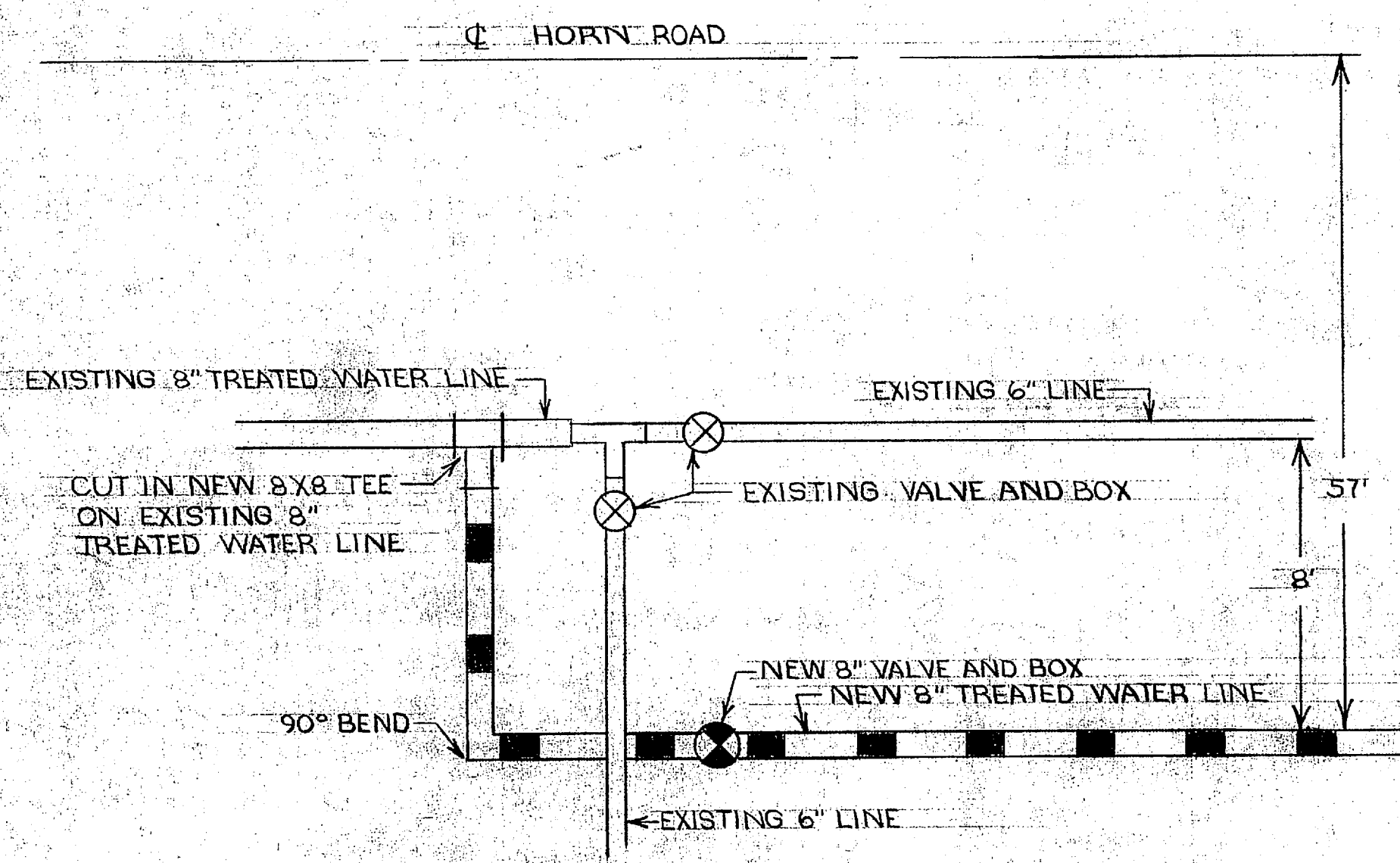

DETAIL #1 SHOWING TIE-IN FOR NEW 8" LINE
 TO EXISTING 6" TREATED WATER LINE
 SCALE: N.T.S.

- LEGEND**
- P- POWER LINE
 - T- TELEPHONE LINE
 - RW- RAW WATER LINE
 - TW- TREATED WATER LINE
 - DIP- DUCTILE IRON PIPE
 - ⊗ VALVE
 - W- EXISTING POTABLE WATER LINE
 - ⊙ POWER POLE

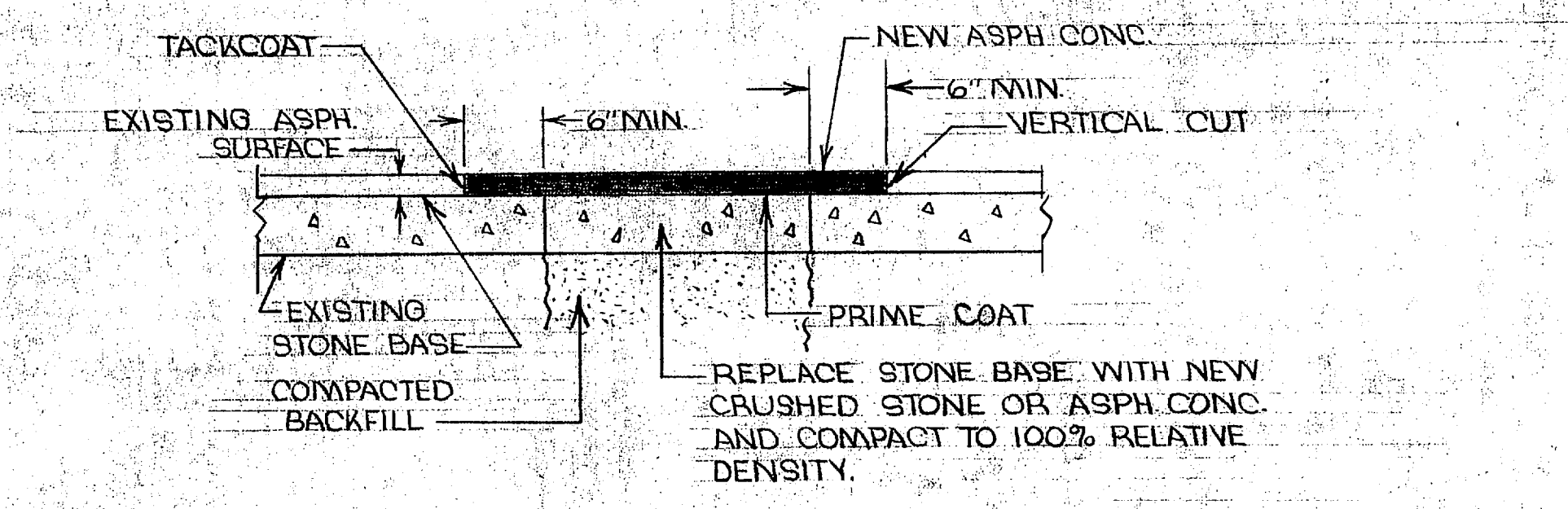

TYPICAL SECTION FOR REPAIR TO ASPHALTIC CONCRETE
 SCALE: N.T.S.

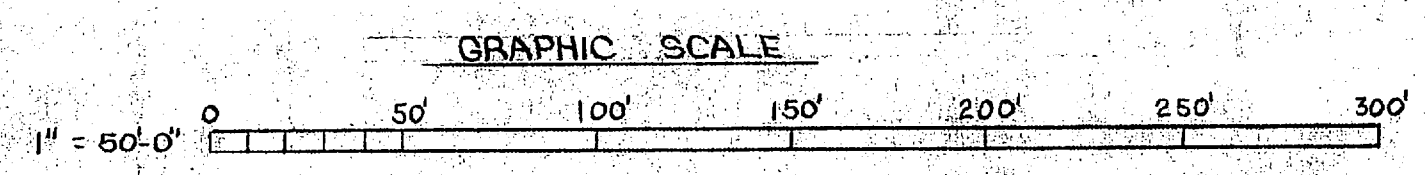

BB AREA

PUBLIC WORKS DEPT. MARINE CORPS BASE CAMP LEJEUNE, N.C.		DEPARTMENT OF THE NAVY NAVAL FACILITIES ENGINEERING COMMAND ATLANTIC DIVISION NORFOLK, VIRGINIA	
DESIGNER: <i>CHK 8/18</i>	DATE: <i>8/18/78</i>	SIZE: F	CODE IDENT NO: 80091
APPROVER: <i>CHK 8/18</i>	DATE: <i>8/18/78</i>	NAVAC DRAWING NO: 401175	
Satisfactory to: <i>CHK 8/18</i>		CONSTR. CONTR. NO: 2470-10-00001	
COMMISS. GENERAL: <i>W/18</i>	DATE: <i>8/18/78</i>	SCALE: GRAPHIC	SHEET 2 OF 3
APPROVED: <i>W/18</i>		SHEET 2 OF 3	

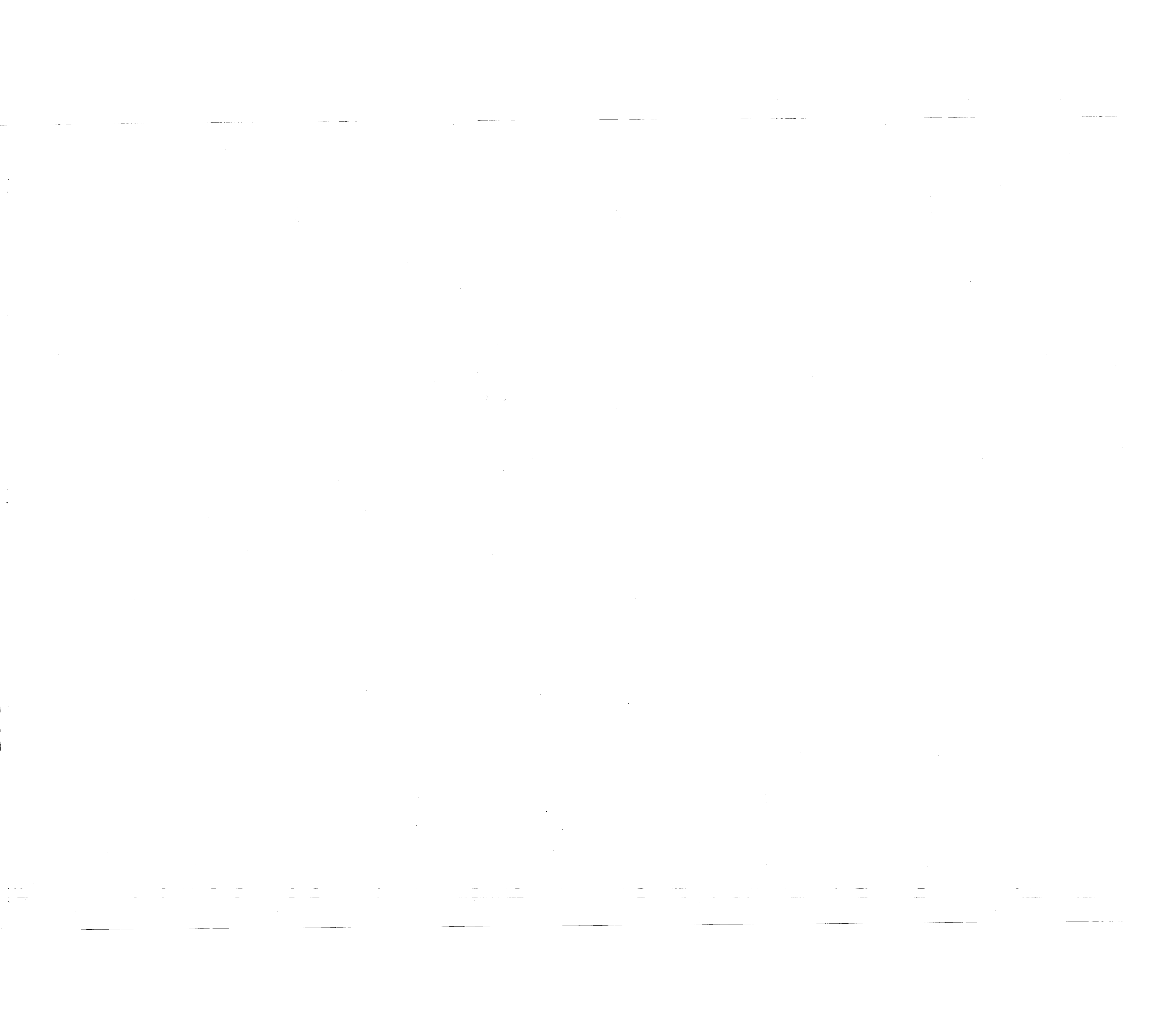

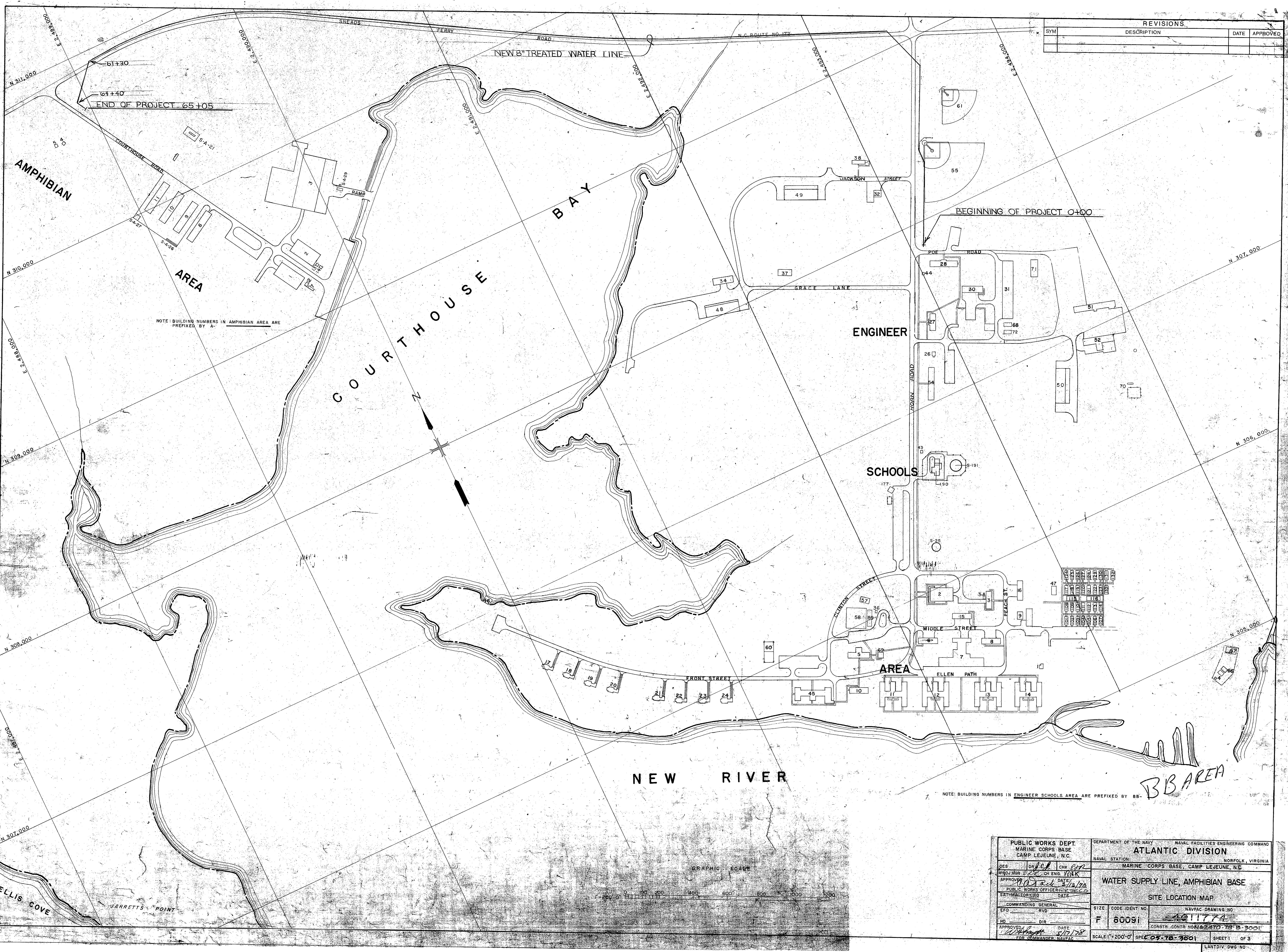

REVISIONS			
SYM	DESCRIPTION	DATE	APPROVED

NOTE: BUILDING NUMBERS IN AMPHIBIAN AREA ARE PREFIXED BY 'A'

NOTE: BUILDING NUMBERS IN ENGINEER SCHOOLS AREA ARE PREFIXED BY 'BB'

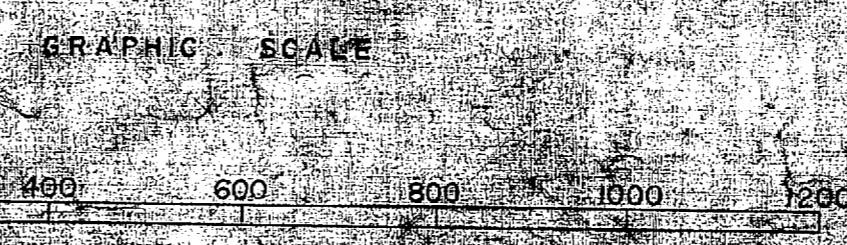

PUBLIC WORKS DEPT. MARINE CORPS BASE CAMP LEJEUNE, N.C.		DEPARTMENT OF THE NAVY NAVAL FACILITIES ENGINEERING COMMAND ATLANTIC DIVISION NAVAL STATION MARINE CORPS BASE, CAMP LEJEUNE, N.C.	
DESIGNED BY: <i>DR/CL</i>	CHKD BY: <i>DR/CL</i>	SIZE: <i>F</i>	CODE IDENT NO: <i>60091</i>
APPROVED BY: <i>DR/CL</i>	DATE: <i>5/12/78</i>	NAVAC DRAWING NO: <i>4011774</i>	CONSTR. CENTER NO: <i>2410-728-15-9001</i>
PUBLIC WORKS OFFICER: <i>DR/CL</i>		SCALE: 1"=200'-0"	
DATE: <i>5/17/78</i>		SHEET 1 OF 3	
FOR COMMANDER, NAVAC		LANTDIV, DWS NO.	

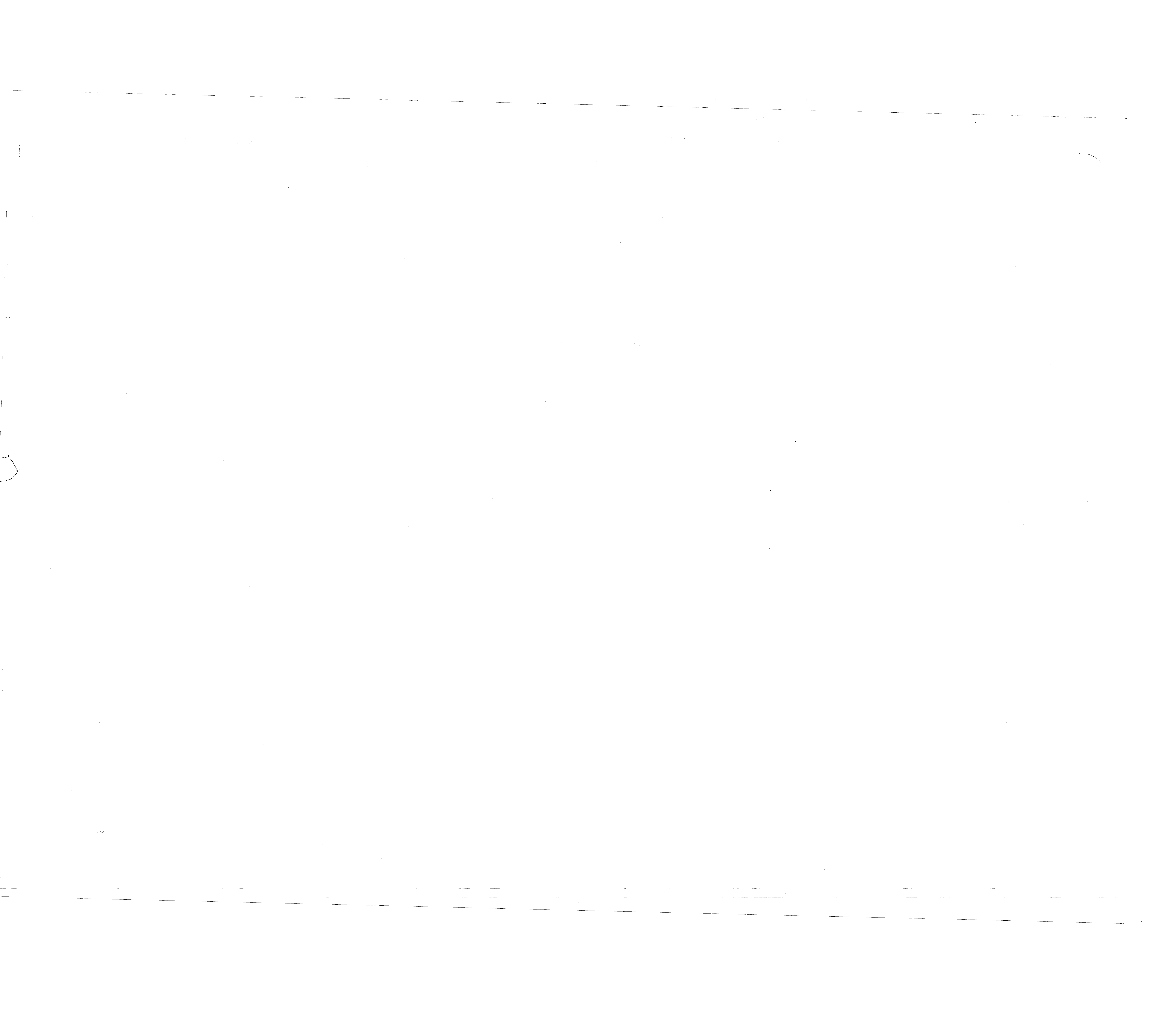

REVISIONS			
SYM	DESCRIPTION	DATE	APPROVED

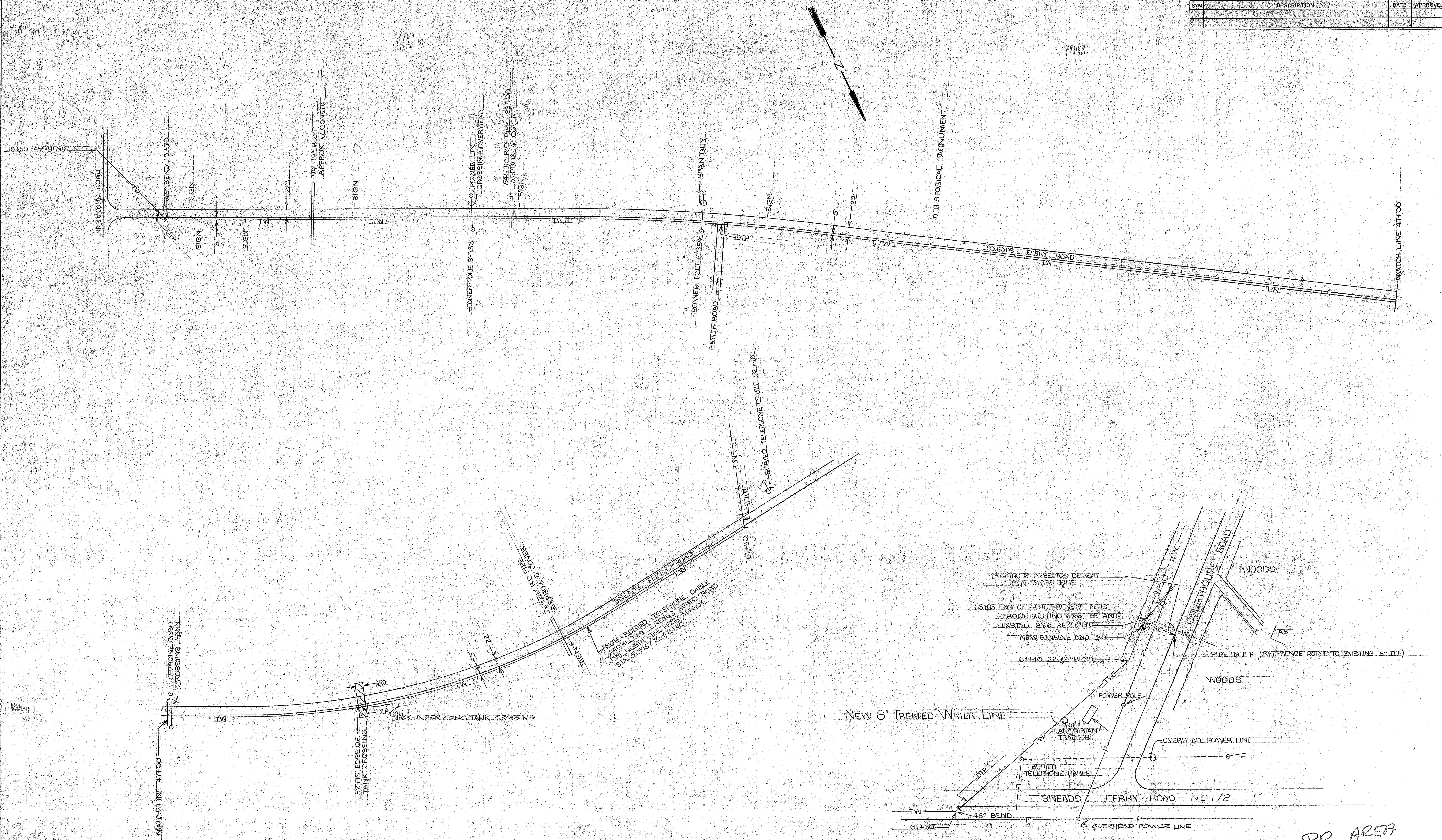

MATCH LINE 47+00
TELEPHONE CABLE CROSSING T.W.

SCALE: 1"=100'-0"

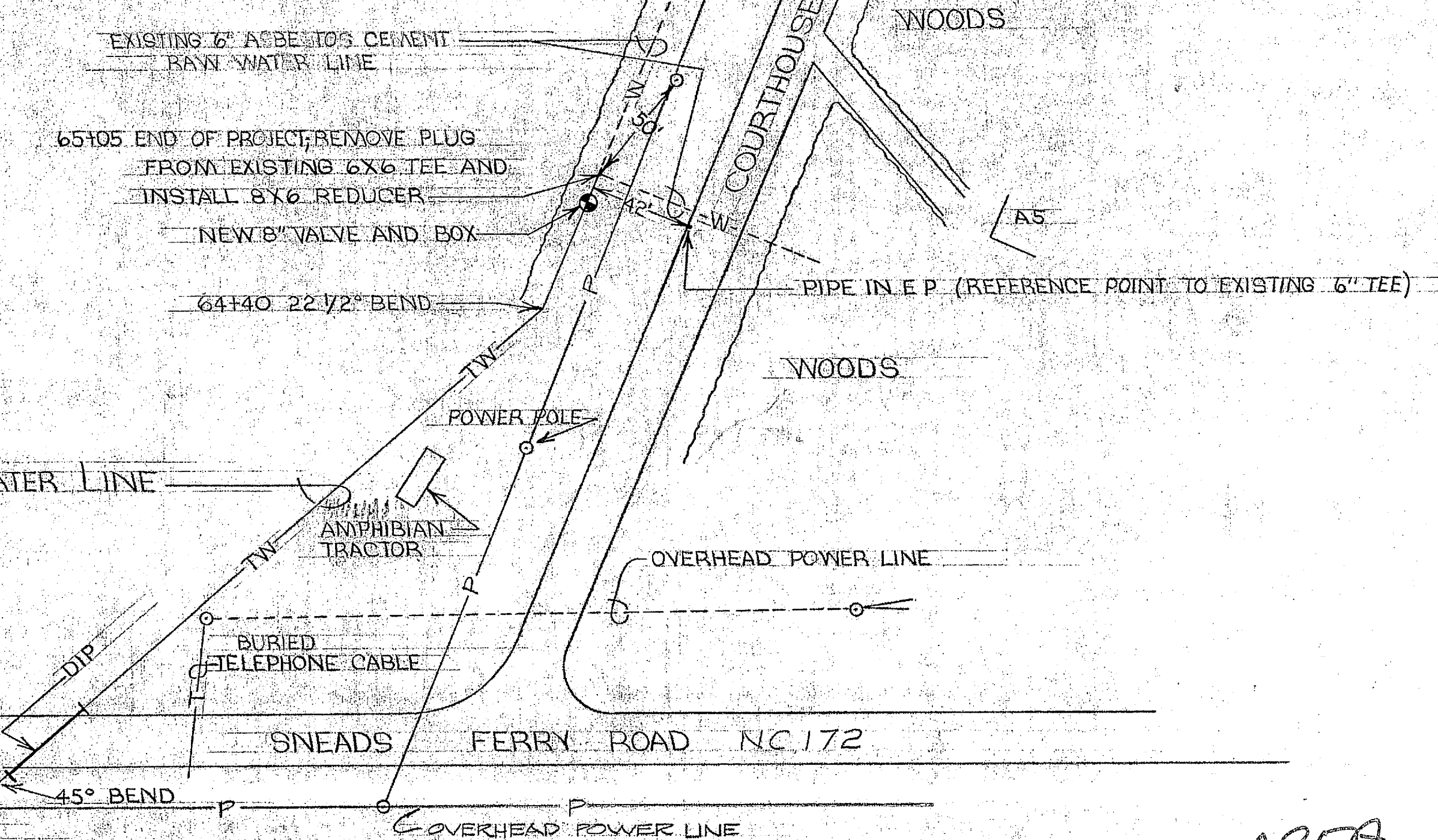
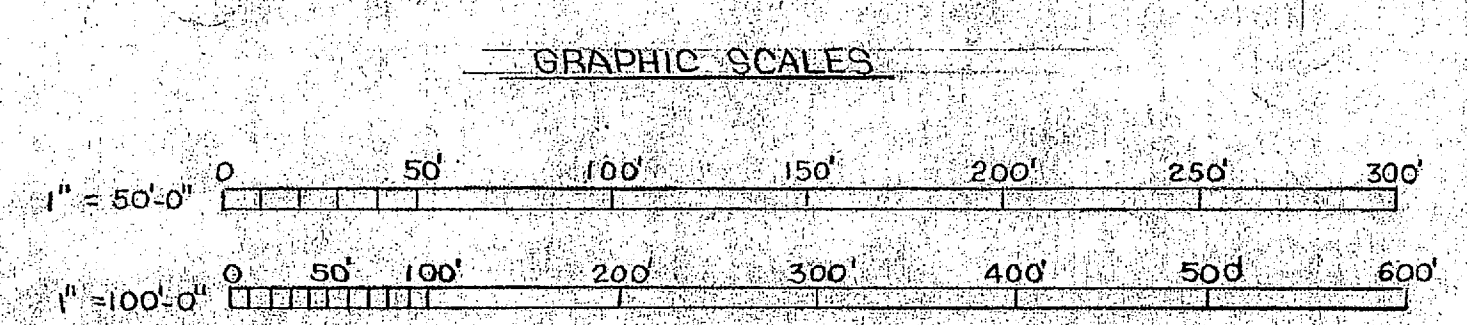

SCALE: 1"=50'-0"

BB - AREA

PUBLIC WORKS DEPT. MARINE CORPS BASE CAMP LEJUNE, N.C.		DEPARTMENT OF THE NAVY NAVAL FACILITIES ENGINEERING COMMAND ATLANTIC DIVISION	
DES: <i>[Signature]</i> CHK: <i>[Signature]</i>		NAVAL STATION: MARINE CORPS BASE, CAMP LEJUNE, N.C.	
APPROVED: <i>[Signature]</i> DATE: 5/12/78		NORFOLK, VIRGINIA	
SATISFACTORY TO: <i>[Signature]</i> DATE: 5/12/78		WATER SUPPLY LINE, AMPHIBIAN BASE	
COMMANDING GENERAL		PLAN STATIONS 13+70 TO 65+05, & DETAIL	
EF: <i>[Signature]</i> RVD: <i>[Signature]</i>	SIZE: F	CODE: 80091	NAVFAC DRAWING NO: 4011776
HD: <i>[Signature]</i> DIR: <i>[Signature]</i>	CONST. CONTR. NO. N62470-76-D-3001		
APPROVED: <i>[Signature]</i> DATE: 5/12/78	SCALE: GRAPHIC	SPEC: 05-78-3001	SHEET 3 OF 3
FOR COMMANDER, NAVFAC			

PK 81