

US Army Corps  
of Engineers  
Charleston District

No. 1	Area 1	Area 1	Area 1
No. 2	Area 2	Area 2	Area 2
No. 3	Area 3	Area 3	Area 3
No. 4	Area 4	Area 4	Area 4
No. 5	Area 5	Area 5	Area 5
No. 6	Area 6	Area 6	Area 6
No. 7	Area 7	Area 7	Area 7
No. 8	Area 8	Area 8	Area 8
No. 9	Area 9	Area 9	Area 9
No. 10	Area 10	Area 10	Area 10
No. 11	Area 11	Area 11	Area 11
No. 12	Area 12	Area 12	Area 12
No. 13	Area 13	Area 13	Area 13
No. 14	Area 14	Area 14	Area 14
No. 15	Area 15	Area 15	Area 15
No. 16	Area 16	Area 16	Area 16
No. 17	Area 17	Area 17	Area 17
No. 18	Area 18	Area 18	Area 18
No. 19	Area 19	Area 19	Area 19
No. 20	Area 20	Area 20	Area 20
DATE		DESCRIPTION	

DATE: 13 DEC 2012	
DRAWN BY: MRV	DATE BY: 9490
DESIGNED BY:	DATE:
CHECKED BY:	DATE:
APPROVED BY:	DATE:

CLARK CREEK CHANNEL  
CONDITION SURVEY  
9490  
GEORGETOWN, CHARLESTON, COUNTIES SOUTH CAROLINA

SHEET 1 OF 3

Submitted by: Chief Navigation Section  
Approval/Recommendation: Chief Construction-Operations Branch  
Approved by: Chief Technical Services Division

- NOTES:
- SOUNDINGS ARE IN FEET AND TENTHS AND REFER TO MEAN LOWER LOW WATER.
  - HORIZONTAL DATUM IS SOUTH CAROLINA STATE PLANE COORDINATES 1983.
  - THE SOUNDINGS ON THIS DRAWING ONLY INDICATE THE GENERAL CONDITION OF THE CHANNEL ON THE DATE OF SURVEY.
  - DATE OF SURVEY: 6 DEC. 2012 CONDITION

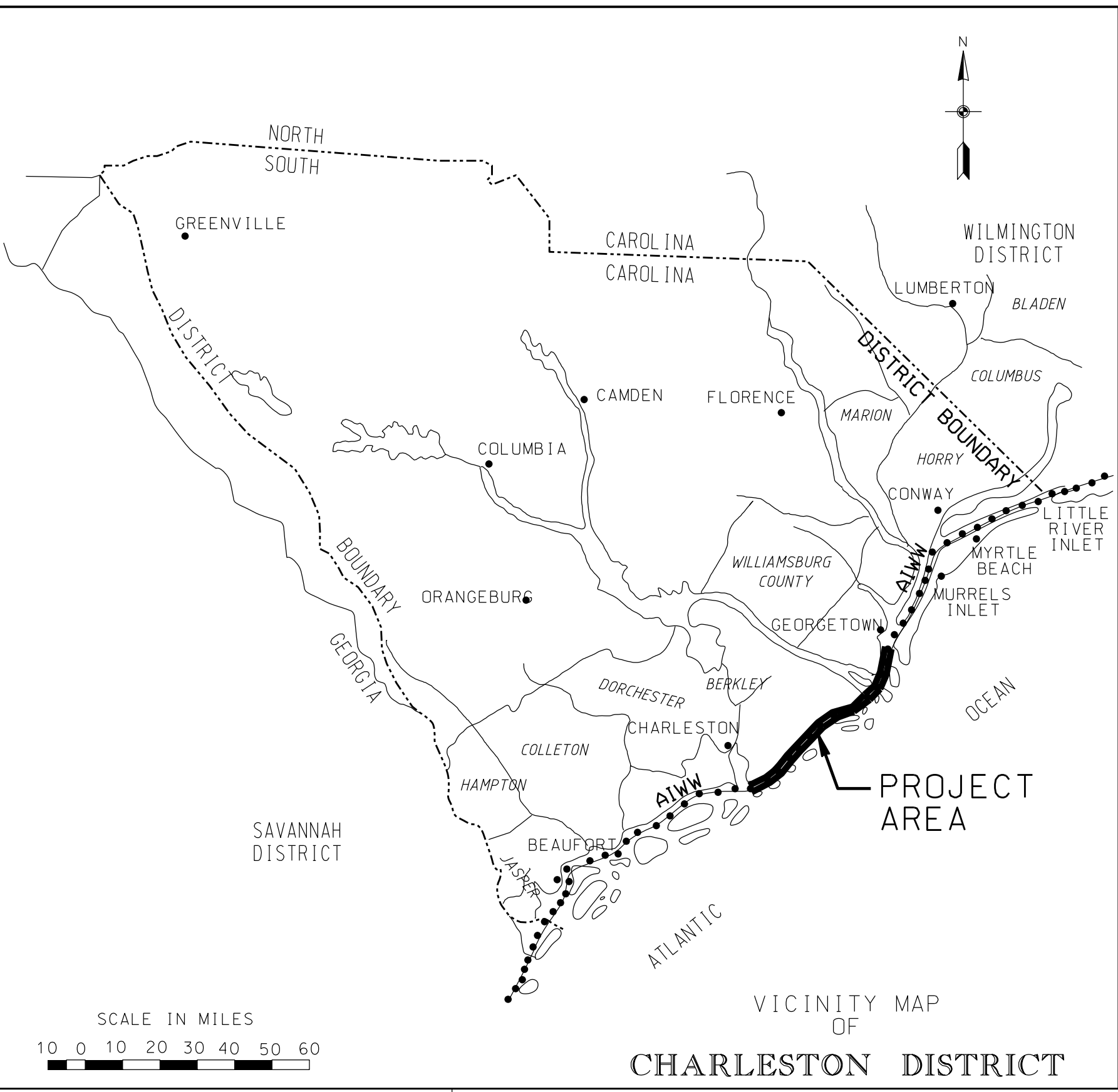
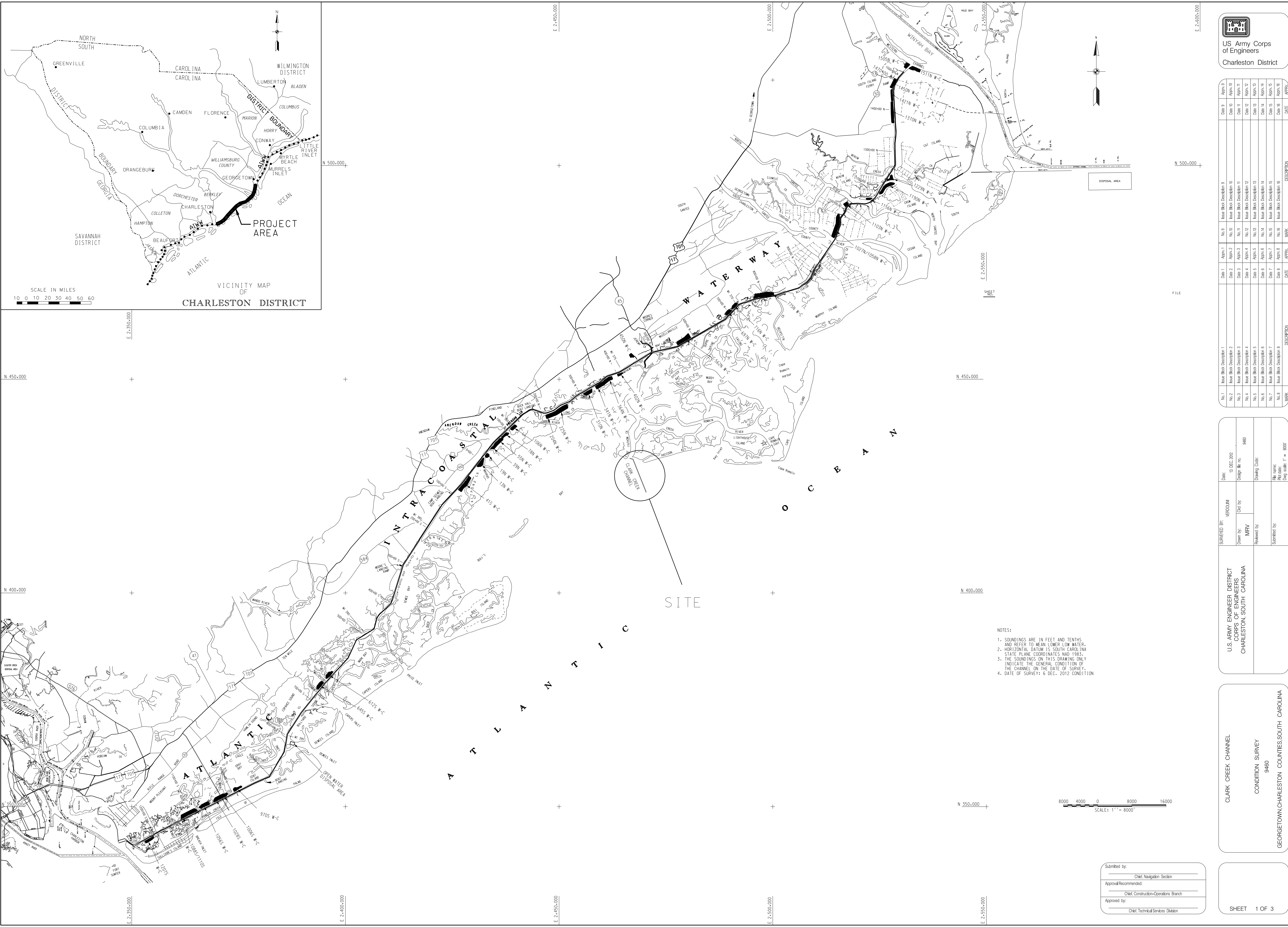

428,000

427,000

426,000

425,000

424,000

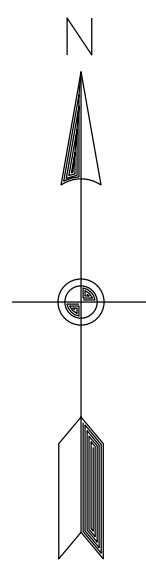

- NOTES:
1. SOUNDINGS ARE IN FEET AND TENTHS AND REFER TO MEAN LOWER LOW WATER.
  2. HORIZONTAL DATUM IS SOUTH CAROLINA STATE PLANE COORDINATES NAD 1983.
  3. THE SOUNDINGS ON THIS DRAWING ONLY INDICATE THE GENERAL CONDITION OF THE CHANNEL ON THE DATE OF SURVEY.
  4. DATE OF SURVEY: 6 DEC. 2012 CONDITION

BUOY 3

50+00

40+00

BUOY 2

30+00

20+00

10+00

0+00

PROJECT DEPTH 12'

LR N 423,523.4  
E 2,470,346.6

32 59 15.953  
79 27 57.24

CL N 423,542  
E 2,470,393

32 59 16.13  
79 27 56.689

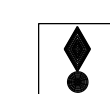

BUOY 1

RR N 423,560.6  
E 2,470,439.4

32 59 16.307  
79 27 56.141

2,466,000

2,467,000

2,468,000

2,469,000

2,470,000

2,471,000

2,472,000

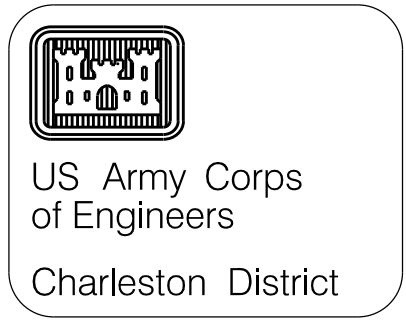

No.	Desc	Date	Appr.
No. 1	Base Buo Description 1	Date 1	Appr. 1
No. 2	Base Buo Description 2	Date 2	Appr. 2
No. 3	Base Buo Description 3	Date 3	Appr. 3
No. 4	Base Buo Description 4	Date 4	Appr. 4
No. 5	Base Buo Description 5	Date 5	Appr. 5
No. 6	Base Buo Description 6	Date 6	Appr. 6
No. 7	Base Buo Description 7	Date 7	Appr. 7
No. 8	Base Buo Description 8	Date 8	Appr. 8
No. 9	Base Buo Description 9	Date 9	Appr. 9
No. 10	Base Buo Description 10	Date 10	Appr. 10
No. 11	Base Buo Description 11	Date 11	Appr. 11
No. 12	Base Buo Description 12	Date 12	Appr. 12
No. 13	Base Buo Description 13	Date 13	Appr. 13
No. 14	Base Buo Description 14	Date 14	Appr. 14
No. 15	Base Buo Description 15	Date 15	Appr. 15
No. 16	Base Buo Description 16	Date 16	Appr. 16
No. 17	Base Buo Description 17	Date 17	Appr. 17
No. 18	Base Buo Description 18	Date 18	Appr. 18
No. 19	Base Buo Description 19	Date 19	Appr. 19
No. 20	Base Buo Description 20	Date 20	Appr. 20
MARK	MARK	DATE	APPRA

DATE: 13 DEC 2012  
 DESIG: 9460  
 DRAWN BY: MRV  
 CHECKED BY: [Signature]  
 SURVEYED BY: [Signature]  
 U.S. ARMY ENGINEER DISTRICT  
 CORPS OF ENGINEERS  
 CHARLESTON, SOUTH CAROLINA

CLARK CREEK  
 CONDITION SURVEY  
 9460

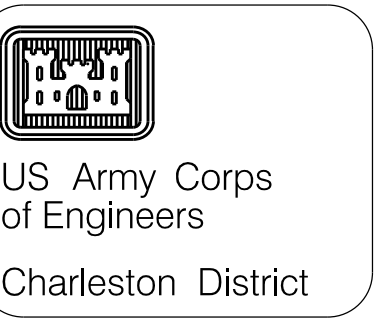

No.	DATE	DESCRIPTION
No. 1	6 DEC. 2012	Initial Survey
No. 2		
No. 3		
No. 4		
No. 5		
No. 6		
No. 7		
No. 8		
No. 9		
No. 10		
No. 11		
No. 12		
No. 13		
No. 14		
No. 15		
No. 16		
No. 17		
No. 18		
No. 19		
No. 20		

DATE: 6 DEC. 2012	DRAWING NO.: 9460
PROJECT NO.: 9460	PROJECT CODE:
DATE: 6 DEC. 2012	DATE: 6 DEC. 2012
DATE: 6 DEC. 2012	DATE: 6 DEC. 2012

U.S. ARMY ENGINEER DISTRICT  
CORPS OF ENGINEERS  
CHARLESTON, SOUTH CAROLINA

CLARK CREEK  
CONDITION SURVEY

9460

SHEET 30F 3

CLARK CREEK ENTRANCE

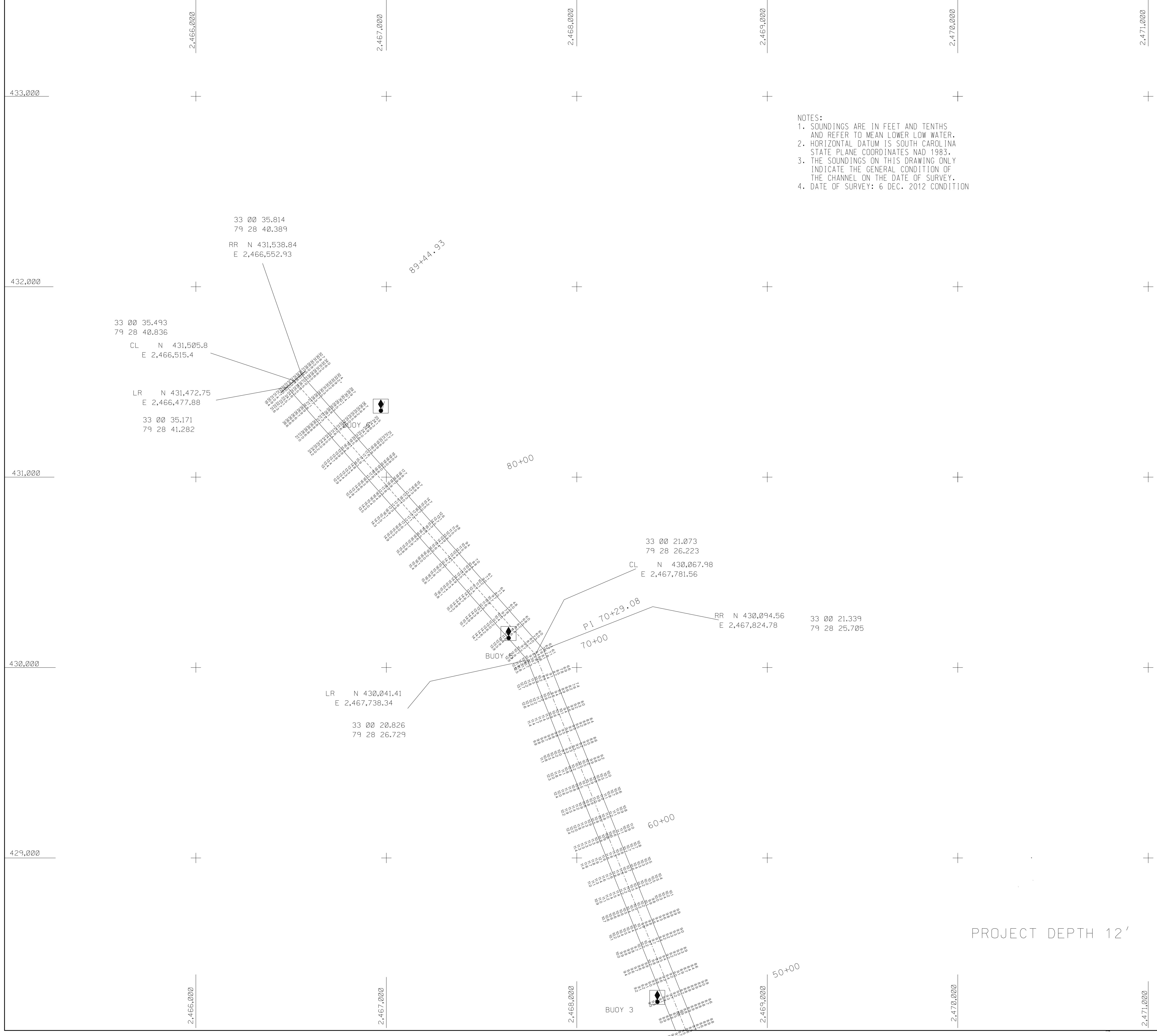

NOTES:  
1. SOUNDINGS ARE IN FEET AND TENTHS AND REFER TO MEAN LOWER LOW WATER.  
2. HORIZONTAL DATUM IS SOUTH CAROLINA STATE PLANE COORDINATES NAD 1983.  
3. THE SOUNDINGS ON THIS DRAWING ONLY INDICATE THE GENERAL CONDITION OF THE CHANNEL ON THE DATE OF SURVEY.  
4. DATE OF SURVEY: 6 DEC. 2012 CONDITION