

- NOTES:**
1. SOUNDINGS ARE IN FEET AND TENTHS AND REFER TO MEAN LOWER LOW WATER.
  2. HORIZONTAL DATUM IS SC STATE PLANE COORDINATES NAD 1983.
  3. THE SOUNDINGS ON THIS DRAWING ONLY INDICATE THE GENERAL CONDITION OF THE CHANNEL ON THE DATE OF SURVEY.
  4. DATE OF SURVEY: 26 SEP - 3 OCT 2012 CONDITION
  5. THE POSITIONS OF THE AIDS TO NAVIGATION ON THESE SHEETS ARE FROM OLDER SURVEYS AND MAY NOT BE ACCURATE.

DATE	DESCRIPTION

DESIGNED BY: _____	DATE: OCT 2012
DRAWN BY: MRY	DRAWING NO.: 9453
CHECKED BY: _____	CHECKED DATE: _____
SCALE: 1" = 2000'	

U.S. ARMY ENGINEER DISTRICT  
CORPS OF ENGINEERS  
CHARLESTON, SOUTH CAROLINA

CHARLESTON HARBOR  
LOWER CHARLESTON PROFILE LINES  
9453  
CHARLESTON & BERKELEY COUNTIES, SOUTH CAROLINA

Submitted by: \_\_\_\_\_  
CHIEF, NAVIGATION SECTION

Approval Recommended: \_\_\_\_\_  
CHIEF, OPERATIONS BRANCH

Approved by: \_\_\_\_\_  
CHIEF, TECHNICAL SERVICES DIVISION

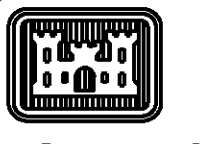

US Army Corps of Engineers  
Charleston District

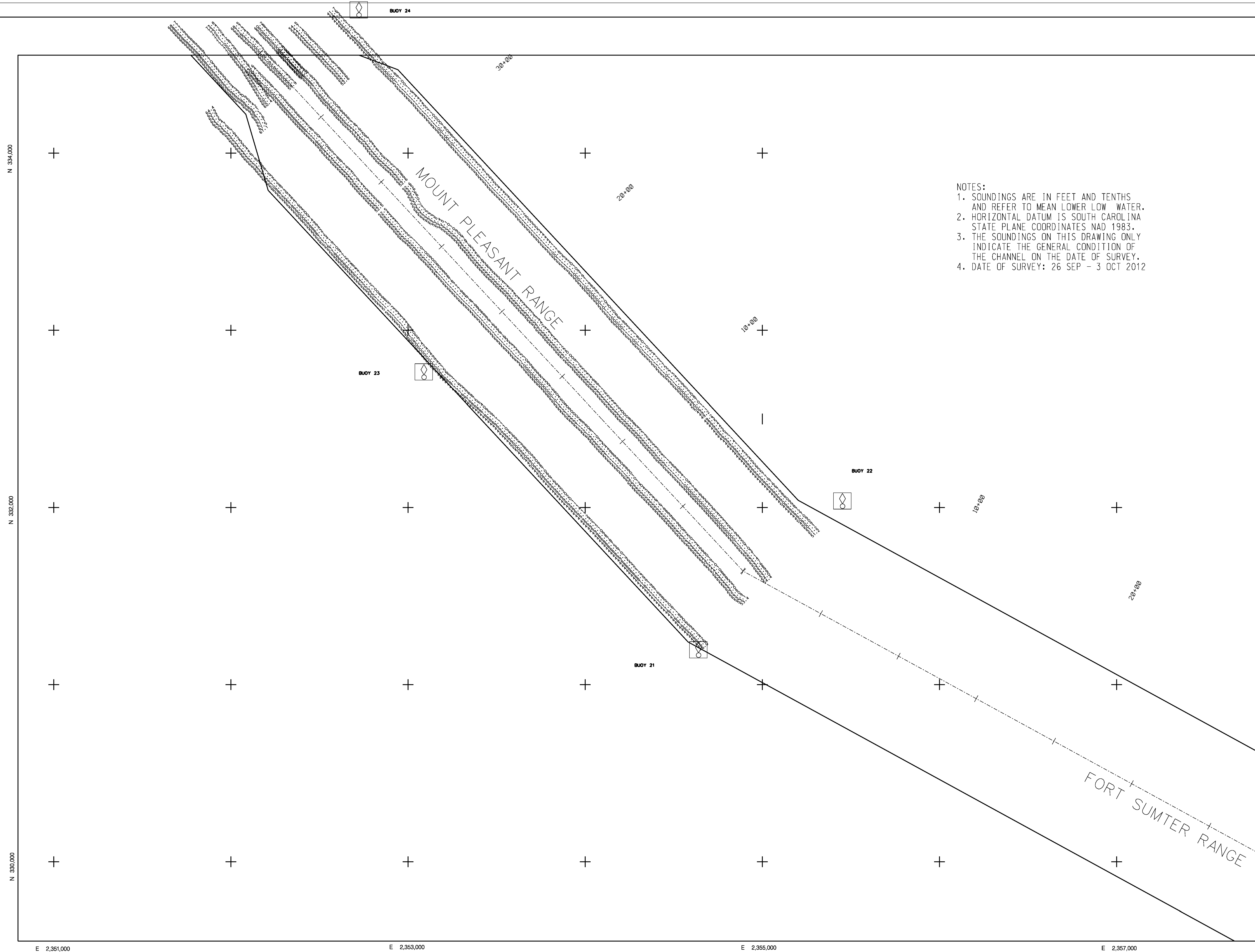

**NOTES:**  
 1. SOUNDINGS ARE IN FEET AND TENTHS AND REFER TO MEAN LOWER LOW WATER.  
 2. HORIZONTAL DATUM IS SOUTH CAROLINA STATE PLANE COORDINATES NAD 1983.  
 3. THE SOUNDINGS ON THIS DRAWING ONLY INDICATE THE GENERAL CONDITION OF THE CHANNEL ON THE DATE OF SURVEY.  
 4. DATE OF SURVEY: 26 SEP - 3 OCT 2012

DATE	APPROVED	DESCRIPTION

U.S. ARMY ENGINEER DISTRICT CORPS OF ENGINEERS CHARLESTON, SOUTH CAROLINA	Designated by MRV	Date OCT. 2012
	Drawn by MRV	Design file no. 9453
Reviewed by	Checked by	File name: Dwg No. 7 - 201

CHARLESTON HARBOR  
**LOWER CHARLESTON PROFILES**  
 CHARLESTON COUNTY SOUTH CAROLINA  
 9453

SHEET REFERENCE NUMBER  
 SHEET 2 OF 14

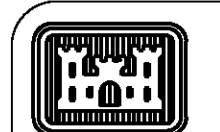

US Army Corps of Engineers  
Charleston District

MARK	DESCRIPTION	DATE	APPV.

Designed by:	Date:	Rev:
Drawn by:	OCT 2012	1
Reviewed by:	Drawn by no.:	9453
Checked by:	Drawn Code:	
	File name:	W:\Projects\09
	Per date:	XX 0000 000
	Proj scale:	1" = 200'

CHARLESTON HARBOR  
LOWER CHARLESTON PROFILES  
9453  
CHARLESTON COUNTY SOUTH CAROLINA

SHEET REFERENCE NUMBER  
SHEET 3 OF 14

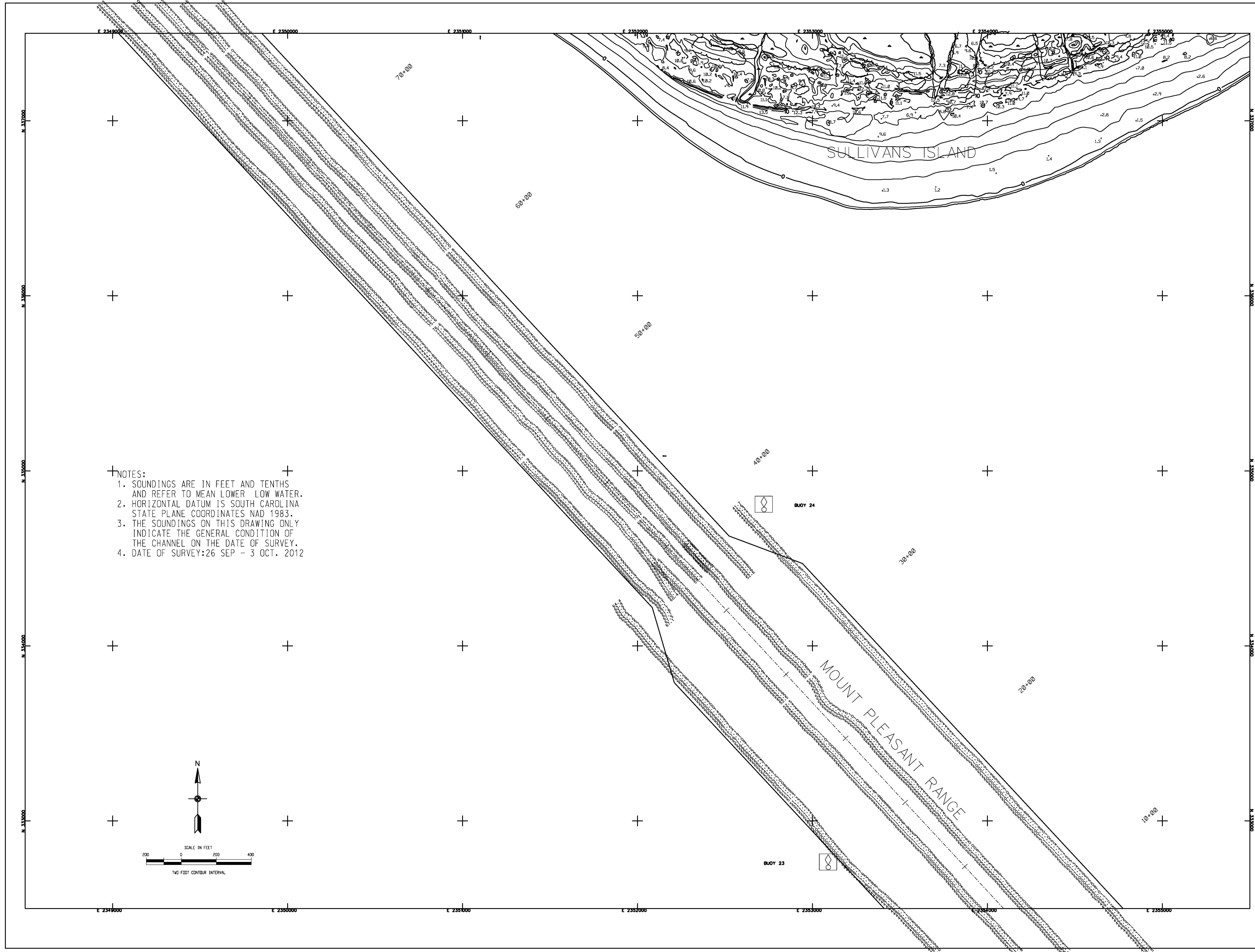

- NOTES:
1. SOUNDINGS ARE IN FEET AND TENTHS AND REFER TO MEAN LOWER LOW WATER.
  2. HORIZONTAL DATUM IS SOUTH CAROLINA STATE PLANE COORDINATES NAD 1983.
  3. THE SOUNDINGS ON THIS DRAWING ONLY INDICATE THE GENERAL CONDITION OF THE CHANNEL ON THE DATE OF SURVEY.
  4. DATE OF SURVEY: 26 SEP - 3 OCT. 2012

NO.	DESCRIPTION	DATE	BY

U.S. ARMY ENGINEER DISTRICT CORPS OF ENGINEERS CHARLESTON SOUTH CAROLINA	Designated by: _____ Drawn by: MRY Checked by: _____ Reviewed by: _____ Survised by: _____	Date: OCT 2012 Design No: 9453 Drawing Code: _____ File Name: _____ Project: _____ Proj Code: F - 207
--	--	--

CHARLESTON HARBOR  
 LOWER CHARLESTON PROFILES  
 CHARLESTON COUNTY SOUTH CAROLINA  
 9453

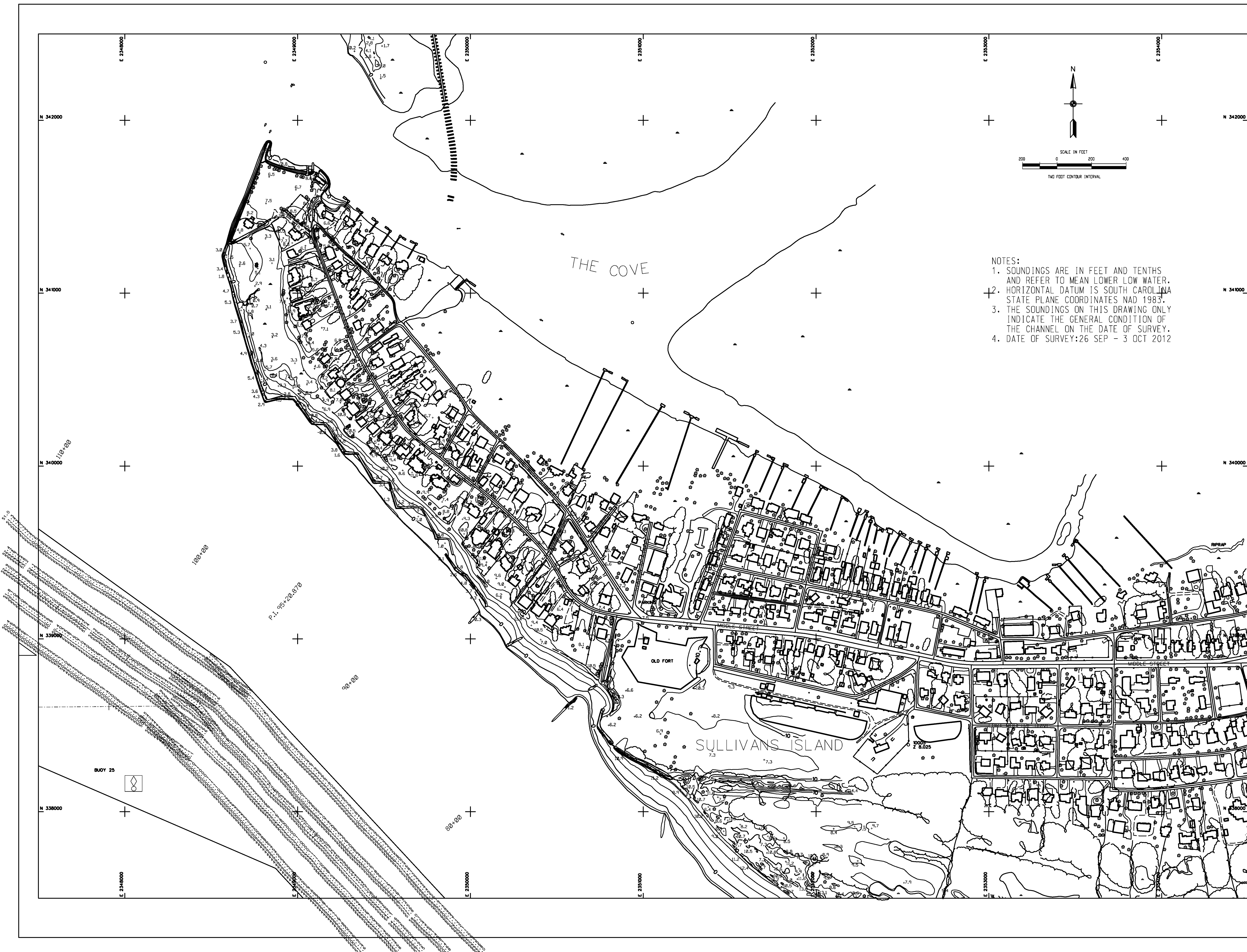

- NOTES:
- SOUNDINGS ARE IN FEET AND TENTHS AND REFER TO MEAN LOWER LOW WATER.
  - HORIZONTAL DATUM IS SOUTH CAROLINA STATE PLANE COORDINATES NAD 1983.
  - THE SOUNDINGS ON THIS DRAWING ONLY INDICATE THE GENERAL CONDITION OF THE CHANNEL ON THE DATE OF SURVEY.
  - DATE OF SURVEY: 26 SEP - 3 OCT 2012

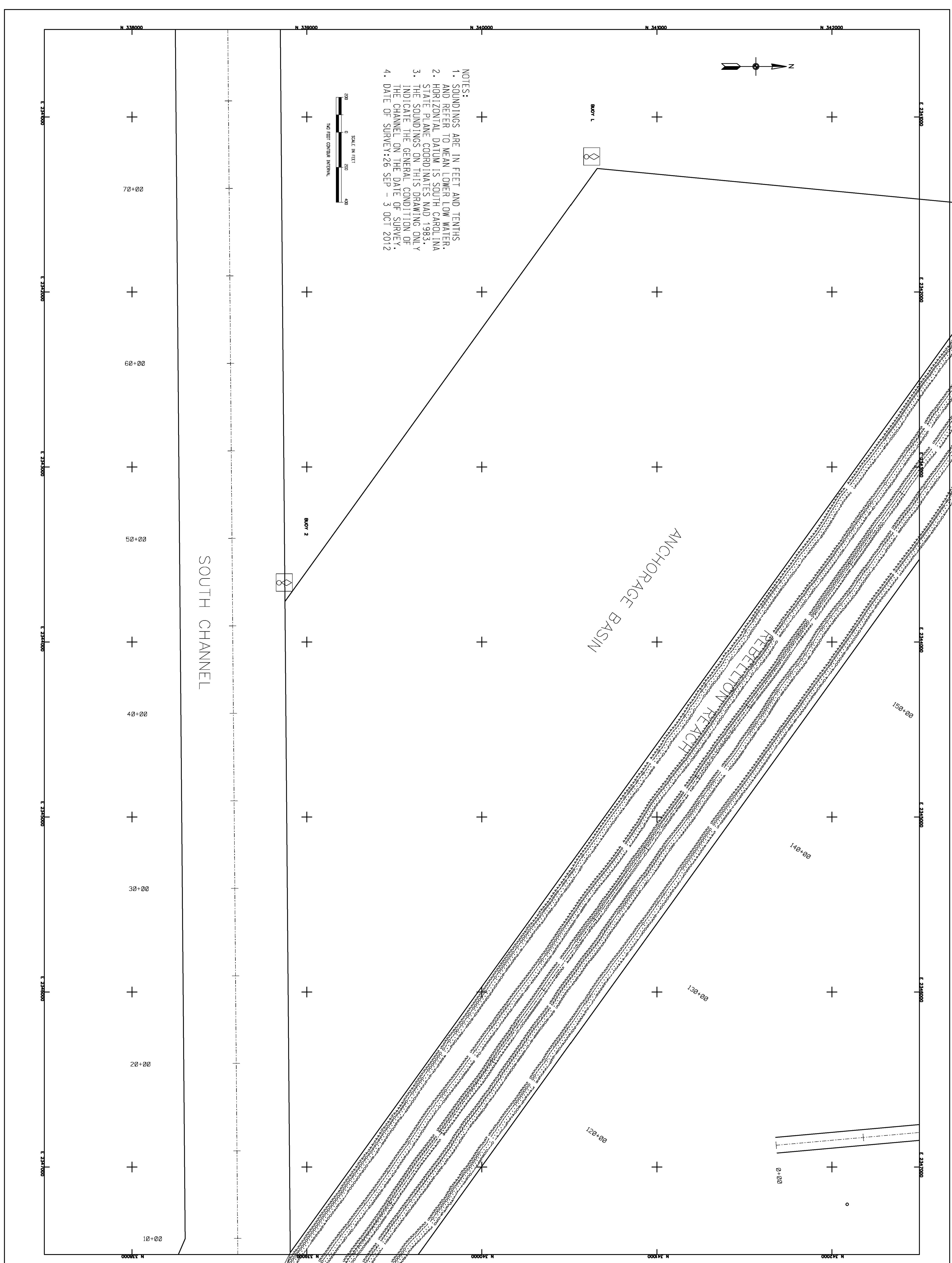

- NOTES:
1. SOUNDINGS ARE IN FEET AND TENTHS AND REFER TO MEAN LOWER LOW WATER.
  2. HORIZONTAL DATUM IS SOUTH CAROLINA STATE PLANE COORDINATES NAD 1983.
  3. THE SOUNDINGS ON THIS DRAWING ONLY INDICATE THE GENERAL CONDITION OF THE CHANNEL ON THE DATE OF SURVEY.
  4. DATE OF SURVEY: 26 SEP - 3 OCT 2012

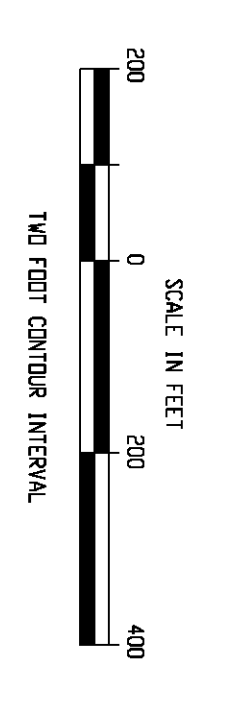

SHEET REFERENCE NUMBER SHEET 5 OF 14	CHARLESTON HARBOR <b>LOWER CHARLESTON PROFILES</b> 9453 CHARLESTON COUNTY SOUTH CAROLINA	U.S. ARMY ENGINEER DISTRICT CORPS OF ENGINEERS CHARLESTON, SOUTH CAROLINA	<table border="1" style="width: 100%; border-collapse: collapse;"> <tr> <td>Designed by:</td> <td>Date:</td> <td>Rev:</td> </tr> <tr> <td>Drawn by:</td> <td>Chk by:</td> <td>Design file no.:</td> </tr> <tr> <td>Reviewed by:</td> <td></td> <td>Drawing Code:</td> </tr> <tr> <td>Submitted by:</td> <td>File name:</td> <td>Plot date:</td> </tr> <tr> <td></td> <td>Proj title:</td> <td>Orig scale: 1" = 200'</td> </tr> </table>	Designed by:	Date:	Rev:	Drawn by:	Chk by:	Design file no.:	Reviewed by:		Drawing Code:	Submitted by:	File name:	Plot date:		Proj title:	Orig scale: 1" = 200'	<table border="1" style="width: 100%; border-collapse: collapse;"> <thead> <tr> <th>MARK</th> <th>DESCRIPTION</th> <th>DATE</th> <th>APPR</th> <th>MARK</th> <th>DESCRIPTION</th> <th>DATE</th> <th>APPR</th> </tr> </thead> <tbody> <tr><td> </td><td> </td><td> </td><td> </td><td> </td><td> </td><td> </td><td> </td></tr> <tr><td> </td><td> </td><td> </td><td> </td><td> </td><td> </td><td> </td><td> </td></tr> <tr><td> </td><td> </td><td> </td><td> </td><td> </td><td> </td><td> </td><td> </td></tr> <tr><td> </td><td> </td><td> </td><td> </td><td> </td><td> </td><td> </td><td> </td></tr> <tr><td> </td><td> </td><td> </td><td> </td><td> </td><td> </td><td> </td><td> </td></tr> </tbody> </table>	MARK	DESCRIPTION	DATE	APPR	MARK	DESCRIPTION	DATE	APPR																																								
Designed by:	Date:	Rev:																																																																	
Drawn by:	Chk by:	Design file no.:																																																																	
Reviewed by:		Drawing Code:																																																																	
Submitted by:	File name:	Plot date:																																																																	
	Proj title:	Orig scale: 1" = 200'																																																																	
MARK	DESCRIPTION	DATE	APPR	MARK	DESCRIPTION	DATE	APPR																																																												

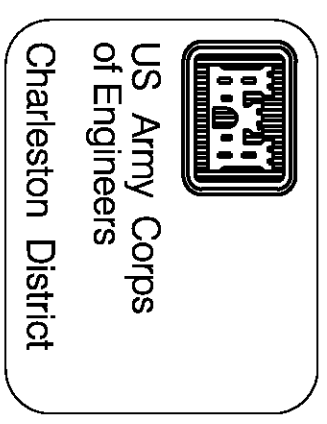

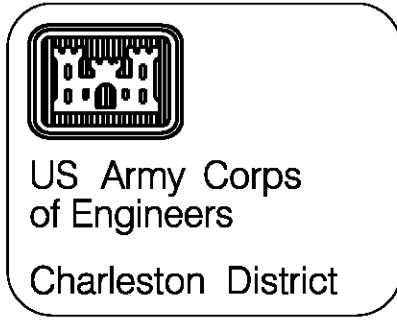

US Army Corps  
of Engineers  
Charleston District

MARK	DESCRIPTION	DATE	APPN.

DESIGNED BY: OCT 2012	DATE: OCT 2012	PROJECT NO. / SHEET NO. 9453	FILE NAME P.L. 29+93.900
DRAWN BY: MRV	CHECKED BY: MRV	SCALE: AS SHOWN	APP. NO. 20
APPROVED BY: (Signature)			
U.S. ARMY ENGINEER DISTRICT CORPS OF ENGINEERS CHARLESTON SOUTH CAROLINA			

CHARLESTON HARBOR  
**LOWER CHARLESTON PROFILES**  
 CHARLESTON COUNTY 9453 SOUTH CAROLINA

SHEET  
 REFERENCE  
 NUMBER  
 SHEET 6 OF 14

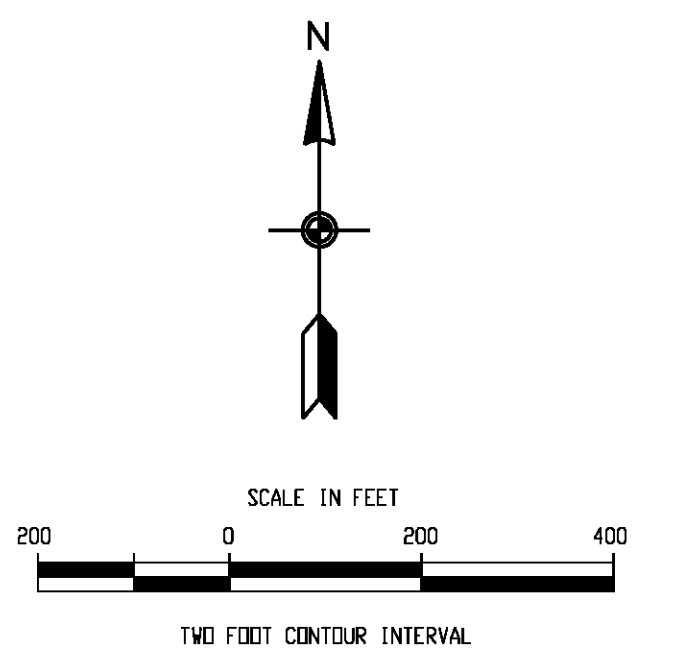

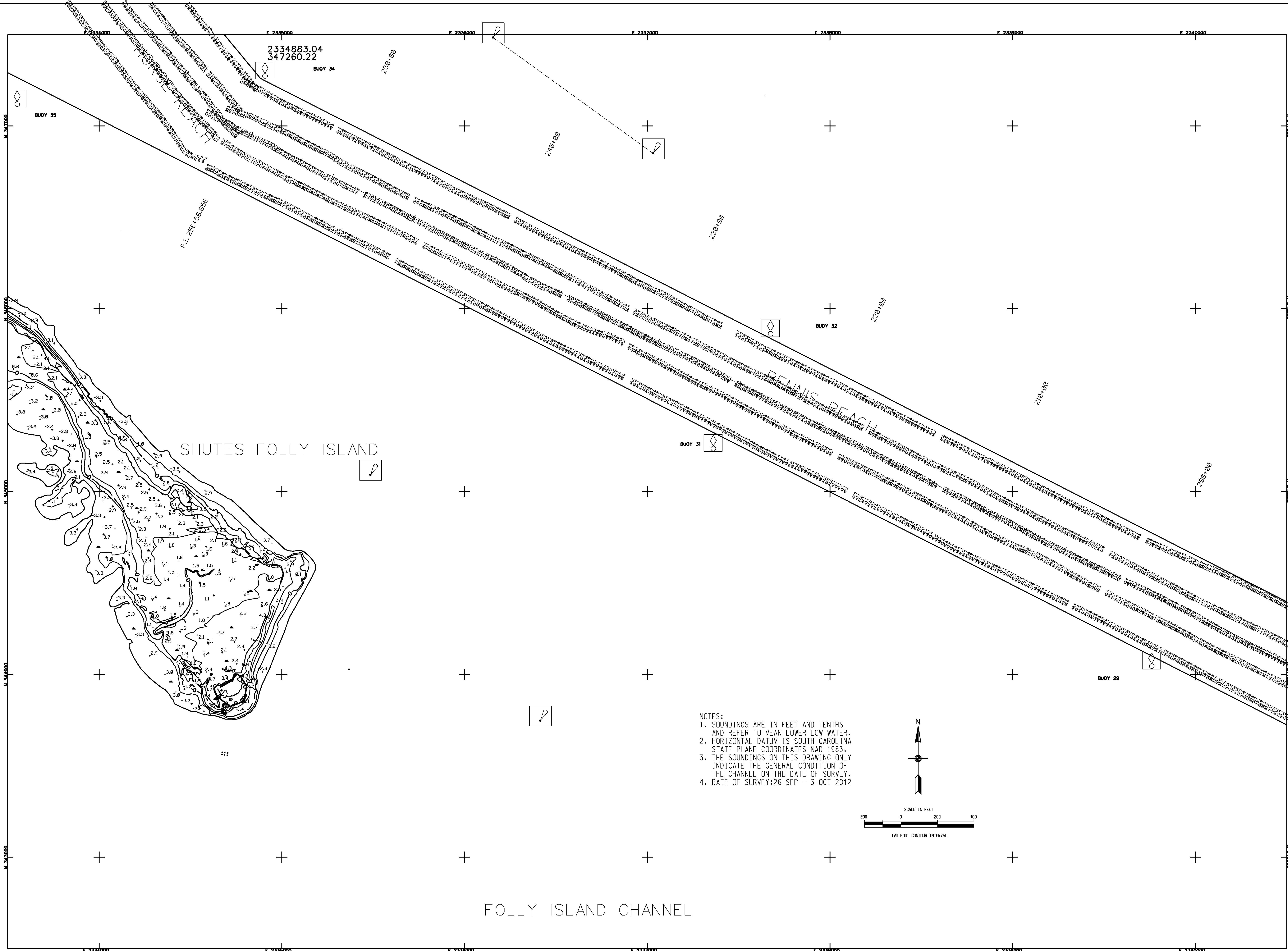

2334883.04  
347260.22

P.L. 236156.636

- NOTES:
- SOUNDINGS ARE IN FEET AND TENTHS AND REFER TO MEAN LOWER LOW WATER.
  - HORIZONTAL DATUM IS SOUTH CAROLINA STATE PLANE COORDINATES NAD 1983.
  - THE SOUNDINGS ON THIS DRAWING ONLY INDICATE THE GENERAL CONDITION OF THE CHANNEL ON THE DATE OF SURVEY.
  - DATE OF SURVEY: 26 SEP - 3 OCT 2012

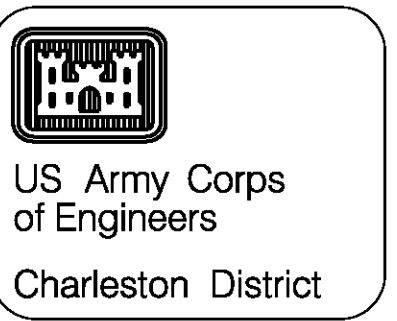
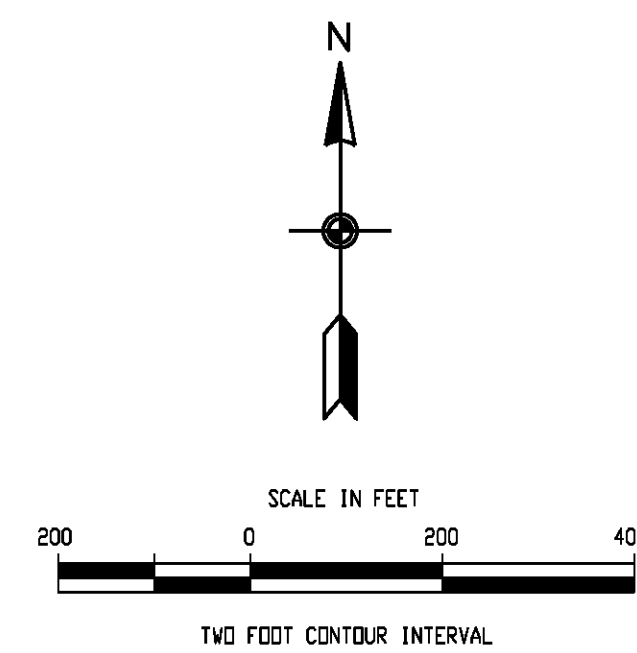

MARK	DESCRIPTION	DATE	APPROV

U.S. ARMY ENGINEER DISTRICT CHARLESTON, SOUTH CAROLINA	DESIGNED BY: MRY	DATE: OCT 2012
	DRAWN BY: MRY	DESIGN FILE NO: 9463
	REVIEWED BY:	DRAWING CODE:
	SUBMITTED BY:	FILE NAME: DRAWING NO: 1 - 201

CHARLESTON HARBOR SOUTH CAROLINA  
LOWER CHARLESTON PROFILES 9463  
CHARLESTON COUNTY

SHEET REFERENCE NUMBER  
SHEET 7 OF 14

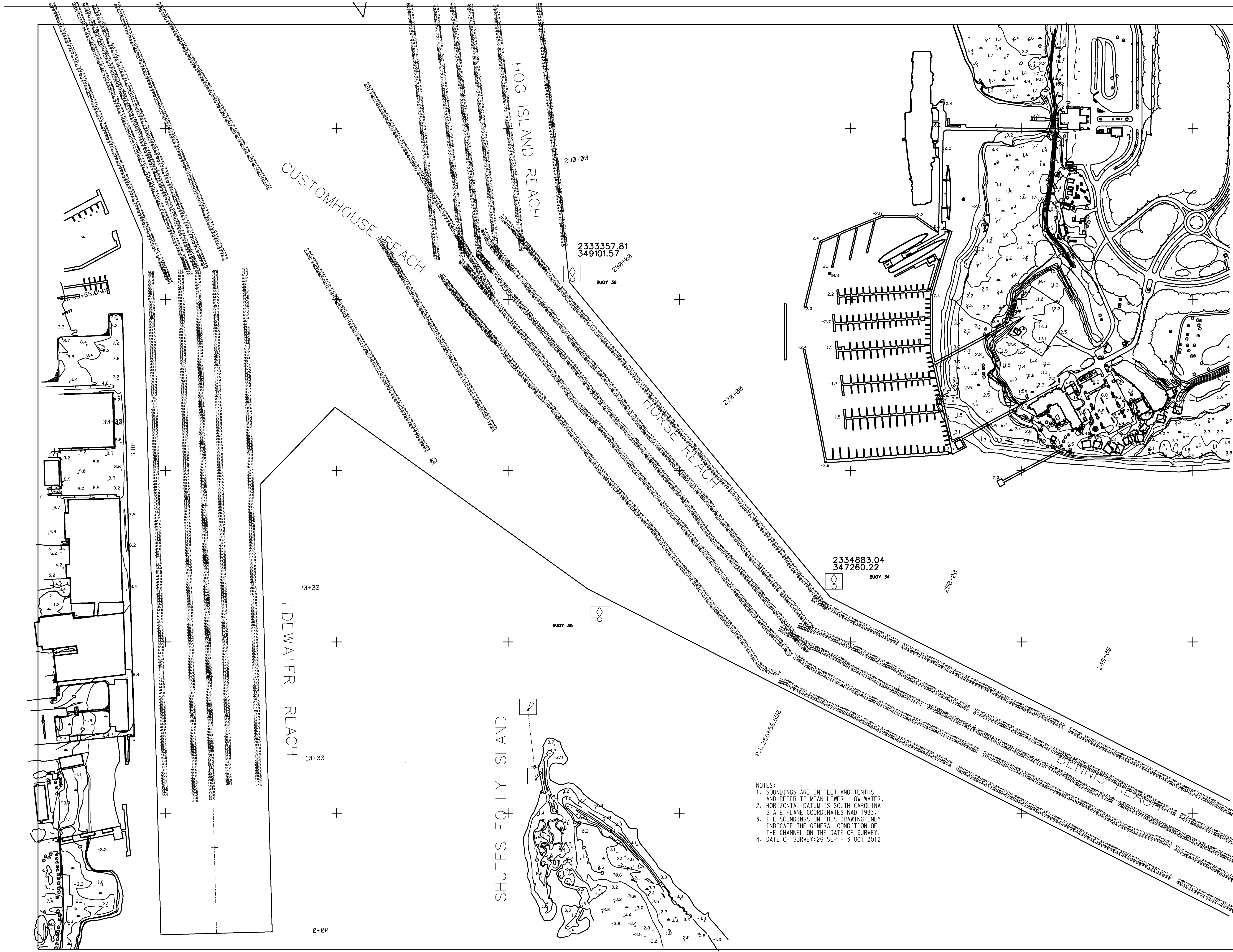

NOTES:  
 1. SOUNDINGS ARE IN FEET AND TENTHS AND REFER TO MEAN LOWER LOW WATER.  
 2. HORIZONTAL DATUM IS SOUTH CAROLINA STATE PLANE COORDINATES NAD 1983.  
 3. THE SOUNDINGS ON THIS DRAWING ONLY INDICATE THE GENERAL CONDITION OF THE CHANNEL ON THE DATE OF SURVEY.  
 4. DATE OF SURVEY: 26 SEP - 3 OCT 2012

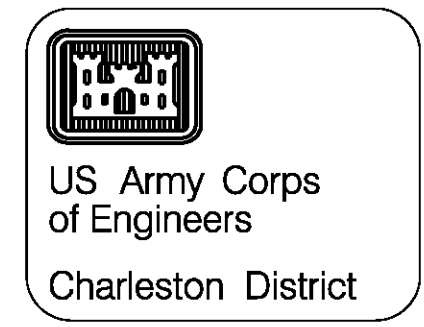

US Army Corps  
 of Engineers  
 Charleston District

MARK	DISCREPANCY	DATE	APPROV.	MARK	DISCREPANCY	DATE	APPROV.

Designed by:	MRV	Checked by:	MRV	Date:	OCT 2012
Drawn by:	MRV	Reviewed by:	MRV	Project No.:	9453
Surfaced by:					

CHARLESTON HARBOR  
 LOWER CHARLESTON PROFILES  
 CHARLESTON COUNTY SOUTH CAROLINA  
 9453

SHEET  
 REFERENCE  
 NUMBER  
 SHEET 8 OF 14



DATE	APPV.	DESCRIPTION	DATE	APPV.	MARK.

Designed by:	Drawn by:	Reviewed by:	Checked by:	Date:
MW	MW			OCT 2013
Drawn Code:	Design Code:	Design No.:	Sheet No.:	9453
U.S. ARMY ENGINEER DISTRICT CORPS OF ENGINEERS CHARLESTON SOUTH CAROLINA				

CHARLESTON HARBOR  
**LOWER CHARLESTON PROFILES**  
9453  
CHARLESTON COUNTY SOUTH CAROLINA



- NOTES:
1. SOUNDINGS ARE IN FEET AND TENTHS AND REFER TO MEAN LOWER LOW WATER.
  2. HORIZONTAL DATUM IS SOUTH CAROLINA STATE PLANE COORDINATES NAD 1983.
  3. THE SOUNDINGS ON THIS DRAWING ONLY INDICATE THE GENERAL CONDITION OF THE CHANNEL ON THE DATE OF SURVEY.
  4. DATE OF SURVEY: 26 SEP - 3 OCT 2012

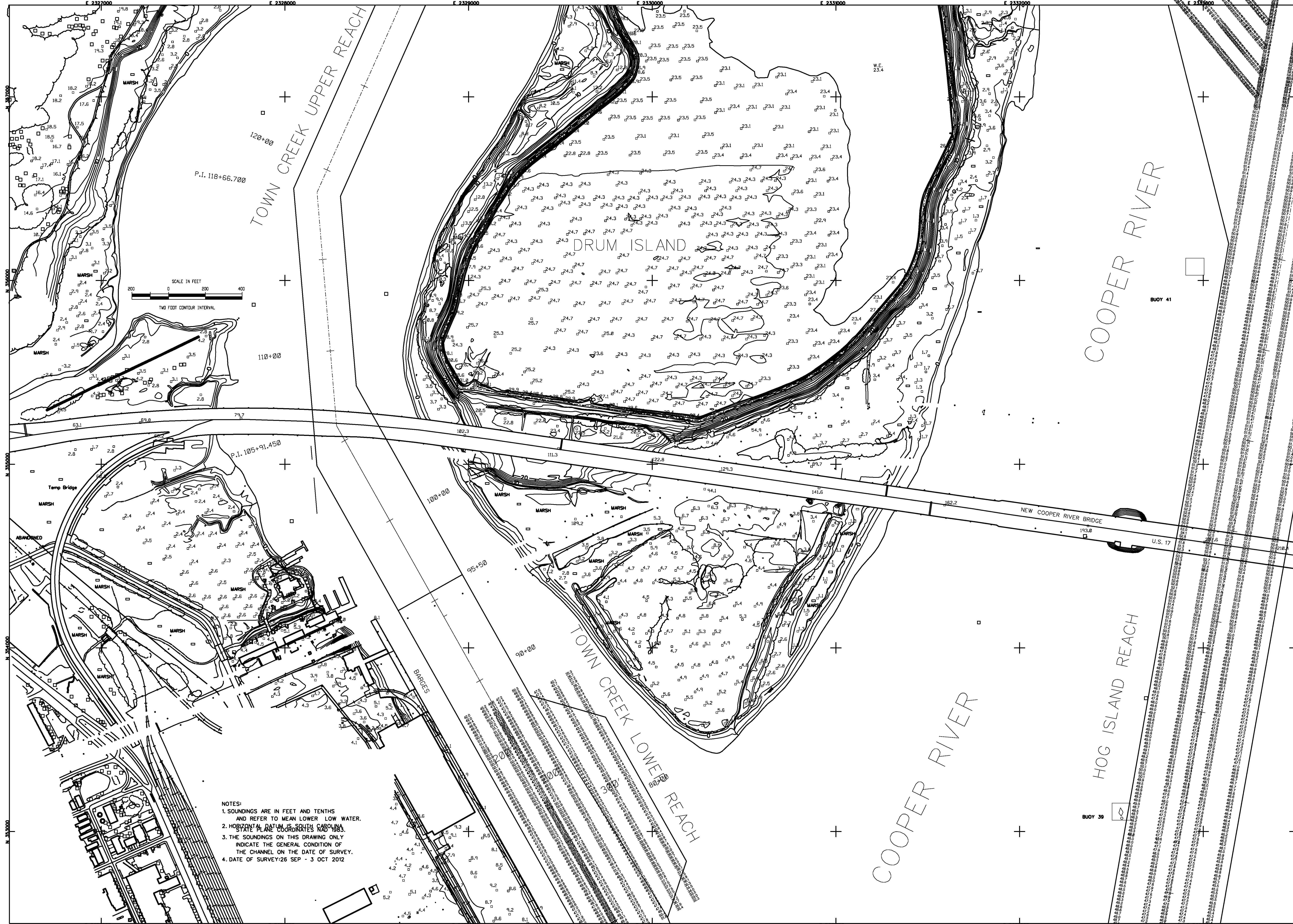

NOTES:  
 1. SOUNDINGS ARE IN FEET AND TENTHS AND REFER TO MEAN LOWER LOW WATER.  
 2. HORIZONTAL DATUM IS SOUTH CAROLINA STATE PLANE COORDINATE 1801983.  
 3. THE SOUNDINGS ON THIS DRAWING ONLY INDICATE THE GENERAL CONDITION OF THE CHANNEL ON THE DATE OF SURVEY.  
 4. DATE OF SURVEY: 26 SEP - 3 OCT 2012

 U.S. Army Corps of Engineers Charleston District	
DESIGNED BY: MRV DRAWN BY: MRV CHECKED BY: MRV SURVEILED BY: MRV	DATE: OCT 2012 DRAWING NO.: 9453 SHEET NO.: 10 OF 14
CHARLESTON HARBOR <b>LOWER CHARLESTON PROFILES</b> CHARLESTON COUNTY 9453 SOUTH CAROLINA	
SHEET REFERENCE NUMBER SHEET 10 OF 14	



US Army Corps of Engineers  
Charleston District

DATE	DESCRIPTION	DATE	MARK	APPROVAL

Designed by:	Drawn by:	Checked by:	Reviewed by:	Submitted by:	Date:	Rev:
MAR	MAR	MAR	MAR	MAR	OCT 2012	1

U.S. ARMY ENGINEER DISTRICT  
CORPS OF ENGINEERS  
CHARLESTON SOUTH CAROLINA

CHARLESTON HARBOR  
LOWER CHARLESTON PROFILES

9453

CHARLESTON COUNTY SOUTH CAROLINA

SHEET REFERENCE NUMBER

SHEET 11 OF 14

NOTES:  
 1. SOUNDINGS ARE IN FEET AND TENTHS AND REFER TO MEAN LOWER LOW WATER.  
 2. HORIZONTAL DATUM IS SOUTH CAROLINA STATE PLANE COORDINATES NAD 1983.  
 3. THE SOUNDINGS ON THIS DRAWING ONLY INDICATE THE GENERAL CONDITION OF THE CHANNEL ON THE DATE OF SURVEY.  
 4. DATE OF SURVEY: 26 SEP - 3 OCT 2012

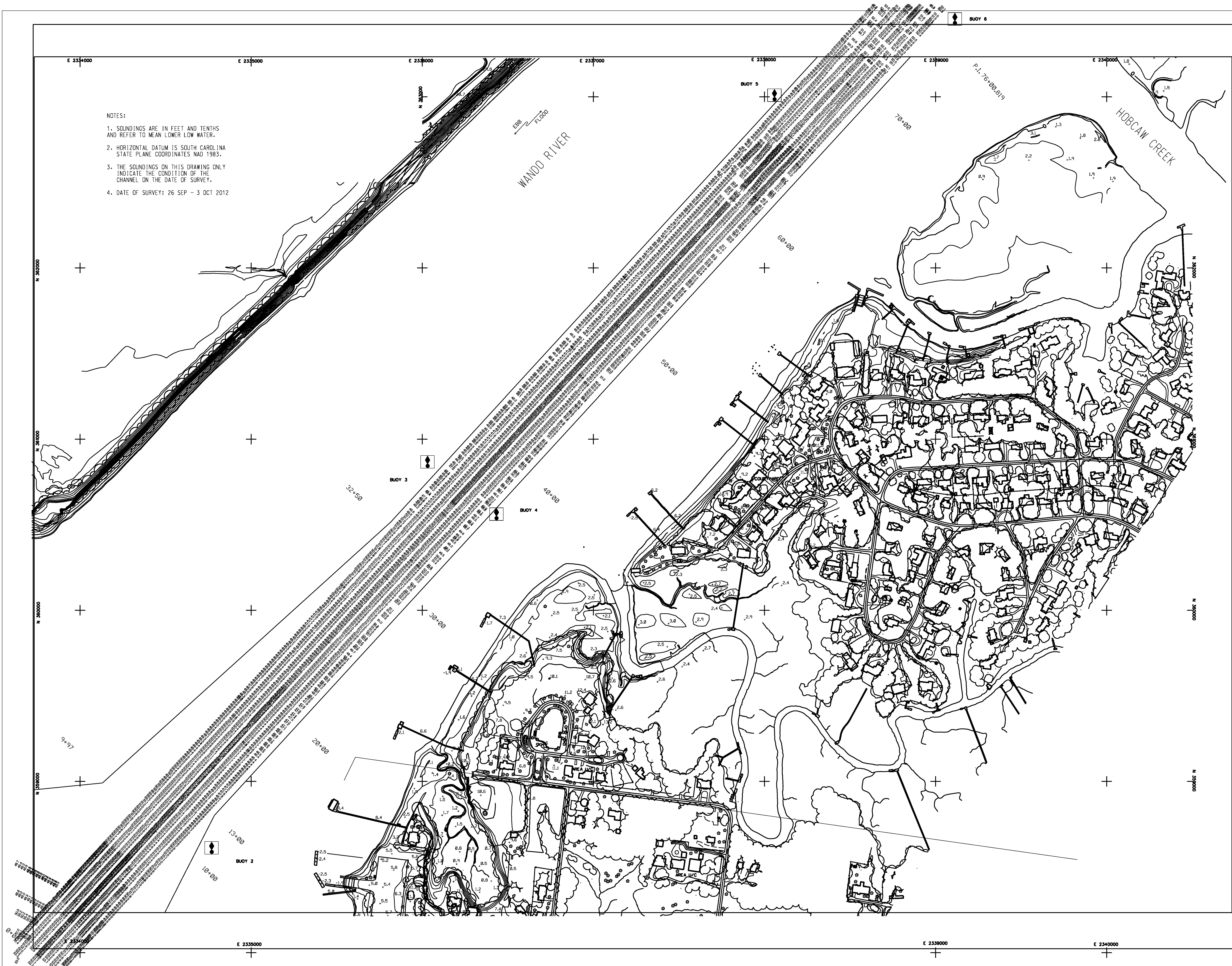

**US Army Corps  
of Engineers  
Charleston District**

NO.	DATE	DESCRIPTION	REVISION

**U.S. ARMY ENGINEER DISTRICT  
CORPS OF ENGINEERS  
CHARLESTON, SOUTH CAROLINA**

Project No: 9453  
Date: OCT 2012  
Scale: 1" = 800'  
Drawing Code: P&I-76-00-B19

Designed by: [Blank]  
Checked by: [Blank]  
Drawn by: MRY  
Reviewed by: [Blank]  
Submitted by: [Blank]

CHARLESTON HARBOR  
LOWER CHARLESTON HARBOR  
**9453**  
CHARLESTON COUNTY  
SOUTH CAROLINA

SHEET  
REFERENCE  
NUMBER

SHEET 12 OF 14

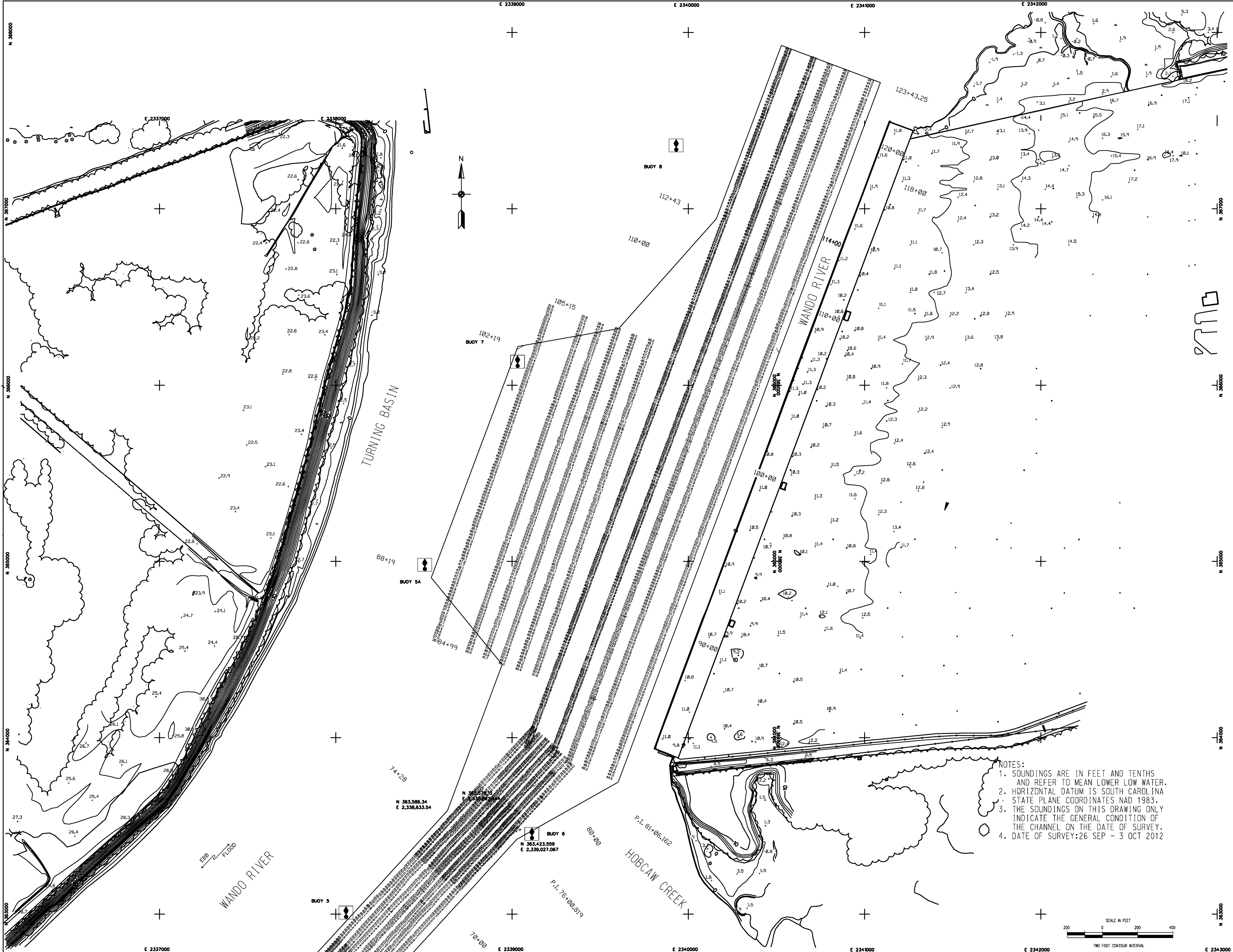

DATE	APPV.	DESCRIPTION

Designed by U.S. ARMY ENGINEER DISTRICT CORPS OF ENGINEERS CHARLESTON, SOUTH CAROLINA	Drawn by MERV	Date OCT 2012	Sheet title no. 9453

CHARLESTON HARBOR  
LOWER CHARLESTON HARBOR  
**9453**  
SOUTH CAROLINA  
CHARLESTON COUNTY

SHEET  
REFERENCE  
NUMBER  
SHEET 13 OF 14

- NOTES:  
1. SOUNDINGS ARE IN FEET AND TENTHS AND REFER TO MEAN LOWER LOW WATER.  
2. HORIZONTAL DATUM IS SOUTH CAROLINA STATE PLANE COORDINATES NAD 1983.  
3. THE SOUNDINGS ON THIS DRAWING ONLY INDICATE THE GENERAL CONDITION OF THE CHANNEL ON THE DATE OF SURVEY.  
4. DATE OF SURVEY: 26 SEP - 3 OCT 2012

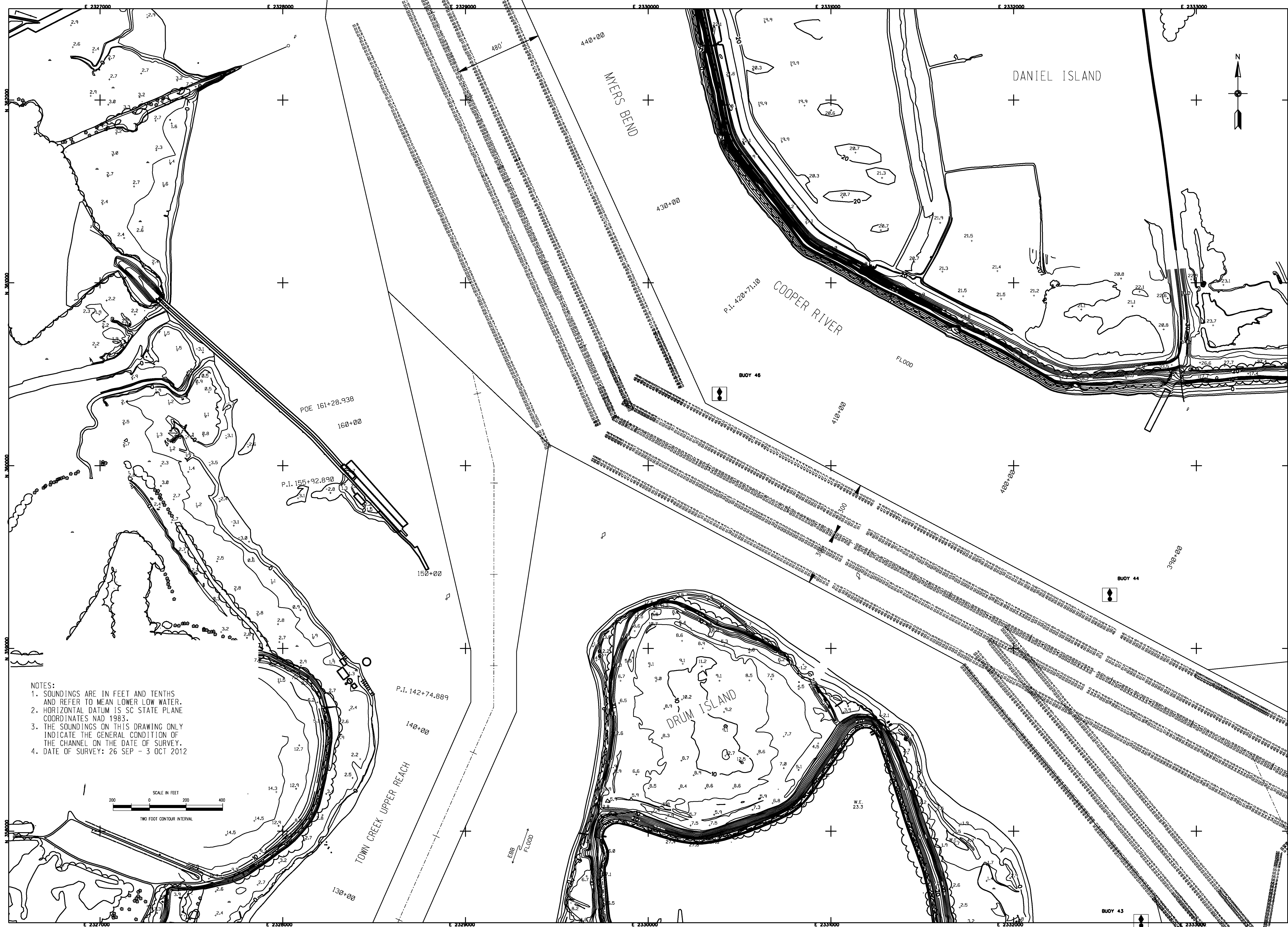

- NOTES:
- SOUNDINGS ARE IN FEET AND TENTHS AND REFER TO MEAN LOWER LOW WATER.
  - HORIZONTAL DATUM IS SC STATE PLANE COORDINATES NAD 1983.
  - THE SOUNDINGS ON THIS DRAWING ONLY INDICATE THE GENERAL CONDITION OF THE CHANNEL ON THE DATE OF SURVEY.
  - DATE OF SURVEY: 26 SEP - 3 OCT 2012

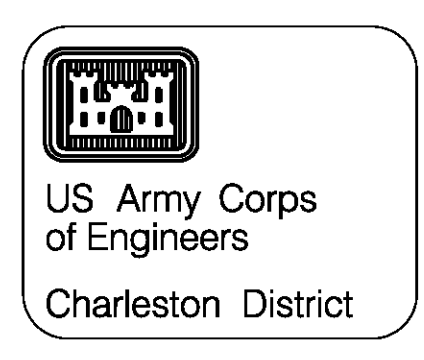
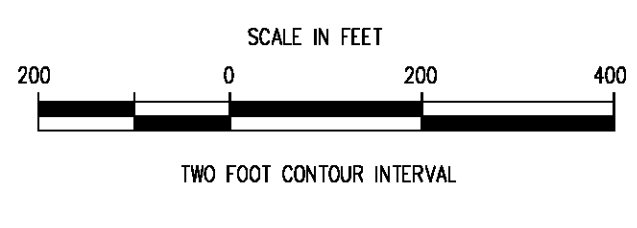

NO.	DESCRIPTION	DATE	BY

Date: OCT 2012  
 Design No: 9453  
 Drawing Code:  
 Drawn by: MRY  
 Reviewed by:  
 Submitted by:  
 No. of sheets: 14  
 Drawing Sheet No: 200

U.S. ARMY ENGINEER DISTRICT  
 CHARLESTON, SOUTH CAROLINA  
 CHARLESTON HARBOR  
 LOWER CHARLESTON HARBOR  
 9453  
 SOUTH CAROLINA  
 CHARLESTON COUNTY