

# Drills, Spills, and Chills

By Ken Bird and Rick Stanley, Geologists

**The inside story on USGS estimates of Alaskan oil and gas resources**

- ▲ See the basic elements of a petroleum system—where the oil comes from and where it goes
- ▲ USGS resource assessments in Alaska have a long history and have changed over time
- ▲ Learn how the newest and best scientific research methods are used to prepare oil and gas estimates
- ▲ Find out what the USGS estimates really mean and how are they are applied to land-use decisions
- ▲ The North Slope (including Prudhoe Bay, NPRA, and ANWR) and the Yukon Flats area provide contrasting case studies

**Thursday, November 16, 2006, 7:00 p.m.**  
**USGS, Building 3, Conference Room A**  
**Menlo Park, California**

## Directions to USGS Menlo Park Service Center

The campus of the USGS Menlo Park Service Center is located at 345 Middlefield Road in Menlo Park. From San Francisco, exit highway 101 at Marsh Road, Atherton and go west to the T junction of Middlefield and turn left (south). From San Jose, exit highway 101 at Willow Road, Menlo Park, and go west to the intersection with Middlefield, turning right (at the Chevron Station). Enter the USGS campus at Survey Land (the main driveway, with large stone markers labeled "U.S. Geological Survey"). You may park in any of our lots and walk to Building 3 (see campus map at right).

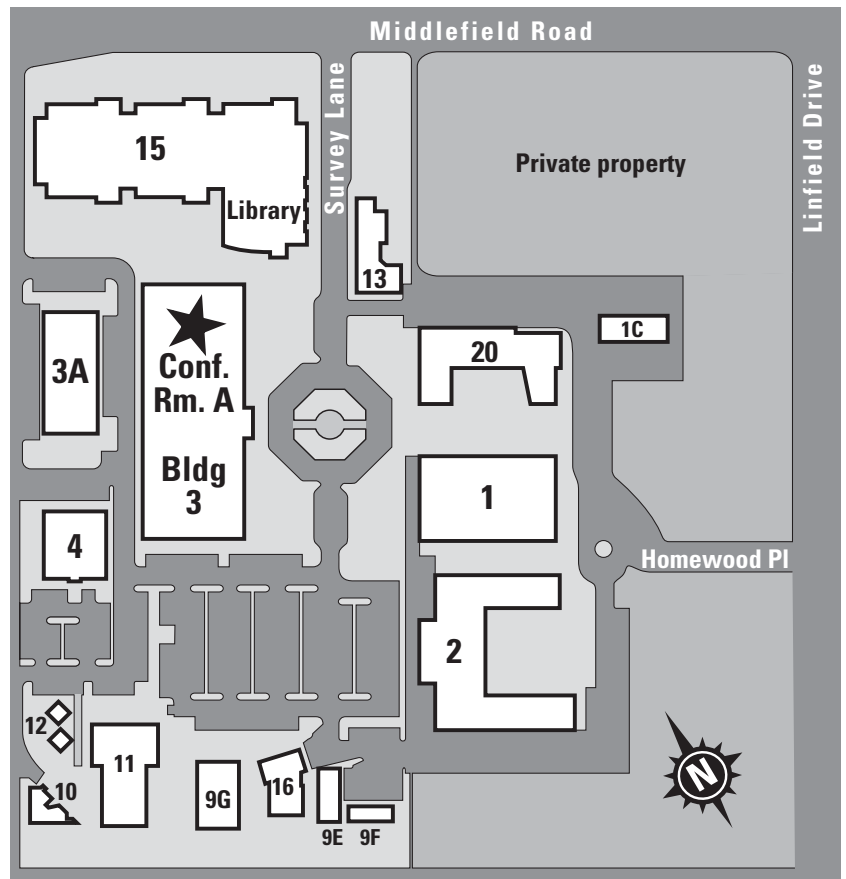
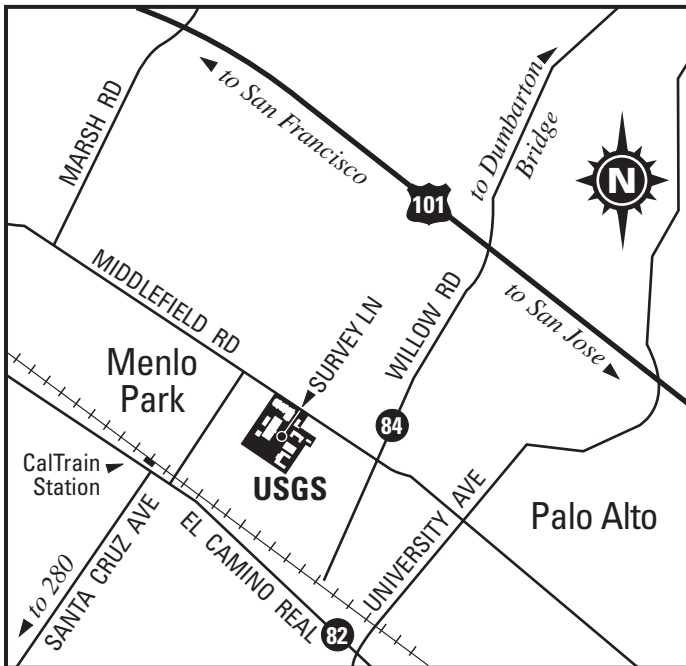

## Invitation to free public lecture at U.S. Geological Survey, Menlo Park Service Center



Office of Communications  
U.S. Geological Survey – MS144  
345 Middlefield Road  
Menlo Park, CA 94025

FIRST CLASS POSTAGE

