

# Restoring the Wild Heart of South San Francisco Bay

## *The South Bay Salt Pond Restoration Project*

by Laura Valoppi, Lead Scientist

- This is largest Western U.S. coastal wetlands restoration project, encompassing 15,100 acres of former salt ponds around the edge of South San Francisco Bay
- The project will restore and enhance South Bay wetlands for endangered species and migratory birds while providing flood management and wildlife oriented public access and recreation
- USGS multidisciplinary science is guiding the restoration effort, providing an integral part of the adaptive management process being used to restore this area over the next 50 years
- Scientists are conducting studies in avian and invertebrate biology, water quality, hydrology, geomorphology, and chemistry to better understand the wetland ecosystem



Photo credit: Judy Irving/Pelican Media

Free Public Lecture  
USGS Menlo Park Campus  
**May 31, 2012, 7 PM**

## Directions to U.S. Geological Survey

The USGS Menlo Park Science Center is located at 345 Middlefield Road in Menlo Park

### From San Francisco

- Exit highway 101 at Marsh Road, Atherton
- Go west to the T-junction with Middlefield Rd.
- Turn left (south)

### From San Jose

- Exit highway 101 at Willow Road, Menlo Park
- Go west to Middlefield Rd.
- Turn right (north)

Enter the USGS campus at Survey Lane with large stone markers labeled “U.S. Geological Survey”

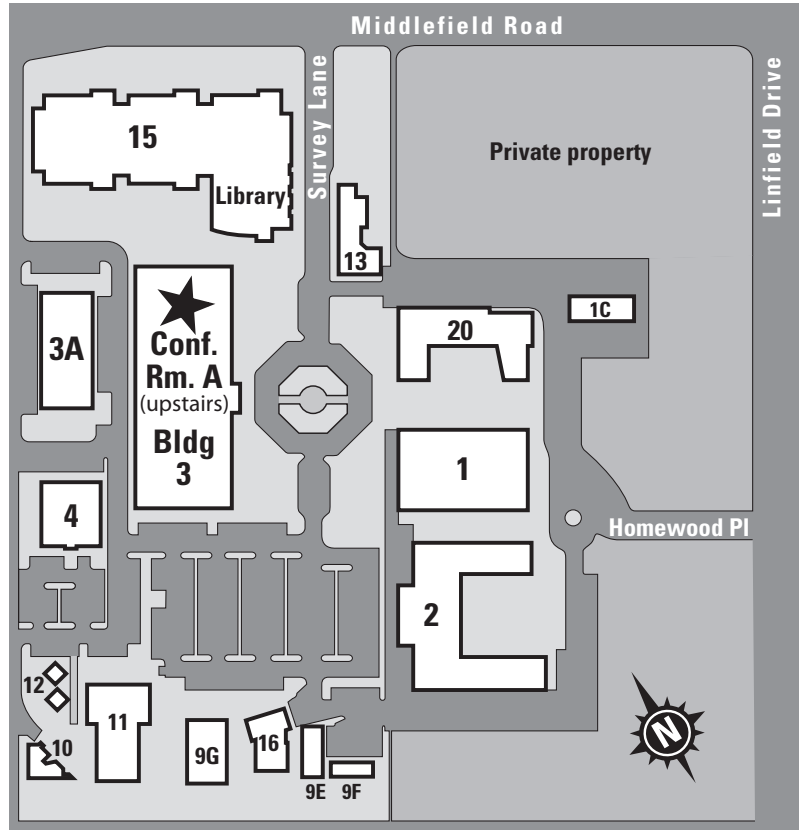
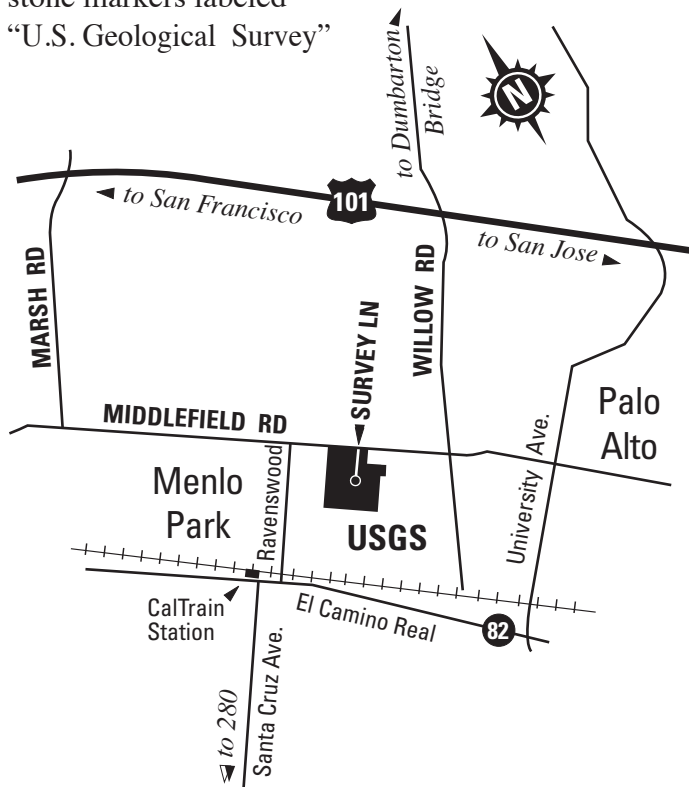

 For special needs accommodation please call 650-329-5136, or e-mail [abarrales2@usgs.gov](mailto:abarrales2@usgs.gov), two weeks prior to an upcoming event.

## Free USGS Public Lecture

For email announcements: [abarrales2@usgs.gov](mailto:abarrales2@usgs.gov)



Office of Communications  
U.S. Geological Survey – MS144  
345 Middlefield Road  
Menlo Park, CA 94025

FIRST CLASS POSTAGE

