

Projected Climate Change Impacts in California

—the consequences of increasing atmospheric greenhouse gases

2C or not 2C, that is the challenge

by Tom Suchanek

*USGS Western Ecological Research Center
Lead Scientist and Climate Change Coordinator*

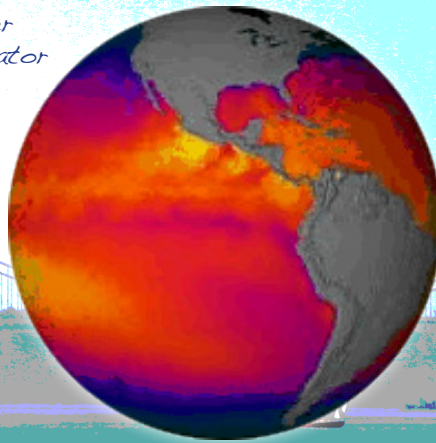

Free Public Lecture

USGS Menlo Park Science Center

March 22, 7 PM

- How will decisions that the global community makes about emissions likely affect the future of the western U.S.?
- How will rising sea level likely affect coastal human communities and vulnerable ecological systems along the Pacific coast?
- What might changes in atmospheric CO₂ concentrations mean to human land-use and environmental systems throughout California, and the San Francisco Bay Area?
- What might Sierra snowpack, sensitive fire regimes, and species distributions look like in our children's and grandchildren's generations?

Directions to U.S. Geological Survey

The USGS Menlo Park Science Center is located at 345 Middlefield Road in Menlo Park

From San Francisco

- Exit highway 101 at Marsh Road, Atherton
- Go west to the T-junction with Middlefield Rd.
- Turn left (south)

From San Jose

- Exit highway 101 at Willow Road, Menlo Park
- Go west to Middlefield Rd.
- Turn right (north)

Enter the USGS campus at Survey Lane with large stone markers labeled “U.S. Geological Survey”

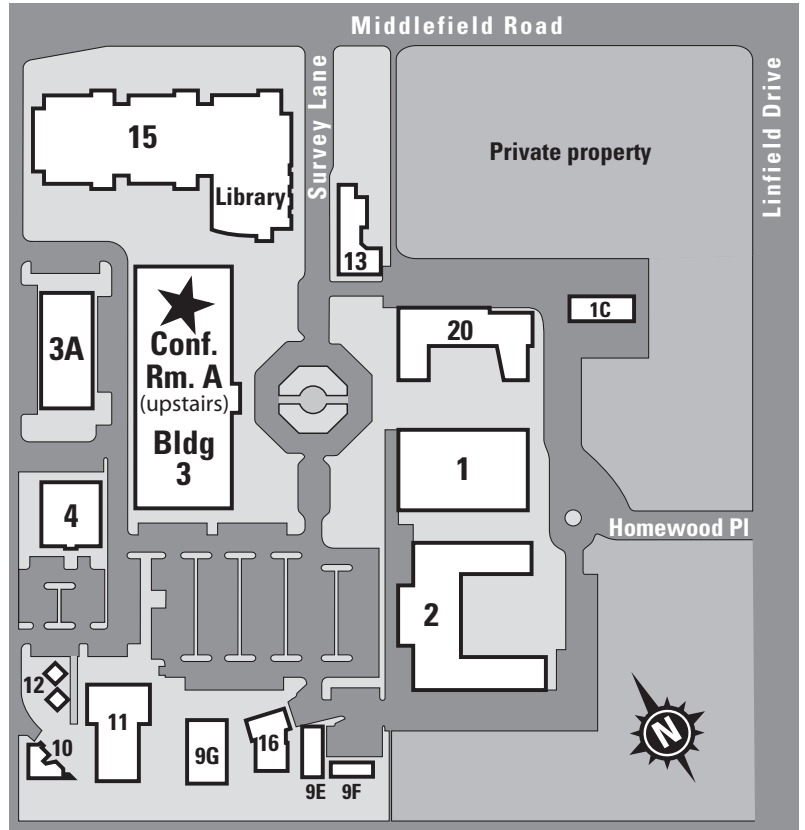
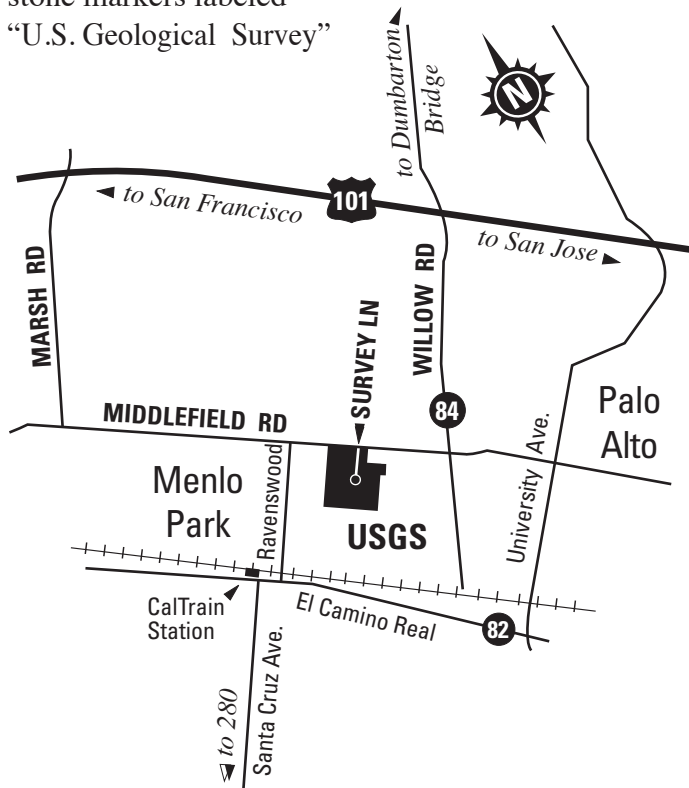

 Please contact us at least two weeks before an upcoming event to request accomodation for special needs by calling 650-329-5136.

Free USGS Public Lecture

For email announcements: abarrales2@usgs.gov



Office of Communications
U.S. Geological Survey – MS144
345 Middlefield Road
Menlo Park, CA 94025

FIRST CLASS POSTAGE

