

Lassen Volcanic National Park

— *a wonderland of volcanoes and thermal features*

by **Patrick Muffler, Geologist Emeritus**

Lassen Peak, the southernmost active volcano in the Cascade Range, explosively erupted in 1915, devastating nearby areas and raining volcanic ash as far away as 200 miles to the east

Lassen National Park, in addition to prominent volcanic areas, contains the most spectacular array of thermal features in the Cascade Range including fumaroles, bubbling mud pots, and a boiling lake

A new USGS map shows volcanic centers in unprecedented detail, enabling development of products to better evaluate and assess regional volcanic hazards



Free Public Lecture

USGS Menlo Park Science Center

January 26, 2012, 7PM

• Landsat 7 background image shows Lassen Peak area

Directions to U.S. Geological Survey

The USGS Menlo Park Science Center is located at 345 Middlefield Road in Menlo Park

From San Francisco

- Exit highway 101 at Marsh Road, Atherton
- Go west to the T-junction with Middlefield Rd.
- Turn left (south)

From San Jose

- Exit highway 101 at Willow Road, Menlo Park
- Go west to Middlefield Rd.
- Turn right (north)

Enter the USGS campus at Survey Lane with large stone markers labeled "U.S. Geological Survey"

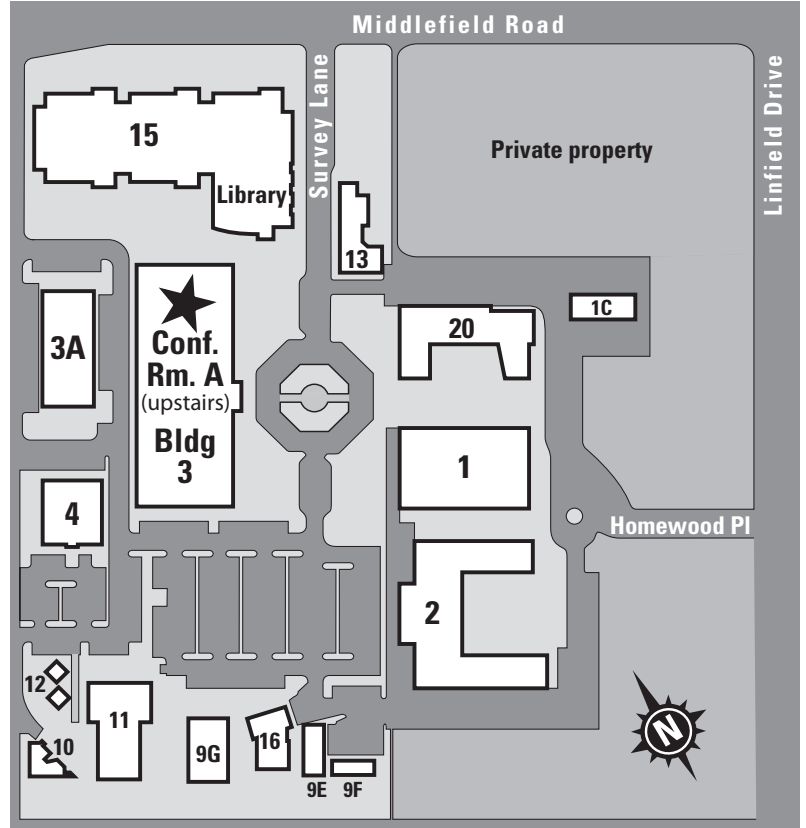
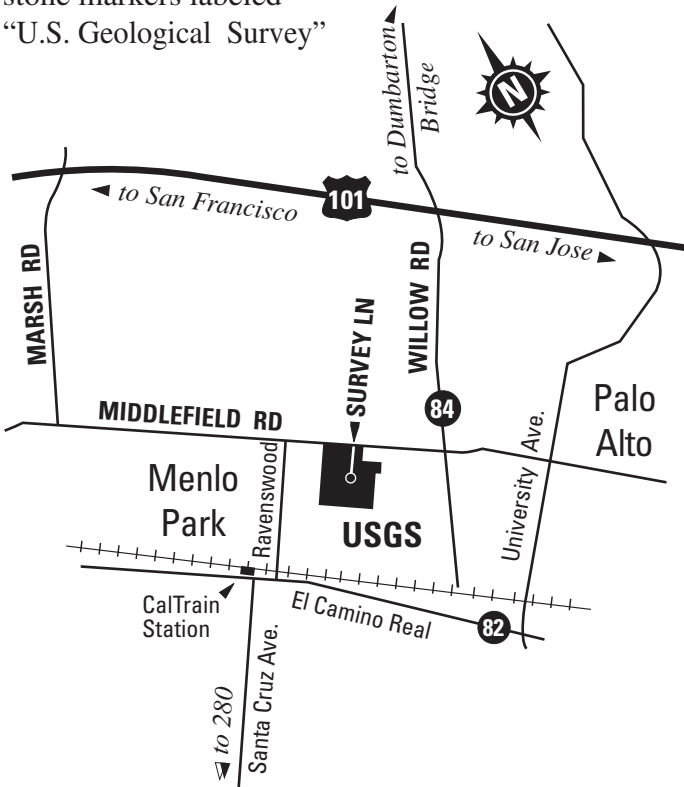

Special Assistance - Please contact us at least two weeks in advance of an event to request assistance. Special needs will be accommodated whenever possible. (650-329-5136)

Free USGS Public Lecture

For email announcements: abarrales2@usgs.gov



Office of Communications
U.S. Geological Survey – MS144
345 Middlefield Road
Menlo Park, CA 94025

FIRST CLASS POSTAGE

