

# EXPLORING MARS WITH *CURIOSITY*

— *searching the Martian surface for evidence of habitable conditions*

by Ken Herkenhoff  
USGS Astrogeology Science Center

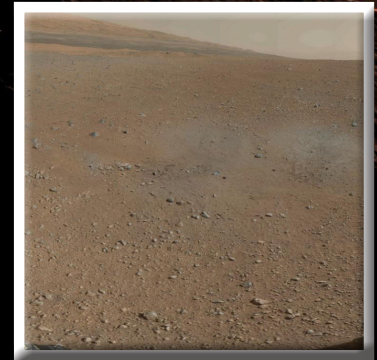
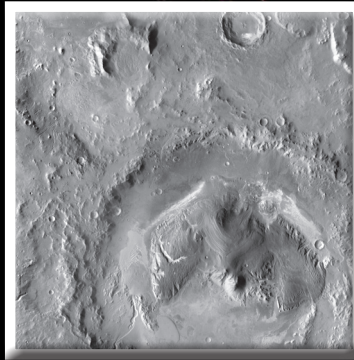
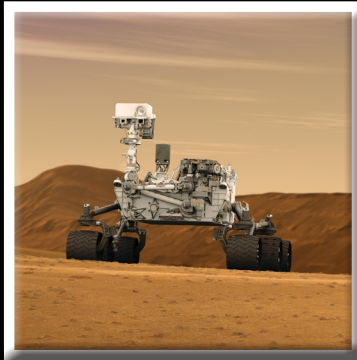

- The Mars Science Laboratory rover "Curiosity" landed successfully on August 5th to begin its 23 month mission
- What have scientists discovered so far, particularly with respect to the geology of the Gale crater landing site?
- Instruments aboard Curiosity are searching for evidence of environmental conditions that could support microbial life
- How are dust and rocks analyzed and studied to learn about the role of water in forming the Martian landscape?

**Free Public Lecture  
USGS Menlo Park Campus  
October 25, 2012 at 7 PM**

## Directions to U.S. Geological Survey

The USGS Menlo Park Science Center is located at 345 Middlefield Road in Menlo Park

### From San Francisco

- Exit highway 101 at Marsh Road, Atherton
- Go west to the T-junction with Middlefield Rd.
- Turn left (south)

### From San Jose

- Exit highway 101 at Willow Road, Menlo Park
- Go west to Middlefield Rd.
- Turn right (north)

Enter the USGS campus at Survey Lane with large stone markers labeled “U.S. Geological Survey”

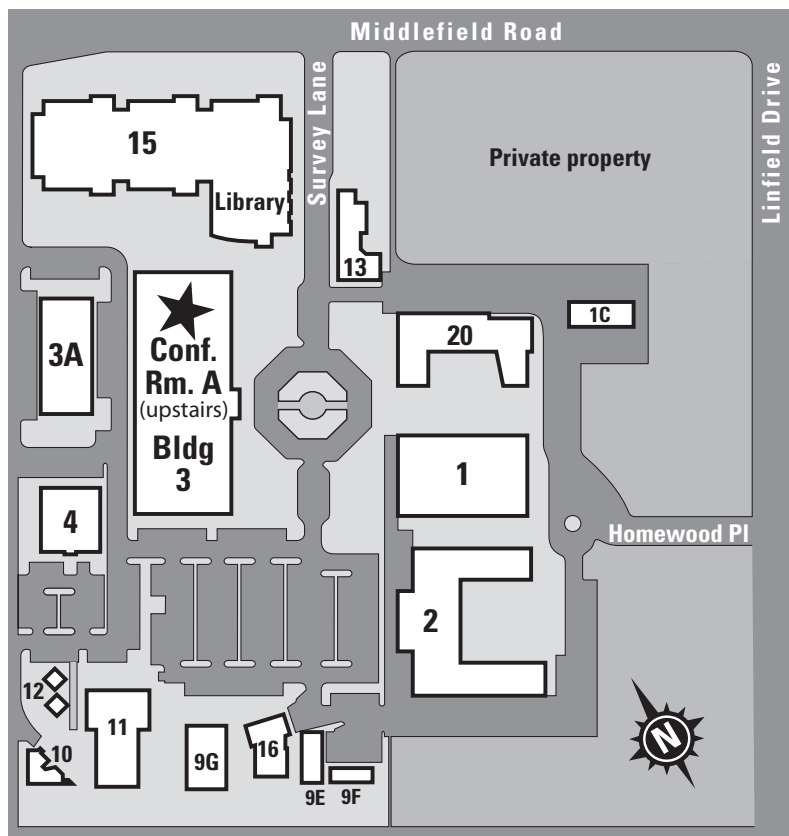
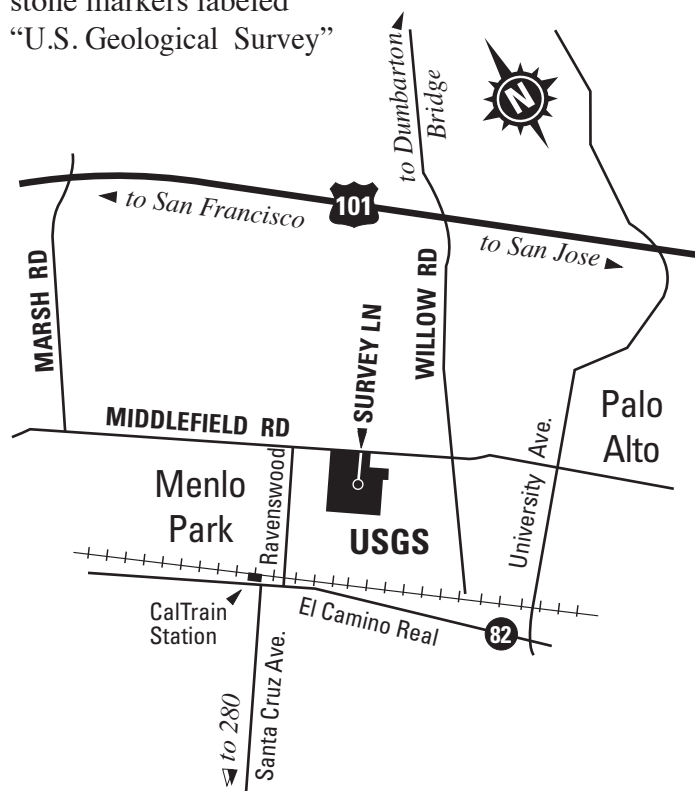

 For special needs accommodation please call 650-329-5136, or e-mail [abarrales2@usgs.gov](mailto:abarrales2@usgs.gov), two weeks prior to an upcoming event.

## Free USGS Public Lecture

For email announcements: [abarrales2@usgs.gov](mailto:abarrales2@usgs.gov)



Office of Communications  
U.S. Geological Survey – MS144  
345 Middlefield Road  
Menlo Park, CA 94025

FIRST CLASS POSTAGE

