

Wind Energy and Wildlife

by *Manuela Huso,*
Research Statistician



*— the challenges of wind-energy
development and wildlife conservation*

- Wind-power development in the United States is increasing exponentially, with proposals to provide 20% of the country's total power by 2030.
- High numbers of bird and bat carcasses at some wind farms have raised concerns about the environmental effects of this rapidly expanding industry.
- Why don't simple counts of carcasses beneath turbines provide reliable estimates of fatality?
- What tools are scientists developing to accurately estimate wildlife fatalities and help identify options for monitoring and mitigation?

Free Public Lecture
USGS Menlo Park Campus
July 26, 2012 at 7 PM

Directions to U.S. Geological Survey

The USGS Menlo Park Science Center is located at 345 Middlefield Road in Menlo Park

From San Francisco

- Exit highway 101 at Marsh Road, Atherton
- Go west to the T-junction with Middlefield Rd.
- Turn left (south)

From San Jose

- Exit highway 101 at Willow Road, Menlo Park
- Go west to Middlefield Rd.
- Turn right (north)

Enter the USGS campus at Survey Lane with large stone markers labeled “U.S. Geological Survey”

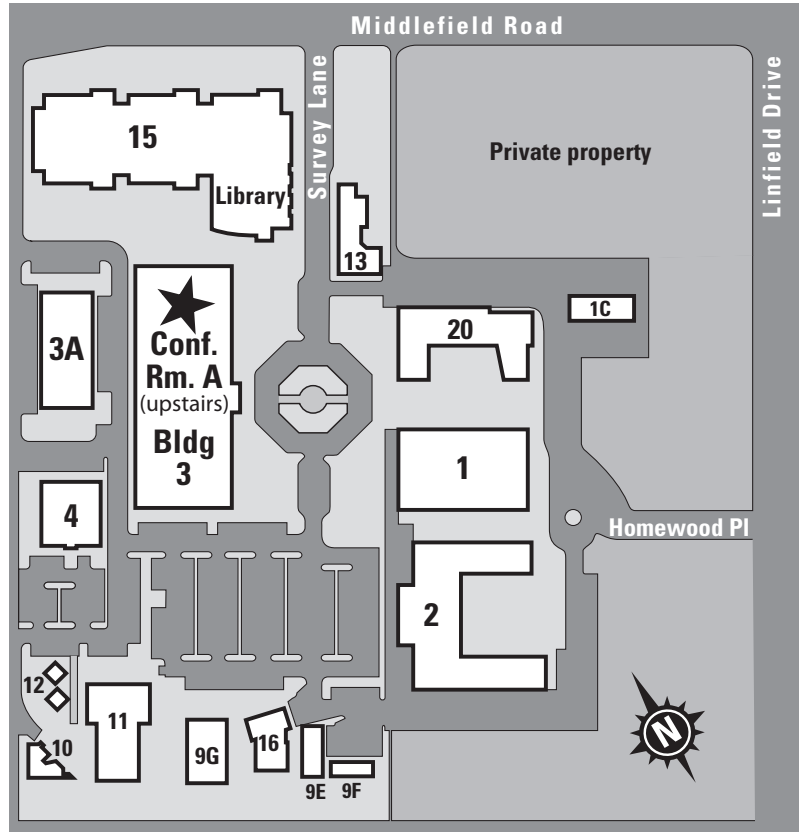
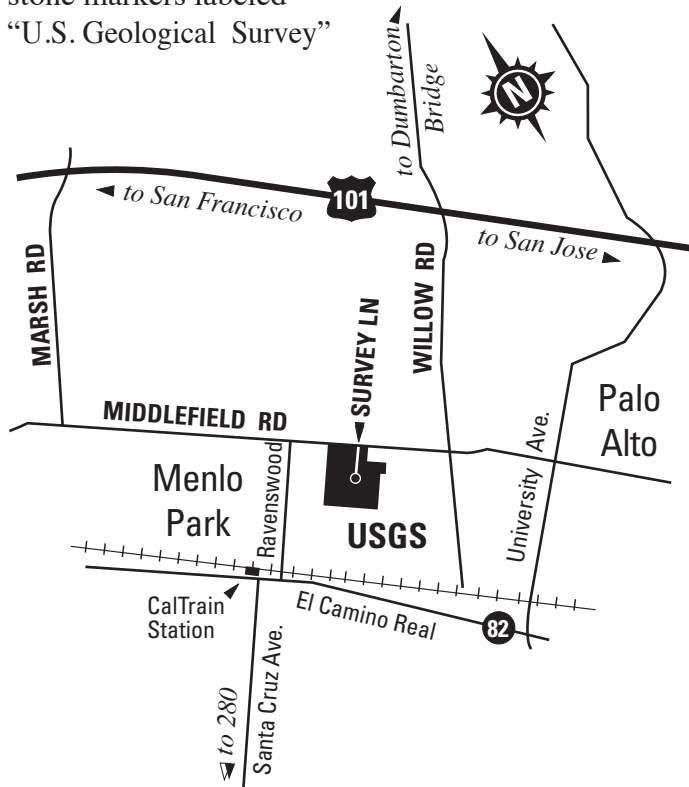

 For special needs accommodation please call 650-329-5136, or e-mail abarrales2@usgs.gov, two weeks prior to an upcoming event.

Free USGS Public Lecture

For email announcements: abarrales2@usgs.gov



Office of Communications
U.S. Geological Survey – MS144
345 Middlefield Road
Menlo Park, CA 94025



FIRST CLASS POSTAGE

