

Global Food Security in the 21st Century

— the increasing need for food production, cropland areas, and agricultural water

by USGS Research Geographer
Prasad Thenkabail

- Worldwide demand for food will require more than one billion hectares of new cropland to feed 9 billion plus people by 2050
- Presently, of all the water used by humans over 70% goes towards agriculture to produce food in most countries
- Remote-sensing from space will provide crucial data for policy development affecting croplands and their water use
- Social scientists recognize global food security as a primary requirement for human advancement, overall health, and peaceful coexistence.



70%



Free Public Lecture
USGS Menlo Park Campus
August 30, 2012 , 7 PM

Directions to U.S. Geological Survey

The USGS Menlo Park Science Center is located at 345 Middlefield Road in Menlo Park

From San Francisco

- Exit highway 101 at Marsh Road, Atherton
- Go west to the T-junction with Middlefield Rd.
- Turn left (south)

From San Jose

- Exit highway 101 at Willow Road, Menlo Park
- Go west to Middlefield Rd.
- Turn right (north)

Enter the USGS campus at Survey Lane with large stone markers labeled “U.S. Geological Survey”

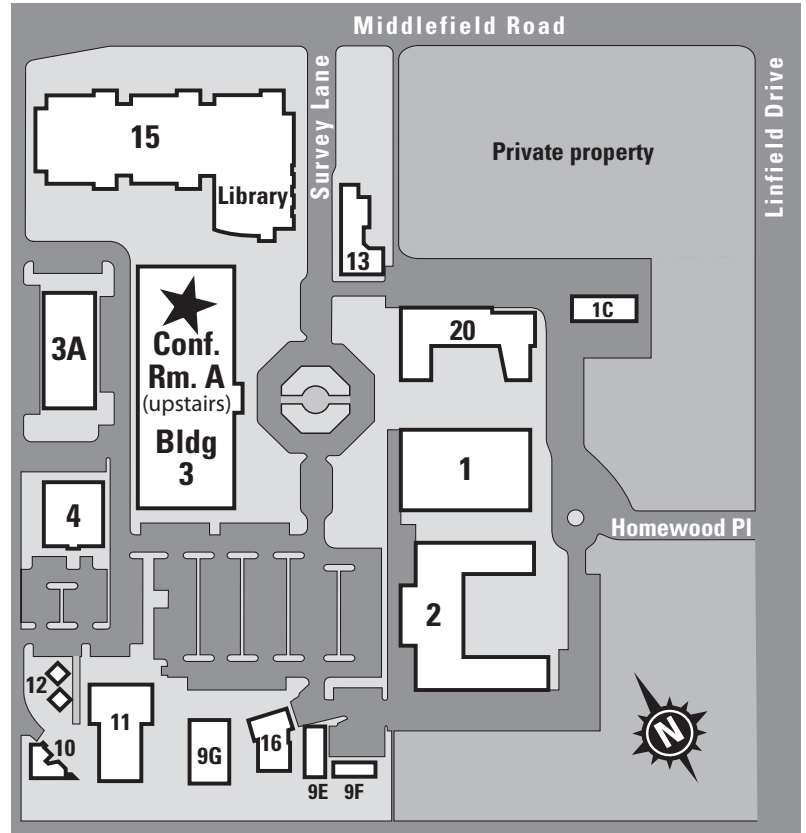
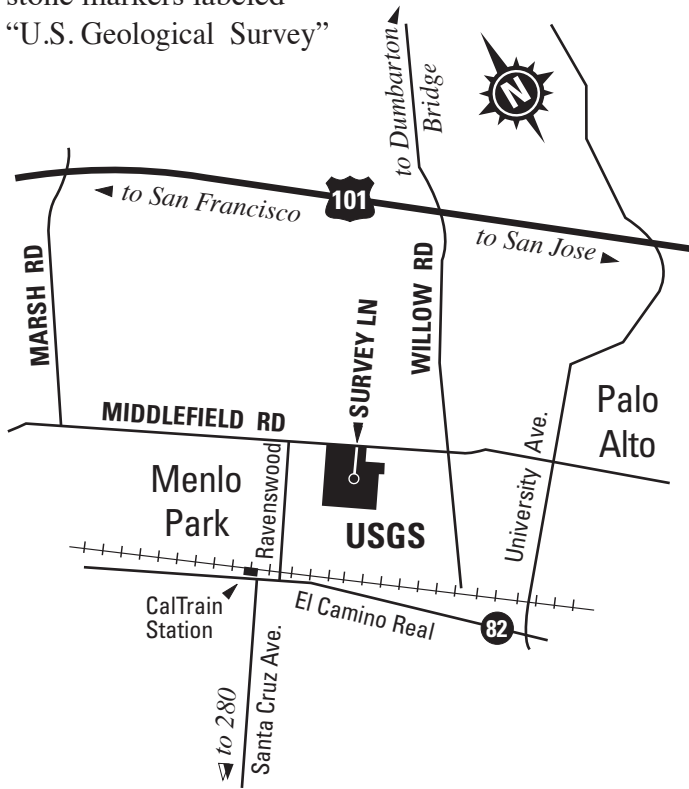

 For special needs accommodation please call 650-329-5136, or e-mail abarrales2@usgs.gov, two weeks prior to an upcoming event.

Free USGS Public Lecture

For email announcements: abarrales2@usgs.gov



Office of Communications
U.S. Geological Survey – MS144
345 Middlefield Road
Menlo Park, CA 94025



FIRST CLASS POSTAGE

