

Studying Migratory Connectivity in a Changing Climate

Free Public Lecture • **October 27, 7PM** • USGS Conference Room A, Bldg 3 • 345 Middlefield Road, Menlo Park, CA

*by Susan Haig
Wildlife Ecologist*

- Scientists are studying global migratory animal movements throughout their annual cycles to improve conservation efforts

- Changing climate conditions are accentuating this need, as species movements and their ranges fluctuate every year

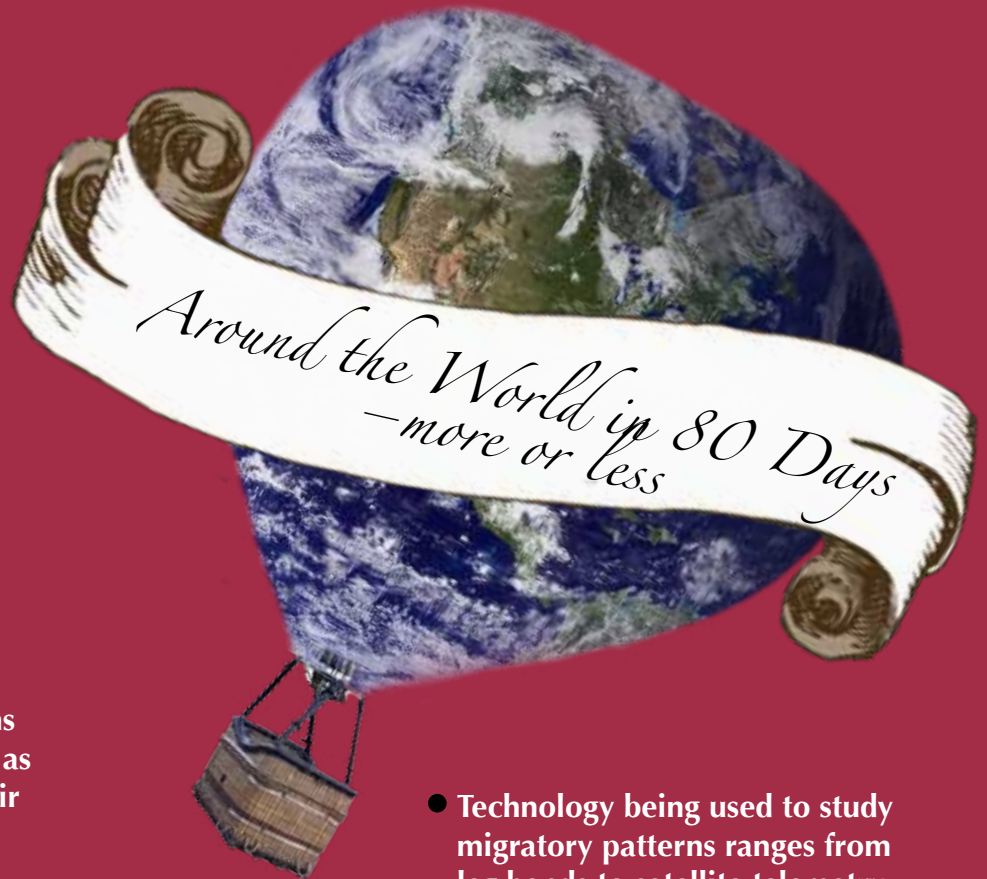

- Technology being used to study migratory patterns ranges from leg bands to satellite telemetry and isotopic markers



The Migratory
Connectivity Project

www.migratoryconnectivityproject.org/

- The USGS and the Smithsonian Institution have partnered to form the Migratory Connectivity Project to address this issue

USGS Evening Public Lecture Series: online.wr.usgs.gov/calendar • 650-329-5000

Map for lecture site on reverse

Directions to U.S. Geological Survey

The USGS Menlo Park Science Center is located at 345 Middlefield Road in Menlo Park

From San Francisco

- Exit highway 101 at Marsh Road, Atherton
- Go west to the T-junction with Middlefield Rd.
- Turn left (south)

From San Jose

- Exit highway 101 at Willow Road, Menlo Park
- Go west to Middlefield Rd.
- Turn right (north)

Enter the USGS campus at Survey Lane with large stone markers labeled "U.S. Geological Survey"

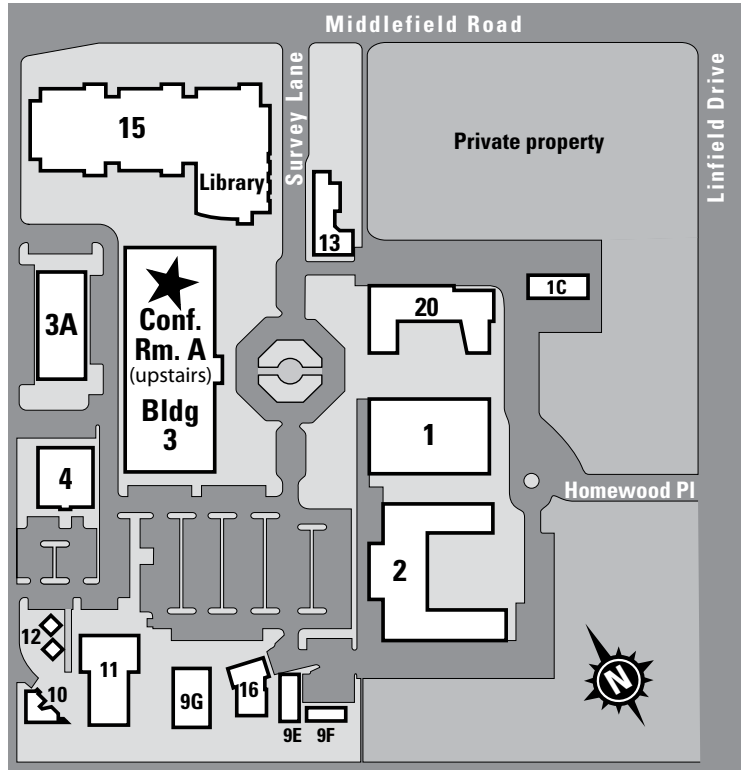
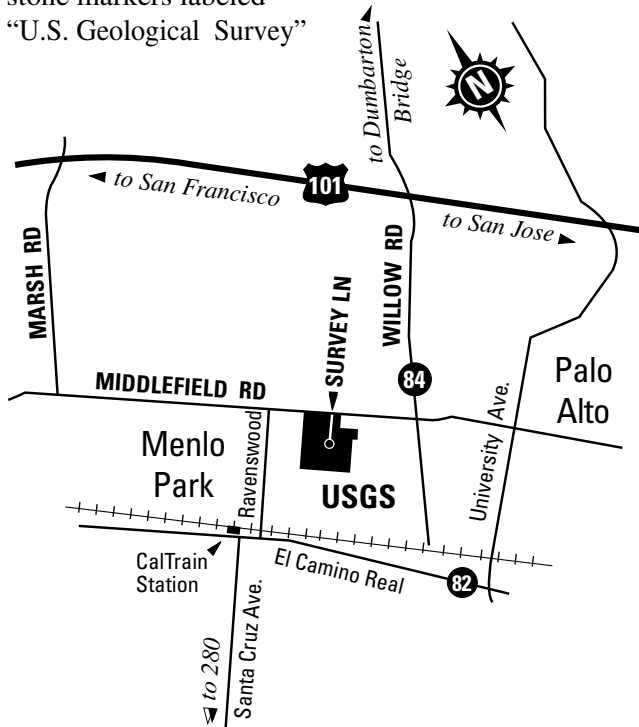

Special Assistance - Please contact us at least two weeks in advance of an event to request assistance. Special needs will be accommodated whenever possible. (650-329-5136)

Free USGS Public Lecture

For email announcements: abarrales2@usgs.gov



Office of Communications
 U.S. Geological Survey – MS144
 345 Middlefield Road
 Menlo Park, CA 94025

FIRST CLASS POSTAGE

