

# ARKSTORM

## A Scenario of a Massive West Coast Storm

By Dale Cox, Project Manager, USGS Multi-Hazards Demonstration Project

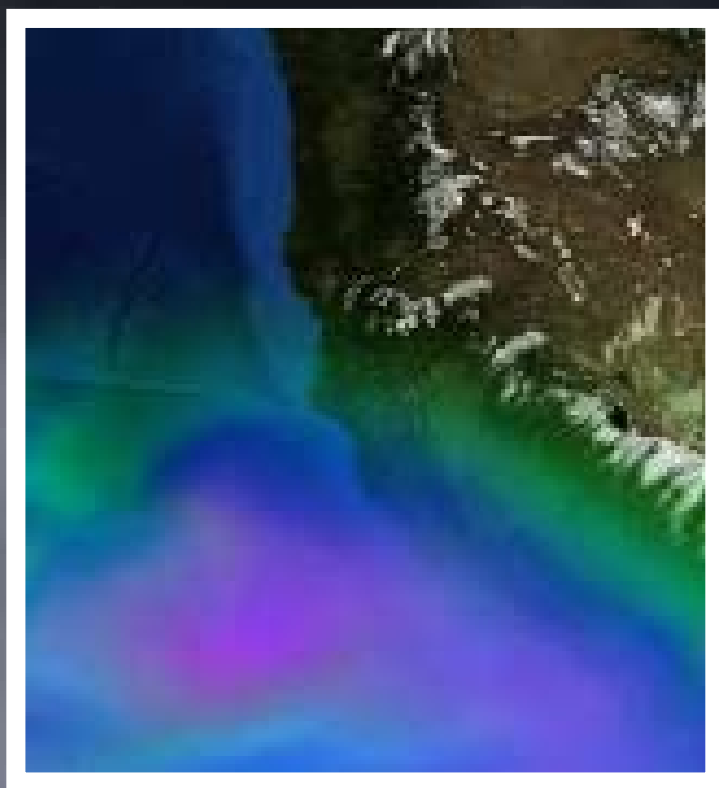

- Scientists are preparing ARkStorm for emergency planning and disaster preparedness
- A series of “Atmospheric River” events slams into the West Coast with hurricane force over several weeks
- Weather models show expected hazards such as floods, landslides, and erosion impacting life and property
- Storms of this magnitude are projected to become more frequent and intense as a result of changing climate conditions



<http://urbanearth.usgs.gov/winter-storm/>

**USGS Evening Public Lecture Series: <http://online.wr.usgs.gov/calendar> • 650-329-5000**

**Map for lecture site on reverse**

## Directions to U.S. Geological Survey

The USGS Menlo Park Science Center is located at 345 Middlefield Road in Menlo Park

### From San Francisco

- Exit highway 101 at Marsh Road, Atherton
- Go west to the T-junction with Middlefield Rd.
- Turn left (south)

### From San Jose

- Exit highway 101 at Willow Road, Menlo Park
- Go west to Middlefield Rd.
- Turn right (north)

Enter the USGS campus at Survey Lane with large stone markers labeled “U.S. Geological Survey”

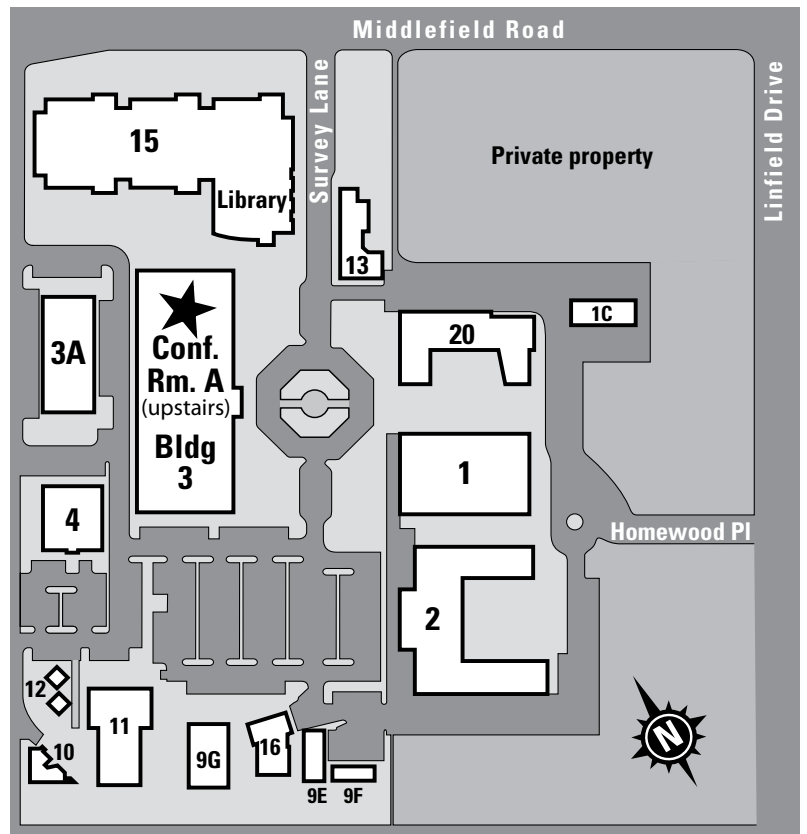
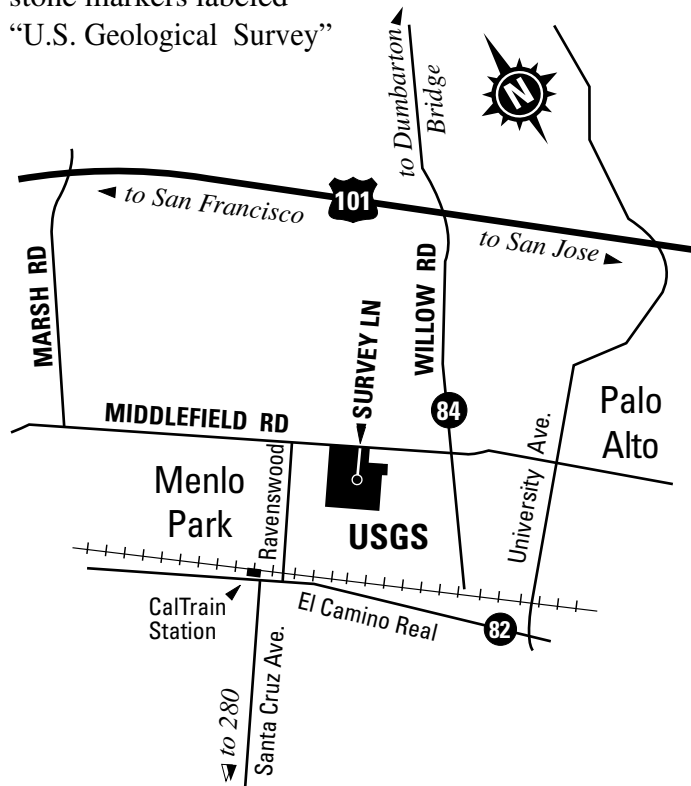

**Special Assistance** - Please contact us at least two weeks in advance of an event to request assistance. Special needs will be accommodated whenever possible. (650-329-5136)

## Free USGS Public Lecture

For email announcements: [abarrales2@usgs.gov](mailto:abarrales2@usgs.gov)



Office of Communications  
 U.S. Geological Survey – MS144  
 345 Middlefield Road  
 Menlo Park, CA 94025

FIRST CLASS POSTAGE

