

Meeting the Challenge of the Loma Prieta Earthquake

with Seismologist Jack Boatwright

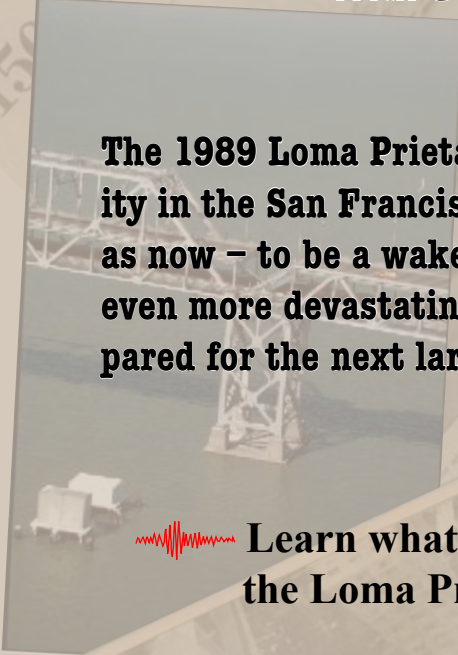

The 1989 Loma Prieta earthquake ended decades of seismic tranquility in the San Francisco Bay region. It was considered then – as well as now – to be a wake-up call for the region to prepare for potentially even more devastating earthquakes. How well is the Bay Area prepared for the next large earthquake?



Learn what scientists now think happened during the Loma Prieta earthquake



How did this destructive event change scientific thinking and influence Bay Area earthquake engineering?



Future large Bay Area earthquakes are inevitable – are we prepared?



Directions to U.S. Geological Survey

The USGS Menlo Park Science Center is located at 345 Middlefield Road in Menlo Park

From San Francisco

- Exit highway 101 at Marsh Road, Atherton
- Go west to the T-junction with Middlefield Rd.
- Turn left (south)

From San Jose

- Exit highway 101 at Willow Road, Menlo Park
- Go west to Middlefield Rd.
- Turn right (north)

Enter the USGS campus at Survey Lane with large stone markers labeled "U.S. Geological Survey"

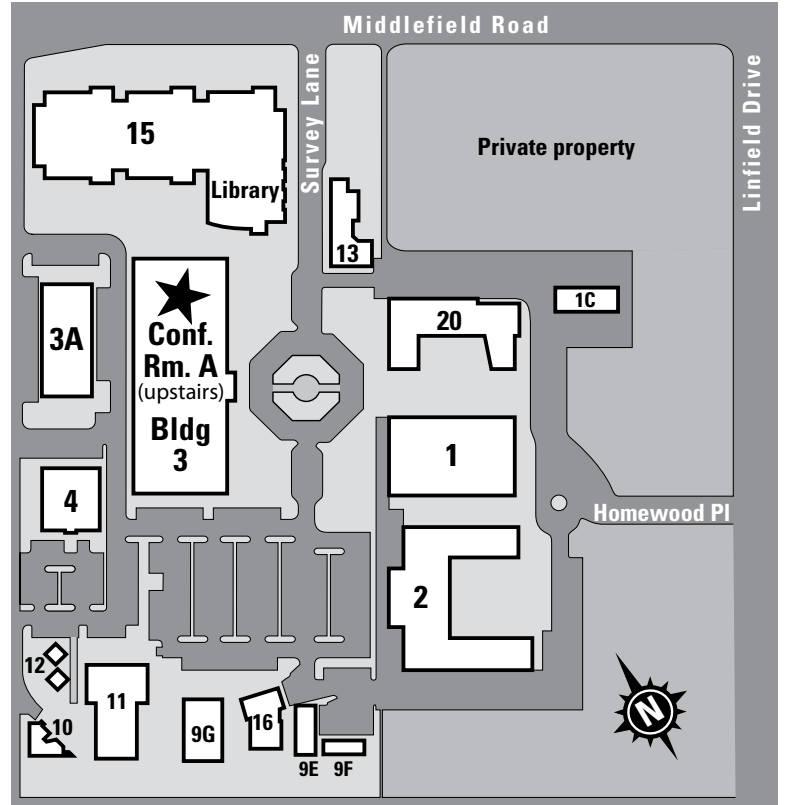
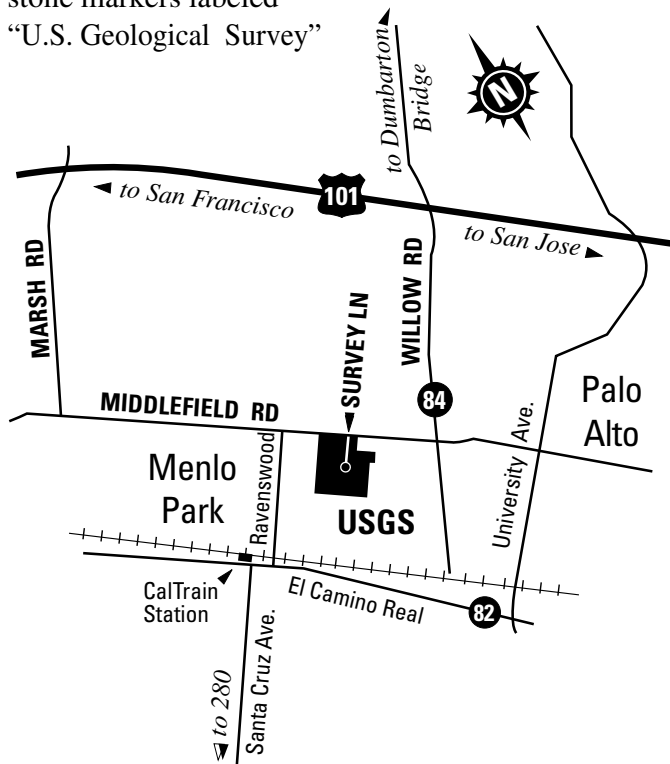

Special Assistance - Please contact us at least two weeks in advance of an event to request assistance. Special needs will be accommodated whenever possible. (650-329-5136)

Free USGS Public Lecture

For email announcements: abarrales2@usgs.gov



Office of Communications
U.S. Geological Survey – MS144
345 Middlefield Road
Menlo Park, CA 94025

FIRST CLASS POSTAGE

