

Can Our Western Forests Take the Heat?!

by Phillip van Mantgem, USGS Ecologist

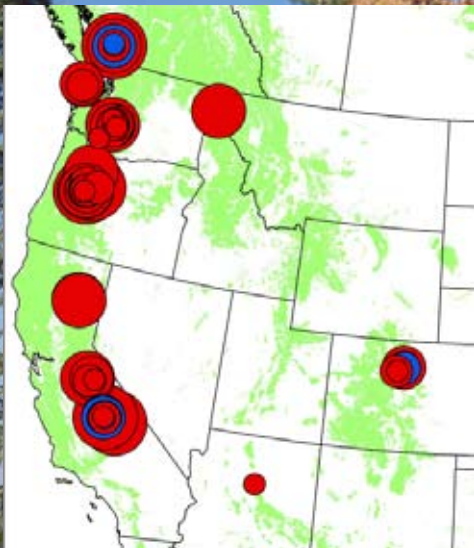

- Tree death rates have more than doubled over the last few decades in old-growth forests of our western states, possibly reflecting increasing temperatures, with potentially serious consequences for wildlife, fire risks, and the global carbon cycle
- Rising regional temperatures have lengthened the summer drought, likely stressing trees and leading to higher death rates
- Is this alarming trend a harbinger of larger, more abrupt changes in our forests?

Photo courtesy of Jerry Franklin, University of Washington



**USGS Evening Public Lecture Series: <http://online.wr.usgs.gov/calendar>
650-329-5000**

Map for lecture site on reverse

Directions to USGS Menlo Park Science Center

The campus of the USGS Menlo Park Science Center is located at 345 Middlefield Road in Menlo Park

From San Francisco

- Exit highway 101 at Marsh Road, Atherton
- Go west to the T junction of Middlefield
- Turn left (south)

From San Jose

- Exit highway 101 at Willow Road, Menlo Park
- Go west to Middlefield
- Turn right (north)

Enter the USGS campus at Survey Lane (the main driveway, with large stone markers labeled "U.S. Geological Survey").

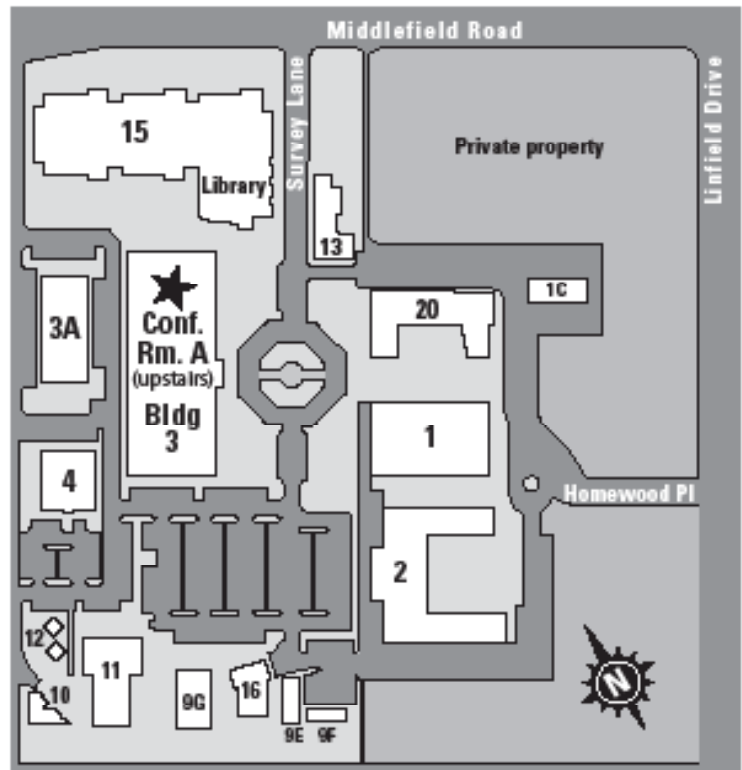
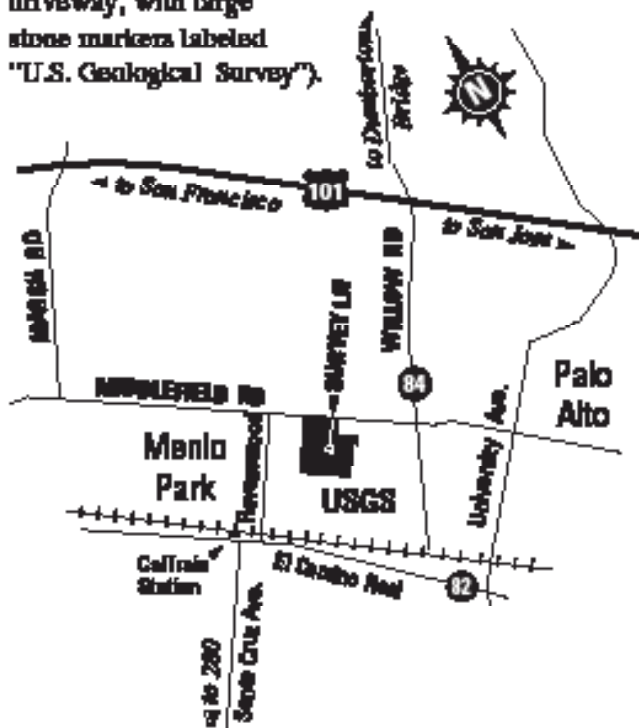

You may park in any of our parking areas
and walk to Building 3

Free public lecture at U.S. Geological Survey

Save trees and money, receive lecture flyers by e-mail: abramles2@usgs.gov



Office of Communications
U.S. Geological Survey - MS144
345 Middlefield Road
Menlo Park, CA 94025

FIRST CLASS POSTAGE

