

The Future of Geothermal Energy — a discussion of present opportunities and future challenges

by Colin F. Williams
Geophysicist

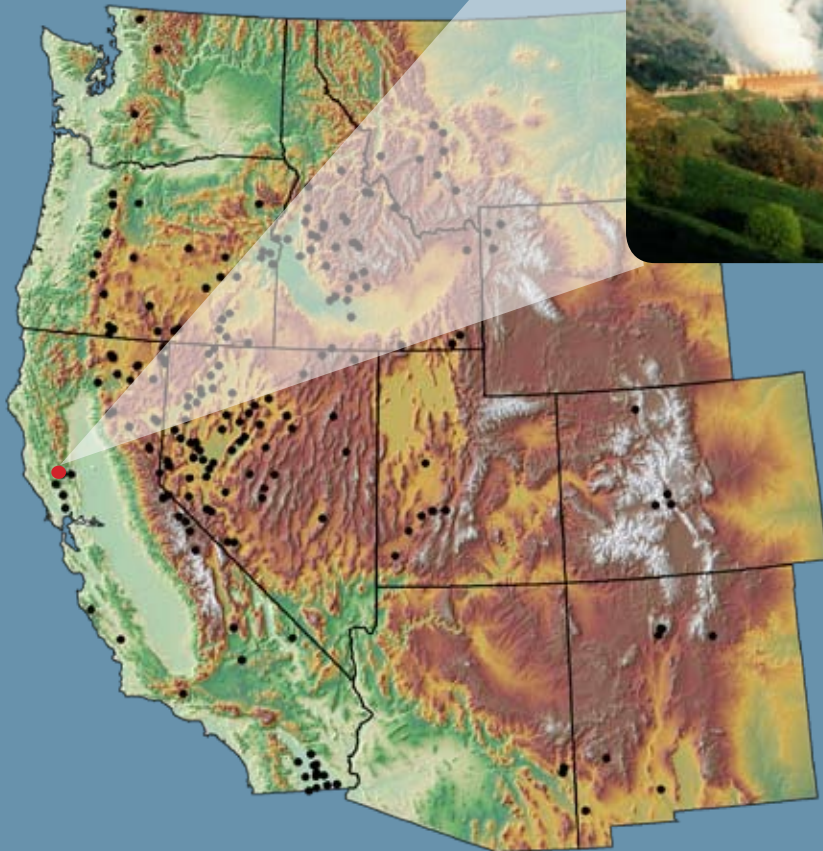

- A new USGS assessment of our Nation's geothermal resources identifies favorable areas for energy development

- Can geothermal energy help satisfy the growing need for "clean" energy sources?

- Seven western states are currently generating electricity from geothermal resources

- Emerging technologies may dramatically increase the potential for geothermal energy extraction

USGS Evening Public Lecture Series: <http://online.wr.usgs.gov/calendar> • 650-329-5000
Map for lecture site on reverse

Directions to U.S. Geological Survey

The USGS Menlo Park Science Center is located at 345 Middlefield Road in Menlo Park

From San Francisco

- Exit highway 101 at Marsh Road, Atherton
- Go west to the T-junction with Middlefield Rd.
- Turn left (south)

From San Jose

- Exit highway 101 at Willow Road, Menlo Park
- Go west to Middlefield Rd.
- Turn right (north)

Enter the USGS campus at Survey Lane with large stone markers labeled "U.S. Geological Survey"

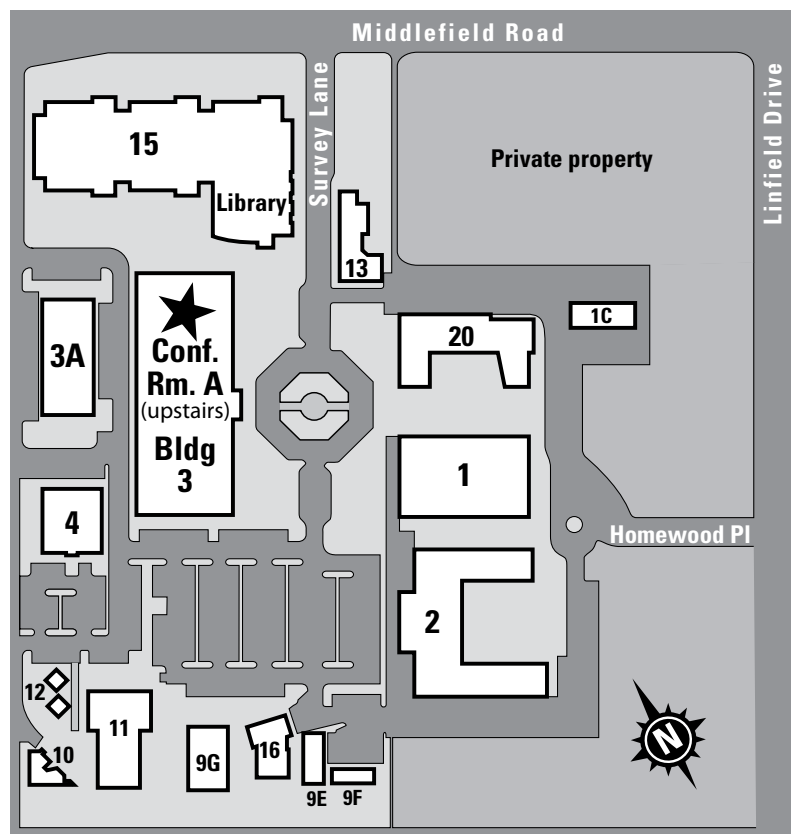
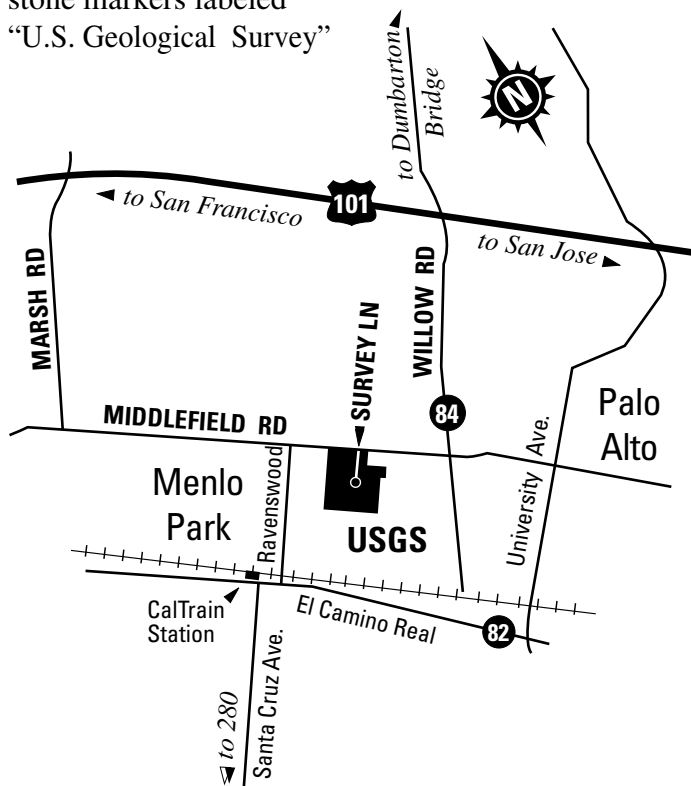

Special Assistance - Please contact us at least two weeks in advance of an event to request assistance. Special needs will be accommodated whenever possible. (650-329-5136)

Free USGS Public Lecture

For email announcements: abarrales2@usgs.gov



Office of Communications
U.S. Geological Survey – MS144
345 Middlefield Road
Menlo Park, CA 94025

FIRST CLASS POSTAGE

