

SOILS, CARBON, and Global exCHANGE

by Jennifer Harden, USGS Soil Scientist

- Studying Arctic Changes during the International Polar Year
- Why soils aren't just for growing crops
- What does carbon have to do with global weather and climate?
- Balancing tradeoffs between the carbon cycle, economic concerns, and the environment
- Making choices—from household decisions to national policies



Directions to USGS Menlo Park Service Center

The campus of the USGS Menlo Park Service Center is located at 345 Middlefield Road in Menlo Park. From San Francisco, exit highway 101 at Marsh Road, Atherton and go west to the T junction of Middlefield and turn left (south). From San Jose, exit highway 101 at Willow Road, Menlo Park, and go west to the intersection with Middlefield, turning right (at the Chevron Station). Enter the USGS campus at Survey Land (the main driveway, with large stone markers labeled "U.S. Geological Survey"). You may park in any of our lots and walk to Building 3 (see campus map at right).

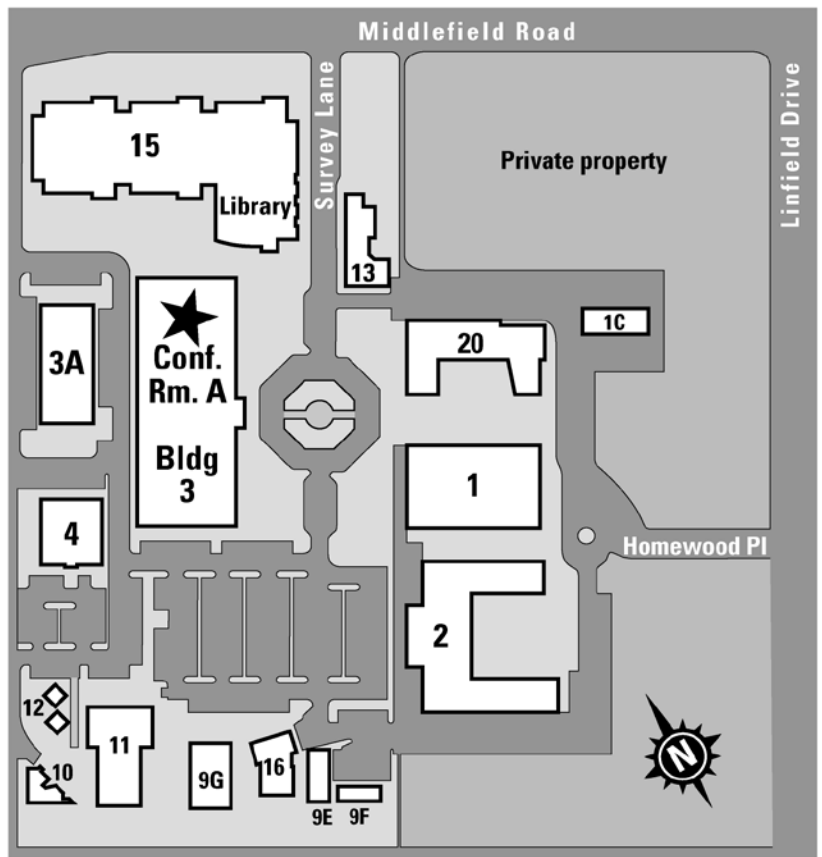
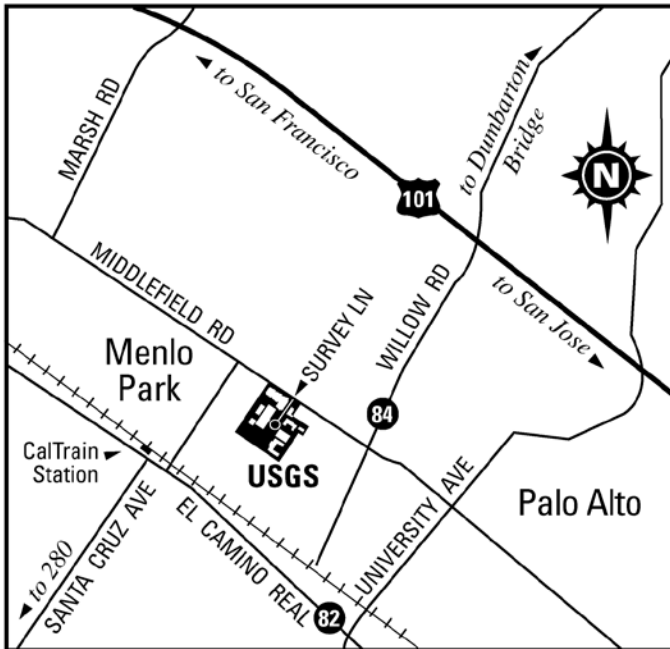

Invitation to free public lecture at U.S. Geological Survey, Menlo Park Service Center



Office of Communications
U.S. Geological Survey – MS144
345 Middlefield Road
Menlo Park, CA 94025

FIRST CLASS POSTAGE

