

EXPLORING THE EARTH'S CRUST

Seismology Uncovers Hidden Secrets Beneath our Feet

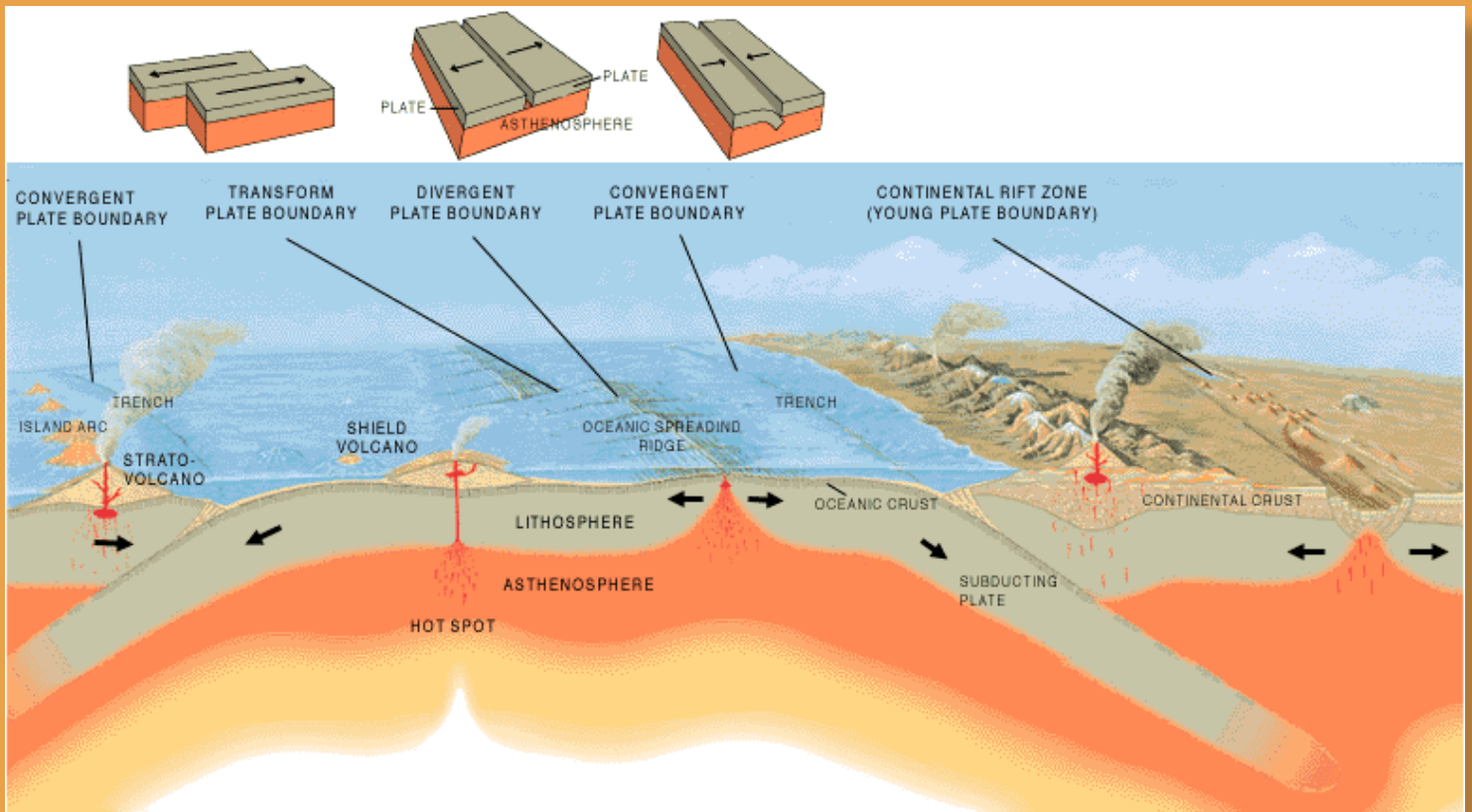

by Walter D. Mooney, Geophysicist

- During the past century, scientists have dissected the outer layer of our planet with bold scientific investigations revealing the deep properties of the Earth's crust
- Scientific creativity has fostered innovation in field measurements from the Tibetan Plateau to the deep Pacific Ocean, and beyond
- New insights are providing clues to processes that have been shaping the Earth during the past 4.5 billion years

Free Public Lecture
USGS Menlo Park Campus
January 24, 2013 at 7 PM

Directions to U.S. Geological Survey

The USGS Menlo Park Science Center is located at 345 Middlefield Road in Menlo Park

From San Francisco

- Exit highway 101 at Marsh Road, Atherton
- Go west to the T-junction with Middlefield Rd.
- Turn left (south)

From San Jose

- Exit highway 101 at Willow Road, Menlo Park
- Go west to Middlefield Rd.
- Turn right (north)

Enter the USGS campus at Survey Lane with large stone markers labeled “U.S. Geological Survey”

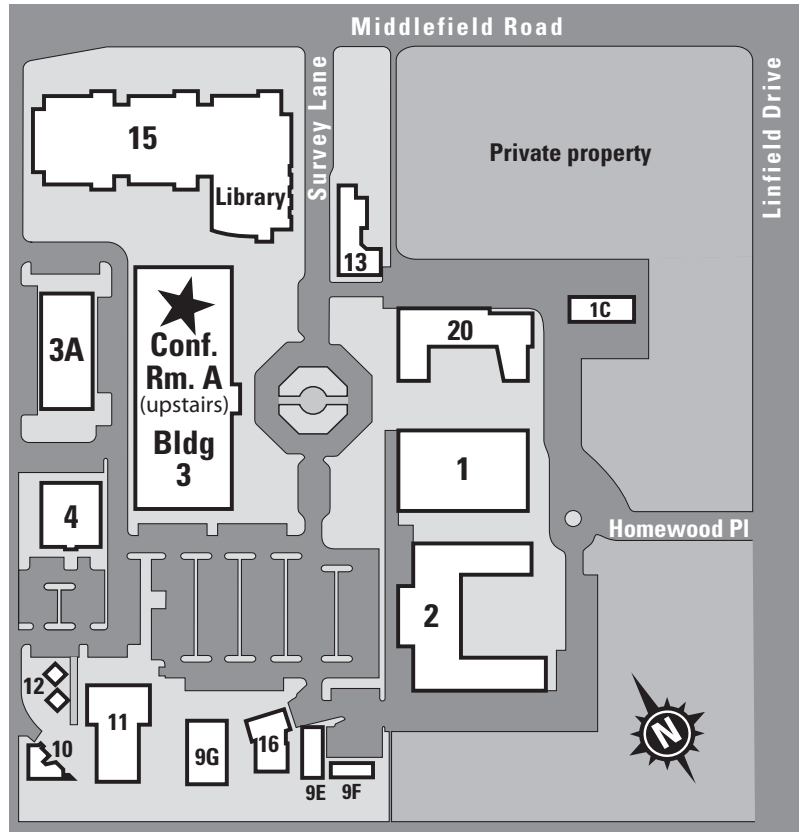
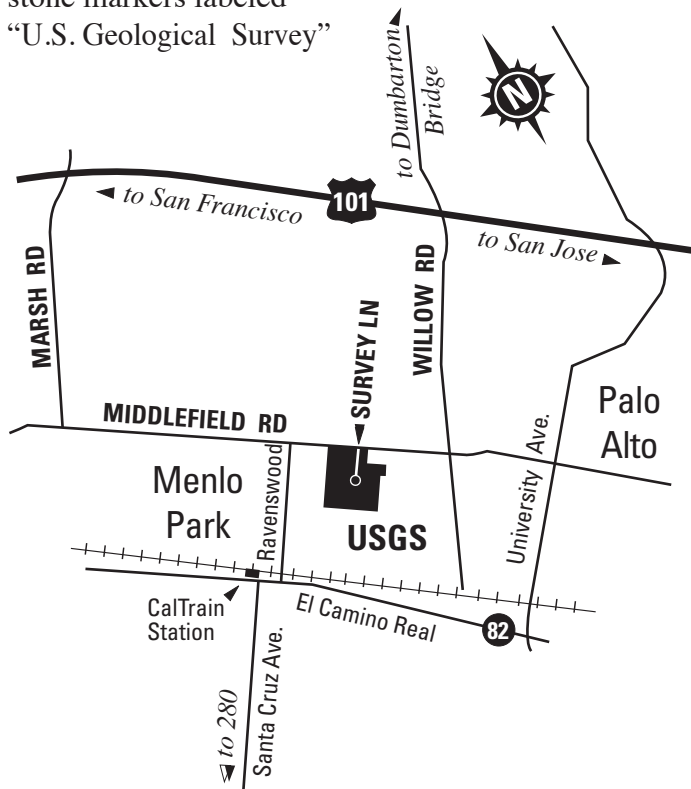

 For special needs accommodation please call 650-329-5136, or e-mail abarrales2@usgs.gov, two weeks prior to an upcoming event.

Free USGS Public Lecture

For email announcements: abarrales2@usgs.gov



Office of Communications
U.S. Geological Survey – MS144
345 Middlefield Road
Menlo Park, CA 94025



FIRST CLASS POSTAGE

